

Ruins at Bewley Castle

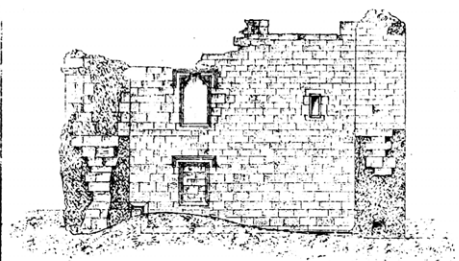

S.E. Elevation

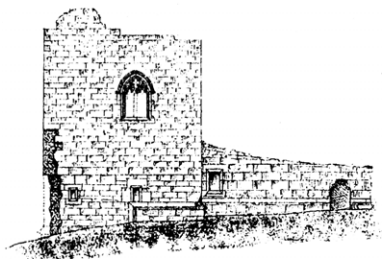

N.E. Elevation

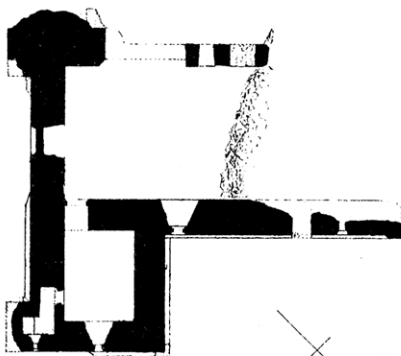

Plan



Charles J. Ferguson F.S.A.

ENGLISH OF CARLISLE,
15 TRANS. ST. WESTMINSTER SW
NOV. 10, 1885

ART. XXXVIII.—*The Episcopal Residences* of the Bishop of Carlisle, No. 1. Buley or Bewley Castle.* By R. S. FERGUSON, F.S.A.

Read at Appleby, September 22nd, 1885.

EASTWARD from Bolton, and about a mile and a half west from Appleby, is a pleasant seat belonging to the bishop of Carlisle, called Buley Castle, on the south side of Eden, opposite Crackenthorp. It was formerly controverted, but is now agreed to be in Morland parish. It was so called, from its being built by, or belonging unto John Builly, whose daughter and heir Idonea was married to the first Robert de Veteripont. It is now a mean ruinous building: but anciently the bishops sometimes resided here. Several ordinations have been held at this place. And divers confirmations of charters and other publick acts are dated from hence. Perhaps at such times especially when the bishop was desirous to be removed out of the way of the Scotch incursions, *Nicolson and Burn*, vol. i. p. 456.

Mr. Hodgson in his history of Westmorland gives an account, which is a mere paraphrase of the above.

Both accounts are misleading, as to the site of Buley Castle; the modern farm house of Beuley Castle stands near the river Eden, but the ruins of the ancient castle are at least half a mile from the river, and stand on the bank of a small beck, which runs into the river. The ruins consist of an L shaped block, the line bisecting whose angle runs, as near as possible, north and south, the hollow angle being to the north and the longer limb running from north-west to south-east. The shorter limb is about 40 feet in length from the angle of the L and projects about 15 feet beyond the longer limb. The lower portion of this projection is occupied by a vaulted chamber about 12 feet by 9 feet internal measurement, lighted by a small square-headed window in the N.E. front: it has a garderobe in the

* Linstock, Rose, Buley, Horncastle, Melbourne, Carlisle House in the Strand.
east

east angle, lighted by a similar, but smaller window. The chamber over this has fragments of a very beautiful window of the decorated period, (see the N.E. elevation given herewith) and was probably the chapel. The angle of the L now contains two chambers, floorless, one over the other, lighted by windows in the S.E. front. The buttress at the angle has contained a system of garderobes.

At some time or other this angle has been used as a cottage, the lower window built up and made into a fire place, and a hole bored through the wall, below the upper window, for a smoke hole.

The entrance has been in the longer limb, but has been robbed of its lintel, threshold and sides, and exists only as a huge gap. The rest of the longer limb is occupied by two vaulted chambers: they are not shown upon the plan given with these papers, being buried under a heap of fallen ruins: the one to the N.W. is entered though the other, which has a compartment for a garderobe built in it.

By the kindness of Mr. Bellasis, Lancaster Herald, we are able to reproduce two sketches taken about a century ago by his grandfather Dr. Bellasis, vicar of Appleby.

One of these gives a view of the ruins from the east: by comparison with the two elevations given with this paper and taken in the autumn of 1885, we see that a whole story has perished in the last 100 years. The other gives a view, from the interior, of the upper window (first floor) in the S.E. front, which is important, as the transom and mullion are now entirely gone: Dr. Bellasis, in finishing this drawing, has shaded the right side of it, which makes it appear as if the window projected on the interior, instead of being flush with the wall.

John de Builli or de Busli was descended from Ernald, the younger son of the Sieur de Builli, in the Bailiwick of Drincourt in Normandy: from Roger the elder son of the Sieur, the lords of the honour of Tickhill, in Yorkshire, were descended. Richard de Busli, grandson and heir of
Ernald

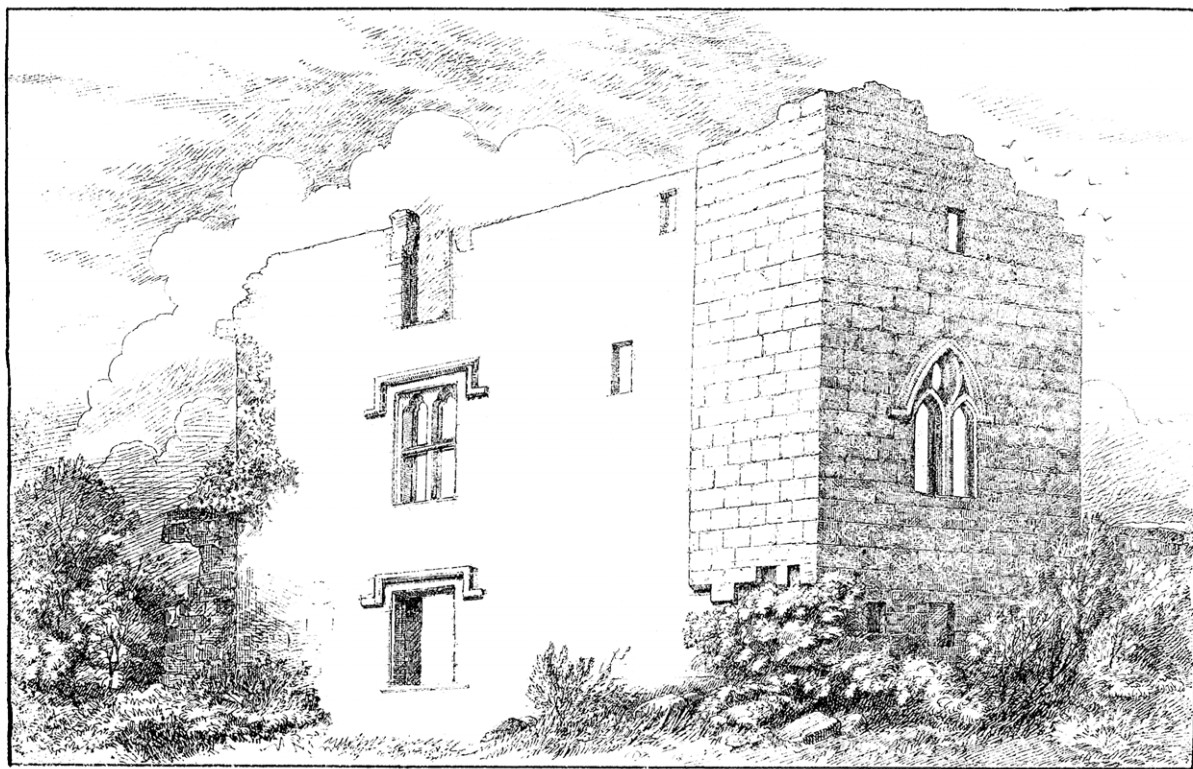

BULEY CASTLE, WESTMORLAND.

(From a drawing by the Rev. G. Bellasis, D.D., June 12, 1789).

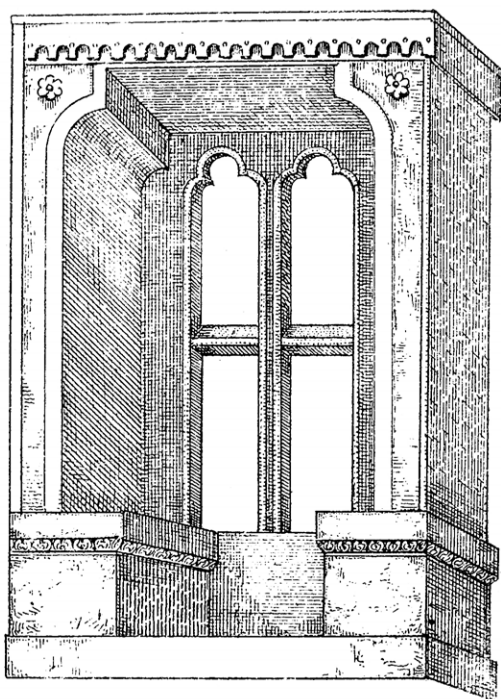

WINDOW AT BULEY CASTLE.

(From a Drawing by the Rev. G. Bellasis, D.D., June 12, 1789).

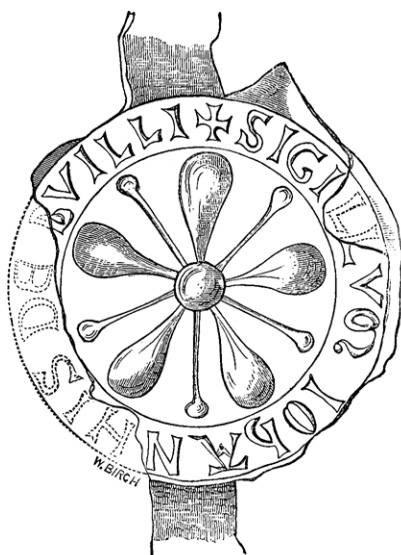

SEAL OF JOHN DE BULLI, TEMP K. JOHN.

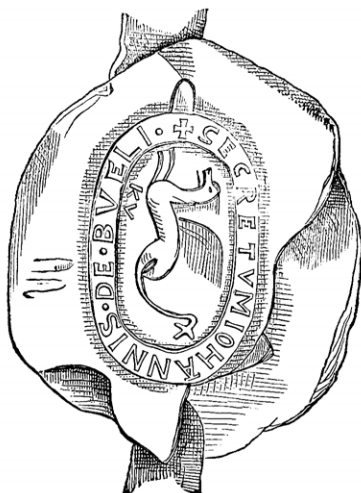

COUNTER SEAL OF SAME.

Ernald was the founder of Roche Abbey. John de Busli was his son and heir, and died 1213, leaving by his wife Cecilia an heiress Idonia de Busli, married to Robert de Vipont : he died 1228, and she 1241 : in 1220 she laid claim to the honour of Tickhall. See an article on *The Counts of Eu, sometime lords of the honour of Tickhill*, Yorkshire. Arch. & Top. Journal, vol. ix. p. 257-291. Also *Roche Abbey*, British Arch. Association, vol. xxx., 420-423, where is engraved a very beautiful seal and gem counterseal of John de Busli. On the seal is engraved a seeded cinquefoil of bold pattern ; the counter-seal is an unusually fine antique gem, of which the device is a winged river horse. The gem is inscribed with the letters K V, probably the name of the engraver. By the kind permission of the council of the British Archæological Association, we reproduce this seal and counter from an electro kindly lent us by the Yorkshire Society.

Nothing is at present known of the history of Buley Castle, or how the see of Carlisle acquired it. In date it seems later than the time of John de Builli, and from the accomodation it affords, seems to have been designed rather for the reception of a peaceful prelate, than of a bold border baron. In 1649, the manor of Bewley Castle was sold by the Parliamentary Commissioners to Robert Braithwaite, for £321 10s. It was resumed after the Restoration, and in 1853 was sold by the Ecclesiastical Commissioners to William Brougham. It is now the property of R. Burra, Esq., of 32, Chester, Terrace, London, to whom I am indebted for permission to make the plans and elevations which accompany this paper, and which come from my brother's office.
