



Ridgeway Farm, Purton, North Wiltshire

Archaeological Evaluation Report



Fieldwork

Wessex Archaeology



www.wessexarch.co.uk

Ridgeway Farm, Purton, North Wiltshire Archaeological Evaluation

Prepared for:

Taylor Wimpey UK Ltd (Strategic Land)
Weald Court
101-103 Tonbridge Road
Hildenborough
Tonbridge
Kent
TN11 9HLF



Summary

Wessex Archaeology was commissioned by Taylor Wimpey UK to undertake an archaeological evaluation ahead of development on land at Ridgeway Farm, Purton, North Wiltshire centred on NGR 411417 187084.

The works comprised 83 machine excavated trial trenches (30m x 1.8m) consistent with an approximate 2% sample of the Site area. The work aimed to identify the date, extent, character and preservation of any underlying archaeological remains and in particular to assess the results of a previous desk-based assessment geophysical survey.

Duration

The fieldwork was undertaken between the 15th and 26th August 2011.

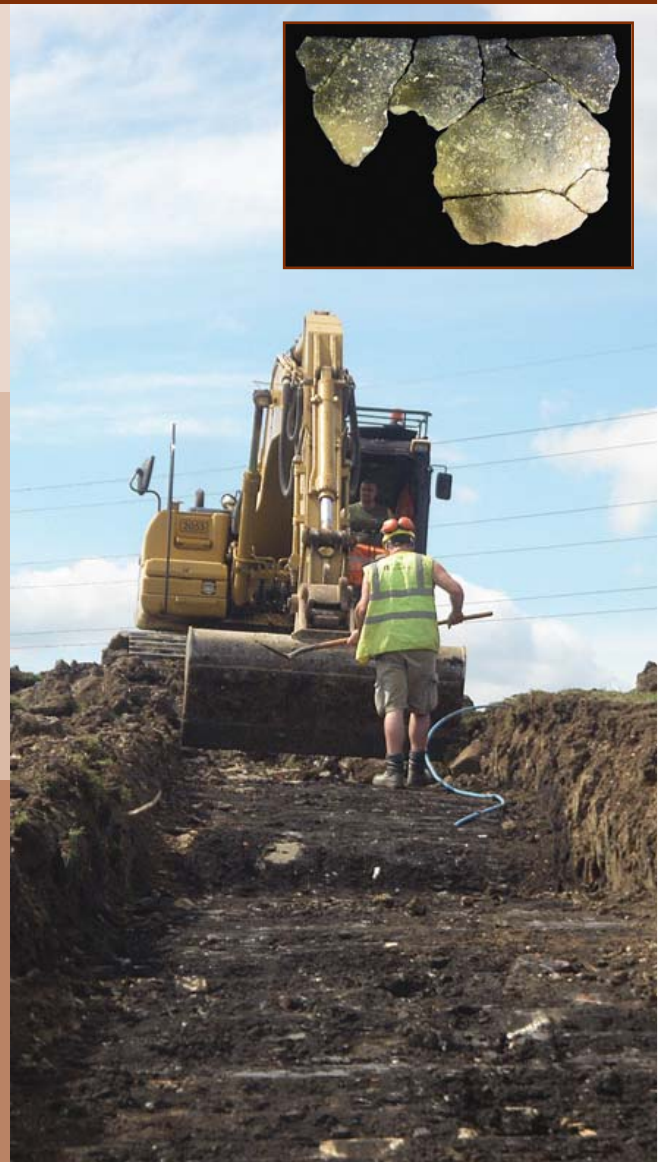
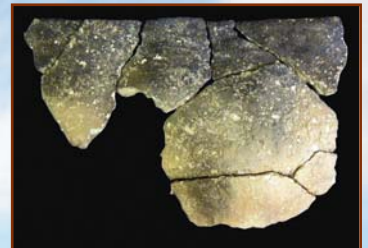

Fieldwork results

To the south-west of Ridgeway Farm, the fieldwork revealed a concentration of intercutting Early to Middle Iron Age rubbish pits containing deliberately deposited occupation debris including pottery and animal bone. Adjacent postholes suggest associated structures may be present. To the south, a second concentration of features which could relate to quarrying or tree clearance, were dated to the Romano-British period.

Extensive modern land fill recorded in the north-west of the Site comprised contaminated clay containing modern debris to a depth of 2.2 m to 2.8 m. The area may have been quarried for limestone prior to the modern infilling.



Conclusion and recommendations

Archaeological features in the south-west of the Site define areas of Early to Middle Iron Age and Romano-British activity. The character of the features and the range of artefacts recovered are of local significance. Pottery fragments recovered from the topsoil overlying these features and from the topsoil in adjacent trenches were dated to the Romano-British and possibly Saxon period and are important in defining the extent of a proposed archaeological mitigation area. The archaeological remains were encountered immediately below the topsoil and would be directly impacted by any future development. It is therefore likely that the County Archaeologist for Wiltshire Council will require further archaeological mitigation in this area.

The modern land fill in the north-west of the Site covered an area of c. 5ha. No archaeological horizons were revealed to have survived as a result of this extensive modern impact.

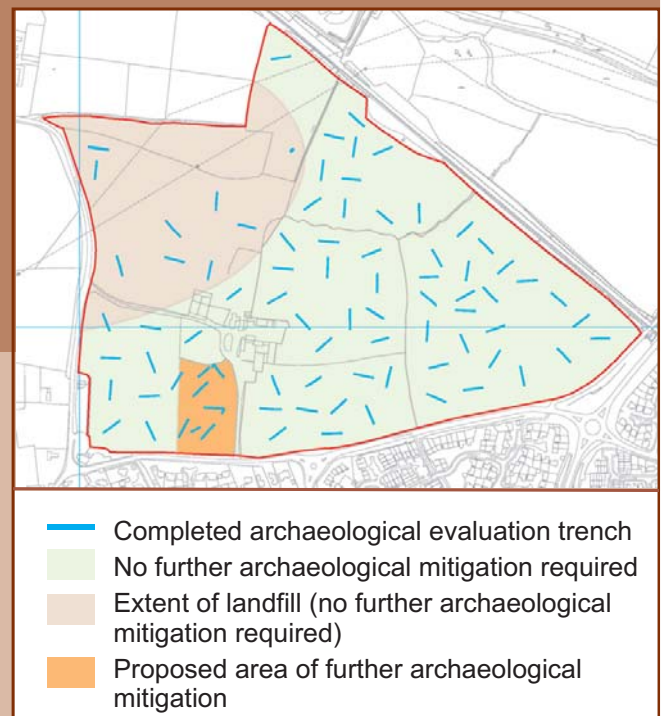

- Completed archaeological evaluation trench
- No further archaeological mitigation required
- Extent of landfill (no further archaeological mitigation required)
- Proposed area of further archaeological mitigation

Contains Ordnance Survey data © Crown copyright and database right 2010.
This material is for client report only © Wessex Archaeology. No unauthorised reproduction.

Salisbury
Nick Truckle

Wessex Archaeology
Portway House
Old Sarum Park
Salisbury SP4 6EB
01722 326867
n.truckle@wessexarch.co.uk

Sheffield
Chris Moore

Wessex Archaeology
Unit 6, Riverside Block
Sheaf Bank Business Park
Sheffield S2 3EN
0114 255 9774
c.moore@wessexarch.co.uk

Edinburgh
Candy Hatherley

Wessex Archaeology
7/9 North St David Street
Edinburgh
EH2 1AW
0131 524 9561
c.hatherley@wessexarch.co.uk

Rochester
Helen Glass

Wessex Archaeology
Bridgewood House, 8 Laker Road
Airport Industrial Estate, Rochester
Kent ME1 3QX
01622 739381
h.glass@wessexarch.co.uk



**RIDGEWAY FARM, PURTON
NORTH WILTSHIRE**

Archaeological Evaluation Report

Prepared for

Taylor Wimpey UK Ltd
Strategic Land
Weald Court
101-103 Tonbridge Road
Hildenborough
Tonbridge
Kent
TN11 9HL

By

Wessex Archaeology
Portway House
Old Sarum Park
SALISBURY
Wiltshire
SP4 6EB

Report reference: 78261.03

September 2011

*© Wessex Archaeology Limited 2011 all rights reserved
Wessex Archaeology Limited is a Registered Charity No. 287786*

DISCLAIMER

THE MATERIAL CONTAINED IN THIS REPORT WAS DESIGNED AS AN INTEGRAL PART OF A REPORT TO AN INDIVIDUAL CLIENT AND WAS PREPARED SOLELY FOR THE BENEFIT OF THAT CLIENT. THE MATERIAL CONTAINED IN THIS REPORT DOES NOT NECESSARILY STAND ON ITS OWN AND IS NOT INTENDED TO NOR SHOULD IT BE RELIED UPON BY ANY THIRD PARTY. TO THE FULLEST EXTENT PERMITTED BY LAW WESSEX ARCHAEOLOGY WILL NOT BE LIABLE BY REASON OF BREACH OF CONTRACT NEGLIGENCE OR OTHERWISE FOR ANY LOSS OR DAMAGE (WHETHER DIRECT INDIRECT OR CONSEQUENTIAL) OCCASIONED TO ANY PERSON ACTING OR OMITTING TO ACT OR REFRAINING FROM ACTING IN RELIANCE UPON THE MATERIAL CONTAINED IN THIS REPORT ARISING FROM OR CONNECTED WITH ANY ERROR OR OMISSION IN THE MATERIAL CONTAINED IN THE REPORT. LOSS OR DAMAGE AS REFERRED TO ABOVE SHALL BE DEEMED TO INCLUDE, BUT IS NOT LIMITED TO, ANY LOSS OF PROFITS OR ANTICIPATED PROFITS DAMAGE TO REPUTATION OR GOODWILL LOSS OF BUSINESS OR ANTICIPATED BUSINESS DAMAGES COSTS EXPENSES INCURRED OR PAYABLE TO ANY THIRD PARTY (IN ALL CASES WHETHER DIRECT INDIRECT OR CONSEQUENTIAL) OR ANY OTHER DIRECT INDIRECT OR CONSEQUENTIAL LOSS OR DAMAGE

Quality Assurance

Site Code	78261	Accession Code		Client Code	
Planning application Ref.		NGR	411417 187084		

Version	status*	Prepared by	APPROVE D BY	Approver's Signature	Date	File
01	E	Susan Clelland and Caroline Budd	Richard Greatorex		07/09/11	78261_Ridegway Farm Evaluation Report_Draft to client_CB_070911.doc
02	F	Caroline Budd	Clare King (Wiltshire Council)		23/09/11	78261_Ridegway Farm Evaluation Report FINAL following WC comments_CB_230911.doc

- I= Internal Draft E= External Draft F= Final

RIDGEWAY FARM, PURTON, NORTH WILTSHIRE

Archaeological Evaluation Report

Contents

1	INTRODUCTION	1
	1.1 Project Background	1
2	THE SITE.....	1
	2.1 Location, topography and geology	1
3	ARCHAEOLOGICAL AND HISTORICAL BACKGROUND	2
	3.1 Introduction.....	2
	3.2 Recent Investigations	2
4	METHODOLOGY	3
	4.1 Evaluation Strategy	3
	4.2 Aims and Objectives.....	3
	4.3 Trial trenching.....	4
	4.4 Archaeological excavation and recording.....	4
	4.5 Finds collection.....	5
	4.6 Finds treatment.....	5
	4.7 Health and Safety	5
5	RESULTS	5
	5.1 Introduction.....	5
	5.2 Results.....	6
6	FINDS	9
	6.1 Introduction.....	9
	6.2 Animal bone.....	10
7	ENVIRONMENTAL.....	10
8	DISCUSSION.....	11
	8.1 Introduction.....	11
9	CONCLUSION.....	12
10	STORAGE AND CURATION	12
	10.1 Museum.....	12
	10.2 Preparation of archive	12
	10.3 Conservation	13
	10.4 Discard policy	13
	10.5 Copyright, Designs and Patents Act 1988.....	13
	10.6 Security copy	13
11	BIBLIOGRAPHY	14
12	APPENDIX 1: TRENCH SUMMARIES	15

Figures:

- Figure 1** Site and trench location plan with drift geology from trench observations
- Figure 2** Archaeological evaluation results
- Figure 3** Early-Middle Iron Age/possible Early-Middle Iron Age features in trenches 61 and 89
- Figure 4** Romano-British/Possible Romano-British features in trenches 70 and 90
- Figure 5** Trench layout with proposed recommendations for further archaeological mitigation

Plates:

- Plate 1** Early Iron Age pottery from feature 61005
- Plate 2** Trench 90 looking south-west

- Front cover** View of Mill Hill looking north-west
- Back cover** Excavation of Trench 77 looking west

RIDGEWAY FARM, PURTON, NORTH WILTSHIRE

Archaeological Evaluation Report

Summary

Wessex Archaeology was commissioned by Taylor Wimpey UK to undertake an archaeological evaluation ahead of development on land at Ridgeway Farm, Purton, North Wiltshire centred on NGR 411417 187084.

The works comprised 83 machine excavated trial trenches (30m x 1.8m) consistent with an approximate 2% sample of the Site area. The fieldwork was undertaken between the 15th and 26th August 2011 and aimed to identify the date, extent, character and preservation of any underlying archaeological remains and in particular to assess the results of a previous desk-based assessment and geophysical survey.

To the south of Ridgeway Farm, the fieldwork revealed a concentration of intercutting Early to Middle Iron Age rubbish pits containing deliberately deposited occupation debris including pottery and animal bone. Adjacent postholes suggest associated structures may be present. To the south, a second concentration of features which could relate to quarrying or tree clearance, were dated to the Romano-British period.

Extant ridge and furrow was present throughout the two fields to the east of Ridgeway Farm which were aligned broadly north to south. No associated medieval features were recorded in these areas.

Numerous and diverse field drains (including stone filled French Drains and ceramic Dutch and later mole drains) were found across the Site.

Extensive modern land fill recorded in the north-west of the Site comprised contaminated clay containing modern debris to a depth of 2.2 m to 2.8 m. The area may have been quarried for limestone prior to the modern infilling.

Archaeological features in the south of the Site define areas of Early to Middle Iron Age and Romano-British activity. The character of the features and the range of artefacts recovered are of local significance. Pottery fragments recovered from the topsoil overlying these features and from the topsoil in adjacent trenches were dated to the Romano-British and possibly Saxon period and are important in defining the extent of a proposed archaeological mitigation area. The archaeological remains were encountered immediately below the topsoil and as such would be directly impacted by any future development. It is therefore likely that the County Archaeologist for Wiltshire Council will require further archaeological mitigation in this defined area.

The modern land fill in the north-west of the Site covered an area of c. 5ha. No archaeological horizons were revealed to have survived as a result of this extensive modern impact.

**RIDGEWAY FARM,
PURTON, NORTH WILTSHIRE**

Archaeological Evaluation Report

Acknowledgements

Wessex Archaeology is grateful to Taylor Wimpey (the Client), specifically John Aylwin, for commissioning the evaluation. The advice and assistance provided by Melanie Pomeroy-Kellinger and Clare King who monitored the project on behalf of the Wiltshire Council Archaeology Service, is duly acknowledged.

The evaluation fieldwork was directed by Susan Clelland, assisted by Neil Fitzpatrick, Rebecca Wills, Ray Kennedy, Matt Fenn and Vicky Gallagher.

This report was prepared by Susan Clelland with contributions from Rachael Seager Smith (Finds). The report illustrations were prepared by Rob Goller.

The project was managed on behalf of Wessex Archaeology by Caroline Budd.

RIDGEWAY FARM, PURTON NORTH WILTSHIRE

Archaeological Evaluation Report

1 INTRODUCTION

1.1 Project Background

- 1.1.1 Wessex Archaeology was commissioned by Taylor Wimpey UK Ltd (hereafter 'the Client') to carry out a programme of archaeological evaluation by machine excavated trial trenches ahead of development on land at Ridgeway Farm, Purton, North Wiltshire (hereafter 'the Site') centred on National Grid Reference (NGR) 411417 187084 (**Figure 1**).
- 1.1.2 The methods by which the archaeological field evaluation was undertaken were outlined in *Ridgeway Farm, Purton, North Wiltshire – Written Scheme of Investigation for an Archaeological Field Evaluation* (Wessex Archaeology 2011b).

2 THE SITE

2.1 Location, topography and geology

- 2.1.1 The Site comprises an irregular area of approximately 37.5ha (**Figure 1**). The Site's north-eastern boundary is defined by the Swindon/Cheltenham railway line, this boundary consists of a single track set on a mixture of shallow embankments and cuttings. Purton Road forms the southern boundary, whilst the western boundary is formed by the B4553 Cricklade/Purton Road. The borough boundary runs along Purton Road and the Site lies within North Wiltshire district.
- 2.1.2 In the north of the Site a small hill (named in historic maps as Mill Hill) lies at c. 98m above Ordnance Datum (aOD). It has been partly cut by the railway line. From the hill the ground slopes south-west towards Ridgeway Farm which is set on a small ridge at approximately 90m aOD. The farm complex comprises a number of buildings including the farmhouse, outbuildings and a large stone and brick built open fronted structure (possibly a fold yard).
- 2.1.3 The surrounding landscape comprised pasture fields, bounded by hedgerows, much of it grazed by cattle and sheep.
- 2.1.4 The solid geology of the Site is predominantly Upper Jurassic Kimmeridge Clay and Upper Corallian deposits (Geological survey of Great Britain Sheet 252 Swindon 1:63360 1974). The detail of this geological variation is represented in **Figure 1**. The Upper Corallian deposits (Coral Rag) are represented as 'limestone brash' and the gleyed orange clay and marsh clays represent the Upper Jurassic Kimmeridge Clay. The interface between the geological boundaries is shown as the clay brash and gleyed sandy clay deposits.

3 ARCHAEOLOGICAL AND HISTORICAL BACKGROUND

3.1 Introduction

- 3.1.1 The archaeological evaluation follows a desk-based assessment and heritage statement by Wessex Archaeology (WA 2007 and WA 2011). A walkover survey and geophysical survey had also previously been undertaken. The results of which are briefly summarised below.
- 3.1.2 The Site is located c. 400m south of an area designated a 'Locally Important Archaeological Site' by Wiltshire Council (WC). This represents an area of extant ridge and furrow earthworks. The area of ridge and furrow situated within the Site boundary (**Figure 2**) does not form part of this designated area.
- 3.1.3 There are no Listed Buildings within the Site. The only Listed Building recorded in the vicinity is the Grade II Listed Moredon Aqueduct, situated c. 400m to the north. The North Wiltshire Canal is located just to the north of the Site beyond the existing railway line to the north.
- 3.1.4 The desk-based assessment (WA 2007) identified a background level of prehistoric activity in the area with more recent discoveries at the Moredon Bridge site confirming a prehistoric presence.
- 3.1.5 Romano-British and Saxon period pottery fragments have been recovered in the area, although no evidence for activity from these periods has previously been identified within the Site boundaries.
- 3.1.6 Potential evidence for medieval agricultural activity is present within the Site comprising an area of ridge and furrow earthworks which survive in the south-eastern quadrant of the Site. Further medieval remains are recorded outside the Site, focused around the village of Purton to the west.
- 3.1.7 Post-medieval activity is represented by Ridgeway farmhouse and associated ancillary buildings and though one of the buildings is Listed some may be of local interest. The remains of Ridgeway Mill are located just to the north of the Site, still visible as a group of earthworks close to the River Ray. No development is proposed in this area.
- 3.1.8 Modern features of potential archaeological and historical interest include the Grade II Listed Moredon Aqueduct and the extant element of the Great Western Railway which bisects the Site from north-west to south-east.

3.2 Recent Investigations

Detailed Walkover Survey

- 3.2.1 A slightly raised area was noted during the walkover survey lying within the area of ridge and furrow, which it appears to post-date. The nature of this feature remains unknown, although given the geophysical results below, it is likely to represent a building platform associated with a former agricultural structure.

Geophysical Survey

- 3.2.2 Magnetic reconnaissance survey was carried out across all accessible areas of the Site. The survey was supported by detailed magnetometry targeted on areas of enhanced magnetic susceptibility, earthworks and additional control areas. In all, nine separate areas of detailed magnetometry were surveyed totalling approximately 7ha.
- 3.2.3 Two zones which were subject to detailed magnetometry produced anomalies that suggested anthropogenic activity. Magnetometry targeted on earthwork features, including those identified during the detailed walkover survey, did not produce anomalies that would support an archaeological interpretation. Ridge and furrow was revealed by magnetometry to the east of Ridgeway Farm and it is suggested that soil characteristics may play an important part in the formation of magnetic contrast across the Site.
- 3.2.4 Areas where imported material is known to have been deposited offered inconclusive geophysical results, probably as a result of quantities of magnetic debris within the dumped material.

4 METHODOLOGY

4.1 Evaluation Strategy

- 4.1.1 The evaluation was carried out in accordance with the methodology as laid out in the document in *Ridgeway Farm, Purton, North Wiltshire – Written Scheme of Investigation for an Archaeological Field Evaluation* – (Wessex Archaeology 2011b).

4.2 Aims and Objectives

General

- 4.2.1 The aims of the archaeological field evaluation were to:
- Clarify the presence/absence and extent of any buried archaeological remains within the Site that may be threatened by development.
 - To confirm and enhance the results of the previous geophysical survey by testing a sample of the anomalies revealed.
 - Identify, within the constraints of the evaluation, the date, character, condition and depth of any surviving remains within the Site.
 - Assess the degree of existing impacts to sub-surface horizons and to document the extent of archaeological survival of buried deposits.
 - Produce a report which will present the results of the evaluation in sufficient detail to allow an informed decision to be made concerning the Site's archaeological potential.

Specific

- 4.2.2 To confirm the results of the desk-based assessment and geophysical survey by targeting the location of the trial trenches on previously identified anomalies.

4.3 Trial trenching

- 4.3.1 All trenches were marked out on the ground prior to the commencement of work and located relative to Ordnance Survey (OS) grid. Topsoil and overburden were removed using a 360° tracked excavator fitted with a toothless bucket, working under the continuous direct supervision of a suitably experienced archaeologist. Spoil was stockpiled at a safe distance from the edge of trenches, with topsoil and subsoil stockpiled separately.
- 4.3.2 Topsoil and modern overburden were removed in a series of level spits down to the top of the first significant archaeological horizon. Excavation ceased at a depth of 1.2m in accordance with Health and Safety guidelines.
- 4.3.3 Following excavation and recording, all trenches were carefully backfilled on completion using excavated material in accordance with best practice, but not otherwise reinstated.

4.4 Archaeological excavation and recording

- 4.4.1 All archaeological and potentially archaeological features exposed in the trial trenches were cleaned and recorded in plan at an appropriate scale. The aims of the project were to assess presence, absence, density and feature type. Care was also taken to be minimally intrusive and where possible, not to compromise the integrity of archaeological features or deposits, which might better be investigated under the conditions pertaining to full excavation. This approach was agreed during on-site consultations with Clare King of Wiltshire Council Archaeology Service and is discussed in detail below (5.2.4 and 5.2.9)
- 4.4.2 All archaeological features and deposits encountered were recorded using WA *pro forma* recording sheets and a continuous unique numbering system. Plans at appropriate scales were prepared, showing the areas investigated and their relation to more permanent topographical features. The plans show the location of contexts observed and recorded in the course of the investigation. Other plans, sections and elevations of archaeological features and deposits were drawn at 1:10, 1:20 and 1:50 (as appropriate). All drawings were made in pencil on permanent drafting film.
- 4.4.3 The spot height of all principal features and levels was calculated in metres relative to Ordnance Datum, correct to two decimal places. Plans, sections and elevations were annotated with spot heights as appropriate.
- 4.4.4 Photographs were taken as necessary to produce a photographic record and to support report preparation. Photographs were also taken of areas prior to trenching and after backfilling.

4.5 Finds collection

4.5.1 All finds were recorded by context and significant objects recorded in three dimensions. All recovered objects have been retained unless they are undoubtedly of modern or recent origin. The presence of modern objects was, however, noted on context records. In these circumstances sufficient material was retained to elucidate the date and function of the deposit from which it was recovered. Animal bones were recovered by hand during excavation and processed as part of the finds assemblage. Animal bone recovered from bulk samples was also retained for analysis.

4.6 Finds treatment

4.6.1 All finds were processed in accordance with the Institute for Archaeologists' *Standard and Guidance for the collection, documentation, conservation and research of archaeological materials* (IfA 2001, revised 2008). All artefacts were, as a minimum, washed, marked, counted, weighed and identified. Spot dating of finds was undertaken during the course of the fieldwork in order to inform excavation strategy. Objects that required immediate conservation treatment to prevent deterioration were treated according to guidelines laid down in *First Aid for Finds* (Watkinson and Neal 1998).

4.7 Health and Safety

4.7.1 All work was carried out in accordance with the Health and Safety at Work etc. Act 1974 and the Management of Health and Safety regulations 1992 and all other relevant Health and Safety legislation and regulations and codes of practice in force at the time.

4.7.2 Prior to the commencement of the fieldwork, site-specific Risk Assessments were produced. All site staff involved in the work signed and complied with this document.

5 RESULTS

5.1 Introduction

5.1.1 The archaeological evaluation was undertaken between Monday 15th and Friday 26th August 2011. A total of 83 trenches were excavated (**Figures 1 to 5**).

5.1.2 The evaluation revealed two adjacent concentrations of archaeological remains located in the south of the Site. These dated from the Early/Middle Iron Age and Romano-British periods. The results are discussed below by chronological period. A number of features and deposits remain undated, but are described, along with their possible association and significance to other positively dated archaeological features.

5.1.3 Of the proposed 87 trenches measuring, on average, 30m x 2m a total of 83 trenches were excavated:

- **6** were not opened within an area demonstrated to comprise modern landfill (Trenches **72, 73, 78, 80, 81, 82**). This was agreed in consultation with WCAS
- **2** trenches were extended to clarify the nature of potential archaeological remains (Trenches **61** and **66**).
- **2** additional trenches were opened to further clarify the extent of these archaeological remains (**89** and **90**)

5.1.4 The underlying natural deposits varied across the Site as shown of **Figure 1**, and ranged from seams of limestone brash to gleyed orange clay.

5.1.5 This report provides a summary of the information derived from the trial trench evaluation. Detailed trench summaries containing a brief description of all of deposits uncovered are provided in **Appendix 1**.

5.2 Results

Early/Middle Iron

5.2.1 A concentration of intercutting Early to Middle Iron Age rubbish pits were identified at the northern end of Trench 61 (**Figures 2** and **3**). Subsequent to the hand excavation of pits **61005** and **61007** and post-pit **61003** the trench was extended to further investigate and define the extent of the surviving archaeological remains. An additional trench, Trench 89 was also excavated in this regard (**Figure 2**).

5.2.2 Pit **61005** (1.5 m x 1.3 m x 0.5 m) (**Figure 3** and **inset**) was the largest of the features within the group and was found to cut away pit **61007** to the north and pit **61012** to the south. . A single deposit of deliberately backfilled material containing joining fragments of pottery vessels and animal bone, consistent with occupation debris, was recovered from pit **61005**. No artefacts were recovered from the full excavation of pit **61007** (**Figure 3** and **inset**).

5.2.3 Post-pit **61003** (**Figure 3**) defined a 0.7 m diameter posthole elongated during the removal of the associated post. Large fragments of flint and limestone within the backfill are likely to represent post-packing.

5.2.4 The remainder of the features identified within Trench 61 and the eastern end of Trench 89, were recorded in plan only to preserve their integrity for possible future mitigation (**Figure 3**). Elongated pits **61008, 61012, 61014** and **61016** all contained loose of re-deposited material of reworked limestone within a mid-brown silty matrix. Pit **61010** may represent two intercut features as the southern half of the feature contained a loose reddish brown clay and the northern end reworked limestone within a mid-brown silty matrix.

5.2.5 Adjacent postholes also visibly containing stone packing included **61018, 61020, 61022** and **89003** and suggest that associated structures maybe present in the vicinity.

5.2.6 No additional trenches were excavated to the north of the features in Trench 61 due to truncation caused by a modern show-jumping structure (**Figure 2**) and Health and Safety constraints associated with that structure. The

structure is known to consist of a substantial ditch and bank arrangement (Devil's Dyke) and as such it is likely that the central area of the structure has been impacted in such a way as to preclude archaeological survival however, it is possible that features may have survived in some of the affected areas.

Romano-British

- 5.2.7 A group of possible quarry hollows were recorded in Trench 70 (**Figure 4**). An additional trench (Trench 90) was excavated to the south-west to investigate the potential extent of any archaeological features in this area (**Figure 4**).
- 5.2.8 All the archaeological features recorded in Trench 90 have been provisionally dated by pottery to the Romano-British period and those in Trench 70 have been assigned to the same period by association. All the features identified within these two trenches contained similar deposits of brown-grey gleyed clay and were moderately defined in plan.
- 5.2.9 In Trench 90, Pit **90011** (**Figure 4**) was 0.4 m in diameter and 0.1 m deep and contained joining pottery fragments dating to this period. Romano-British pottery was also recovered from the surface of adjacent pits/quarry hollows **90006** and **90003** (**Figure 4**). As features **90003** and **90006** extended beyond the trench limits it was determined, in consultation with Wiltshire Council Archaeology Service in order to preserve their integrity and allow full understanding should further excavation take place at a later stage, no further excavation was appropriate.
- 5.2.10 Adjacent features **70005** and **70006** extended beyond the northern limit of Trench 70 (**Figure 4**) and were 1.2 m and 2.4 m wide respectively. No surface finds were identified but it is thought that both represent pit/quarry hollows similar to those recorded in Trench 90. The irregular appearance of feature **70007** may be the result of rooting. Though filled with a deposit of brown-grey gleyed clay, the feature was found to be only 0.04m deep with undulating sides and base. The nature of the deposit and proximity to better defined archaeological features implies that this root disturbance may be the result of contemporary clearance during the Romano-British period..
- 5.2.11 A section excavated through feature **70002** (Trench 70), (**Figure 4**) contained no datable artefacts but revealed a wide shallow linear 0.3 m deep with a flat base. Feature **90007** (Trench 90) (**Figure 4**) exhibited a similar profile and it is possible that these features form a shallow 3.8 m wide curvilinear boundary defining the south-western extent of activity associated with the discrete features described above (**Figure 4**).
- 5.2.12 Mechanically excavated deposits of topsoil and subsoil were routinely scanned for artefacts both during removal and after the weathering of the associated spoil heaps Romano-British pottery was recovered from topsoil deposits in Trenches 61, 65 and 66. Despite no archaeological features being revealed in these trenches the pottery spread does assist in defining the extent of the archaeological activity (**Figure 5**).

Medieval-Post-medieval

- 5.2.13 Extant ridge and furrow was present throughout the two fields to the east of Ridgeway Farm which were aligned broadly north to south (**Figure 2**). Evidence of the deeper furrows were recorded in Trenches 12, 13, 16 and 17 and material relating to the furrow ridges were noted in Trenches 14, 17, 25, 39, 41, and 49. Fragments of unidentified animal bone were recovered from furrow ridge deposits in Trench 25 however no associated features or artefacts were recorded within any of the evaluation trenches.

Modern

- 5.2.14 The modern impact on the landscape of the Site was dominated by an extensive deposit of modern land fill in the north-west. A total of 9 trenches (74, 75, 76, 77, 79, 83, 84, 86 and 87) were opened within this area in order to establish the extent of this disturbance (**Figure 2**). Machine excavated test-pits were dug to investigate the depth of impact across the disturbed area in Trenches 76, 84 and 87 (see inset deposit model, **Figure 2**). It was revealed that these deposits extended between 2.2 m and 2.8 m below the present ground surface and comprised a lower layer of pungent grey black clay with lenses of burnt material overlain by a capping layer of re-deposited silty clay and rubble. Both deposits were found to contain metal, plastic, glass, brick, cable etc. Where encountered (in Trenches 76, 84 and 87) the natural geology was found to be greensand which may suggest that the area had been quarried for overlying limestone prior to the modern infilling.
- 5.2.15 A north-west to south-east aligned 1.5 m wide ditch containing modern ceramic building material and burnt debris was recorded in Trench 8 (**Figure 2**).
- 5.2.16 A wide east to west aligned trench recorded in Trenches 47 and 48 (**Figure 2**) is thought to be associated with one of the main farm water pipes.
- 5.2.17 An extant though disused north to south aligned 1.2 m wide field boundary ditch was recorded in Trench 54 (**Figure 2**).
- 5.2.18 Immediately north of the Ridgeway Farm a large machine excavated rubbish pit was recorded in Trench 50 (**Figure 2**). The pit cut away 6.6 m of the north-eastern end of the trench extending beyond its limits. The pit was excavated to a depth of 1.2 m however the base was not reached. In Trench 71 two rubbish pits were also recorded (**Figure 2**). Both were sub-square, 1.2 m in width with a recorded length of approximately 1.7 m, both extended northwards beyond the trench limits.
- 5.2.19 Numerous and diverse field drains (including stone filled French Drains, ceramic Dutch and mole drains were found across the Site (Trenches 2,5,7,9,11,17,23,27,33,35,36,45,53,54,55,67,68,69 and 70).

Undated

- 5.2.20 A probable field boundary was represented by an east to west orientated tree line incorporating approximately 10 tree throw holes in Trenches 38 and 39 (**Figure 2**). Tree throw holes were also identified in Trenches 51, 52 and 66. No artefacts were retrieved from any of these features.

6 FINDS

6.1 Introduction

- 6.1.1 Pottery was found in five of the evaluation trenches (Trenches 61, 65, 66, 88/89 and 90), all in the south-west corner of the site. Within each context, all the sherds have been rapidly scanned, spot-dated and quantified by broad ware group; this information is summarised in **Table 1** (see below).
- 6.1.2 The majority of sherds were of Early/Middle Iron Age date and most were from Trench 61 and pit **61005** (62 pieces, 1381g) in particular. Two fabrics were represented; shelly-limestone tempered wares and sandy wares. These wares form part of the standard range seen at other contemporary sites in the area (e.g. Gingell 1982; Timby 2001; McSloy 2011), where there is some evidence to suggest that the importance of the calcareous wares declined during the Iron Age as the proportion of sandy fabrics increased.
- 6.1.3 Thirty-one of the shelly-limestone tempered sherds from pit **61005** derived from a single vessel - a fairly large jar (see **Figure 3, plate**), approximately 300mm in diameter, with a globular body, a relatively tall, upright neck and a simple, unelaborated rim. The lower part of this vessel was not recovered, and its profile remains unparalleled at this stage, most jars from the vicinity being more ovoid in shape, with short, stubby or everted rims. Sooty residues were noted on both surfaces. The sandy wares (15 sherds) from this feature also included part of a wide-mouthed bead rim jar/bowl with a very well burnished exterior surface and a small fragment from a flat-topped jar rim, probably from a weakly-shouldered form. Two thin-walled (less than 3mm) body sherds hint at the presence of fineware bowls amongst this material. Overall, these sherds date from the 6th – 3rd centuries BC. Some of the plain body sherds from other contexts could be slightly later (Middle/Late Iron Age), perhaps extending this range into the 1st century BC, although all occurred residually in the contexts in which they were found.

Ware	No.	Wt. (g)
<i>Iron Age:</i>		
Calcareous ware	59	1231
Sandy	19	229
<i>Romano-British:</i>		
Greyware	18	98
Oxidised ware	5	20
Savernake-type ware	4	27
Grog-tempered ware	1	4
<i>Saxon:</i>		
Organic tempered ware	1	10
Total:	108	1622

Table 1: Total number and weight (g) of sherds by ware type and chronological period

- 6.1.4 Romano-British sherds were recovered from the topsoil of Trenches 61, 65 and 66 as well as pits/quarry hollows, **90003, 90006 and 90011** (contexts **90004, 90005 and 90012** respectively) in Trench 90. All were from local sources. The hard, fine, light grey Savernake-type ware fabric is likely to be from the Whitehill Farm and Toothill Farm kilns to the west of Swindon (Anderson 1979, 13), while even more locally, reduced (greyware) and oxidised-firing sandy coarsewares were made in the area of the Dogridge housing estate on the western side of Purton (Anderson 1980). Diagnostic sherds were limited to five rims from everted rim jars/bowls, all broken above the neck/shoulder junction, four in greyware and one in an oxidised sandy fabric. All the Romano-British sherds are likely to be of 2nd - 4th century AD date.
- 6.1.5 A single sherd of organic-tempered ware of early-middle Saxon (5th – 8th centuries AD) date was also found in pit/quarry hollow **90006** (context **90005**). Locally, this fabric can be paralleled amongst material from the Hermitage, Old Town, Swindon (Seager Smith 1997, fabric V101).

6.2 Animal bone

- 6.2.1 A total of 85 fragments of animal bone were recovered from four contexts (**25002, 61000, 61002 and 61004**) located in Trenches 25 and 61. The bone is well preserved and only a few fragments show signs of dog gnawing. The following species have been identified and are given in order of abundance: sheep/goat, cattle, pig and horse.
- 6.2.2 The seven fragments recovered from Trench 25 are all small unidentifiable splinters of bone. In Trench 61, identified fragments were recovered from topsoil (**61000**) and the fill (**61004**) of Early/Middle Iron Age pit **61005**. The pit assemblage includes a range of sheep/goat and cattle carcass parts, as well as a few pig bones and a horse scapula. Both immature and adult livestock are represented. Butchery marks including fine knife cuts were observed on some of the bones and a few charred fragments were also noted. This probably occurred as a result of normal food preparation (i.e. cooking on open fires).
- 6.2.3 Overall, the assessment results indicate that soil conditions at the Site are favourable for the preservation of animal bone. The potential to recover a larger and more informative assemblage of animal bone from future investigations at the Site is therefore quite high.

7 ENVIRONMENTAL

- 7.1.1 No material suitable for environmental analysis was demonstrated to be present within the excavated area.

8 DISCUSSION

8.1 Introduction

- 8.1.1 The archaeological evaluation trenching carried out across the Site has revealed a discrete concentration of archaeological remains dating from the Early/Middle Iron Age to Romano-British periods located to the south of the Ridgeway Farm buildings complex (**Figure 5**).
- 8.1.2 The series of intercut pits (**Figure 3**) sited on the limestone brash geology which contained both animal bone and pottery both showing signs of charring or sooty residues, are typical of occupation. These features were found in association with post-pits perhaps indicating contemporary structures in the vicinity. Pottery fragments retrieved from the overlying topsoil deposits were Romano-British in date and reflect a later phase of activity associated with a second concentration of archaeological features within the same area.
- 8.1.3 Sited on the clay geology a group of possible pits or quarry hollows (**Figure 4**) potentially enclosed within a shallow curvilinear boundary were found to contain fragments, including joining pieces, of Romano-British pottery. Contemporary pottery found in topsoil deposits in the surrounding trench locations defines an area of potential archaeological activity. A site of Romano-British pottery kilns has been recorded on the western side of Purton 2.7m west of the Site and it is possible clay was being quarried here.
- 8.1.4 One fragments of pottery, recovered from the topsoil in Trench 65 (**Figure 2**) may be of Saxon date and may suggest that the Romano-British activity within this area extended into this period.
- 8.1.5 Extant north to south aligned ridge and furrow were present throughout the two fields to the east of Ridgeway Farm (**Figure 2**), the extent of which has been defined however no associated medieval remains were identified.
- 8.1.6 Field ditches and rubbish pits associated with the modern workings of Ridgeway Farm were recorded to the north and east of the farm building complex (**Figure 2**). An area of extensive modern land fill was also recorded throughout a majority of the north-west of the Site (**Figure 2**). An area of approximately 305m² immediately north of the Early/Middle Iron Age pits had also been considerably impacted by a modern show jumping structure (**Figure 2**).
- 8.1.7 The anomalies identified by the geophysical survey proved to represent ridge and furrow in the east of the Site and changes in geology in the south-west of the Site.
- 8.1.8 The raised area observed during the walkover survey and suggested as a building platform (see 3.2.1 above) was sited over Trenches 11, 12, 13 and 15 (**Figure 1**). The observed platform or terracing is thought to have resulted from the accentuated impact of ridge and furrow at the boundary between differing underlying geologies. No evidence of archaeological or structural remains was present.

9 CONCLUSION

- 9.1.1 Archaeological features in the south of the Site define areas of Early to Middle Iron Age and Romano-British activity. The character of the features and the range of artefacts recovered are of local significance. Pottery fragments recovered from the topsoil overlying these features and from the topsoil in adjacent trenches were dated to the Romano-British and possibly Saxon period and are important in defining the extent of a proposed archaeological mitigation area (**Figure 5**). It is perhaps of note that the two groups of features were associated with different underlying geology (**Figure 1**) and may reflect differing uses of the landscape over time.
- 9.1.2 The archaeological remains were encountered immediately below the topsoil and as such would be directly impacted by any future development. It is therefore likely that the County Archaeologist for Wiltshire Council will require further archaeological mitigation in this defined area which is likely to comprise of an open area excavation as suggested on **Figure 5**. The final extent of the mitigation area will be agreed in consultation with Wiltshire Council and the area as shown on **Figure 5** suggests a proposed strategy only.
- 9.1.3 The modern land fill in the north-west of the Site covered an area of c. 5ha. No archaeological horizons were revealed to have survived as a result of this extensive modern impact and therefore it is unlikely that any further archaeological work will be required here (**Figure 5**).

10 STORAGE AND CURATION

10.1 Museum

- 10.1.1 The archive is currently stored at Wessex Archaeology's office in Salisbury under the project code 78261. The complete project archive will be prepared in accordance with the relevant standards set out in 'Management of Research Projects in the Historic Environment' (MoRPHE), English Heritage (2006), Wessex Archaeology's Guidelines for Archive Preparation and in accordance with *Guidelines for the preparation of excavation archives for long-term storage* (UKIC 1990).

10.2 Preparation of archive

- 10.2.1 The complete Site archive, which will include paper records, photographic records, graphics, artefacts and ecofacts, and digital data, will be prepared following the standard conditions for the acceptance of excavated archaeological material, and in general following nationally recommended guidelines (Walker 1990; SMA 1995; Richards and Robinson 2000; Brown 2007).
- 10.2.2 Details of the Site will be submitted online to the OASIS (Online Access to the Index of Archaeological Investigations) database, a copy of this will be included as an Appendix to the report. A full archive of site photographs will also be submitted to the ADS.

10.2.3 All archive elements are marked with the Site code (78261), and a full index will be prepared.

10.2.4 The archive is currently being held at Wessex Archaeology's office building under the site code 78261, but will ultimately be deposited for permanent storage at the Wiltshire County Museum.

10.3 Conservation

10.3.1 No immediate conservation requirements were noted in the field.

10.4 Discard policy

10.4.1 Wessex Archaeology follows the guidelines set out in Selection, Retention and Dispersal (Society of Museum Archaeologists 1993), which allows for the discard of selected artefact and ecofact categories which are not considered to warrant any future analysis.

10.4.2 The discard of environmental remains and samples follows the guidelines laid out in Wessex Archaeology's 'Archive and Dispersal Policy for Environmental Remains and Samples'. The archive policy conforms with nationally recommended guidelines (SMA 1993; 1995; English Heritage 2002) and is available upon request.

10.5 Copyright, Designs and Patents Act 1988

10.5.1 Wessex Archaeology shall retain full copyright of any report under the Copyright, Designs and Patents Act 1988 with all rights reserved. Excepting that it hereby provides an exclusive licence to the client for the use of the report by the client in all matters directly relating to the project as described in the specification. Any document produced to meet planning requirements may be copied for planning purposes by the Local Planning Authority.

10.5.2 This report, and the archive generally, may contain material that is non-Wessex Archaeology copyright (e.g. Ordnance Survey, British Geological Survey, Crown Copyright), or the intellectual property of third parties, which we are able to provide for limited reproduction under the terms of our own copyright licences, but for which copyright itself is non-transferable by Wessex Archaeology. You are reminded that you remain bound by the conditions of the Copyright, Designs and Patents Act 1988 with regard to multiple copying and electronic dissemination of the report.

10.6 Security copy

10.6.1 In line with current best practice, on completion of the project a security copy of the paper records will be prepared, in the form of microfilm. The master jackets and one diazo copy of the microfilm will be submitted to the National Archaeological Record (English Heritage), a second diazo copy will be deposited with the paper records, and a third diazo copy will be retained by Wessex Archaeology.

11 BIBLIOGRAPHY

- Anderson, A.S. 1979 *The Roman Pottery Industry in North Wiltshire*, Swindon Archaeol. Soc. Rep. 2, Swindon
- Anderson, A.S. 1980 Romano-British Pottery Kilns at Purton, Wilts. Archaeol. Mag. 72/73 (for 1977/1978), 51-58.
- Archaeological Surveys Ltd 2007, Ridgeway Farm, Purton, North Wiltshire: Magnetic Susceptibility and Magnetometer Survey, unpublished client report ref 212
- Gingell, C. 1982 Excavation of an Iron Age enclosure at Groundwell Farm, Blunsdon St. Andrew, 1976-7, Wilts. Archaeol. Mag. 76, 33-76
- McSloy, E.R. 2011 Pottery, in M. Brett and E.R. McSloy, Prehistoric Pits and Roman enclosures on the A419 Blunsdon Bypass, Blunsdon St. Andrew: excavations 2006-7, Wilts. Archaeol. Mag. 104, 105-9
- Seager Smith, R.H., 1997 'Pottery' in Butterworth, C.A., and Seager Smith, R.H., 1997 'Excavations at The Hermitage, Old Town, Swindon' Wiltshire Archaeol. Natur. Hist. Mag. 90, 58-69
- Timby, J. 2001 The Pottery, in G. Graeme Walker, B. Langton and N. Oakey, An Iron Age Site at Groundwell West, Blunsdon St Andrew, Wiltshire. Excavations in 1996, Cotswold Archaeological Trust, 19-26
- Wessex Archaeology 2007, Ridgeway Farm, Swindon: Extended Walkover Survey, unpublished client report WA ref 65421
- Wessex Archaeology 2009, Ridgeway Farm, Swindon: Archaeological Desk Based Assessment, unpublished client report WA ref 65420
- Wessex Archaeology 2011, Ridgeway Farm, Swindon: Heritage Statement, unpublished client report WA ref 78260.01
- Wessex Archaeology 2011b, Ridgeway Farm, Purton, North Wiltshire, Written Scheme of Investigation for an Archaeological Field Evaluation, unpublished client report WA ref 78261.01

12 APPENDIX 1: TRENCH SUMMARIES

Trench 1	Dimensions: 30m x 2m x 0.4m		
	Land use: Pasture		
	Coordinates: (NW) 411386.078E 187308.531N 88.616m aOD (SE) 411406.759E 187286.641N 92.53m aOD		
Context	Category	Description	Depth
1000	Topsoil	Mid brown silty clay with frequent sub-angular limestone inclusions	0-0.3m
1001	Subsoil	Light brown clay with frequent sub-angular limestone inclusions	0.3-0.4m
1002	Natural	Limestone brash	0.4m+
1003	Natural	Light brown sandy clay with limestone flecking	0.4m+
No archaeological remains identified			

Trench 2	Dimensions: 30m x 2m x 0.86m		
	Land use: Pasture		
	Coordinates: (NW) 411349.122E 187277.678N 86.663m aOD (SE) 411378.5999E 187268.5608N 88.47m aOD		
Context	Category	Description	Depth
2000	Topsoil	Dark brown silty clay with frequent sub-angular flint and limestone inclusions	000.53m
2001	Subsoil	Light brown clay with frequent sub-angular limestone inclusion	0.53-0.86m
2002	Natural	Light brown sandy clay with limestone flecking	0.86m+
2003	Colluvium	Mid orange clay with moderate blue grey mottling	0.2-0.7m
2004	Natural	Anaerobic gleyed clay	0.7m+
No archaeological remains identified. Ceramic field drains recorded			

Trench 3	Dimensions: 30m x 2m x 0.3m		
	Land use: Pasture		
	Coordinates: (NW) 411395.9107E 187272.8424N 90.689m aOD (SE) 411393.0696E 187242.0913N 90.317m aOD		
Context	Category	Description	Depth
3001	Topsoil	Mid brown silty clay with frequent sub-angular limestone inclusions	0-0.3m
3002	Natural	Limestone brash	0.3m+
No archaeological remains identified			

Trench 4	Dimensions: 30m x 2m x 0.3m		
	Land use: Pasture		
	Coordinates: (NW) 411421.4541E 187244.9562N 93.603m aOD (SE) 411448.2438E 187257.0137N 96.119m aOD		
Context	Category	Description	Depth
4000	Topsoil	Mid brown silty clay with frequent sub-angular limestone inclusions	0-0.1m
4001	Subsoil	Dark brown clay with frequent sub-angular limestone inclusions (interface)	0.1-0.3m
4002	Natural	Limestone brash	0.3m+
No archaeological remains identified			

Trench 5	Dimensions: 30m x 2m x 0.48m		
	Land use: Pasture		
	Coordinates: (NW) 411349.4751E 187238.3414N 86.928m aOD (SE) 411346.8199E 187209.3223N 87.389m aOD		
Context	Category	Description	Depth
5000	Topsoil	Mid grey brown silty	0-0.3m
5001	Subsoil	Orange grey mottled silty clay (interface)	0.3-0.48m
5002	Natural	Stiff orange clay with moderate gleying	0.48m+
No archaeological remains identified. Ceramic field drains recorded			

Trench 6	Dimensions: 30m x 2m x 0.52		
	Land use: Pasture		
	Coordinates: (NW) 411374.5730E 187214.2240N 88.243m aOD (SE) 411403.1130E 187209.2150N 90.311m aOD		
Context	Category	Description	Depth
6000	Topsoil	Dark brown silty clay with frequent sub-angular limestone inclusions	0-0.3m
6001	Subsoil	Light brown clay with frequent sub-angular limestone inclusion	0.3-0.44m
6002	Colluvium	Light yellow brown silty clay with occasional gleyed mottling	0.44-0.52m
6003	Natural	Stiff dark orange clay	0.52m+
No archaeological remains identified			

Trench 7	Dimensions: 30m x 2m x 0.4m		
	Land use: Pasture		
	Coordinates: (NW) 411345.0030E 187185.9720N 87.542m aOD (SE) 411321.6979E 187167.0589N 87.895m aOD		
Context	Category	Description	Depth
7000	Topsoil	Dark reddish brown silty	0-0.1m
7001	Subsoil	Orangey grey gleyed clay (interface)	0.1-0.4m
7002	Natural	Anaerobic gleyed clay	0.4m+
No archaeological remains identified. Ceramic field drains recorded			

Trench 8	Dimensions: 30m x 2m x 0.64m		
	Land use: Pasture		
	Coordinates: (NW) 411378.9840E 187184.6900N 88.685m aOD (SE) 411379.4310E 187156.7500N 87.992m aOD		
Context	Category	Description	Depth
8000	Topsoil	Mid grey brown silt with frequent sub-angular limestone inclusions	0-0.19m
8001	Subsoil	Mid yellow brown silty clay with frequent sub-angular limestone and flint inclusions	0.19-0.64m
8002	Natural	Limestone brash	0.64m
8003	Deliberate backfill	Mixed deposit of re-deposited up-cast and charred modern waste. FO 8004	0.48-0.64m
8004	Ditch/Trench	NNW_SSE aligned modern linear 1.2m wide. FB 8003	0.48-0.64m
Modern ditch recorded. Trench moved 4m northward to allow safe working distance from field boundary			

Trench 9	Dimensions: 30m x 2m x 0.59m		
	Land use: Pasture		
	Coordinates: (NW) 411425.5360E 187168.7900N 88.846m aOD (SE) 411447.1810E 187147.3890N 87.991m aOD		
Context	Category	Description	Depth
9000	Topsoil	Mid grey brown silt with frequent sub-angular limestone inclusions	0-0.28m
9001	Subsoil	Mid orange brown silty clay with frequent sub-angular limestone and flint inclusions	0.28-0.59m
9002	Natural	Stiff orange clay brick-earth to NW – Light grey brown silty clay (clay brash) with abundant limestone inclusions to SE	0.59m+
No archaeological remains identified. Ceramic field drains recorded			

Trench 10	Dimensions: 30m x 2m x 51m		
	Land use: Pasture		
	Coordinates: (NW) 411484.6190E 187179.8950N 88.567m aOD (SE) 411488.0420E 187149.1370N 87.835m aOD		
Context	Category	Description	Depth
10000	Topsoil	Mid grey brown silt with frequent sub-angular limestone inclusions	0-0.23m
10001	Subsoil	Mid yellow brown silty clay with frequent sub-angular limestone and flint inclusions	0.23-0.52m
10002	Natural	Light grey brown silty clay (clay brash) with abundant limestone inclusions	0.52m+
No archaeological remains identified			

Trench 11	Dimensions: 30m x 2m x 0.7m		
	Land use: Pasture		
	Coordinates: (NW) 411561.9080E 187151.0590N 88.894m aOD (SE) 411541.1300E 187129.0250N 88.894m aOD		
Context	Category	Description	Depth
11000	Topsoil	Mid grey brown silt with frequent sub-angular limestone inclusions	0-0.25m
11001	Subsoil	Mid yellow brown silty clay with frequent sub-angular limestone and flint inclusions	0.25-0.5m
11002	Colluvium	Mid orange grey silty clay with occasional limestone inclusions	0.5-0.7m
11003	Natural	Light grey brown silty clay (clay brash) with abundant limestone inclusions	0.7m+
No archaeological remains identified. Ceramic field drains recorded			

Trench 12	Dimensions: 30m x 2m x 1m		
	Land use: Pasture		
	Coordinates: (NW) 411505.3740E 187112.9960N 89.111m aOD (SE) 411517.3040E 187086.1410N 89.544m aOD		
Context	Category	Description	Depth
12000	Topsoil	Mid grey brown silt with frequent sub-angular limestone inclusions	0-0.2m
12001	Subsoil	Mid yellow brown silty clay with frequent sub-angular limestone and flint inclusions	0.2-1m
12002	Natural	Dark brown stiff clay with flint	1m+
12003	Secondary deposit	Dark yellowish brown sandy silt with occasional sub-angular flint inclusions. FO 12004	1-0.2m
12004	Furrow	N-S aligned plough furrow. FB 12003	1-0.2m
Deep furrow recorded no associated archaeological remains observed.			

Trench 13	Dimensions: 30m x 2m x 0.8m		
	Land use: Pasture		
	Coordinates: (NW) 411572.4830E 187127.2560N 88.906m aOD (SE) 411591.3460E 187104.8740N 90.175m aOD		
Context	Category	Description	Depth
13000	Topsoil	Mid orange grey silty clay with occasional sub-angular flint inclusions	0-0.3m
13001	Subsoil	Dark yellow brown clay with occasional sub-angular flint inclusions	0.3-0.45m
13002	Secondary deposit	Blue grey gelyed clay with moderate sub-angular flint inclusions. FO 13004	0.45-0.8m
13003	Natural	Mid orange gelyed stiff clay with flint	0.68m+
13004	Furrow	N-S aligned furrow. FB 13002	0.45-0.8m
Deep furrow recorded no associated archaeological remains observed.			

Trench 14	Dimensions: 30m x 2m x 1.12m		
	Land use: Pasture		
	Coordinates: (NW) 411486.3730E 187073.077N 89.233m aOD (SE) 411515.7470E 187071.5130N 89.656m aOD		
Context	Category	Description	Depth
14000	Topsoil	Mid grey brown silt with frequent sub-angular limestone inclusions	0-0.3m
14001	Subsoil	Mid yellow brown silty clay with frequent sub-angular limestone and flint inclusions	0.3-0.86m
14002	Colluvium	Mid orange grey silty clay with moderate small sub-angular flint and limestone inclusions. Relates to build up of furrow ridges	0.86-0.12m
14003	Natural	Light grey brown silty clay (clay brash) with abundant limestone inclusions	0.12m+
Trench moved 7m eastwards to avoid large muck heap. No archaeological remains recorded			

Trench 15	Dimensions: 30m x 2m x 0.3m		
	Land use: Pasture		
	Coordinates: (NW) 411556.3560E 187095.8540N 90.301m aOD (SE) 411554.1740E 187065.9350N 91.019m aOD		
Context	Category	Description	Depth
15000	Topsoil	Mid grey brown silt with frequent sub-angular limestone inclusions	0-0.21m
15001	Subsoil	Mid yellow brown silty clay with frequent sub-angular limestone and flint inclusions	0.21-0.3m
15002	Natural	Limestone brash	0.3m+
No archaeological remains identified			

Trench 16	Dimensions: 30m x 2m x 0.7m		
	Land use: Pasture		
	Coordinates: (NW) 411621.2870E 187096.9410N 90.232m aOD (SE) 411599.3310E 187076.0730N 91.111m aOD		
Context	Category	Description	Depth
16000	Topsoil	Mid grey brown silt with frequent sub-angular limestone inclusions	0-0.3m
16001	Subsoil	Mid yellow brown silty clay with frequent sub-angular limestone and flint inclusions	0.3-0.7m
16002	Natural	Mid brown clay with flint	0.7m+
16003	Secondary deposit	Yellow brown clay with moderate flint. FO 16004	0.7m+
16004	Furrow	N-S aligned furrow. FB 16004	0.7m+
Deep furrow recorded no associated archaeological remains observed.			

Trench 17	Dimensions: 30m x 2m x 1.2m		
	Land use: Pasture		
	Coordinates: (NW) 411488.9400E 187051.6570N 89.721m aOD (SE) 411511.0540E 187029.7640N 90.823m aOD		
Context	Category	Description	Depth
17000	Topsoil	Dark grey brown silt with frequent sub-angular limestone inclusions	0-0.4m
17001	Subsoil	Mid yellow brown sandy silt with frequent sub-angular limestone and flint inclusions	0.4-1m
17002	Secondary deposit	Mid orange grey silty clay with moderate small sub-angular flint/limestone inclusions and occasional manganese. Relates to build up of furrow ridges. FO 17004	1-0.2m
17003	Natural	Dark grey brown gelyed clay. Abundant manganese	1m+
17004	Furrow	N-S aligned furrows. FB 17002	1-1.2m
Deep furrow recorded no associated archaeological remains observed. Ceramic field drains recorded			

Trench 18	Dimensions: 30m x 2m x 0.5m		
	Land use: Pasture		
	Coordinates: (NW) 411565.3780E 187053.6600N 91.461m aOD (SE) 411539.6430E 187036.8940N 91.26m aOD		
Context	Category	Description	Depth
18000	Topsoil	Dark grey brown silt with frequent sub-angular limestone inclusions	0-0.25m
18001	Subsoil	Mid yellow brown sandy silt with frequent sub-angular limestone and flint inclusions	0.25-0.5m
18002	Natural	Light orange brown sandy clay (clay brush) with abundant limestone inclusions ranges to limestone brush to NE	0.5m+
No archaeological remains identified			

Trench 19	Dimensions: 30m x 2m x .065m		
	Land use: Pasture		
	Coordinates: (NW) 411578.2380E 187058.7530N 91.532m aOD (SE) 411598.6830N 187034.1460N 92.308m aOD		
Context	Category	Description	Depth
19000	Topsoil	Dark grey brown silt with frequent sub-angular limestone inclusions	0-0.25m
19001	Subsoil	Mid yellow brown sandy silt with frequent sub-angular limestone and flint inclusions	0.25-0.5m
19002	Subsoil	Dark brown compact clay with occasional limestone inclusions (interface)	0.5-0.65m
19003	Natural	Mid brown silt clay (clay brush) with abundant limestone inclusions ranges to limestone brush to NW	0.65m+
No archaeological remains identified			

Trench 20	Dimensions: 30m x 2m x 0.5m		
	Land use: Pasture		
	Coordinates: (NW) 411626.0330E 187066.9550N 91.072m aOD (SE) 411656.0990E 187066.1610N 91.00m aOD		
Context	Category	Description	Depth
20000	Topsoil	Dark grey brown silt with frequent sub-angular limestone inclusions	0-0.3m
20001	Subsoil	Mid yellow brown silty clay with frequent sub-angular limestone and flint inclusions	0.3-0.5m
20002	Natural	Limestone brash	0.5m+
No archaeological remains identified			

Trench 21	Dimensions: 30m x 2m x 0.5m		
	Land use: Pasture		
	Coordinates: (NW) 411537.3440E 187025.5660N 91.67m aOD (SE) 411567.8310E 187021.8650N 92.425m aOD		
Context	Category	Description	Depth
21000	Topsoil	Dark grey brown silt with frequent sub-angular limestone inclusions	0-0.26m
21001	Subsoil	Mid yellow brown silty clay with frequent sub-angular limestone and flint inclusions	0.26-0.5m
21002	Natural	Mid brown silt clay (clay brash) with abundant limestone inclusions	0.5m+
No archaeological remains identified			

Trench 22	Dimensions: 30m x 2m x 0.5m		
	Land use: Pasture		
	Coordinates: (NW) 411675.7840E 187050.7980N 91.75m aOD (SE) 411696.5420E 187029.4570N 92.943m aOD		
Context	Category	Description	Depth
22000	Topsoil	Dark grey brown silt with frequent sub-angular limestone inclusions	0-0.25m
22001	Subsoil	Mid yellow brown silty clay with frequent sub-angular limestone and flint inclusions	0.25-0.5m
22002	Natural	Limestone brash	0.5m+
No archaeological remains identified			

Trench 23	Dimensions: 30m x 2m x 0.61m		
	Land use: Pasture		
	Coordinates: (NW) 411497.5040E 187010.0170N 91.362m aOD (SE) 411497.9980E 186979.1320N 93.18m aOD		
Context	Category	Description	Depth
23000	Topsoil	Dark grey brown silt with frequent sub-angular limestone inclusions	0-0.26m
23001	Subsoil	Mid yellow brown sandy silt with frequent sub-angular limestone and flint inclusions	0.26-0.61m
23002	Natural	Mid yellow brown compact sandy clay with manganese inclusions	0.61m+
No archaeological remains identified. Ceramic field drains recorded			

Trench 24	Dimensions: 30m x 2m x 0.64m		
	Land use: Pasture		
	Coordinates: (NW) 411608.7740E 187004.1890N 93.202m aOD (SE) 411581.4735E 186991.8678N 93.568m aOD		
Context	Category	Description	Depth
24000	Topsoil	Dark grey brown silt with frequent sub-angular limestone inclusions	0-0.2m
24001	Subsoil	Mid yellow brown sandy silt with frequent sub-angular limestone and flint inclusions	0.2-0.64m
24002	Natural	Mid yellow brown compact sandy clay with manganese inclusions	0.64m+
No archaeological remains identified			

Trench 25	Dimensions: 30m x 2m x 0.96m		
	Land use: Pasture		
	Coordinates: (NW) 411729.5990E 187019.6400N 93.28m aOD (SE) 411705.8250E 186997.9470N 94.156m aOD		
Context	Category	Description	Depth
25000	Topsoil	Dark brown silt with frequent sub-angular limestone inclusions	0-0.31m
25001	Subsoil	Mid yellow brown silty clay with moderate charcoal flecks	0.31-0.62m
25002	Colluvium	Mid orange brown clayey silt. Relating to furrow ridges. Animal bone retrieved.	0.62-0.96m
25003	Natural	Mid orange brown silty clay with manganese inclusions with bands of bluish grey gleyed clay	0.96m+
No archaeological remains identified			

Trench 26	Dimensions: 30m x 2m x 0.6m		
	Land use: Pasture		
	Coordinates: (NW) 411546.2230E 186991.1680N 93.335m aOD (SE) 411555.7270E 186962.7190N 94.854m aOD		
Context	Category	Description	Depth
26000	Topsoil	Dark grey brown silt with frequent sub-angular limestone inclusions	0-0.3m
26001	Subsoil	Mid yellow brown silty clay with frequent sub-angular limestone and flint inclusions	0.3-0.5m
26002	Subsoil	Dark brown compact clay with no inclusions (interface)	0.5-0.6m
26003	Natural	Mid brown clay with occasional flint inclusions	0.6m+
No archaeological remains identified			

Trench 27	Dimensions: 30m x 2m x 0.75m		
	Land use: Pasture		
	Coordinates: (NW) 411498.8510E 186942.1700N 95.356m aOD (SE) 411528.7030E 186946.7360N 95.23m aOD		
Context	Category	Description	Depth
27000	Topsoil	Dark grey brown silt with rare sub-angular limestone inclusions	0-0.25m
27001	Subsoil	Mid yellow brown silty clay. Sterile layer	0.25-0.5m
27002	Subsoil	Dark orange brown compact clay with occasional manganese inclusions (interface)	0.5-0.75m
27003	Natural	Compact mid orange brown clay with manganese inclusions	0.75m+
No archaeological remains identified. Ceramic field drains recorded			

Trench 28	Dimensions: 30m x 2m x 0.62m		
	Land use: Pasture		
	Coordinates: (NW) 411601.9610E 186968.9160N 95.001m aOD (SE) 411587.4230E 186941.3220N 96.669m aOD		
Context	Category	Description	Depth
28000	Topsoil	Mid grey brown silt with rare sub-angular limestone inclusions	0-0.2m
28001	Subsoil	Mid yellow brown sandy silt with sparse sub-angular limestone and flint inclusions	0.2-0.62m
28002	Natural	Compact mid orange clay with limestone brash outcropping	0.62m+
No archaeological remains identified			

Trench 29	Dimensions: 30m x 2m x 1m		
	Land use: Pasture		
	Coordinates: (NW) 411730.7230E 186985.1830N 94.847m aOD (SE) 411759.9480E 186982.9210N 94.849m aOD		
Context	Category	Description	Depth
29000	Topsoil	Mid grey brown silt with occasional sub-rounded inclusions	0-0.25m
29001	Subsoil	Mid yellow brown sandy silt with sparse sub-angular limestone/flint inclusions and manganese	0.25-0.7m
29002	Subsoil	Mid grey brown clay with occasional manganese (interface)	0.7-1m
29003	Natural	Mid brown silt clay (clay brash) with abundant limestone inclusions and occasional manganese with a band of limestone brash across centre of the trench	1m+
No archaeological remains identified			

Trench 30	Dimensions: 30m x 2m x 0.5m		
	Land use: Pasture		
	Coordinates: (NW) 411683.8532E 186970.9624N 95.641m aOD (SE) 411702.8730E 186948.0780N 97.424m aOD		
Context	Category	Description	Depth
30000	Topsoil	Mid grey brown silt with occasional sub-angular flint inclusions	0-0.3m
30001	Subsoil	Light yellow brown sandy silt with occasional sub-angular flint inclusions	0.3-0.35m
30002	Colluvium	Compact blue grey gleyed clay with frequent moderate sub-angular flint. Deeper at NW end – associated with furrow ridges	0.35-0.5m
30003	Natural	Mid orange mottled clay with flint	0.5m+
Colluvium associated with furrow ridges. No associated archaeological remains observed			

Trench 31	Dimensions: 30m x 2m x 0.4m		
	Land use: Pasture		
	Coordinates: (NW) 411629.6850E 186945.3060N 97.169m aOD (SE) 411638.3800E 186915.6760N 99.086m aOD		
Context	Category	Description	Depth
31000	Topsoil	Mid grey brown silty clay with occasional sub-angular flint inclusions	0-0.15m
31001	Subsoil	Mid orange brown mottled silty clay with moderate angular flint inclusions	0.15-0.4m
31002	Natural	Mid orange mottled clay with flint	0.4m+
No archaeological remains identified			

Trench 32	Dimensions: 30m x 2m x 0.74m		
	Land use: Pasture		
	Coordinates: (NW) 411548.5540E 186911.4370N 97.834m aOD (SE) 411578.5170E 186912.3100N 98.304m aOD		
Context	Category	Description	Depth
32000	Topsoil	Mid grey brown silt with rare sub-angular flint inclusions	0-0.23m
32001	Subsoil	Mid yellow brown silty clay with occasional sub-angular flint inclusions	0.23-0.53m
32002	Colluvium	Mid yellow grey clay with rare limestone flecking and sub-angular flint inclusions. Associated with furrow ridges	0.53-0.74m
32003	Natural	Mid orange brown to mid yellow grey stiff sandy clay	0.74m+
Colluvium associated with furrow ridges. No associated archaeological remains observed			

Trench 33	Dimensions: 30m x 2m x 0.67m		
	Land use: Pasture		
	Coordinates: (NW) 411496.5560E 186906.311N 97.443m aOD (SE) 411524.2650E 186891.5950N 98.326m aOD		
Context	Category	Description	Depth
33000	Topsoil	Mid grey brown clay with no inclusions	0-0.21m
33001	Subsoil	Mid yellow brown sandy silt with rare sub-angular flint and manganese inclusions	0.21-0.47m
33002		Mid orange brown mottled clay with rare sub-angular flint inclusions. Increased in depth to NW - associated with furrow ridges	0.23-0.67m
33003	Natural	Mid orange stiff gleyed clay with flint	0.67m+
No archaeological remains identified. Ceramic field drains recorded			

Trench 34	Dimensions: 30m x 2m x 0.5m		
	Land use: Pasture		
	Coordinates: (NW) 411410.8100E 186889.1250N 99.085m aOD (SE) 411420.4760E 186861.0160N 99.87m aOD		
Context	Category	Description	Depth
34000	Topsoil	Grey brown silty loam with rare limestone inclusions	0-0.16m
34001	Subsoil	Orange brown silty clay with occasional flint inclusions	0.16-0.44m
34002	Natural	Orange stiff gleyed clay with flint	0.44m+
No archaeological remains identified			

Trench 35	Dimensions: 30m x 2m x 0.35m		
	Land use: Pasture		
	Coordinates: (NW) 411346.3780E 186849.0750N 99.508m aOD (SE) 411376.7040E 186847.2410N 99.789m aOD		
Context	Category	Description	Depth
35000	Topsoil	Brown silty loam with rare flint inclusions	0-0.12m
35001	Subsoil	Mid orange brown clay with very rare flint inclusions	0.12-0.25m
35002	Natural	Orange stiff gleyed clay with flint	0.25m+
No archaeological remains identified. Ceramic field drains recorded			

Trench 36	Dimensions: 30m x 2m x 0.48m		
	Land use: Pasture		
	Coordinates: (NW) 411294.7210E 186857.8430N 99.223m aOD (SE) 411272.2420E 186837.7760N 99.29m aOD		
Context	Category	Description	Depth
36000	Topsoil	Dark brown grey silty loam.	0-0.21m
36001	Subsoil	Mid orange yellow clay with occasional flint inclusions	0.21-0.39m
36002	Natural	Mid orange stiff gleyed clay with flint	0.39m+
No archaeological remains identified. Ceramic field drains recorded			

Trench 37	Dimensions: 30m x 2m x 0.42m		
	Land use: Pasture		
	Coordinates: (NW) 411381.1120E 186897.7090N 98.739m aOD (SE) 411360.6430E 186875.7090N 99.172m aOD		
Context	Category	Description	Depth
37000	Topsoil	Mid brown grey silty loam with occasional flint inclusions.	0-0.16m
37001	Subsoil	Mid orange brown clay with occasional flint inclusions	0.16-0.42m
37002	Natural	Mid orange gleyed clay with flint	0.42m+
No archaeological remains identified			

Trench 38	Dimensions: 30m x 2m x 0.78m		
	Land use: Pasture		
	Coordinates: (NW) 411310.8090E 186885.0250N 98.777m aOD (SE) 411340.9410E 186877.8020N 98.984m aOD		
Context	Category	Description	Depth
38000	Topsoil	Mid brown grey silty loam with occasional flint inclusions.	0-0.39m
38001	Natural	Mid orange gleyed clay with flint	0.39m+
38002	Tree throw hole	Irregular in plan with undulating concave sides and base. FB 38002	0.39-0.78m
38003	Secondary deposit	Mid orange brown silty clay with frequent manganese. Weathered upcast. FO 38002	0.39-0.78m
38002 was one of a line of around 7/8 similar tree throw holes recorded along the length of the trench. The line continued to the west and was noted in Trench 39			

Trench 39	Dimensions: 30m x 2m x 0.49m		
	Land use: Pasture		
	Coordinates: (NW) 411257.8450E 186884.9800N 98.881m aOD (SE) 411289.5700E 186880.8860N 98.955m aOD		
Context	Category	Description	Depth
39000	Topsoil	Mid brown grey silty loam with occasional flint inclusions.	0-0.19m
39001	Subsoil	Mid orange brown clay loam with occasional flint inclusions	0.19-0.48m
39002	Natural	Mid orange gleyed clay with occasional flint	0.48m+
Patches of light orange/yellow silty clay observed in very small quantities in baulk section likely to relate to furrow ridges only just observable in this trench. 3 tree throw holes noted at the east end of the trench associated with those recorded in Trench 38 Trench moved 5m east to avoid overhead wire.			

Trench 40	Dimensions: 30m x 2m x 0.87m		
	Land use: Pasture		
	Coordinates: (NW) 411444.9970E 186943.8040N 96.554m aOD (SE) 411440.3490E 186913.1250N 97.75m aOD		
Context	Category	Description	Depth
40000	Topsoil	Mid brown grey silty loam with occasional flint inclusions.	0-0.19m
40001	Subsoil	Mid orange brown clay loam with occasional flint inclusions	0.19-0.87m
40002	Natural	Mid orange gleyed clay with occasional flint. Blue lias clays prevalent towards the S end of the trench	0.87m+
No archaeological remains identified			

Trench 41	Dimensions: 30m x 2m x 0.72m		
	Land use: Pasture		
	Coordinates: (NW) 411391.6890E 186935.1770N 97.486m aOD (SE) 411421.1110E 186926.2440N 97.514m aOD		
Context	Category	Description	Depth
41000	Topsoil	Mid brown grey silty loam	0-0.19m
41001	Subsoil	Mid orange brown silty clay with sparse limestone inclusions	0.19-0.58m
41002	Colluvium	Yellow orange silty clay. Heavily compacted and sterile. Relates to furrow ridges	0.58-0.72m
41003	Natural	Mid orange brown clay with patches of limestone brash outcropping at east end of trench	0.72m+
Colluvium associated with furrow ridges. No associated archaeological remains observed			

Trench 42	Dimensions: 30m x 2m x 0.59m		
	Land use: Pasture		
	Coordinates: (NW) 411345.7410E 186930.0320N 97.889m aOD (SE) 411323.9020E 186913.8510N 98.38m aOD		
Context	Category	Description	Depth
42000	Topsoil	Mid brown grey silty loam rare limestone inclusions	0-0.18m
42001	Subsoil	Mid yellow brown silty clay with frequent limestone inclusions. Inclusions not observed at south-west end of trench	0.18-0.59m
42002	Natural	Mid orange brown clay with patches of limestone brash outcropping at east end of trench	0.59m+
Trench moved 3m south-east to avoid CAT signal. No archaeological remains identified			

Trench 43	Dimensions: 30m x 2m x 0.34m		
	Land use: Pasture		
	Coordinates: (NW) 411276.5280E 186931.4330N 98.266m aOD (SE) 411285.5130E 186901.2960N 98.78m aOD		
Context	Category	Description	Depth
43000	Topsoil	Dark brown grey silty loam	0-0.21m
43001	Subsoil	Light yellow brown clay loam with abundant sub-angular sorted limestone inclusions	0.21-0.33m
43002	Natural	Limestone brash with mid brown silt clay (clay brash) with abundant limestone inclusions at north-west end of trench	0.33m+
No archaeological remains identified			

Trench 44	Dimensions: 30m x 2m x 0.48m		
	Land use: Pasture		
	Coordinates: (NW) 411442.8020E 186986.3415N 93.938m aOD (SE) 411417.9110E 186977.2830N 95.356m aOD		
Context	Category	Description	Depth
44000	Topsoil	Mid-dark reddish brown clay loam with rare limestone and flint inclusions	0-0.19m
44001	Subsoil	Mid yellow brown silty clay with sparse limestone inclusions and manganese	0.19-0.48m
44002	Natural	Mid-light yellow brown silt clay (clay brash) with abundant limestone inclusions with limestone brash at east end of trench	0.48m+
No archaeological remains identified			

Trench 45	Dimensions: 30m x 2m x 0.65m		
	Land use: Pasture		
	Coordinates: (NW) 411360.0310E 186986.0290N 95.602m aOD (SE) 411339.2540E 186964.1130N 96.967m aOD		
Context	Category	Description	Depth
45000	Topsoil	Mid grey brown silty loam with rare flint inclusions	0-0.24m
45001	Subsoil	Mid yellow brown clay loam with sparse flint inclusions	0.24-0.65m
45002	Natural	Mid yellow brown slightly gleyed clay (clay brash) with abundant limestone inclusions	0.65m+
No archaeological remains identified. Ceramic field drains recorded			

Trench 46	Dimensions: 30m x 2m x 0.41m		
	Land use: Pasture		
	Coordinates: (NW) 411411.1870E 187028.7340N 91.731m aOD (SE) 411434.7890E 187011.1830N 92.543m aOD		
Context	Category	Description	Depth
46000	Topsoil	Mid grey brown clay loam with rare limestone and flint inclusions	0-0.23m
46001	Subsoil	Mid yellow brown silty clay with common limestone/flint inclusions	0.23-0.41m
46002	Natural	Mid orange brown silt clay (clay brash) with abundant limestone inclusions	0.41m+
Trench moved 7.5m north-east to avoid water pipe trench. No archaeological remains identified			

Trench 47	Dimensions: 30m x 2m x 0.81m		
	Land use: Pasture		
	Coordinates: (NW) 411385.7810E 187026.6310N 92.421m aOD (SE) 411388.6170E 186995.9010N 94.651m aOD		
Context	Category	Description	Depth
47000	Topsoil	Mid grey brown clay loam with rare limestone and flint inclusions	0-0.24m
47001	Deliberate backfill	Reworked natural capping a smooth mid yellow grey clay with very rare limestone/flint inclusions. FO 47005	0.24-0.81m
47002	Subsoil	Mid yellow brown silty clay with common limestone/flint inclusions	0.24-0.74m
47003	Deliberate backfill	Mid – dark mottled blue grey clay with large ragstone inclusions. FO 47005	0.81m+
47004	Natural	Stiff mid orange brown silty clay with limestone inclusions. Limestone brash outcropping at north end of trench	0.74m+
47005	Pipe trench	E-W aligned wide water pipe trench. FB 47001 and 47003. Associated with 48003	0.24-0.81m+
Trench moved 7m northwards to try and avoid water pipe trench. Water pipe trench identified. No archaeological remains identified			

Trench 48	Dimensions: 30m x 2m x 0.48m		
	Land use: Pasture		
	Coordinates: (NW) 411311.0780E 187019.2110N 95.616m aOD (SE) 411329.7660E 186995.7990N 96.198m aOD		
Context	Category	Description	Depth
48000	Topsoil	Mid grey brown clay loam with rare limestone and flint inclusions	0-0.19m
48001	Subsoil	Mid yellow brown silty clay with common limestone/flint inclusions	0.19-0.48m
48002	Natural	Light yellow brown clay (clay brash) with limestone brash to south-east	0.48m+
48003	Pipe trench	E-W aligned pipe trench. FB 48004 Associated with 47005	0.19-0.48m+
48004	Deliberate backfill	Mixed backfill of up-cast clay and re-worked topsoil. FO 48003	0.19-0.48m+
Water pipe trench identified. No archaeological remains identified			

Trench 49	Dimensions: 30m x 2m x 1.1m		
	Land use: Pasture		
	Coordinates: (NW) 411425.2260E 187078.9830N 89.04m aOD (SE) 411427.3500E 187048.6910N 90.285m aOD		
Context	Category	Description	Depth
49000	Topsoil	Mid grey brown clay loam with rare limestone and flint inclusions	0-0.3m
49001	Subsoil	Mid yellow brown silty clay with common limestone/flint inclusions	0.3-0.96m
49002	Colluvium	Mid orange brown firm clay. Relating to furrow ridges.	0.96-1.1m
49003	Natural	Dark yellow brown slightly gleyed sandy clay	1.1m+
Colluvium associated with furrow ridges. No associated archaeological remains observed			

Trench 50	Dimensions: 30m x 2m x 0.82m		
	Land use: Pasture		
	Coordinates: (NW) 411296.2920E 187051.2570N 93.108m aOD (SE) 411269.4620E 187032.6270N 96.075m aOD		
Context	Category	Description	Depth
50000	Topsoil	Mid grey brown clay loam with rare limestone and flint inclusions	0-0.31m
50001	Subsoil	Mid yellow brown silty clay with common limestone/flint inclusions. Not present at south-west end of trench and cut away by 50005	0.31-0.52m
50002	Natural	Light yellow brown clay (clay brash) with large limestone inclusions	0.31m+
50003	Deliberate backfill	Reworked topsoil and up-cast clay containing modern detritus. FO 50005	0.31m-0.68m
50004	Deliberate backfill	Re-worked topsoil with modern detritus. FO 50005	0.68-0.82m+
50005	Rubbish pit	Large machine excavated rubbish pit. FB 50003 and 50004	0.31-0.82m+
Modern rubbish pit identified. No archaeological remains recorded			

Trench 51	Dimensions: 30m x 2m x 1.1m		
	Land use: Pasture		
	Coordinates: (NW) 411354.4780E 187100.4570N 89.249m aOD (SE) 411355.7677E 187070.4922N 90.071m aOD		
Context	Category	Description	Depth
51000	Topsoil	Dark grey brown silty loam with rare limestone and flint inclusions	0-0.25m
51001	Subsoil	Mid brown grey clay loam with sparse limestone/flint inclusions	0.25-0.72m
51002	Colluvium	Light yellow brown clay loam. Deeper northwards, augmented by furrow ridges.	0.72-0.79m
51003	Natural	Mid yellow brown clay with occasional flint	0.79m+
51004	Tree throw hole	Sub-circular 1.06m diameter shallow vegetation hollow. FB 51005	0.95-1.1m
51005	Secondary deposit	Mottled grey brown silty clay with lenses of weathered yellow orange clay. FO 51004	0.95-1.1m
Tree throw hole identified. No archaeological remains recorded			

Trench 52	Dimensions: 30m x 2m x 0.94m		
	Land use: Pasture		
	Coordinates: (NW) 411275.6300E 187086.7250N 90.44m aOD (SE) 411306.3120E 187081.3920N 90.195m aOD		
Context	Category	Description	Depth
52000	Topsoil	Mid grey brown clay loam with rare limestone and flint inclusions	0-0.31m
52001	Subsoil	Mid yellow brown sandy loam with common limestone/flint inclusions	0.31-0.68m
52002	Colluvium	Light yellow brown sandy loam. .	0.68-0.94m
52003	Natural	Mid yellow brown clay with common manganese	0.94m+
An irregular shallow rootbole/tree throw hole investigated at east end of trench. No archaeological remains recorded			

Trench 53	Dimensions: 30m x 2m x 0.67m		
	Land use: Pasture		
	Coordinates: (NW) 411431.5180E 187113.1890N 88.423m aOD (SE) 411404.6130E 1870899.2140N 88.702m aOD		
Context	Category	Description	Depth
53000	Topsoil	Mid reddish brown clay loam with sparse limestone and flint inclusions increasing in frequency to north-east. Horizontal lenses of blue grey clay with abundant manganese observed in northern baulk relating to marshy environment present to north	0-0.4m
53001	Subsoil	Mid yellow brown silty clay with frequent manganese	0.4-0.67m
53002	Natural	Mid orange brown gleyed clay.	0.67m+
No archaeological remains recorded			

Trench 54	Dimensions: 30m x 2m x 0.53m		
	Land use: Pasture		
	Coordinates: (NW) 411342.0840E 187125.4020N 88.117m aOD (SE) 411371.8590E 187120.3540N 88.455m aOD		
Context	Category	Description	Depth
54000	Topsoil	Mid reddish brown clay loam	0-0.35m
54001	Subsoil	Mid yellow brown gleyed clay	0.35-0.53m
54002	Natural	Mid yellow orange gleyed clay.	0.53m+
Extant though disused field boundary ditch present at west end of trench. No archaeological remains recorded			

Trench 55	Dimensions: 30m x 2m x 0.65m		
	Land use: Pasture		
	Coordinates: (NW) 411288.7080E 187135.1540N 88.173m aOD (SE) 411307.1590E 187108.9460N 88.786m aOD		
Context	Category	Description	Depth
55000	Topsoil	Mid reddish brown silty loam with rare sub-angular flint and limestone inclusion	0-0.17m
55001	Subsoil	Mid yellow brown gleyed clay with sparse to moderate flint and limestone inclusions	0.17-0.65m
55002	Natural	Mid blue grey gleyed clay.	0.65m+
No archaeological remains identified. Ceramic field drains recorded			

Trench 56	Dimensions: 30m x 2m x 1.2m		
	Land use: Pasture		
	Coordinates: (NW) 411034.1230E 187021.2360N 104.365m aOD (SE) 411041.9860E 186993.6360N 103.348m aOD		
Context	Category	Description	Depth
56000	Topsoil	Dark brown silt with sparse rounded limestone inclusions	0-0.27m
56001	Subsoil	Mid brown grey silt with sparse sub-angular flint and limestone inclusions	0.27-0.42m
56002	Made ground	Mixed modern landfill	0.27-1.2m+
56003	Natural	Limestone brash	0.42m+
Extent of landfill identified within the trench. No archaeological remains recorded			

Trench 57	Dimensions: 30m x 2m x 0.30m		
	Land use: Pasture		
	Coordinates: (NW) 411087.3590E 187002.8620N 103.156m aOD (SE) 411116.1850E 186996.1750N 102.444m aOD		
Context	Category	Description	Depth
57000	Topsoil	Mid brown grey silt with abundant degraded limestone	0-0.26m
57001	Natural	Limestone brash	0.26m+
No archaeological remains identified.			

Trench 58	Dimensions: 30m x 2m x		
	Land use: Pasture		
	Coordinates: (NW) 411174.5190E 186995.8290N 101.121m aOD (SE) 411151.5940E 186976.5800N 101.563m aOD		
Context	Category	Description	Depth
58000	Topsoil	Mid brown grey silt with abundant degraded limestone and flint inclusions	0-0.33m
58001	Natural	Limestone brash	0.33m+
No archaeological remains identified.			

Trench 59	Dimensions: 30m x 2m x 0.44m		
	Land use: Pasture		
	Coordinates: (NW) 411029.9370E 186958.0040N 101.786m aOD (SE) 411059.0010E 186954.4660N 101.719m aOD		
Context	Category	Description	Depth
59000	Topsoil	Dark grey brown silt with rare degraded limestone and moderate flint inclusions	0-0.15m
59001	Subsoil	Light brown grey silt with abundant degraded limestone and occasional sub-angular flint and inclusions	0.15-0.44m
59002	Natural	Limestone brash	0.44m+
No archaeological remains identified.			

Trench 60	Dimensions: 30m x 2m x 0.3m		
	Land use: Pasture		
	Coordinates: (NW) 411098.1640E 186964.7470N 102.147m aOD (SE) 411107.0272E 186934.6259N 100.931m aOD		
Context	Category	Description	Depth
60000	Topsoil	Dark brown grey silt with abundant degraded limestone and flint inclusions	0-0.22m
60001	Natural	Limestone brash with a band of limestone aligned NNW-SSE across centre of the trench	0.22m+
Band of limestone may correspond to targeted geophysical anomaly. No archaeological remains identified			

Trench 61	Dimensions: 30m x 2m x 0.3m		
	Land use: Pasture		
	Coordinates: (NW) 411191.075 ^E 186946.506N 100.37m aOD (SE) 411207.98 ^E 186928.108N 99.541m aOD		
Context	Category	Description	Depth
61000	Topsoil	Mid brown grey silt with abundant degraded limestone and flint inclusions	0-0.3m
61001	Natural	Limestone brash	0.2m+
61002	Secondary deposit	Mid grey brown silt with abundant limestone inclusions. Included flint & limestone fragments possibly representing packing. FO 61003	0.3-0.55m
61003	Post-pit	Elongated post-pit. Incorporated a 0.7m diameter post. Shape thought to be due to removal of post. FB 61002	0.3-0.55m
61004	Deliberate backfill	A single deposit of deliberately backfilled material containing joining fragments of pottery vessels and animal bone consistent with occupation debris FO 61005	0.3-0.8m
61005	Pit	Rubbish pit. Cut away pits 61003 & 61012. Steep concave sides and flat based. Well defined. (1.5m x 1.3m x 0.5m). FB 61004	0.3-0.8m
61006	Secondary deposit	Mid brown silt with abundant limestone inclusions. FO 61007	0.3-0.6m
61007	Pit	Small pit approximately 0.4m in diameter. FB 61006	0.3-0.6m

61008	Pit	Possible elongated pit. 1.13m x 0.6m. Unexcavated. FB 61009	0.3m+
61009	Fill	Mid brown silt with abundant limestone inclusions. Re-worked up-cast. FO	0.3m+
61010	Pit	N-S aligned. May have been two intercut features? 1.6m x 0.8m. Unexcavated. Possibly cut away the end of pit 61014. FB 61011	0.3m+
61011	Fill	Southern half of deposit contained loose reddish brown clay and the northern end reworked limestone within a mid-brown silty matrix. FO 61010	0.3m+
61012	Pit	NE-SW aligned. Possible elongated pit. 0.9m x 0.85m. Unexcavated. Cut away by pit 61005. FB 61013	0.3m+
61013	Fill	Mid brown silt with abundant limestone inclusions. Re-worked up-cast. FO 61012	0.3m+
61014	Pit	E-W aligned. Possible elongated pit. 0.9m x 0.5m. Unexcavated. Extended beyond trench limit. Appeared to be cut away by pit 61010. FB 61015	0.3m+
61015	Fill	Mid brown silt with abundant limestone inclusions. Re-worked up-cast. FO 61014	0.3m+
61016	Pit	NW-SE aligned. Possible elongated pit. 0.7m x 0.7m. Unexcavated. Extended beyond trench limit. FB 61017	0.3m+
61017	Fill	Mid brown silt with occasional limestone inclusions. Re-worked up-cast. FO 61016	0.3m+
61018	Posthole	Clipped by trench edge. Appeared to be a possible 0.5m diameter posthole. FB 61019. Associated with 61022.	0.2m+
61019	Fill	Limestone inclusions within a reworked topsoil matrix. Included large limestone and flint - possible packing. FO 61018	0.2m+
61020	Posthole?	Only partially visibly in edge of trench. A possible posthole. Uncertain relationship with 61007. FB 61021	0.2m+
61021	Fill	Mid-dark silt with moderate limestone inclusions. FO 61020	0.2m+
61022	Posthole	Clipped by trench edge. Appeared to be a possible 0.5m diameter posthole. FB 61023. Associated with 61018.	0.2m+
61023	Fill	Limestone inclusions within a reworked topsoil matrix. Included large limestone and flint - possible packing. FO 61018	0.2m+
Trench initially moved 15m to south-east to avoid a modern show jumping structure. The trench was then extended to determine extent of archaeological remains.			

Trench 62	Dimensions: 30m x 2m x 0.44m		
	Land use: Pasture		
	Coordinates: (NW) 411044.3050E 186925.4940N 100.103m aOD (SE) 411044.3270E 186894.6280N 98.855m aOD		
Context	Category	Description	Depth
62000	Topsoil	Mid brown grey silt with sparse sub-angular flint inclusions	0-0.17m
62001	Subsoil	Mid orange brown clayey silt with abundant sub-angular flint inclusions	0.17-0.43m
62002	Natural	Mid orange clay with limestone brash towards N end	0.43m+
No archaeological remains identified			

Trench 63	Dimensions: 30m x 2m x 0.51m		
	Land use: Pasture		
	Coordinates: (NW) 411084.6190E 186902.2510N 99.461m aOD (SE) 411115.0840E 186900.8240N 99.404m aOD		
Context	Category	Description	Depth
63000	Topsoil	Mid brown grey silt with sparse sub-angular flint inclusions	0-0.16m
63001	Subsoil	Mid brown silty clay with abundant flint inclusions	0.16-39m
63002	Natural	Mid orange brown clay (clay brash) with patches of light brown clay	0.39m+
No archaeological remains identified			

Trench 64	Dimensions: 30m x 2m x 0.27m		
	Land use: Pasture		
	Coordinates: (NW) 411146.1290E 86936.5240N 100.929m aOD (SE) 411132.6450E 186909.9610N 99.786m aOD		
Context	Category	Description	Depth
64000	Topsoil	Mid brown grey silt with sparse flint inclusions	0-0.26m
64001	Natural	Limestone brash	0.26m+
No archaeological remains identified			

Trench 65	Dimensions: 30m x 2m x 0.49m		
	Land use: Pasture		
	Coordinates: (NW) 411183.3150E 186922.7030N 100.117m aOD (SE) 411163.3780E 186900.0020N 99.671m aOD		
Context	Category	Description	Depth
65000	Topsoil	Mid brown grey silt	0-0.18m
65001	Subsoil	Light brown silty clay with abundant sub-angular flint inclusions	0.18-0.48m
65002	Natural	Limestone brash	0.48m+
No archaeological remains identified however Romano-British pottery recovered from the topsoil.			

Trench 66	Dimensions: 30m x 2m x 0.42m		
	Land use: Pasture		
	Coordinates: (NW) 411177.5410E 186886.3720N 99.065m aOD (SE) 411204.6210E 186875.8800N 98.885m aOD		
Context	Category	Description	Depth
66000	Topsoil	Dark brown grey silt with rare limestone flecks and sparse sub-angular flint inclusions	0-0.14m
66001	Tree throw hole	Sub circular shallow vegetation hollow with concave sides and base. FB 66002	0.14-0.42m
66002	Secondary Deposit	Mid orange brown clay with abundant sub-rounded limestone and sparse sub-angular flint inclusions. FO 60001	0.14-0.42m
66003	Natural	Orange clay (clay brash) with limestone brash towards W end	0.14m+
An undated tree throw hole identified. Romano-British pottery recovered from the topsoil.			

Trench 67	Dimensions: 30m x 2m x 0.46m		
	Land use: Pasture		
	Coordinates: (NW) 411057.4810E 186867.7540N 98.232m aOD (SE) 411034.2430E 186847.7070N 97.794m aOD		
Context	Category	Description	Depth
67000	Topsoil	Mid brown grey silt with sparse sub-angular flint inclusions	0-0.11m
67001	Subsoil	Mid orange brown clay silt with rare sub-angular flint inclusions	0.11-0.28m
67002	Natural	Orange clay with moderate limestone inclusions	0.28m+
No archaeological remains identified. Ceramic field drains recorded			

Trench 68	Dimensions: 30m x 2m x 0.40m		
	Land use: Pasture		
	Coordinates: (NW) 411096.3390E 186866.6910N 98.352m aOD (SE) 411107.4120E 186837.0550N 97.981m aOD		
Context	Category	Description	Depth
68000	Topsoil	Mid brown grey silt with rare flint inclusions	0-0.14m
68001	Subsoil	Light brown grey silty clay with moderate flint inclusions	0.14-0.31m
68002	Natural	Mid orange clay with limestone inclusions	0.31m+
No archaeological remains identified.			

Trench 69	Dimensions: 30m x 2m x 0.52m		
	Land use: Pasture		
	Coordinates: (NW) 411155.2490E 186869.8740N 98.711m aOD (SE) 411143.1340E 186841.8180N 98.259m aOD		
Context	Category	Description	Depth
68000	Topsoil	Mid brown grey silt with moderate flint inclusions	0-0.09m
68001	Subsoil	Mid grey brown clay silt with abundant flint and limestone inclusions	0.09-0.31m
69002	Natural	Orange clay	0.31m+
No archaeological remains identified.			

Trench 70	Dimensions: 30m x 2m x 0.69m		
	Land use: Pasture		
	Coordinates: (NW) 411192.4740E 186862.2280N 98.773m aOD (SE) 411174.6150E 186838.3280N 98.431m aOD		
Context	Category	Description	Depth
70000	Topsoil	Dark brown grey silt with abundant flint and limestone inclusions	0.00-0.22m
70001	Subsoil	Mid brown grey clayey silt with abundant flint and limestone inclusions	0.23-0.38m
70002	Hollow	Linear cut orientated E-W, runs parallel to modern pipe. Shallow with concave edges and flat base. May be associated with 90007. FB 70003	0.38-0.69m
70003	Secondary deposit	Mid brown grey clay, sterile. FO 70002	0.38-0.69m
70004	Natural	Stiff orange clay varying to limestone brash towards NE end	0.38m+
70005	Feature	Unexcavated possible quarry hollow filled with mid-dark grey brown silty clay with sparse to occasional limestone inclusions.	0.38m+
70006	Feature	Unexcavated possible quarry hollow filled with mid-dark grey brown silty clay with sparse to occasional limestone inclusions.	0.38m+
70007	Feature	Unexcavated possible quarry hollow filled with mid-dark grey brown silty clay with sparse to occasional limestone inclusions.	0.38m+
Possible shallow linear boundary and quarry hollows. May be associated with Romano-British activity			

Trench 71	Dimensions: 30m x 2m x 0.69m		
	Land use: Pasture		
	Coordinates: (NE) 411230.884E 187056.335N 94.72m aOD (SW) 411210.405E 187037.657N 97.95m aOD		
Context	Category	Description	Depth
71000	Topsoil	Dark brown grey silt with abundant flint and limestone inclusions	0.00-0.15m
71001	Subsoil	Light brown silty clay with abundant sub-angular flint inclusions	0.15-0.25m
71002	Natural	Limestone brash	0.25m+-
Contained 2 x sub-square pits (1.2m in width with a recorded length of approximately 1.7m) extending northwards. Modern CBM and limestone blocks present. A ceramic land drain and a north-south service trench thought to be the water pipe also present.			

Trench 72	Trench location was within the disturbed modern land-fill in the north-west of the Site. Not excavated.
------------------	--

Trench 73	Trench location was within the disturbed modern land-fill in the north-west of the Site. Not excavated.
------------------	--

Trench 74	Dimensions: 30m x 2m x 1.20m		
	Land use: Pasture		
	Coordinates: (NW) 411188.4590E 187096.5360N 97.088m aOD (SE) 411184.6880E 187066.6330N 97.345m aOD		
Context	Category	Description	Depth
74000	Topsoil	Mid grey brown clayey silt with sparse sub-angular and sub-rounded flint and limestone inclusions	0-0.15
74001	Deliberate deposit	Modern landfill	0.15-1.20m+
Modern land fill site.			

Trench 75	Dimensions: 30m x 2m x 1.20m		
	Land use: Pasture		
	Coordinates: (NW) 411119.8310E 187101.8360N 101.729m aOD (SE) 411149.5090E 187091.9050N 100.703m aOD		
Context	Category	Description	Depth
75000	Topsoil	Mid grey clayey silt with sparse sub rounded and sub-angular flint and limestone inclusions	0-0.18m
75001	Deliberate deposit	Modern landfill	0.18-1.20m+
Modern land fill site.			

Trench 76	Dimensions: 30m x 2m x 1.20m		
	Land use: Pasture		
	Coordinates: (NW) 411054.1660E 187104.0930N 103.097m aOD (SE) 411060.3900E 187072.3350N 104.126m aOD		
Context	Category	Description	Depth
76000	Topsoil	Mid grey clayey silt with moderate sub-angular and sub-rounded flint and limestone inclusions	0-0.21m
76001	Deliberate deposit	Modern landfill (two episodes of deposition)	0.21-2.5m+
76002	Natural	Greensand	
Modern land fill site. Southern end of the trench excavated as a Test pit to investigate depth of land fill			

Trench 77	Dimensions: 30m x 2m x 1.20m		
	Land use: Pasture		
	Coordinates: (NW) 411225.2380E 187148.7420N 93.954m aOD (SE) 411253.5300E 187139.6410N 90.023m aOD		
Context	Category	Description	Depth
77000	Topsoil	Mid grey clayey silt with moderate angular and sub-angular flint inclusions	0-0.17m
77001	Deliberate deposit	Made ground sealing modern landfill	0.17-0.41m
77002	Deliberate deposit	Modern landfill	0.42-1.20m+
Modern land fill site			

Trench 78	Trench location was within the disturbed modern land-fill in the north-west of the Site. Not excavated.
------------------	--

Trench 79	Dimensions: 30m x 2m x 1.20m		
	Land use: Pasture		
	Coordinates: (NW) 411123.6640E 187154.3570N 98.866m aOD (SE) 411144.5020E 187127.7760N 99.379m aOD		
Context	Category	Description	Depth
79000	Topsoil	Mid grey brown clayey silt with moderate sub-angular flint inclusions	0-0.19m
79001	Deliberate deposit	Modern landfill	0.19-1.20m+
Modern land fill site			

Trench 80	Trench location was within the disturbed modern land-fill in the north-west of the Site. Not excavated.
------------------	--

Trench 81	Trench location was within the disturbed modern land-fill in the north-west of the Site. Not excavated.
------------------	--

Trench 82	Trench location was within the disturbed modern land-fill in the north-west of the Site. Not excavated.
------------------	--

Trench 83	Dimensions: 30m x 2m x 1.20m		
	Land use: Pasture		
	Coordinates: (NW) 411195.9670E 187195.7170N 93.084m aOD (SE) 411196.6300E 187165.8850N 94.839m aOD		
Context	Category	Description	Depth
83000	Topsoil	Mid grey clayey silt with moderate sub-angular and sub-rounded flint and limestone inclusions	0-0.14m
83001	Deliberate deposit	Modern landfill	0.14-1.20m+
Modern land fill site			

Trench 84	Dimensions: 6m x 2m x 2.8m		
	Land use: Pasture		
	Coordinates: (NE) 411306.0174E 187256.158N 89.393m aOD (SW) 411302.594E 184250.305N 89.455m aOD		
Context	Category	Description	Depth
84000	Topsoil	Mid grey clayey silt with moderate sub-angular and sub-rounded flint and limestone inclusions	0-0.19m
84001	Deliberate deposit	Modern landfill (two episodes of deposition)	0.19-2.8m
84002	Natural	Greensand	2.8m+
Modern land fill site. Trench excavated as a Test pit to investigate depth of land fill			

Trench 85	Trench location was within the disturbed modern land-fill in the north-west of the Site. Not excavated.
------------------	--

Trench 86	Dimensions: 30m x 2m x 1.20m		
	Land use: Pasture		
	Coordinates: (NW) 411023.1450E 187239.3050N 95.137m aOD (SE) 411023.0290E 187210.2630N 96.489m aOD		
Context	Category	Description	Depth
86000	Topsoil	Mid grey brown clayey silt with sparse sub-angular flint inclusions	0-0.14m
86001	Deliberate deposit	Modern landfill	0.14-1.20m+
No archaeological remains identified.			

Trench 87	Dimensions: 30m x 2m x 2.20m		
	Land use: Pasture		
	Coordinates: (NW) 411012.9070E 187259.4000N 94.518m aOD (SE) 411041.8757E 187252.5032N 94.401m aOD		
Context	Category	Description	Depth
87000	Topsoil	Mid grey brown clayey silt with moderate sub-angular flint inclusions	0-0.14m
87001	Deliberate deposit	Modern landfill	0.14-2.20m
87002	Natural	Mid green brown sandy clay, no inclusions observed	2.20m+
Modern land fill site. West end of the trench excavated as a Test pit to investigate depth of land fill			

Trench 88	An additional number allocation – Not used		
------------------	---	--	--

Trench 89	Dimensions: 20m x 2m x 0.24m		
	Land use: Pasture		
	Coordinates: (NW) 411185.415E 186943.920N 100.49m aOD (SE) 411170.574E 186927.635N 100.5m aOD		
Context	Category	Description	Depth
89000	Topsoil	Mid brown grey silt with abundant degraded limestone and flint inclusions	0-0.24m
88000	Topsoil	Same as 89000	0-0.24m
89001	Natural	Limestone brash	0.24m+
88002	Voided number		
89003	Post-pit	0.75m x 0.6m probable post-pit. FB 89004/88004	0.24m+
89004	Fill	Mid-dark brown silt with abundant reworked limestone including large flint/limestone packing. FO 89003	0.24m+
88004	Fill	Same as 89004.	0.24m+
Additional trench excavated to determine extent of archaeological remains. Contained post-pit possibly associated with post-pits in Trench 61			

Trench 90	Dimensions: 15m x 2m x 2.20m		
	Land use: Pasture		
	Coordinates: (NW) 411172.404E 186858.461N 98.45m aOD (SE) 411159.602E 186848.896N 98.59m aOD		
Context	Category	Description	Depth
90000	Topsoil	Dark brown grey silt with abundant flint and limestone inclusions	0.0-0.17m
90001	Subsoil	Mid brown grey clayey silt with abundant flint and limestone inclusions	0.17-0.3m
90002	Hollow	Linear cut orientated E-W, runs parallel to modern pipe. Shallow with concave edges and flat base. May be associated with 90007.	0.3-0.7m
90003	Pit/quarry hollow	3.8m x 1.3m extends beyond southern trench baulk. Thought to be two intercut pits. FB 90004	0.3m+
90004	Secondary deposit	Brown grey gleyed clay with sparse small flint/limestone inclusions. FO 90003	0.3m+
90005	Secondary deposit	Brown grey gleyed clay with sparse small flint/limestone inclusions. FO 90006	0.3m+
90006	Pit/quarry hollow	Possible elongated pit/quarry hollow. Extends beyond the NE trench baulk. FB 90005	0.3m+
90007	Hollow	Linear cut orientated NW-SE Moderate concave sides with flat to pitted base. Max Approximately 0.4m deep. FB 90008	0.3-0.7m
90008	Secondary deposit	Brown grey gleyed clay with sparse small flint/limestone inclusions.	0.3-0.7m
90009	Feature	Only a narrow extent of this feature present in the trench. 1.7m x 0.4m. Possible pit/quarry hollow. FB 90010	0.3m+
90010	Secondary deposit	Brown grey gleyed clay with sparse small flint/limestone inclusions. FO 90009	0.3m+
90011	Pit	0.4m diameter shallow pit base. 0.1m deep. FB 90012	0.3-0.4m
90012	Secondary deposit	Brown grey gleyed clay with sparse small flint/limestone inclusions.	0.3-0.4m
90013	Natural	Orange gleyed clay	0.3m+
Additional trench excavated to determine extent of archaeological remains. Romano-British- possibly Saxon pits/quarry hollows			

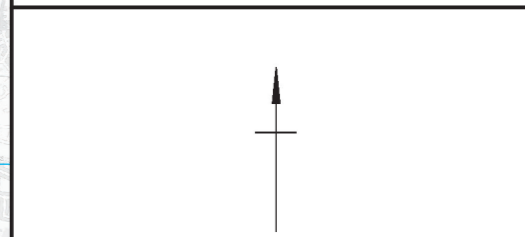
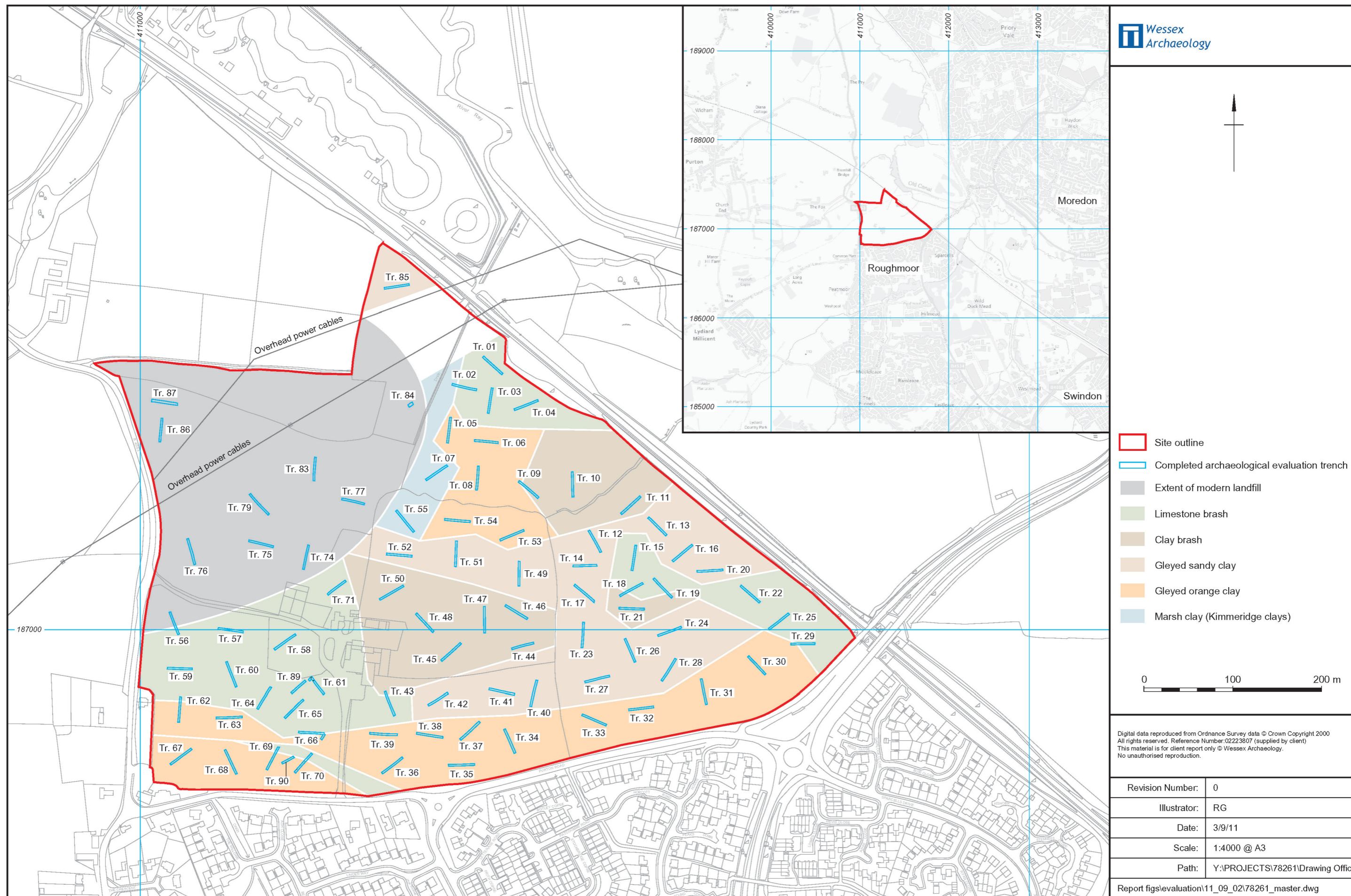

- Site outline
- Completed archaeological evaluation trench
- Extent of modern landfill
- Limestone brash
- Clay brash
- Gleyed sandy clay
- Gleyed orange clay
- Marsh clay (Kimmeridge clays)

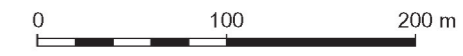

Digital data reproduced from Ordnance Survey data © Crown Copyright 2000
All rights reserved. Reference Number:02223807 (supplied by client)
This material is for client report only © Wessex Archaeology.
No unauthorised reproduction.

Revision Number:	0
Illustrator:	RG
Date:	3/9/11
Scale:	1:4000 @ A3
Path:	Y:\PROJECTS\78261\Drawing Office
Report figs\evaluation\11_09_02\78261_master.dwg	

Site and trench location plan with drift geology from trench observations

Figure 1

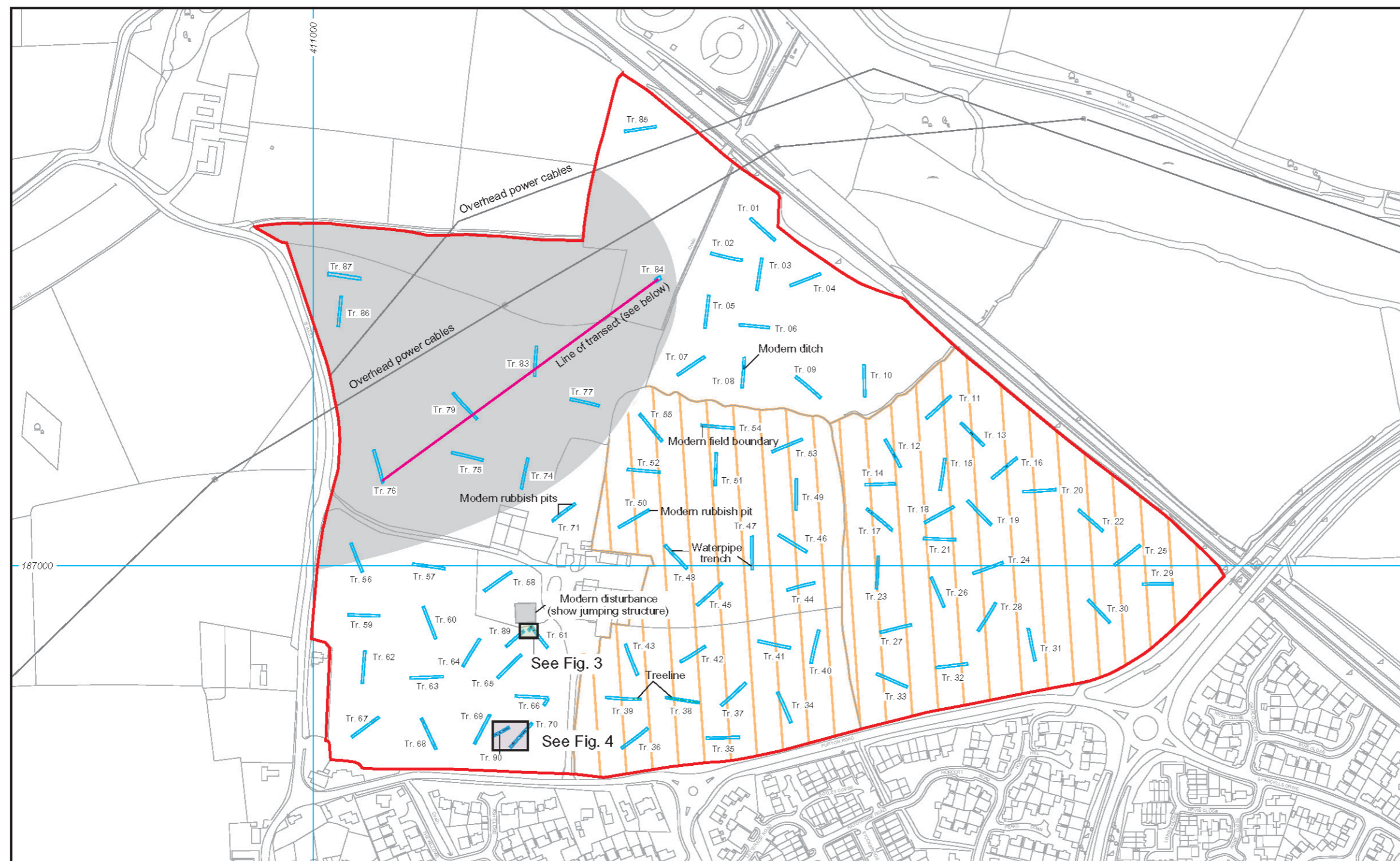

- Archaeological features
- ▭ Site outline
- ▭ Completed archaeological evaluation trench
- ▭ Area of ridge and furrow (lines indicative of direction and spacing)
- ▭ Extent of modern landfill

Truncation deposit model

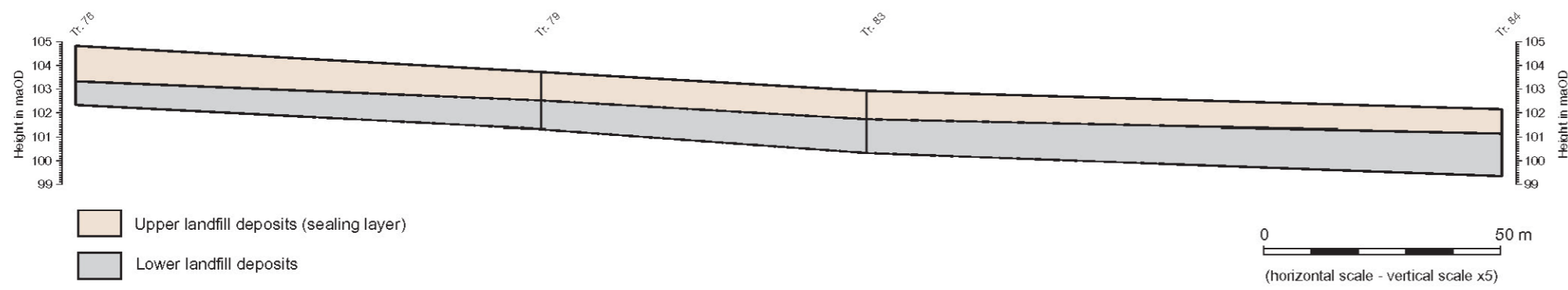



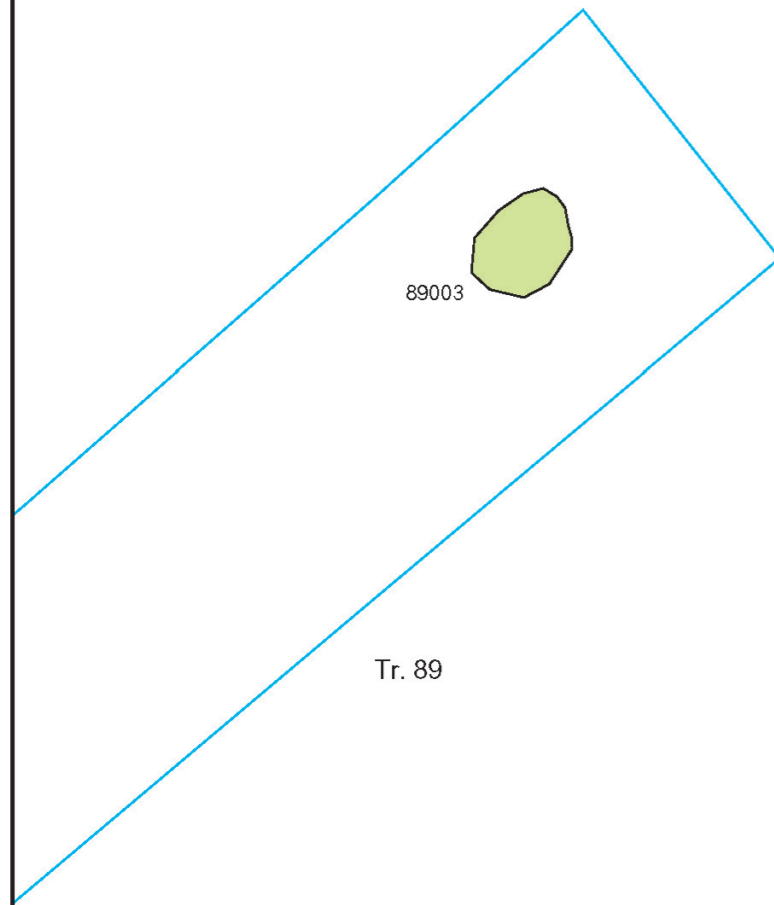
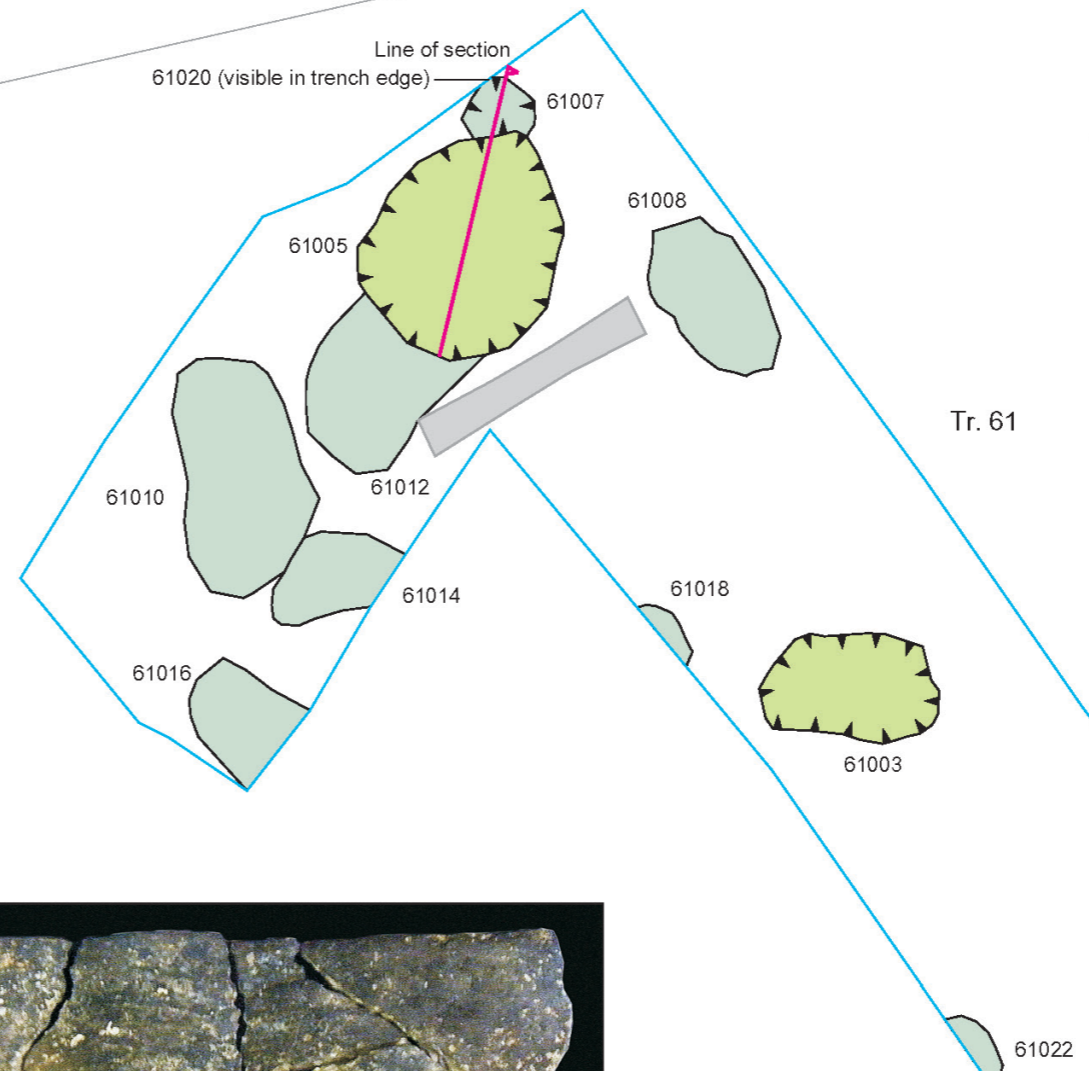
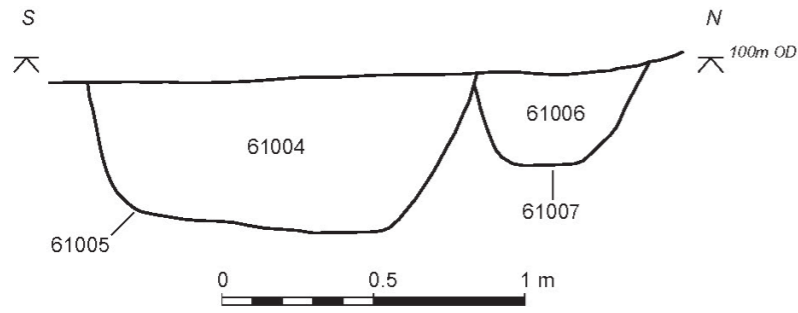

Digital data reproduced from Ordnance Survey data © Crown Copyright 2000
All rights reserved. Reference Number 02223807 (supplied by client)
This material is for client report only © Wessex Archaeology.
No unauthorised reproduction.

Revision Number:	0
Illustrator:	RG
Date:	3/9/11
Scale:	Plan 1:4000 @ A3
Path:	Y:\PROJECTS\78261\Drawing Office
Report figs\evaluation\11_09_02\78261_master.dwg	



Early Iron Age pottery from feature 61005



-  Excavated feature
-  Modern disturbance
-  Early/Middle Iron Age feature
-  Possible Early/Middle Iron Age feature





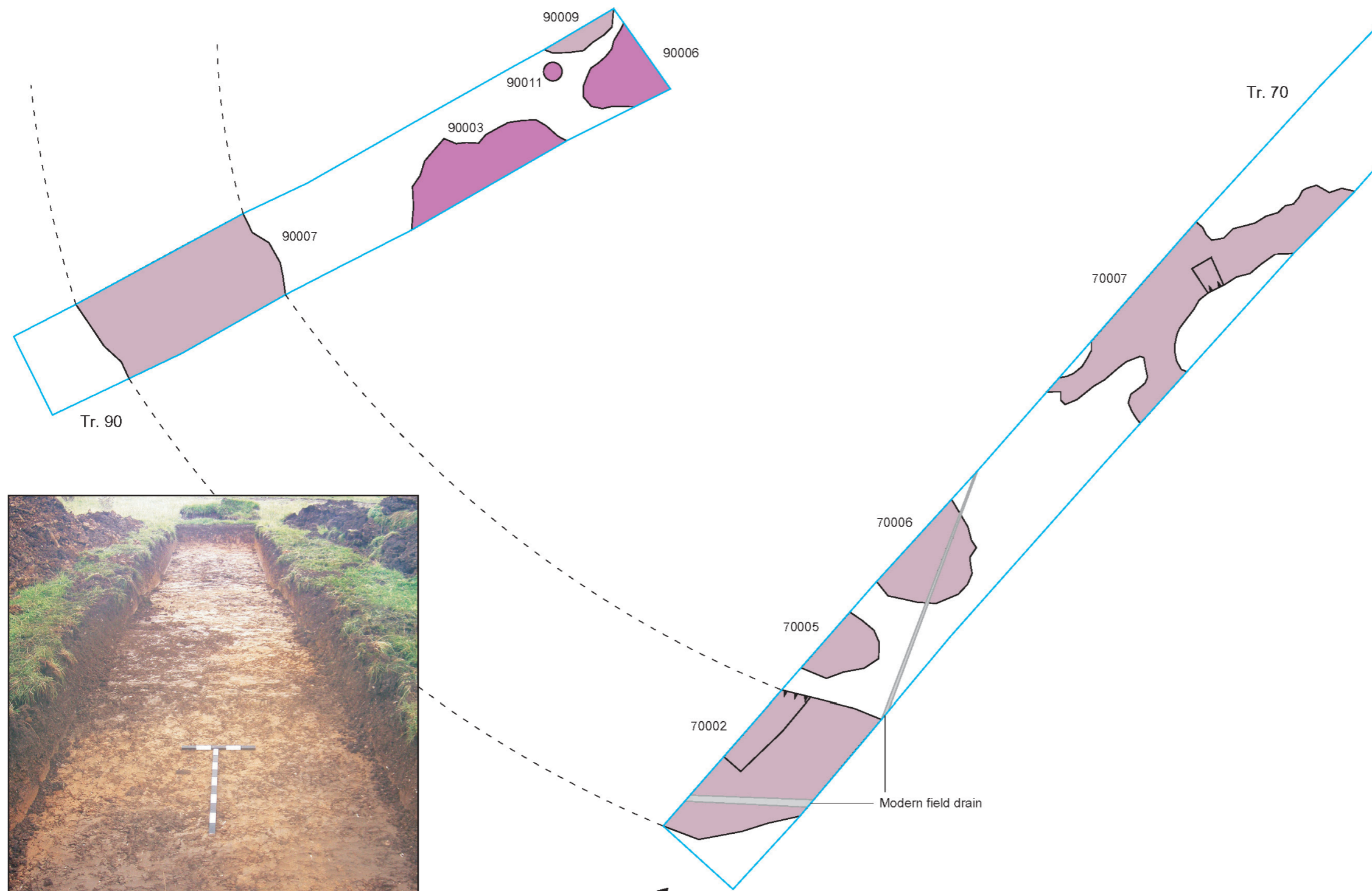

Digital data reproduced from Ordnance Survey data © Crown Copyright 2000
 All rights reserved. Reference Number: 02223807 (supplied by client)
 This material is for client report only © Wessex Archaeology.
 No unauthorised reproduction.

Revision Number:	0
Illustrator:	RG
Date:	3/9/11
Scale:	Plan 1:50/section 1:25 @ A3
Path:	Y:\PROJECTS\78261\Drawing Office
Report figs\evaluation\11_09_02\78261_master.dwg	



Trench 90 looking south west

Direction of photograph

-  Excavated feature
-  Modern disturbance
-  Romano-British feature
-  Possible Romano-British feature
-  Extrapolated feature



Digital data reproduced from Ordnance Survey data © Crown Copyright 2000
All rights reserved. Reference Number: 02223807 (supplied by client)
This material is for client report only © Wessex Archaeology.
No unauthorised reproduction.

Revision Number:	0
Illustrator:	RG
Date:	3/9/11
Scale:	Plan 1:100 @ A3
Path:	Y:\PROJECTS\78261\Drawing Office
Report figs\evaluation\11_09_02\78261_master.dwg	

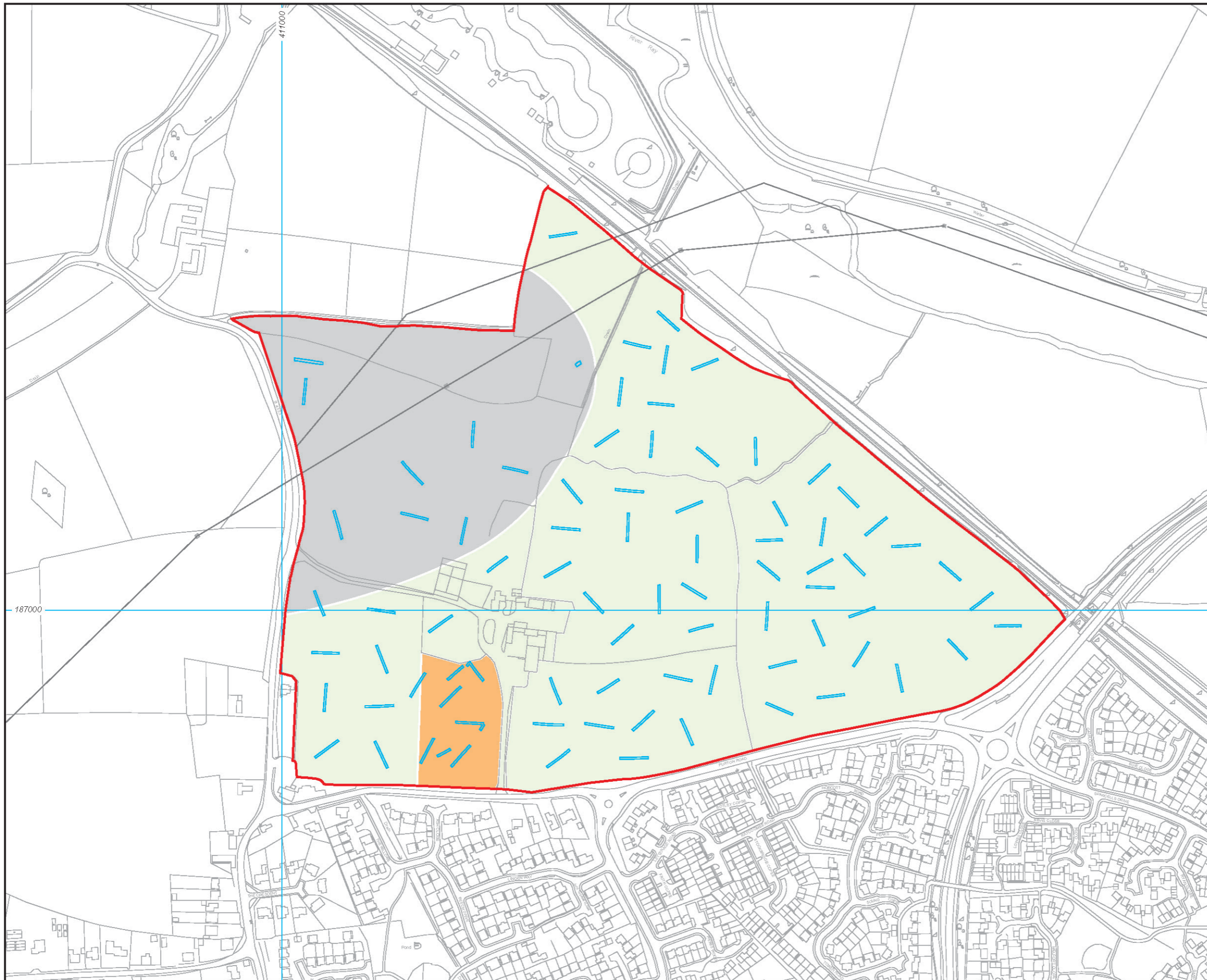

- Site outline
- Completed archaeological evaluation trench
- No archaeological mitigation required
- Extent of landfill:
No archaeological mitigation required
- Proposed area of archaeological mitigation



Digital data reproduced from Ordnance Survey data © Crown Copyright 2000
All rights reserved. Reference Number 02223807 (supplied by client)
This material is for client report only © Wessex Archaeology.
No unauthorised reproduction.

Revision Number:	0
Illustrator:	RG
Date:	3/9/11
Scale:	1:4000 @ A3
Path:	Y:\PROJECTS\78261\Drawing Office
Report figs\evaluation\11_09_02\78261_master.dwg	

Trench layout with proposed recommendations for further archaeological mitigation

Figure 5



WESSEX ARCHAEOLOGY LTD.

Registered Head Office: Portway House, Old Sarum Park, Salisbury, Wiltshire SP4 6EB.

Tel: 01722 326867 Fax: 01722 337562 info@wessexarch.co.uk

With regional offices in Maidstone, Sheffield and Edinburgh

For more information visit www.wessexarch.co.uk



Registered Charity No. 287786. A company with limited liability registered in England No. 1712772