

N  
 ↑  
 Channel Tunnel Rail Link  
 Project Area 430  
 Significant Discovery Individual  
 Leacon Lane  
 (ARC 430/81+800-82+000/99)  
 (Watching Brief)

© Union Railways (South) Limited 2000.  
 Reproduced from the Ordnance Survey's 1:25,000 map of 1997  
 with the permission of the Controller of Her Majesty's Stationary  
 Office © Crown Copyright. Licence No. 854190.

SCALE 1:250  
 0 ————— 10m

- linear feature
- pit
- post hole
- extent of archaeological site
- Extrapolated Feature
- Truncated by Machine

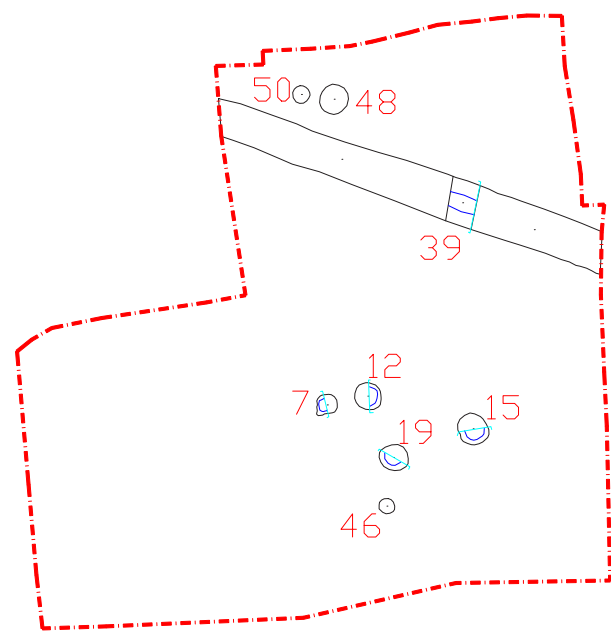

⊕ 75230, 27530

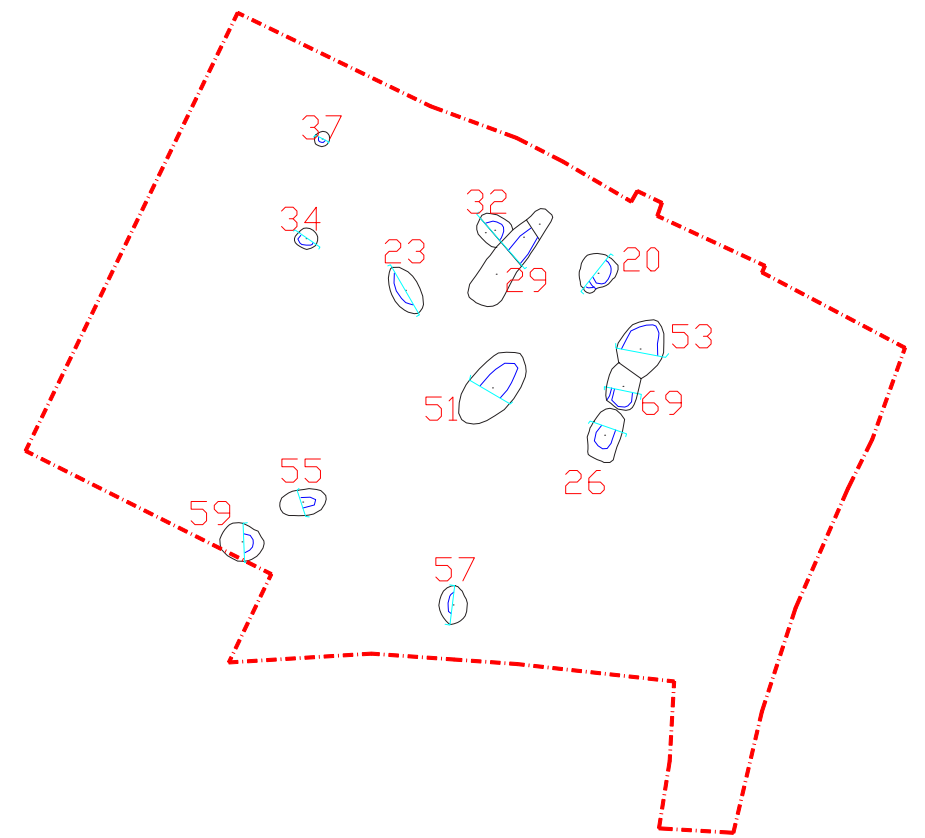

⊕ 75290, 27530

Figure 12