

Continuation 30 505

30 505 East

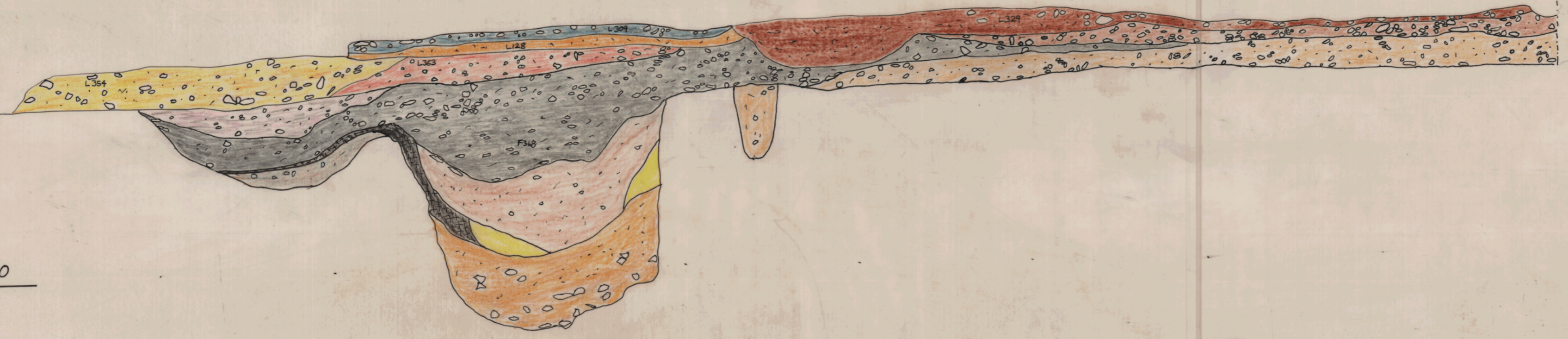

VS/74 SECTION E-W SCALE 1:20

NB L329 volcanic chips ▲  
L354

West 30 505

30 505

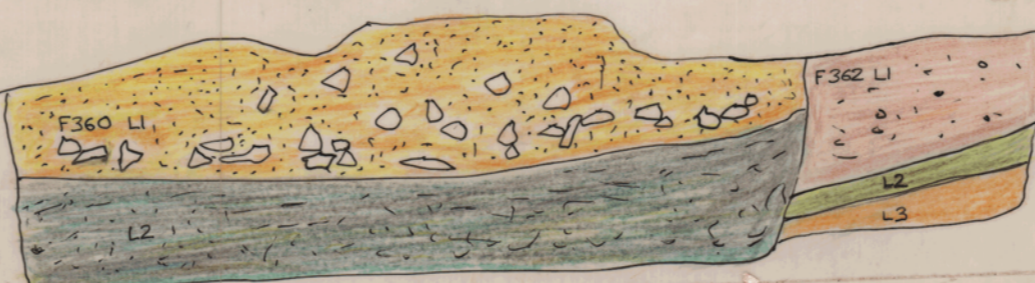

20 115  
29 785  
10 045  
27 16 / 34 22  
38 92  
37 47 / 40 2

VS 74 SECTION N-S SCALE 1:20

North 1441

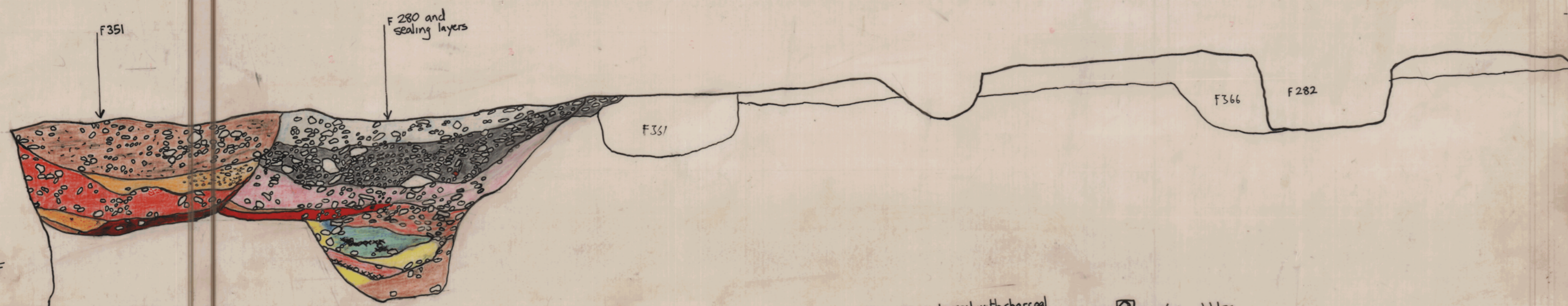

- F351 Layer 1 Dark humic soil mixed with claysols, w/w pebbles, tile flecks, slate frage.
- Layer 2 Gravely orange sand with lumps of concreted iron panings, small pebbles noticeably to south
- Layer 3 Gravely mixed reddish claysol with iron panings, large w/w pebbles noticeably to south
- Layer 4 Fine reddish/yellow sand with slight charcoal fleck
- Layer 5 Fine pure light yellow sand
- Layer 6 Aereated dark red/brown clay with thin patches of fine light red sand above

- F280 etc. Layer 1 Dark claysol with small w/w pebbles charcoal, slate and tile flecks
- Layer 2 Abundant large and small w/w pebbles and large tile frags, some mixed claysol
- Layer 3 Mixed dark claysols with heavy iron panings, small w/w pebbles
- Layer 4 Fine light orange sand
- Layer 5 Dark red/brown clay with slight charcoal flecks and iron panings
- Layer 6 Light red sandy claysol with charcoal, mortar, tile flecks

- Layer 7 Olive claysol with charcoal patches, yellow clay slump at N.
- Layer 8 Dry yellow clay
- Layer 9 Red sandy claysol with charcoal flecks above a gravely dark red claysol with charcoal patches
- Layer 10 Mixed dark brown claysols with some large w/w pebbles and tile fragments, yellow clay slump at N.

- W/w pebbles
- Charcoal patches
- Tile
- Decayed Red Sandstone

FLOD

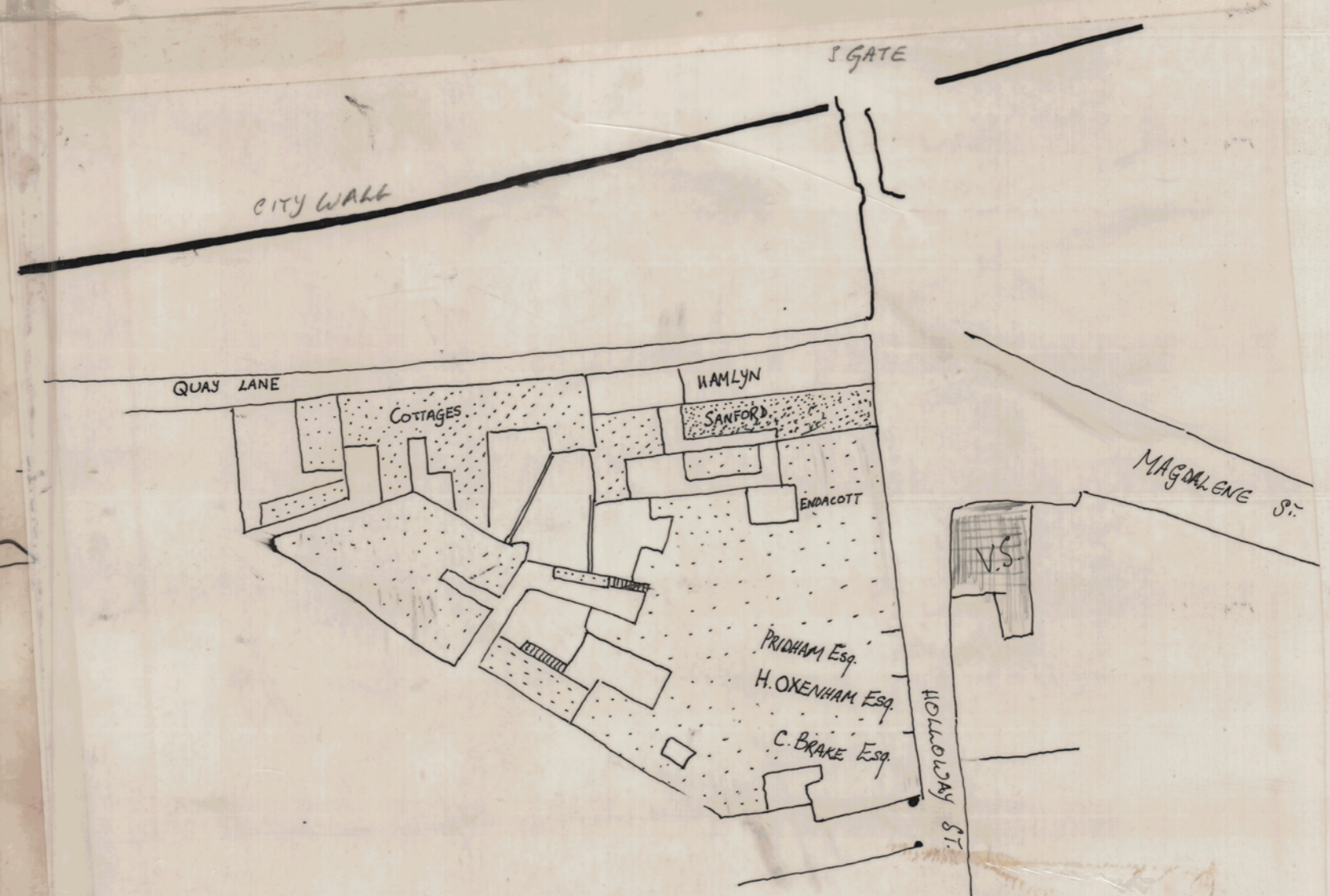

COLDRIDGE ? 1818/19

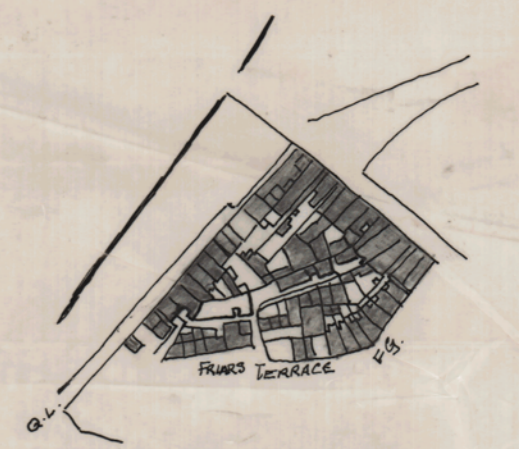
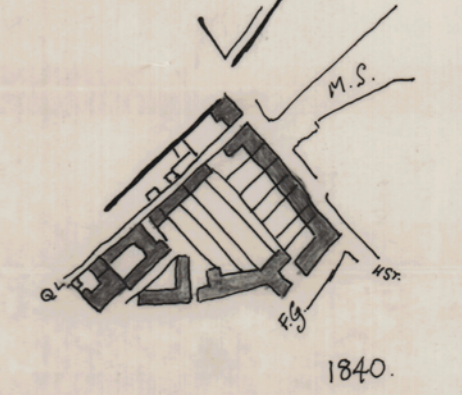
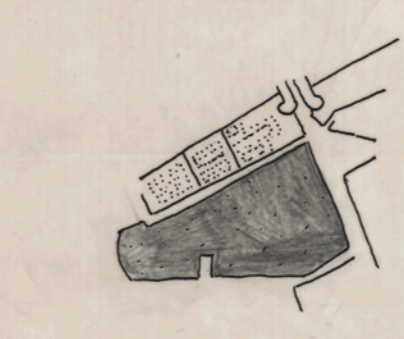

SHOWN AS BUILT ON IN MAP OF THE LANDS OF THE CHAMBER OF EXETER c. 1750. (NO DETAILS) 1792. ( " )  
CHARLES TOSER