



## **Rear of 15-49 Ulster Avenue** Ipswich, Suffolk

**Client:**

Ipswich Borough Council

**Date:**

February 2015

IPS 762

Archaeological Evaluation Report

SACIC Report No. 2015/011

Author: M. Sommers

© SACIC

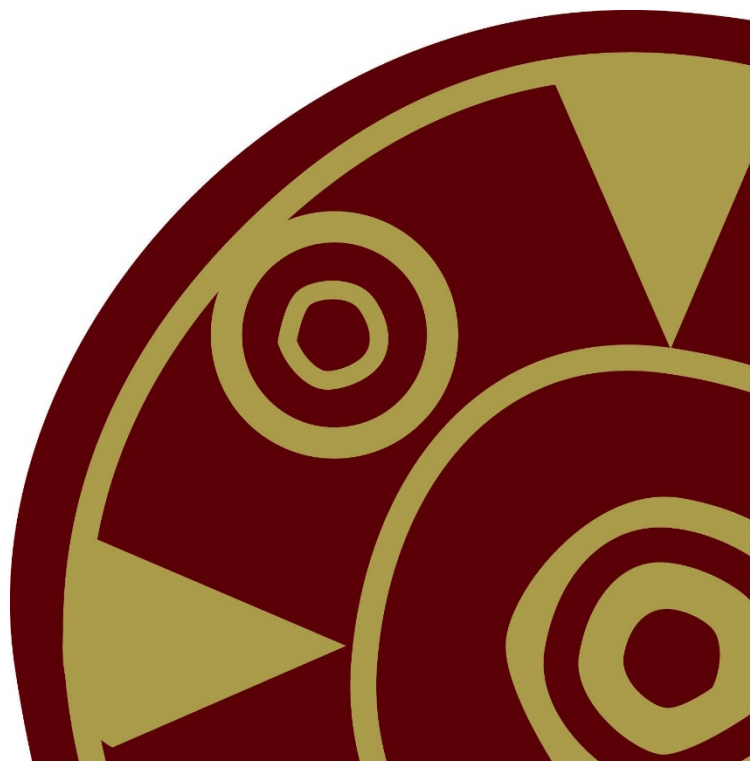



# Rear of 15-49 Ulster Avenue, Ipswich IPS 762

Archaeological Evaluation Report

SACIC Report No. 2015/011

Author: M. Sommers

Editor: S. Boulter

Report Date: February 2015



## HER Information

---

<b>Site Code:</b>	<b>IPS 762</b>
<b>Site Name:</b>	<b>Rear of 15-49 Ulster Avenue, Ipswich</b>
<b>Report Number</b>	<b>2015/011</b>
<b>Planning Application No:</b>	<b>IP/14/00376</b>
<b>Date of Fieldwork:</b>	<b>24th February 2015</b>
<b>Grid Reference:</b>	<b>TM 1376 4643</b>
<b>Oasis Reference:</b>	<b>suffolka1-202312</b>
<b>Curatorial Officer:</b>	<b>Dr M. Brudenell</b>
<b>Project Officer:</b>	<b>M. Sommers</b>
<b>Client/Funding Body:</b>	<b>Ipswich Borough Council</b>
<b>Client Reference:</b>	<b>n/a</b>

Digital report submitted to Archaeological Data Service:

<http://ads.ahds.ac.uk/catalogue/library/greylit>

### Disclaimer

Any opinions expressed in this report about the need for further archaeological work are those of Suffolk Archaeology CIC. Ultimately the need for further work will be determined by the Local Planning Authority and its Archaeological Advisors when a planning application is registered. Suffolk Archaeology CIC cannot accept responsibility for inconvenience caused to the clients should the Planning Authority take a different view to that expressed in the report.

Prepared By: M. Sommers

Date: 27th February 2015

Approved By: S. Boulter

Position: Senior Project Officer

Date:

Signed:



# Contents

---

## Summary

<b>1. Introduction</b>	<b>1</b>
<b>2. Geology and topography</b>	<b>1</b>
<b>3. Archaeology and historical background</b>	<b>3</b>
<b>4. Methodology</b>	<b>4</b>
<b>5. Results</b>	<b>4</b>
<b>6. Finds and environmental evidence</b>	<b>6</b>
<b>7. Discussion</b>	<b>6</b>
<b>8. Conclusions and recommendations for further work</b>	<b>6</b>
<b>9. Archive deposition</b>	<b>6</b>
<b>10. Acknowledgements</b>	<b>6</b>

## List of Figures

Figure 1. Location map	2
Figure 2. Trench locations in relation to the proposed development	5

## List of Tables

Table 1. Summary of HER entries	3
---------------------------------	---

## List of Plates

Plate 1. Sample of the exposed natural subsoil as seen in Trench 4 camera facing southeast	7
Plate 2. Soil profile as revealed in the side of Trench 1, camera facing west	7

## List of Appendices

Appendix 1. Written Scheme of Investigation	
Appendix 2. OASIS data collection form	





## **Summary**

An archaeological evaluation was carried out on an area of land to the rear of nos. 15 to 49 Ulster Avenue, Ipswich, in advance of a residential development. A total of five trenches were excavated but no features of any period were identified and no artefacts recovered. Only an undisturbed natural subsoil of pale orange sandy silt, at a depth of c.0.30m, was exposed lying immediately beneath a garden topsoil (Suffolk Archaeology Community Interest Company for Ipswich Borough Council)



## **1. Introduction**

---

Planning permission has been granted for a residential development on an area land to the rear of 15 to 49 Ulster Avenue, Ipswich, Suffolk (application number IP/14/00376). One of the conditions attached to the planning consent called for an agreed programme of archaeological work to be put in place in advance of this development.

The first stage of the programme of work, as specified in a Brief produced by Dr. Matthew Brudenell of the Suffolk County Council Conservation Team, was the undertaking of a trenched evaluation in order to ascertain what levels of archaeological evidence may be present within the development area and to inform any mitigation strategies that may then be deemed necessary. Based on this brief a Written Scheme of Investigation (WSI) was produced and subsequently approved by the Conservation Team (Appendix 1).

The National Grid Reference for the approximate centre of the site is TM 1376 4643. Figure 1 shows a location plan of the site.

The archaeological evaluation was carried out on the 24th February 2015 by Suffolk Archaeology Community Interest Company (SACIC) who were commissioned by the developer, Ipswich Borough Council.

## **2. Geology and topography**

---

The underlying geology in this area consists of clay, silt and sand of the Thanet Sand Formation And Lambeth Group, which is overlain by the Lowestoft Formation, an extensive sheet of chalky till, together with outwash sands and gravels, silts and clays.

The development site is located at c.20m above sea level on a high level terrace above the Gipping Valley, which meanders around a large spur to the southwest. The River Gipping itself flows from North to South in a channel c.900m to the west of the site.

The site comprises the rear gardens to apartments fronting onto Ulster Avenue and at the time of the evaluation was grassed with occasional small trees and bushes. Concrete paths and areas of hard standing were also present.

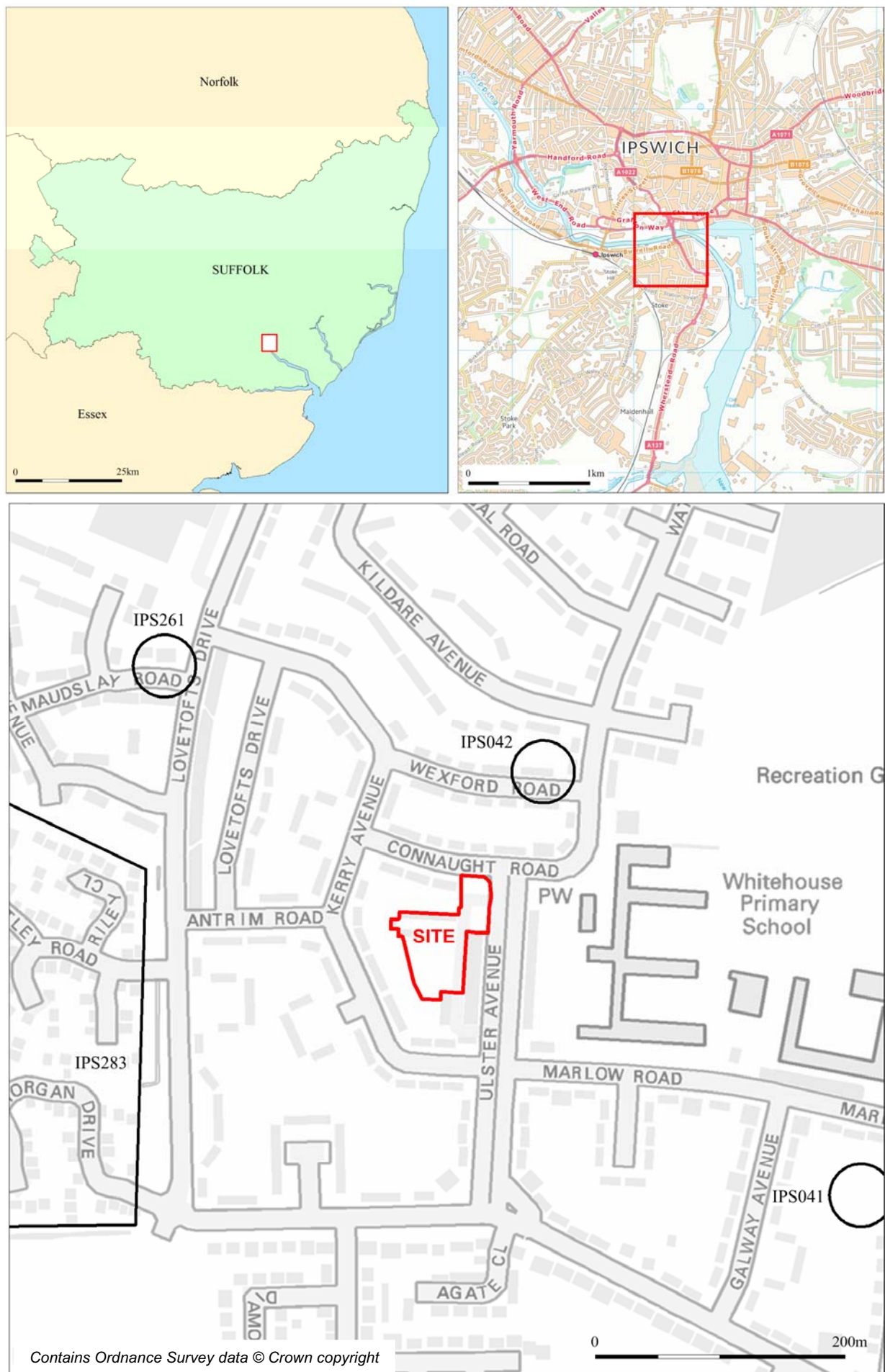

Figure 1. Location map

### 3. Archaeology and historical background

A small number of archaeological sites or findspots are recorded on the Historic Environment Record (HER) within the vicinity of the development site. A summary of these entries is presented in the following table; the recorded locations of which are marked in Figure 1.

HER No.	Address	Date	Nature of Evidence
IPS041	25 Marlow Rd.	Rom	Coin. Dupondius of Nero, AD 54-68 (BMC 339). Found in garden of 25 Marlow Road.
IPS042	6 Wexford Rd.	Rom	Coin. Faustina II, AD 175.
IPS261	Lovetofts Drive	med, Pmed	Site of Lovetofts, The Manor House known as Lovetofts Hall is a farmhouse on or near the site? Named after John de Lovetot 'who had a grant of free warren here in 1277. John de Lovetot died in 1295'. Manor House shown on tithe and OS maps up to 1955, no longer shown on c.1959 map.
IPS283	Lovetofts Drive	BA, IA, Sax, med and Pmed.	Possible house site, causewayed ring ditch with BA & IA pottery found in evaluation trenching. Also some sherds of Middle Iron Age pottery (Matt Brudenell, Oct 2008) pottery in south end of trench A (TM 1335 4624 approx.) and a 'pre' (?) medieval ditch in trench E. Also metal detector finds dated to the medieval and post medieval periods and a Saxon sceat (porcupine series G).

Table 1. Summary of HER entries

The recorded sites indicate low-level activity in the local area during the Roman and Anglo-Saxon periods. An area of Late Bronze Age/Iron Age occupation (IPS283) and a probable medieval occupation site, Lovetofts Hall (IPS261), are located within 300m of the development site. Additionally, a significant site with occupation activity dating to the Early Iron Age, Roman, Late Saxon and post-medieval periods is located approximately 900m to northwest (IPS247).

The proximity of these recorded sites suggest a reasonable potential for further archaeological deposits to be present within the development area.

Ulster Avenue is part of the Whitehouse Estate. The housing and the parade of shops and apartments in this area of the estate are believed to have been constructed in the early 1950s. Prior to this the area is marked as open farmland on 19th and early 20th century maps.

## **4. Methodology**

---

The trial trenches were machine excavated down to the level of the natural subsoil using a toothless bucket fitted to a small (3.5 tonne) mechanical excavator.

The machining of the trenches was closely observed throughout in order to identify archaeological features and deposits and to recover any artefacts that might be revealed. Excavation continued until undisturbed natural deposits were encountered, the exposed surface of which was then examined for cut features.

A photographic record of the work undertaken was also compiled using a 14 megapixel digital camera.

Following excavation of each trench, the nature of the overburden was recorded and the depths noted. The location of each trench was then related to the site boundary using 30m measuring tapes.

## **5. Results**

---

Five evaluation trenches were excavated across the site in locations that were broadly in accordance to the agreed trench plan (as per the WSI) but with some minor alterations to two of the trenches. Due to the presence of site huts and existing concrete hardstanding Trench 2 was moved c.4m to the north and Trench 4, which was originally intended to run further to the south, was stopped short to avoid a wildlife habitat in an area outside the proposed construction footprint. This trench was extended to the east by 8m at its northern end to form an 'L' shaped trench

Figure 2 depicts the trenches as excavated in relation to a plan of the proposed development (drawing ref. 2877/03 C, dated 20/1/14).

The soil profile as revealed in the trenches was consistent across the entire evaluation area. The exposed natural subsoil comprised a pale orange-yellow sandy silt that become sandier towards western site boundary (plate 1). It lay at a depth of c.0.30m below an overburden of clayey garden soil (plate 2). There was no positive evidence to suggest the surface had been artificially truncated. No disturbances, other than from tree roots, or features of any period were seen and no obviously pre-20th century artefacts were present in the topsoil.

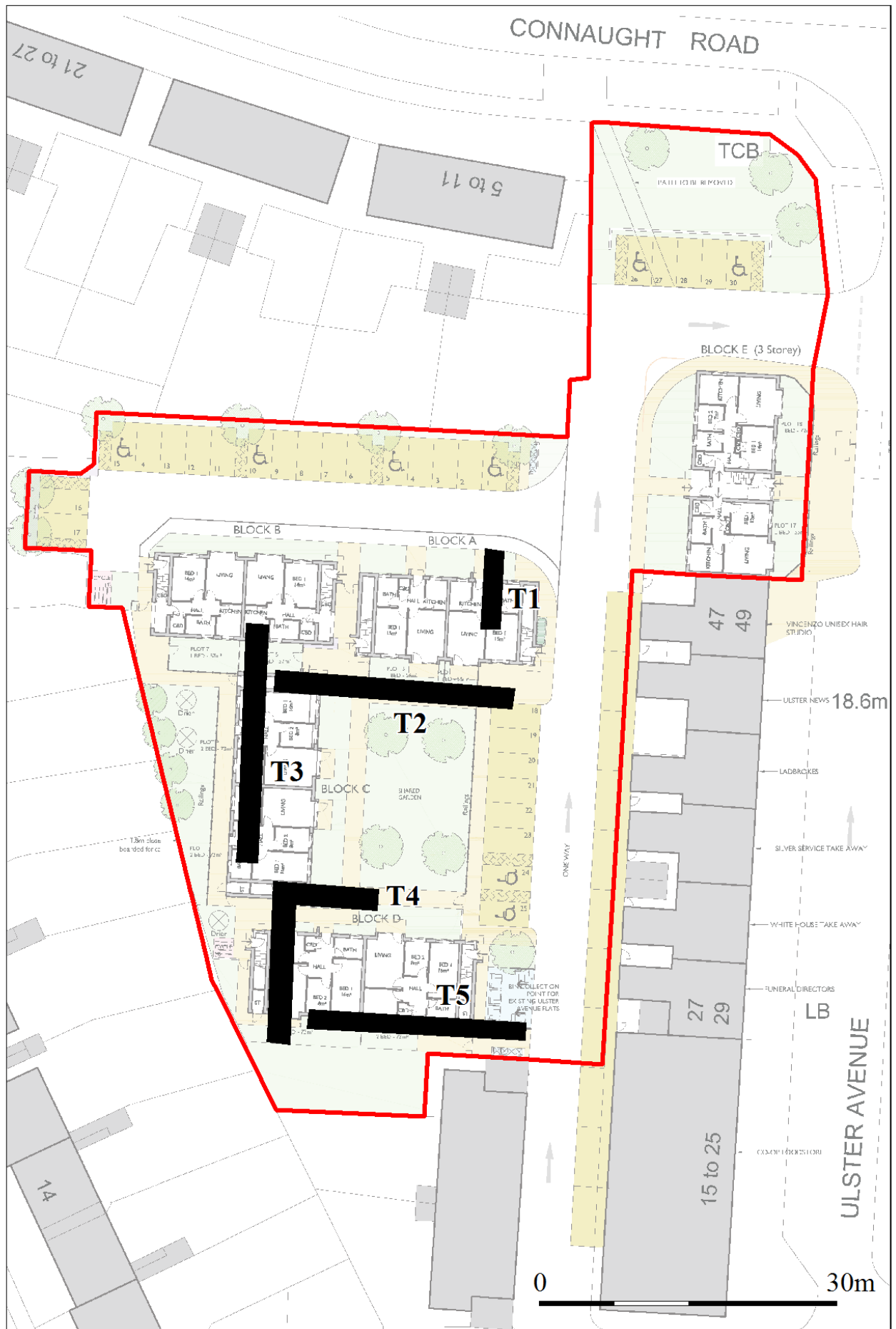

Figure 2. Trench locations in relation to the proposed development

## **6. Finds and environmental evidence**

---

No artefacts worthy of further analysis were recovered and no environmental samples taken.

## **7. Discussion**

---

No archaeological features were recorded in the evaluation trenches and no significant artefacts were recovered. There was no positive evidence for wholesale truncation of the natural subsoil during the construction of the housing in this area during the 1950s.

## **8. Conclusions and recommendations for further work**

---

Based on the results of evaluation no further archaeological work is recommended for this site although the final decision is at the discretion of the County Conservation Team.

## **9. Archive deposition**

---

Paper, digital and photographic archive will be sent to the County HER, ref. IPS762.

SACCIC digital photograph refs. HZJ 35 to HZJ 46.

Finds and environmental archive: n/a.

## **10. Acknowledgements**

---

The fieldwork was carried out by Preston Boyles and Mark Sommers

Project management was undertaken by Stuart Boulter who also provided advice during the production of the report and provided final editing.



## Plates

---



Plate 1. Sample of the exposed natural subsoils seen in Trench 4  
camera facing southeast (ref. HZJ 43)



Plate 2. Soil profile as revealed in the side of Trench 1, camera facing west (ref. HZJ 36)



## **Appendix 1. Written Scheme of Investigation**

---



**Land Rear of 15 – 49 Ulster Avenue,  
Ipswich, Suffolk**

**Archaeological Evaluation:**

**Written Scheme of Investigation**

**Prepared by  
Suffolk Archaeology CIC  
February 2015**

## **Document Control**

---

Title: Land Rear of 15 – 49 Ulster Avenue, Ipswich, Suffolk, Archaeological Evaluation: Written Scheme of Investigation and Risk Assessment.

Date: February 2015

Issued by: Suffolk Archaeology CIC

Author: Stuart Boulter

Checked by: N/A

Issued to: Suffolk County Council Archaeological Service Conservation Team  
and Ipswich Borough Council

## **Contents**

---

1. Background
2. Project Objectives
3. Project Details
4. Archaeological Method Statement

## **Figures**

1. Site location
2. Site detail and proposed trench locations

# 1 Background

- Suffolk Archaeology CIC (hereafter SA CIC) have been commissioned by Ipswich Borough Council to undertake a programme of archaeological evaluation on land to the rear of 15 – 49 Ulster Avenue, Ipswich, Suffolk (app. no. IP/14/00376) (TM 1376 4641) (Figure 1).
- The site covers an area of approximately 0.41 hectares (Figure 2).
- A Brief for these works was produced by the Suffolk County Council Archaeological Service Conservation Team (hereafter SCCAS/CT) Archaeologist Dr Matthew Brudenell in a document dated 19<sup>th</sup> December 2014. All SA CIC works will adhere to the requirements of this document.
- The archaeological potential for the site is based on information held by the County Historic Environment Record (HER). Iron Age settlement (HER no. 283) was recorded 200m to the east and Roman coins have been discovered both to the north and east (IPS 041 and IPS 042). These suggest widespread early occupation in the general area.
- This excavation will be carried out by members of SA CIC under the supervision of Project Officer Jez Meredith. Stuart Boulter will undertake the project management.
- The work is projected to be undertaken in the week beginning 23<sup>rd</sup> of February 2015.

## ***2 Project Objectives***

- PO1:** Identify the date, approximate form and purpose of any archaeological deposit within the application area, together with its likely extent, localised depth and quality of preservation.
- PO2:** Evaluate the likely impact of past land uses, and the possible presence of masking colluvial deposits.
- PO3:** Establish the potential for the survival of environmental evidence.
- PO4:** Provide sufficient information to construct an archaeological conservation strategy, dealing with preservation, the recording of archaeological deposits, timetables and orders of cost.



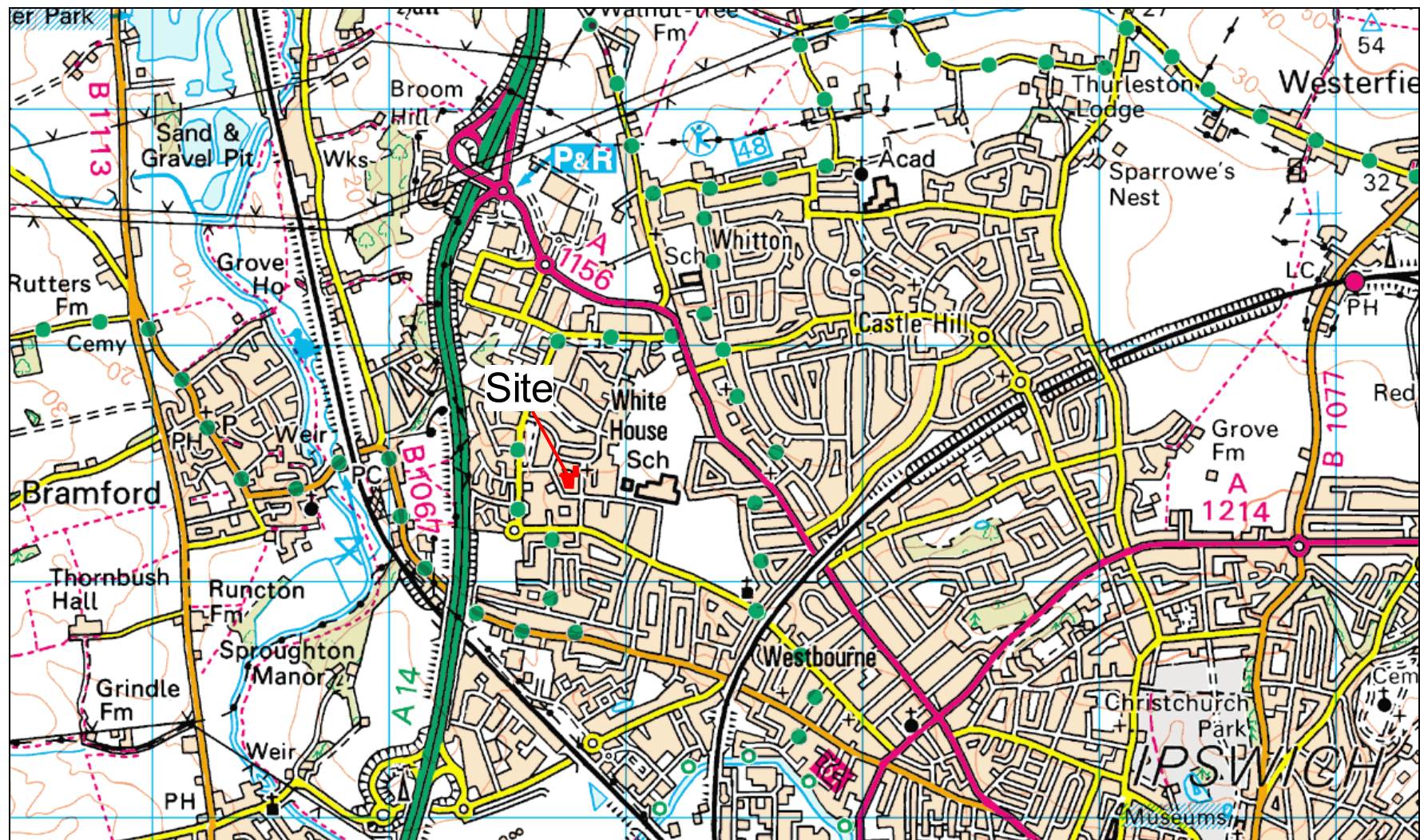

© Crown Copyright. All rights reserved. Suffolk County Council Licence No. 100023395 2015

Figure 1. Site location

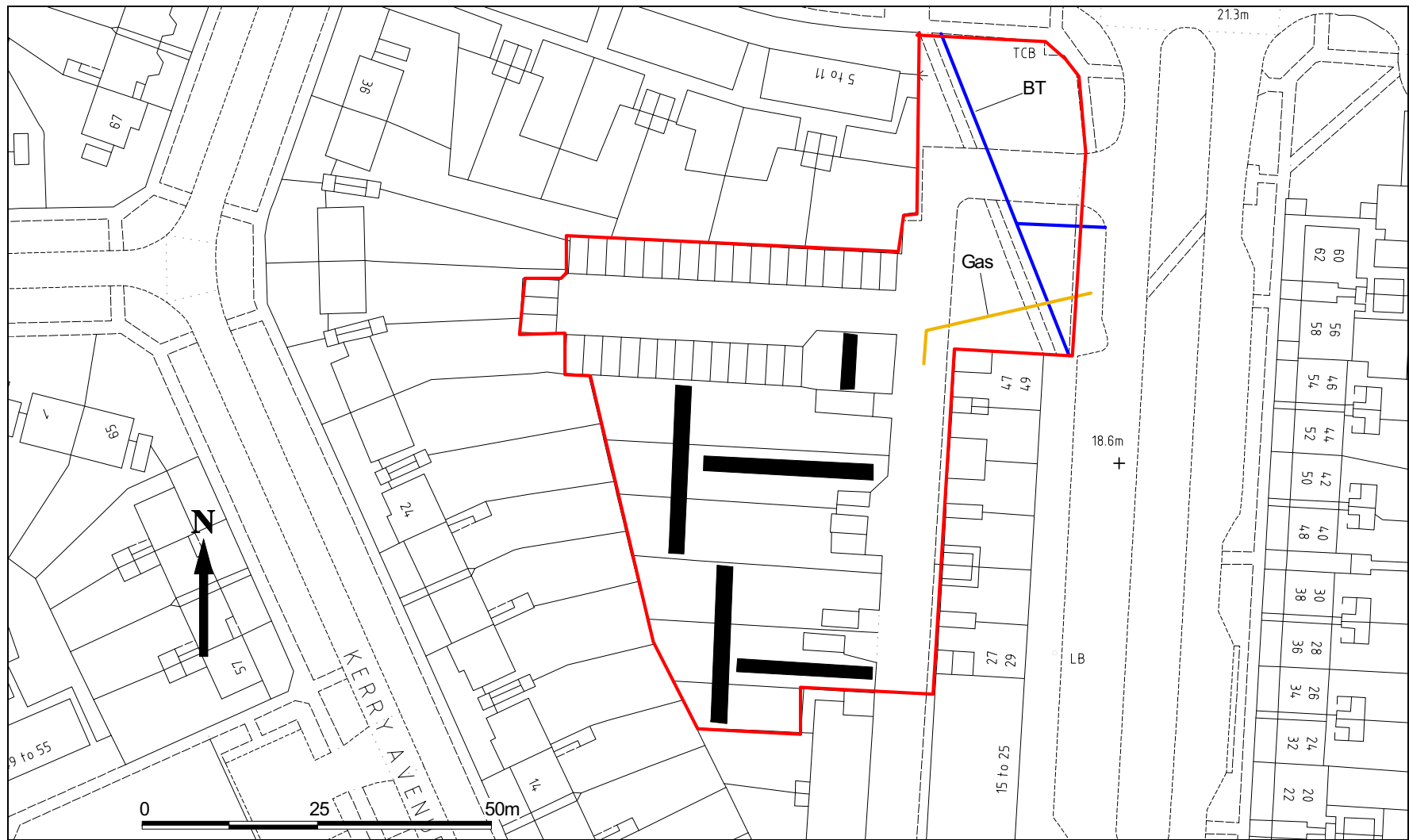

Figure 2. Site detail and proposed trench locations

### 3 Project Details

<b>Site Name</b>	Land Rear of 15 – 49 Ulster Avenue, Ipswich, Suffolk
<b>Site Location/Parish</b>	Ipswich
<b>Grid Reference</b>	TM 1376 4641
<b>Access</b>	From Ulster Avenue
<b>Planning No</b>	IP/14/00376
<b>HER No./HER Event No.</b>	IPS 762 / ESF22797
<b>OASIS Ref</b>	suffolka1-202312
<b>SA CIC Job Code</b>	IPSWULS001
<b>Type:</b>	Archaeological Evaluation
<b>Area</b>	c.0.41 hectares
<b>Project start date</b>	Week beginning 23 <sup>rd</sup> February 2015
<b>Duration</b>	Projected as 2 - 3 days on site
<b>Number of personnel on site</b>	2 SA CIC staff

#### Personnel and contact numbers

<b>Project Manager</b>	Stuart Boulter	07810 647259
<b>Assistant Project Officer (first point of on-site contact)</b>	Jezz Meredith	07889 971049
<b>Outreach Officer</b>	Duncan Allan	07768 430556
<b>Finds Dept.</b>	Richenda Goffin	01449 900129
<b>EH Regional Science Advisor</b>	Dr Helen Chappell	01223 582707
<b>Sub-contractors</b>	N/A	-
<b>Curatorial Officer</b>	Dr. Matthew Brudenell	01284 741227
<b>Consultant/Contact</b>	-	-
<b>Developer</b>	-	-
<b>Client</b>	Ipswich Borough Council	-
<b>Site landowner</b>	-	-

#### Emergency contacts

<b>Local Police</b>	10 Museum Street, Ipswich, IP1 1HT	01473 613500
<b>Local GP</b>	Dr. S. Roberts and Partners, 2 Deben Road, Ipswich, Suffolk, IP1 5EN	01473 741152
<b>Location of nearest A&amp;E</b>	Heath Road, Ipswich, Suffolk, IP4 5PD	01473 713223
<b>Qualified First Aiders</b>	Jezz Meredith	07889 971049
<b>Base emergency no.</b>	N/A	

#### Hire details

<b>Plant:</b>	Holmes Plant Hire	01473 890766
<b>Accommodation Hire</b>	N/A	
<b>Toilet Hire</b>	N/A	
<b>Tool hire:</b>	N/A	

## 4 Archaeological method statement

### Fieldwork

- The archaeological fieldwork will be carried out by members of SA CIC led by Project Officer Jez Meredith. The primary team of two will include an experienced metal detectorist/excavator from a pool of suitable staff at SA CIC.
- The c.0.41 hectare site is located to the west and north of a row of shops on the west side of Ulster Avenue, Ipswich and was previously occupied by gardens, garages and a grass verge (Figures 1 and 2).
- All mechanical excavation will be undertaken using a toothless ditching bucket for a good clean cut and will be constantly supervised by an experienced archaeologist.
- Topsoil and overburden will be removed stratigraphically by the mechanical excavator. The site will be excavated down to the top of the first undisturbed archaeological horizon, or the upper surface of the naturally occurring subsoil.
- There may be the need to remove additional masking subsoil layers such as hillwash (colluvium).
- Archaeological features and deposits will be sampled by hand excavation and the trench bases and sections cleaned and recorded as necessary in order to satisfy the project aims. While there is a presumption that the excavation work will cause minimum disturbance consistent with adequate evaluation, with solid or bonded structural remains, building slots or post-holes preserved intact, even if sampled, the following guidelines will be maintained:

A minimum of 1m wide slots will be excavated across linear features

50% of discrete features, such as pits, will be sampled, although in some instances 100% may be required

- Sufficient excavation will be undertaken to provide clear evidence for the period, depth and nature of any archaeological deposit. The depth and character of any colluvial or any other masking deposit will be established across the site.
- A site plan, which will show the trench location and other areas of investigation, feature positions and levels will be recorded. Where necessary, a RTK GPS or TST will be used, otherwise trenches will be located by triangulation from extant structures and boundaries. Feature sections and plans will be recorded at 1:20 or 1:50 as appropriate. Normal SA CIC conventions, compatible with the County HER, will be used during the site recording.
- The site will be recorded under the HER site code IPS 762 (event No. ESF22797). All archaeological features and deposits will be allocated '*observed phenomena*' numbers within a unique continuous number sequence and will be recorded using standard *pro forma* SA CIC Context Recording Sheets.
- A photographic record (high resolution digital) will be made during the evaluation.
- Metal detector searches will be made at all stages of the project covering both the upcast spoil and the base of the trenches.
- All pre-modern finds will be kept and no discard policy will be considered until all the finds have been processed and assessed. Finds on site will be treated according to 'First Aid For Finds' and a conservator will be available for on-site consultation as required.
- All finds will be taken to the SA CIC offices at Lion Barn Industrial Estate, Needham Market for processing, preliminary conservation and packing. Much of the archive and assessment preparation work will be done '*in-house*' at the Needham Market office, but in some circumstances it may be necessary to send some categories of finds to specialists working in archaeology and university departments in other parts of the country.
- In order to obtain palaeoenvironmental evidence, bulk soil samples (30-40 litres each) will be taken from selected archaeological features, particularly those

which are both datable and interpretable, and retained until an appropriate specialist has assessed their potential for palaeoenvironmental remains.

Decisions will be made on the need for further analysis following this assessment. If necessary advice will be sought from Dr Helen Chappell, English Heritage Regional Advisor in Archaeological Science, on the need for specialist environmental sampling. Four samples have been covered by the project costing and should SCCAS/CT require additional samples to be collected and processed then increased costs would be occurred.

- In the event of human remains being encountered on the site, guidelines from the Ministry of Justice will be followed and a suitable licence obtained before their removal from the site. Human remains will be treated at all stages with care and respect, and will be dealt with in accordance with the law. They will be recorded *in situ* and subsequently lifted, packed and marked to standards compatible with those described in the IFA's Technical Paper 13 Excavation and post-excavation treatment of Cremated and Inhumed Human Remains, by McKinley & Roberts. Following full recording and analysis, where appropriate, the remains will be reburied.
- Fieldwork standards will be guided by 'Standards and Guidance for Archaeological Excavation' (IFA, 1995, revised 2001), 'Standards for Field Archaeology in the East of England (EAA Occasional Papers 14, 2003), SCCAS/CT Requirements for a Trenched Archaeological Evaluation 2011 ver. 1.3 and SCCAS Archive Guidelines 2010.
- Welfare facilities have kindly been provided by R G Carter.

### **Post-excavation: programme management and detail**

- Post-excavation finds work will be managed by Richenda Goffin with the overall post-excavation reporting work the responsibility of Jez Meredith and managed by Stuart Boulter.
- An archive of all records and finds will be prepared, consistent with the principles of *MoRPHE*. It will be adequate to perform the function of a final archive for

deposition in the Archaeological Store of SCCAS/CT or in a suitable museum in Suffolk (see Archaeological Archives Forum: a guide to best practice 2007).

- The project manager will consult the intended archive depository before the archive is prepared regarding the specific requirements for the archive deposition and curation to include the specific cost implications of deposition. The final repository (in this SCCAS/CT) will accept the entire archive resulting from the project (both finds and written records) in order to create a complete record of the project. To that end, the archive will comply with SCCAS Archive Guidelines 2010.
- All site data will be entered on a computerised database compatible with the County HER. Site plans and sections will be copied/scanned and digitised to form a permanent archive on archivally stable material. Ordnance Datum levels will be on the section sheets. The photographic archive will be fully catalogued within the SA CIC photographic index.
- All finds will be processed, marked and bagged/boxed following ICON guidelines and the requirements of the County HER. All finds will be marked with a site code and a context number.
- Bulk finds will be fully quantified on a computerised database compatible with the County HER. Quantification will fully cover weights and numbers of finds by OP and context with a clear statement for specialists on the degree of apparent residuality observed.
- Metal finds on site will be stored in accordance with ICON guidelines, initially recorded and assessed for significance before dispatch to a conservation laboratory within four weeks of the end of the excavation. All pre-modern silver, copper alloy and ferrous metal artefacts will be x-rayed and coins will be x-rayed if necessary for identification. Sensitive finds will be conserved if necessary and deposited in bags/boxes suitable for long term storage to ICON standards. All coins will be identified to a standard acceptable to normal numismatic research.



### ***Finds reports***

Specialist finds reports will be undertaken in-house or commissioned as necessary to meet the following requirements at assessment level:

- The site archive will meet the standards set by 'The Guideline for the preparation of site archives and assessments of all finds other than fired clay vessels' of the Roman Finds Group and Finds Research Group AD700 - 1700 (1993).
- The pottery will be recorded and archived to a standard consistent with the Draft Guidelines of the Medieval Pottery Research Group and Guidelines for the archiving of Roman Pottery, SGRP (ed. M.G. Darling, 1994).
- Environmental samples will be processed and assessed to standards set by the Regional Environmental Archaeologist (Dr Helen Chapell) with a clear statement of potential for further analysis.
- Animal and human bone will be quantified and assessed to a standard acceptable to national and regional English Heritage specialists.
- An industrial waste assessment will cover all relevant material (i.e. fired clay finds as well as slag).

### ***Reporting***

- The evaluation report will contain a stand-alone summary and a description of the excavation methodology. It will also contain a clear separation of the objective account of the archaeological evidence from its archaeological interpretation and recommendations to assist the Planning Officer. It will contain sufficient information to stand as an archive report should further work not be required.
- The report will present a clear and concise assessment of the archaeological value and significance of the results and will be related to relevant known archaeological information held in the Suffolk HER.



- The finished report will also include an opinion as to the necessity for further evaluation and the scope of these works although the final decision will be made by SCCAS/CT. No further site work will be undertaken until the evaluation results have been assessed and the need for and scope of additional work established by SCCAS/CT.
- Following approval of a draft copy of the report, a single hard copy as well as a digital copy of the approved report will be marked for the attention of the archaeological officer, who will deposit it with the County HER.
- If applicable, a copy of the approved report will be sent to the local archaeological museum.
- An OASIS online record was initiated prior to the writing of this WSI document (Ref. suffolka1-202312). On completion of the projected, all the remaining applicable fields will be filled in a copy will be included in the final report and with the site archive. In addition, the final report (.pdf format) will be uploaded to the OASIS website (<http://ads.ahds.ac.uk/project/oasis/>).
- If positive results are drawn from the project, a summary report will be prepared, in the established format, suitable for inclusion in the annual 'Archaeology in Suffolk' section of the *Proceedings of the Suffolk Institute of Archaeology and History*. The summary will be included in the final report and will also be submitted to SCCAS/CT by the end of the calendar year in which the work took place.



## Appendix 2. OASIS data collection form

OASIS ID: suffolka1-202312	
<b>Project details</b>	
Project name	Land Rear of 15 - 49 Ulser Avenue, Ipswich: Record of an Archaeological Evaluation
Short description of the project	trenched evaluation - no features or artefacts of any period identified
Project dates	Start: 25-02-2015 End: 27-02-2015
Previous/future work	No / No
Any associated project reference codes	IPS762 - HER event no.
Any associated project reference codes	IP/14/00376 - Planning Application No.
Type of project	Field evaluation
Current Land use	Other 5 - Garden
Monument type	NONE None
Significant Finds	NONE None
Methods & techniques	"Sample Trenches"
Development type	Urban residential (e.g. flats, houses, etc.)
Prompt	National Planning Policy Framework - NPPF
Position in the planning process	After full determination (eg. As a condition)
<b>Project location</b>	
Country	England
Site location	SUFFOLK IPSWICH IPSWICH Rear of 15 - 49 Ulster Avenue
Study area	4000.00 Square metres
Site coordinates	TM 1376 4641 52.0741924662 1.11958567804 52 04 27 N 001 07 10 E Point
<b>Project creators</b>	
Name of Organisation	Suffolk Archaeology CIC
Project brief originator	Local Authority Archaeologist and/or Planning Authority/advisory body
Project design originator	Suffolk Archaeology Community Interest Company
Project director/manager	Stuart Boulter
Project supervisor	Mark Sommers
Type of sponsor/funding body	Developer

<b>Project archives</b>	
Physical Archive Exists?	No
Digital Archive recipient	Suffolk HER
Digital Archive ID	IPS762
Digital Contents	"other"
Digital Media available	"Images raster / digital photography","Text"
Paper Archive recipient	Suffolk HER
Paper Archive ID	IPS762
Paper Contents	"other"
Paper Media available	"Correspondence","Notebook - Excavation',' Research',' General Notes","Report"
<b>Project bibliography 1</b>	
Publication type	Grey literature (unpublished document/manuscript)
Title	15-49 Ulster Avenue, Ipswich: Archaeological Evaluation Report
Author(s)/Editor(s)	Sommers, M.
Other bibliographic details	SACIC Report No. 2015/011
Date	2015
Issuer or publisher	SACIC
Place of issue or publication	Needham Market
Description	printed sheets of A4 paper with card covers and a plastic comb binding
Entered by	MS (mark.sommers@suffolkarchaeology.co.uk)
Entered on	27 February 2015



Suffolk Archaeology CIC  
Unit 5 | Plot 11 | Maitland Road | Lion Barn Industrial Estate  
Needham Market | Suffolk | IP6 8NZ  
[Rhodri.Gardner@suffolkarchaeology.co.uk](mailto:Rhodri.Gardner@suffolkarchaeology.co.uk)

01449 900120  
**[www.suffolkarchaeology.co.uk](http://www.suffolkarchaeology.co.uk)**

