

PROJECT WP13	TRENCH 4	CONTEXT RECORD FORM The Whitworth Park Community Archaeology and History Project	INITIAL + DATE SD 5/7/13	CONTEXT 4020
EXCAVATOR	SUPERVISOR SD	*** DEPOSIT ***	SECTION	PLAN

FIELD INTERPRETATION

PROVISIONAL DATE

CONTEXT DESCRIPTION	CONTINUES	FINDS
COLOUR Yellowy Orange	CLARITY OF HORIZON Extremely clear	SAMPLES NO
COMPOSITION Clay, silt & sand soil matrixes material culture	Stone size + shape fine pebbles, large stones (5-10cm)	% of context
COMPACTION Extremely compact	Stone % + sorting 6%	Reason
LENGTH 3m	Charcoal % < 5%	Sieved?
WIDTH/DIAM. 1m	Roots < 5% A few	PHOTO (Slide) No
DEPTH/HEIGHT	Other inclusions	PHOTO (Digital) No

CONTEXT FORMATION (Taphonomy)	CONTEXT FORMATION (Anthropogenic)	HOW WAS THE CONTEXT FORMED? (Intentional? The process/procedure) Intentional re-deposition of clay material to form the mound feature for the Victorian park. Appears to have been largely hand shoveled with pockets
----------------------------------	--------------------------------------	---

Stratigraphical relationships	Physical relationships
	Overlies (402)
	Underlies (4002)
	Fill of
This context	Cuts
	Cut by
	Continues
	Same as
COORDINATES	Within
	Abuts
GRID REF	Abutted by

WHY IS THE DEPOSIT LIKE THIS?
(Look up from the deposit and consider why here, why now. What process made it happen)

This mound was most likely re-deposited as the lake feature was being dug to the south of the mound. The feature is mostly composed of dense clay, but there are many distinct pockets of various other soil matrixes (such as silt & sand) & also fragments of brick, pottery, glass & metal waste material mixed throughout.

Particulate soil matrix

WHAT WAS THIS DEPOSIT (context narrative- what kinds of practice does it relate to? look out from the deposit and consider the story)

While creating the lake feature, a "natural" ^{looking} mound was created to add to the Victorian landscape of the park & add character to the park while also providing a needed & convenient place to dispose of the excavated lake materials.

CONFIDENCE IN EXCAVATION 1 ↔ 5	CONFIDENCE IN INTERPRETATION 1 ↔ 5
--------------------------------	------------------------------------

PRE-EX: initial thoughts, notes and relevant discussion. (complete following pre-ex plan).

(Fine deposition of the clay mand)

We think this is a continuation of 4007, but as we are re-opening from last year's excavation we have given it a new context number and continuing to remove it.

HALF SECTION: consideration at this stage. (complete following section drawing).

POST-EX: concluding thoughts. (complete following post-ex plan).

In the South facing wall which is approx. 15cm off (to the North) from the limits of the WPII TR4 Trench boundaries, we can see a clear change in the soil matrix in the section. We still say these were both contexts from the action of constructing the mand (4007 & 4020), however the change is notable.

SKETCH AND ANY FURTHER DISCUSSION

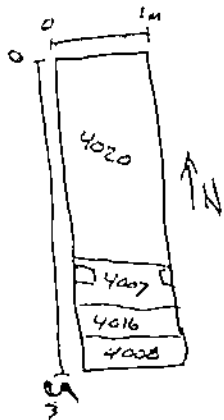

PROJECT WP13	TRENCH 4	CONTEXT RECORD FORM The Whitworth Park Community Archaeology and History Project	INITIAL + DATE SD 5/7/13	CONTEXT 4021
EXCAVATOR	SUPERVISOR SD	*** DEPOSIT ***	SECTION	PLAN

FIELD INTERPRETATION		PROVISIONAL DATE	
CONTEXT DESCRIPTION	CONTINUES	FINDS	Pottery, fish head, glass, pipes, bone
COLOUR Brown	CLARITY OF HORIZON fairly clear	SAMPLES	yes
COMPOSITION Silty soil	Stone size + shape pebbles	% of context	< 5%
COMPACTION moderately compact	Stone % + sorting 0.4%	Reason	Fish head deposit
LENGTH 5m	Charcoal % 6%	Sieved?	
WIDTH/DIAM. 1m	Roots < 5% yes	PHOTO (Slide) yes	143-148 #150-151 5x6 ST6
DEPTH/HEIGHT	Other inclusions brick, ceramic, pipe, glass	PHOTO (Digital) yes	7

CONTEXT FORMATION (Taphonomy)	CONTEXT FORMATION (Anthropogenic)	HOW WAS THE CONTEXT FORMED? (Intentional? The process/procedure) This was the main buried surface underlying the mound feature 4020 #4007
----------------------------------	--------------------------------------	--

Stratigraphical relationships	Physical relationships	WHY IS THE DEPOSIT LIKE THIS? (Look up from the deposit and consider why here, why now. What process made it happen) This deposit is most likely a buried surface, that was present and original, prior to the construction of the low mound. High material content suggests that the surface may have been walked on. This could indicate a possible path, area within the grounds of Ducie or Grove House.
	Overlies 4020	
	Underlies 4020	
	Fill of	
This context	Cuts	
	Cut by	
	Continues	
	Same as	
COORDINATES	Within	
	Abuts	
GRID REF	Abutted by	

WHAT WAS THIS DEPOSIT (context narrative- what kinds of practice does it relate to? look out from the deposit and consider the story)
This layer has been interpreted as an original ground surface, possibly a path leading through the gardens & the grounds of the surrounding estate. It overlies a subsoil ~~and~~ so we hope that we will soon reach natural. Its high material content may be indicative of a higher proportion of human activity over time rather than the result of a single action within this feature.

CONFIDENCE IN EXCAVATION 1 ↔ 5	CONFIDENCE IN INTERPRETATION 1 ↔ 5
--------------------------------	------------------------------------

PRE-EX: initial thoughts, notes and relevant discussion. (complete following pre-ex plan).

We are ~~so~~ confident that this is the buried surface prior to ~~the~~ the construction of the mound feature.

HALF SECTION: consideration at this stage. (complete following section drawing).

We realized that after excavating the Northern half of the sondage that we needed to work out the relationships for the path to the buried surface, so we can determine if the path cuts the surface or sits on top of it.

POST-EX: concluding thoughts. (complete following post-ex plan).

We determined that the path & the drain & trench all sat on top of the buried surface. ~~We used that the top of the sondage from 4011 (4021) was part of the~~ It is also likely that material recovered from 4016 from 2013 only was in actual fact 4021.

• SKETCH AND ANY FURTHER DISCUSSION

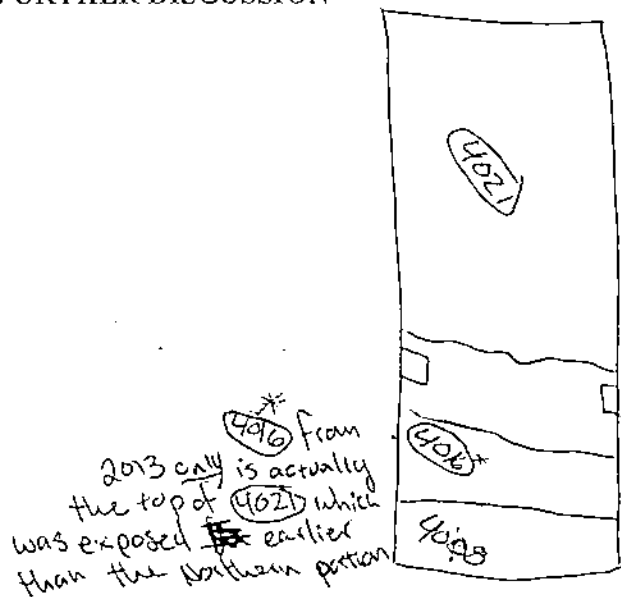

PROJECT WP13	TRENCH 4	CONTEXT RECORD FORM The Whitworth Park Community Archaeology and History Project	INITIAL + DATE 08/07/2013	CONTEXT 4022
EXCAVATOR	SUPERVISOR SD	*** DEPOSIT ***	SECTION	PLAN

FIELD INTERPRETATION PROVISIONAL DATE

CONTEXT DESCRIPTION	CONTINUES	FINDS Pottery, glass, coal
COLOUR Yellow, brown, grey	CLARITY OF HORIZON Very clear	SAMPLES No
COMPOSITION clay	Stone size + shape Pebbles & occasional medium	% of context N/A
COMPACTION very dense	Stone % + sorting > 1%	Reason N/A
LENGTH	Charcoal % > 5%	Sieved? N/A
WIDTH/DIAM.	Roots 5%	PHOTO (Slide) yes 15/17, 16
DEPTH/HEIGHT	Other inclusions broken brick, nothing else	PHOTO (Digital) yes 150, 151

CONTEXT FORMATION (Taphonomy)	CONTEXT FORMATION (Anthropogenic)	HOW WAS THE CONTEXT FORMED? (Intentional? The process/procedure) Intentional re-deposition of the material to create the lake feature at the base of the Victorian path with a possible path from the surface prior to the construction of the park.
----------------------------------	--------------------------------------	--

Stratigraphical relationships	Physical relationships	WHY IS THE DEPOSIT LIKE THIS? (Look up from the deposit and consider why here, why now, What process made it happen) The deposit was most likely redeposited as the lake feature was dug to the south of the mound. The feature is mostly composed of yellowish, brown and grey clay, very dense and hard to work through, with a small amount of broken brick pieces, but no other artefacts were found.
	Overlies	
	Underlies 4008	
	Fill of	
This context	Cuts	
	Cut by	
	Continues	
	Same as	
COORDINATES	Within	
	Abuts	
GRID REF	Abutted by	

WHAT WAS THIS DEPOSIT (context narrative- what kinds of practice does it relate to? look out from the deposit and consider the story)
~~While creating the lake feature, an artificial mound was created to add to the Victorian landscape of the park. This was the underlying clay from the pre-existing path either laid at in advance of the construction of the Victorian path feature at the base of the mound or a path associated with the grounds of Dacie House.~~
 This was the underlying clay from the pre-existing path either laid at in advance of the construction of the Victorian path feature at the base of the mound or a path associated with the grounds of Dacie House.

PRE-EX: initial thoughts, notes and relevant discussion. (complete following pre-ex plan).

HALF SECTION: consideration at this stage. (complete following section drawing).

POST-EX: concluding thoughts. (complete following post-ex plan).

SKETCH AND ANY FURTHER DISCUSSION

PROJECT WP13	TRENCH 4	CONTEXT RECORD FORM The Whitworth Park Community Archaeology and History Project	INITIAL + DATE 08/07/2013	CONTEXT 4024
EXCAVATOR	SUPERVISOR SD	*** DEPOSIT ***	SECTION	PLAN

FIELD INTERPRETATION PROVISIONAL DATE

CONTEXT DESCRIPTION	CONTINUES	FINDS
COLOUR light brownish/grey	CLARITY OF HORIZON Fairly clear	SAMPLES
COMPOSITION st silty clay coal inclusions	Stone size + shape Small smoothed pebbles	% of context
COMPACTION moderate ^{to 2/3} compact	Stone % + sorting 8-9%	Reason
LENGTH 5m	Charcoal % 710% 710%	Sieved? yes
WIDTH/DIAM. 1m	Roots yes	PHOTO (Slide)
DEPTH/HEIGHT	Other inclusions	PHOTO (Digital)

CONTEXT FORMATION (Taphonomy)	CONTEXT FORMATION (Anthropogenic)	HOW WAS THE CONTEXT FORMED? (Intentional? The process/procedure) subsoil → natural deposition of material, some inclusions, possibly from filling the land.
----------------------------------	--------------------------------------	---

Stratigraphical relationships	Physical relationships	WHY IS THE DEPOSIT LIKE THIS? (Look up from the deposit and consider why here, why now. What process made it happen) Subsoil layer kept moist, by being buried under the material excavated from the lake & redeposition. Inclusions of coal possibly the result of domestic waste Underlies (402), the buried surface.
	Overlies	
4022	Underlies (4021) (4022) (4023)	
	Fill of	
This context 4024	Cuts	
	Cut by	
	Continues	
	Same as	
COORDINATES	Within	
GRID REF	Abuts	

WHAT WAS THIS DEPOSIT (context narrative- what kinds of practice does it relate to? look out from the deposit and consider the story)
This deposit represents the subsoil underlying the original ground surface, and overlying the natural. A thick compact, silty clay layer stretches the whole extent of the sondage, suggesting that it is a buried ~~soil~~ subsoil. Possibly underlying an pre-park path surface layer. Although the layer itself is so clear there have been a number of finds within it.

PRE-EX: initial thoughts, notes and relevant discussion. (complete following pre-ex plan).

HALF SECTION: consideration at this stage. (complete following section drawing).

POST-EX: concluding thoughts. (complete following post-ex plan).

SKETCH AND ANY FURTHER DISCUSSION