



# C261 ARCHAEOLOGY EARLY EAST Survey Report Archaeological Watching Briefs and Evaluation Stepney Green Shaft - XRV10

Document Number: C261-MLA-X-RGN-CR140-50001

Document History (MOLA internal):

Version:	Date:	Prepared By:	Checked by:	Approved by:	Version History
1.0	27/01/11	G Simons	S Jones	E Eastbury	For Crossrail Approval
2.0	22.03.12	G Simons	S Jones	E Eastbury	MOLA response to document review No: C261-XRL-X-XCS-CR140-50006
3.0	19.06.12 9/6/12	C Drew	S Jones	E Eastbury	MOLA response to document review No: C261-XRL-X-XCS-CR140-50011 v.2
		<i>C Drew</i>	<i>S Jones</i>	<i>E Eastbury</i>	

This document contains proprietary information and may not be reproduced without prior written consent from the executive chairman of Crossrail Ltd.

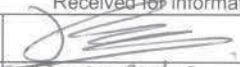

<b>CROSSRAIL REVIEW AND ACCEPTANCE STATUS</b>		
This decal is to be used for submitted documents requiring acceptance by CRL.		
<input checked="" type="checkbox"/>	Code 1.	Accepted. Work May Proceed
<input type="checkbox"/>	Code 2.	Not Accepted. Revise and resubmit. Work may proceed subject to incorporation of changes indicated
<input type="checkbox"/>	Code 3.	Not Accepted. Revise and resubmit. Work may not proceed
<input type="checkbox"/>	Code 4.	Received for information only. Receipt is confirmed
Reviewed/Accepted by:(signature)		
Print Name:	D. Craven	Date: 13/6/12
Acceptance by CRL does not relieve the designer/supplier from full compliance with their contractual obligations and does not constitute CRL approval of design, details, calculations, analyses, test methods or materials developed or selected by the designer/supplier.		



<b>CROSSRAIL REVIEW AND ACCEPTANCE STATUS</b>		
This decal is to be used for submitted documents requiring acceptance by CRL.		
<input type="checkbox"/>	Code 1.	Accepted. Work May Proceed
<input type="checkbox"/>	Code 2.	Not Accepted. Revise and resubmit. Work may proceed subject to incorporation of changes indicated
<input type="checkbox"/>	Code 3.	Not Accepted. Revise and resubmit. Work may not proceed
<input type="checkbox"/>	Code 4.	Received for information only. Receipt is confirmed
Reviewed/Accepted by:(signature)		
Print Name:		Date:
Acceptance by CRL does not relieve the designer/supplier from full compliance with their contractual obligations and does not constitute CRL approval of design, details, calculations, analyses, test methods or materials developed or selected by the designer/supplier.		



MOLA Survey Report for Crossrail

Event code / MOLA site code	XRV10
Sub-site division (if applicable)	N/A
Site Address	Stepney Green Shaft, King John Street, Stepney Green, London E1 3DG
Type of archaeological fieldwork	General Watching Brief / Evaluation
Coordinate system	OSGB36
Survey method and control	Optical survey using Crossrail survey control  GPS tie in to Crossrail London Survey Grid control Station CR150 : 85982.168/36284.970/109.357 Station CR151 : 86108.781/36248.013/109.858
Survey date / surveyors	06/12/2010, M. Burch and C. Drew 20/12/2010, M. Burch and C. Drew 11/01/2011, M. Burch and G. Simons 13/01/2011, M. Burch and G. Simons Report compiled by M. Burch
Derivation of vertical control	Brought in by Crossrail Engineer on site
Values of TBMs	Site TBM located on survey nail CR151 value of 9.357 mOD.
Additional information	MOLA Survey was tied into Crossrail London Survey Grid control Stations provided by Crossrail site surveyors.  The digital deliverable was created in AutoCAD2009 and exported to Microstation dgn V8 format. This will be delivered in Project Wise and number created at a later date.

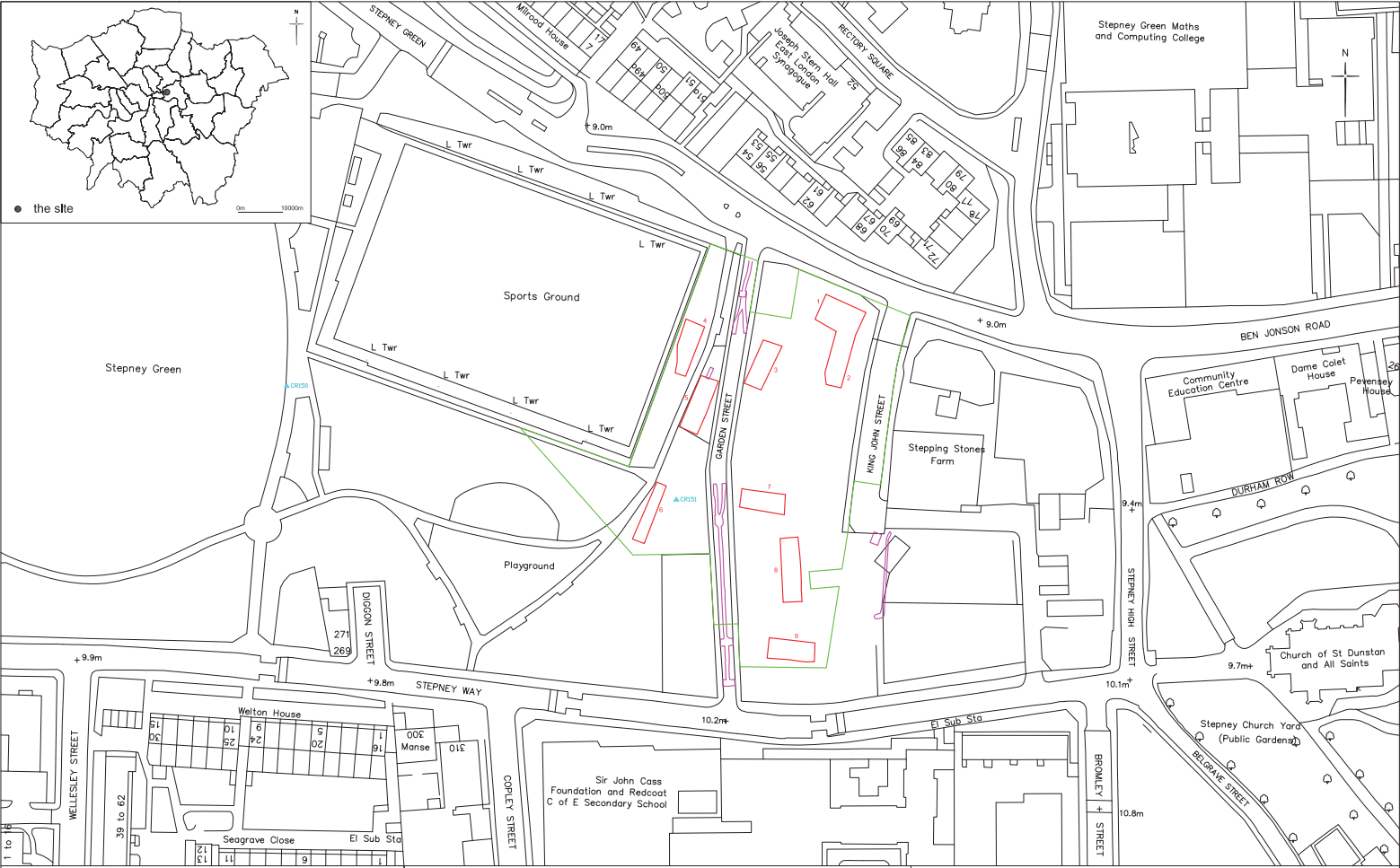

Fig 1: Site location

- Area of ground reduction
- Area of GWB
- Area and location of evaluation trenches
- ▲ CR100 Crossrail control stations used by MOLA

0 1: 1250 @ A3 100m

Based upon the Ordnance Survey mapping with the permission of the Controller of Her Majesty's Stationery Office © Crown Copyright. Unauthorised reproduction infringes Crown Copyright and may lead to prosecution or civil proceedings. TFL 100032379 2010.