

CFA Archaeology Ltd

archaeological consultants

Advice on Archaeology & Planning

Environmental Impact Assessment

Interpretation, Design & Display

Finds/ Environmental Analysis

Field Evaluation & Excavation

Historic Building Recording

Site & Landscape Survey

Geophysical Survey

Erection of site hoarding alongside the Forth & Clyde Canal: Glasgow Branch

Archaeological Watching Brief

Report No. 3306

CFA ARCHAEOLOGY LTD

The Old Engine House
Eskmills Business Park
Musselburgh
East Lothian
EH21 7PQ

Tel: 0131 273 4380
Fax: 0131 273 4381
email: info@cfa-archaeology.co.uk
web: www.cfa-archaeology.co.uk

Author	Ewan MacNeilage MA
Illustrator	Graeme Carruthers MA MCIfA
Editor	Melanie Johnson MA PhD FSA Scot MCIfA
Commissioned by	Elmwood Projects Ltd
Date issued	June 2014
Version	0
Grid Ref	NS 5883 6673

This document has been prepared in accordance with CFA Archaeology Ltd
standard operating procedures.

Erection of site hoarding alongside the Forth & Clyde Canal: Glasgow Branch

Archaeological Watching Brief

Report No. 3306

CONTENTS

1.	Introduction	3
2.	Working Methods	4
3.	Archaeological Results	4
4.	Conclusion	5

Appendices

1.	Photograph Register	6
2.	Context Register	6
3.	Discovery and Excavation in Scotland Entry	7

Figures (bound at rear)

1.	Location of site	
2.	Plan shot of post-hole 1 showing stone deposit 002	
3.	Plan shot of post-hole 15 showing sandy gravel layer 003	
4.	Plan shot of post-hole 35 showing metal fitting in-situ	
5.	General view of working area	

1. INTRODUCTION

1.1 General

This report presents the results of a programme of archaeological work undertaken by CFA Archaeology Ltd (CFA) in June 2015 during groundbreaking works associated with the erection of site hoarding on the towpath at Speirs Wharf along the bank of the Forth & Clyde Canal, off Sawmillfield Street, Glasgow (NGR: NS 5883 6673) (Fig. 1).

The Forth & Clyde Canal: Glasgow Branch is a Scheduled Monument (Index No 6771). A Written Scheme of Investigation (WSI) was produced by CFA on behalf of Elmwood Projects Ltd for an archaeological watching brief during the excavation of post-holes within the scheduled area for the erection of site hoarding, in order to support an application for Scheduled Monument Consent. Its content is based on communication between Elmwood Projects Ltd and John Malcolm of Historic Scotland. Scheduled Monument Consent was granted.

1.2 Background

Historic Scotland has identified that historic mapping shows a 19th century jute mill was built on the construction site, and was demolished after the war. This factory was partly built into the side of the embankment of the Forth & Clyde Canal, so its foundations and possible floor levels may be partly preserved within the embankment. It was therefore possible that associated remains would be uncovered in the excavations for the fence posts. It was also possible that canal-side features would be uncovered.

1.3 Objectives

The objectives of the programme of archaeological works were:

- To conduct an appropriate programme of archaeological investigation (watching brief) to monitor all ground breaking works as described above.
- To mitigate the effects of construction on any archaeological deposits or features identified through their excavation and recording and produce a report on them.

2. WORKING METHODS

2.1 General

CFA Archaeology Ltd follows the Chartered Institute for Archaeologists' Code of Conduct, Standards and Guidance for Archaeological Fieldwork. Recording of all elements followed established CFA methods.

2.2 Archaeological Watching Brief

The erection of site hoarding involved the excavation of 49 post-holes with centres at 2.4m intervals with the holes approximately 400mm by 300mm by 450mm deep. The post-holes were hand excavated and backfilled with post-crete.

A watching brief was carried out during the excavation of the post-holes. Any archaeological remains identified in the post-holes were fully recorded by excavation, drawing, photography and survey.

3. ARCHAEOLOGICAL RESULTS

49 post-holes were hand excavated to a depth of c.0.45m, and measured 0.4m by 0.3m in plan on average, and all were subject to archaeological monitoring (Fig. 1, 5). Starting from the north end of the site and moving southwards, the post-holes were numbered from 1 to 49 successively.

The post-holes were excavated through 0.1m to 0.2m of turf and black/dark brown silty sand topsoil (**001**) containing rubble and occasional lenses of blaes. Natural subsoil was not reached in any of the locations.

In some of the post-holes (numbers 4, 7, 8 and 24-30) the topsoil overlay a densely packed deposit of large stones (**002**), the stones measuring up to 0.3m across (Fig. 2). This stone deposit was in places visible on the ground surface as a cobble surface along the bank of the canal and was widespread. Once the stones were removed, where needed, the post-holes were excavated to the correct depth through a mid brown/mixed sand and gravel layer (**003**) which contained occasional inclusions of ash and broken ceramic building material (Fig. 3). These lower deposits most likely represent a surface levelling layer as part of the modern canal towpath.

Post-hole 35 contained an iron fitting, possibly a cast-off girder fitting, at a depth of roughly 0.1m from the ground surface (Fig. 4). The fitting was kept in situ.

No other archaeological remains were encountered.

4. CONCLUSION

A watching brief was carried out during ground-breaking works associated with the erection of site hoarding along the bank of the Forth & Clyde Canal (SAM Index No 6771) in Speirs Wharf, City of Glasgow.

49 post-holes were hand excavated during the course of the works. The post-holes were excavated through topsoil, overlying in places a deposit of large stones and a sandy gravel deposit of made ground, both of which are likely related to levelling operations for the modern canal towpath. One metal fitting was encountered. No other archaeological remains were encountered, and no micro-siting of the post-holes was required.

The project archive, comprising all CFA record sheets, maps and reports, will be deposited with the National Monuments Record of Scotland (NMRS) as well as Historic Scotland, and copies of reports will be lodged with the Glasgow City Council Sites and Monuments Record.

A summary statement of the results of this watching brief will be submitted for publication in *Discovery and Excavation in Scotland* (Appendix 2).

APPENDIX 1: Photographic Register

Shot No.	Summary description of subject	Taken from	Conditions
1	General shot of site area along canal bank	N	Sun
2	Working shot at post-hole 1	S	Sun
3	Post-hole 1 post-ex (northernmost)	Above	Sun
4	Post-hole 4 post-ex	Above	Sun
5	Post-hole 7 post-ex	Above	Sun
6	Post-hole 11 post-ex	Above	Sun
7	Post-hole 15 post-ex	Above	Sun
8	Post-hole 19 post-ex	Above	Sun
9	Post-hole 23 post-ex	Above	Sun
10	Post-hole 28 post-ex	Above	Sun
11	Post-hole 35 post-ex showing metal fitting	Above	Sun
12	Post-hole 42 post-ex	Above	Sun
13	Post-hole 49 post-ex (southernmost)	Above	Sun
14	Post-hole 49 post-ex (southernmost)	Above	Sun
15	General shot of site upon completion	S	Sun

APPENDIX 2: Context Register

Context no.	Description
001	Dark brown/black silty sand topsoil. 0.1m to 0.2m in depth
002	Deposit of large stones up to 0.3m in diameter directly underlying topsoil.
003	Sandy gravel with inclusions of ash and broken ceramic building material, directly underlying stony layer 002 .

APPENDIX 3: Discovery and Excavation in Scotland Entry

LOCAL AUTHORITY:	West of Scotland Archaeology Service
PROJECT TITLE/SITE NAME:	Erection of site hoarding alongside the Forth & Clyde Canal: Glasgow Branch
PROJECT CODE:	SPIE
PARISH:	Glasgow (City of Glasgow)
NAME OF CONTRIBUTOR:	Ewan MacNeilage
NAME OF ORGANISATION:	CFA Archaeology Ltd
TYPE(S) OF PROJECT:	Watching Brief
NMRS NO(S):	-
SITE/MONUMENT TYPE(S):	Forth & Clyde Canal (Glasgow Branch) – SAM No. 6771
SIGNIFICANT FINDS:	-
NGR (2 letters, 10 figures)	NS 5883 6673
START DATE (this season)	10 June 2015
END DATE (this season)	11 June 2015
PREVIOUS WORK (incl. DES ref.)	N/A
MAIN (NARRATIVE) DESCRIPTION: (May include information from other fields)	<p>A watching brief was carried out during ground-breaking works associated with the erection of site hoarding along the bank of the Forth & Clyde Canal (SAM Index No 6771) in Speirs Wharf, City of Glasgow.</p> <p>49 post-holes were hand excavated during the course of the works. The post-holes were excavated through topsoil, overlying in places a deposit of stones and a sandy gravel deposit of made ground, both of which are likely related to levelling operations for the modern canal towpath. One metal fitting was encountered and left in situ. No other archaeological remains were encountered.</p>
PROPOSED FUTURE WORK:	None
CAPTION(S) FOR ILLUSTRS:	N/A
SPONSOR OR FUNDING BODY:	Elmwood Projects Ltd
ADDRESS OF MAIN CONTRIBUTOR:	The Old Engine House, Eskmills Park, Musselburgh, EH21 7PQ
EMAIL ADDRESS:	cfa@cfa-archaeology.co.uk
ARCHIVE LOCATION (intended/deposited)	<p>National Monuments Record of Scotland (archive)</p> <p>Glasgow City Council Sites and Monuments Record</p>

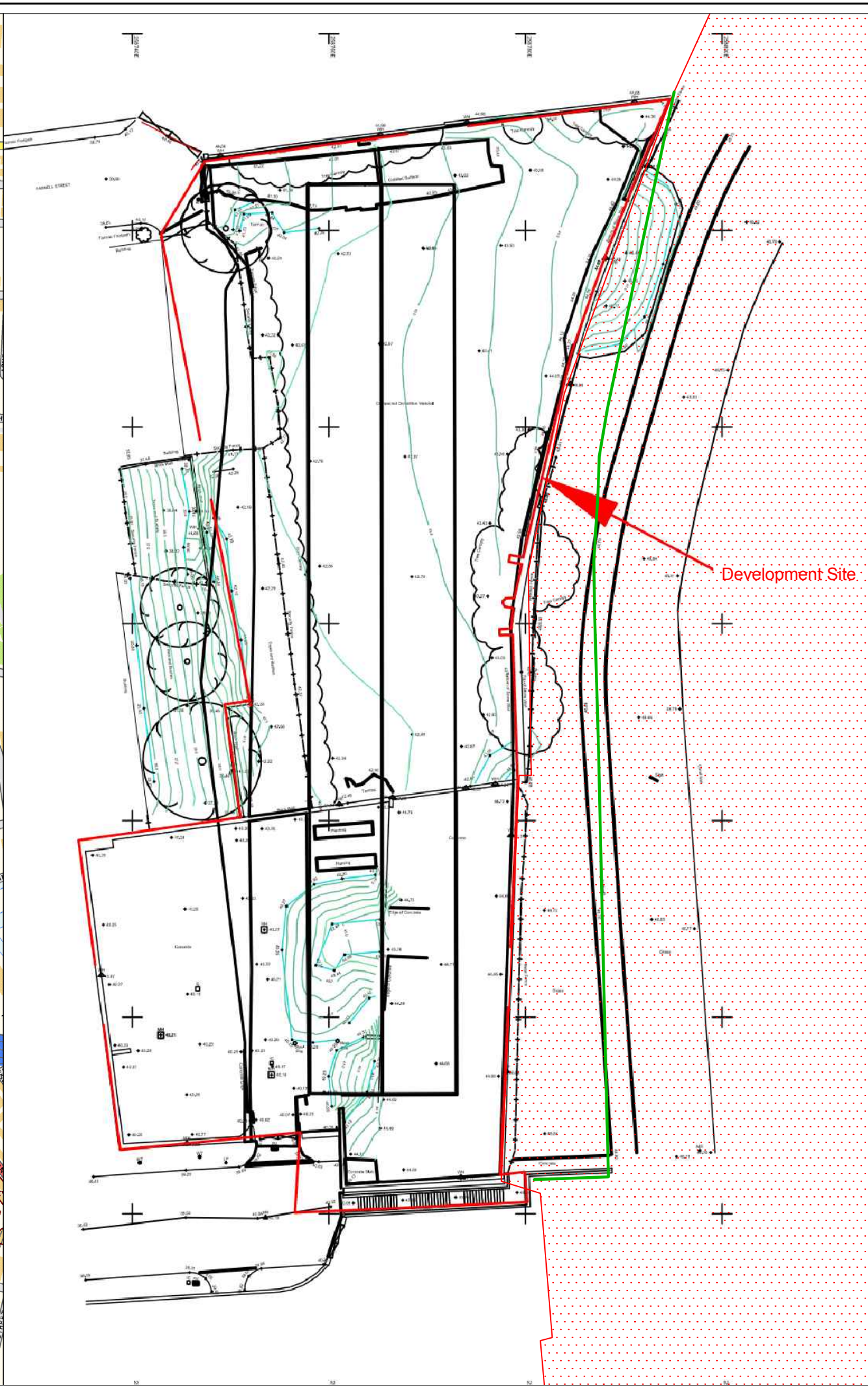
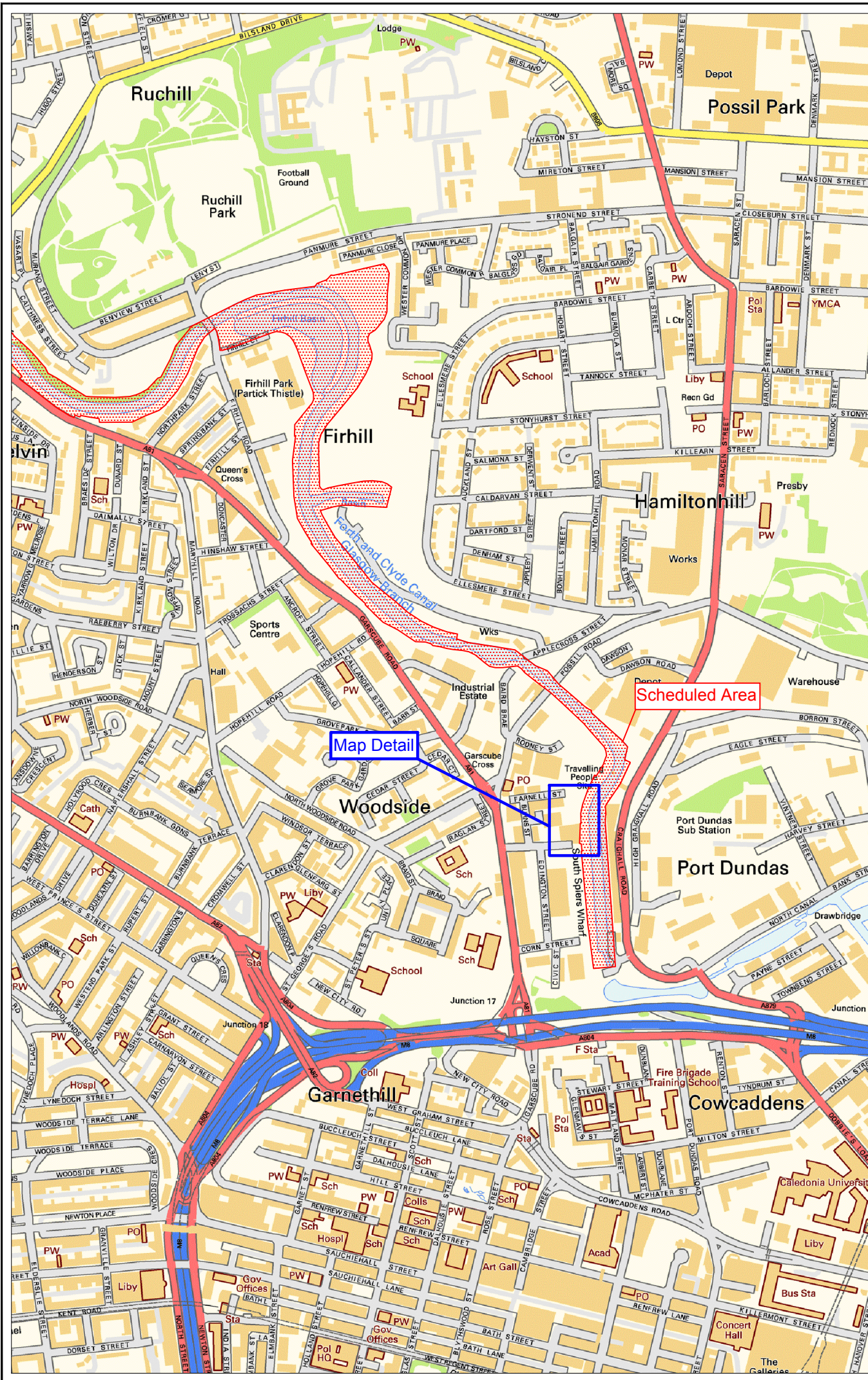

Key:

- Development Area
- Development Site
- Line of new hoarding
- Scheduled Monument

CFA ARCHAEOLOGY LTD
Old Engine House
Eskmills Park
Musselburgh
East Lothian, EH21 7PQ
T: 0131 273 4380
F: 0131 273 4381
info@cfa-archaeology.co.uk
www.cfa-archaeology.co.uk

Fig. No: 1	Report No: 3306
Title: Location of site	
Project: Ground breaking works associated with the erection of site hoarding alongside the Forth & Clyde Canal Archaeological Watching Brief	
Client: Elmwood Projects Ltd	
Scale at A3: 1:10 000 main map 1:500 map detail	
Drawn by: GC	Checked: SW
Date: 17/06/2015	
Reproduced with the permission of Ordnance Survey on behalf of The Controller of Her Majesty's Stationery Office, © Crown copyright. CFA Archaeology Ltd, Old Engine House, Eskmills Park, Musselburgh EH21 7PQ AL100034785	
The copyright in this document (including its electronic form) shall remain vested in CFA Archaeology Ltd (CFA) but the Client shall have a licence to copy and use the document for the purpose for which it was provided. CFA shall not be liable for the use by any person of this document for any purpose other than that for which the same was provided by CFA. This document shall not be reproduced in whole or in part or relied upon by third parties for any use whatsoever without the express written authority of CFA.	



Fig. 2 Plan shot of post-hole 1 showing stone deposit **002**



Fig. 3 Plan shot of post-hole 15 showing sandy gravel layer **003**



CFA ARCHAEOLOGY LTD
 Old Engine House
 Eskmills Park
 Musselburgh
 East Lothian, EH21 7PQ
 T: 0131 273 4380
 F: 0131 273 4381
 info@cfa-archaeology.co.uk
 www.cfa-archaeology.co.uk

Title:	Fig. 2 - 3	Report: 3306	Drawn: GC	CKD: SW	Date: 01/07/15
	Client: Elmwood Projects Ltd				
Project: Ground breaking works associated with the erection of site hoarding along the Forth & Clyde Canal : Glasgow Branch - Archaeological Watching Brief					



Fig. 4 Plan shot of post-hole 35 showing metal fitting in situ



Fig. 5 General view of working area



CFA ARCHAEOLOGY LTD
 Old Engine House
 Eskmills Park
 Musselburgh
 East Lothian, EH21 7PQ
 T: 0131 273 4380
 F: 0131 273 4381
info@cfa-archaeology.co.uk
www.cfa-archaeology.co.uk

Title:	Fig. 4-5	Report: 3306	Drawn: GC	CKD: SW	Date: 01/07/15
Client: Elmwood Projects Ltd					
Project: Ground breaking works associated with the erection of site hoarding along the Forth & Clyde Canal : Glasgow Branch - Archaeological Watching Brief					