

# CFA Archaeology Ltd

archaeological consultants

*Advice on Archaeology & Planning*

*Environmental Impact Assessment*

*Intpretation, Design & Display*

*Finds/ Environmental Analysis*

*Field Evaluation & Excavation*

*Historic Building Recording*

*Site & Landscape Survey*

*Geophysical Survey*

**Extension to 2 Grannus Mews,  
Inveresk,  
East Lothian**

**Archaeological Watching Brief**

**Report No. 1783**

 0131 273 4380

 0131 273 4381

 info@cfa-archaeology.co.uk

 www.cfa-archaeology.co.uk

## **CFA ARCHAEOLOGY LTD**

The Old Engine House  
Eskmills Business Park  
Musselburgh  
East Lothian  
EH21 7PQ

Tel: 0131 273 4380  
Fax: 0131 273 4381  
email: [info@cfa-archaeology.co.uk](mailto:info@cfa-archaeology.co.uk)  
web: [www.cfa-archaeology.co.uk](http://www.cfa-archaeology.co.uk)

Author	Ian Suddaby MA FSA Scot MifA
Illustrator	Graeme Carruthers BA MAAIS
Editor	Melanie Johnson MA PhD FSA Scot MifA
Commissioned by	Mr Fred Lawson via The Pollock Hammond Partnership
Date issued	July 2010
Version	1
OASIS Reference	cfaarcha1 - 78593
Planning Application No	09/00726/P
Grid Ref	NT 34563 71963

This document has been prepared in accordance with CFA Archaeology Ltd standard operating procedures.

**Extension to 2 Grannus Mews,  
Inveresk,  
East Lothian**

**Archaeological Watching Brief**

**Report No. 1783**

## CONTENTS

1.	Introduction	3
2.	Methodology	4
3.	Archaeological Results	4
4.	Conclusion	5
5.	References	6

## Appendices

1.	Context Register	7
2.	Photograph Register	7
3.	Drawings Register	8
4.	Finds Quantification	8
5.	Discovery and Excavation in Scotland Entry	9

## Illustrations (bound at rear)

Fig. 1 Location map and plan of the extension with the archaeological remains superimposed

Fig. 2 General view of the extension area from the east

Fig. 3 West facing section through pit **009**

Fig. 4 General view of the west facing section of the extension

## **1. INTRODUCTION**

### **1.1 General**

- 1.1.1 This report presents the results of an archaeological watching brief undertaken by CFA Archaeology Ltd (CFA) at 2 Grannus Mews, Inveresk Village, East Lothian (NGR: NT 34563 71963 centred, Fig. 1). The work was conducted under the terms of Historic Scotland Scheduled Monument Consent (SMC) Ref: AMH/3293/1/1 and was commissioned by Mr Fred Lawson via The Pollock Hammond Partnership.
- 1.1.2 A Written Scheme of Investigation (WSI) dated 06 January 2010 was produced by CFA on behalf of the client. The WSI was designed to meet the requirements of Historic Scotland and fulfil the terms of the SMC.
- 1.1.3 The current project involved the demolition of an existing conservatory and the excavation of deposits contained within the footprint of an extension to be built against the southern wall of the house.

### **1.2 Background**

- 1.2.1 The extension lies within the extensive environs of a civilian settlement associated with the Roman fort at Inveresk, which was occupied in the mid 2<sup>nd</sup> century AD. It falls wholly within the Scheduled Monument (SM) of Inveresk, Roman Civil Settlement West of Inveresk Gate (SM no. 3293). Several excavations in the vicinity have examined the settlement, revealing complex stratified remains, most notably the excavations at Inveresk Gate in 1976-77 (Thomas 1988) and 2000 (Goeder 2000).
- 1.2.2 A watching brief was conducted at 2 Grannus Mews in 2003 (Suddaby 2003) during the construction of a conservatory against the western wall of the house. That work led to the recovery of eleven sherds of Black Burnished Ware, a Roman coarseware pottery.

### **1.3 Objectives**

- 1.3.1 The objectives of the project were:
- To monitor the removal of topsoil or other layers within the footprint of the development. This aims to ensure that all archaeological features contained within it are identified and recorded to Historic Scotland standards.

## **2. METHODOLOGY**

- 2.1 CFA Archaeology Ltd follows the Institute for Archaeologists' (IfA) Code of Conduct, Standards and Guidance for Archaeological Watching Briefs. The terms of the SMC were adhered to.
- 2.2 The groundbreaking work comprised two elements; the removal of the existing conservatory and the excavation of deposits within the footprint of the extension (Figs. 1-2).
- 2.3 During the watching brief, the removal of topsoil and other layers was undertaken by machine, with all exposed surfaces being subsequently cleaned by hand. All ensuing excavation and on-site recording was carried out according to standard CFA procedures, principally by drawing, by photography and by completing standard CFA record forms.

## **3. ARCHAEOLOGICAL RESULTS**

### **3.1 General**

- 3.1.1 Numbers in bold and parentheses below refer to contexts, a full list of which is contained in Appendix 1. The finds from the excavation are assessed by Sue Anderson in Section 3.3 and quantified in Appendix 4. Other site records form Appendices 2 and 3. An entry to be included in Discovery & Excavation in Scotland 2010 forms Appendix 5.
- 3.1.2 The site of the extension lies within a small garden to the south of the existing house. Beyond, the land drops rapidly to the south towards the River Esk.

### **3.2 Watching Brief**

- 3.2.1 The foundations of the existing conservatory (**000**) were exposed and cut up on site to allow their removal. A small portion of these is visible prior to their removal in Figs. 2 and 4.
- 3.2.2 The footprint of the extension measured 8.5m east-west by 5m north-south (Figs. 1-2). The ground breaking works removed overburden and garden soil deposits and natural subsoil up to a depth of 1m. Large quantities of modern pottery, glass, brick, tile, plastic and metalwork within these deposits were not retained.
- 3.2.3 Overburden within the footprint of the new development comprised of soil and gravel layers associated with construction and landscaping works at 2 Grannus Mews. These overlay earlier garden soils. Once excavated, natural subsoil (**008**) was recorded in plan to the north, with garden soils pre-dating (**004**) and post-dating (**003**) the existing house to the south (Fig. 1).
- 3.2.4 A single sub-rectangular pit feature (**009**) measuring 1.2m by 0.6m was recorded in the base of the trench, cutting natural subsoil (**008**, Fig. 3). This

contained a yellow-brown silty sand soil (010) which had been affected by faunal and floral intrusions. A cow phalanx was recovered and small pieces of coal were contained in fill (010). The feature had been cut by surface water drains (011) and its relationship with the soil layer (004) in the base of the trench had been lost.

- 3.2.5 The west-facing section of the development footprint (Fig. 4) showed that soil layer 004 was cut (014) by a possible feature measuring at least 2.2m north-south and with a depth of 0.5m. This was filled by a compact dark-brown silty sand which contained flecks of coal and lumps of black silt (015). Possible feature 014 had been both horizontally and vertically truncated (005) by the foundations and landscaping works associated with the existing house.

### **3.3 Finds (Sue Anderson)**

- 3.3.1 Five sherds of pottery were recovered as unstratified finds. There were two sherds (48g) of Throsk-type ware (Scottish post-medieval reduced ware) with external green glaze, probably from jugs of 15th-18th-century date. A large redware base (73g) with brown glaze on both surfaces was 18th/19th-century in date. There were also two fine redware sherds (23g), a rim and a body, which appear superficially similar to Roman samian ware, but the glossy surfaces and lathe-turned bodies are more typical of 18th/19th-century red stoneware.
- 3.3.2 Two fragments of animal bone (13g), including a complete cattle phalanx, were collected from pit fill 010, in association with two fragments of coal (5g).

## **4. CONCLUSIONS**

- 4.1 A watching brief was carried out during groundbreaking work for the construction of an extension at 2 Grannus Mews, Inveresk.
- 4.2 The watching brief recorded the excavation of the extension footprint which removed overburden and garden soil deposits and natural subsoil up to a depth of 1m. Two possible features were recorded, both containing redeposited and bioturbated fills similar to the garden soils, and are of uncertain date.
- 4.3 No archaeological evidence was found for Roman occupation on the site or other activity associated with Inveresk Roman Fort during this watching brief, and no features or deposits of archaeological significance were discovered.
- 4.4 The project archive, comprising all CFA record sheets, maps and reports, will be deposited with Historic Scotland, the National Monuments Record of Scotland (NMRS) and copies of reports will be lodged with the East Lothian Council Sites and Monuments Record.
- 4.5 A summary statement to be submitted for publication in *Discovery and Excavation in Scotland* 2010 (Appendix 5) will be sufficient to disseminate the results of this watching brief.

## 5. REFERENCES

Gooder, J 2000 'Plot 16, Inveresk Gate, Inveresk', *Discovery and Excavation in Scotland 2000*, 26.

Thomas, G 1988 'Excavations at the Roman civil settlement at Inveresk, 1976-77', *Proceedings of the Society of Antiquaries of Scotland*, 118, 139-176.

Suddaby, I 2003 *2 Grannus Mews, Inveresk Village, Musselburgh, East Lothian. Archaeological Watching Brief. Data Structure Report No. 797*, CFA Archaeology Ltd.

## APPENDIX 1: Context Register

Context No.	Description
000	Brick and concrete foundation of the existing conservatory
001	Turf and topsoil
002	Modern grey imported gravel
003	Compact brown soil. Mixed finds
004	Soft dark yellow-brown sandy silt
005	Cut for the existing house
006	Compact brown soil. Mixed finds
007	Structure of the existing house
008	Natural subsoil. Yellow-orange iron-mottled sandy silt
009	Cut for sub-rectangular pit cut by 011
010	Firm orange-brown silty sand
011	Collective cut for the modern surface water drains
012	Modern imported gravel and mixed soils within 011
013	Fill of cut 005, loose soil and modern building rubbish
014	Irregular cut into 004, 008 containing 015
015	Soil. Dark brown compact silty sand with coal & flecks of redeposited subsoil
016	General context for unstratified finds

## APPENDIX 2: Photographic Register

Digi No	SLR No.	Contexts/description	Taken from	Conditions
1		Extension site pre-ex	East	Overcast
2-3		Extension site pre-ex	South-west	Overcast
4-5		Extension site after work 1 <sup>st</sup> June	South-west	Overcast
6		Extension site after work 1 <sup>st</sup> June	East	Overcast
7-15	1-14	Extension site part excavated after work 2 <sup>nd</sup> June. NE & N facing sections 001-6	NE & N	Bright/shade
16	15-16	General view of N facing section	West	Bright/shade
17	17-18	General view of NE facing section	East	Bright/shade
18	19-20	Pit 009 with fill 010 pre-ex	West	Sunny
19-20	21-22	Pit 009 west facing section	West	Sunny
21		Pit 009 general view	North	Sunny
22	23-24	Extension site fully excavated 3 <sup>rd</sup> June, west-facing section	West	Sunny
23-25	25-28	West-facing section, close up from N to S	West	Sunny
26-27	29-30	Close-up views of the centre of the section 014-5		Sunny
28-29		As digital 22		Sun/shade
30-31	31-32	General views of the extension area from the garden of the adjacent house to the east	East	Sun/shade



### APPENDIX 3: Drawings Register

Drawing No	Sheet	Scale	Description
1	1	1:20	General site plan
2	2	1:20	East and North-East facing sections 001-6
3	2	1:20	West facing section 001-5, 013-5
4	2	1:10	West facing section through pit 009 with fill 010 and drain 011-2

### APPENDIX 4: Finds Quantification

Ctxt	Find type	No	Wt (g)	Notes	Spot-date
U/S	Pot	2	48	Scottish post-med reduced green-glazed body sherds = 2 jugs	15-18
		1	73	Redware base, brown glazed	18-19
		2	23	Red stoneware rim and body	18-19
010	Bone	2	13	Cow phalange & frag	pmed?
	Coal	2	5	1 burnt	

## APPENDIX 5: Discovery and Excavation in Scotland Entry

<b>LOCAL AUTHORITY:</b>	East Lothian
<b>PROJECT TITLE/SITE NAME:</b>	Extension to 2 Grannus Mews, Inveresk, East Lothian
<b>PROJECT CODE:</b>	INCO2
<b>PARISH:</b>	Inveresk
<b>NAME OF CONTRIBUTOR:</b>	Ian Suddaby
<b>NAME OF ORGANISATION:</b>	CFA Archaeology Ltd
<b>TYPE(S) OF PROJECT:</b>	Watching Brief
<b>NMRS NO(S):</b>	SM No. 3293
<b>SITE/MONUMENT TYPE(S):</b>	N/A
<b>SIGNIFICANT FINDS:</b>	None
<b>NGR (2 letters, 10 figures)</b>	NT 3456 7196
<b>START DATE (this season)</b>	June 2010
<b>END DATE (this season)</b>	June 2010
<b>PREVIOUS WORK (incl. DES ref.)</b>	DES 2003, 59
<b>MAIN (NARRATIVE) DESCRIPTION:</b> (May include information from other fields)	<p>A watching brief was carried out by CFA Archaeology during groundbreaking work for the construction of a new extension to an existing dwelling house at 2 Grannus Mews, Inveresk. The site lies within the Scheduled Monument of Inveresk, Roman Civilian Settlement W of Inveresk Gate (SM No. 3293).</p> <p>The watching brief monitored the excavation of deposits from within the area of the extension. These consisted of garden soil deposits up to 1m deep and natural subsoil. A single pit containing a post-abandonment fill was recorded in the base of the trench. The garden soils contained numerous finds including sherds of late/post-medieval ceramics.</p>
<b>PROPOSED FUTURE WORK:</b>	None
<b>CAPTION(S) FOR ILLUSTRS:</b>	N/A
<b>SPONSOR OR FUNDING BODY:</b>	Fred Lawson via The Pollock Hammond Partnership
<b>ADDRESS OF MAIN CONTRIBUTOR:</b>	The Old Engine House, Eskmills Park, Musselburgh, EH21 7PQ
<b>EMAIL ADDRESS:</b>	isuddaby@cfa-archaeology.co.uk
<b>ARCHIVE LOCATION (intended/deposited)</b>	National Monuments Record of Scotland East Lothian Council Sites and Monuments Record

Key:

- footprint of new extension
- limit of excavated area

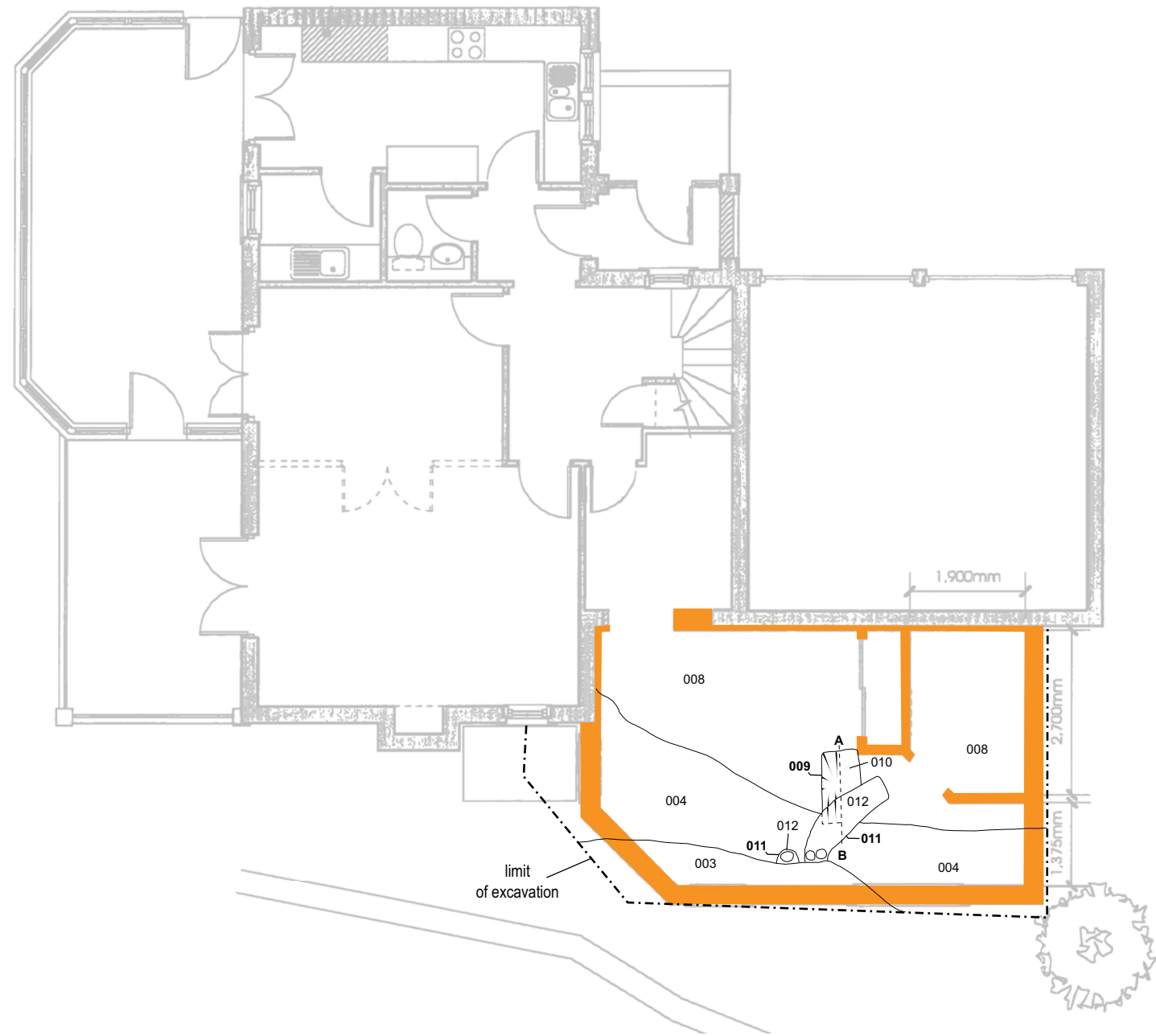
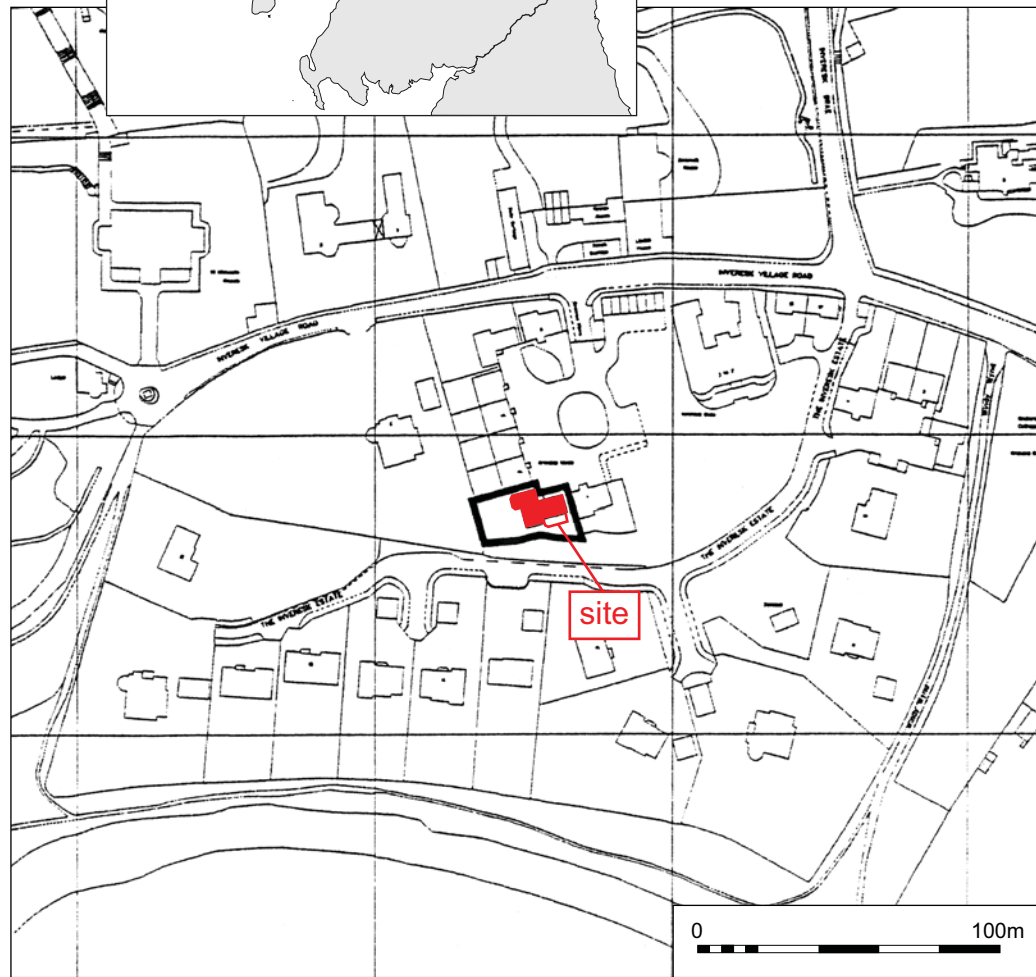
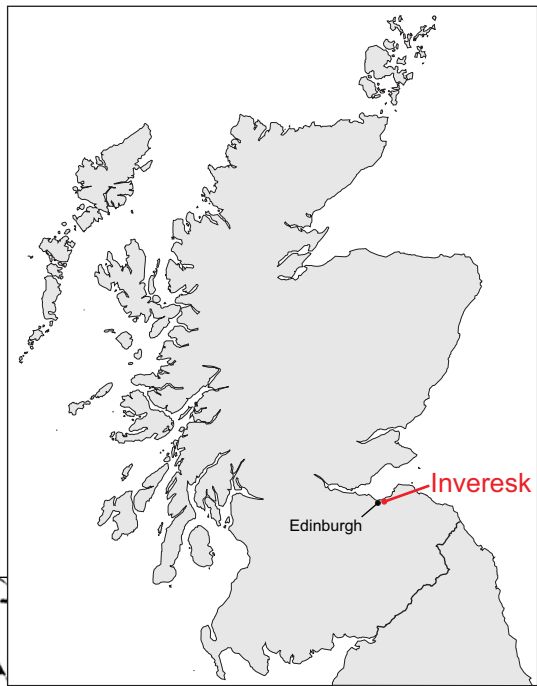

Fig. No: **1** Revision: **A**

Title:  
**Location map and plan of the extension with the archaeological remains superimposed**

Project:  
**Extension to 2 Grannus Mews, Inveresk, East Lothian**

Scale:  
**1:12,500 @ A3**

Client:  
**Mr Fred Lawson**



Key:

Fig. No: 2

Revision:

Client:

Mr Fred Lawson

Title:

General view of the extension area from the east

Project:

Extension to 2 Grannus Mews, Inveresk, East Lothian

Scale:



CFA ARCHAEOLOGY LTD  
The Old Engine House  
Eskmills Park  
Musselburgh  
East Lothian, EH21 7PQ  
t: 0131 273 4380  
f: 0131 273 4381  
e: info@cfa-archaeology.co.uk  
w: www.cfa-archaeology.co.uk

Drawn by: GC

Page No:

Report No: 1783

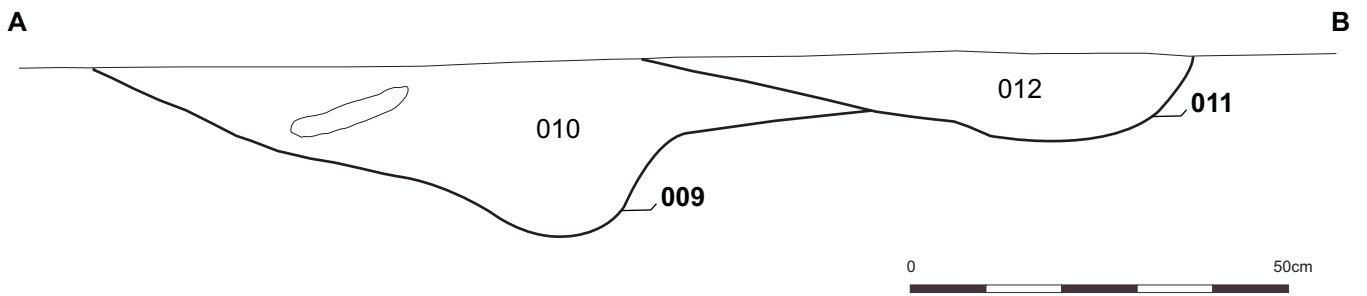

Key:

Fig. No: **3**

Revision:

Client: **Mr Fred Lawson**

Title: **West facing section through pit 009**

Project: **Extension to 2 Grannus Mews,  
Inveresk, East Lothian**



**CFA ARCHAEOLOGY LTD**  
The Old Engine House  
Eskmills Park  
Musselburgh  
East Lothian, EH21 7PQ  
t: 0131 273 4380  
f: 0131 273 4381  
e: info@cfa-archaeology.co.uk  
w: www.cfa-archaeology.co.uk

Scale: **1:10@A4**

Drawn by: **GC**

Page No:

Report No: **1783**



Key:

Fig. No: **4**      Revision:      Client: **Mr Fred Lawson**

Title: **General view of the west facing section of the extension**

Project: **Extension to 2 Grannus Mews, Inveresk, East Lothian**

Scale:



**CFA ARCHAEOLOGY LTD**  
 The Old Engine House  
 Eskmills Park  
 Musselburgh  
 East Lothian, EH21 7PQ  
 t: 0131 273 4380  
 f: 0131 273 4381  
 e: info@cfa-archaeology.co.uk  
 w: www.cfa-archaeology.co.uk

Drawn by: **GC**

Page No:

Report No: **1783**