

Digital Chapter 9 : The Pottery

Part 6 : The coarse pottery : catalogues of the groups

A. T. Croom, R. M. McBride, and P. T. Bidwell

(file name : Ch9DCoarseGroups)

Contents

Outer Ditch	D9.245
Inner Ditch	D9.247
Northern <i>vicus</i>	D9.249
Villa	D9.253
Pottery of Interest	D9.253

Figures

Fig. 9.69	Coarse pottery of interest	D9.25
-----------	----------------------------	-------

For ease of reference Figs. 0.29-38 from the letterpress volume are reproduced here

Part 6: The coarse wares: catalogues of selected groups

A. T. Croom, R. M. McBride, and P. T. Bidwell

These are the catalogue entries for the groups illustrated and discussed in Chapter 9 of the letterpress volume.

CAM = *Camulodunum* series, see Hawkes and Hull, 1947.

OUTER DITCH

Lowest ditch fills

The coarse ware suggests a late third century date.

Layer 871 (YJ), lowest fill (fig. 9.29)

1. CRA RE. 1193
2. DOR BB 1. 1194
3. DOR BB 1. 1195
4. Unidentified reduced ware. Approximately 50% of the rim survives, with seven strap handles. This vessel is the same as nos 583-4 in the type series. 1196
5. Mortarium. 1197

See the type series for a Central Gaulish black-slipped beaker (no. 66) and gritty grey cooking pot (no. 334).

Filling of ditch before building of vicus building 2

The re-catalogued coarse ware suggests an early fourth-century date, with some intrusive late fourth-century material (see nos 62-8).

Layer 551 (XD) (fig. 9.29)

6. CRA RE. 1169
7. CG. 1171
8. CG. 1172
9. Gritty grey ware. 1173
10. Gritty grey ware. 1174
11. Hard, gritty grey fabric with almost white core. 1175
12. Mortarium. 1176
13. Mortarium. 1177
14. Mortarium. 1178

Layer 538 (TB), the filling of the ditch before the building of Vicus Building 2 (fig. 9.29-30)

15. CRA RE. 1127
16. CRA RE. 1128
17. CRA RE. 1130

18. CRA RE. 1131
19. CRA RE. 1132
20. CRA RE. 1133
21. CRA RE. 1134
22. CRA RE. 1135
23. CG. 1143
24. CG. 1144
25. CG. 1145
26. CG. 1146
27. CG. 1147
38. CG. 1148
29. CG. 1150
30. CG. 1151
31. Gritty grey ware. 1152
32. Gritty grey ware. 1153
33. Unidentified reduced ware. 1154
34. Unidentified reduced ware. 1155
35. DAL SH. 1156
36. OXF RS? 1157
37. Unidentified reduced ware. 1158
38. Mortarium. 1159
39. Mortarium. 1160
40. Mortarium. 1161
41. Mortarium. 1162

Later features and fillings within ditch

The re-catalogued coarse ware provides a late fourth-century, or later, date.

Layer 539 (TG) in upper filling of ditch (fig. 9.30)

42. CRA PA. 1163
43. CG. 1164
44. CG. 1165
45. Light grey, fine, sandy fabric with matt, dark grey surface. 1166
46. Gritty grey ware. 1167
47. Unidentified reduced ware. 1168

See the type series for a Huntcliff-type calcite-gritted cooking pot (536).

Layer 557 (XH) in upper filling of ditch (fig. 9.30)

48. CRA RE. 1179
49. CRA RE. 1180
50. Grey fabric with darker surfaces and large black inclusions. 1181
51. Highly fired brown fabric with occasional large opaque white inclusion. 1182
52. Mid-grey fabric with darker surfaces, and small black and red inclusions. 1183
53. CRA red. 1184
54. CRA red. 1185

- 55. Gritty grey ware, with sparkling grit. 1186
- 56. Unidentified reduced ware. 1187
- 57. Mortarium. 1188

Layer 848 (VF) in upper filling of ditch (fig. 9.31)

- 58. CRA RE. 1189
- 59. CRA RE. 1190
- 60. Gritty grey ware. 1191
- 61. Gritty grey ware. 1192

There was also a sherd of a North African red-slipped vessel from 816 (RF), in a dark red fabric with abundant sub-rounded sand and occasional ferrous, lime and yellow inclusions. The sherd had been re-used, with the rim and one edge at right-angles worn very smooth. Probably from a lid, as Hayes 1972, type 22.

Latest pottery from the area

Pottery probably from topsoil and similar, but found in layer 538 (TB) (fig. 9.31)

- 62. CRA RE. 1129
- 63. CRA red. 1139
- 64. CRA PA. 1136
- 65. CRA PA. 1137
- 66. CRA PA. 1138
- 67. CRA red. 1141
- 68. CRA red. 1142

INNER DITCH

Original ditch fills (selected layers 14, 19, 423, 430) (fig. 9.31-2)

The re-catalogued pottery indicates a late fourth-century, or later, date.

Layer 14

- 69 - 76. CRA RE. 1001 – 1008.
- 77 – 79. CRA PA. 1009 -1011.
- 80. CRA red. 1012
- 81. CRA red. 1013
- 82. Mortarium. 1014
- 83 – 91. CG. 1015 – 1023
- 92 – 94. NVCC. 1024-1026
- 95. Dense black fabric with heavily burnished surface. 1027
- 96. Gritty grey ware. 1028
- 97. Mid-grey fabric with traces of burnishing on surface. 1029
- 98. Hard, gritty grey fabric. 1030
- 99. Light grey fabric with burnished exterior surface. 1031
- 100. Mortarium. 1032
- 101. Mortarium. 1033

See the type series for a Nene Valley beaker (271), Dales ware cooking pots (301, 303), gritty grey ware cooking pot (314), Crambeck parchment and red ware bowls (475, 481, 508), calcite-gritted ware cooking pot and wide-mouthed bowl (537, 547) and a Throlam storage jar (579).

Layer 19 (fig. 9.32-3)

102 – 106. CRA RE. 1034 – 1038

107. CRA PA. 1039

108. CG. 1040

109. CG. 1041

110. Shell gritted. 1042

111. Shell gritted. 1043

112. Gritty grey ware. 1044

113. Norton.

114. Handmade, light grey fabric. 1046

Layer 423 (WN) (fig. 9.33)

115. CG. 1067.

116. Hard gritty fabric with pimply surface, with occasional calcite inclusions. 1068

117. Hard light grey fabric with darker surfaces. 1069

118. Hard mid-grey fabric. 1070.

See the type series for a BB1 dish (205), gritty grey cooking pot (313) and Crambeck grey ware bowl and dish (400, 421).

Layer 430 (WF) (fig. 9.33)

119 – 122. CRA RE. 1071 – 1074

123. CG. 1075

124. CG. 1076

125. Dense black fabric, with heavily burnished surface. 1077

Fill of recut ditch

The re-catalogued Roman pottery is late fourth century to fifth century in date.

Layer 409 (TW) (fig. 9.33-4)

126. CG. 1062

127. CG. 1063

128. CRA red. 1064

129. Unusual example with wavy line on exterior. CRA RE. 1065.

130. Mortarium. 1066.

See the type series for a grey gritty cooking pot (310), Crambeck red bowl (504) and calcite-gritted cooking pot and bowl (515, 545).

NORTHERN VICUS

Vicus building (site TF73)

Phase 1

The samian and other finds indicate a date in the very late first century or early second century.

See type series for a flagon (1, context Q13 24) and rusticated jars (18, context Q13 24) and possibly also no. 17 (context Q13 12 & 24).

Phase 2

The samian and other finds indicate a date from c.120 to the end of the second century.

Layer R13 19 (fig. 9.34)

- 131 168. DOR BB 1. 1257
- 132 169. DOR BB 1. 1258
- 133 170. Grey fabric with darker grey surface. 1259
- 134 171. Hard, sandy grey fabric with slightly burnished surface. 1260
- 135 172. Brownish-grey fabric with darker grey surface. 1261
- 136 173. Mortarium. 1262

See the type series for a BB1 cooking pot (79), and a reeded-rimmed bowl (30, context Q13 17).

Phase 3

The samian suggests a start date of after c. 200 for this phase, and the latest coins date to the 270s.

Phase 3A

The illustrated pottery includes apparently residual material that could be Hadrianic and very little later pottery. The later material consist of two probably third-century BB2 bowls (nos 196-7) in layer R14 9, and a Nene Valley funnel-necked beaker of the second half of the third century, a late third century Crambeck ware bowl and a fourth-century calcite-gritted ware rim in layer S12 3 (nos. 209, 212-3).

Layer Q12 7 (fig. 9.34)

- 137 174. Grey, sandy fabric with darker grey surface. 1236
- 138 175. Lead-grey fabric with smooth outer surface. 1470
- 139 176. Grey fabric with blue-grey core. Darker grey external surface. 1237
- 140 177. Hard, grey, burnished surface. Non-joining fragments have lattice decoration. 1238
- 141 178. Hard, mid-grey fabric with burnished surfaces. 1239
- 142 179. Orange-buff fabric with grey core. 1240
- 143 180. Light grey fabric with darker grey surface. Surface very flaky and worn. 1241

- 144 181. Hard, light grey fabric with slightly darker grey outer surface. 1242
- 145 182. Light grey fabric with darker grey surface. 1243
- 146 183. Hard, grey fabric with light grey around rim. Burnished outer surface. 1244
- 147 184. DOR BB 1. 1245
- 148 185. DOR BB 1. 1246

Layer R14 9 (fig. 3.34)

- 149 186. Sandy, mid-grey fabric. 1268
- 150 187. Sandy, mid-grey fabric. 1269
- 151 188. Mid-grey fabric. 1270
- 152 189. Grey fabric with smooth outer surface. 1271
- 153 190. Mid-grey, gritty fabric. 1272
- 154 191. Orange-brown fabric with burnished, black surface. 1273
- 155 192. Soft, orange fabric with grey surface and grey core. 1274
- 156 193. As above. 1275
- 157 194. Orange-brown fabric with burnished black surface. 1276
- 158 195. Sandy, grey fabric. 1277
- 159 196. BB2. 1278
- 160 197. BB2. 1279

Layer R14 7 (fig. 3.34)

- 161 198. Sandy, pinkish-brown fabric. 1263
- 162 199. Hard, grey gritty fabric. 1264
- 163 200. Light grey fabric with burnished surface. 1265
- 164 201. Hard, light grey fabric with burnished, blue-grey outer surface. 1266
- 165 202. Hard, sandy orange fabric. 1267

Layer S12 3 (fig. 3.34-5)

- 166. DOR BB1. 1280
- 167. DOR BB 1. 1281
- 168. DOR BB 1. 1282
- 169. DOR BB 1. 1283
- 170. Hard, grey fabric with slightly darker grey surface. 1284
- 171. Hard, sandy grey fabric with grey outer surface and grey core with layer of white beneath surface. 1285
- 172. NVCC. Yellowish fabric with brown metallic colour-coat. 1286
- 173. Light brown fabric with light grey surface. 1287
- 174. Grey fabric with darker grey surface. 1288
- 175. Surfaces burnt black. CRA RE. 1289
- 176. CG. 1290

See the type series for a BB1 cooking pot (99).

Phase 3B

The illustrated pottery includes some late third-century material, no fourth-century calcite-gritted ware, but a painted Crambeck parchment ware bowl and Corder and Birley 1937 type 1B bowl of late fourth-century date.

Layer R12 5 (fig. 9.35)

- 177. DOR BB 1. 1247
- 178. DOR BB 1. 1248
- 179. BB2. 1249
- 180. Hard, light grey fabric with darker grey surface. 1250
- 181. Hard, pinkish-orange fabric. 1251

See the type series for a BB1 flat-rimmed bowl (130).

Layer Q12 2 (fig. 9.35)

- 182. DOR BB 1. 1229
- 183. Hard, grey fabric, burnt black in patches. 1230
- 184. CRA RE. 1231
- 185. Hard grey fabric with smooth outer surface. Norton? 1232
- 186. CRA PA. 1233
- 187. Hard, blue-grey fabric. Norton? 1234
- 188. Mortarium. 1235

See the type series for a BB1 fish dish (220).

Layer R13 4 (fig. 9.35)

- 189. DOR BB 1. 1252
- 190. DOR BB 1. 1253
- 191. Gritty grey ware. 1254
- 192. Gritty grey ware. 1255
- 193. CRA RE. 1256

See the type series for BB1 cooking pots (109, 112) and dish (189), and a Nene Valley indented scale beaker (262).

‘Temple’

The illustrated pottery indicates a late third century date for layer 4. The later ditch remained open until the late fourth-century.

Layer 4 (fig. 9.36)

- 194. Sandy, orange-red fabric with grey exterior surface and black surface on rim. 1434
- 195. Sandy grey fabric with lightly burnished exterior surface. 1435
- 196. Sandy grey fabric with orange margin and darker grey surface. 1436
- 197. Hard grey fabric. 1437
- 198. HOR RE. 1438

- 199. Gritty grey ware. 1439
- 200. Gritty grey ware. 1440
- 201. Gritty grey ware. 1441
- 202. Gritty grey ware. 1442
- 203. Gritty grey ware. 1443
- 204-14. DOR BB 1. 1444 – 1454
- 215. CRA RE. 1555
- 216. CRA RE. 1556
- 217. Mortarium. 1457
- 218. Mortarium. 1458

Ditch cut through the building (117) (fig. 9.37)

- 219-21. DOR BB 1. 1198 - 1200
- 222. CRA RE. 1201
- 223. NVCC. 1202
- 224. Gritty grey ware. 1203
- 225. Gritty grey ware. 1204
- 226. Hard grey fabric with glittering grit inclusions. 1205
- 227. Hand-made, hard gritty grey fabric with large mixed grit, some glittering. 1206
- 228. Hand-made, hard gritty dark grey fabric. 1207.
- 229. White pipe-clay fabric. 1208
- 230. Hard grey fabric with burnished rim and interior surface. 1209
- 231. Northern Campanian amphora. 1210.
- 232. Mortarium. 1211

Vicus Building 2

The illustrated pottery suggests a fourth century date.

Layer 805A (RD) (fig. 9.38)

- 233. Dense black fabric with heavily burnished surfaces. 1212
- 234. Orange fabric. 1214
- 235. Hard, pinkish yellow fabric, perhaps over-fired. 1215
- 236. NVCC. 1216

Layer 855 (WU) (fig. 9.38)

- 237. CRA RE. 1217
- 238. CRA RE. 1218
- 239. CRA RE. 1219
- 240. CRA RE. 1220
- 241. CRA RE. 1221
- 242. CRA RE. 1222
- 243. CG. 1223
- 244. CG. 1224
- 245. CG. 1225
- 246. Grey gritty ware. 1226

247. Mortarium. 1227

248. Mortarium. 1228

VILLA

See type series for a rough-cast beaker (no. 9), a complete beaded rim BB1 cooking pot of unusually squat profile (no. 81), BB1 flat-rimmed bowls and dishes (nos 124-6, 182-3), a small Cologne hunt cup (no 246), bowls and dishes in unidentified grey wares (nos 643-4, 646-7) and an amphora stamp (Fig. D9.30 no. 7).

POTTERY OF INTEREST

288. Lower Tyne valley painted oxidised. Whole of body of vessel burnished below the level of handle. The upper wavy line is a thin, dark brown wash, while the incomplete lower wavy line is thicker and darker. NNC78 15(E). (Fig. D9.69).

289. Lower Tyne valley painted oxidised. Alternating white and brown painted stripes decoration. NNB75 16C. (Fig. D9.69).

290. SAV GT. HHI72, B43 3B. (Fig. D9.69).

291. Three body sherds and two 'cups' in a micaceous buff fabric. The exact form of the vessel is unclear, but it was a large wheel-thrown closed vessel. There are at least three close-set, large holes made pre-firing, with rough, unfinished edges, which have had an additional element luted round the opening which has now flaked off; two of the sherds also have a straight edge suggesting a pre-firing join. One small body sherd with a hole joining onto a 'cup' reveals that the 'cups' were attached to the vessel to cover the holes. The two 'cups' are both incomplete, but enough survives of one to suggest that these were likely to have been either totally closed or else had only a very small hole to one side. Both 'cups' are wheel-thrown, but have been shaped to have a hollow point on one side. Both show evidence of a partial cream slip, and there is a line of cream slip on the larger body sherd. There is also evidence of burning. The exact form or function of this vessel is unclear. A small jar from Norton had four holes mid-way down the body of the vessel, but these only had small ridges of clay above them rather than complete cups (Hayes and Whitley 1950, fig. 11, no. 11). Jars with a number of smaller vessels (covering holes) attached round their rim are a rare but long-lived type, but have open-ended cups (Symonds and Wade 1999, fig. 6.27, nos 793-4; *Cam* 390), although the Piercebridge vessel may be a related type. TF74 43C (*vicus* north of the river: Dere Street). (Fig. D9.69).

292. Base sherd from a segmented dish, with part of an inner wall, one radiating wall surviving to its full height and probably the base of a second radiating wall. Hard, mid-grey fabric with soft grey inclusions, some occasionally large (2mm). Slightly darker surfaces, burnished. An oxidized example is known from Colchester (Hull 1963, fig. 74, no. 3). HS 137 (berm, topsoil). (Fig. D9.69).

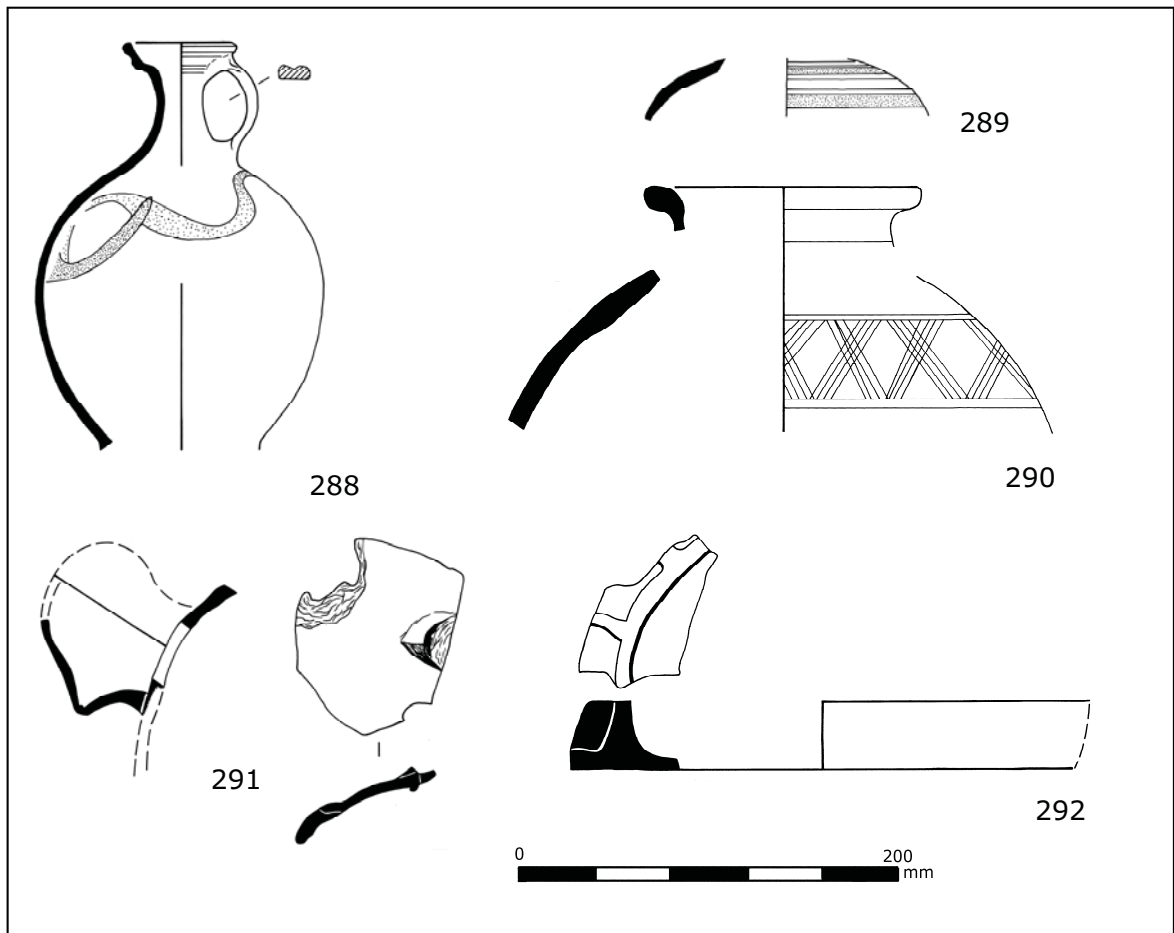

Fig. D9.69. Coarse pottery of interest. Scale 1:4

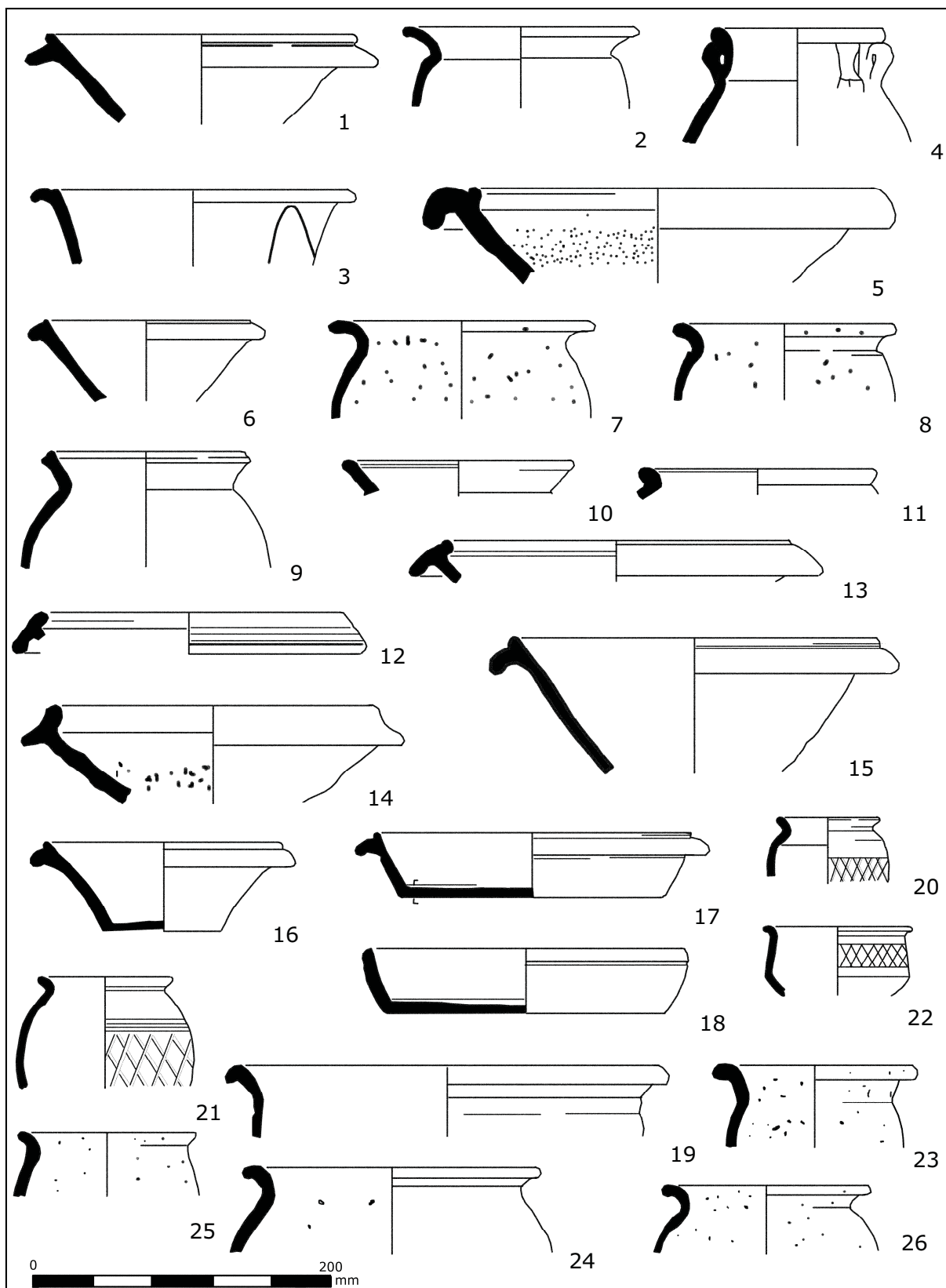

Fig. 9.29—from letterpress

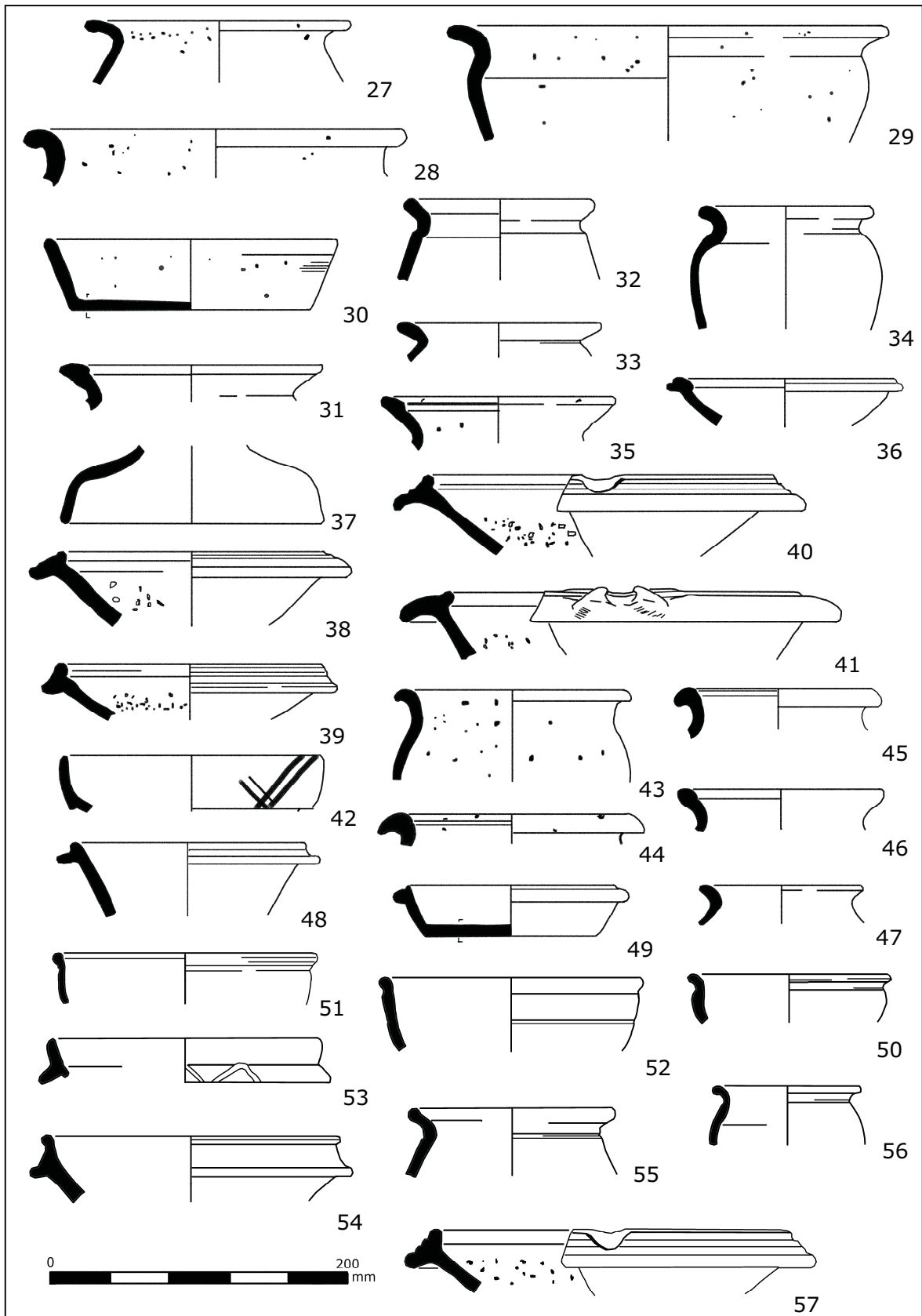

Fig. 9.30 — from letterpress.

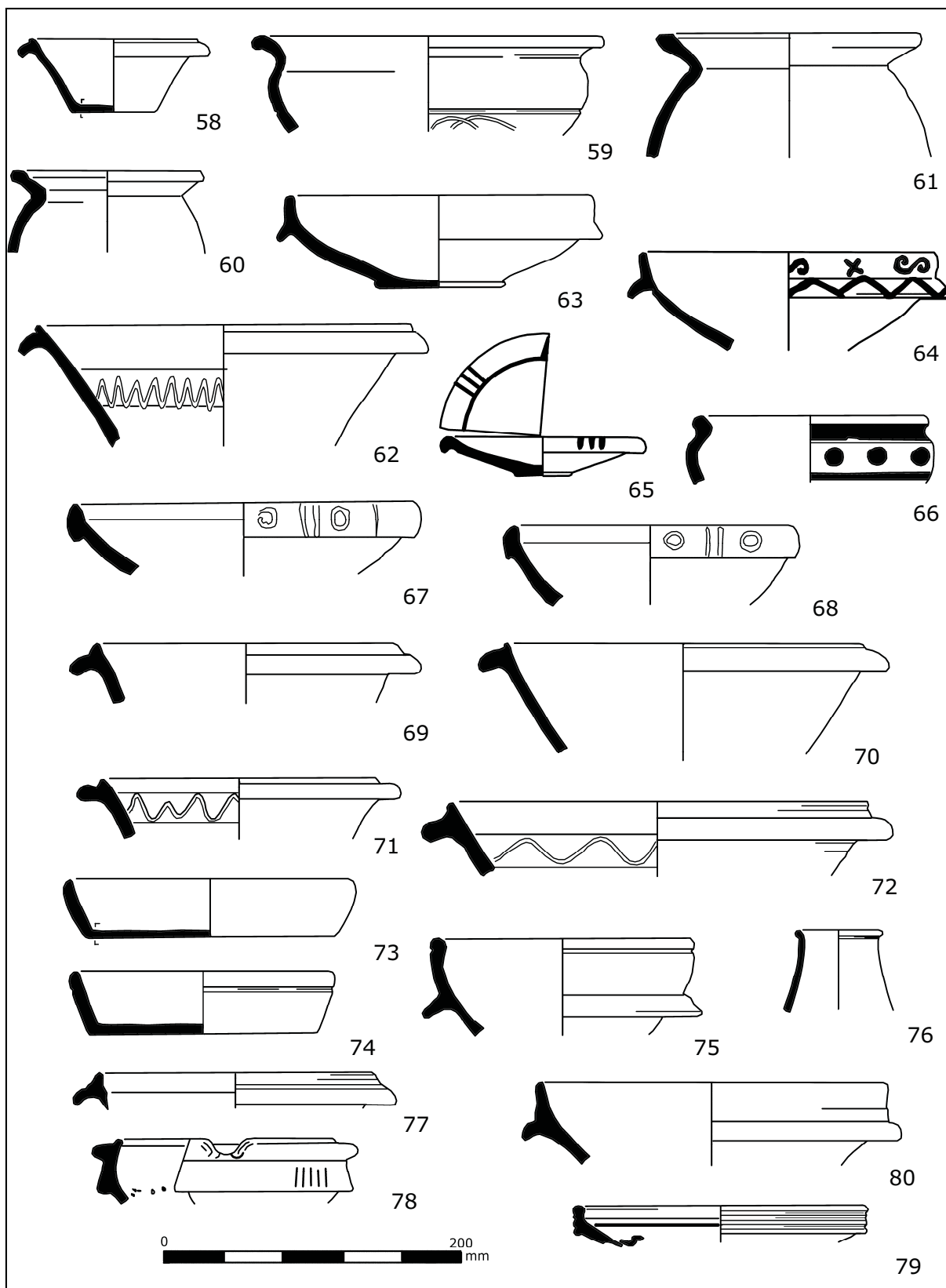

Fig. 9.31—from the letterpress

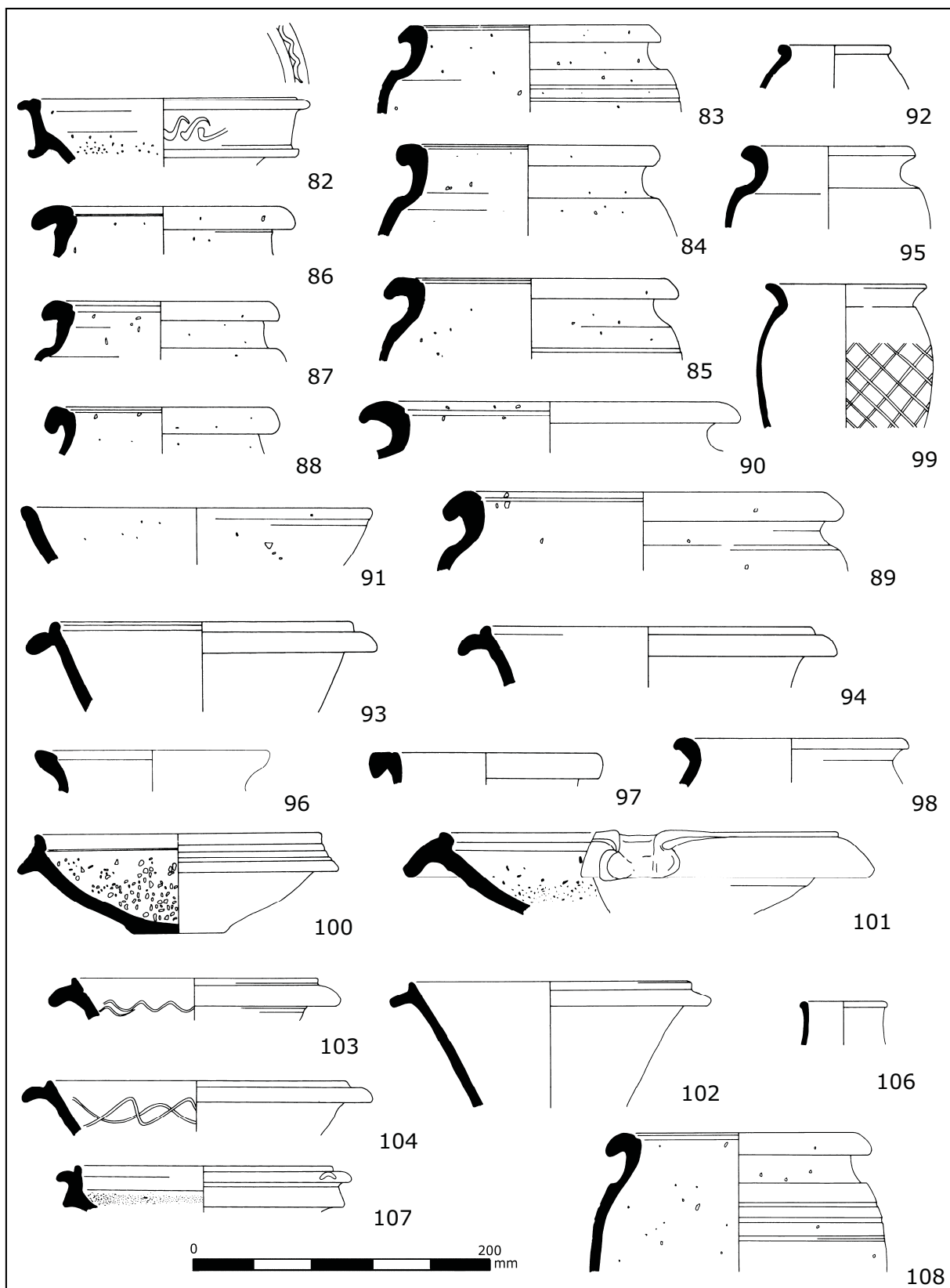

Fig. 9.32—from letterpress

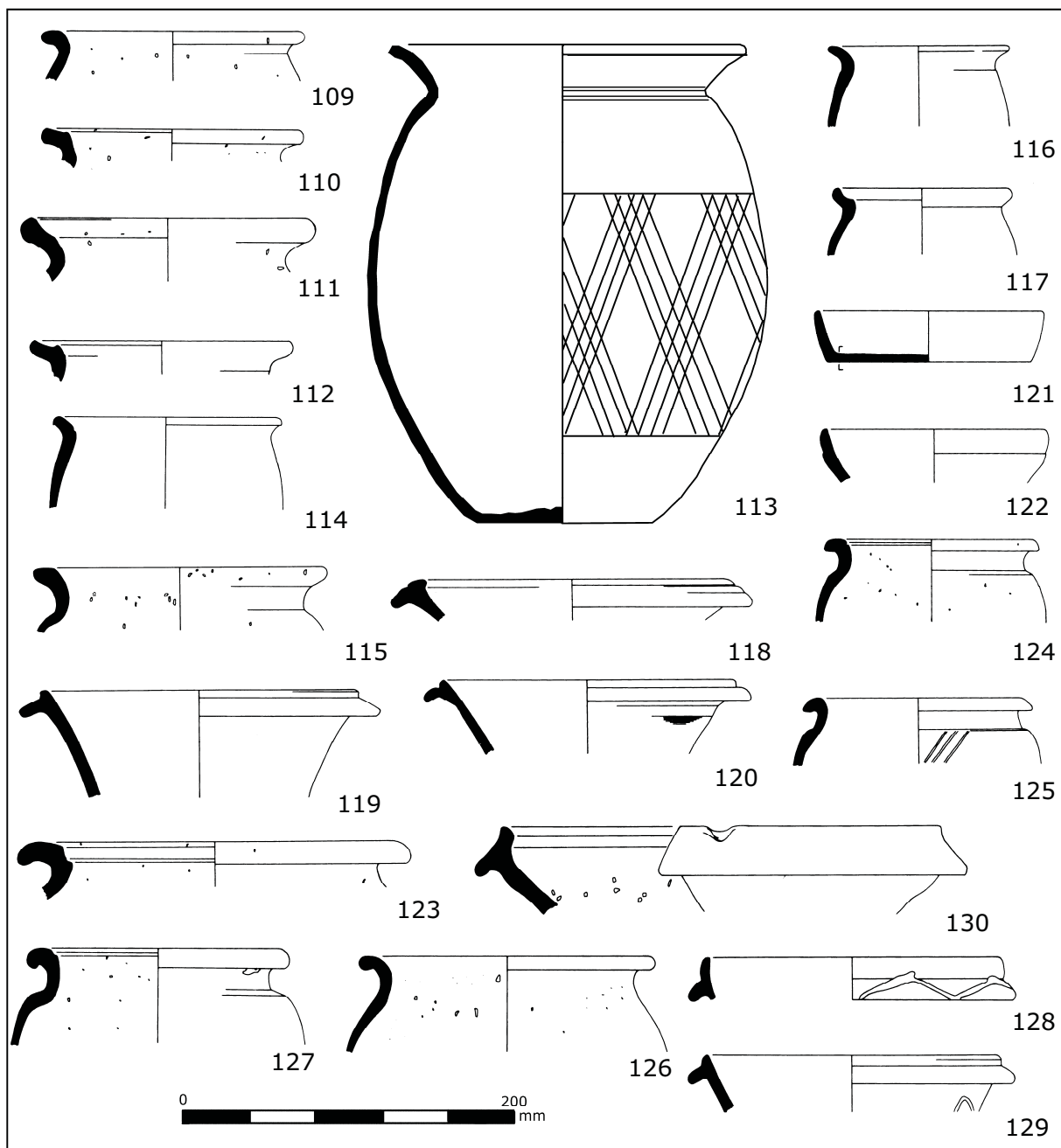

Fig. 9.33—from letterpress

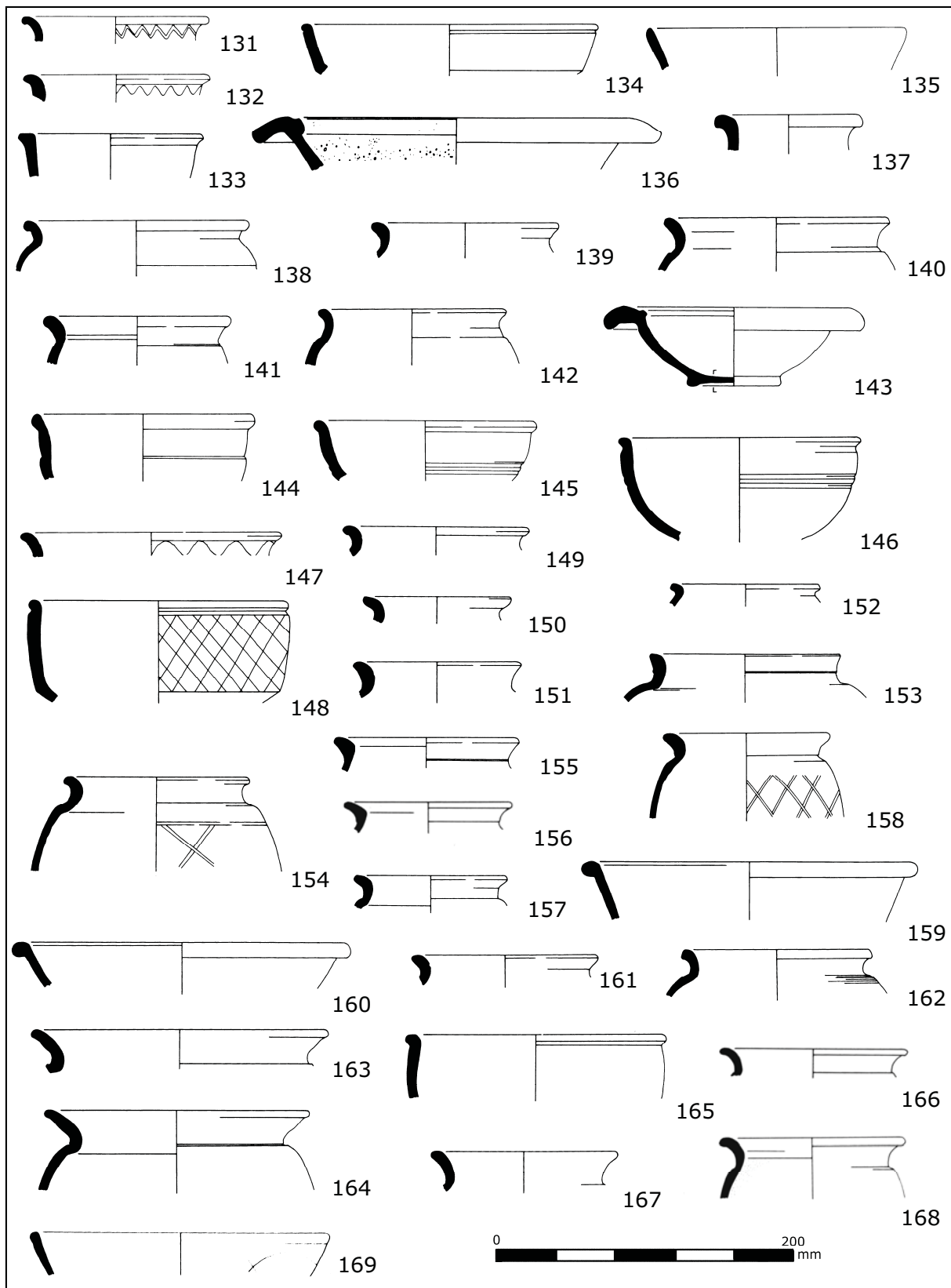

Fig. 9.34— from letterpress.

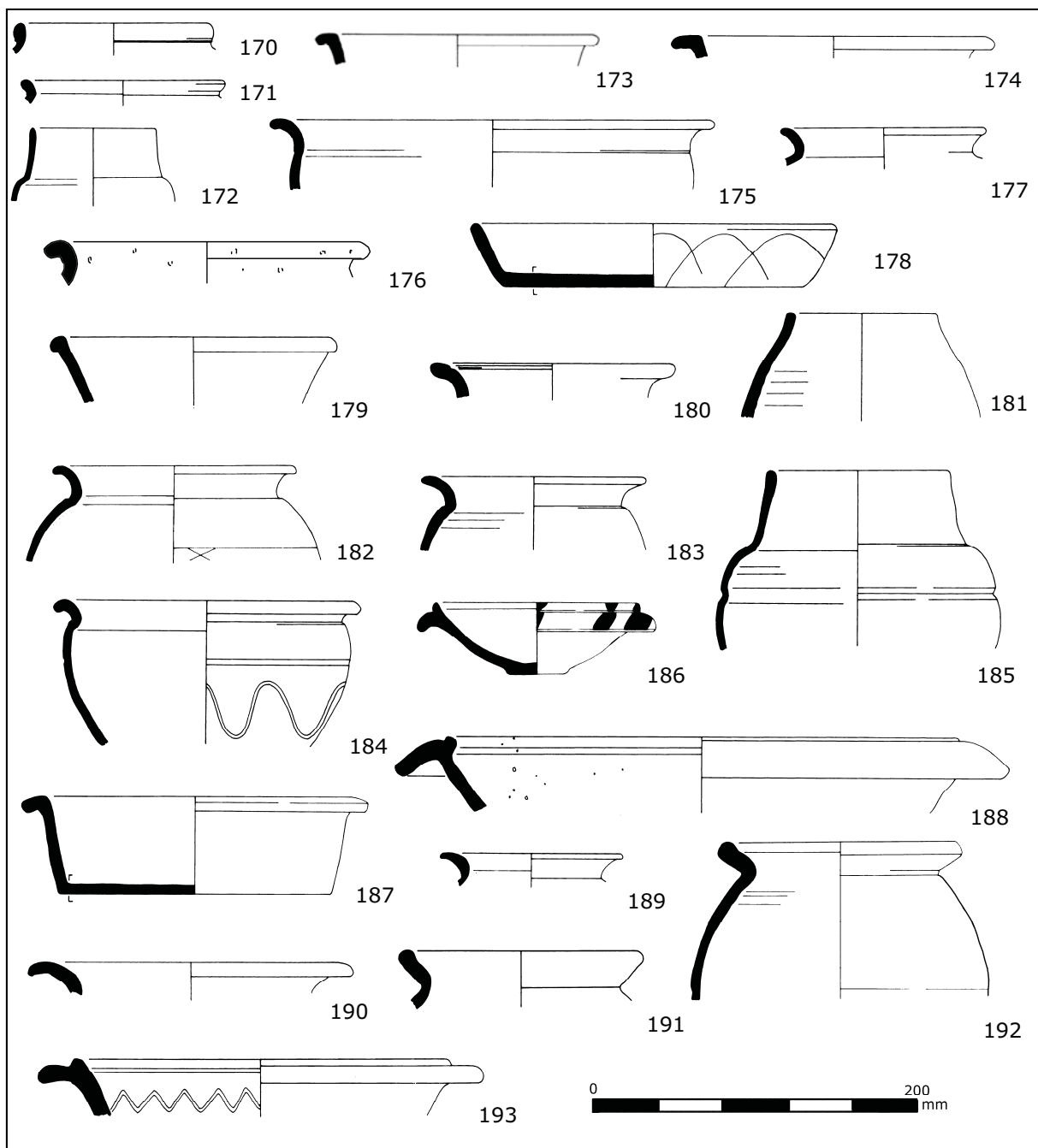

Fig. 9.35— from letterpress

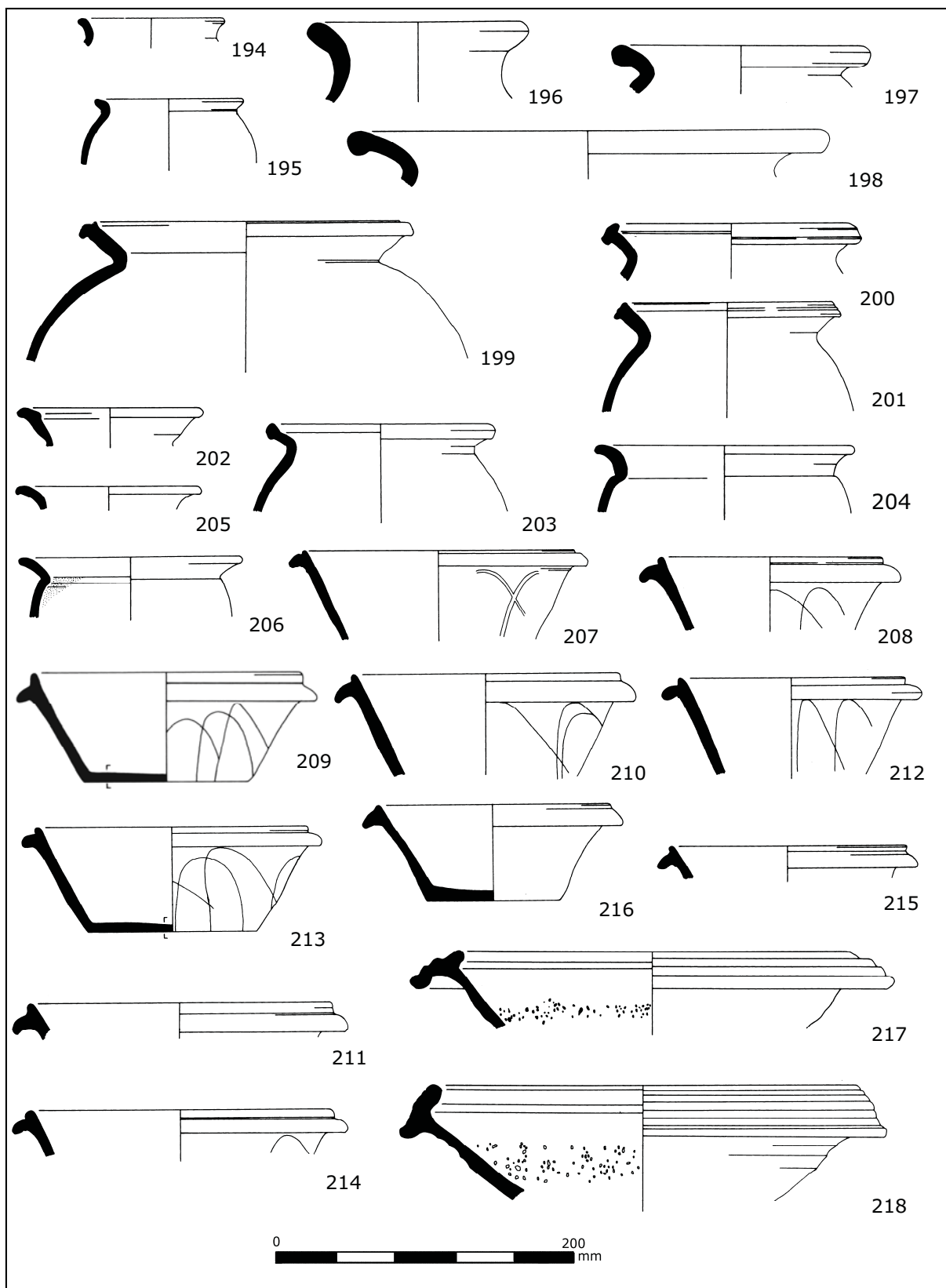

Fig. 9.36— from letterpress.

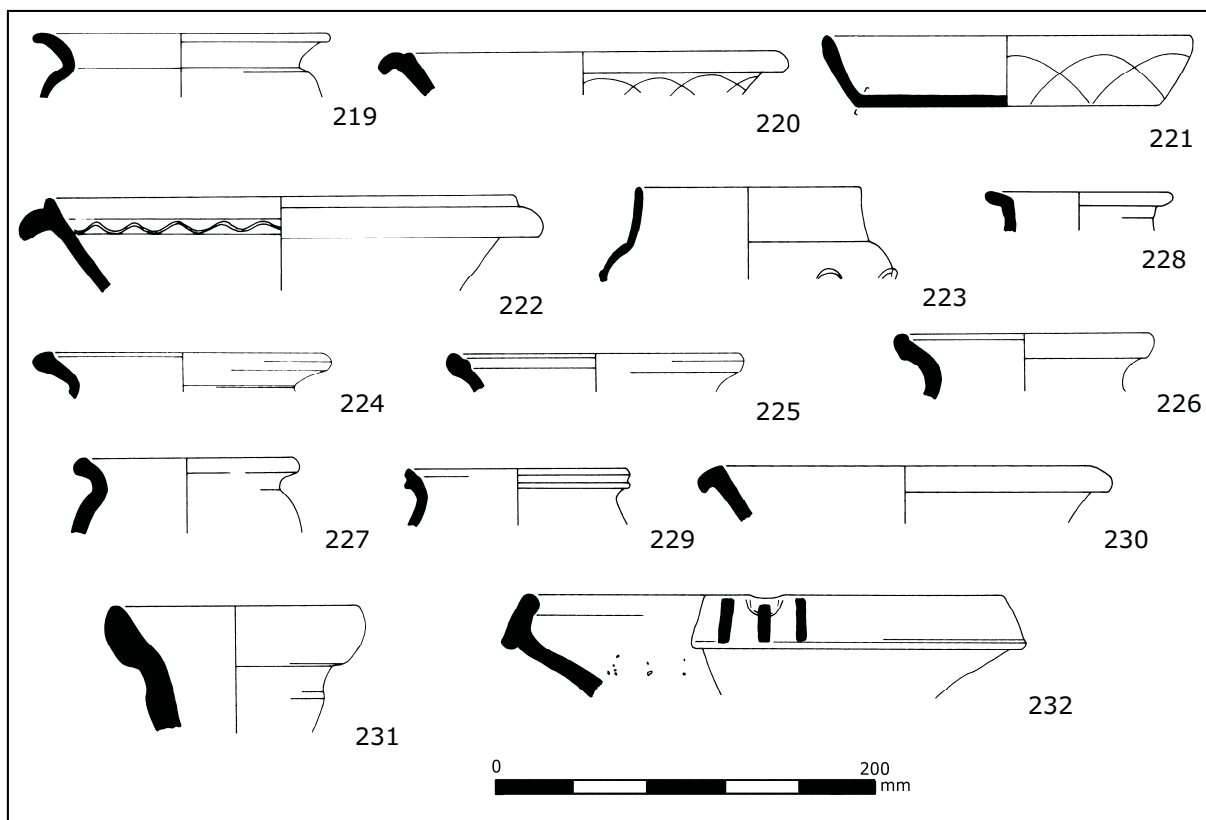

Fig. 9.37— from letterpress

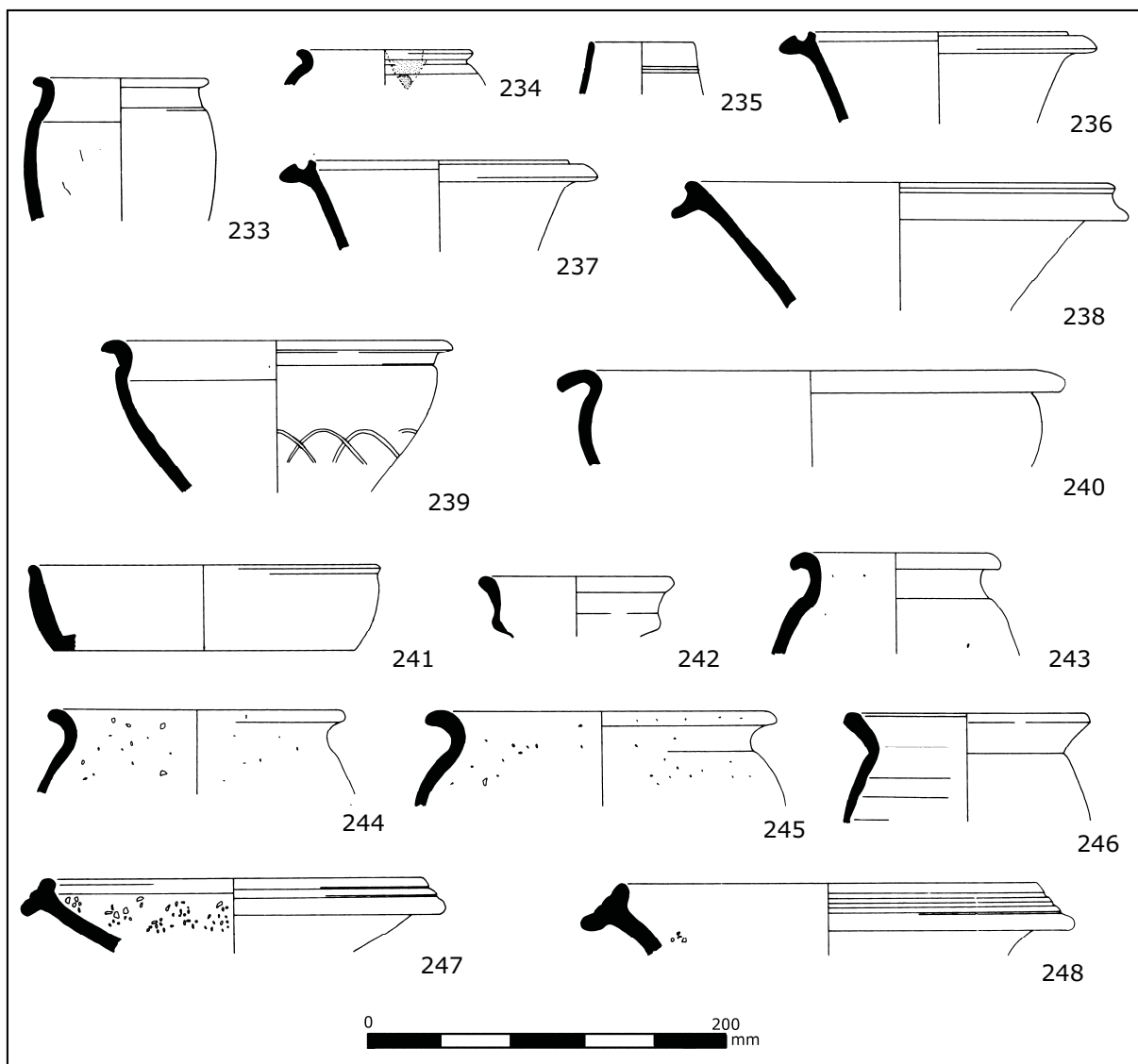

Fig. 9.38 from letterpress.