

No 3 Rectory Meadow, Fornham All Saints, Suffolk

Planning application: DC/22/0783/HH

HER Ref: FAS 085

Archaeological Monitoring Report

(Continuous observation of ground works)

(© John Newman BA MCIFA, 10 Fitzgerald Road, Bramford, Ipswich, IP8 4AA)

(August 2022)

(Tel: 07754 501033 Email: johnnewman2@btinternet.com)

Site details for HER

Name: No 3 Rectory Meadow, Fornham All Saints, IP28 6JR

Client: Mr R Beaton

Local planning authority: West Suffolk DC

Planning application ref: DC/22/0783/HH

Development: Erection of rear and small front extension

Date of fieldwork: 27 July, 2022

HER Ref: FAS 085

Grid ref: TL 8396 6748

OASIS ref: johnnewm1-508298

Contents

Summary

1. Introduction & background
2. Monitoring methodology
3. Results
4. Conclusion

Fig. 1 Site location

Fig. 2 Monitored development areas

List of appendices

Appendix I- Images of foundations works

Appendix II- Written scheme for monitoring of works

Appendix III- OASIS data collection form

Summary: Fornham All Saints, 3 Rectory Meadow (FAS 085 TL 8396 6748) monitoring of groundworks for a rear and a small front extension in an area close to a prehistoric cursus and near to a complex of cropmarks which are of uncertain date and which forms a Scheduled Monument did not reveal any archaeological features and the only stray finds were of recent date (John Newman Archaeological Services for Mr R Beaton).

1. Introduction & background

1.1 Mr R Beaton commissioned John Newman Archaeological Services (JNAS) to undertake the archaeological monitoring of ground works required under a condition for a programme of archaeological works of the planning decision notice for application DC/22/0783/HH. The monitoring requirements were set out following planning advice and a Brief issued by Dr H Cutler of the Suffolk CC Archaeological Service (SCCAS) to satisfy this condition and JNAS produced the relevant written scheme (Appendix II) to gain the conditional discharge allowing works to start on site. This development concerns the erection of a rear and a small front extension at 3 Rectory Meadow, Fornham All Saints (see Fig. 1).

1.2 Located to the north of Bury St Edmunds and on the southern side of the River Lark Fornham All Saints has a compact settlement pattern centred around the parish church and with quite extensive residential development since the 1960s with Rectory Meadow forming one of these developments. At the time of the monitoring the larger rear extension area had been superficially cleared to allow the foundation trenches to be excavated while the small front porch extension area was partly under lawn and partly under an existing concrete slab.

1.3 The British Geological Survey describes the site as being on Croxton sand and gravel at c28m OD.

1.4 Archaeological interest in this site was generated by its location close over part of a cursus of prehistoric (HER FAS 004), a c1.90km and c40m wide enclosure of Neolithic date of national importance that extends from Hengrave to the north-west and under the village towards its south-eastern end. In addition nearby to this site on the western side of Pigeon Lane a complex of cropmarks (HER FAS 005, 012, 013 & 015) are recorded on aerial photographs. These cropmarks are of uncertain date but are likely to have a major prehistoric element and they form a scheduled monument again therefore recognised as being of national importance (SM 1006018). The relevant SCCAS brief confirming that the planned small-scale works could best be monitored by an archaeologist as they were excavated.

2. Monitoring methodology

2.1 Once some hard patio type surface had been removed the foundation trenches were monitored in a single visit and they were entered to clean indistinct areas. The upcast spoil was examined visually and the overall project was photographed as the works continued (see Appendix I).

3. Results

3.1 The foundation trenches for the rear extension (see Fig. 2) were 700mm wide and 900mm deep with 400mm of topsoil where they extended into the garden over 400mm to 500mm of mid brown sandy subsoil and below this clean orange sand

with flints. No archaeological features were revealed and the few stray finds were small brick and tile fragments of recent date.

3.2 To the front of the house a foundation trench was excavated where soft ground made this feasible, this was 600mm wide and 800mm deep with a similar deposit profile to the rear extension area; no archaeological features or finds were revealed.

4. Conclusion

4.1 While this site is close to areas with evidence for important and significant archaeological features recorded on aerial photographs the groundworks for the extensions were on a small scale so little ground was disturbed. In conclusion it can be confirmed that no deposits or finds of archaeological significance have been disturbed by this development at 3 Rectory Meadow, Fornham All Saints.

(Acknowledgements: JNAS is grateful to Rob Beaton and everyone on site for their close cooperation with regard to this site monitoring).

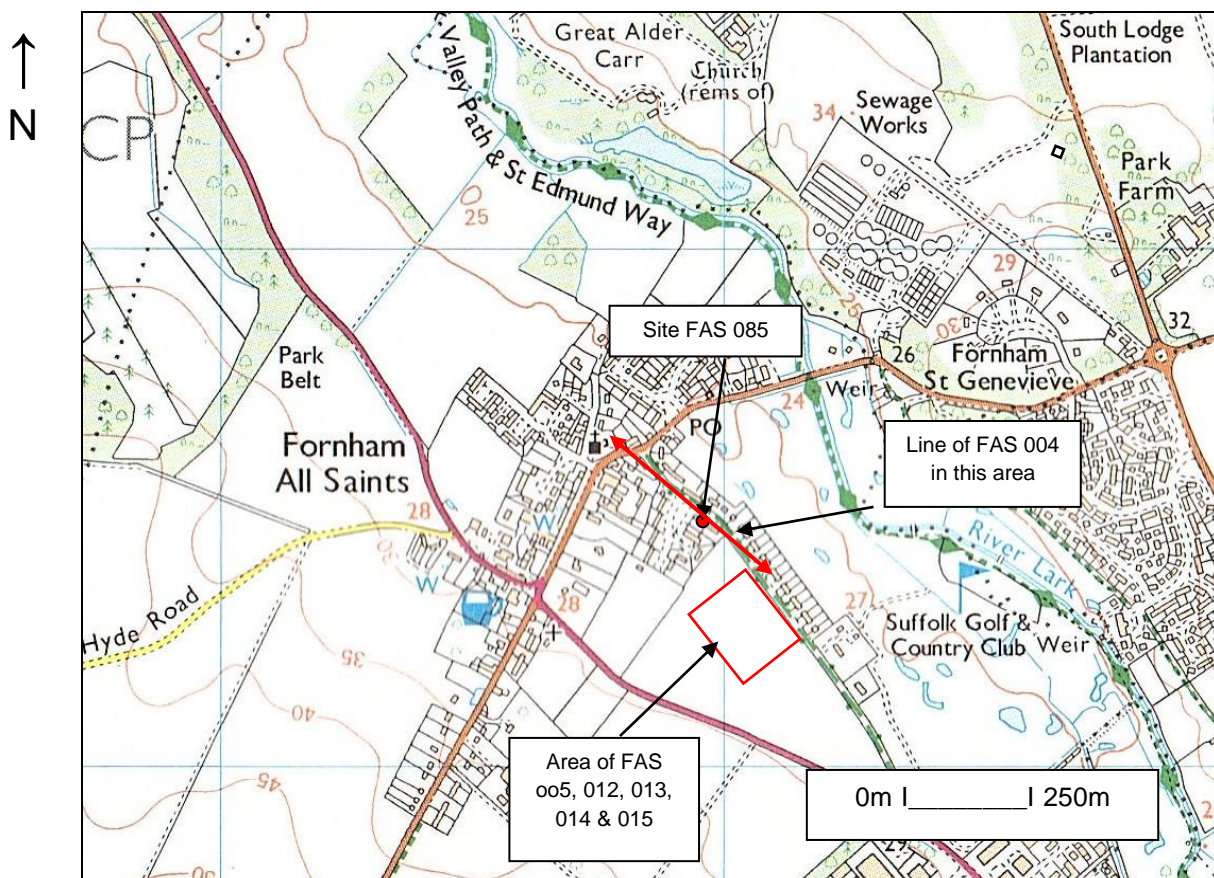

Fig. 1: Site location (Ordnance Survey © Crown copyright 2006
All rights reserved Licence No 100049722)

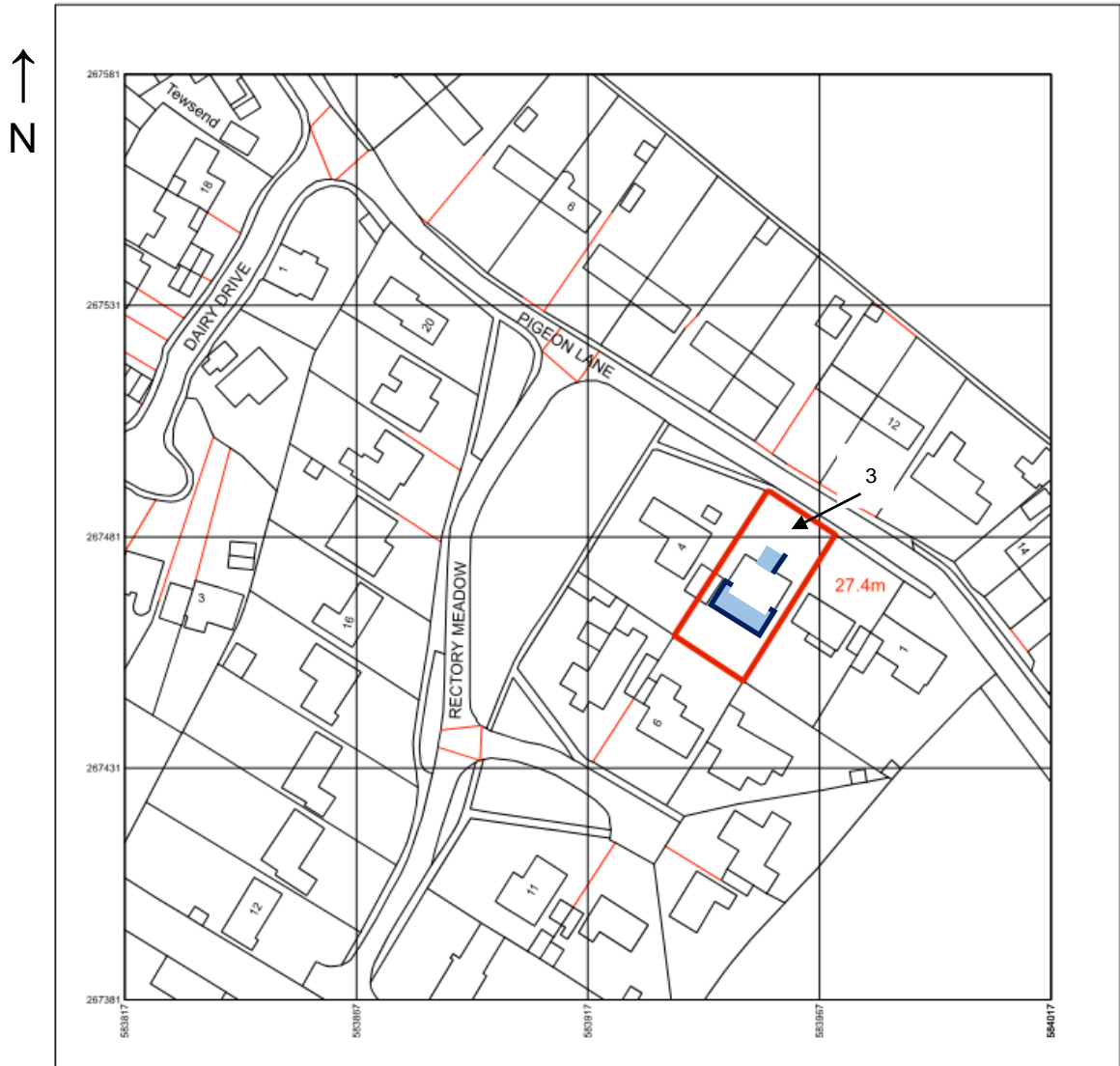

Fig. 2: Location of extension areas

(Ordnance Survey © Crown copyright 2022 All rights reserved Licence No 100049722)

Appendix I- Images



General view of rear of house



Eastern trench for rear extension



Southern rear extension trench from west



Southern trench deposit profile



Western rear extension trench



Trench for small front porch extension

**No 3 Rectory Road, Fornham All Saints,
Suffolk**

Planning application: DC/22/0783/HH

**Written Scheme of Investigation for
Continuous Archaeological Monitoring**

(© John Newman BA MCIFA, 10 Fitzgerald Road, Bramford, Ipswich, IP8 4AA)

(Tel: 07754 501033 Email: johnnewman2@btinternet.com)

Site details

Name: No 3 Rectory Road, Fornham All Saints, Suffolk, IP28 6JR

Client: Mr R Beaton

Local planning authority: West Suffolk DC

Planning application ref: DC/22/0783/HH

Proposed development: Erection or rear extension and small front extension

Brief ref: SCCAS Monitor.pdf (Brief for continuous monitoring and recording)

Proposed date for ground works: 25/7/2022

HER ref: Within area of Fornham cursus (HER FAS 004) in part a scheduled monument, also near cropmarks (HER FAS 005, 012, 013, 014 & 015)

Grid ref: TL 839 674

Conservation area

HER ref: tbc

OASIS: johnnewm1-508298

Contents

1. Introduction
2. Location, Topography & Geology
3. Archaeological & Historical Background
4. Aims of the Site Monitoring
5. Methodology
6. Risk Assessment
7. Specialists

John Newman Archaeological Services

1. Introduction

1.1 Mr R Beaton has commissioned John Newman Archaeological Services (JNAS) to undertake the archaeological monitoring of ground works required under a condition for a programme of archaeological works for the planning decision notice issued for application DC/22,0783/HH. This written scheme of investigation (WSI) details the background to the archaeological condition and how JNAS implemented the requirements set in a Brief from Dr H Cutler of the Suffolk CC Archaeological Service (SCCAS) to satisfy the condition. In this case retrospectively as the site monitoring was carried out on Monday, 25 July, 2022. The WSI also sets out how potential risks will be mitigated. This proposed development concerns the erection of a rear extension and a small front porch type extension at 3 Rectory Meadow, Fornham All Saints.

1.2 The monitoring was carried out to the standards set regionally in the *Standards for Field Archaeology in the East of England (EAA Occ. Papers 14, 2003)* and nationally in *Standards and Guidance for Archaeological Watching Briefs (Chartered Institute for Archaeologists 1994, revised 2001 & reissued 2014)*.

2. Location, Topography & Geology

2.1 Located to the north of Bury St Edmunds and on the southern side of the River Lark Fornham All Saints has a compact settlement pattern centred around the parish church and with quite extensive residential development since the 1960s with Rectory Meadow forming one of these developments. At the time of the monitoring the larger rear extension area had been superficially cleared to allow the foundation trenches to be excavated while the small front extension area was partly under lawn and partly under an existing concrete surface.

2.2 The British Geological Survey describes the PDS as being on Croxton sand and gravel at c28m OD.

3. Archaeological & Historical Background

3.1 Archaeological interest in this small-scale development was generated by its location within the line of the Fornham cursus (HER FAS 004), a c 1.90km and c40m wide enclosure of Neolithic date and of national importance that extends from Hengrave to the north-west and through the village. The Suffolk Heritage Explorer (<http://heritage.suffolk.gov.uk>, accessed 25 July, 2022) indicates that the northern side of this originally ditched and banked enclosure of likely ritual/religious use runs under or close to Pigeon Lane to the north of Rectory Meadow putting this site within the monument. However the same source also notes that archaeological examination of the Rectory Meadow area in 1969 when it was being developed did not recover any evidence for past use. In addition Rectory Meadow is close to recorded cropmarks (HER FAS 005, 012, 013, 014 & 015) indicative of past activity which form part of a scheduled monument (SM 1006018).

3.2 The archaeological advice then confirmed that while this development may reveal deposits of archaeological significance this potential disturbance to local heritage assets can be mitigated by their investigation and recording as the ground works progress through a programme of continuous monitoring by an archaeologist with subsequent full reporting as the ground works are undertaken.

4. Aims of the Site Monitoring

4.1 As outlined in section 3 above the planned extension areas are within an area where evidence of prehistoric activity in particular might be revealed. This monitoring will aim to record all possible details relating to the depth of overburden and evidence, character and date of any past activity that is revealed with the primary aim of gaining more information relating to past activity of prehistoric date as the site lies within the area recognised as a cursus of Neolithic date.

5. Methodology

5.1 The erection of the planned extensions were closely monitored as soon as site works commenced with trench fill foundations using a medium sized 360 machine with any other significant ground works also to be monitored. Time was available to investigate any possible archaeological deposits and scan the upcast spoil with a metal detector. The ground works were undertaken under dry weather conditions with the upcast spoil stored to the front of the house where it could be further examined. To inform the reporting on any positive archaeological results from the monitoring a search will be commissioned from the County HER in consultation with SCCAS for the area within 500m of this site.

5.2 Site records were made under a continuous and unique numbering system of archaeological contexts under a HER numbers to be supplied by Suffolk CC. All contexts will be numbered and finds recorded by context. Conventions compatible with the county HER were used throughout the monitoring. Site plans as necessary would be drawn at 1:20 or 1:50 as appropriate and sections at 1:10 or 1:20 (all on plastic drawing film) and related to OS map cover with the monitored areas shown. Sections will be levelled to a datum OD. A photographic record of high resolution digital images will be made of the site and exposed features (using a Lumix DMC-FZ5 camera).

5.3 As necessary and to define archaeological deposits exposed sections/surfaces were trowelled/shovel clean before recording. Any potential archaeological deposits were fully hand investigated and recorded within the constraints of the relevant trenched ground works. Even if no archaeological deposits are revealed every effort will be made to gain a record of the natural occurring deposits and overburden that could help in the understanding of the general history of land use and topography in the area. Where appropriate palaeoenvironmental samples (40 litres if possible) were to be taken for processing and assessment by a specialist conversant with

John Newman Archaeological Services

regional archaeological standards and research agendas if relevant archaeological deposits are revealed. If human burial evidence is revealed the SCC Archaeological Officer will be informed and a Ministry of Justice licence obtained before excavation, recording and removal of the remains. The possibility of modifying the ground work design to leave any such remains in situ will also be examined (the potential of this site to contain burials is assessed as being low).

5.4 All finds will be collected and processed unless any variation is agreed with the relevant SCC Archaeological Officer. Finds will be assessed by recognised period specialists and their interpretation will form an integral part of the overall report. Finds will be stored according to ICON guidelines with specialist advice/treatment sought for fragile ones. Every effort will be made to gain the deposit of the site finds to the SCC Archaeological Store under their relevant HER code and site numbering for future reference. If this is not possible then the SCC Archaeological Officer will be consulted over any requirements for additional recording. Any discard policy will be discussed and agreed with the relevant Archaeological Officer at Suffolk CC.

5.5 An archive of all records and finds will be prepared consistent with the principles in *MoRPHE* and this will be deposited with the Suffolk CC HER within 4 months of working finishing on site under the relevant HER number. As necessary the site digital archive will be deposited with the Archaeology Data Service (ADS) within the agreed allowance for the monitoring and reporting works.

5.6 The monitoring report will be consistent with the principles of *MoRPHE* and this report will summarise the methodology employed and relate the archaeological record directly to the level of visibility allowed by the operation of plant given the nature of the underlying natural deposits. The report will also give an objective account of the deposits and stratigraphy recorded and finds recovered with an inventory of the latter. Any interpretation of the monitoring results will be clearly separated from the objective account of the monitoring and its results. The report will give a clear statement regarding the results of the site monitoring in relation to both the more detailed aims in section 4 above and their significance in the context of the Regional Research Framework (EAA Occ. Papers 3, 8 & 24 1997, 2000 & 2011). A pdf version draft copy of the report will be presented to the Archaeological Service at Suffolk CC within 3 months of the completion of the site works. Once accepted a bound hard copy will be provided for the County HER, a pdf copy will also be sent to the client so they can gain discharge of the relevant condition. The project will be registered on the OASIS online archaeological record before site works start followed by submission of the final draft in .pdf format. A summary prepared of any positive results will be sent for the annual PSIAH round-up.

6. Risk Assessment

6.1 Protective clothing will be worn on site (hard hat, high visibility vest/coat, steel-toe cap boots & ear muffs if required). A safe working method will be agreed with the

John Newman Archaeological Services

contractors on site in order to maximise access to disturbed ground and up cast spoil while at the same time allowing efficient use of plant. Suitable clothing will be available to mitigate against extremes of weather.

6.2 Vehicles will be safely parked away from work areas and lines of access.

6.3 Before work on site starts any special requirements regarding potential site contamination will be discussed with the client and any ground test reports examined. Gloves and hand wash/wipes be available and any information on possible ground contamination will be passed to finds and environmental specialists. The potential for services in the area will be discussed with the client and their contractor.

6.4 A fully charged mobile phone will be carried and a first aid kit will be taken to site.

6.5 Deep holes/trenches will only be entered if assessed to be safe and after consultation with the contractor on site, they will not be entered if no-one else is in the vicinity.

6.6 JNAS holds full insurance cover for archaeological site works from the specialist provider Tovergate Risk Solutions covering Public & Products Liability, details can be supplied on request.

7. Specialists

Conservation:	Conservation Services
Faunal remains:	J Curl (Sylvanus Archaeology)
Human remains:	S Anderson (Freelance)
Metal detector search	James Armes
Palaeoenvironmental samples:	V Fryer (Freelance)
Pre-historic flint:	S Bates (Freelance)
Pre-historic pottery:	S Percival (Freelance)
Post Roman ceramics & CBM:	S Anderson (Freelance)
Roman period ceramics	Colchester Archaeological Trust
Roman period small finds	N Crummy
Post Roman small finds:	JNAS

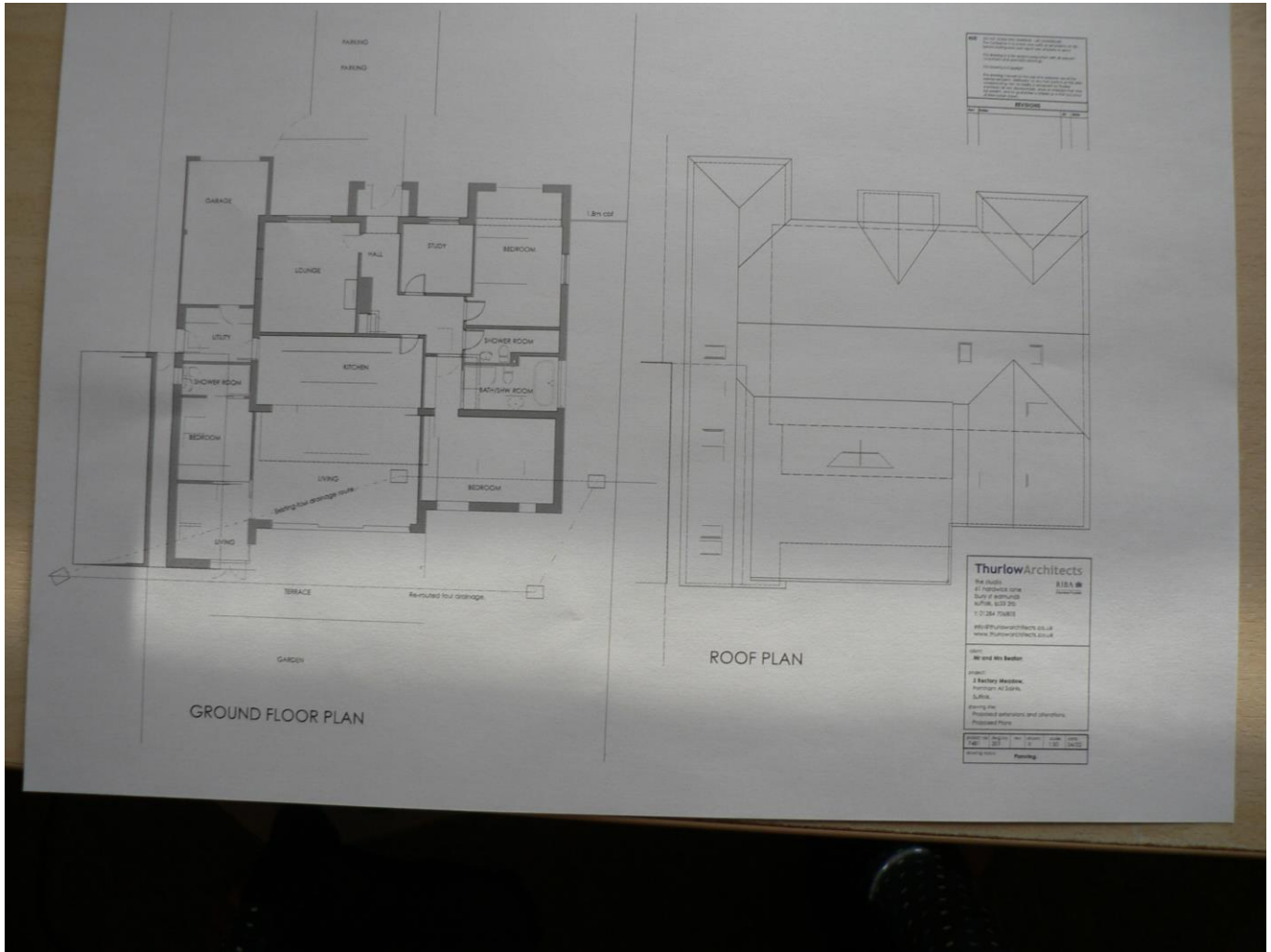

Proposed extension areas

Summary for johnnewm1-508298

OASIS ID (UID)	johnnewm1-508298
Project Name	Monitoring at No 3 Rectory Meadow Fornham All Saints
Sitename	No 3 Rectory Meadow Fornham All Saints
Activity type	Watching Brief
Project Identifier(s)	FAS 085
Planning Id	DC/22/0783/HH
Reason For Investigation	Planning: Post determination
Organisation Responsible for work	John Newman Archaeological Services
Project Dates	25-Jul-2022 - 25-Jul-2022
Location	No 3 Rectory Meadow Fornham All Saints NGR : TL 83900 67400 LL : 52.2739877407915, 0.694018554895189 12 Fig : 583900,267400
Administrative Areas	Country : England County : Suffolk District : West Suffolk Parish : Fornham All Saints
Project Methodology	Watching brief
Project Results	Fornham All Saints, 3 Rectory Meadow (FAS 085 TL 8396 6748) monitoring of groundworks for a rear and a small front extension in an area close to a prehistoric cursus and near to a complex of cropmarks which are of uncertain date and which forms a Scheduled Monument did not reveal any archaeological features and the only stray finds were of recent date.
Keywords	
Funder	
HER	Suffolk HER - unRev - STANDARD
Person Responsible for work	John, Newman
HER Identifiers	
Archives	