

**No 88 Hardwick Lane, Bury St Edmunds,  
Suffolk**

**Planning application: SE/09/0282**

**HER Ref: BSE 445**

**Interim Monitoring Report on front extension**

(© John Newman BA MIFA, 2 Pearsons Place, Henley, Ipswich, IP6 0RA)

(May 2014)

(Tel: 01473 832896 Email: [johnnewman2@btinternet.com](mailto:johnnewman2@btinternet.com) )

**Site details for HER**

Name: No 88 Hardwick Lane, Bury St Edmunds, Suffolk, IP33 2RA

Client: Mr A Bond & Mrs J Smith

Local planning authority: St Edmundsbury B C

Planning application ref: SE/09/0282

Development: Erection of front & side extensions

Date of fieldwork: 29 April, 2014 (front extension)

HER ref: BSE 445

OASIS ref: johnnewm1-177817

Grid ref: TL 8526 6293

**Contents**

Summary

HER summary sheet

Site location

Monitored front extension

Site image

*Summary: Bury St Edmunds, No 88 Hardwick Lane (BSE 445, TL 8526 6293)  
Monitoring of ground works for a small front extension were too shallow to reveal any level where archaeological deposits might be revealed (John Newman Archaeological Service for Mr A Bond & Mrs J Smith).*

# John Newman Archaeological Services

---

## SUMMARY SHEET

<b>Site name/Address:</b> No 88 Hardwick Lane, Bury St Edmunds	
<b>Planning application:</b> SE/09/0282	
<b>Parish:</b> Bury St Edmunds	<b>District:</b> St Edmundsbury BC
<b>NGR:</b> TL 8526 6293	<b>Site Code:</b> BSE 445 (OASIS johnnewm1-177817)
<b>Type of Work:</b> Watching brief on hand excavation of a raft foundation for a small (4m x 2m) front extension	<b>Site Director/Group:</b> John Newman Archaeological Services
<b>Date of Work:</b> 29 April, 2014	<b>Size of Area Investigated:</b> 8m <sup>2</sup> <b>Current land use:</b> Front garden & path
<b>Location of Finds/Curating Museum:</b> NA	<b>Funding source:</b> Mr A Bond & Mrs J Smith
<b>Further Seasons Anticipated?:</b> Yes	<b>Archaeological interest:</b> The site is in the general area where previously Early Anglo-Saxon burials have been recorded.
<b>Final Report:</b> NA	
<b>Periods Represented:</b> None	
<b>SUMMARY OF FIELDWORK RESULTS:</b> (See also Fig) As the foundation raft for the front extension was only 200mm deep with a 350mm toe round the edge and therefore remained in a mid brown sandy subsoil and was too shallow to reveal any archaeological deposits if present.	
<b>Conclusion:</b> As noted above the ground disturbance was too shallow to reveal anything of interest, the larger side extension will be constructed at a later date.	
<b>Author of Summary:</b> John Newman	<b>Date of Summary:</b> 2 May, 2014



Site location

(Ordnance Survey © Crown copyright 2009 All rights reserved Licence No 100049722)

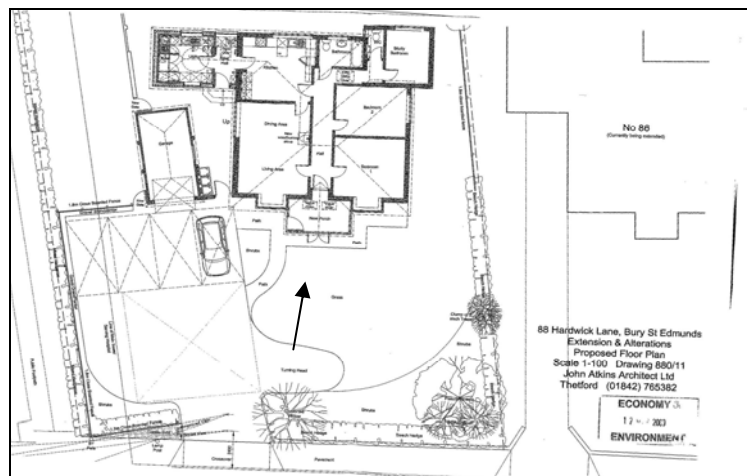

Monitored front extension (north to top)

