

**New Garage at 80 Hardwick Lane, Bury St Edmunds,
Suffolk**

Planning application: DC/13/0594/HH

HER Ref: BSE 444

Evaluation Report

(© John Newman BA MIFA, 2 Pearsons Place, Henley, Ipswich, IP6 0RA)

(March 2015)

(Tel: 01473 832896 Email: johnnewman2@btinternet.com)

Site details for HER

Name: No 80 Hardwick Lane, Bury St Edmunds, Suffolk, IP33 2RA

Client: Mr S Steele

Local planning authority: St Edmundsbury B C

Planning application ref: DC/13/0594/HH

Development: Erection of extensions & cartlodge

Date of fieldwork: 18 March, 2015 (site visit to inspect & record homeowners hand excavated evaluation trenches)

HER ref: BSE 444

OASIS ref: johnnewm1-177818

Grid ref: TL 8534 6290

Contents

Summary

HER summary sheet

Site location

Location of evaluation trenches

Site images

Summary: Bury St Edmunds, No 80 Hardwick Lane (BSE 444, TL 8534 6290) Hand excavated evaluation trenches across the site of a planned garage did not reveal any archaeological finds or features with clean natural sand being revealed at a depth of 300mm (John Newman Archaeological Service for Mr S Steele).

John Newman Archaeological Services

SUMMARY SHEET

Site name/Address: No 80 Hardwick Lane, Bury St Edmunds	
Planning application: DC/13/0594/HH	
Parish: Bury St Edmunds	District: St Edmundsbury BC
NGR: TL 8534 6290	Site Code: BSE 444
Type of Work: Inspection and recording of two hand excavated evaluation trenches across the footprint of the planned new garage in the south-eastern corner of the overall plot.	Site Director/Group: John Newman Archaeological Services
Date of Work: 18 March, 2015	Size of Area Investigated: Two 2.80m long & 900mm wide trenches excavated on an east-west orientation and 900mm apart Current land use: Shingle covered drive
Location of Finds/Curating Museum: NA	Funding source: Mr S Steele
Further Seasons Anticipated?: Yes	Archaeological interest: The site is in the general area where previously Early Anglo-Saxon burials have been recorded.
Final Report: NA	
Periods Represented: None	
SUMMARY OF FIELDWORK RESULTS: (See also Fig & Images) The two trenches had a similar deposit profile with 250mm to 300mm of clean mid brown sandy subsoil below a thin shingle layer for the drive and above the locally occurring natural orange sand with small flints and chalk fragments where no archaeological features were revealed.	
Conclusion: The results from this small scale evaluation supports the findings of a previous monitoring for an extension at the house further suggesting that if the scatter of Early Anglo-Saxon burials recorded in the Barons Road/Hardwick Lane area extend to this area then their density appears to be low.	
Author of Summary: John Newman	Date of Summary: 19 March, 2015

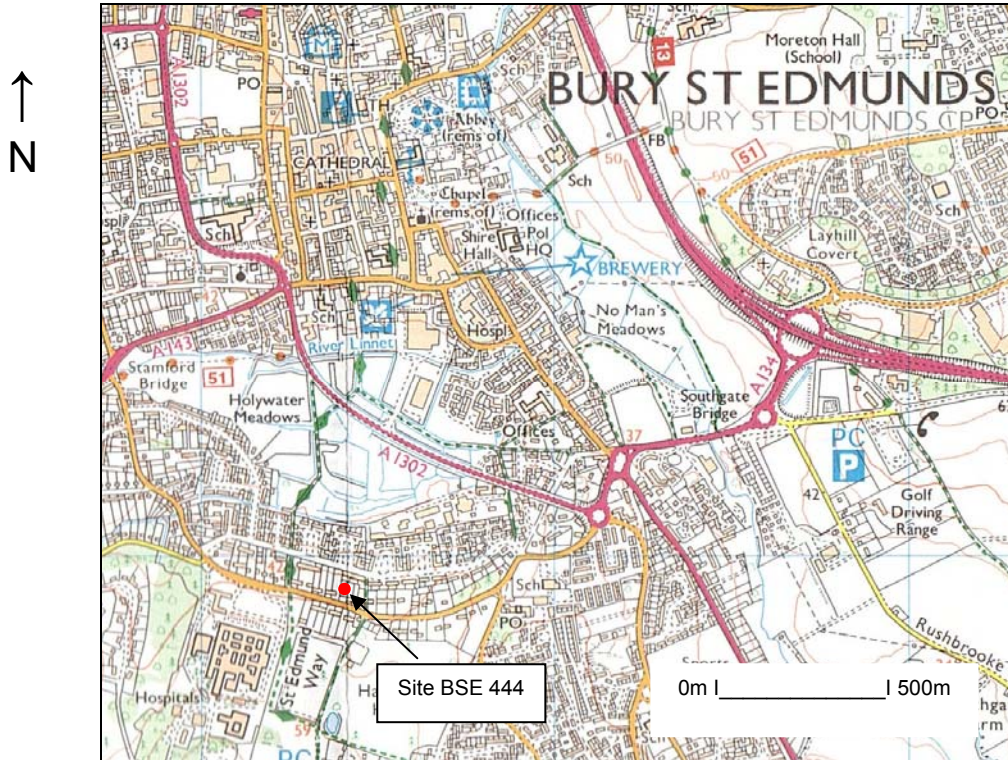

Site location

(Ordnance Survey © Crown copyright 2009 All rights reserved Licence No 100049722)

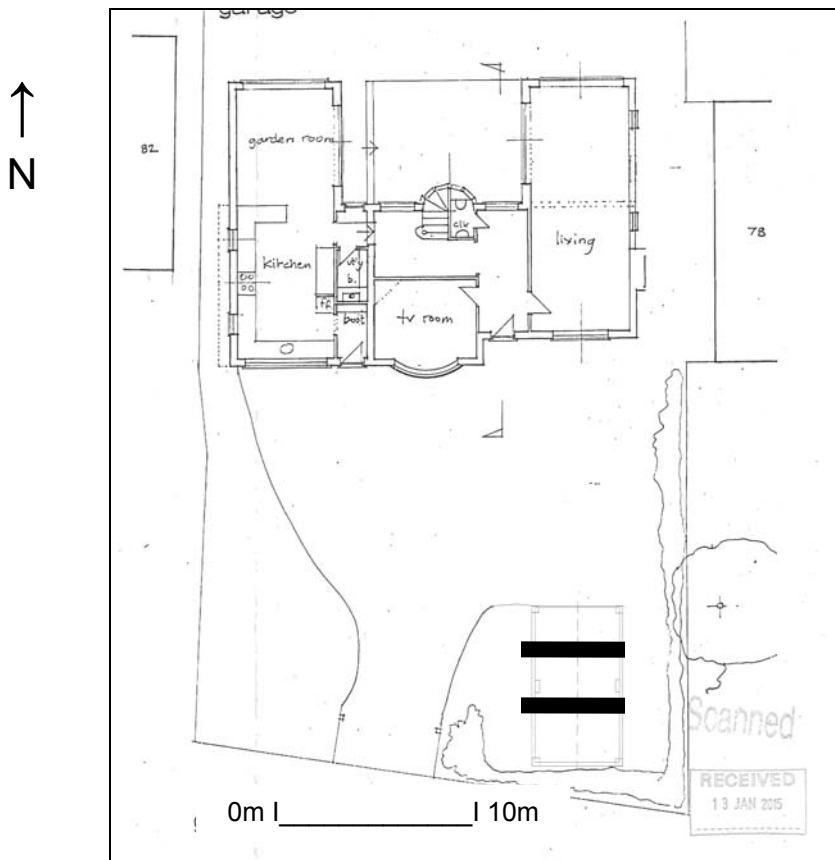

Location of evaluation trenches

Site images



General view of garage site from northwest



Northern trench from west



Southern trench from northeast



Deposit profile

OASIS DATA COLLECTION FORM: England

[List of Projects](#) | [Manage Projects](#) | [Search Projects](#) | [New project](#) | [Change your details](#) | [HER coverage](#) | [Change country](#) | [Log out](#)

Printable version

OASIS ID: johnnewm1-177818

Project details

Project name	No 80 Hardwick Lane, Bury St Edmunds, Suffolk- Archaeological Monitoring Report
Short description of the project	Bury St Edmunds, 80 Hardwick Lane (BSE 444, TL 8534 6290) monitoring of foundation trenches for an extension did not reveal any features though a single sherd of Iron Age pottery sherd and a flint flake were recovered as stray finds. Later evaluation trenching for a new garage did not reveal any features or finds (John Newman Archaeological Services for Mr S Steele).
Project dates	Start: 29-04-2014 End: 18-03-2015
Previous/future work	Yes / Not known
Any associated project reference codes	BSE 444 - Related HER No.
Any associated project reference codes	DC/13/0594/HH - Planning Application No.
Type of project	Recording project
Site status	None
Current Land use	Other 5 - Garden
Monument type	NONE None
Significant Finds	FLAKE Late Prehistoric
Significant Finds	POTTERY Late Prehistoric
Investigation type	"Watching Brief"
Prompt	Planning condition

Project location

Country	England
Site location	SUFFOLK ST EDMUNDSBURY BURY ST EDMUNDS No 80 HARDWICK LANE
Postcode	IP33 2RA
Study area	60.00 Square metres
Site coordinates	

TL 8534 6290 52.2325878352 0.714366923876 52 13 57 N 000 42 51 E
Point

Height OD / Depth Min: 49.00m Max: 50.00m

Project creators

Name of Organisation John Newman Archaeological Services

Project brief originator Local Authority Archaeologist and/or Planning Authority/advisory body

Project design originator John Newman

Project director/manager John Newman

Project supervisor John Newman

Type of sponsor/funding body Landowner

Project archives

Physical Archive recipient Discarded

Physical Contents "Ceramics","Worked stone/lithics"

Digital Archive recipient Suffolk CC Archaeological Service

Digital Contents "Ceramics","Worked stone/lithics"

Digital Media available "Images raster / digital photography","Text"

Paper Archive recipient Suffolk CC Archaeological Service

Paper Contents "Ceramics","Worked stone/lithics"

Paper Media available "Report"

Project bibliography 1

Publication type Grey literature (unpublished document/manuscript)

Title No 80 Hardwick Lane, Bury St Edmunds, Suffolk- Archaeological Monitoring and Evaluation Reports

Author(s)/Editor(s) Newman, J

Date 2015

Issuer or publisher John Newman Archaeological Services

Place of issue or publication Henley, Suffolk

Description Loose bound client reports and pdfs

Entered by John Newman (johnnewman2@btinternet.com)

Entered on 7 April 2015

OASIS:

Please e-mail [Historic England](#) for OASIS help and advice

© ADS 1996-2012 Created by [Jo Gilham and Jen Mitcham](#), email Last modified Wednesday 9 May 2012

Cite only: <http://www.oasis.ac.uk/form/print.cfm> for this page