

**No 18 New Cut, Hadleigh,
Suffolk**

Planning application: B/11/00104/FHA/AF

HER Ref: HAD 121

Archaeological Monitoring Report

(© John Newman BA MIFA, 2 Pearsons Place, Henley, Ipswich, IP6 0RA)

(June 2014)

(Tel: 01473 832896 Email: johnnewman2@btinternet.com)

Site details for HER

Name: No 18 New Cut, Hadleigh, Suffolk

Client: Mr & Mrs D Richardson

Local planning authority: Babergh D C

Planning application ref: B/11/00104/FHA/AF

Development: Erection of front porch extension (rear extension not monitored)

Date of fieldwork: 17 May, 2011

HER ref: HAD 121

OASIS ref: johnnewm1-180857

Grid ref: TM 0319 4292

Contents

Summary

HER summary sheet

Fig. 1: Site location

Fig. 2: Location of monitored front porch extension

Site images

OASIS data form

Summary: Hadleigh, 18 New Cut (HAD 121, TM 0319 4292) Monitoring of ground works for a small front porch extension revealed a substantial depth of recently disturbed deposits (John Newman Archaeological Service for Mr & Mrs D Richardson).

John Newman Archaeological Services

SUMMARY SHEET

Site name/Address: No 18 New Cut, Hadleigh	
Planning application: B/11/00104/FHA/AF	
Parish: Hadleigh	District: Babergh DC
NGR: TM 0319 4292	Site Code: HAD 121 (OASIS johnnewm1-180857)
Type of Work: Watching brief on foundation trenches for a front porch	Site Director/Group: John Newman Archaeological Services
Date of Work: 17 May, 2011	Size of Area Investigated: 5m of 400mm wide trench Current land use: Entrance to house
Location of Finds/Curating Museum: NA	Funding source: Mr & Mrs D Richardson
Further Seasons Anticipated?: No	Archaeological interest: The site is on the eastern edge of the historic core of the town.
Final Report:	
Periods Represented: Later Post medieval	
SUMMARY OF FIELDWORK RESULTS: (See also Fig. 2) The foundation trenches were hand excavated to a depth of 1000mm and remained within made ground at this level below a concrete surface with the upcast spoil containing a few small fragments of brick and tile of 19 th & 20 th century date.	
Conclusion: The area to the front of the house, which is of recent date, revealed made ground to a depth of 1000mm which is probably derived from disturbance caused when the house was built. The rear extension will not require monitoring.	
Author of Summary: John Newman	Date of Summary: 6 June, 2014

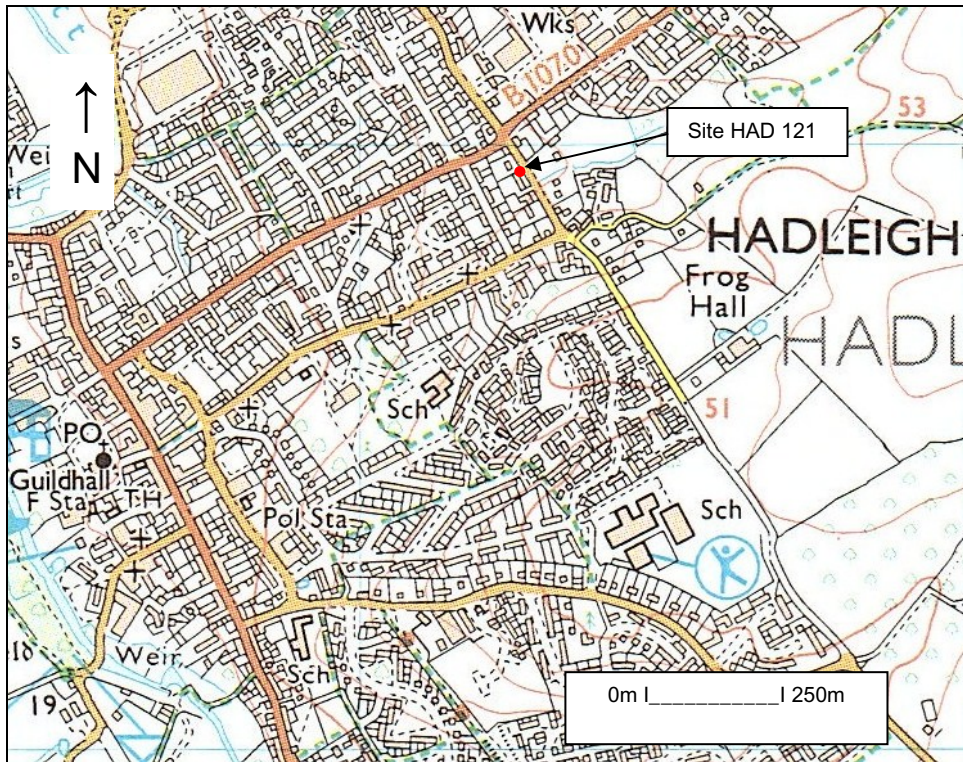

Fig. 1: Site location

(Ordnance Survey © Crown copyright 2009 All rights reserved Licence No 10049722)

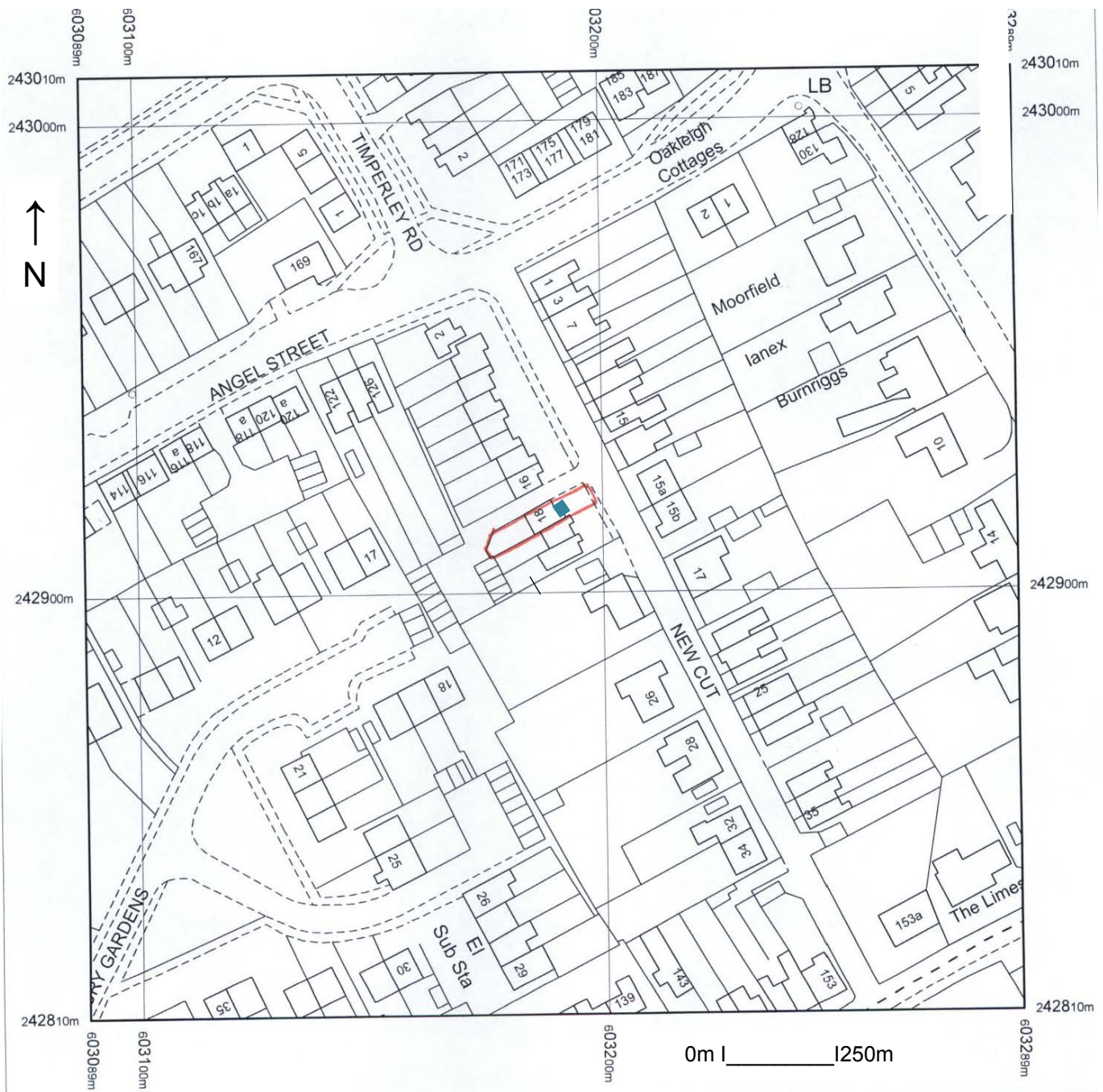

Fig. 2: Location of monitored porch extension (blue)
 (Ordnance Survey © Crown copyright 2010 All rights reserved Licence No 100049722)

Appendix I- Site images



Foundation trench from east



Foundation trench from north-east

Extensions to 18 New Cut, Hadleigh, Suffolk

Planning application: B/11/00104/FHA/AF

Written Scheme of Investigation for Archaeological Monitoring

(© John Newman BA MIFA, 2 Pearsons Place, Henley, Ipswich, IP6 0RA)

(Tel: 01473 832896 Email: johnnewman2@btinternet.com)

Site details

Name: 18 New Cut, Hadleigh, Suffolk, IP7 5DA

Client: Mr & Mrs D Richardson

Local planning authority: Babergh DC

Planning application ref: B/11/00104/FHA/AF

Proposed development: Erection of front porch & rear extension

Proposed date for ground works: Porch- May, 2011, rear extension- ?later 2011

Brief & Specification ref: 18 New Cut

Grid ref: TM 0319 4292

Contents

1. Introduction
2. Location, Topography & Geology
3. Archaeological & Historical Background
4. Aims of the Site Monitoring
5. Methodology
6. Risk Assessment
7. Specialists

1. Introduction

1.1 Mr & Mrs D Richardson have commissioned John Newman Archaeological Services (JNAS) to undertake the archaeological monitoring of ground works required under a condition for a programme of archaeological works of the planning decision notice for application B/11/00104/FHA/AF. This written scheme of investigation (WSI) details the background to the archaeological condition and how JNAS will implement the requirements of the Brief and Specification set by Mr K Wade of the Suffolk CC Archaeological Service to satisfy the condition. The WSI will also set out how potential risks will be mitigated. This proposed development concerns the erection of a small front porch and an extension to the rear of the property.

2. Location, Topography & Geology

2.1 Hadleigh is a small market town in south Suffolk to the west of Ipswich that had been established by the late Saxon period at least and flourished through the medieval period. The town is focused on the area around the parish church and the main historic street lines with Angel Street and George Street running off the High Street at a right angle perhaps indicating some medieval attempt to form a planned settlement on a grid basis. However the extent of the historic core is uncertain as opportunities to investigate below ground deposits has been limited in modern times. The site of the proposed development falls towards the eastern edge of the likely historic town area with New Cut being a mid 19th century creation parallel, and just to the west, of a short road called The Green.

3. Archaeological & Historical Background

3.1 To quote from the relevant Brief and Specification this proposal is 'within the area of archaeological importance for Hadleigh.' In such an area archaeological deposits and finds relating to past settlement in the town may be disturbed by development works. Any such deposits, however, can be recorded by an experienced archaeologist as a mitigation measure against any such disturbance.

4. Aims of the Site Monitoring

4.1 As outlined in section 3 above the site lies in a location with high archaeological potential and close monitoring of ground works can best record what may be revealed. This monitoring will aim to record all possible details relating to depth of overburden and evidence, character and date of any past activity that is revealed with the primary aim of

gaining more information relating to the development of Hadleigh as later Saxon and medieval town.

5. Methodology

5.1 The construction method to be used on the site will be strip foundations for both the porch and rear extension. The excavation of the strip footings will be observed once they are underway and then through to completion and any up cast spoil examined for finds. Any unexpected findings will be reported back to the relevant Suffolk CC Archaeological Office. Time will be available to hand clean sections as necessary and investigate any possible archaeological deposits at the rate of 1.5 hours per 10m of trench as a minimum.

5.2 Site records will be made under a continuous and unique numbering system of 'observable phenomena' (OPs) under an overall site HER number supplied by Suffolk CC. All contexts will be numbered and finds recorded by context. Conventions compatible with the county HER will be used throughout the monitoring. Site plans will be drawn at 1:20 or 1:50 as appropriate and sections at 1:10 or 1:20 (all on plastic drawing film) and related to OS map cover with the monitored footings shown. Sections will be levelled to a datum OD. A photographic record of high resolution digital images will be made of the site and exposed features.

5.3 As necessary and to define archaeological deposits exposed surfaces will be trowelled clean before recording. Archaeological deposits will be fully hand investigated and recorded within the constraints of the trench foundations with sections recorded related to the trench sides if possible. Even if no archaeological deposits are revealed every effort will be made to gain a record of the natural occurring deposits and overburden that could help in the understanding of the general history of land use and topography in the town. Where appropriate palaeoenvironmental samples will be taken for processing and assessment by a specialist conversant with regional archaeological standards and research agendas if relevant archaeological deposits are revealed. If human burial evidence is revealed the SCC Archaeological Officer will be informed and a Ministry of Justice licence obtained before excavation, recording and removal of the remains. The possibility of modifying the ground work design to leave any such remains in situ will also be examined –(the potential of this part of the town to contain burials is assessed as being very low).

5.4 All finds will be collected and processed unless any variation is agreed with the relevant SCC Archaeological Officer. Finds will be assessed by recognised period specialists and their interpretation will form an integral part of the overall report. Finds will be stored according to ICON guidelines with specialist advice/treatment sought for fragile ones. Every effort will be made to gain the deposit of the site finds to the SCC Archaeological Store under their relevant HER code and site numbering for future reference. If this is not possible then the SCC Archaeological Officer will be consulted over any requirements for additional recording. Any discard policy will be discussed and agreed with the relevant Archaeological Officer at Suffolk CC.

5.5 An archive of all records and finds will be prepared consistent with the principles in *Management of Archaeological projects* (MAP2) and particularly Appendix 3 and this will be deposited with the Suffolk CC HER within 3 months of working finishing on site under the relevant HER number. As necessary the site digital archive will be deposited with the Archaeology Data Service (ADS) within the agreed allowance for the monitoring and reporting works.

5.6 The monitoring report will be consistent with the principles of MAP2 (particularly Appendix 4) and this report will summarise the methodology employed and relate the archaeological record directly to the level of visibility allowed by the operation of plant given the nature of the underlying natural deposits. The report will also give an objective account of the deposits and stratigraphy recorded and finds recovered with an inventory of the latter. Any interpretation of the monitoring results will be clearly separated from the objective account of the monitoring and its results. The report will give a clear statement regarding the results of the site monitoring in relation to both the more detailed aims in section 2 above and their significance in the context of the Regional Research Framework (EAA Occ. Papers 3 & 8, 1997 & 2000). An unbound draft copy of the report will be presented to the Archaeological Service at Suffolk CC within 3 months of the completion of the site works. Once accepted a bound hard copy will be provided plus another for the County HER, a copy will be sent to the client so they can gain discharge of the relevant condition. If the results of the site monitoring are positive the project will be registered on the OASIS online archaeological record followed by submission of the final draft in .pdf format. An HER summary sheet will be completed and a summary prepared of any positive results for inclusion in the annual PSIAH round-up.

6. Risk Assessment

6.1 Protective clothing will be worn on site (hard hat, high visibility vest/coat, steel-toe cap boots, ear muffs if required). A safe working method will be agreed with the contractors on site in order to maximise access to disturbed ground and up cast spoil while at the same time allowing efficient use of plant. Suitable clothing will be available to mitigate against extremes of weather.

6.2 Vehicles will be safely parked away from work areas and lines of access.

6.3 Before work on site starts any special requirements regarding potential site contamination will be discussed with the client and any ground test reports examined. Gloves and hand wash/wipes be available and any information on possible ground contamination will be passed to finds and environmental specialists. The potential for services in the area will be discussed with the client and their contractor.

6.4 A fully charged mobile phone will be carried and a first aid kit will be taken to site.

6.5 Deep holes/trenches will only be entered if assessed to be safe and after consultation with the contractor on site, they will not be entered if no-one else is in the vicinity.

6.6 JNAS holds full insurance cover for archaeological site works from the specialist provider Towergate Risk Solutions covering Public & Products Liability, details can be supplied on request.

7. Specialists

Conservation:	Conservation Services
Faunal remains:	J Curl (Sylvanus Archaeology)
Human remains:	S Anderson (CFA Archaeology)
Palaeoenvironmental samples:	V Fryer (Freelance)
Pre-historic flint:	S Bates (Freelance)
Pre-historic pottery:	S Percival (NAU/NPS)
Post Roman ceramics & CBM:	S Anderson (CFA Archaeology)
Roman period small finds:	N Crummy (Freelance)
Roman period ceramics	S Benfield (CAT)

John Newman Archaeological Services

Post Roman small finds:

JNAS

OASIS DATA COLLECTION FORM: England

[List of Projects](#) | [Manage Projects](#) | [Search Projects](#) | [New project](#) | [Change your details](#) | [HER coverage](#) | [Change country](#) | [Log out](#)

Printable version

OASIS ID: johnnewm1-180857

Project details

Project name	No 18 New Cut, Hadleigh, Suffolk- Archaeological Monitoring Report
Short description of the project	Hadleigh, 18 New Cut (HAD 121, TM 0319 4292) Monitoring of ground works for a small front porch extension revealed a substantial depth of recently disturbed deposits.
Project dates	Start: 17-05-2011 End: 17-05-2011
Previous/future work	No / No
Any associated project reference codes	HAD 121 - HER event no.
Any associated project reference codes	B/11/00104/FHA/AF - Planning Application No.
Type of project	Recording project
Site status	None
Current Land use	Other 5 - Garden
Monument type	NONE None
Significant Finds	NONE None
Investigation type	"Watching Brief"
Prompt	Planning condition

Project location

Country	England
Site location	SUFFOLK BABERGH HADLEIGH No 18 NEW CUT
Postcode	IP7 5DA
Study area	6.00 Square metres
Site coordinates	TM 0319 4292 52.0468543289 0.96348092189 52 02 48 N 000 57 48 E Point
Height OD / Depth	Min: 53.00m Max: 54.00m

Project creators

Name of Organisation	John Newman Archaeological Services
Project brief originator	Local Authority Archaeologist and/or Planning Authority/advisory body

Project design originator	John Newman
Project director/manager	John Newman
Project supervisor	John Newman
Type of sponsor/funding body	Landowner

Project archives

Physical Archive Exists?	No
Digital Archive recipient	Suffolk CC Archaeological Service
Digital Contents	"none"
Digital Media available	"Text"
Paper Archive recipient	Suffolk CC Archaeological Service
Paper Contents	"none"
Paper Media available	"Report"

Project bibliography 1

Publication type	Grey literature (unpublished document/manuscript)
Title	No 18 New Cut, Hadleigh, Suffolk- Archaeological Monitoring Report
Author(s)/Editor(s)	Newman, J
Date	2014
Issuer or publisher	John Newman Archaeological Services
Place of issue or publication	Henley, Suffolk
Description	Loose bound client report
Entered by	John Newman (johnnewman2@btinternet.com)
Entered on	6 June 2014

OASIS:

Please e-mail [English Heritage](#) for OASIS help and advice

© ADS 1996-2012 Created by [Jo Gilham and Jen Mitcham, email](#) Last modified Wednesday 9 May 2012

Cite only: <http://www.oasis.ac.uk/form/print.cfm> for this page