

**Land Adjacent To The Old Eight Bells,
The Street, Horham, Suffolk**

Planning application: 2133/14

HER Ref: HRM 015

Archaeological Evaluation Report

(© John Newman BA MIFA, 2 Pearsons Place, Henley, Ipswich, IP6 0RA)

(March 2015)

(Tel: 01473 832896 Email: johnnewman2@btinternet.com)

Site details for HER

Name: Land adjacent to The Old Eight Bells, The Street, Horham, Suffolk, IP21 5PX

Clients: Mr & Mrs J Groen

Local planning authority: Mid Suffolk DC

Planning application ref: 2133/14

Development: Erection of new dwelling

Date of fieldwork: 16 March, 2015

HER ref: HRM 015

Event ref: ESF 22986

OASIS ref: johnnewm1-206341

Grid ref: TM 2049 7230

Contents

Summary

1. Introduction & background
2. Evaluation methodology
3. Results

Table 1: Trench details

4. Conclusion

Fig. 1 Site location

Fig. 2 Location of evaluation trench

List of appendices

Appendix I- Selected images

Appendix II- Written scheme for evaluation

Appendix III- OASIS data collection form

Summary: Horham, land adjacent to The Old Eight Bells, The Street (HRM 015, TM 2049 7230) evaluation trenching for a single dwelling close to various listed buildings did not reveal any archaeological features and the few stray finds were of recent date (John Newman Archaeological Services for Mr & Mrs J Groen).

1. Introduction & background

1.1 Mr & Mrs J Groen commissioned John Newman Archaeological Services (JNAS) to undertake the archaeological evaluation works for a single residential dwelling development on land adjacent to The Old Eight Bells, The Street, Horham (see Fig. 1). The evaluation requirements were set out in a Brief, following the granting of planning application 2133/14 set by Mrs R Abraham of the Suffolk CC Archaeological Service (SCCAS) with the aim of gaining a representative sample by trial trenching of the footprint area concerned. The Written Scheme of Investigation for the archaeological evaluation (see Appendix II) was subsequently prepared by JNAS in order to gain a conditional discharge and allow the trenching to go ahead before any other ground works are undertaken.

1.2 Horham parish is located in north central Suffolk in an area where, historically, villages have clustered partly round the church but also with a more scattered pattern dispersed round various green edges and along the numerous roads and lanes. With a productive, though heavy, soils based on the deep clays of the till plateau of central Suffolk over the underlying chalky till of the Beccles series, population densities were high through the medieval and early Post medieval periods in a prosperous region as evidenced by the numerous substantial historic buildings in the area. The proposed development site lies on flat ground c500m east of the parish church and is 20m north of the frontage onto The Street in a historic village characterised by a linear settlement pattern at c55mOD. At the time of the evaluation the site was soft ground.

1.3 Archaeological interest in this development was generated by its location within the historic settlement area within the village of Horham as evidenced by nearby listed buildings such as Rose Cottage and The Homestead to the south which are 15th century date in origin (see Appendix I first image). In addition medieval activity close to this site is indicated by the record of medieval pottery sherds (HER HRM 007) having been found to the south of The Street (see Fig. 1). To the east The Old Eight Bells is not a listed building and appears to be of later 18th to 19th century date.

2. Evaluation methodology

2.1 In order to maintain the integrity of the footprint area for the proposed dwelling a T shaped trench was excavated on its southern side (see Fig. 2) using a medium sized 360 machine equipped with a 1000mm flat bucket which was under archaeological supervision at all times with any indistinct areas being hand cleaned for better clarity.

2.2 The sides and base of the trench and the upcast spoil were examined visually and scanned with a metal detector for any finds as the work progressed and any indistinct areas were investigated by hand. Site visibility for features and finds is considered to have been good throughout the evaluation which was undertaken under dry and sunny conditions. At the end of the evaluation the location of the trench was plotted from nearby mapped features and as the evaluation progressed a full photographic record in digital format (see Appendix I) was taken of the trenching works.

3. Results

3.1 In this case the results are most easily summarised as in the table below as very little of archaeological interest was revealed (see also Fig. 2):

Length (m)	Topsoil depth (mm)	Subsoil depth (mm)	Drift geology	Archaeological/ natural features & finds
10m (T shaped, 5m north-south & 5m east-west)	300	150 of a mid brown clay subsoil at northern end increasing to 350mm at southern end	Stiff pale brown chalky clay with flints	No features, only finds from the upcast spoil being occasional blue & white 19 th /early 20 th century pottery sherds, two clay tobacco pipe stem fragments & a small number of small Post medieval brick & peg tiles fragments

Table 1: Trench details

3.2 The glaciofluvial deposit exposed in the base of the trench proved to be a stiff pale brown chalky clay with flints. As indicated in the table above no archaeological features were revealed during the evaluation with the 450mm to 650mm deep trench revealing a deposit profile comprising a 300mm layer of topsoil over 150mm to 350mm of mid brown clay subsoil (see Appendix I).

3.3 During the evaluation the only finds seen in the upcast spoil comprised occasional blue and white pottery sherds of 19th/earlier 20th century date, two clay tobacco pipe stem fragments and a small number of small number of brick and peg tile fragments of Post medieval date.

4. Conclusion

4.1 With such negative results regarding any significant evidence for past activity from a substantial sample of the proposed development area it can only be concluded this site has only seen use as agricultural land or garden in the past with the medieval and earlier Post medieval settlement pattern along The Street clearly being intermittent with gaps between historic buildings.

4.2 Based on the evaluation results it is recommended that no further archaeological investigations need to be carried out on the proposed site of the new dwelling on land adjacent and to the east of The Old Eight Bells, The Street, Horham.

Archive- to be deposited with the Suffolk CC Archaeological Service under the HER ref. HRM 015.

Disclaimer- any opinions regarding the need for further archaeological work in relation to this proposed development are those of the author's alone. Formal comment regarding the need for further work must be sought from the official Archaeological Advisors to the relevant Planning Authority.

(Acknowledgements: JNAS is grateful April and Jack Groen for their close cooperation with regard to this evaluation and to Alex from AJC Construction for his skilled machine operation)

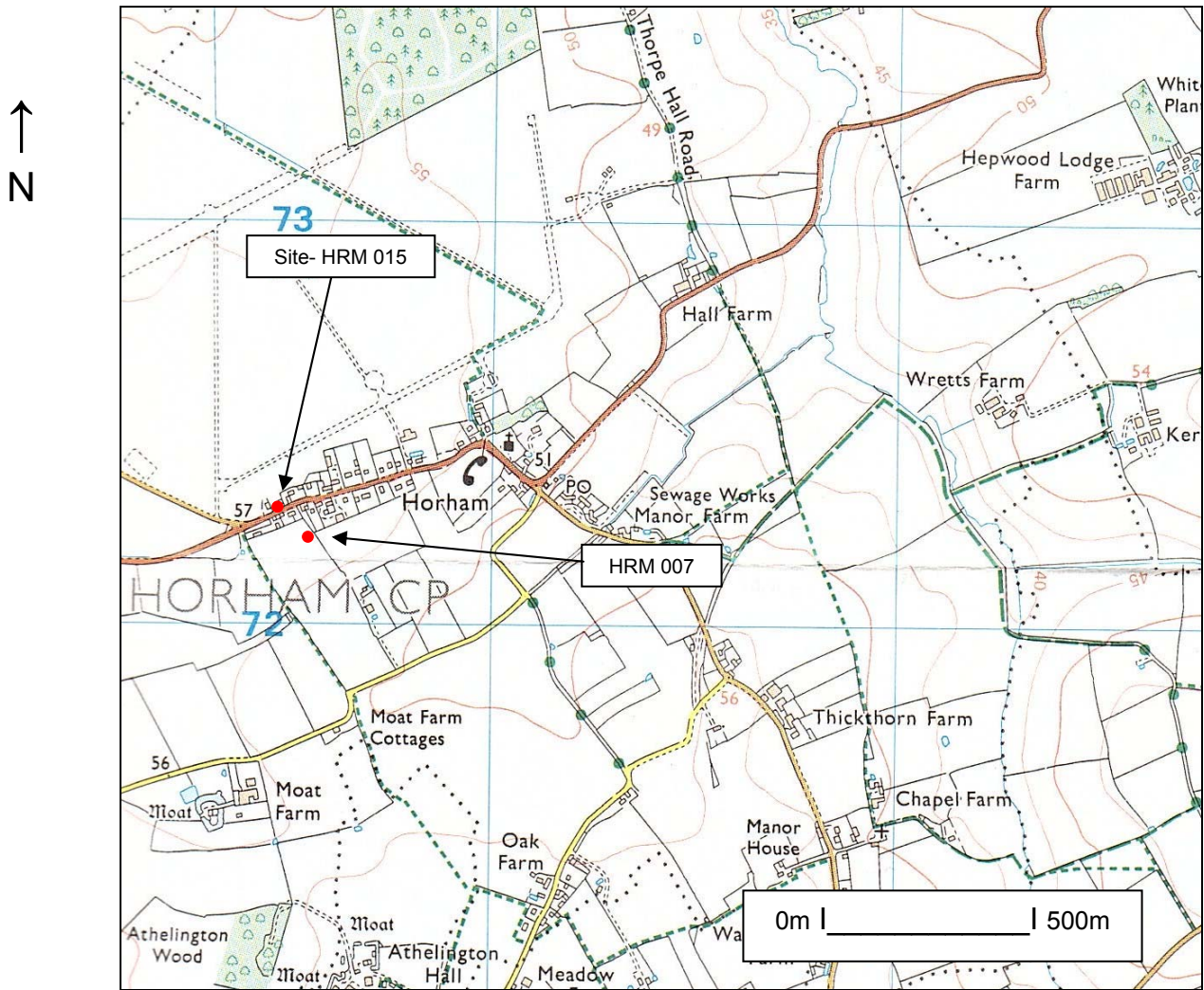

Fig. 1: Site location (Ordnance Survey © Crown copyright 2006
All rights reserved Licence No 100049722)

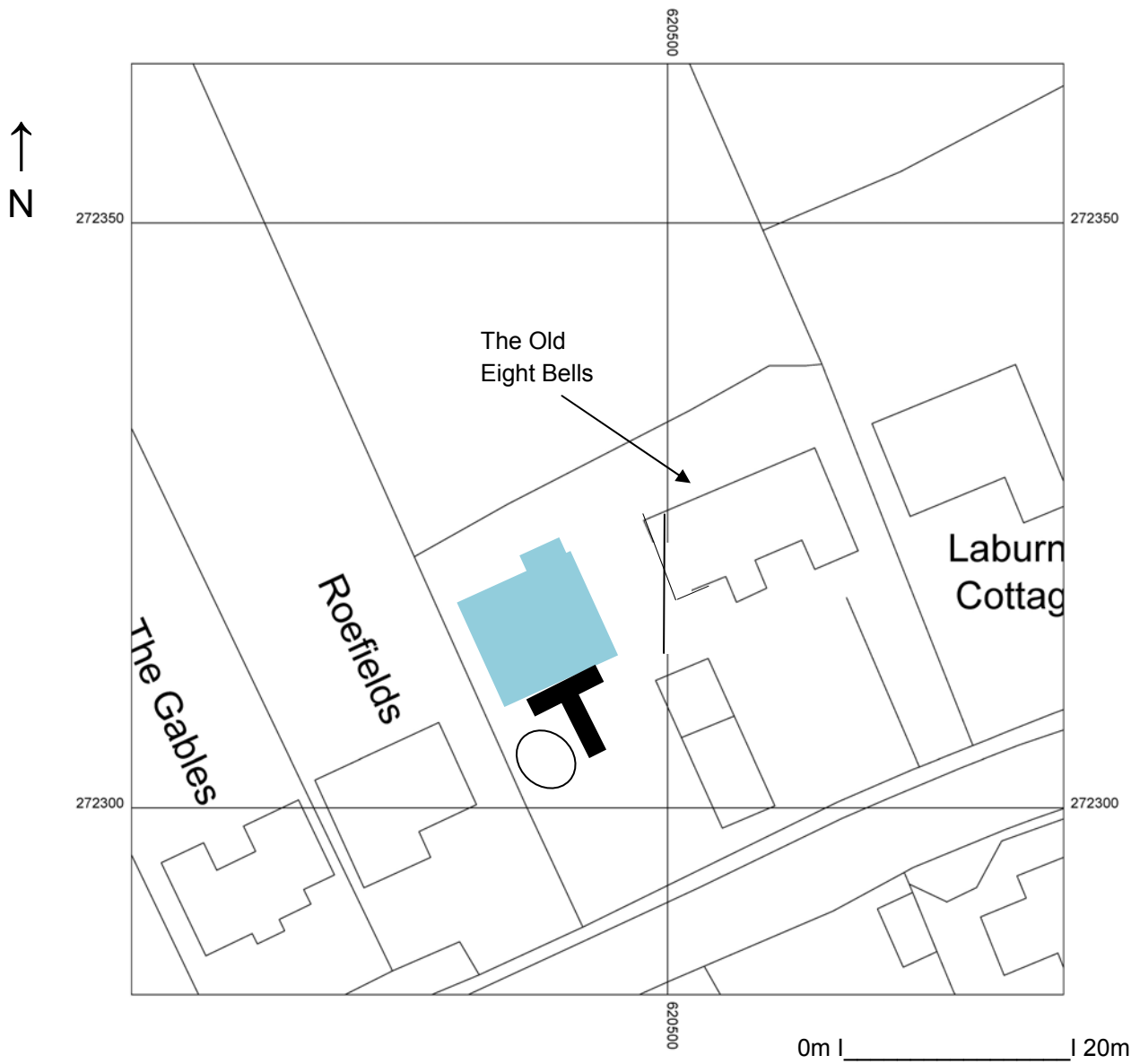

Fig. 2: Location of evaluation trench (light blue- planned house footprint)

Appendix I- Images



General view from north with Rose Cottage/The Homestead in background



General view from south with The Old Eight Bells in background



Trench from south



Trench from east



Deposit profile

**Land Adjacent to The Old Eight Bells,
The Street, Horham, Suffolk**

**Written Scheme of Investigation for
Archaeological Evaluation**

Site details

Name: Land adjacent to The Old Eight Bells, The Street, Horham, Suffolk, IP21 5PX

Client: Ms A Groen

Local planning authority: Mid Suffolk DC

Planning application ref: 2133/14

Proposed development: Erection of a single dwelling

Proposed date for evaluation: tbc

Brief ref: SCCAS_RA_Trenched Archaeological Evaluation Brief_ The Old Eight Bells The Street Horham

Grid ref: TM 2056 7232

Contents

1. Introduction
2. Location, Topography & Geology
3. Archaeological & Historical Background
4. Aims of the Site Evaluation
5. Methodology
6. Risk Assessment
7. Specialists

Proposed location of trial trench

1. Introduction

1.1 Ms A Groen has commissioned John Newman Archaeological Services (JNAS) to undertake the archaeological site evaluation for a proposed single dwelling development that has recently received consent to go ahead. This written scheme of investigation (WSI) details the background to the archaeological requirements for planning application 2133/14 and how JNAS will implement the requirements of the Brief for Archaeological Evaluation set by Mrs R Abraham of the Suffolk CC Archaeological Service (SCCAS). The WSI will also set out how potential risks will be mitigated. This proposed development concerns the construction of a single detached dwelling on land adjacent to The Old Eight Bells, The Street, Horham.

1.2 The evaluation will be carried out to the standards set regionally in the *Standards for Field Archaeology in the East of England (EAA Occ. Papers 14, 2003)*, locally in *Requirements for Trenched Archaeological Evaluation 2011 Ver. 1.1 (Suffolk CC)* and nationally in *Standards and Guidance for Archaeological Field Evaluation (Institute for Archaeologists 1994, revised 2001)*.

2. Location, Topography & Geology

2.1 Horham parish is located in north central Suffolk in an area where, historically, villages have clustered partly round the church but also with a more scattered pattern dispersed round various green edges and along the numerous roads and lanes. With a productive, though heavy, soils based on the deep clays of the till plateau of central Suffolk over the underlying chalky till of the Beccles series, population densities were high through the medieval and early Post medieval periods in a prosperous region as evidenced by the numerous historic buildings in the area. The proposed development site (PDS) lies on flat ground c500m east of the parish church and is 20m north of the frontage onto The Street in a historic characterised by a linear settlement pattern at c55mOD. The site is currently soft ground.

3. Archaeological & Historical Background

3.1 To quote from the relevant Brief 'This application lies within an area of archaeological potential indicated by the County Historic Environment Record. Finds of medieval pottery have been recorded from the immediate area of the proposal (HER no. HRM 007), which in addition is situated on a street fronted by listed medieval and post-medieval buildings. As a result there is high potential for medieval and post-medieval occupation deposits to be disturbed by development. Any

ground-works associated with the proposed development has the potential to cause significant damage or destruction to any underlying heritage assets.' To the south of the PDS Rose Cottage and The Homestead are listed buildings dated to the 15th century in origin while other listed structures nearby include the 16th century cottage Treen to the south-west, Veldon Cottage to the east which is also of 16th century date and Whitehouse Cottage to the west is dated to the 17th century.

A site evaluation by trial trenching is therefore required

- Identify the date, approximate form and purpose of any archaeological deposit, together with its likely extent, localised depth and quality of preservation.
- Evaluate the likely impact of past land uses, and the possible presence of masking colluvial/alluvial deposits.
- Establish the potential for the survival of environmental evidence.
- Provide sufficient information to construct an archaeological conservation strategy, dealing with preservation, the recording of archaeological deposits, working practices, timetables and orders of cost.

4. Aims of the Site Evaluation

4.1 As outlined in section 3 above the main archaeological potential relates to the site's location in a historic village settlement where evidence for medieval and earlier Post medieval period settlement and related activities in particular may exist. The aim of the evaluation is therefore to examine the specified sample of the proposed development area with an evaluation trench adjacent to the proposed new build area, but in the area of driveway which will also be disturbed, under controlled conditions so, if archaeological deposits are revealed they can be sampled and characterised. With this information a strategy can then be formulated for their possible preservation in situ or, failing that, the systematic recording of these deposits and the associated working practices, timetables and orders of cost with regard to a new dwelling which will be constructed on a raft of, as yet, uncertain depth.

5. Methodology

5.1 The proposed development is for a single residential dwelling on what is soft ground on land adjacent to The Old Eight Bells, The Street, Horham.

5.2 The Brief requires 10m of 1.80m wide trenches. The trenching will be undertaken using a 1.2/1.5m wide toothless ditching bucket on a suitably sized machine operated by an experienced driver with a trench plan as set out below. The machine will be closely supervised by an experienced archaeologist as the overburden is removed in shallow spits to the top of any archaeological deposits that are present, where hand investigation will start, or to expose the underlying drift geology which will be further hand cleaned and examined. The spoil will be stored adjacent to the excavated trench with top and sub soil kept separate to allow for subsequent sequential backfilling. No trenches will be backfilled until the relevant officer at SCCAS has been consulted and should any modification to the trench layout be required due to any unforeseen circumstances, such as local services, then SCCAS will be contacted immediately. A metal detector search will be carried out by an experienced operator at all stages of the evaluation. The up cast spoil will also be closely examined for unstratified artefacts as evidence for past activity in rural areas in particular is often as evident via artefact scatters as by undisturbed archaeological deposits.

5.3 Site records will be made under a continuous and unique numbering system of contexts under overall site event and HER numbers obtained from the Suffolk CC HER beforehand. All contexts will be numbered and finds recorded by context. Conventions compatible with the county HER will be used throughout the monitoring. Site plans will be drawn at 1:20 or 1:50 as appropriate and sections at 1:10 or 1:20 (all on plastic drawing film) and related to OS map cover. Sections will be levelled to a datum OD. A photographic record in high resolution digital images will be made of the site and exposed features.

5.4 As necessary and to define archaeological deposits exposed surfaces will be trowelled clean before appropriate hand investigation and recording. Exposed archaeological features will be sampled at standard levels with care being taken to cause minimum disturbance to the site consistent with evaluation to a level adequate to properly form a subsequent mitigation strategy. Significant features such as solid or bonded structural remains, building slots or post holes (where fills are sampled) will have their integrity maintained (and during backfilling). Otherwise for discrete, contained, features, sampling will be at 50%-

possibly rising to 100% if requested, and 1m wide sampling slots across linear features. If human burial evidence is revealed the SCCAS Officer will be informed and the clear presumption must be to preserve such remains in situ with minimum disturbance during this evaluation stage. If this is not possible then a Ministry of Justice licence will be obtained prior to full on site recording (total 100% sampling if a cremation deposit) and removal of the remains followed by examination by the relevant specialist and possibly scientific dating. If human remains do have to be recorded, removed from site and reported on then these works will add an additional cost to the evaluation works which may involve radiocarbon dating (in this case the likelihood of revealing human burial is assessed as being low).

5.5 All finds will be collected and processed unless any variation is agreed with the relevant SCCAS Officer. Finds will be assessed by recognised period specialists and their interpretation will form an integral part of the overall report. Finds will be stored according to ICON guidelines with specialist advice/treatment sought for fragile ones. Every effort will be made to gain the deposit of the site finds to the SCCAS Store under their relevant HER code and site numbering for future reference. If this is not possible then the SCCAS Officer will be consulted over any requirements for additional recording (which may have an additional cost implication). Any discard policy will be discussed and agreed with the relevant SCCAS Officer.

5.6 Where appropriate palaeoenvironmental samples will be taken for processing and assessment by a specialist conversant with regional archaeological standards and research agendas. The sampling, processing and assessment will follow the guidelines as detailed in *A guide to sampling archaeological deposits for environmental analysis* (Murphy P L & Wiltshire P E J, 1994). In accordance with standard practice bulk samples of 40 litres (or 100% of the deposit where less) will be taken from a representative cross section of archaeological deposits of all periods (respecting defined fills within features), in consultation with the relevant SCCAS Officer (and RSA if the deposits merit more targeted advice) including deposits that cannot be immediately dated by their artefact content, so the state of preservation and full archaeological and palaeoenvironmental potential of the deposits can be assessed and any further sampling, should further field work take place, be systematically planned and fully costed. Archaeological deposits of all types may reveal valuable data through the processing and assessment of samples with high priority features including the primary fills of pits, wells and cesspits, layers of middens, occupation surfaces and structural features as well as other discrete activity areas, contents of

hearths, ovens, and other craft related or industrial structures. In addition more generalised settlement and land use features such as ditches may also yield valuable and informative data when sampling is undertaken systematically as the sum of all the assessment results can add considerably to the interpretation of a site and its landscape. Through an integrated study of all the data recovered from the evaluation the results from the assessment of the samples will be reviewed in terms of:

- What is the quality and state of preservation of charred plant remains, mineralised plant and animal related remains, small vertebrates and industrial residues such as evidence for iron working (contributing to the fullest interpretation of the evaluation results and to aid the planning of any further field work- if any RC dates are required on features containing suitable material but no easily dateable finds then this will incur an additional cost though this is a rare occurrence on small scale evaluations).
- What is the concentration of macro-remains (to inform sampling strategy in any further field work), in particular how might bulk sampling inform the interpretation of burial deposits.
- Can any patterning or similarities/differences be ascertained between deposits from different periods represented on site, similarly can any useful comparisons be made with undated and unphased deposits (to aid interpretation of the evaluation results and help in the study of undated deposits which may otherwise be overlooked and which may via sampling yield material for RC dating)
- Do waterlogged deposits exist on site, if so is there potential for palaeoenvironmental data from preserved insects or pollen and do such deposits contain organic material suitable for RC dating from samples taken as advised by the relevant soil specialist (who would also coordinate the assessment for pollen and insect remains), the RSA will also be consulted in such cases in conjunction with the relevant SCCAS Officer. Incremental column samples will be taken should waterlogged deposits be revealed in close consultation with the evaluation soils specialist with 10-20 litre sample sizes which will be sub-sampled for preserved pollen, insects, diatoms, preserved parasite eggs etc. If waterlogged wood is encountered it will ideal to leave in situ, if it has to be lifted it will be packed while wet in black polythene and stored at 5C until it can be transferred to a specialist for species identification, assessment and potential for RC dating is undertaken (should RC

dating be required in the evaluation on such deposits this will be covered within the resources agreed for the first date but will take time to obtain, examination of the topographic location of the site indicates that the presence of waterlogged deposits is unlikely unless particularly deep features are present).

- Deep blanket type deposits resulting from both natural and human derived actions and events can yield valuable land use and palaeoenvironmental information. In particular such deposits can form at the base of a slope, if located in the evaluation the relevant SCCAS Officer and RSA will be consulted over monolith sampling and assessment by the relevant evaluation specialist (the composition of such deposits may give information on past land use in the area through a study of the soil matrix notwithstanding additional data if it is waterlogged)

5.7 An archive of all records and finds will be prepared consistent with the principles in *Management of Archaeological projects* (MAP2, and particularly Appendix 3). This archive will be deposited with the Suffolk CC HER within 3 months of working finishing on site under the relevant HER number and following the guidelines outlined in '*Deposition of Archaeological Archives in Suffolk*' (SCCAS Conservation Team 2008). As necessary the site digital archive will be deposited with the Archaeology Data Service (ADS) within the agreed allowance for the monitoring and reporting works.

5.8 The evaluation report will be consistent with the principles of MAP2 (particularly Appendix 3.1 & Appendix 4.1) and this report will summarise the methodology employed and relate the archaeological record directly to the aims of this WSI and section 4 above in particular. The report will give an objective account of the deposits and stratigraphy recorded and finds recovered with an inventory of the latter. The report will include an assessment of palaeoenvironmental remains recovered from palaeosols and cut features in relation to both dated and undated features and in terms of patterning across the site.

5.9 Any interpretation of the evaluation will be clearly separated from the objective account of the evaluation and its results and the results will be discussed with the relevant SCCAS Officer at an early stage in the reporting process following reporting on the day of the immediately apparent conclusions. The report will give a clear statement regarding the results of the site evaluation in relation to both the more detailed aims in section 4 above and their significance in the context of local HER records and of the Regional Research Framework (EAA Occ. Papers 3,

8 & 24, 1997, 2000 & 2011). There will be no further work on site until the evaluation results have been assessed and the SCCAS Officer has considered whether further archaeological works are required if this application receives consent. The report may give an opinion regarding the necessity for further evaluation work as appropriate. A draft copy of the report will be presented to SCCAS following completion of the site works. Once accepted a bound hard copy will be provided for the County HER with a digital version on disc. As required the site evaluation will be registered on the OASIS online archaeological record followed by submission of the final draft in .pdf format. An HER summary sheet will be completed and a summary prepared of any positive results for inclusion in the annual PSIAH round-up. As appropriate a vector plan of the trench location will be provided in .dxf format for inclusion in the County HER.

6. Risk Assessment

6.1 Protective clothing will be worn on site (hard hat, high visibility vest/coat, steel-toe cap boots, and ear muffs if required). A safe working method will be agreed with the machine operator for excavation of the trenches and examination of the up cast spoil while at the same time allowing efficient use of plant. Suitable clothing will be available to mitigate against extremes of weather.

6.2 Vehicles will be safely parked away from work areas and lines of access.

6.3 Discussion with the client's agent has already confirmed that there is no known, or likely, ground contamination and the discovery of underground services is unlikely. No overhead services impinge on the trench locations. Gloves and hand wash/wipes be available and any information on possible ground contamination revealed during the evaluation will be passed to finds and environmental specialists.

6.4 A fully charged mobile phone will be carried and a first aid kit will be taken to site.

6.5 It is unlikely that any trench plus excavated feature depth will go below c1/1.3m from the present ground level. If any excavations need to go deeper measures such as stepping in the sides will be employed.

6.6 JNAS holds full insurance cover for archaeological site works from the specialist provider Torgate Risk Solutions covering Public & Products Liability, details can be supplied on request.

John Newman Archaeological Services

7. Specialists

Conservation:	Conservation Services
Faunal remains:	J Curl (Sylvanus Archaeology)
Human remains:	S Anderson (Freelance)
Metal detecting:	J Armes (experienced freelance)
Palaeoenvironmental samples:	V Fryer (Freelance)
Soils specialist	R Macphail (UCL)
Pre-historic flint:	S Bates (Freelance)
Pre-historic pottery:	S Percival (Freelance)
Post Roman ceramics & CBM:	S Anderson (Freelance)
Roman period small finds:	N Crummy (Freelance)
Roman period ceramics:	S Benfield (CAT)
Medieval coins:	M Allen (Fitzwilliam Museum)
Post Roman small finds:	JNAS

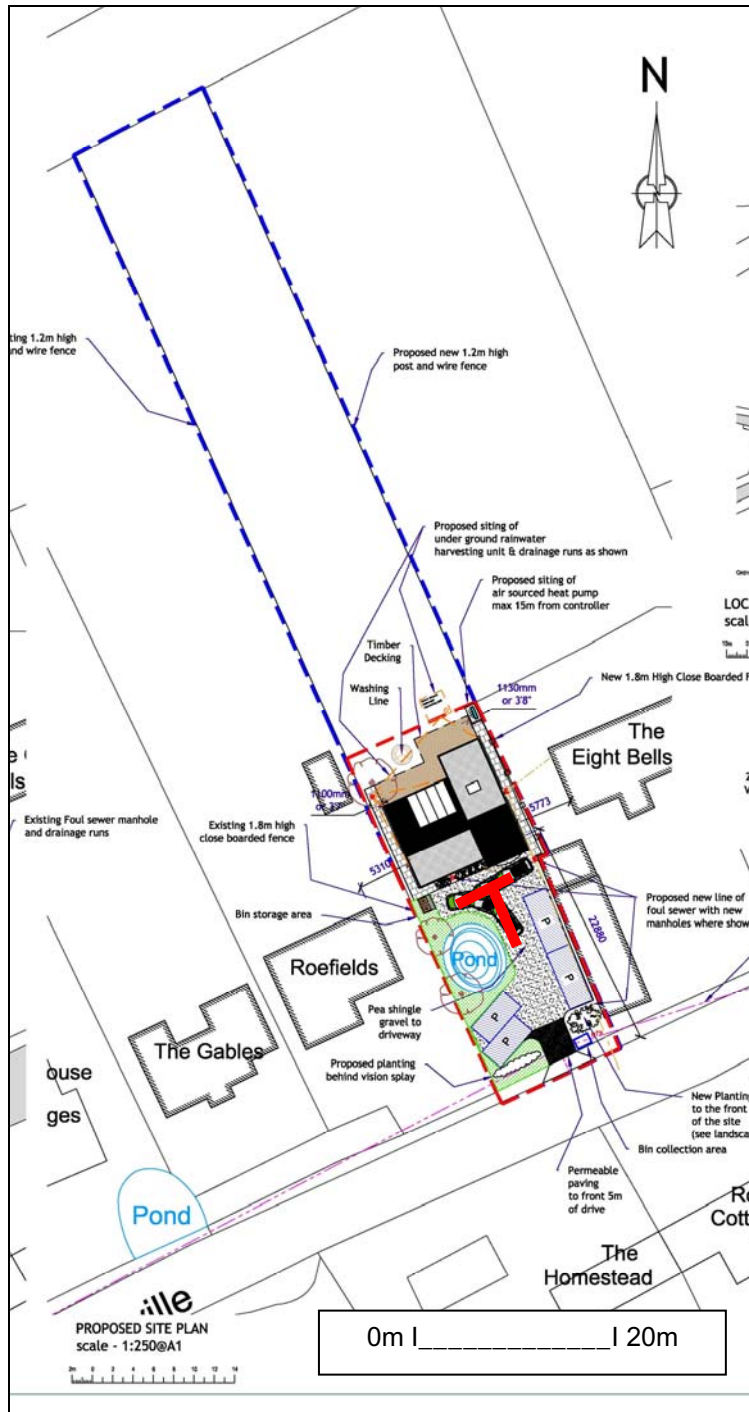

Proposed location of trial trench (red)

OASIS DATA COLLECTION FORM: England

[List of Projects](#) | [Manage Projects](#) | [Search Projects](#) | [New project](#) | [Change your details](#) | [HER coverage](#) | [Change country](#) | [Log out](#)

Printable version

OASIS ID: johnnewm1-206341

Project details

Project name	Land Adjacent To The Old Eight Bells, The Street, Horham, Suffolk-Archaeological Evaluation Report
Short description of the project	Horham, land adjacent to The Old Eight Bells, The Street (HRM 015, TM 2049 7230) evaluation trenching for a single dwelling close to various listed buildings did not reveal any archaeological features and the few stray finds were of recent date.
Project dates	Start: 16-03-2015 End: 16-03-2015
Previous/future work	No / No
Any associated project reference codes	ESF 22986 - HER event no.
Any associated project reference codes	HRM 015 - Related HER No.
Any associated project reference codes	2133/14 - Planning Application No.
Type of project	Field evaluation
Site status	None
Current Land use	Other 5 - Garden
Monument type	NONE None
Significant Finds	NONE None
Methods & techniques	""Sample Trenches""
Development type	Small-scale (e.g. single house, etc.)
Prompt	Planning condition
Position in the planning process	After full determination (eg. As a condition)

Project location

Country	England
Site location	SUFFOLK MID SUFFOLK HORHAM LAND ADJACENT TO THE OLD EIGHT BELLS, THE STREET

Postcode	IP21 5PX
Study area	200.00 Square metres
Site coordinates	TM 2049 7230 52.3039551294 1.23447659628 52 18 14 N 001 14 04 E Point
Height OD / Depth	Min: 55.00m Max: 56.00m

Project creators

Name of Organisation	John Newman Archaeological Services
Project brief originator	Local Authority Archaeologist and/or Planning Authority/advisory body
Project design originator	John Newman
Project director/manager	John Newman
Project supervisor	John Newman
Type of sponsor/funding body	Landowner

Project archives

Physical Archive Exists?	No
Digital Archive recipient	Suffolk CC Archaeological Service
Digital Contents	"none"
Digital Media available	"Images raster / digital photography", "Text"
Paper Archive recipient	Suffolk CC Archaeological Service
Paper Contents	"none"
Paper Media available	"Report"

Project bibliography 1

Publication type	Grey literature (unpublished document/manuscript)
Title	Land Adjacent To The Old Eight Bells, The Street, Horham, Suffolk- Archaeological Evaluation Report
Author(s)/Editor(s)	Newman, J
Date	2015
Issuer or publisher	John Newman Archaeological Services
Place of issue or publication	Henley, Suffolk
Description	Loose bound client report and pdf
Entered by	John Newman (johnnewman2@btinternet.com)
Entered on	26 March 2015