



INDEX DATA	RPS INFORMATION
Scheme Title Lincoln Rd (A15) Leasingham.	Details Arch-Fieldwork Surv.
Road Number A15 .	Date Dec '98 .
Contractor Kate ORR .	
County Lincs .	
OS Reference TFO 4	
Single sided Double sided <input checked="" type="checkbox"/> A3 <input type="checkbox"/> Colour <input type="checkbox"/>	

✓

ARCHAEOLOGICAL FIELDWALKING SURVEY

AT LINCOLN ROAD (A15) LEASINGHAM

REPORT COMPILED BY KATE ORR

NORTH KESTEVEN HERITAGE OFFICER

DECEMBER 1998

Aims

The aims of the survey were to introduce interested members of the public to field archaeology and to record any archaeological finds.

Methods

The field was walked in 47 10m wide north south transects (see map). The transects were lettered A- Z from the western edge of the field. After Z the transects were given the letters AA, BB etc. to UU. The survey did not extend to the eastern edge of the field. Due to the irregular shape of the field, not all the transects were of uniform length i.e. transects A- Q were shorter. This accounts for the fewer artefacts found in these western transects.

Due to the participants' lack of fieldwalking experience they were instructed to pick up anything that looked man-made or man-used. The finds were not three dimensionally surveyed, however any concentrations of artefacts along the transects were noted. Approximately 55 people took part in the survey.

The finds were later washed and analysed. The City and County Museum did not wish to accept the finds but Roxholm Estates kept the arrowhead. A selection of some of the finds were given to Leasingham School. The remainder were disposed of.

Results

A broad range of artefacts were collected and some distributions recorded. A spread of Roman pottery (mainly greyware) was recorded in the central transects with a particular concentration in transects CC and DD. The concentration occurred approximately 100-200m from the northern edge of the field. Two possible tesserae from a mosaic or tessellated pavement were identified in Transect Y and one piece of Romano-British tegula in transect R which could indicate a Roman building. It is unusual for a Roman building to be located on the Heath as soils and water sources were poor in this area at that time.

An early Bronze Age flint barbed and tanged arrowhead with points broken off was found in transect DD which would indicate that this area was a hunting ground c.4000 years ago. Two pieces of Bronze Age pot were recorded from Transects M & TT respectively. A scattering of flint flakes were found, some of which had been worked and presumably used as tools in the prehistoric period.

A thin scatter of medieval pottery was recorded. This is compatible with the activity of spreading rubbish mixed with manure over the field in the Middle Ages.

Introduction

On the 8th of February 1998 Dave Start and Kate Orr of Heritage Lincolnshire led a fieldwalking survey as an event for the public. Permission to walk the field was kindly given by Roxholm Estates. The location of the field is centred on National Grid Reference TF 053 493 (see location map).

Location, Topography and Geology

The village of Leasingham is situated approximately 3km north of Sleaford and 24km southeast of Lincoln. The topography is relatively flat. The area lies approximately 30m above sea level. Local soils are the Aswarby Association, gleyic calcareous earths (Hodge et. al. 1984, 99).

The field is situated in the north west corner of the village. It is bounded by Lincoln road to the west, a track to the north and houses on 'The Link' to the south. There is no boundary on the east. The field had been ploughed a few weeks previously to the fieldwalk and conditions were rainy.

The area walked was 470m x 360m.

Archaeological Setting

There is a wealth of evidence in Leasingham of archaeological remains dating from the prehistoric through to the medieval period. Prehistoric activity is represented by a fragment of a Neolithic polished stone axe from approximately 1km west of the village (NK 36.7).

From within the survey area quantities of Roman pottery (NK36.3) have been found. A thin scatter of Roman pottery has also been recorded immediately to the west of the A15 in Roxholm parish (NK 51.5). 1 km to the west of the village (NK 36.12, NK 36.15), more Roman pottery has been recorded. A scatter of stone has been noticed in the field immediately to the north of the survey area which could be building stone.

Anglo-Saxon activity is represented by a spearhead located in the vicinity of the village (NK 36.13) and by fragments of pottery (which include medieval examples) located from the centre of the village near Hall Farm. The name Leasingham (spelt Levesingham in the Domesday Book of 1086) contains the Saxon element 'Ham' and probably means the Ham (or dwelling) of Leofsiges's people.

Undated artefacts from the area comprise two lead loom weights (NK 36.22) to the south east of the village and a ceramic spindle whorl (NK36.4) located within the survey area.

The Church of St Andrew was not mentioned in the Domesday Book but contains Norman carved stone. Trollope (1872) writes of a second church in the village in the twelfth century; that of St John the Evangelist. The Lords of the Manor of Leasingham in the twelfth century had connections with Haverholme Priory; the monks and nuns being given pasture land and rights to drive their vehicles across the Lord's land.

Trollope states that there were formerly two village crosses, neither of which survives. One called the Butter Cross stood opposite the road leading to Roxholm. The other, termed the Bakers Cross stood on the rising ground north of the village near the present turn in the Lincoln Road (possibly adjacent to the survey area).

Other buildings have 16th and 17th century origins (Pevsner and Harris, 1989, 431).

List of Terms used:

Prehistoric = before c.43AD

Bronze-Age = c.2000 - c.600BC

Romano-British (RB) = c.43.AD - c.410AD

Early Saxon = c.410 - 600AD

Medieval (Med) c.1200 - 1400AD

Late Medieval (Late Med) c.1400 - c.1500AD

Post Medieval (Post Med) = c. 1500 - 1800AD

Modern = c.1880 - present day.

FINDS ANALYSIS BY HILARY HEALEY (NDD, M. PHIL, FSA)

Transect	Finds Details
A	Modern - 2 glass, 2 x pottery, 1 iron hinge
B	Prehistoric - 1 waste flint flake Modern - 3 x pottery, 1 drain
C	RB - 1 x pottery Med - 2 x pottery Post Med - 3 clay pipe stems, 1 cream pot (2 nd ½ 18 th C) Modern - 6 x pottery, 3 tile, 2 iron objects
D	Med - 1 x pottery, 1 iron door stud? Post Med - 1 clay pipe, 1 slip ware, 1 Bourne D Ware (16 th -17 th C), 7 black ware (17 th -19 th C) Modern - 6 drain, 1 mirror fragment
E	Med -5 x pottery, 3 Cistercian Ware (15 th -16 th C) Post Med - 1 clay pipe Modern - 9 x pottery, 14 tile or drain, 1 glass, 1 slag, stones containing iron, 2 iron objects
F	Prehistoric - 1 flint flake Med - 3 x pottery Modern - 9 x pottery, 4 drain, 7 glass (some possibly 18 th C), ironstone?, 1 iron object
G	RB - 7 greyware, Med - 3 x pottery Post Med - 2 x pottery (17 th C), 6 clay pipe Modern - 8 x pottery, 3 iron nails, 1 iron scrap, 1 slate
H	Post Med - 2 black pottery(17 th C), 1 horse tooth
I	RB - 1 greyware Med -1 pottery Post Med- 1 x pottery (17 th C) Modern - 5 x pottery, 2 drain, 1 horse tooth
J	RB - 1 greyware Med - 4 x pottery (3 Cistercian ware 15 th -16 th C) Post Med - 4 black (17 th C), 4 tile, 1 horse tooth
K	Late Med - 1 x pottery, Post Med - 3 Bourne D Ware (16 th -17 th C), 4 Black(16 th C), 3 tile, 1 slag
L	Prehistoric - 1 flint flake RB - 1 greyware, 1 samian Med - 2 x pottery Post Med -1 Bourne D Ware (16 th - 17 th C) 2 x 17 th C pottery Modern - 3 x pottery, 3 tile, 1 glass
M	Prehistoric - 2 flint flakes, 1 Bronze Age pottery RB - 4 greyware Med - 1 Cistercian Ware(15 th -16 th) Post Med - 1 Bourne D Ware (16 th -17 th), 2 x 17 th C pottery, 2 clay pipes

N	Prehistoric - 5 worked flints, RB - 1 greyware, Med - 2 x pottery Post Med, 2 Bourne D Ware, 4 clay pipe, 1 Staffordshire Ware (17 th -18 th C), 1 x 18 th C pottery Modern - 1 x pottery, 1 tile, 1 oyster shell, 3 iron nails
O	Prehistoric - 1 flint flake RB - 8 greyware Post Med- 1 Staffordshire, 1 cream ware Modern - 13 x pottery, 1 bone
P	Prehistoric - 1 flint flake RB - 8 Greyware Post Med - 5 x 18 th /19 th pottery Modern - 1x pottery, 4 tile, 1 bone, 1 whetstone
Q	RB - 3 Greyware Post Med - 2 Staffordshire, 4 Black, 6 tile Modern - 1 x pottery, 1 glass, 1 mica-schist hone, 1 lead strip, 1 iron nail
R	RB - 12 greyware (small pieces), 1 tegula Med - 1 x pottery, Post Med- 4 clay pipe, 1x 17 th C pottery Modern -6 x pottery, 4 tile, 1 tooth fragment, 4 glass, 1 copper alloy disc with hole, 1 piece of metal, 2 ironstone, 1 oyster shell
S	RB - 2 Greyware Med- 1 x pottery Post Med - 1 Bourne D Ware, 3 x 17 th C Modern - 20 x pottery, 10 tile, 1 flat whetstone, 1 iron crumb
T	Prehistoric - 1? flint flake RB - 5 greyware Med - 3 x pottery Post Medieval- 4 clay pipe Modern - 13 x pottery, 5 tile, 1 iron nail, 1 slag
U	Prehistoric - 1 flint flake? RB - 1 amphora and 2 greyware Med - 1 x pottery Post Med - 4 clay pipe, 1 x 17 th C Modern - 5 x pottery, 6 tile, 1 whetstone
V	Prehistoric - 1 tiny flint flake RB - 4 greyware and 1 red Med- 1x pottery Post Med - 9 clay pipe Modern- 10 x pottery, 4 drain, 1 horse tooth, 2 glass, 1 oyster shell
W	Prehistoric - 1 flint flake ? RB- 2 greyware Early Saxon - 1x pottery Post Medieval -3 clay pipes Modern - 10 x pottery, 3 tile, 1 iron fragment
X	RB- 5 greyware Post Med- 1 Bourne D Ware, 5 clay pipe Modern - 22 x pottery, 13 drain (possibly 1 med), 1 glass, 1 iron fragment
Y	RB - 4 greyware, 2 tesserae? Post Med - 4 x pottery (18 th C) Modern - 3 x pottery, 3 tile, 1 horse tooth
Z	Post Med -2 clay pipe (19 th C), 1x 18 th C pottery Modern- 6 x pottery, 2 iron fragments

AA	Prehistoric - 1 waste flint flake RB- 6 incl. shelly jar base Post Med- 2 clay pipe, 2x 18 th C Modern - 8 x pottery, 1 drain, 1 horse tooth, bone, 6 glass, 1 iron fragment, coal
BB	Prehistoric - 1 waste flint flake RB - 6 greyware, 1 Samian Post Med - 1 Bourne D Ware, 2 clay pipe (17 th C), 2x 18 th C pottery Modern - 2 x pottery, 8 tile/ drain, 4 small bones, 3 modern glass, 2 iron objects
CC	Prehistoric - 1 partly worked flint RB -21 greyware (1 with tiny hole), 1 shelly Modern- 3 x pottery, 2 drain, 3 tile, 1 brick, 1 slate, 2 tiny glass, 1 iron object, 1 lead? musket ball, 1 piece shale
DD	Prehistoric - 1 barbed and tanged flint arrowhead, 1 possible flint core, flint flakes, RB- 13 greyware, 1 red Post Med- 1x17 th C pottery, 3 clay pipe (1x17 th C & 1x 18 th C) Modern -18 x pottery, 1 pantile, 5 tiles, 1 tooth, 2 glass, 1 oyster shell
EE	RB- 6 greyware, 1 samian, 1 sandy Med - 3 x pottery Post Med- 3 clay pipe (1x 17 th & 2x 18 th C) Modern- 30x pottery, 3 drain, 8 tile, 3 brick, 1 tiny bone, half iron horseshoe
FF	Prehistoric - 2 flint?, (1 cracked), RB - 2 greyware, 1 sandy Post Med- 6 clay pipe (3x 17 th C) Modern - 14 x pottery, 2 tile, 4 modern glass, 1 slate, 1 oyster shell
GG	Prehistoric - 1 burnt flint flake, 1 large flint scraper (damaged) RB -12 greyware, 1 buff Post Med- 2 clay pipe(17 th C), 1x Bourne D Ware, 1x 18 th C clay pipe Modern - 21 x pottery, 2 tile, 2 tooth fragments, 1 cow? leg? bone, 1 oyster
HH	Prehistoric - 1 flint flake RB- 2 greyware, 2 large shelly rim Post Med- 7 clay pipes(18 th C and later), 22 Black, 16 white or blue/white, 1 saltglaze
II	RB - 4 Greyware Late Med - 1 costrel handle Post Med - 4 clay pipe (17 th - 19 th C) 1 x 18 th C pottery, Modern - 12 x pottery, 3 tile, 4 drain, 3 tooth fragments. 2 glass(18 th & 19 th C). 1 oyster
JJ	Prehistoric -1 flint flake, 1 flint narrow blade RB- 2 Greyware Med- 1 x pottery Post Med - 9 clay pipes (17 th & 18 th C) 1 slip pot (17 th C) Modern -19 x pottery
KK	Prehistoric - 3 flints? RB - 14 (small) Med - 1x pottery, 1 Potterhanworth ware Post Med- 5 clay pipes (3 x 17 th C), 1 clay pipe bowl(18 th C) Modern -3 x pottery, 1 fragment pantile, 3 oyster shell. 1 cockle
LL	Med - 1 x pottery Post Med -1 Bourne D ware, 2 clay pipe (17 th C) Modern - 10 x pottery, 1 button, 1 ironstone
MM	Prehistoric- 1 flint flake RB -5 greyware Med - 4 x pottery, 1 Potterhanworth ware Post Med - 6 clay pipes(17 th 7 18 th C), Modern -1 clay pipe bowl (19 th C). 8 x pottery. 1 pantile. 4 tile. 2 slag. 1 oyster shell

√	<p>Prehistoric - 2 flint flakes RB - 7 greyware Med - 6 x pottery Post Med - 1 Bourne D ware, 17 clay pipes, 6 clay pipe bowls (3x 18th C) Modern -20 x pottery, 16 tile, 2 oyster, 1 cockle</p>
OO	<p>Prehistoric- 2 waste flint flakes, 1 burnt flint Med- 1 x pottery Post Med- 2 clay pipe bowls (1x 19th C), 15 clay pipes (18th/19th C), 1 china dolls foot, 3 tile, 2 iron objects, 1 oyster shell</p>
PP	<p>RB- 2 greyware Post Med- 2 Bourne D Ware, 3 clay pipes (18th C), 13 x pottery (18th C), 5 tile. 4 modern glass, 1 iron link, 1 slate, 1 oyster</p>
QQ	<p>Post Med - 2 clay pipe with spur (19th C)7 clay pipes (18th C) Modern - 2 x pottery</p>
RR	<p>Prehistoric - 1 flint flake? RB - 5 greyware Med- 3 x pottery inc.jug handle Post Med - 7 clay pipe (18th C), 1 x Westerwald pottery(early 17th C) Modern - 14 x pottery, 3 tile, 1 glass 1 fossil bivalve</p>
SS	<p>Modern - 11x 19th C pot, 6 tile/ drain, 1 pantile, 1 stone with possible artificial hole</p>
TT	<p>Prehistoric- 1 x Bronze Age pottery Med- 2 x pottery Post Med- 2 clay pipes Modern- 14 x pottery, 16 misc tile/ drain or brick, 1 halfpenny, 1 possible shale</p>
UU	<p>RB - 2 greyware Med - 2 x pottery Post Med- 1 clay pipe complete bowl, 5 clay pipes Modern - 9 x pottery, 2 tile, 1 bottle (18th C), 1 oyster shell</p>

Bibliography

Erkwall, E. 1974. *The Concise Oxford Dictionary of English Placenames* (Fourth Edition)

Hodge, C.A.H, Burton, R.G.O, Corbett, W.M, Evens, R and Seale, R.S. 1984 *Soils and their uses in Eastern England*, Soil survey of England and Wales 13

Pevsner, N and Harris, J. 1989 *Lincolnshire, the Buildings of England* (2nd Edition, revised by Antram, N)

Trollope, E. 1872 *Sleaford and The Wapentakes of Flaxwell and Aswardhun*

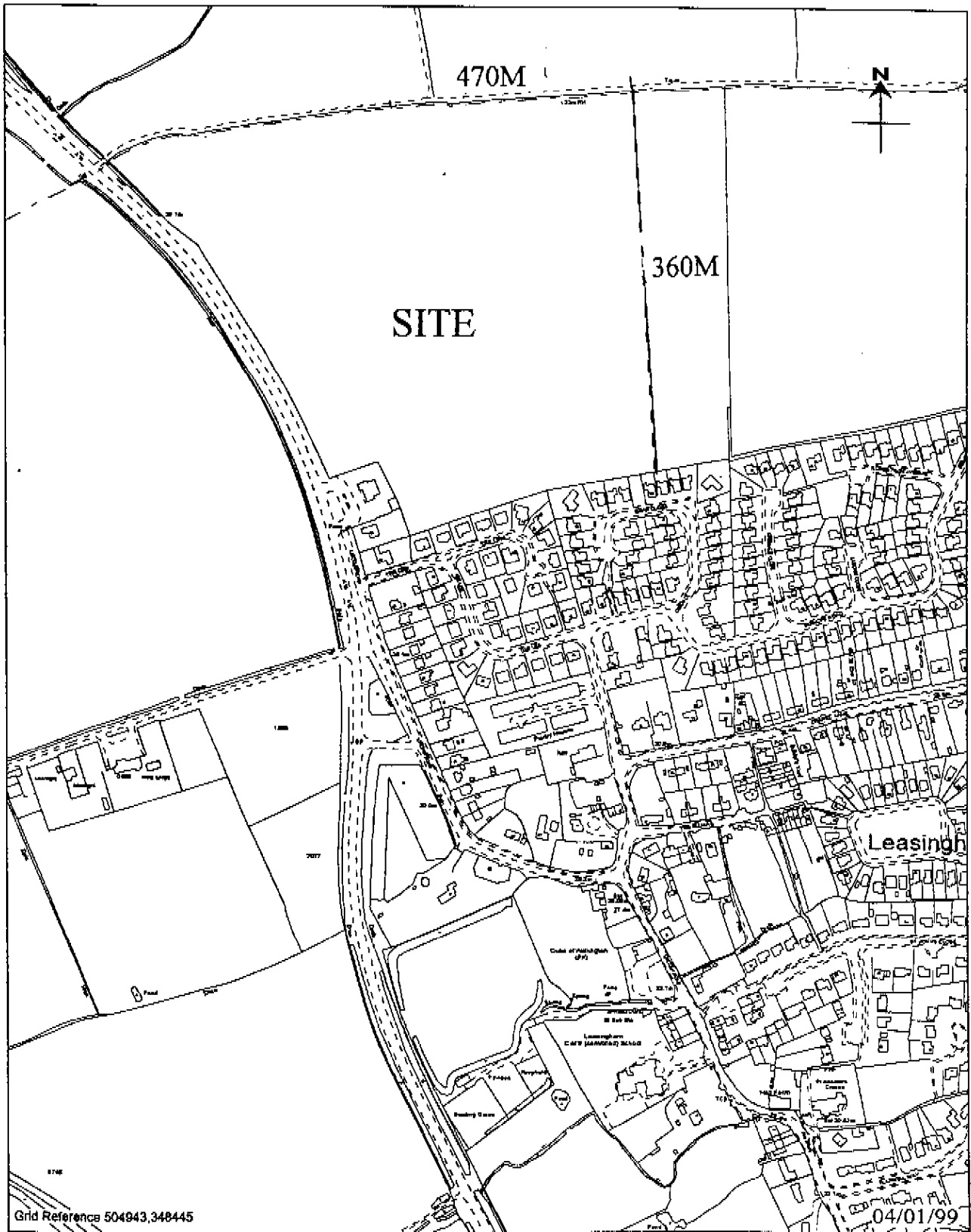

Reproduced from or based upon the 1995 Ordnance Survey mapping with the permission of the Controller of Her Majesty's Stationery Office (c) Crown Copyright. Licence No. LA078808.



NORTH
KESTEVEN
DISTRICT
COUNCIL