

INDEX DATA	RPS INFORMATION
Scheme Title A63 Selby Bypass	Details Maps.
Road Number A63	Date 1999
Contractor BHWB	
County YORKS	
OS Reference SE63	
Single sided Double sided A3 8 Colour 8	

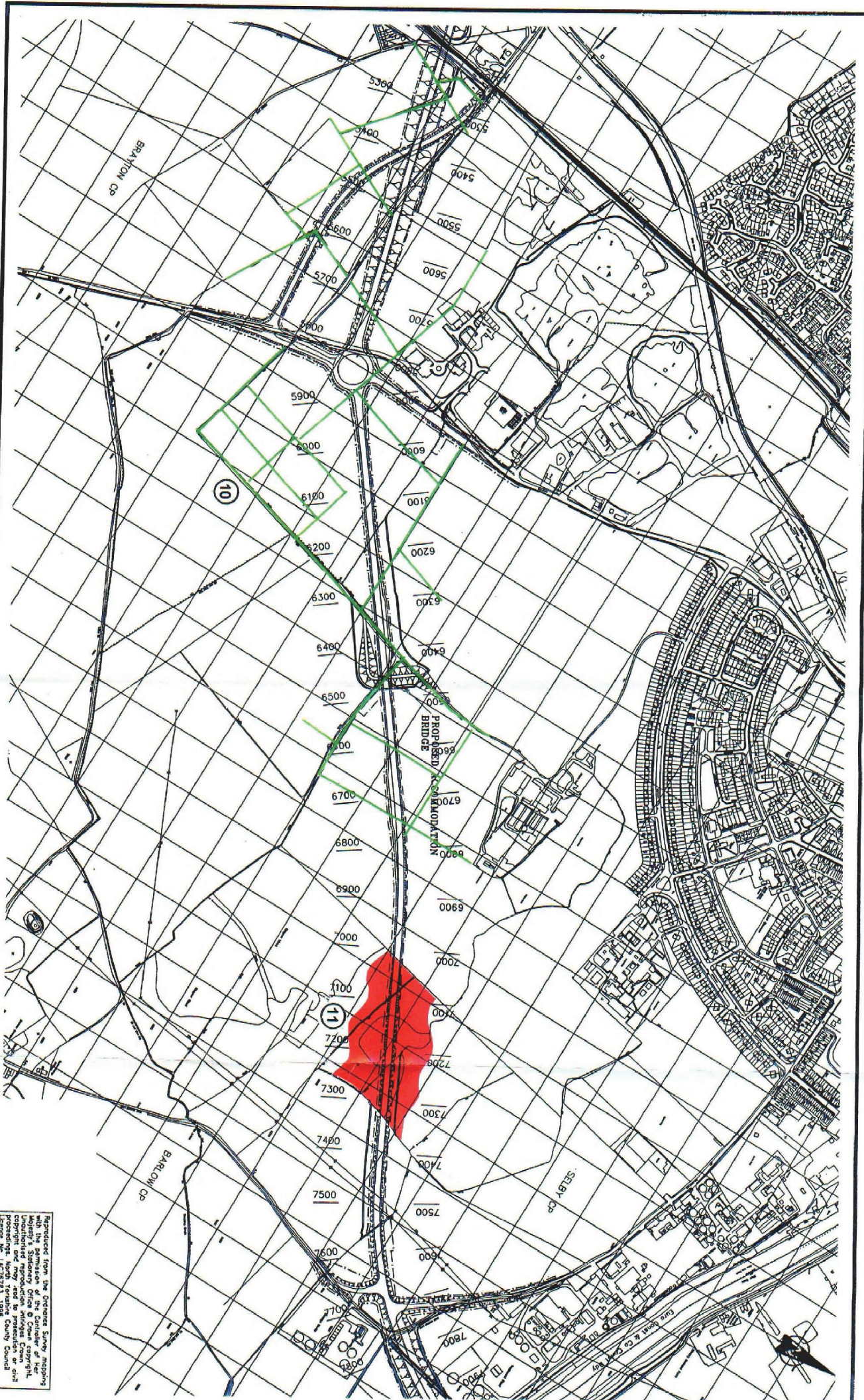

Reproduced from the Ordnance Survey, mapping
 copyright © Crown Copyright and the
 Controller of Her Majesty's Stationery Office & Crown
 Copyright 1998. All rights reserved. No part of this
 publication may be reproduced, stored in a retrieval
 system, or transmitted in any form or by any means
 electronic, mechanical, photocopying, recording, or
 otherwise, without the prior written permission of the
 Controller of Her Majesty's Stationery Office.
 Licence No. UC/78723, 1998.

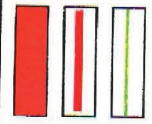

FIELD BOUNDARIES

ARCHAEOLOGICAL FEATURES

ARCHAEOLOGICAL SITES

Project

A63 SELBY BYPASS

Title

ARCHAEOLOGICAL SITES

Project No. 904

Date MAR 99



Client

HIGHWAYS AGENCY

Scale



Figure

3

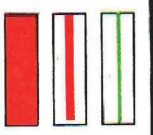
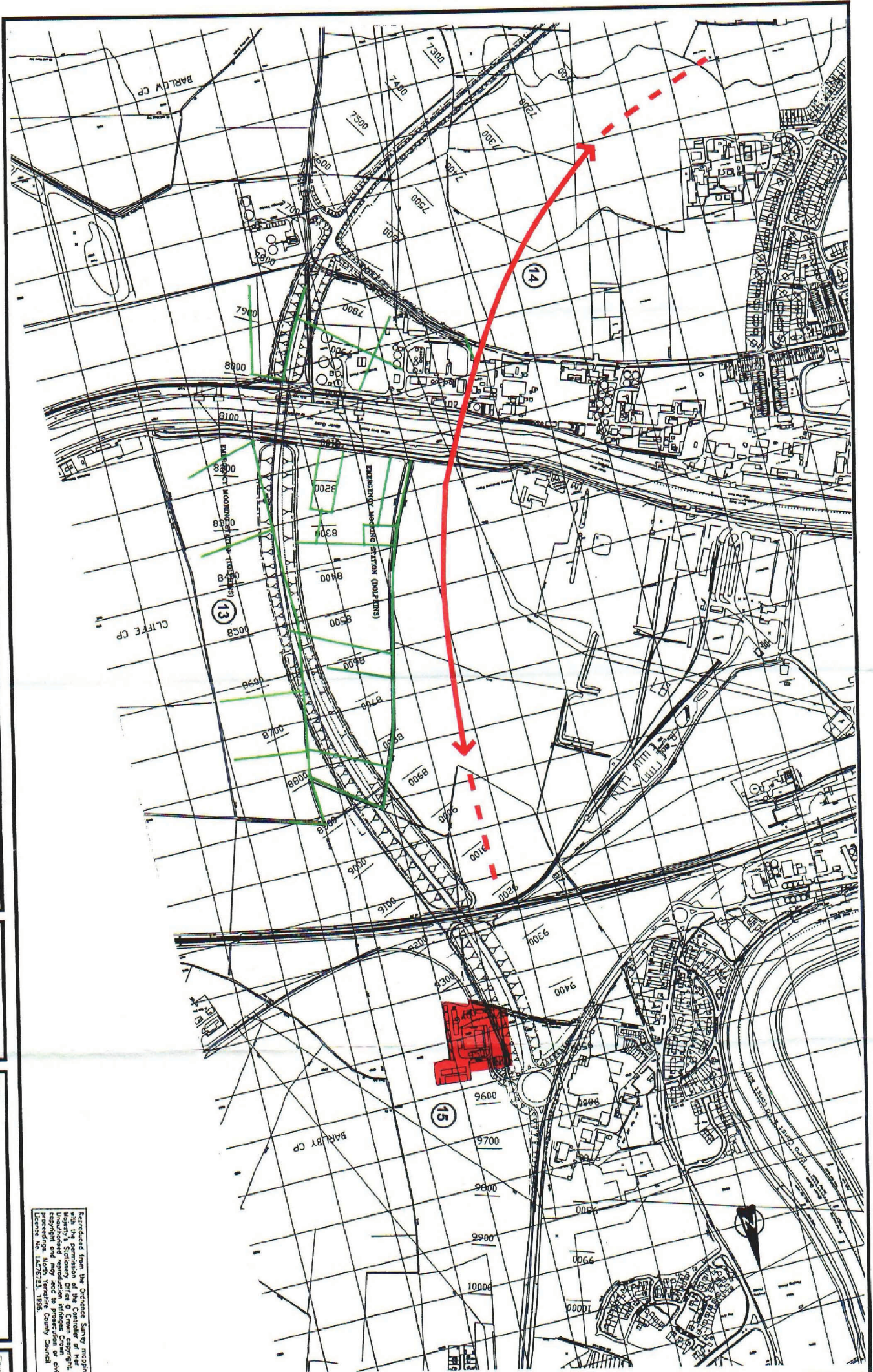

FIELD BOUNDARIES

ARCHAEOLOGICAL FEATURES

ARCHAEOLOGICAL SITES

Project: **A63 SELBY BYPASS**

Title: **ARCHAEOLOGICAL SITES**

Project No. 904

Date: MAR 99

Client: **HIGHWAYS AGENCY**



Figure: **4**

Reproduced from the Ordnance Survey mapping with the permission of the Controller of Copyright. No responsibility is accepted for reproduction without the Controller's permission and any use is at the user's own risk. Ordnance Survey, 100, Broad Street, Birmingham, B1 2DT. Ordnance Survey, 100, Broad Street, Birmingham, B1 2DT. Ordnance Survey, 100, Broad Street, Birmingham, B1 2DT.

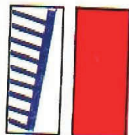

PROPOSED INITIAL FIELD WALKING
PROPOSED GEOPHYSICAL SURVEY

Project
A63 SELBY BYPASS
 Title
ARCHAEOLOGICAL STAGE 3 WORKS
 (TO DATE)

Project No. 904
 Date **MAR 99**

Client
HIGHWAYS AGENCY

Figure
5

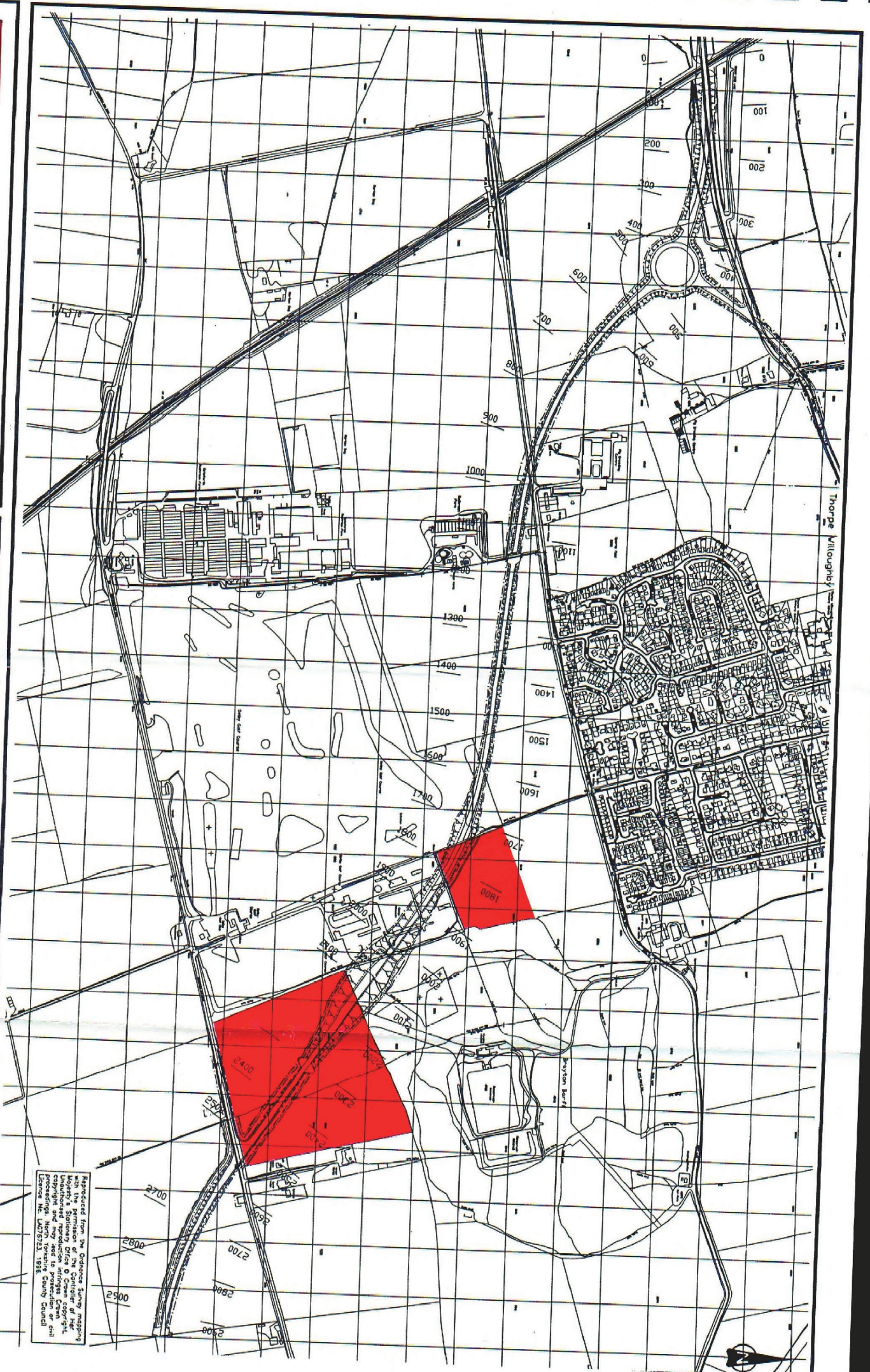

Reproduced from the Ordnance Survey mapping
 Major's Station of the Controller of Her
 Majesty's Stationery Office. All rights reserved.
 Underneath reproduction without copyright
 permission may not be given to the
 Controller of Her Majesty's Stationery Office
 Licence No. 1407833 1998. County Council

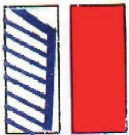

PROPOSED INITIAL FIELD WALKING

PROPOSED GEOPHYSICAL SURVEY

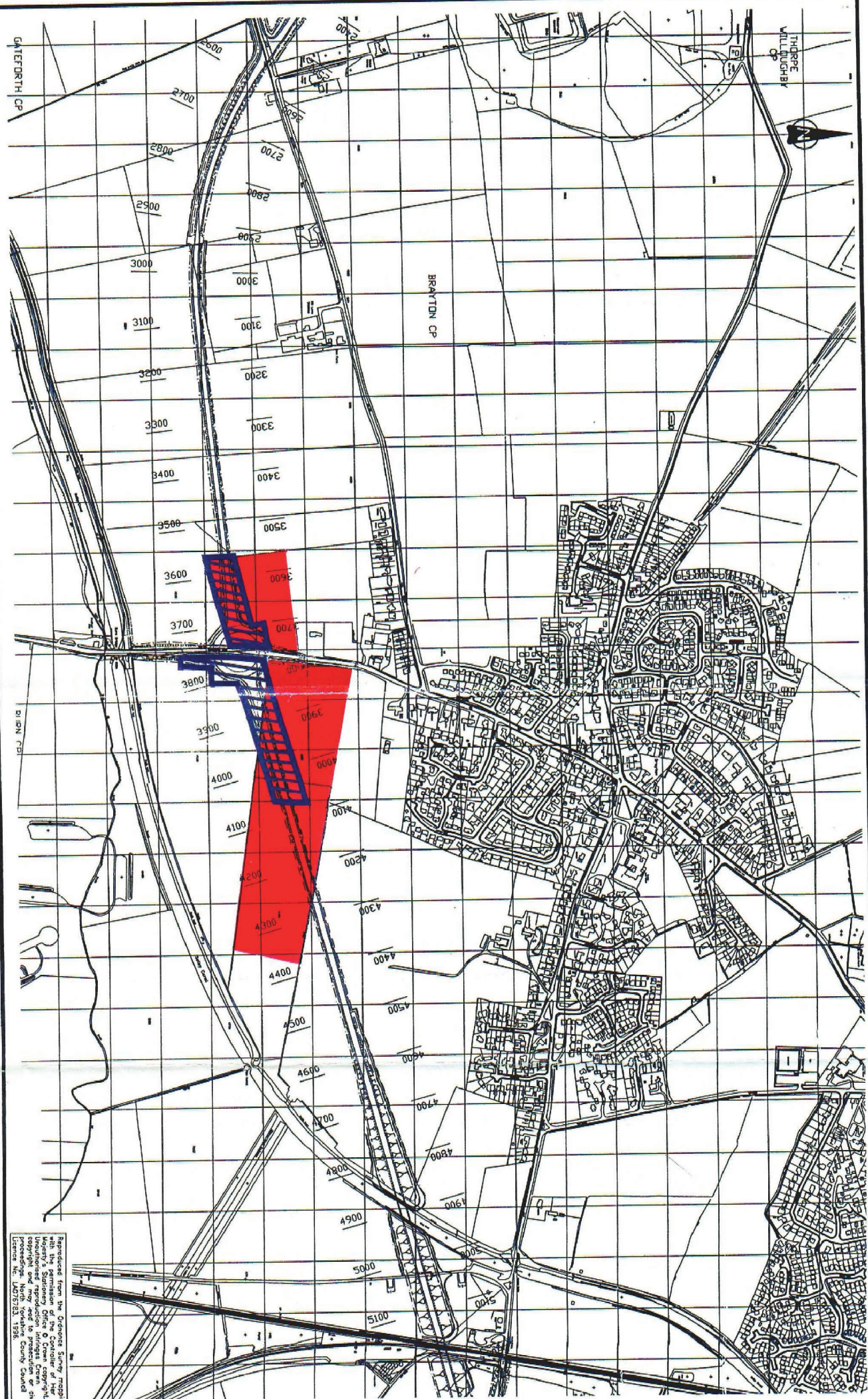

Reproduced from the Ordnance Survey mapping with the permission of the Controller of Her Majesty's Stationary Office © Crown copyright. All rights reserved. No part of this publication may be reproduced, stored in a retrieval system or transmitted in any form or by any means, electronic, mechanical, photocopying, recording or otherwise, without the prior written permission of the Controller of Her Majesty's Stationary Office. Ordnance Survey Licence No. LM07513, 1996.

Project **A63 SELBY BYPASS**

Title **ARCHAEOLOGICAL STAGE 3 WORKS (TO DATE)**

Project No. **904**
Date **MAR 99**



Client **HIGHWAYS AGENCY**



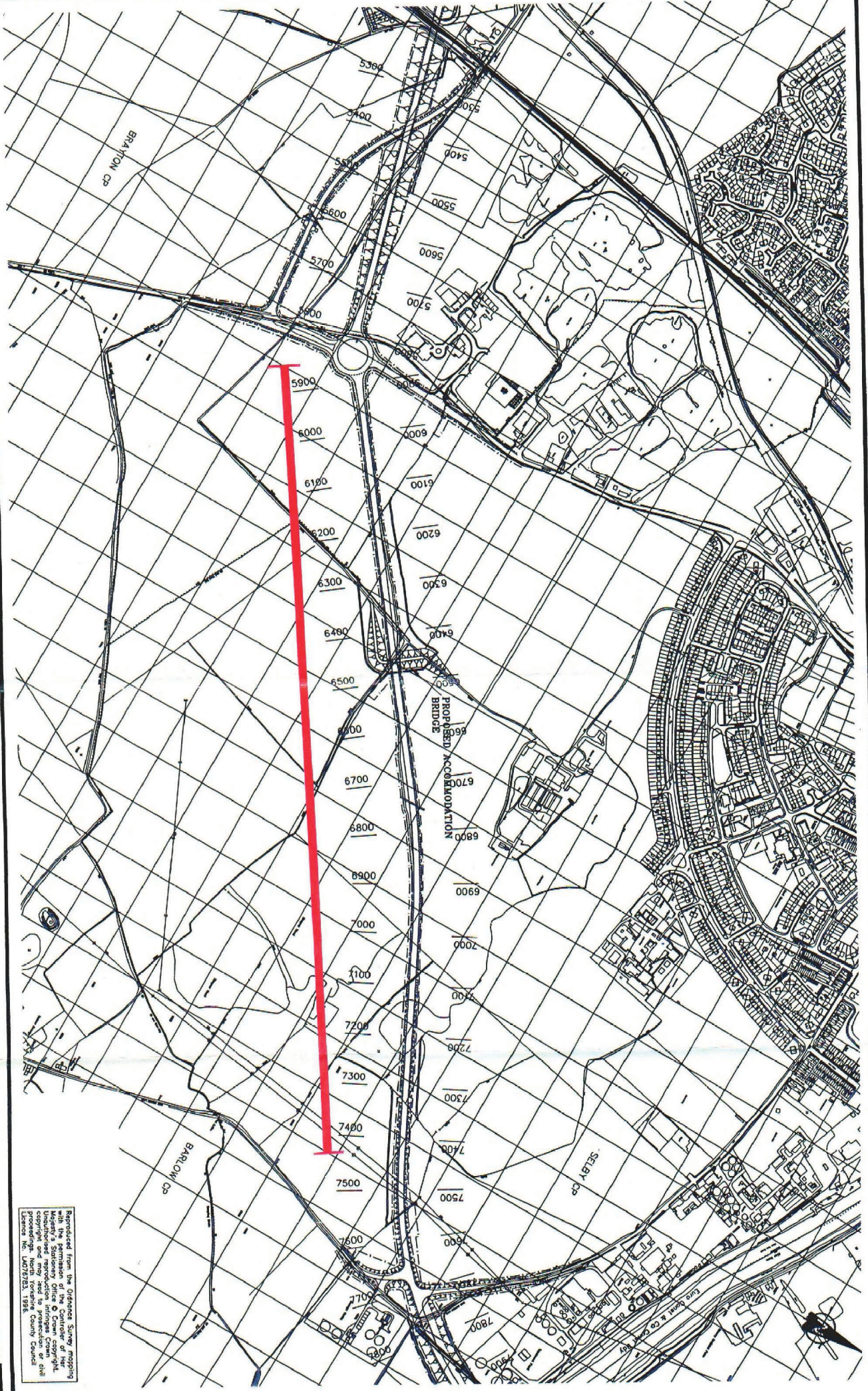

Extracted from the Ordnance Survey mapping with the permission of the Controller of Her Majesty's Stationery Office. Crown Copyright. Unauthorised reproduction or publication of this proceedings. North Devon County Council. Licence No. 1007823, 1998.



TO BE DETERMINED

NO STAGE 3 WORKS PROPOSED AT PRESENT

Project

A63 SELBY BYPASS

Project No. 904

Date **MAR 99**

Client

HIGHWAYS AGENCY

Title **ARCHAEOLOGICAL STAGE 3 WORKS (TO DATE)**



Figure **7**

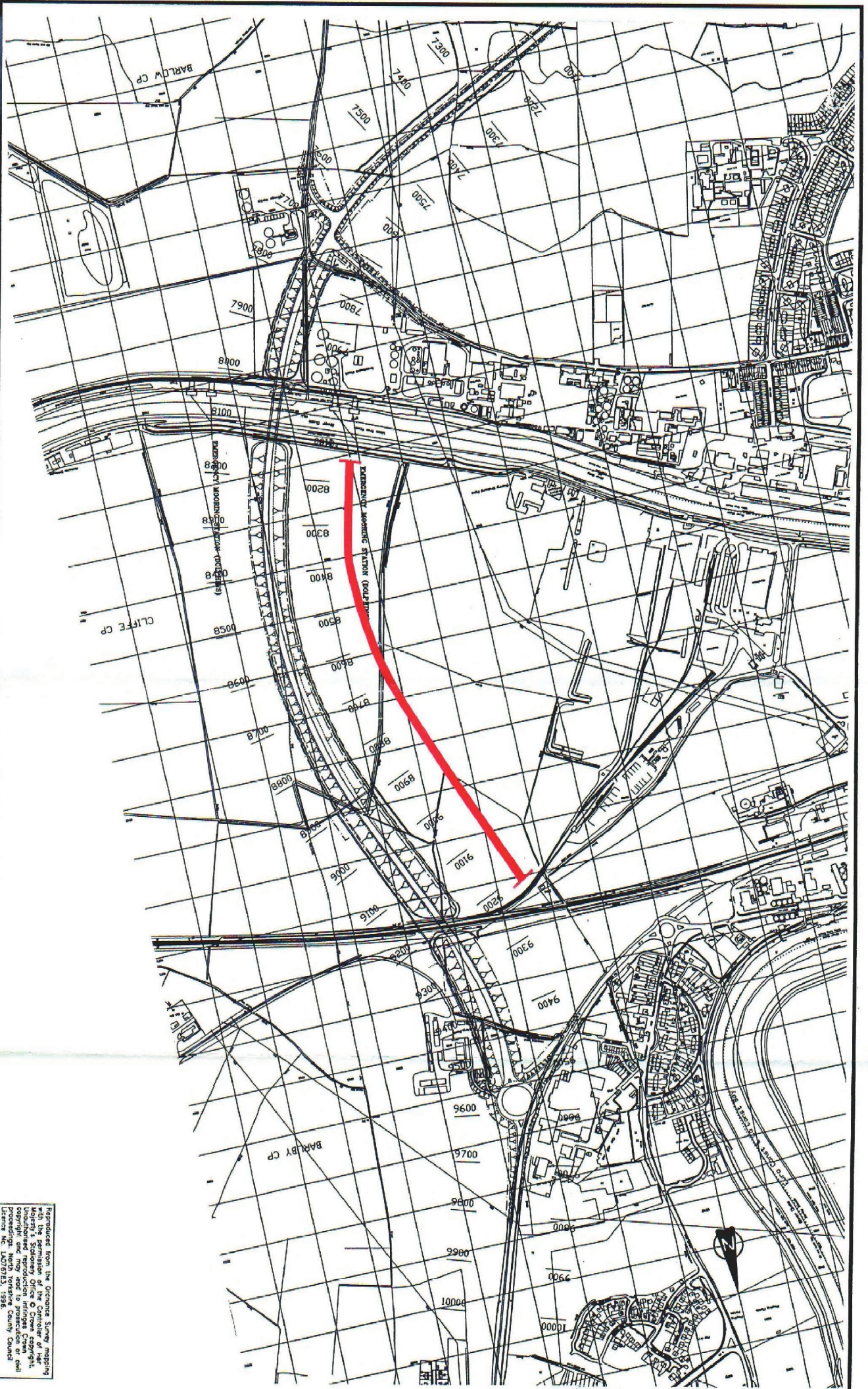

Reproduced from the Ordnance Survey mapping with the permission of the Controller of Her Majesty's Stationery Office © Crown copyright. Ordnance Survey reproduction in respect of the copyright in the map is by permission of the Controller of Her Majesty's Stationery Office. North Yorkshire County Council Licence No. LA07913, 1986.

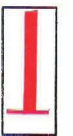

TO BE DETERMINED

NO STAGE 3 WORKS PROPOSED AT PRESENT

Project

A63 SELBY BYPASS

Project No. 904

Date MAR 99

Client

HIGHWAYS AGENCY

Figure

Title

**ARCHAEOLOGICAL STAGE 3 WORKS
(TO DATE)**



Scale



8