



LINDSEY ARCHAEOLOGICAL SERVICES

**Land At Bunkers Hill, Greetwell, Lincoln.  
Archaeological Fieldwalking  
and Geophysical Survey  
Site code: LBH 96  
LCNCC Museum Accn No: 156.96  
NGR: TF 0015 7280**

**Report  
for**

**Smiths Gore Chartered Surveyors  
on behalf of**

**The Church Commissioners  
and Mr N. Ward**

**Report No:264  
November 1997**



## Contents

List of Figures

List of Plates

Summary

Introduction

Archaeological Background

Fieldwalking Methodology

Results

Area A

Area B

Area C

Area D

Discussion

Conclusion

Acknowledgements

References

Appendix 1: Finds List

Appendix 2: Post-Roman Pottery Archive List

Appendix 3: Contents of Site Archive

Plates

EVENTS 42857 42858

SOURCE 47537 47538

70178 Prehistoric

70179 Prehistoric

54248 Medieval to modern

70220 Roman

70221 Prehistoric

50348 Prehistoric

54602 Undated

1

1

2

2

3

3

4

5

5

5

6

7

7

## Figures

Fig. 1 Location of proposed development site. Reduced from a 1:10,000 Ordnance Survey map. reproduced with the permission of the Controller of HMSO © Crown copyright. (LAS Ordnance Survey Licence No. AL 50424A).

Fig. 2 Fieldwalking area with features mapped from aerial photographs.

Fig. 3 Artefact distribution from fieldwalking. Scale 1:1250. (Midland Surveying and Engineering)

Fig. 4 Gradiometer survey areas in relation to artefact distribution from fieldwalking survey. (Reduced scale)

## Plates

Pl.1 Area A. East end of the field. Looking north.

Pl.2 Area A. Looking north west.

Pl.3 Area B. Note crop either side of ploughed area. Looking south east.

Pl.4 Area D. Looking south west.

**Land At Bunkers Hill, Greetwell, Lincoln**  
**Archaeological Fieldwalking Survey**  
**Site code: LBH 96**  
**LCNCC Museum Accn No: 156.96**  
**NGR: TF 0015 7280**

**Summary**

*A preliminary archaeological assessment identified a triple linear ditch system, showing as a cropmark on aerial photographs, crossing the proposed development site. Of the 383 finds retrieved the majority proved, upon examination, to be either post-medieval in date (later discarded) or undiagnostic. Only a small quantity of Roman tile was retrieved and there was no Roman pottery. The medieval and post-medieval pottery and tile probably represent manuring of cultivated fields rather than evidence of occupation. Concentrations of post medieval brick and tile in the SE corner of the survey area are probably associated with the demolition of the farm complex adjacent to the survey area.*

*Geophysical survey showed that the ditches cross the eastern half of the development area in a continuous line, possibly underlying colluvium and/or alluvium at the southern limit of the survey area. A ring-form within an oval enclosure may have been deliberately avoided by the triple ditch, suggesting they are of an earlier date. A second ring form was identified south of the triple ditches.*

*The geophysical survey results elsewhere within the proposed development area show that it is generally quiet with spots of enhanced magnetism revealing a only few possible pits and linear anomalies of unknown date and function.*

**Introduction**

Lindsey Archaeological Services was commissioned in November 1995 by Smiths Gore Chartered Surveyors (acting on behalf of The Church Commissioners and Mr N. Ward) to carry out a fieldwalking and geophysical survey of land at Bunkers Hill, Lincoln. The evaluation followed a preliminary archaeological assessment, prepared by John Samuels Archaeological Consultants for Smiths Gore Chartered Surveyors in September 1994.

The fieldwork was undertaken in accordance with the requirements of the Brief prepared by John Samuels Archaeological Consultants (December 1994). The purpose of the evaluatory work was to:

- establish the presence or absence of archaeological remains and their location within the survey area;
- determine the level of further archaeological investigation required prior to development.



This report should be read in conjunction with the results of the geophysical survey carried out by Oxford Archaeotechnics and presented in the accompanying report (Johnson 1997).

Copies of the reports have been sent to Smiths Gore Chartered Surveyors, The Church Commissioners, Mr N. Ward, West Lindsey District Council, Lincoln City Council, the Archaeology Section of Lincolnshire County Council, and the City and County Museum, Lincoln. The paper archive and the artefacts will be lodged with the City and County Museum, Lincoln when the project is completed.

### **Archaeological Background**

The survey area lies east of the city of Lincoln on the south-east slope of the Jurassic Limestone Scarp known as the Lincoln Edge and overlooking the Witham Valley.

Previous work in the surrounding area has identified archaeological remains of prehistoric, Roman and medieval date. This includes a triple linear ditch boundary, recorded from the air as cropmarks, which crosses the survey area on its east side. These ditches have been traced both north and south of the survey area for a minimum of 5km but their full extent is not yet known. Staff now working at LAS have excavated two narrow cross-sections through the ditches in 1979 and 1993. Whilst they appear to pre-date Roman features, little clear evidence of their function and date has been obtained so far.

Land to the south of the survey area has been the subject of a separate archaeological survey which has confirmed the continuation of the triple ditch and geophysical survey has identified numerous additional features such as pits and enclosures which appear to overlie the ditches. These features are not visible on existing aerial photographs. Large quantities of associated Roman and medieval pottery and tile have been made.

### **Fieldwalking Methodology**

The brief prepared by John Samuels Archaeological Consultants treated the proposed development area as one block of land (Fig. 2). For ease of fieldwalking the land was divided into four areas defined by existing field boundaries and trackways (Fig. 3). Except for a narrow strip c.1ha in area, Area B contained an oil seed rape crop, which made visibility too poor for fieldwalking (Pl. 3). Area D was only partially ploughed and this further reduced the area available for walking.

Fieldwalking was carried out by a team of three archaeologists walking transects across the land at 10m intervals, giving a 10% coverage of the ground. All finds were individually and two-dimensionally recorded using a Total Station geodimeter, operated by Midland Surveying and Engineering (MSE). Each fieldwalker was supplied with pre-labelled finds bags, a surveying staff with prism, and a two-way radio. The position of each find was immediately recorded through radio contact with the MSE surveyor. This precluded the need to set out a grid. The use of the geodimeter also allowed



the limits of each area walked, as well as permanent landscape features such as field boundaries, and trackways to be accurately recorded (Fig. 3).

In accordance with the brief, the presence of post-medieval material was noted but not intentionally picked up. Inevitably, post-medieval pieces were only identified after washing. Animal bone was not collected as this cannot normally be assigned to any specific archaeological period. In the event very few pieces were seen.

Conditions for finds retrieval were generally fair, as Areas A, C and D, plus a narrow strip of Area B, had been recently ploughed. Area C and a central band of Area A, c.70m wide (aligned NE - SW), were harrowed. The fields showed little sign of weathering. For most of the two days on site the weather was sunny with little cloud cover, providing poor visibility during the early morning and late afternoon. It is probable, however, that the low recovery rate largely reflects the real quantity of material present and not poor visibility of finds.

## **Results**

A total of 383 finds were made, the majority of them post-medieval in date (46 pottery, 12 brick, 37 tile and 39 miscellaneous) or non-diagnostic (71 tile and 14 pottery sherds). Post-medieval finds were discarded after being recorded in accordance with the brief, (Appendix 1; Fig 3). Undiagnostic tile was also discarded, after being weighed.

Assessment of the finds assemblage (prior to discarding artefacts) showed it to comprise 234 fragments of tile, 12 brick fragments, 90 pieces of pottery, 3 struck flints, 4 pieces of glass, 1 clay pipe stem and 39 miscellaneous artefacts. There was such an abundance of tile on the ground that only a sample was retrieved within the transects, so the proportion of tile to other artefacts was even greater than the figures suggest.

**Area A** covered the largest area (Pls.1 and 2), comprising at least three former fields whose boundaries had been removed. The dry ploughsoil contained a moderate, fairly even scatter of limestone fragments, presumably derived from the underlying bedrock. Patches of natural orange brown clay silt were also noted.

Post-medieval brick and tile artefacts were evenly spread across this area. They may have originated from Greetwell North Farm, scattered after its demolition. Post-medieval bricks (complete) were noted on the NE-SW aligned hedge border at the NW corner of Area A, close to the copse. These finds were not retrieved or plotted.

7 fragments of Roman tile were found in this Area together with 17 sherds of pottery and 35 pieces of tile, all of medieval date. One piece of tile of either Roman or medieval date was also retrieved. The remainder of finds in Area A proved to be post-medieval in date.



Two blocks of magnetometer survey were carried out in Area A (Fig. 4). These comprised two grids in the NE corner (Area 3, Johnson 1997, Fig. 9) and a block of 18 grids along the length of the triple linear ditch system, 4 of which extended into Area D (Area 5, Johnson 1997, Fig. 12). These grids covered zones of enhanced magnetism identified on the magnetic susceptibility survey.

Area 3 identified a diffuse linear anomaly, possibly a former field boundary, and a number of small magnetic anomalies indicative of former pits or hollows. Very few finds were made within the two grids although four pieces of Roman tile were found on the periphery.

Area 5 was arranged in a stepped configuration along the triple ditches which were clearly defined. The ditches deviate to the west, as if avoiding an unknown feature. This coincides with a possible oval feature, showing as a negative anomaly, containing a ring-ditch (Johnson 1997, Fig. 12). It is of note that this area of the field produced hardly any finds during the fieldwalking survey. Whilst the triple ditches themselves were not expected to produce finds because of their presumed prehistoric date the lack of medieval and post-medieval finds was more surprising. The reason for this lack of finds may be that banks associated with the ditches may have been ploughed out only relatively recently, masking any earlier remains.

Although the north-eastern extension of the magnetometer survey in Area 5 covered an area within which cropmarks had been observed (Fig. 2) no linear features corresponding with the cropmarks were recorded.

Linear features orientated perpendicular to the triple ditches probably represent the remains of medieval ridge and furrow.

**Area B** (Pl.3) was defined by hedges to the south, east and west, with the southern extent of the sports ground and the car park of the Lincolnshire Poacher Inn backing onto its northern boundary. All but a strip of ploughed land, 0.97 ha, was under a crop of oil seed rape which obscured the ground, making fieldwalking impossible. The ploughsoil contained a low scatter of natural limestone.

As with Area A, few artefacts earlier than post-medieval date were located. They comprised 1 struck flint, 4 pieces of Roman tile, 4 sherds of medieval pottery, and 8 positively identified pieces of medieval tile.

Three magnetometer survey Areas were located in Area B (Fig. 4). Magnetometer Survey Area 1 (Johnson 1997, Fig. 6) revealed 8 pit-like features 3-4m in diameter spaced approximately 8m apart (centre to centre) running on a north west-south east axis. Evidence of possible medieval ridge and furrow was also present. Area 2 (Johnson 1997, Fig. 6) to the west of the triple linear ditch system had several linear features aligned approximately north west-south east. Some of these features might be associated with the



triple linear ditch system. Area 4 (Johnson 1997, Fig. 9) at the south end of Area B contained a single linear feature aligned north east-south west.

It is unfortunate that all the areas covered by magnetometer survey were under crop at the time of fieldwalking and as such no finds can be related to the recorded anomalies.

**Area C.** The limit of the fieldwalking survey crossed the field diagonally, the southern part of the field not requiring fieldwalking as it is disturbed by early quarrying activity. The ploughsoil in Area C contained a low, even scatter of limestone which increased in density towards the western end of the walked area.

Archaeological finds amounted to 3 worked flints - 1 piece of core, 1 flake and a scraper; 3 sherds of medieval pottery, 1 Roman and 5 medieval pieces of tile, with a further 4 pieces of tile being non-diagnostic.

The magnetic susceptibility survey results were low and there was no magnetometer survey in this field.

**Area D** (Pl. 4), a wedge-shaped piece of land, south-east of the trackway, of which c.0.7ha had not been ploughed. Ploughing of the rough grass only extended c.55m south from the trackway. Area D produced a concentration 31 pieces of post-medieval brick and tile, close to the site of Greetwell North Farm. The area also produced 14 pieces of medieval tile and 5 medieval pottery sherds. The densest concentration of Roman material from the fieldwalking survey was found in this area with 4 Roman tile fragments and 6 more pieces being of probable Roman date.

Magnetometer Area 6, at the west end of Area D (Johnson 1997, Fig. 15) located numerous linear anomalies, all of which were thought to be modern in origin. The distribution of Roman finds is thought to reflect outlying material from the known Roman remains which lie beyond the limits of this survey, rather than being an indication of underlying Roman features.

Magnetometer survey Area 5 extended across the trackway into Area D where the triple linear ditch system was recorded but was less substantial possibly due to colluvial cover. As in Area A no concentration of, or unusual, finds were found over the ditches to indicate their presence.

## **Discussion**

The overall quantity of artefacts retrieved was low, the majority of finds being post-medieval in date with a background scatter of medieval pottery. Their abraded condition and general distribution across the survey area is indicative of manuring associated with land cultivation rather than occupation. The lack of finds from the 16-17th century suggests perhaps a change of land usage to pasture with a return to arable in the 18-19th century.



The complete absence of Roman pottery and the small number of Roman tile fragments recovered is perhaps surprising given the area of known Roman activity south-east of the survey area. Most of the Roman tile fragments came from Area D and are most probably outliers rather than an indication of the presence of Roman features.

The absence of pre-Roman finds over the triple linear ditch system and the associated enclosure to the east was expected as previous excavations of the linear ditches around Lincoln (Palmer-Brown 1993) and at Brauncewell Quarry, Sleaford (Tipper 1994) yielded few artefacts. A 'blank' area over the triple linear ditch system was also evident in the distribution of later finds, suggesting that banks associated with the ditches had been levelled relatively recently.

The small amount of lithic material recovered was concentrated in Area C but were not associated with any area of enhanced magnetic activity. These finds were fashioned from poor quality chert (typical of material found on the limestone) and amounts at best, to a background of prehistoric activity.

The results of the geophysical survey found that, with the exception of the triple ditch system and a possible area of activity immediately east of the ditches, there is little magnetic evidence from either the topsoil magnetic susceptibility mapping, or gradiometer survey, to suggest extensive areas of former settlement with potential archaeological significance. The fieldwalking survey results appear to reinforce this conclusion and the small number of finds must be seen as a real reflection of the low level of human activity within much of the survey area.

The triple ditch system showed up graphically on the gradiometer plot, although paradoxically its potential degree of preservation is greatest at the southern limits of the survey (in Area D) where the plot is less strong. This is because the ditches may be protected by colluvium and/or alluvium. Also of archaeological interest is the ring-form which straddles the trackway in Area D and a second ring-form contained within a possible oval enclosure east of the triple ditches in Area A (Fig. 4). They may have been deliberately avoided by the triple ditch, suggesting they are of an earlier date. The absence of associated finds and their relatively low magnetic signal also suggests that these features may pre-date the triple linear ditches.

### **Conclusion**

The low level of magnetic enhancement within the survey area, coupled with the small number of finds retrieved during fieldwalking, point to a real absence of archaeological remains over much of the proposed development area. Evidence for archaeological features, other than medieval ridge and furrow or modern field boundaries, is confined to gradiometer survey Areas 1 and 5. Apart from the possible line of pits identified in Area 1, towards the western limit of the proposed development area, the potential for archaeological activity is mainly concentrated in the southern part of the site.

This comprises three main elements:

- the triple linear ditches, especially in Area D, where they may be protected by overlying colluvial or alluvial material
- a ring-form ditch which straddles the trackway in Area D
- a ring-form ditch contained within a possible oval enclosure east of the triple ditches in Area A

### Acknowledgements

Lindsey Archaeological Services would like to thank Doug Hicklin, Nick Thompson and Ellie Peters of MSE. The fieldwalking team was Jane Frost, Jon Hall, Richard Moore and Mick McDaid. Geoff Tann set up the data base and was responsible for photography. Finds were processed by Jon Hall and Liz Davis. The geophysical survey was carried out by Oxford Archaeotechnics. Thanks also go to Naomi Field for her help and guidance. Jane Frost produced and collated the report.

### References

Armour-Chelu. R. J, *Land at Greetwell, Lincoln. Proposal for Quarry Extension*. LAS Developer Report.

John Samuels Archaeological Consultants: *Bunkers Hill, Greetwell, Lincoln. Preliminary Archaeological Assessment*. October 1994

Johnson. A. E, 1997 *Bunkers Hill, Greetwell, Lincolnshire. Topsoil Magnetic Susceptibility and Gradiometer Survey*. Oxford Archaeotechnics Limited.

Palmer-Brown C. 1994 *Welton to Lincoln Trunkmain: Archaeological Excavations*. LAS Developer Report.

Tipper. J, 1994 *Archaeological Excavations at Brauncewell Limestone Quarry* LAS Developer Report.

M. McDaid  
November 1997



## LBH 97:Bunkers Hill Fieldwalking Finds List

Finds No.	Area	Description	?Date	Discarded y/n	weight /g
u/s	C	pot x 4; not plotted	18-20th	y	
1	D	pot	18/19th	y	
2	D	slag		y	
3	D	tile [pnr]	Rom/med	y	2
4	D	tile [pnr]	med	y	12
5	D	pot	18/19th	y	
6	D	pot	17/18th	y	
7	D	tile [pnr]	med/post-med	y	3
8	D	stone		y	
9	D	tile [pnr]	post-med/mod	y	1
10	D	clinker		y	
11	D	drain tile, internal glaze	med-post-med	n	
12	D	land drain	mod	y	11
13	D	tile [pnr]	Rom/post-med	y	27
14	D	coal		y	
15	D	tile [pnr]	?	y	1
16	D	tile [pnr]	?	y	2
17	D	tile [pnr]	mod	y	8
18	D	clinker		y	
19	D	pot	18/19th	y	
20	D	tile [pnr]	?	y	1
21	D	tile [pnr]	?	y	1
22	D	fe obj			
23	D	pot	17/18th	y	
24	D	tile [pnr], flat; cut post firing	13-15	n	47
25	D	animal bone		y	
26	D	slag		y	
27	D	pot	19/20th	y	
28	D	pot	13-15th	n	
29	D	vessel glass	18/19	y	
30	D	Rom tile (worn)	Rom	y	23
31	D	tile [pnr]	?	y	4
32	D	land drain	post-med/mod	y	8
33	D	tile [pnr]	Rom/med	y	11
34	D	tile [pnr]	post-med/mod	y	44
35	D	brick	post-med/mod	y	28
36	D	misc tile	?	y	3
37	D	pot	?	n	
38	D	tile [pnr]	Rom/post-med	y	39
39	D	tile [pnr]	?	y	1
40	D	Rom imbrex	Rom	y	18
41	D	pot	13-15th	n	
42	D	tile [pnr]	med/post-med	y	15
43	D	fe obj			
44	D	tile [pnr]	med	y	20
45	D	tile [pnr]	med	y	20
46	D	tile [pnr]	med	y	5
47	D	tile [pnr]	med	y	16
48	D	tile [pnr]	Rom/post-med	y	9
49	D	pot	?	n	
50	D	tile [pnr], flat	14-16	y	56
51	D	tile [pnr]	post-med	y	72
52	D	tile [pnr], flat	med/post-med	y	46
53	D	tile [pnr]	med/post-med	y	5
54	D	brick	post-med/mod	y	14
55	D	tile [pnr]	Rom/post-med	y	23



## LBH 97:Bunkers Hill Fieldwalking Finds List

Finds No.	Area	Description	?Date	Discarded y/n	weight /g
56	D	Rom tile	Rom	y	20
57	D	pot	?	y	
58	D	tile [pnr]	post-med/mod	y	8
59	D	tile [pnr]	post-med/mod	y	55
60	D	brick	18-19	y	138
61	D	pot	18/19th	y	
62	D	tile [pnr]	med/post-med	y	13
63	D	pot	18/19th	y	
64	D	tile [pnr]	?	y	1
65	D	tile [pnr]	?	y	8
66	D	tile [pnr]	post-med	y	21
67	D	pot	15-16th	n	
68	D	pot	18/19th	y	
69	D	tile [pnr] x 2	med	y	10
70	D	pot	18/19th	y	
71	D	tile [pnr]	post-med/mod	y	15
72	D	tile [pnr]	med	y	13
73	D	tile [pnr]	?	y	5
74	D	tile [pnr]	med/post-med	y	14
75	D	pot	19/20th	y	
76	D	land drain	mod	y	11
77	D	land drain?	mod	y	12
78	D	tile [pnr]	?	y	3
79	D	tile [pnr]	med/post-med	y	26
80	D	tile [pnr], Fabric 7	12-13	y	45
81	D	tile [pnr]	13-15	y	11
82	D	tile [pnr]	med	y	1
83	D	Rom tile	Rom	y	57
84	D	tile [pnr]	med	y	11
85	D	tile [pnr], Fabric 7	12-13	y	41
86	D	pot	19/20th	y	
87	D	pot	13-15th	n	
88	A	brick	mod	y	98
89	A	tile [pnr]	?	y	2
90	A	tile [pnr] or Rom tile	?Rom	y	10
91	A	tile [pnr]	?	y	1
92	A	tile [pnr], flat	med	y	35
93	A	pot	16-18th	n	
94	A	tile [pnr]	?	y	
95	A	tile [pnr] x 3	?	y	13
96	A	tile [pnr]	?	y	13
97	A	tile [pnr]	?	y	1
98	A	brick	mod	y	19
99	A	brick	mod	y	12
100	A	tile [pnr]	Rom/med	y	34
101	A	clinker		y	
102	A	tile [pnr]	14-16	y	58
103	A	clinker		y	
104	A	tile [pnr]	?	y	11
105	A	fe obj			
106	A	pot	post-med	y	
107	A	tile [pnr]			
108	A	slag		y	
109	A	pot	?	n	
110	A	pot	?	n	
111	A	slag		y	



## LBH 97:Bunkers Hill Fieldwalking Finds List

Finds No.	Area	Description	?Date	Discarded y/n	weight /g
112	A	slag		y	
113	A	pot	18-20th	y	
114	A	slag		y	
115	A	clinker		y	3
116	A	vessel glass			
117	A	pot	19-20th	y	
118	A	tile [pnr], flat	13-14	y	20
119	A	tile [pnr]	post-med	y	11
120	A	tile [pnr]	post-med	y	27
121	A	tile [pnr], Fabric 7	12-13	y	21
122	A	tile [pnr]	med	y	26
201	A	tile [pnr]	?	y	6
202	A	pot	13-15th	n	
203	A	pot	13-15th	n	
204	A	tile [pnr]	?	y	9
205	A	pot	17-18th	y	
206	A	pot	13-15th	n	
207	A	tile [pnr]	14-16	y	53
208	A	tile [pnr]	?	y	8
209	A	pot	13-15th	n	
210	A	tile [pnr]	?	y	2
211	A	tile [pnr]	post-med/mod	y	66
212	A	tile [pnr]	med	y	24
213	A	tile [pnr]	post-med	y	29
214	A	tile [pnr], Fabric 7	12-13	y	20
215	A	tile [pnr]	?	y	4
216	A	tile [pnr]	?	y	7
217	A	pot?	?	n	
218	A	tile [pnr]	12-14	y	36
219	A	tile [pnr]	post-med/mod	y	54
220	A	pot	13-15th	n	
221	A	pot	post-med	y	
222	A	tile [pnr]	?	y	7
223	A	Rom tile	Rom	y	28
224	A	tile [pnr]	?	y	2
225	A	tile [pnr] x 2; ?brick	?	y	33
226	A	tile [pnr]	?	y	13
227	A	tile [pnr]	med	y	30
228	A	tile [pnr]	?	y	15
229	A	tile [pnr]	med	y	17
230	A	tile [pnr]	mod	y	19
231	A	pot	?	n	
232	A	tile [pnr]		y	
233	A	asbestos land drain	mod	y	15
234	A	tile [pnr]	14-16	y	44
235	A	tile [pnr]	med	y	5
236	A	pot	13-15th	n	
237	A	tile [pnr]	?	y	3
238	A	tile [pnr], flat	13	y	73
239	A	tile [pnr]	?	y	8
240	A	Rom tile	Rom	y	30
241	A	tile [pnr]	med/post-med	y	13
242	A	tile [pnr]	?	y	7
243	A	tile [pnr]	?	y	4
244	A	tile [pnr]	post-med	y	10
245	A	brick	mod	y	56



## LBH 97:Bunkers Hill Fieldwalking Finds List

Finds No.	Area	Description	?Date	Discarded y/n	weight /g
246	A	brick	mod	y	14
247	A	Rom tile	Rom	y	9
249	A	tile [pnr]	med/post-med	y	13
250	D	tile [pnr]	?	y	5
251	D	tile [pnr]	med	y	32
252	D	tile [pnr]	?	y	14
253	D	pot	13-15th	n	
254	A	tile [pnr]	post-med	y	61
255	A	Rom tile	Rom	y	79
256	A	tile [pnr]	?	y	12
257	A	tile [pnr]	med	y	16
258	A	tile [pnr]	post-med	y	12
259	A	tile [pnr]	?	y	6
260	A	tile [pnr]	post-med	y	36
261	A	tile [pnr]	?	y	5
262	A	tile [pnr], Fabric 7	12-13	y	57
263	A	tile [pnr]	med	y	35
264	A	pot	?	n	
265	A	pot	14-15th	n	
266	A	brick	mod	y	11
267	A	tile [pnr]	13	y	13
268	A	Rom tile, flat	Rom	y	74
269	A	tile [pnr]	med	y	19
270	A	tile [pnr]	?	y	16
271	A	Rom tegula	Rom	y	99
272	A	tile [pnr]	med	y	16
273	A	tile [pnr]	?	y	4
274	A	pot	13-15th	n	
275	A	nib, Type 3	13th	y	22
276	A	tile [pnr], flat	13	y	24
277	A	tile [pnr]	med	y	42
278	A	vessel glass	18-19	y	
279	A	tile [pnr]	13-14	y	26
280	A	pot	13-15th	n	
281	A	tile [pnr]	13-14	y	22
282	A	pot	13-15th	n	
283	A	brick	mod	y	15
284	A	tile [pnr]	med	y	8
285	A	tile [pnr]	med	y	33
286	A	ridge tile	post-med	y	29
287	A	ridge tile	post-med	y	29
288	A	pot	13-15th	n	
289	A	tile [pnr]	post-med	y	10
290	A	tile [pnr]	?	y	6
291	A	pot	15-16th	n	
292	A	tile [pnr]	?	y	10
293	B	pot	13-15th	n	
294	B	tile?		y	
296	B	tile [pnr]	post-med	y	57
297	B	tile [pnr]	med	y	26
298	B	tile [pnr]	13	y	11
299	B	tile [pnr]	?	y	2
300	B	tile [pnr]	med/post-med	y	39
301	A	tile [pnr]	post-med	y	28
302	A	tile [pnr]	post-med	y	50
303	A	pot	post-med	y	



## LBH 97:Bunkers Hill Fieldwalking Finds List

Finds No.	Area	Description	?Date	Discarded y/n	weight /g
304	A	tile [pnr]	med	y	13
305	A	tile [pnr]	med/post-med	y	46
306	A	tile and land drain x 11	post-med/mod	y	499
307	A	land drain	post-med/mod	y	15
308	A	land drain	mod	y	35
309	A	tile [pnr]	?	y	18
310	A	tile [pnr]	?	y	3
311	A	tile [pnr]	?	y	5
312	A	land drain	mod	y	41
313	A	vessel glass	18-19	y	
314	A	land drain	mod	y	50
315	A	tile [pnr]	?	y	57
316	A	land drain	mod	y	44
317	A	tile [pnr]		y	
318	A	tile [pnr]	?	y	3
319	A	tile [pnr]	mod	y	
320	A	land drain?	mod	y	38
321	A	tile [pnr]	med/post-med	y	32
322	A	tile [pnr]	post-med	y	34
323	B	pot	post-med	y	
324	B	clay tobacco pipe stem			
325	B	pot	post-med	y	
326	B	tile [pnr]	?	y	1
327	B	pot	15-16th	n	
328	B	tile [pnr]	med	y	14
329	B	pot	?	n	
330	B	tile [pnr]	med	y	5
331	B	tile [pnr]	post-med	y	29
332	C	pot	19/20th	y	
333	C	pot	18th	y	
334	C	ridge tile	post-med	y	26
335	C	pot	18/19th	y	
336	C	tile [pnr]	?	y	2
337	C	tile [pnr]	med	y	55
339	C	pot	13-15th	n	
340	C	tile [pnr]	post-med	y	22
341	C	tile [pnr]	post-med/mod	y	56
349	A	tile [pnr]	med	y	6
351	A	slag		y	
352	A	tile [pnr]	post-med	y	24
353	A	pot	post-med	y	
354	A	tile [pnr]	post-med	y	26
355	A	Rom tile	Rom	y	75
356	A	pot	18-20th	y	
357	A	tile [pnr]	med	y	6
358	A	tile [pnr]	med	y	12
359	A	tile [pnr]	?	y	9
360	A	tile [pnr]	?	y	7
361	A	tile [pnr]	med/post-med	y	84
362	A	pot	post-med	y	
363	A	nib tile	13th	y	32
364	A	pot	12-14th	n	
365	A	burnt limestone	?	y	
366	A	tile [pnr]	med	y	22
367	A	pot	18/19th	y	
368	A	tile [pnr]	13	y	5



## LBH 97:Bunkers Hill Fieldwalking Finds List

Finds No.	Area	Description	?Date	Discarded y/n	weight /g
369	A	clinker		y	
370	A	pot	13-15th	n	
371	A	tile [pnr]	14-16	y	35
372	A	gun cartridge	mod	y	
373	A	tile [pnr]	post-med/mod	y	10
374	A	pot	?	n	
375	A	land drain	post-med/mod	y	25
376	A	tile [pnr], flat	13-14	y	33
377	A	pot	18-20th	y	
378	A	tile [pnr]	13-14	y	10
379	A	pot	post-med	y	
380	B	Rom tile	Rom	y	22
381	B	tile [pnr]	?	y	7
382	B	Rom tile	Rom	y	11
383	B	tile [pnr], flat	13-14	y	23
384	B	tile [pnr], flat	13-15	y	50
385	B	tile [pnr]	12-13	y	24
386	B	fe obj			
387	B	pot	16-18th	n	
388	B	fe obj			
389	B	marble tile frag	?	y	
390	A	tile [pnr]	14-16	y	49
391	A	tile [pnr], flat	12-13	y	68
392	D	tile [pnr], flat	13-14	y	12
393	A	brick	mod	y	10
394	A	pot	13-15th	n	
395	A	tile [pnr]	?	y	10
396	A	tile [pnr]	post-med/mod	y	12
397	A	pot	13-15th	n	
398	A	tile [pnr] x 2	post-med	y	89
399	C	tile [pnr]	?	y	1
400	C	tile [pnr]	?	y	8
401	B	pot	18/19th	y	
402	B	Rom tile; tile [pnr]	Rom; med	y	46; 24
403	B	tile [pnr]	med/post-med	y	52
404	B	tile [pnr]	post-med	y	24
405	B	pot	18-20th	y	
406	B	flint			
407	B	Rom tile	Rom	y	55
408	B	pot	15-16th	n	
409	B	tile [pnr] x 2	?	y	19
432	C	tile [pnr]	post-med	y	10
433	C	pot	16-17th	n	
434	C	pot	?	n	
435	C	tile [pnr] x 2	med	y	18
436	C	tile [pnr] x 2	med	y	24
437	C	tile [pnr]	14-16	y	75
438	C	pot	post-med	y	
439	C	pot	18-20th	y	
440	C	tile [pnr]	med	y	9
441	C	tile [pnr]	post-med	y	30
442	C	pot	?	n	
443	C	tile [pnr]	?	y	6
444	C	cu alloy hook			
445	C	pot	18th	y	
446	C	pot	post-med	y	



## LBH 97:Bunkers Hill Fieldwalking Finds List

Finds No.	Area	Description	?Date	Discarded y/n	weight /g
447	C	clinker		y	
448	C	pot	18-19th	y	
449	C	tile [pnr]	post-med	y	10
450	C	pot	post-med	y	
451	C	Rom imbrex	Rom	y	30
452	C	brick/ ?tile	mod	y	38
453	C	tile [pnr]	13-15	y	8
454	C	pot	18th?	y	
455	C	pot	18-20th	y	
470	C	pot	14-16th	n	
471	C	pot	18-20th	y	
472	C	tile [pnr]	13-15	y	17
473	C	pot	?	n	
473	C	pot x 2	?		
474	C	pot	18-20th	y	
475	C	flint			
476	C	pot	post-med	y	
477	C	flint			
478	C	tile [pnr]	med	y	8



## POST-ROMAN POTTERY ARCHIVE: LBH96 WARE TYPES BY CONTEXT

Context	Ware	Sherds	Form	Comments
U/S	BL	1	-	18TH
U/S	BS	1	-	18-20TH
U/S	MP	1	-	15-16TH
U/S	TB	1	JUG	LHJ
1	LERTH	1	-	18/19TH;NO GLZE
5	LSTON	1	-	18/19TH
6	BL	1	-	17/18TH
19	LERTH	1	-	18/19TH
23	BL	1	-	17/18TH
27	LERTH	1	-	19/20TH
28	LSW2/3	1	-	13-15TH;JUG BASE
37	MISC	1	-	? DATE;EARTHEN
41	MEDLOC	1	-	13-15TH;V ODD;THU;? LID
49	MISC	1	-	? DATE;NO GLZE
57	R	1	-	? ID;DISC
61	BL	1	BOWL	18/19TH
63	LERTH	1	-	18/19TH
67	TB	1	JUG	15-16TH
68	LERTH	1	BOWL	18/19TH
70	LERTH	1	-	18/19TH
75	LERTH	1	FLOWERPOT	19/20TH
86	LSTON	1	-	19/20TH
87	MEDLOC	1	JUG	13-15TH
93	PMX	1	BOWL	16-18TH;? MP
106	LPMDISC	1	-	-
109	R	1	-	-
110	R	1	-	-
113	LERTH	1	-	18-20TH
117	LSTON	1	-	19-20TH
202	MEDLOC	1	-	13-15TH
203	POTT	1	-	13-15TH
205	BL	1	-	17-18TH
206	MEDLOC	1	-	13-15TH
209	MEDLOC	1	-	13-15TH
217	MISC	1	-	? DATE
220	MEDLOC	1	-	13-15TH
221	LPMDISC	1	-	-
231	MISC	1	-	? DATE
236	MEDLOC	1	-	13-15TH
253	MEDLOC	1	-	13-15TH
264	MISC	1	-	? DATE
265	LSW3	1	-	14-15TH
274	MEDLOC	1	-	13-15TH
280	MEDLOC	1	-	13-15TH
282	MEDLOC	1	-	13-15TH
288	MEDLOC	1	-	13-15TH
291	LMLOC	1	BOWL	15-16TH



293	MEDLOC	1	-	13-15TH
303	LPMDISC	1	-	-
323	LPMDISC	1	-	-
325	LERTH	1	FLOWERPOT	19/20TH
327	LMLOC	1	BOWL	15-16TH
329	R	1	-	-
332	LERTH	1	-	19/20TH
333	WEST	1	CHAMBERPOT	18TH
335	LERTH	1	-	18/19TH
339	MEDLOC	1	-	13-15TH
353	LPMDISC	1	-	-
356	BS	1	-	18-20TH
362	LPMDISC	1	-	-
364	MEDLOC	1	BOWL	12-14TH
367	BS	1	-	18/19TH
370	MEDLOC	1	JUG	13-15TH
374	R	1	-	-
377	BS	1	-	18-20TH
379	LPMDISC	1	-	-
387	PMLOC	1	BOWL	16-18TH
394	MEDLOC	1	JUG	13-15TH
397	MEDLOC	1	JUG	13-15TH
401	BL	1	BOWL	18/19TH
405	LSTON	1	-	18-20TH
408	LMLOC	1	-	15-16TH
433	BL	1	CUP	16-17TH
434	MISC	1	-	? DATE
438	LPMDISC	1	-	-
439	LERTH	1	FLOWERPOT	18-20TH
442	R	1	-	-
445	BS	1	-	18TH
446	LPMDISC	1	-	-
448	BL	1	-	18-19TH
450	LPMDISC	1	-	-
454	LONS	1	-	18TH;? ID
455	BS	1	-	18-20TH
470	LMLOC	1	-	14-16TH
471	LSTON	1	-	18-20TH
473	MISC	2	-	? DATE
474	LERTH	1	-	18-20TH
476	LPMDISC	1	-	-



## APPENDIX 3

### Contents of Site Archive

Fieldwalking Finds

1 box

Finds plot, showing location finds number and material (Fig. 3)

Full archive list of finds

Photographs

LAS Film No. 96/65 negs 17 to 19

LAS Film No. 97/67 negs 26 to 30

Correspondence



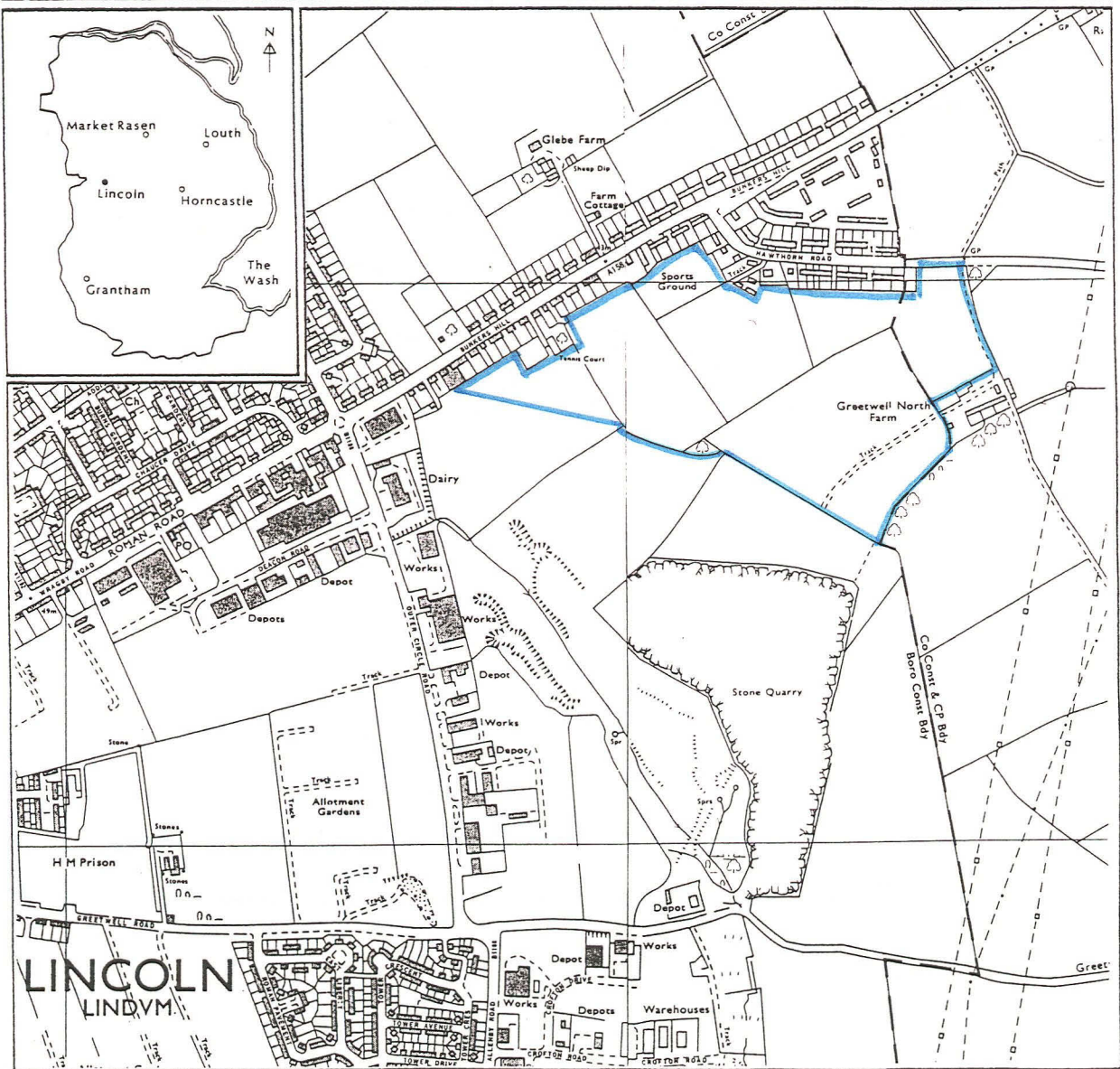
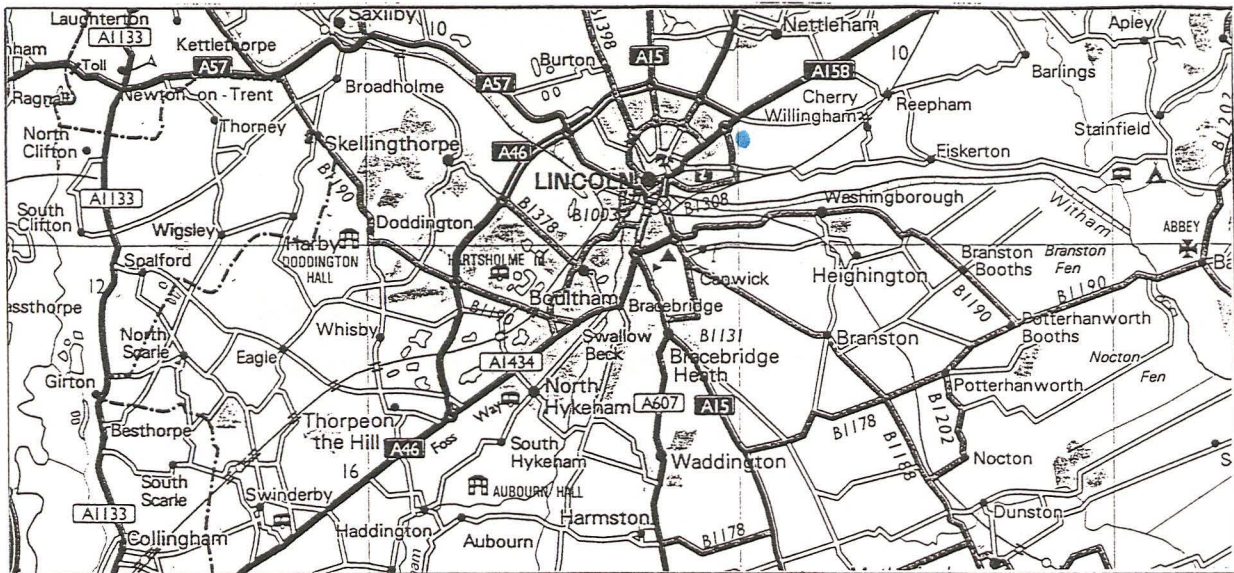

Fig 1: Location of proposed development site. (Reduced from a 1;10,000 Ordnance Survey map. Crown Copyright, reproduced with the permission of the Controller of HMSO. LAS Ordnance Survey Licence No. AL 50424A).



Greetwell, Lincolnshire:

Features mapped from aerial photographs



AIR PHOTO SERVICES: 1994

Fig 2: Fieldwalking area with features mapped from aerial photographs.





Fig. 4 Gradiometer survey areas in relation to artefact distribution from fieldwalking survey. (Reduced scale)





Pl.1 Area A. East end of the field. Looking north.

Pl.2 Area A. Looking north west.







**Pl.3 Area B. Note crop either side of ploughed area. Looking south east.**

**Pl.4 Area D. Looking south west.**





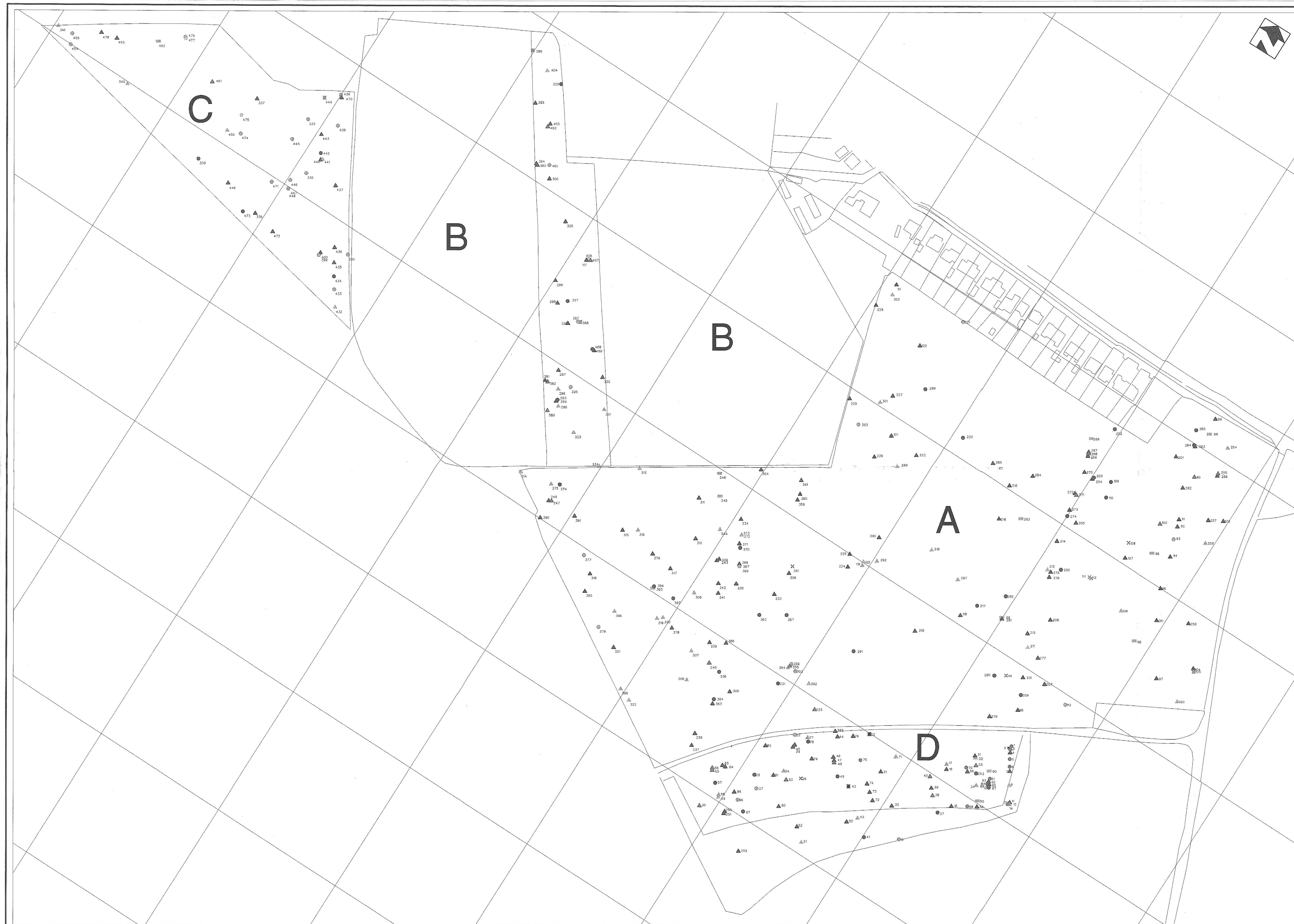

Key

Find locations

- Medieval Pottery
- Post Medieval Pottery
- Undated Pottery
- ▲ Roman Tile
- ▲ Medieval Tile
- ▲ Post Medieval Tile
- ▲ Undated Tile
- ⌘ Metal
- × Slag
- Post Medieval Brick
- Flint

Site

**Land at  
Bunkers Hill Lincoln**

Plan

**Fig 3  
Artefact Distribution  
From Fieldwalking**

Scale : 1/1250      Date : 5/11/97

Plan Ref : LAMSE/999

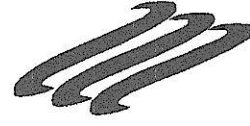
  
**LINDSEY ARCHAEOLOGICAL SERVICES**  
25 WEST PARADE LINCOLN LN1 1HW  
TELEPHONE 01522 544554 FACSIMILE 01522 529211  
EMAIL las@lasarchaeology.demon.co.uk

**M.S.E.**  
A Total Surveying Service

259 Alton Road  
Blackwell  
Ayrton  
Derbyshire  
DE56 6JN  
Tel & Fax: 01773 811667  
email 100612876@compuserve.com