

# A Report to Green Valley Homes Limited

November 1999

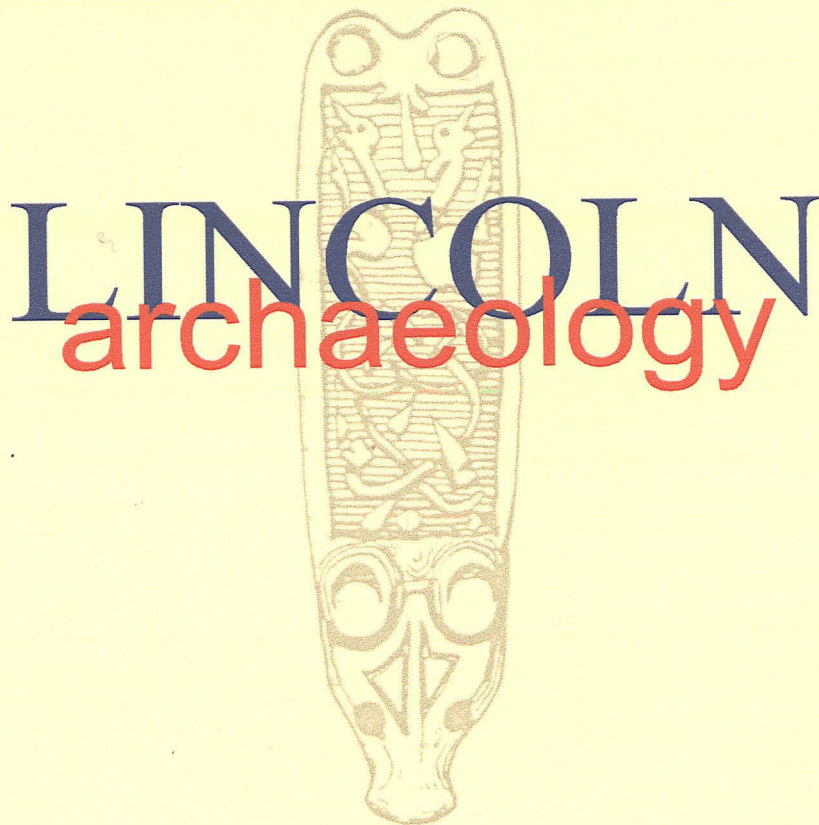

## Development on land to rear of 27-35 Turner Street, Lincoln

### Archaeological Watching Brief

*By K Wragg*

Report No.: 399

**LINCOLN**  
archaeology

ack 24/11/99  
24. NOV 99

1971  
LONDON  
24. NOV 99

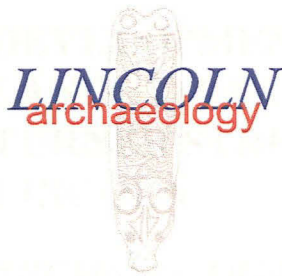

# Development on land to rear of 27-35 Turner Street, Lincoln

Site Code: TS99

LCCM Accession No.: 132.99

Planning Application No.: LC10/0214/97

NGR: SK 9712/7227

## *Archaeological Watching Brief*

<i>Contents</i>	<i>Page</i>
NON-TECHNICAL SUMMARY.....	1
1.0 INTRODUCTION.....	2
2.0 ARCHAEOLOGICAL AND HISTORICAL BACKGROUND.....	2
3.0 RESULTS.....	3
4.0 CONCLUSIONS.....	3
5.0 ACKNOWLEDGEMENTS.....	3
6.0 BIBLIOGRAPHY.....	3
7.0 LHA NOTES/ARCHIVE DETAILS.....	4
7.1 LHA NOTE DETAILS.....	4
7.2 ARCHIVE DETAILS.....	4
APPENDIX A - ARCHIVE DEPOSITION.....	5
APPENDIX B - COLOUR PLATES 1 & 2.....	6

### *Illustrations*

Fig.1 Site location plan - scale 1:10000 & 1:1250

Fig.2 Site layout plan - scale 1:200

# **DEVELOPMENT ON LAND TO REAR OF 27-35 TURNER STREET, LINCOLN**

## **ARCHAEOLOGICAL WATCHING BRIEF**

### ***NON-TECHNICAL SUMMARY***

During June 1999, the City of Lincoln Archaeology Unit (C.L.A.U.) was approached by Mr T.S.Crowe of Green Valley Homes Ltd., regarding a small residential development at the above location in uphill Lincoln.

The site itself actually fronts on to Mill Road, and until recently held a variety of garages and brick workshops. Development proposals involved the levelling of the site, construction of two houses, and limited service trenching.

In view of proximity of the site to areas of known archaeological importance, an archaeological watching brief condition had been applied to the planning consent which was granted in 1997.

C.L.A.U. was appointed to carry out the required watching brief on 7<sup>th</sup> of June 1999, and observations were undertaken on the site between the 7<sup>th</sup> of June and the 22<sup>nd</sup> of September 1999.

Ultimately, however, the results of this watching brief proved to be negative, but given the limited nature of the actual trenching involved this was somewhat to be expected.

In the event, no sign of any ancient archaeological finds or features was uncovered, with only deposits representing either natural strata or modern occupation revealed.

The negative results from this particular project, however, do not diminish the potential for future discoveries in the area.

# DEVELOPMENT ON LAND TO REAR OF 27-35 TURNER STREET, LINCOLN

## ARCHAEOLOGICAL WATCHING BRIEF

### 1.0 INTRODUCTION

During June 1999, the City of Lincoln Archaeology Unit (C.L.A.U.) was approached by Mr T.S.Crowe of Green Valley Homes Ltd., regarding a small residential development at the above location in uphill Lincoln.

The site itself actually fronts on to Mill Road (see Fig.1), and until recently held a variety of garages and brick workshops.

The development proposals involved the levelling of the site, and the construction of two 'linked' detached houses (i.e., the ground floors of the properties were not physically connected, although the first floors were joined above a communal access drive). Limited service trenching was also proposed.

In view of proximity of the site to areas of known archaeological importance (see 2.0, below), an archaeological watching brief condition had been applied to the planning consent.

C.L.A.U. was appointed to carry out the required watching brief on 7<sup>th</sup> of June 1999, and observations were undertaken on the site between the 7<sup>th</sup> of June and the 22<sup>nd</sup> of September 1999.

The information in this document is presented with the proviso that further data may yet emerge. The Unit, its members and employees cannot, therefore, be held responsible for any loss, delay or damage, material or otherwise, arising out of this report. The document has been prepared in accordance with the terms of the Unit's Articles of Association, the Code of Conduct of the Institute of Field Archaeologists, and *The Management of Archaeological Projects 2* (English Heritage, 1991).

### 2.0 ARCHAEOLOGICAL AND HISTORICAL BACKGROUND

The uphill area of Lincoln was probably the first part of the city to be colonised by the Romans, as their military base during the *Legionary Fortress* period, (c.AD50-c.80). Later this became the administrative centre during the *Colonia* period (c.AD90-c.450).

Abandonment of the Roman City seems to have started in the late 4<sup>th</sup> Century with town life reduced to a small community between the 5<sup>th</sup> and late 9<sup>th</sup> centuries. Following the Viking take-over of Lindsey in 874, Lincoln became a centre for a Viking army and, subsequently, a Viking town. Evidence for increasing urbanisation in the 10<sup>th</sup> and 11<sup>th</sup> centuries has emerged from all parts of the former Roman city, with Lincoln forming one, and perhaps the most important, of the so-called Five Boroughs of the present East Midlands. The upper city area does not, however, appear to have been intensively reoccupied before the late 10<sup>th</sup> century or later.

The site itself lies in an area of known archaeological importance lying to the north-west of the Roman and medieval city walls.

Mill Road, which forms the western boundary of the site, was originally the medieval *Cliffegate*, and could actually date to the Roman period. In view of this, the area is believed likely to contain evidence of Roman and medieval suburban occupation and land-use.

The nearest discoveries of significance were found when evaluation excavations were carried out to the south-east, at Cuthbert's Yard (to the north-east of the Burton Road/Westgate junction), during 1989-90 in order to locate and investigate the Roman defences. These works revealed evidence of the first defensive ditch, wooden palisade and rampart bank (belonging to the legionary fortress), together with later modifications (associated with the Roman Colonia), including infilling and repositioning of the ditch, and replacement of the wooden palisade with a stone wall.

Adjacent to Burton Road two north-south gullies were also revealed, possibly associated with a medieval or even Roman predecessor of Burton Road.

### **3.0 RESULTS**

The groundworks for this development comprised only localised shallow trenches, and as a result, no evidence was revealed of any archaeological features. It is possible, however, that any slight traces of occupation had already been truncated by earlier development - notably in the 19<sup>th</sup> century.

The stratigraphic sequence revealed was very basic, and consistent across the site.

The earliest deposit, [101], comprised a moderately compacted, slightly friable, mid-light yellow-brown sandy limestone 'brash', which contained no obvious inclusions. This deposit was present at a depth of approximately 200mm below the existing ground level (G.L.), and continued to the limit of excavation (L.O.E.).

This was then overlain by a very mixed topsoil deposit, [100], comprising a moderate-loose compaction, friable, mid grey-brown sandy silt. This layer contained limestone inclusions, and occasional dumps of modern brick, tile and other modern material close to its upper boundary and was present across the entire site area.

No finds were recovered during the course of the groundworks.

### **4.0 DISCUSSION OF RESULTS AND CONCLUSIONS**

Ultimately, the results of this watching brief have proved to be negative, however, given the limited nature of the actual trenching involved this was somewhat to be expected.

In the event, no sign of any ancient archaeological finds or features was uncovered, with only deposits representing either natural strata or modern occupation revealed.

The negative results from this particular project do not of course diminish the potential for future discoveries in the area.

### **5.0 ACKNOWLEDGEMENTS**

The City of Lincoln Archaeology Unit would like to thank the following for their assistance during this project: Mr T.S.Crowe (Director), Green Valley Homes Ltd., 1, The Orchard, Front Street, Normanby-by-Spital, Market Rasen, Lincolnshire, LN8 2EB for kindly funding this project; Mr Ian George, Lincoln City Council Archaeology Officer, Lincoln City Council, City Hall, Beaumont Fee, Lincoln LN1 1DH.

### **6.0 BIBLIOGRAPHY**

Vince, Alan & Jones, Michael J (eds) 1990 (Revised edition) *Lincoln's Buried Archaeological Heritage*, City of Lincoln Archaeology Unit, Lincoln

Wragg K, 1995 *Garage Court, adjacent to no.21 Wilson Street, Lincoln: Archaeological Investigation*, CLAU Archaeological Report 233

Wragg K, 1996 *Rear of Co-op retail store, 95-99 Burton Road & 2 Gray Street, Lincoln: Archaeological Watching Brief*, CLAU Archaeological Report 245

## **7.0 LHA NOTE/ARCHIVE DETAILS**

### **7.1 LHA NOTE DETAILS**

CLAU CODE: TS99

PLANNING APPLICATION Nos.:  
LC10/0214/97

FIELD OFFICER: K. Wragg

NGR: SK 9712/7227

CIVIL PARISH: Lincoln

SMR No.: n/a

DATE OF INTERVENTION: 07/06/99 -  
22/09/99

TYPE OF INTERVENTION: Watching Brief

UNDERTAKEN FOR: Green Valley Homes  
Ltd., 1, The Orchard, Front Street, Normanby-  
by-Spital, Market Rasen, Lincolnshire, LN8  
2EB

### **7.2 ARCHIVE DETAILS**

PRESENT LOCATION: City of Lincoln  
Archaeology Unit, Charlotte House, The  
Lawn, Union Road, Lincoln, LN1 3BL.

FINAL LOCATION: The City and County  
Museum, Friars Lane, Lincoln.

MUSEUM ACCESSION No.: 132.99

ACCESSION DATE: -

**APPENDIX A - ARCHIVE  
DEPOSITION**

The archive consists of:

No.	Description
1	Site diary
1	Report
2	Context records
2	Site drawings
1 set	Colour slides
1	Stratigraphic matrix

The primary archive material, as detailed above, is currently held by :

**The City of Lincoln Archaeology Unit,  
Charlotte House,  
The Lawn,  
Union Road,  
Lincoln,  
Lincolnshire,  
LN1 3BL.**

It is intended that transfer to the City and County Museum, Friars Lane, Lincoln, in accordance with current published requirements, under Museum Accession Number 132.99, will be undertaken following completion of this project.



**APPENDIX B - COLOUR PLATES**



*Plate 1: General view of excavation in progress - looking west*



*Plate 2: General view of deposits present across the site - looking north-west*



KEY



CITY OF LINCOLN ARCHAEOLOGY UNIT		
SITE CODE: TS99	PLANELEV/SECTION NO:	
CLIENT: Green Valley Homes Ltd	DESCRIPTION: Site Location Plan	
SCALE:	ARCHIVE NO:	
DRAWN BY:	CHECKED:	DATE:
MUSEUM ACCESSION NO: 132.99		

1:10 000



1:1250



Reproduced from the 1976 Ordnance Survey 1:10 000 map with the permission of The Controller of Her Majesty's Stationery Office, © Crown copyright, by CLAU, Charlotte House, The Lawn, Lincoln, under Licence No. AL 52761A0001.

Reproduced from the 1966 Ordnance Survey 1:1250 map with the permission of The Controller of Her Majesty's Stationery Office, © Crown copyright, by CLAU, Charlotte House, The Lawn, Lincoln, under Licence No. AL 52761A0001

Fig.1

CITY OF LINCOLN ARCHAEOLOGY UNIT		
SITE CODE: TS99	PLAN/ELEV/SECTION NO:	
CLIENT: Green Valley Homes Ltd	DESCRIPTION: Site Layout Plan	
SCALE: 1:200	ARCHIVE NO:	
DRAWN BY:	CHECKED:	DATE:
MUSEUM ACCESSION NO: 132.99		

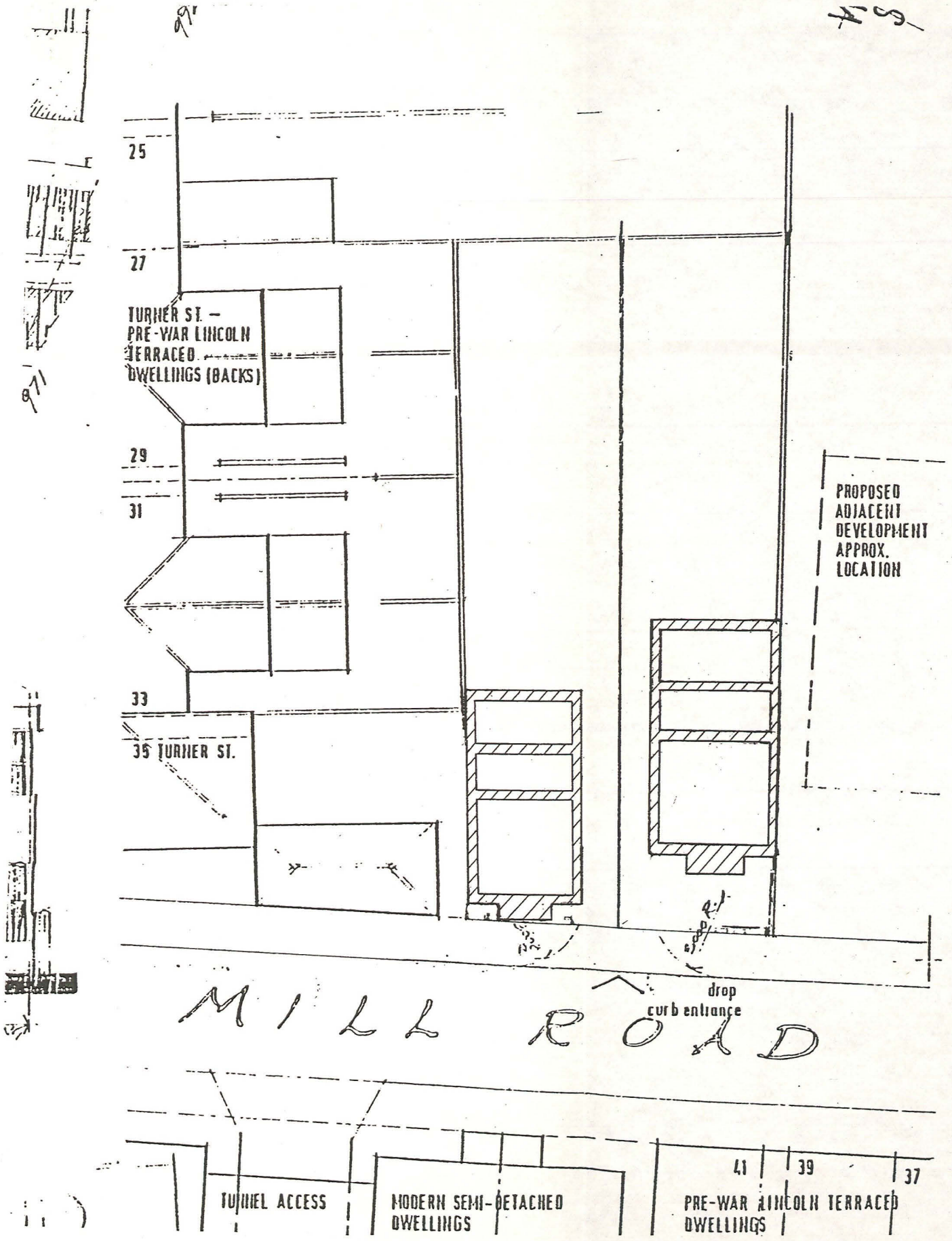

KEY

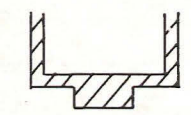

Foundation Trenches

Based upon M.A. Design drawing No. 4122W/011 Rev. A

Fig.2