

00/13



LINDSEY ARCHAEOLOGICAL SERVICES

CROXLEY
heritage

**Land adjacent to 27 Gainsborough Road,
Lea, Lincs.**

**Site Code: LGB00
NGR: SK 8290 8670
LCNCC Accn.: 2000.111**

Archaeological Watching Brief

**Report for
Mr J. R. Hill**

**LAS Report No: 421
June 2000**

25 WEST PARADE · LINCOLN · LN1 1NW

TELEPHONE 01522 544554 · FACSIMILE 01522 522211 · EMAIL las@lasarchaeology.demon.co.uk

F.N.FIELD B.A.(Hons), MIFA

1951-1952

1953-1954

1955-1956

1957-1958

1959-1960

1961-1962

1963-1964

1965-1966

Lancashire County Council
Archaeology Section
20 JUN 00
Oct 20/6/00

U4173

EVENT L11286
SOURCE L16004/05

Contents

List of Figures

List of Plates

Summary

1

Introduction

1

Site Location and Description

1

Archaeological Background

1

Method

2

Results

2

Conclusion

2

Acknowledgments

2

Appendix 1

Figures

Plates

Figures

Fig. 1 Location of development site (based on an Ordnance Survey map. Crown Copyright reproduced with the permission of the Controller of HMSO. LAS Licence No. AL 50424A).

Fig. 2 (a) Location of foundation trenches within plot
(b) Plan of excavated foundation trenches

Plates

Pl. 1 The development site, looking west: the foundation trenches are located at the rear of the plot

Pl. 2 East facing section of foundation trench, showing deposits 100, 101 and 102

**Land adjacent to 27 Gainsborough Road,
Lea, Lincs
Archaeological Watching Brief
NGR: SK 8290 8670
Site Code: LGB00
LCNCC Accn.: 2000.111**

Summary

A watching brief undertaken while groundworks were carried out at land adjacent to 27 Gainsborough Road, Lea, did not expose any deposits of archaeological significance.

Introduction

Lindsey Archaeological Services (LAS) were commissioned by Mr. J.R. Hill to undertake an archaeological watching brief during groundworks on land adjacent to 27 Gainsborough Road, Lea. The development is for a single bungalow and garage.

The work was carried out in accordance with the general requirements set out in the Lincolnshire Archaeological Handbook (Lincolnshire County Council Archaeology Section, 1998).

The aims of the watching brief were to

- establish the presence or absence, quality and extent of any archaeological remains;
- record any archaeological deposits disturbed during groundworks.

Site Location and Description

Lea is located on the edge of the Trent Valley 3km south of Gainsborough. The plot is located on the west side of Gainsborough Road between nos. 25 and 27, in the former garden of no. 27 (Fig. 1; Pl. 1). The area measures approximately 60m in length and 15.60m in width. Until 15-20 years ago, this land had been used as a market garden. The land is almost flat, sloping slightly downwards towards Gainsborough Road.

The geology of the site comprises wind blown sands overlying boulder clay.

Archaeological Background

A Romano-British kiln producing 2-3rd century grey wares was found on the south side of Green Lane to the north of the development site. Associated pits and ditches were also recorded. An evaluation at 35 Gainsborough Road has identified further evidence of Roman pottery production.

In 1957, ten Roman pottery kilns were found at Grange Farm, which is located 400m east of the development site.

Method

The foundation trenches for a single bungalow and garage were machine-excavated using a JCB under archaeological supervision (Fig. 2). The foundation trenches measured 0.60m wide and varied in depth between 0.70m and 1m.

A representative section of the foundation trenches was cleaned by hand and recorded using colour photographs, written records and a sketch section. A plan of the excavated foundation trenches was made based on a plan provided by the developer. A full photographic record was made of the works on site.

All deposits were assigned context numbers by LAS for recording purposes. These are referred to in the following text and illustrations.

Results

The topsoil (**100**) consisted of a grey/brown sandy silt, containing occasional sub rounded and sub angular stones and modern brick fragments. This varied between 0.08m and 0.20m in depth.

The removal of the topsoil revealed an orange/brown windblown sand (**101**), visible to the base of the foundation trenches. At a depth of 0.95m in one trench light orange sand was visible (**102**) (Pl. 2).

Conclusion

No archaeological features were revealed in the machine-excavated foundation trenches. With the exception of the modern brick and rubble in the topsoil, no artefacts were recovered from any of the trenches.

Claire D Angus
Lindsey Archaeological Services
June 2000

Acknowledgements

LAS is grateful to Mr J.R.Hill and his contractor for their help on site. The watching brief was carried out by the author. The illustrations were prepared by Claire Angus. Naomi Field co-ordinated the project and edited the report. The report was produced and collated by Jane Frost.

Appendix 1

Context Summary: Land adjacent to 27 Gainsborough Road, Lea, Lincs (LGB00)

Context Number	Context Type	Relationship	Description	Interpretation
100	Layer	Above 100	Grey/brown sandy silt	Topsoil
101	Layer	Below 100, above 102	Orange brown sand	Windblown sand
102	Layer	Below 101, LOE	Light orange sand	Windblown sand

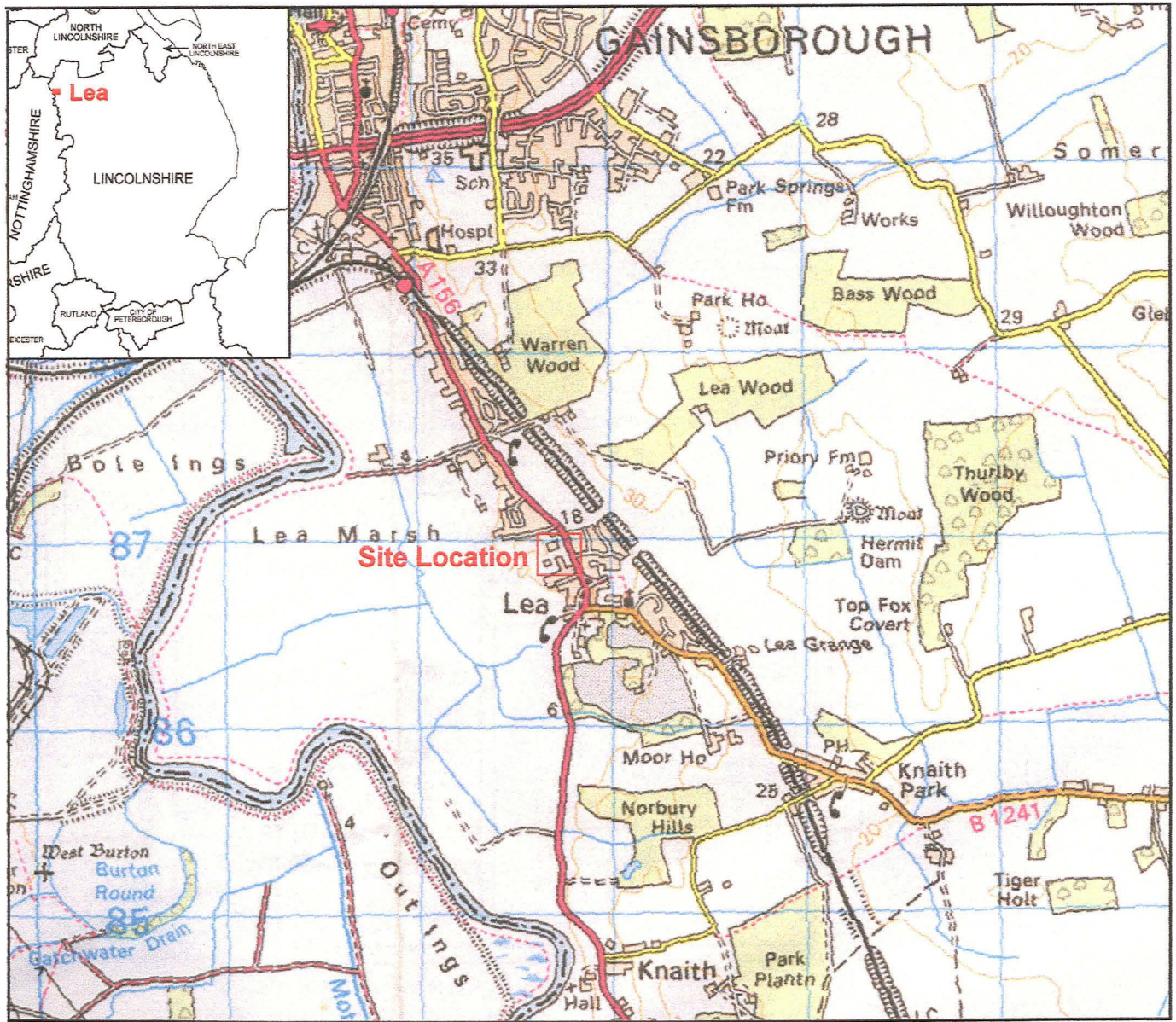
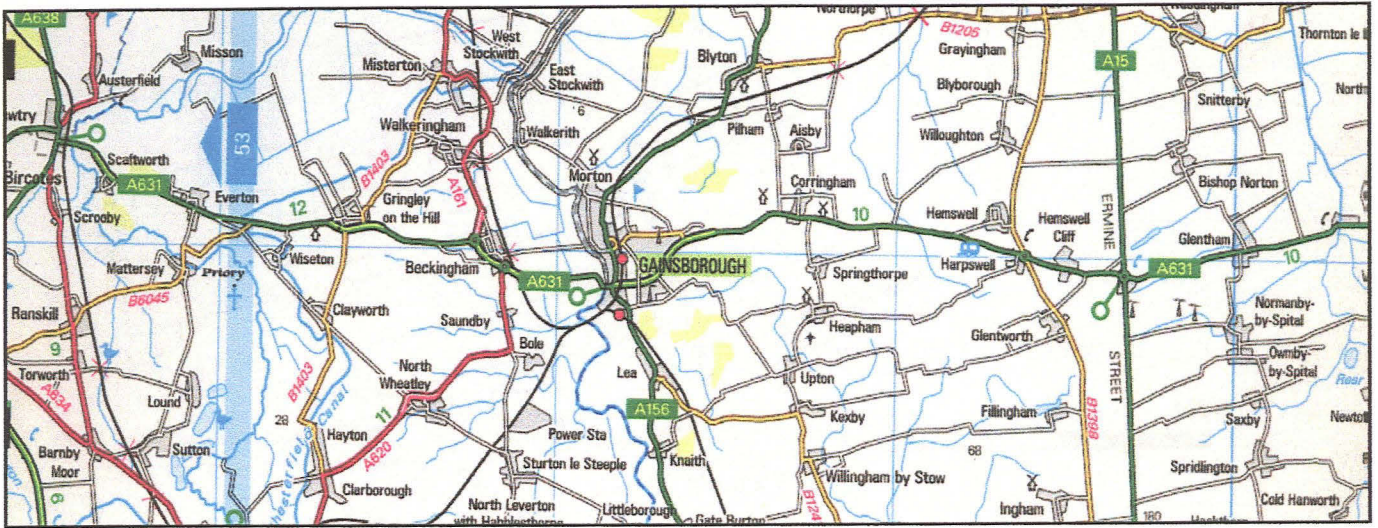

Fig.1 Location of development site, Lea (reproduced with the permission of the Controller of HMSO Crown copyright. LAS Licence No. AL50424A)

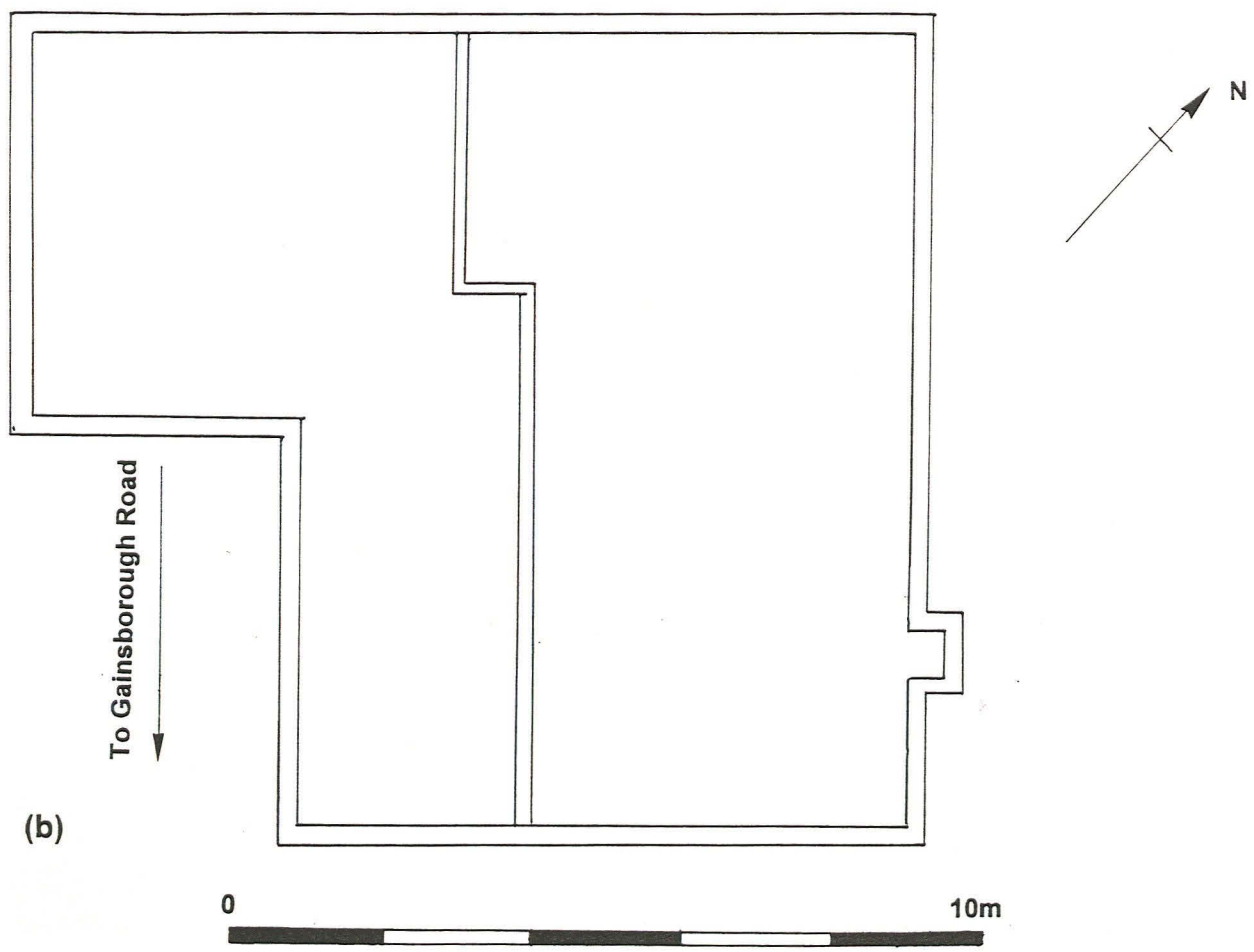
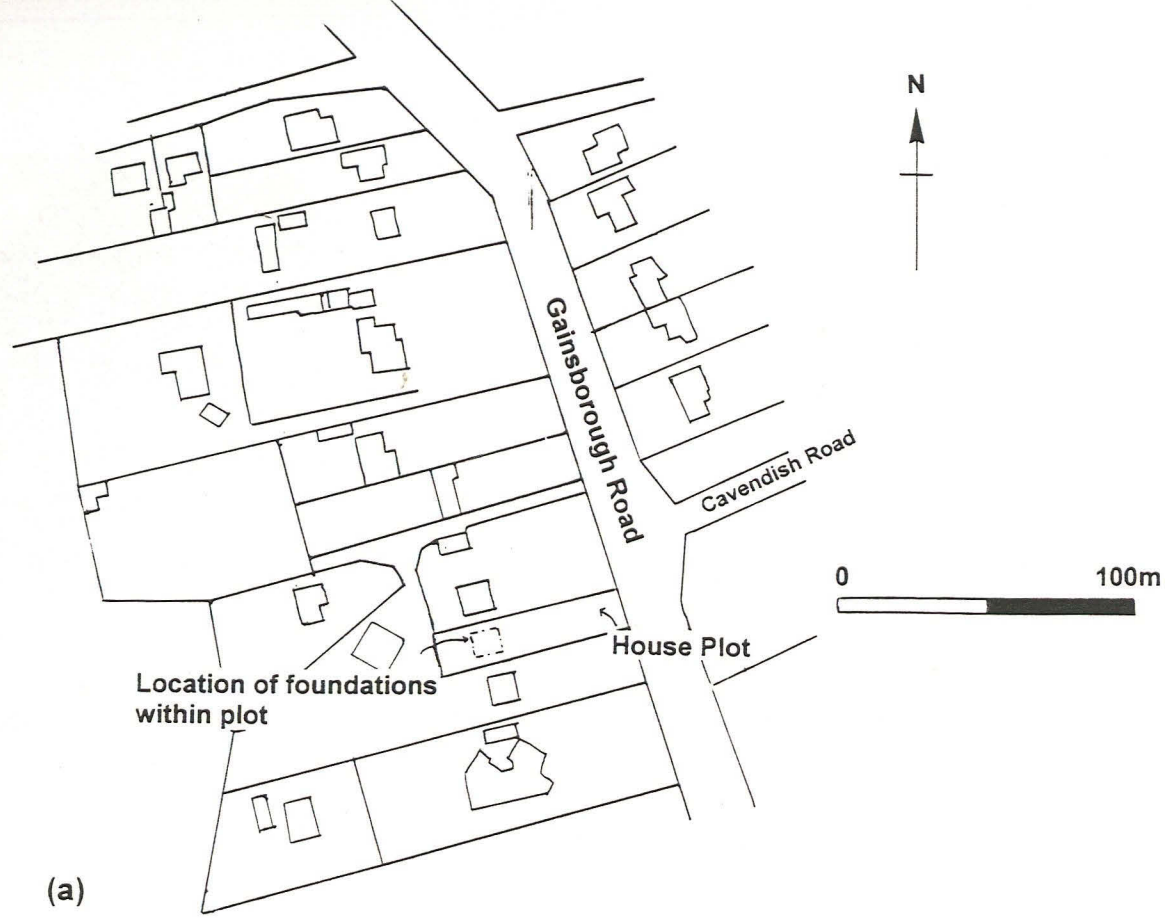

Fig.2 (a) Location of foundation trenches within plot
 (b) Plan of excavated foundation trenches



Pl. 1 The development site, looking west: the foundation trenches are located at the rear of the plot

Pl. 2 East facing section of foundation trench, showing deposits 100, 101 and 102

