

m1/06



LINDSEY ARCHAEOLOGICAL SERVICES

**New Storage Building, The Apiary, Louth Road,
Wragby**

*NGR: TF 1418 7883
Site Code: WTA 01
LCNCC Museum Accn No.: 2001.12
ELDC Planning Application No.: S/216/1642/99*

Archaeological Watching Brief

Report for E. H. Thorne (Beehives) Ltd

by G. Tann and N. Field

Lincoln County Council
Heritage Section

22 MAR 01

LAS Report No 510

March 2001

EVENT 41798
SOURCES 46567 46568
PRN 43951 481484

Contents

List of Figures and Plates

Summary	1
Introduction	1
Site Location and Archaeological Background	1
The Watching Brief	2
Acknowledgements	2
Archive Summary	2
The Figures	
The Plates	

List of Figures and Plates

Figures

- Fig. 1** Location of the Apiary site (C based on the 1956 1:10,560 Ordnance Survey map Sheet TF 17 NW. © Crown Copyright, reproduced with the permission of the Controller of HMSO. © Crown Copyright. LAS Licence No. AL 50424A).
- Fig. 2** The Apiary site, showing the position of the new building (based on John Rowan dwg. no. 99025, reproduced at reduced scale).
- Fig. 3** The monitored groundworks: a) plan (based on John Rowan dwg. no. 99025).; b) section through deposits (McDaid, after Field).

Plates

- Pl. 1** Site of the new building (marked in white) beside Louth Road (looking SW).
- Pl. 2** Fruit trees planted along medieval cultivation ridges east of the site of the new building, with beehives along the furrows (looking west towards Louth Road).
- Pl. 3** Ridge and furrow earthworks approaching the site of the new building (looking NE).
- Pl. 4** Excavation of foundation trenches for the new building (looking NE).
- Pl. 5** Position of the eastern foundation trench of the new building (looking NE). The plough furrows may have ended at a headland alongside the road boundary hedge.
- Pl. 6** Deposits visible in the trench face (looking south, scales 0.5m). No sign of the plough furrows was seen.

New Storage Building, The Apiary, Louth Road, Wragby

Archaeological Watching Brief

NGR: TF 1418 7883

Site Code: WTA 01

LCNCC Museum Accn No.: 2001.12

ELDC Planning Application No.: S/216/1642/99

Summary

Foundation trenches for a new building crossed a headland at the edge of ridge and furrow earthworks in an orchard. No other archaeological features or finds were seen.

Introduction

Lindsey Archaeological Services (LAS) was commissioned in December 1999 by E. H. Thorne (Beehives) Ltd, to conduct an archaeological watching brief during excavations of building foundation trenches on land beside Louth Road, Wragby.

Planning permission was granted by East Lindsey District Council for the construction of a store 8.6m x 4m in size. An initial requirement for a pre-determination archaeological evaluation was removed, but planning consent was subject to an archaeological watching brief being carried out during the groundworks phase of construction.

The watching brief was conducted in accordance with the general requirements set out in the *Lincolnshire Archaeological Handbook* (Lincolnshire County Council Archaeology Section, 1998). Groundworks were monitored by Naomi Field on January 8th 2001.

Site Location and Description

The Apiary is situated 1km NE of Wragby village on the A157 Louth Road. The site is on a plot of ground, currently an orchard, which has been under grass for many years. The plot contains an existing wooden apiary building close to the road frontage, 2m SW of the new building (Pl. 1).

The fruit trees are aligned parallel to a hedge boundary at the southern edge of the plot. This boundary is on the same approximately east-west alignment as clearly visible ridge and furrow earthworks which extend almost to the roadside boundary. The trees have been planted along the ridges; the site of the new store is in line with a furrow and part of the adjacent ridges, but a headland is probable alongside the road boundary (Pls. 2 and 3).

Archaeological Background

The ridge and furrow surviving on this plot shows that this land is not highly regarded for arable use, despite it having been ploughed at some stage during the medieval or post-medieval period. Roman and prehistoric remains have been found in fields adjacent to the site.

The Watching Brief

Part of the SW side of the site of the new store was stripped of topsoil in the late 1990s in preparation for a wooden building which was not constructed. This area had been spread with brick rubble, which was removed by mini-digger. The remainder of the building footprint was then stripped of topsoil.

Four 0.6m wide trenches were excavated by machine around the edges of the stripped area to depths of up to 0.65m below ground level (Pl. 4). The dark brown topsoil **1** was 0.25m thick, overlying a 0.4m thick sandy subsoil **2** with flints. An apparently undisturbed chalky ochrous clay **3**, incorporating flint nodules, was seen at the trench base.

The site was crossed by a west-east aligned plough furrow and ridge, but information about the earthwork features could not be obtained when the ground was stripped. Within the plough furrow, the soil colour was the same as to either side, and the angle at which the foundation trenches crossed the furrows meant that no useful profile could be obtained within the excavated trenches (Pls. 5 and 6). The furrow was no deeper than 0.6m, and did not penetrate the chalky clay layer **3**. During the monitoring visit, water failed to drain from the surface of **3** despite the proximity of the drainage ditch alongside the road frontage.

The groundworks revealed no other archaeological features, and no artefacts were found.

Acknowledgements

LAS is grateful to Mr P. Smith (E.H. Thorne [Beehives] Ltd) and the builder, Mr Wibley, for their co-operation. Further help was received from Dr. Beryl Lott (Lincolnshire County Council Built Environment Assistant).

Illustrations were prepared by Mick McDaid, and the report was collated and produced by Jane Frost.

Geoff Tann and Naomi Field
Lindsey Archaeological Services
March 11th 2001

Archive Summary

Correspondence

Copies of developer's site plans

Photographs: colour prints, LAS film nos. 01/02/22-25; 01/4/17-18

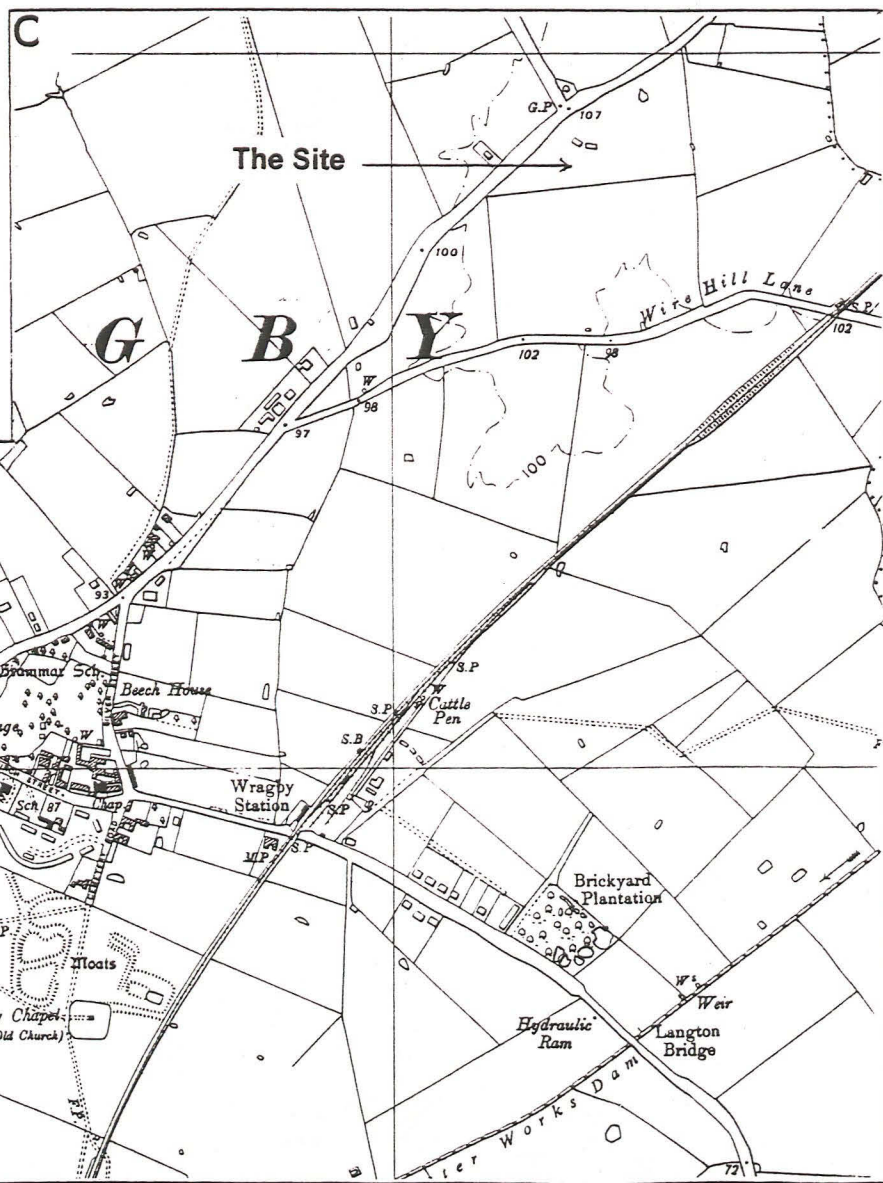
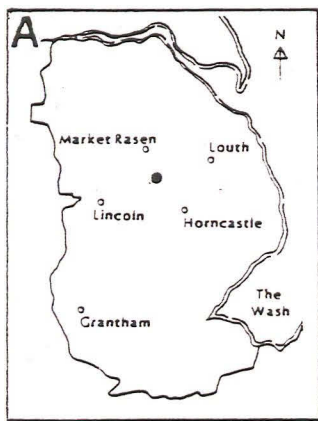
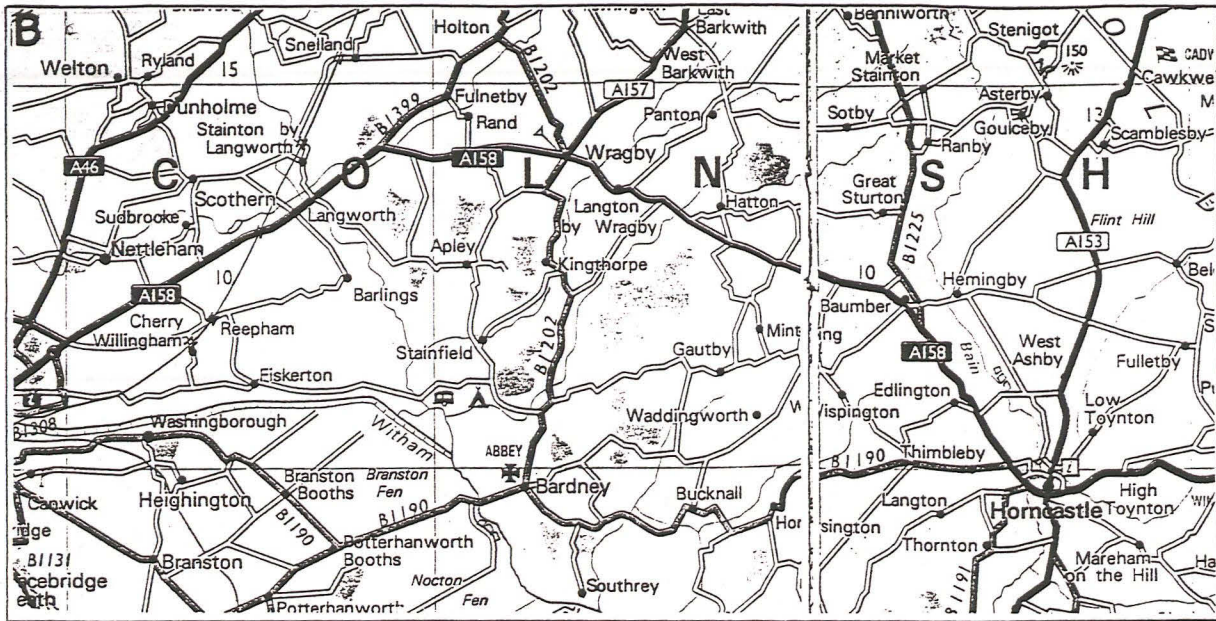

Fig. 1 Location of the Apiary site (C based on the 1956 1:10,560 Ordnance Survey map Sheet TF 17 NW. © Crown Copyright, reproduced with the permission of the Controller of HMSO. © Crown Copyright. LAS Licence No. AL 50424A).

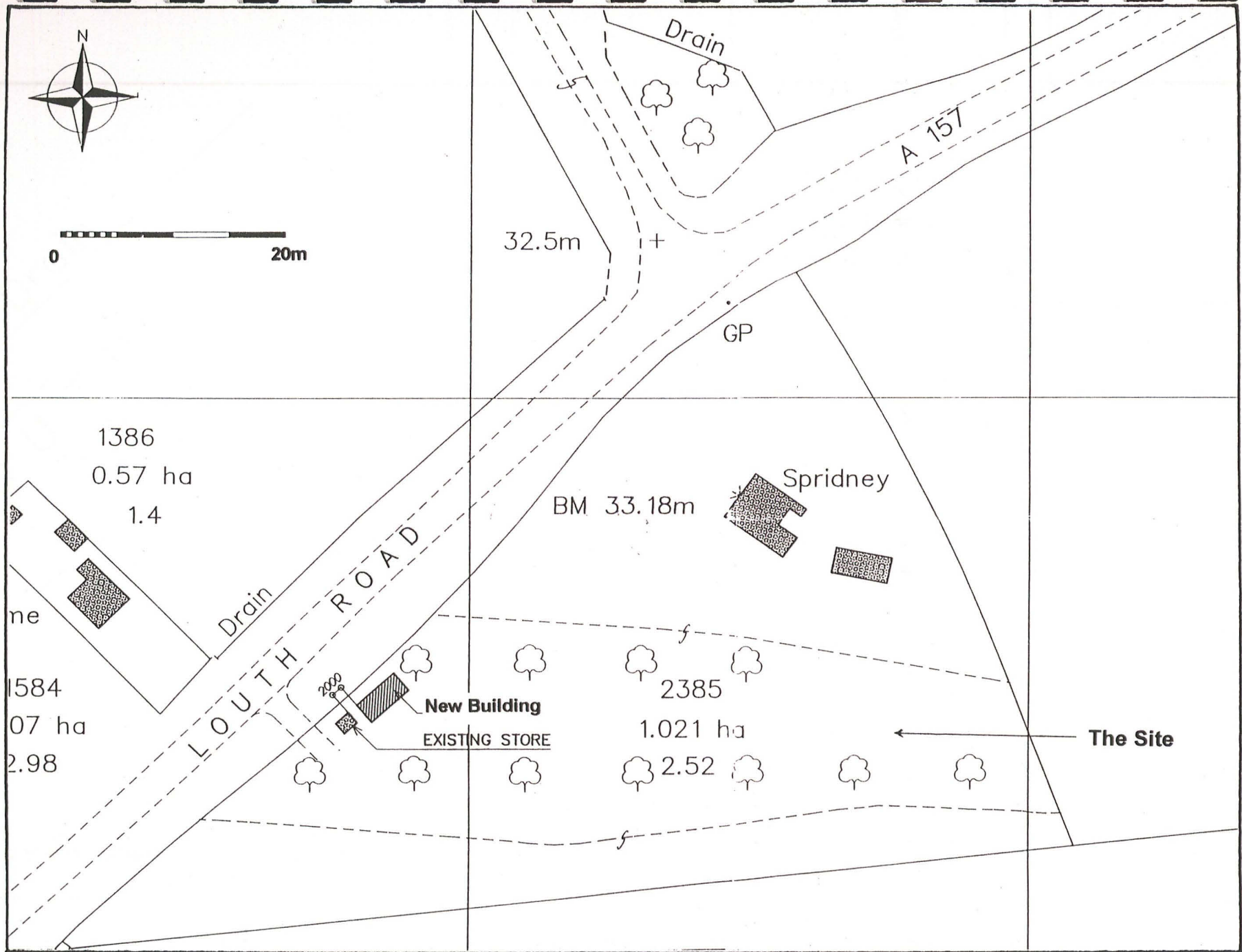

Fig. 2 The Apiary site, showing the position of the new building (based on John Rowan dwg. no. 99025, reproduced at reduced scale).

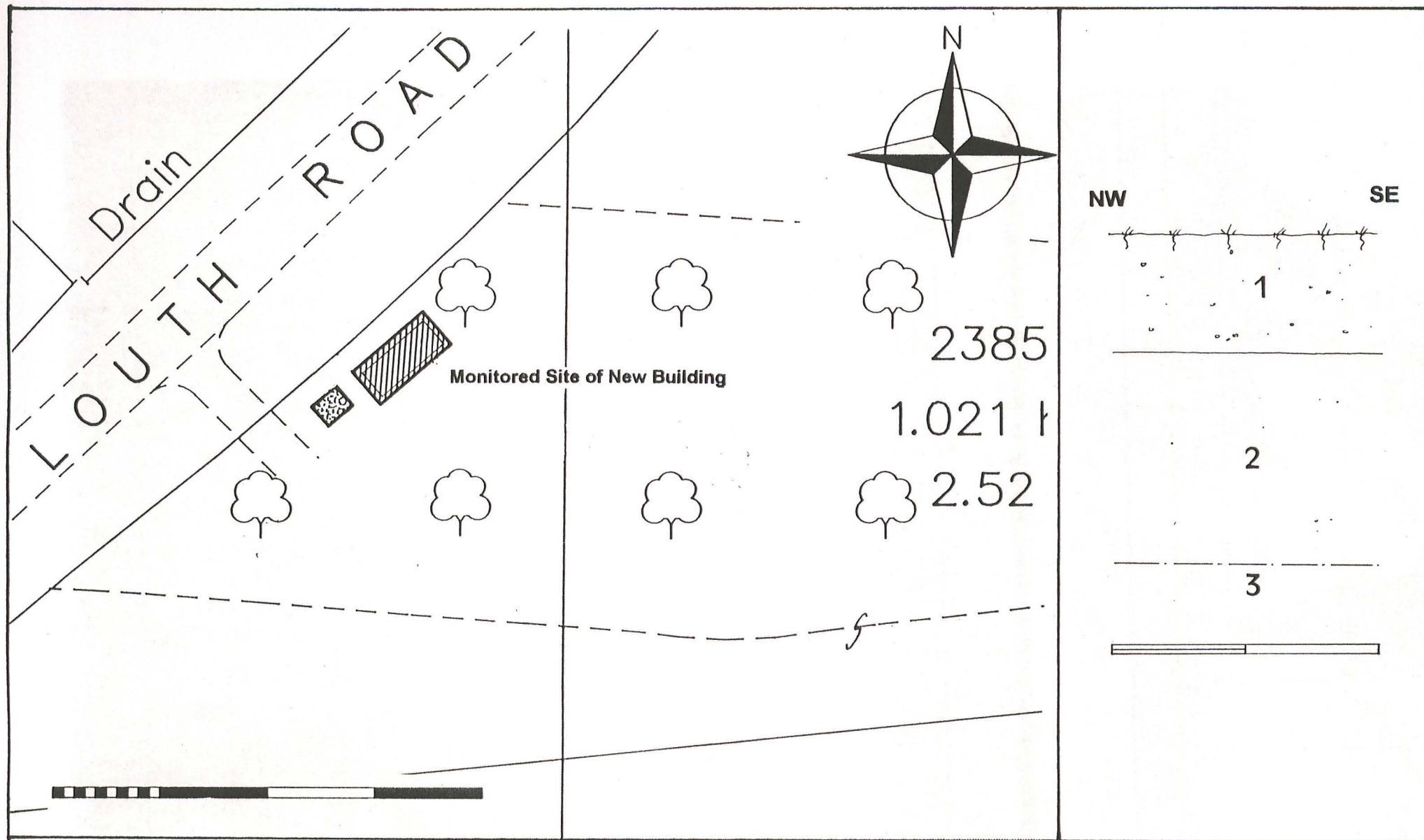

Fig. 3 The monitored groundworks: a) plan (based on John Rowan dwg. no. 99025).; b) section through deposits (McDaid, after Field).



Pl. 1 Site of the new building (marked in white) beside Louth Road (looking SW).

Pl. 2 Fruit trees planted along medieval cultivation ridges east of the site of the new building, with beehives along the furrows (looking west towards Louth Road).





PI. 3 Ridge and furrow earthworks approaching the site of the new building (looking NE).

PI. 4 Excavation of foundation trenches for the new building (looking NE).





Pl. 5 Position of the eastern foundation trench of the new building (looking NE). The plough furrows may have ended at a headland alongside the road boundary hedge.

Pl. 6 Deposits visible in the trench face (looking south, scales 0.5m). No sign of the plough furrows was seen.

