

# A Report to The Bromhead Hospital Ltd.

March 2002

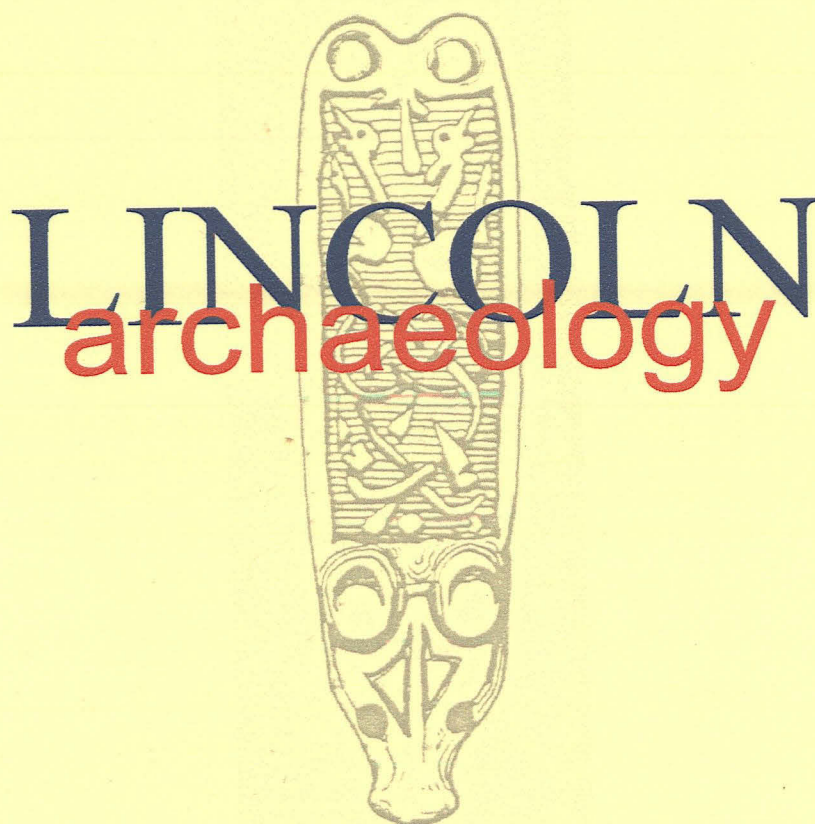

## Extension to The Bromhead Hospital, Nettleham Road, Lincoln

### Archaeological Watching Brief

*By K Wragg*

Report No.: 460

**LINCOLN**  
archaeology

Conservation  
Services

28 MAR 2002

Highways & Planning  
Directorate

**Extension to the Bromhead Hospital,  
Nettleham Road, Lincoln - Phase I**

Site Code: NRE00  
LCCM Accession No.: 2000.253  
Planning Application No.: 99/650/F  
NGR: SK 97987/72233

***Archaeological Watching Brief***

<i>Contents</i>	<i>Page</i>
NON-TECHNICAL SUMMARY.....	1
1.0 INTRODUCTION.....	2
2.0 ARCHAEOLOGICAL AND HISTORICAL BACKGROUND.....	3
3.0 RESULTS.....	3
4.0 DISCUSSION OF RESULTS & CONCLUSIONS.....	4
5.0 ACKNOWLEDGEMENTS.....	4
6.0 SELECTED BIBLIOGRAPHY.....	4
7.0 LHA NOTE/ARCHIVE DETAILS.....	5
7.1 LHA Note details.....	5
7.2 Archive details.....	5
<b>APPENDIX A</b> Archive deposition.....	6
<b>APPENDIX B</b> Colour plates.....	7
<b>APPENDIX C</b> Lincoln UAD data summary.....	8

***List of illustrations***

<b>Fig. 1</b> Site location plan	Scale 1:10000 & 1:1250
<b>Fig. 2</b> Plan of proposed development showing excavated areas	Scale 1:250
<b>Fig. 3</b> West-facing section 1	Scale 1:20



## EXTENSION TO THE BROMHEAD HOSPITAL, NETTLEHAM ROAD, LINCOLN - PHASE I

### ARCHAEOLOGICAL WATCHING BRIEF

#### NON-TECHNICAL SUMMARY

- *This project initially involved the construction of a four-storey rearward extension to the existing hospital structure, together with the creation of new car-parking arrangements, and associated infrastructure.*
- *In view of the archaeological potential of the area, it was proposed by the (then) City Archaeologist, Mr I. George, that a 5m long evaluation trench should be excavated to a maximum depth of 3m in advance of planning consent. In the event, however, it was possible to combine archaeological inspection with geotechnical trial pits already programmed by the developer.*
- *The results from that investigation were wholly negative from an archaeological perspective, and the City of Lincoln Department of Planning therefore decided to grant full planning permission for the scheme; but with the proviso that an archaeological watching brief be carried out during the development groundworks. Full planning permission was granted on the 15<sup>th</sup> of May 2000.*
- *The City of Lincoln Archaeology Unit (C.L.A.U.) was approached by John Roberts Architects Limited, on behalf of The Bromhead Hospital Ltd., to provide the required archaeological services in accordance with the planning condition. C.L.A.U. was subsequently commissioned on the 4<sup>th</sup> of October 2000, to provide this work.*
- *The scheme was modified part way through the project, however, with the extension being deferred to a later date. As a consequence, this report details only the works required for the new car-parking area and associated infrastructure. Site attendance on this part of the project (now titled Phase I) was undertaken on an intermittent basis between the 16<sup>th</sup> of October 2000 and the 23<sup>rd</sup> of April 2001.*
- *Ultimately, however, notwithstanding the potential for archaeological discoveries in this area, no positive evidence of ancient occupation was found during this project.*
- *The majority of the deposits uncovered were associated with either the geological strata, or the more recent topsoil/subsoil layers. Only one possible archaeological feature was revealed during the groundworks. This was present in the trench for the new surface water soakaway, and appeared to represent part of a cut feature (possibly a pit or ditch). Unfortunately, its date, purpose and extent could not be determined.*
- *Archaeological preservation, however, is rarely predictable or regular. Therefore, conclusions regarding the likelihood of archaeological discoveries in the surrounding area cannot be drawn from the results from this very small investigation. Equally, the lack of evidence from this particular area does not necessarily preclude future archaeological discoveries in other parts of the hospital site.*



# EXTENSION TO THE BROMHEAD HOSPITAL, NETTLEHAM ROAD, LINCOLN - PHASE I

## ARCHAEOLOGICAL WATCHING BRIEF

### 1.0 INTRODUCTION

This project initially involved the construction of a four-storey rearward extension to the existing hospital structure, together with the creation of new car-parking arrangements, and associated infrastructure.

In view of the archaeological potential of the area (see 2.0, below), it was proposed by the (then) City Archaeologist, Mr I. George, that a 5m long evaluation trench should be excavated to a maximum depth of 3m in advance of planning consent. In the event, however, it was possible to combine archaeological inspection with geotechnical trial pits already programmed by the developer.

The results from this investigation were wholly negative from an archaeological perspective, and the City of Lincoln Department of Planning therefore decided to grant full planning permission for the scheme; but with the *proviso* that an archaeological watching brief be carried out during the development groundworks. Full planning permission was granted on the 15<sup>th</sup> of May 2000.

The City of Lincoln Archaeology Unit (C.L.A.U.) was approached by John Roberts Architects Limited, on behalf of The Bromhead Hospital Ltd., to provide the required archaeological services in accordance with the planning condition. C.L.A.U. was subsequently commissioned on the 4<sup>th</sup> of October 2000, to provide this work.

The scheme was modified part way through the project, however, with the extension being deferred to a later date. As a consequence, this report details only the works required for the new car-parking area and associated infrastructure (see Figs. 1 & 2). Site attendance on this part of the project (now titled *Phase I*) was undertaken on an intermittent basis between the 16<sup>th</sup> of October 2000 and the 23<sup>rd</sup> of April 2001.

### NOTE

*The information in this document is presented with the proviso that further data may yet emerge. Lincoln City Council cannot, therefore, be held responsible for any loss, delay or damage, material or otherwise, arising out of this report. The document has been prepared in accordance with the Code of Conduct of the Institute of Field Archaeologists, and The Management of Archaeological Projects 2 (English Heritage, 1991).*

*All maps and extracts are reproduced under Ordnance Survey Licence No. AL 100028765 unless otherwise credited.*



## 2.0 ARCHAEOLOGICAL AND HISTORICAL BACKGROUND

Although no formal archaeological brief was established by Lincoln City Council for this particular project, advice supplied by the Director of Planning set out the archaeological/historical background of the site, as follows:

*... it would appear that the development is adjacent to the line of the Roman road which followed the line of Nettleham Road. The aqueduct from the Roaring Meg passes just to the north west. It is likely that extramural settlement of the Roman and later periods could be expected in this area.*

## 3.0 RESULTS

This project comprised two distinct parts. Firstly, the enabling works and ground level reduction for the new car-parking area, and then trenching for new ducting, services and drainage (see Fig. 2).

In general, all archaeological recording during the watching brief was carried out by means of trench-side observation, with access only for the purpose of artefact recovery or investigation of features, if required. All trenches were machine-excavated.

Each discrete archaeological deposit was issued with a unique *context number* (e.g., context [100]), and recorded in both written form, and on scale plan and section drawings. A photographic record was also compiled during the groundworks.

The initial enabling works on the site, and the ground-level reduction in the area of the new car-park, were of very limited extent, only reaching depths of between 300mm and 350mm below the existing ground level (G.L.). The only deposit revealed by this work was the topsoil layer [100]; a moderately compacted mid-dark grey-brown clayey silt, containing fibrous roots and very occasional small flecks of brick/tile.

Similarly, the majority of the excavations for the various ducts, drains and services across the site were of limited depth; generally between 300mm and 500mm below the existing G.L. The only deposits encountered were either topsoil, or more modern material associated with the existing structures or roadways.

The only element of the groundworks to reach a significant depth was the excavation for the new surface water soakaway in the north-eastern corner of the site (see Figs. 2 & 3).

The soakaway measured approximately 2m square, and was c. 1.8m deep. The stratigraphic sequence in this area comprised the following deposits:

The earliest context uncovered was [105], a moderate-well compacted, friable, light yellow-brown degraded limestone and clayey sand, containing no obvious inclusions. [105] was overlain by [104], a moderate-loose compaction mixed mid-brown sandy silt and mid-light yellow-brown clay/degraded limestone. [104] contained moderately frequent amounts of small limestone pieces, and occasional small flecks of limestone and brick/tile. These deposits appear to represent the natural (*i.e.*, geological) limestone ([105]), and limestone brash ([104]) layers, and were present to the limit of excavation (L.O.E.).

The top of [104] was present approximately 900mm below the existing ground level (G.L.), and was cut by a possible pit or ditch feature, [103]. This was not fully revealed, but was possibly oriented E-W, and was at least 800mm deep. It was filled by [102], a moderately compacted mid-dark brown clayey silt containing occasional small flecks of limestone and brick/tile.

[102] was sealed by [101], a 300mm-400mm thick layer of moderately compacted mid-brown clayey silt. This contained frequent small irregularly shaped limestone inclusions and very occasional small flecks of brick/tile, and was overlain by the aforementioned topsoil deposit, [100]. No dating evidence was recovered.



#### **4.0 DISCUSSION OF RESULTS AND CONCLUSIONS**

Notwithstanding the potential for archaeological discoveries in this area (as mentioned in 2.0, above), no positive evidence of ancient occupation was found during this project.

The majority of the deposits uncovered were associated with either the geological strata, or the more recent topsoil/subsoil layers. Only one possible archaeological feature was revealed during the groundworks. This was present in the trench for the new surface water soakaway, and appeared to represent part of a cut feature (possibly a pit or ditch). Unfortunately, its date, purpose and extent could not be determined.

Archaeological preservation, however, is rarely predictable or regular. Therefore, conclusions regarding the likelihood of archaeological discoveries in the surrounding area cannot be drawn from the results from this very small investigation. Equally, the lack of evidence from this particular area does not necessarily preclude future archaeological discoveries in other parts of the hospital site.

#### **5.0 ACKNOWLEDGEMENTS**

The City of Lincoln Archaeology Unit would like to thank the following for their assistance during this project: Bromhead Hospital Ltd., Nettleham Road, Lincoln, LN2 1QU for kindly funding this project; Mr D. Rawdon (Finance Manager), of the Bromhead Hospital; Mr R. Mair, of John Roberts Architects Ltd., 1 James Street, Lincoln, LN2 1QD; Messrs M. Harrison (Contract Manager) & P. Sidebottom (Site Manager) of Lindum Construction, Lindum House, Whisby Road, Lincoln, LN6 3QX (main site contractor); Mr I. George, (former) Archaeology Officer, Department of Planning, Lincoln City Council, City Hall, Lincoln, LN1 1DN.

#### **6.0 SELECTED BIBLIOGRAPHY**

Director of Planning, Department of Planning, City of Lincoln 29<sup>th</sup> of November 1999 *Advice to Applicant, Town and Country Planning Act 1990, Bromhead Hospital, Lincoln. Erection of rear extension.* Lincoln City Council.

## **7.0 LHA NOTE/ARCHIVE DETAILS**

### **7.1 LHA NOTE DETAILS**

CLAU CODE: NRE00

PLANNING APPLICATION NO.: 99/650/F

FIELD OFFICER: K.Wragg

NGR: SK 97987/72233

CIVIL PARISH: Lincoln

SMR No.:

DATE OF INTERVENTION: 16/10/00 - 23/04/01

TYPE OF INTERVENTION: Archaeological Watching Brief

UNDERTAKEN FOR: Bromhead Hospital Ltd., Nettleham Road, Lincoln, LN2 1QU

### **7.2 ARCHIVE DETAILS**

PRESENT LOCATION: City of Lincoln Archaeology Unit, Charlotte House, The Lawn, Union Road, Lincoln, LN1 3BL.

FINAL LOCATION: The City and County Museum, Friars Lane, Lincoln.

MUSEUM ACCESSION No.: 2000.253

ACCESSION DATE: -



## **APPENDIX A - ARCHIVE DEPOSITION**

The archive consists of:

No.	Description
1	Site diary
1	Report
6	Context records (in site diary)
3	Scale drawings
1	Stratigraphic Matrix (in site diary)

The primary archive material, as detailed above, is currently held by :

**The City of Lincoln Archaeology Unit,  
Charlotte House,  
The Lawn,  
Union Road,  
Lincoln,  
Lincolnshire,  
LN1 3BL.**

It is intended that transfer to the City and County Museum, Friars Lane, Lincoln, in accordance with current published requirements, under Museum Accession Number 2000.253, will be undertaken following completion of this project.



## APPENDIX B - COLOUR PLATES



Plate 1: General view of enabling works - looking south



Plate 2: General view of stratigraphic sequence, soakaway trench - looking east



## APPENDIX C - LINCOLN UAD DATA SUMMARY

### Report

<i>Author</i>	K. Wragg
<i>Title</i>	Extension to the Bromhead Hospital, Nettleham Road, Lincoln
<i>Date of Issue</i>	October 2001
<i>Place of Issue</i>	Lincoln
<i>Series Name &amp; Number</i>	C.L.A.U. Report No. 460
<i>Issuer/Publisher</i>	City of Lincoln Archaeology Unit, Lincoln City Council

### Recognition Events Database

<i>Site Name</i>	Extension to Bromhead Hospital, Lincoln
<i>Sitecode</i>	NRE00
<i>Location</i>	Bromhead Hospital, Nettleham Road, Lincoln, LN2 1QU
<i>Grid Reference</i>	SK 97987/72233
<i>Type of Archaeological Intervention</i>	Watching Brief
<i>Start &amp; End Dates of Intervention</i>	16 <sup>th</sup> October 2000 to 23 <sup>rd</sup> April 2001
<i>Reporter</i>	K. Wragg
<i>Organisation</i>	City of Lincoln Archaeology Unit
<i>Location of Archive &amp; Finds</i>	City & County Museum, Friars Lane, Lincoln
<i>Museum Accession Number</i>	2000.253

### Monuments Database

<i>Monument Name</i>	n/a
<i>Date</i> terminus post quem	n/a
Terminus ante quem	n/a
<i>Monument Type</i>	n/a
<i>Grid Reference</i>	n/a
<i>Brief Description</i>	n/a

### Deposit Model

<i>Grid Reference</i>	SK 97987/72233
<i>Surface Code</i>	MODT
<i>Height</i>	61.84m O.D.
<i>Grid Reference</i>	SK 97987/72233
<i>Surface Code</i>	LLIM
<i>Height</i>	60.97m O.D.



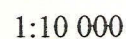

### Location of Site

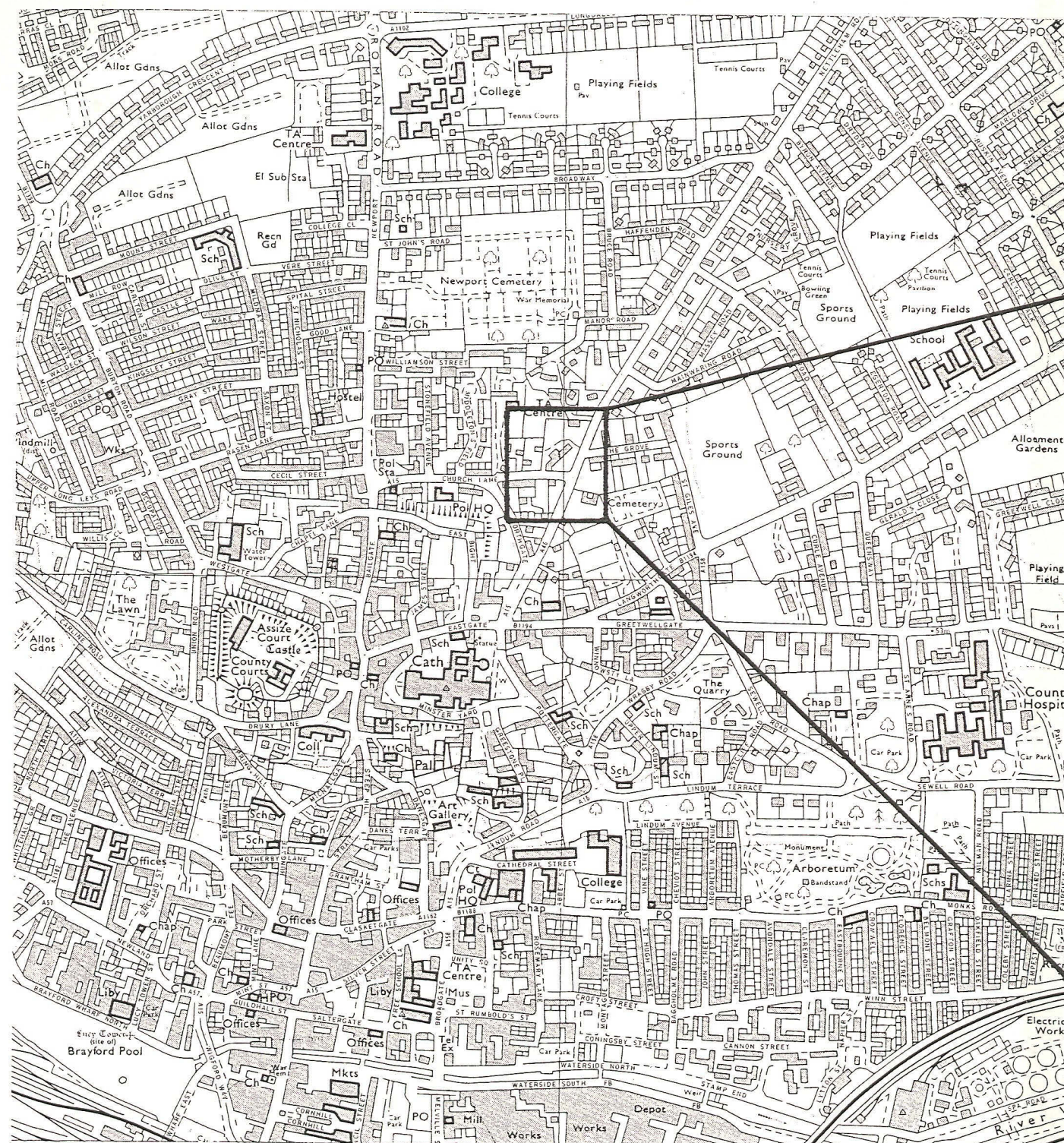

© Crown copyright

1:1250

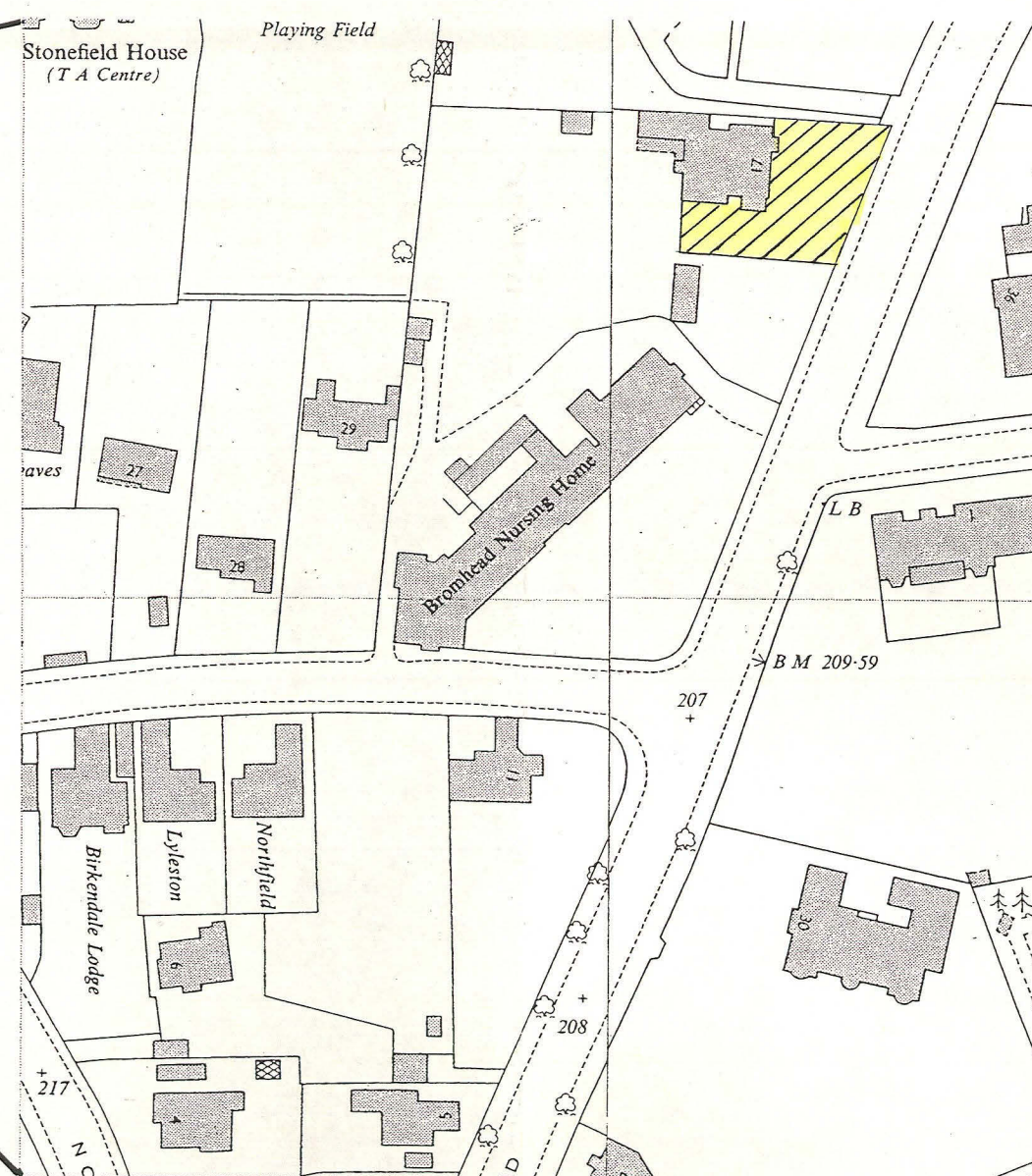

© Crown copyright

<b>CITY OF LINCOLN ARCHAEOLOGY UNIT</b>		
SITE CODE: NRE00	PLAN/ELEV/SECTION NO:	
CLIENT: Bromhead Hospital Ltd.		
DESCRIPTION:  Site Location Plan		
SCALE:	ARCHIVE NO:	
DRAWN BY:	CHECKED:	DATE:
MUSEUM ACCESSION NO:		2000.253

Fig.1



## CITY OF LINCOLN ARCHAEOLOGY UNIT

SITE CODE: NRE00	PLAN/ELEV/SECTION NO:
------------------	-----------------------

CLIENT: Bromhead Hospital Ltd.

DESCRIPTION:	Plan of Proposed Development Showing Excavated Areas
--------------	---

SCALE: 1:200	ARCHIVE NO:
--------------	-------------

ARCHIVE NO:

DRAWN BY:	CHECKED:	DATE:
-----------	----------	-------

CHECKED:      DATE:

MUSEUM ACCESSION NO: 2000.253

2000.253

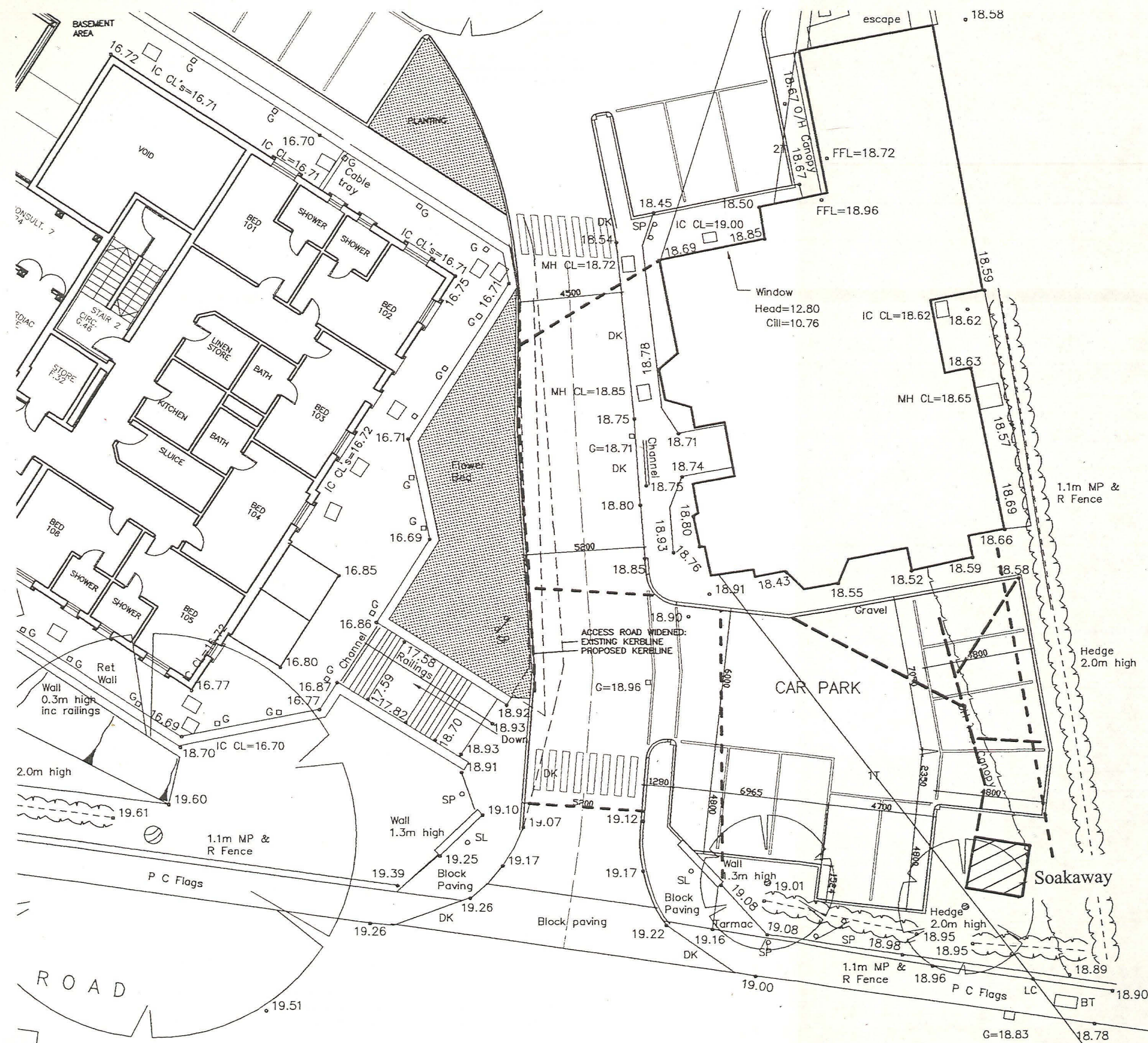

## KEY

— — — Line of Surface Water Drain Trenches

Line of Duct Trenches

Based upon John Roberts Architects Ltd drawing No. 5490B/140

Fig.2



# CITY OF LINCOLN ARCHAEOLOGY UNIT

SITE CODE: NRE00	PLANE/ELEV/SECTION NO:
CLIENT: Bromhead Hospital Ltd.	
DESCRIPTION: West-facing Section 1	
SCALE: 1:20	ARCHIVE NO:
DRAWN BY: KW	CHECKED: DATE: 23/10/2000
MUSEUM ACCESSION NO: 2000.253	

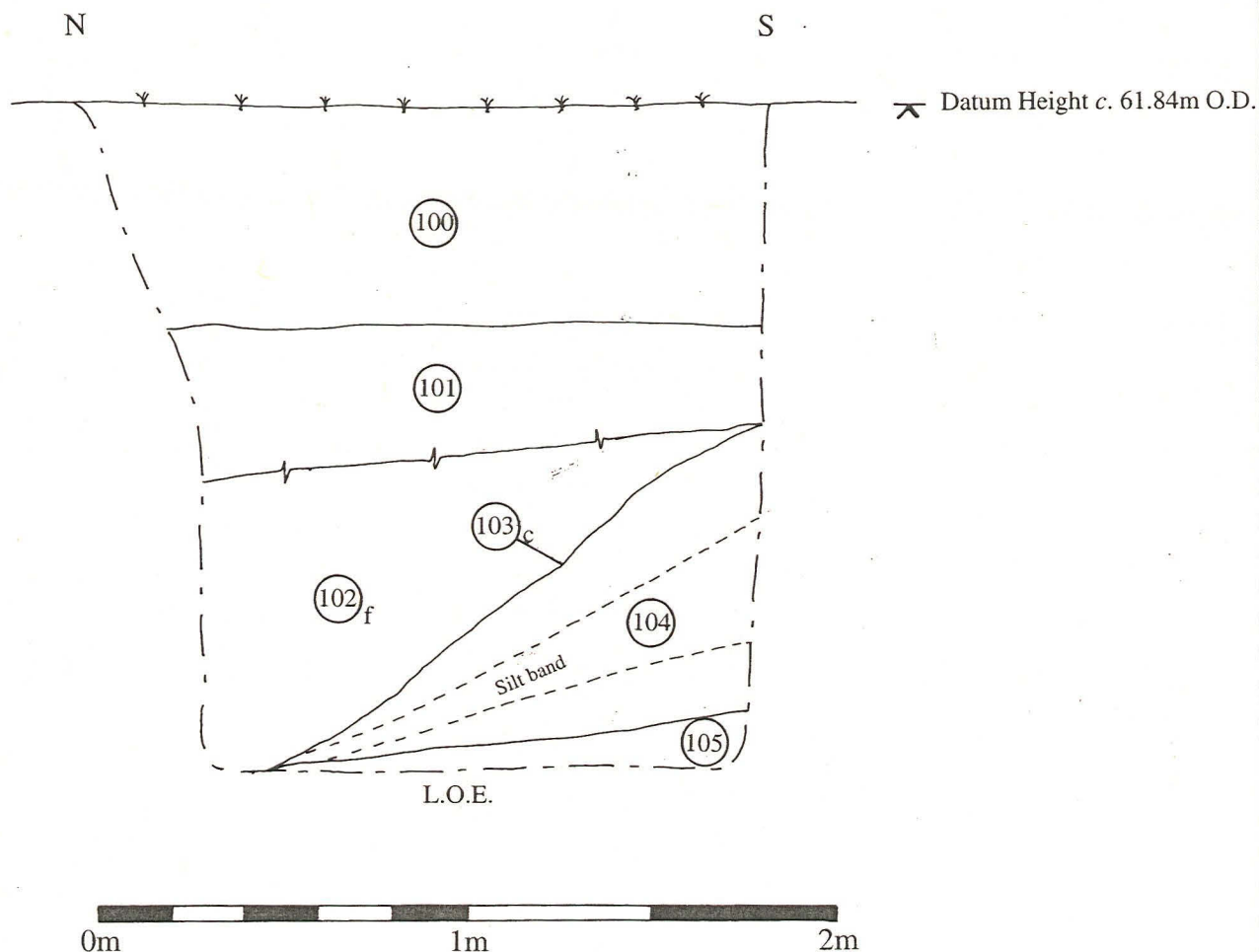

- (100) Moderately compacted mid-dark grey-brown clayey silt topsoil, containing occasional fibrous roots and occasional dumps of modern material. Turf @ upper boundary
- (101) Moderately compacted mid-brown clayey silt containing frequent small irregularly shaped limestone inclusions and very occasional small flecks of brick/tile
- (102) Moderately compacted mid-dark brown clayey silt containing occasional small flecks of limestone and brick/tile
- (103) Possible cut feature; not fully revealed but possibly oriented E-W
- (104) Moderate-loose compaction mixed mid-brown sandy silt and mid-light yellow-brown clay/degraded limestone. Contains moderately frequent amounts of small limestone pieces, occasional small flecks of limestone and brick/tile. Probably the upper boundary of the natural limestone brash deposit
- (105) Moderate-well compacted, friable, light yellow-brown degraded limestone and clayey sand, containing no obvious inclusions. Upper boundary of natural limestone deposit

Fig.3