

JB

M130

**INTERIM STATEMENT FOR AN
ARCHAEOLOGICAL WATCHING BRIEF
OF DEVELOPMENT AT
WATERGATE,
QUADRING,
LINCOLNSHIRE
(QWG 01)**

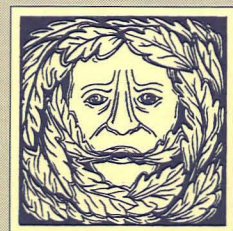

A P S
ARCHAEOLOGICAL
PROJECT
SERVICES

Full report EVENT : L14243 in Box 113/12

**INTERIM STATEMENT FOR AN
ARCHAEOLOGICAL WATCHING BRIEF
OF DEVELOPMENT AT
WATERGATE,
QUADRING,
LINCOLNSHIRE
(QWG 01)**

Report Compiled by
P. Cope-Faulkner BA (Hons) AIFA

October 2001

Planning Application No: H15/1306/00
National Grid Reference: TF 2297 3358

5

A.P.S. Report No: 140/01



INTERIM STATEMENT

ARCHAEOLOGICAL WATCHING BRIEF OF DEVELOPMENT AT 99-101 WATERGATE, QUADRING, LINCOLNSHIRE

1. BACKGROUND

An interim statement has been requested before additional development can be undertaken at Watergate, Quading, Lincolnshire. The development comprises the construction of two bungalows with attached garages and the provision of services. Approval for the development was sought through the submission of planning application H15/1306/00. Permission was granted subject to a standard condition for archaeological recording.

However, the development had begun without archaeological supervision and the foundations for Plot 2 had been completed. Archaeological recording was restricted to drainage trenches located northwest of the foundation trenches. This report details the results of the archaeological recording of these drainage trenches.

2. TOPOGRAPHY AND GEOLOGY

Quading is situated 10km north of Spalding, in the administrative district of South Holland, Lincolnshire. The development site is located *c.* 650km northwest of the centre of Quading and is centred on National Grid Reference TF 2297 3358.

Local soils at the site are Stockwith Series or Wisbech Series, both typically calcareous alluvial gley soils (Robson 1990, 28, 36). These soils overlie a drift geology of young marine alluvium which overlies a solid geology of Jurassic Oxford Clay (BGS 1992).

3. ARCHAEOLOGICAL BACKGROUND

The development site is located in an area of archaeological remains dating from the Romano-British period to the present day. Romano-British pottery has been discovered in fields to the north, south and west (Hayes and Lane 1992, 33). Additionally Middle Saxon pottery is known from immediately southwest of the site. Watergate itself possibly marks the route of a Late Saxon sea bank, the development site lying landward of this. Medieval and later remains are generally concentrated on Quading and Quading Eaudyke to the east.

4. METHODOLOGY AND RESULTS

As only a small part of the development was available for archaeological recording, the side of the trench was cleaned and rendered vertical. Each archaeological deposit was allocated a unique reference number (context number) with an individual written description. A photographic record was compiled and a section was drawn at a scale of 1:10.

Four deposits were encountered during the investigation. The earliest was a firm yellowish brown silt (004) which was overlain by a 0.25m thick layer of bluish grey (oxidising to a yellowish brown) clay (003). Both these deposits were identified as the underlying alluvium.

Sealing the alluvium was a subsoil of firm mid greyish brown silt (002) that measured 0.7m thick and which was sealed by a 0.25m thick topsoil comprising dark greyish brown silt (001).

Finds were retrieved from only the topsoil and comprise a single sherd of Black Glazed Earthenware of 18th century date and a fragment of handmade brick which could date from the medieval to post-medieval periods. Such finds derived from the topsoil may indicate nothing more than a manuring scatter.

5. BIBLIOGRAPHY

BGS, 1992, *Spalding: Solid and Drift edition*, 1:50000 geology map sheet 144

Hayes, P.P. and Lane, T.W., 1992, *The Fenland Project Number 5: Lincolnshire Survey, The South-West Fens*, East Anglian Archaeology 55

Robson, J.D., 1990, *Soils of the Boston and Spalding District (Sheet 131)*, Memoirs of the Soil Survey of Great Britain

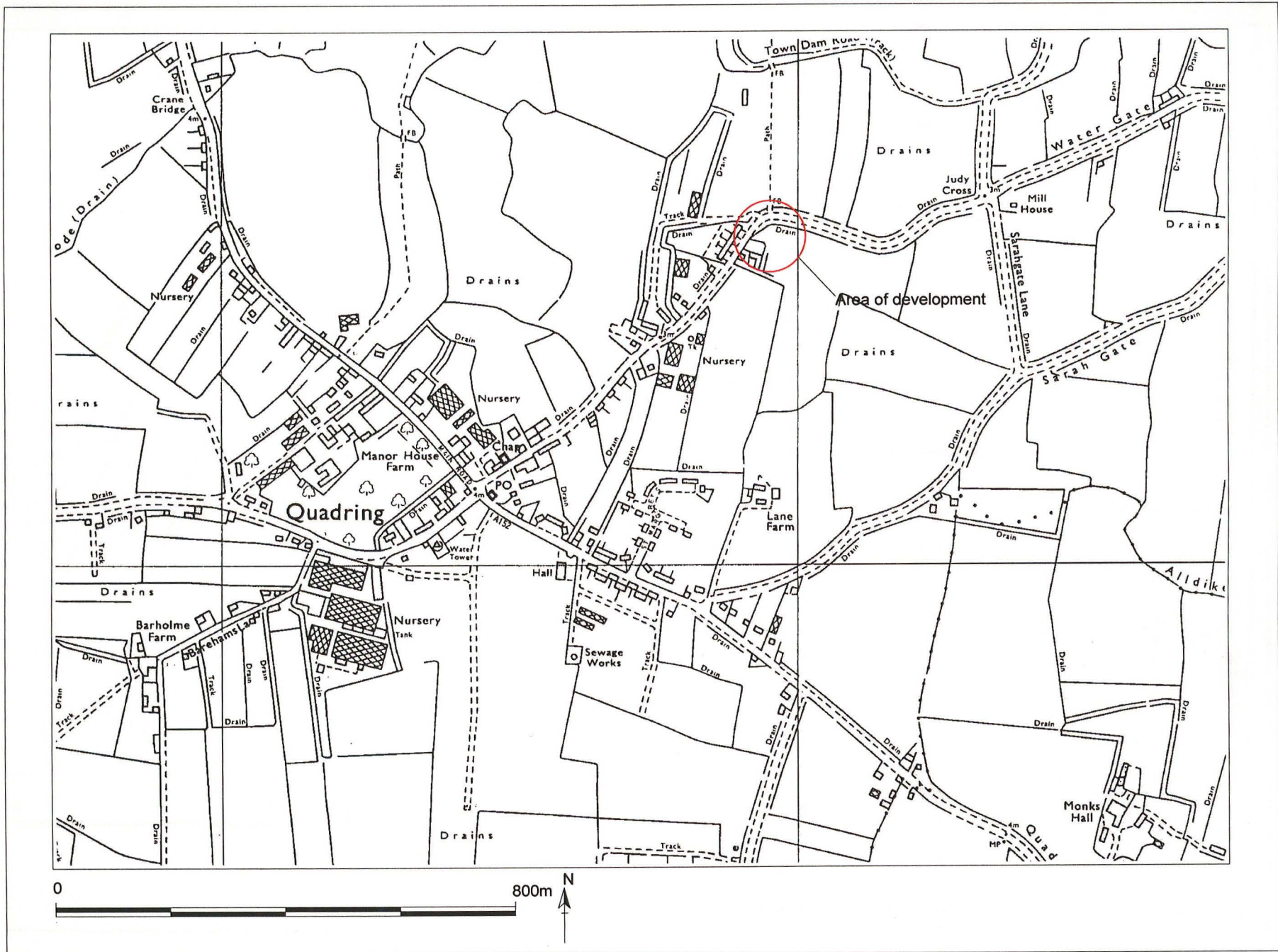

Figure 1 - Site location plan

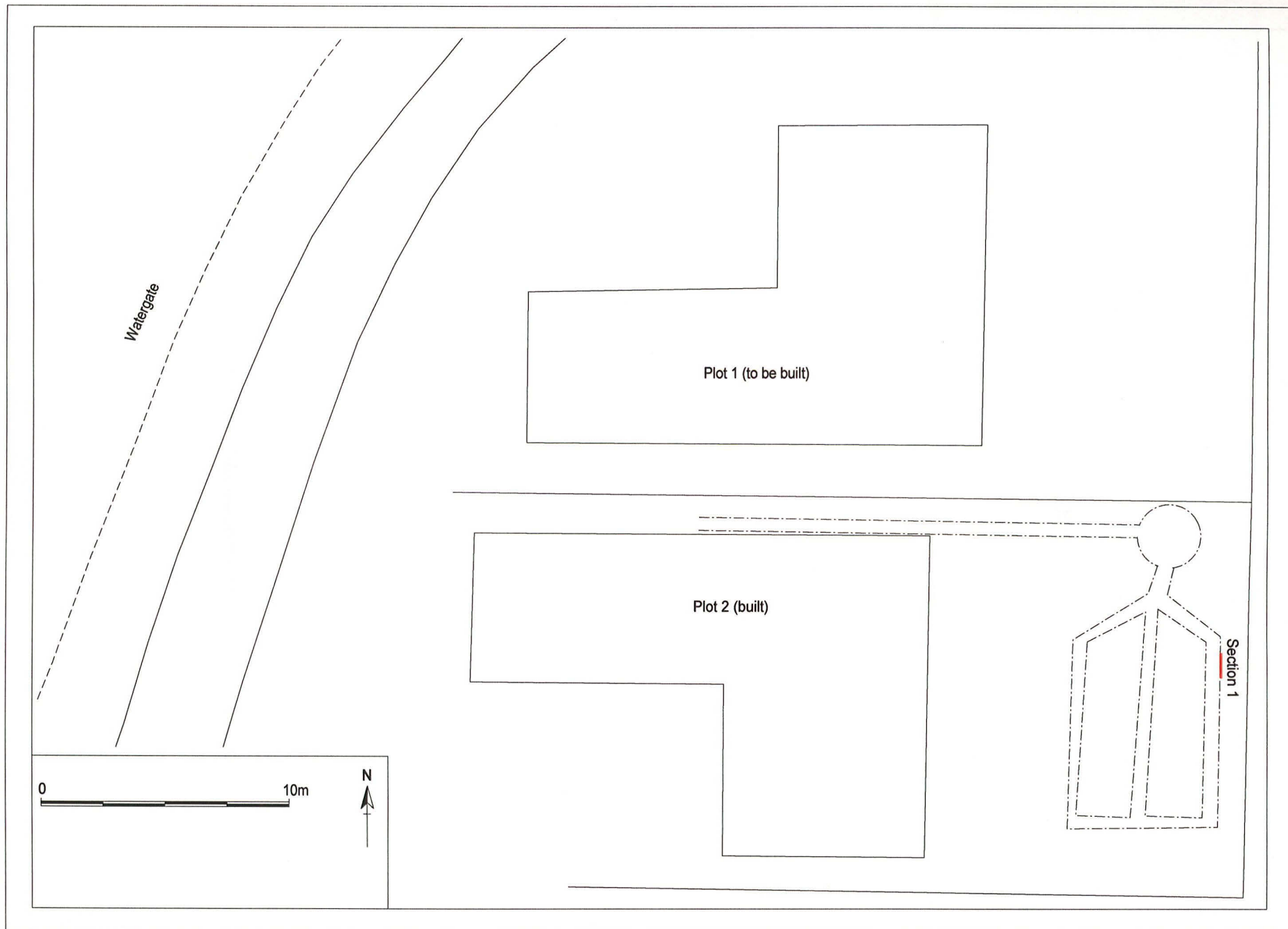
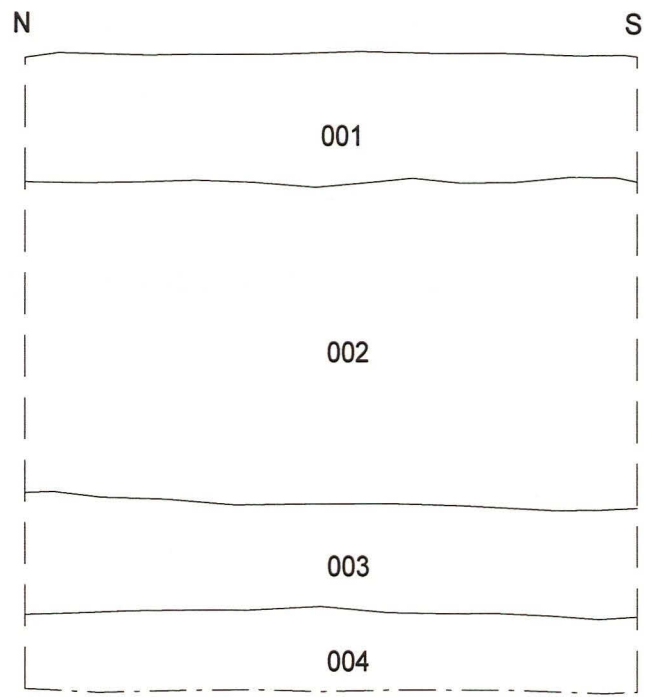

Figure 2 - Plan of the development



Section 1



Figure 3 - Section 1