

# Archaeological watching brief on land on Templefield Road, Willoughton

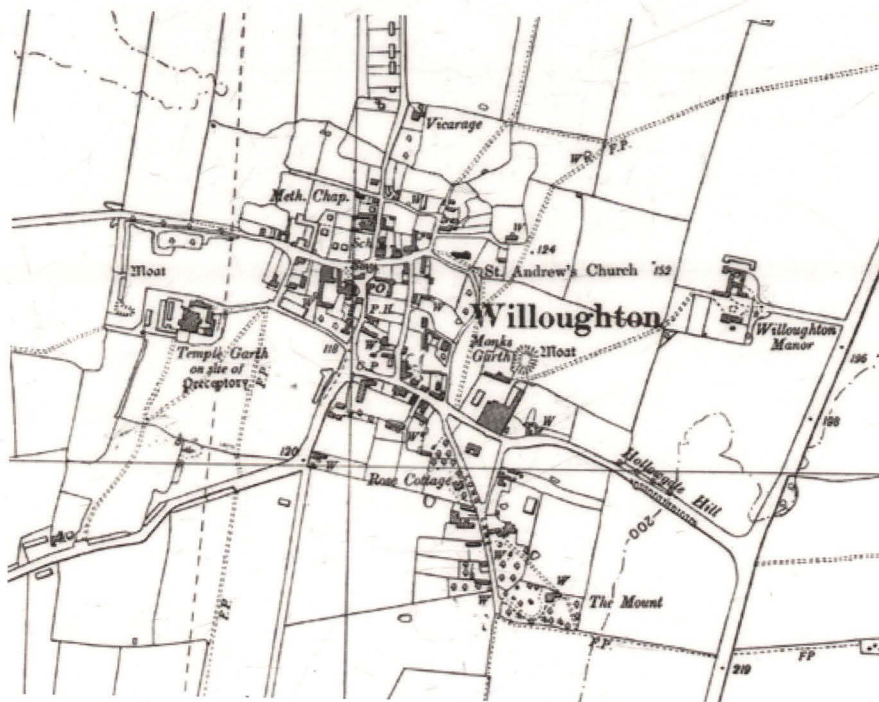

By  
Helen Fenwick



**Wetland  
Archaeology &  
Environments  
Research  
Centre**

Report No LIN/03-01

EVENT L14414

SOURCE L19020  
L19021

L15031

NEGATIVE

Conservation  
Services

22 OCT 2003

Highways & Planning  
Directorate

Archaeological watching brief on land on  
Templefield Road, Willoughton

25<sup>th</sup> September 2003

By  
Helen Fenwick

Planning Reference Number M03/P/0397  
Site Code WIL03



**W**etland  
**A**rchaeology &  
**E**nvironments  
**R**esearch  
**C**entre

Report No: LIN/03-01

---

#### Non-technical summary

---

An archaeological watching brief was undertaken on the site of two new dwellings on Templefield Road, Willoughton. The watching brief took place during the excavation of the footings for the new buildings.

The watching brief found no evidence for archaeological remains on the site. The area under investigation consists of a mixed, brown coloured clayey-sand topsoil directly over an orangey-brown clay, with the footings being excavated to a maximum depth of 2.5 m. The construction work has had no impact on the archaeological resource.

---

Preliminaries

---

Client: T.H. Rowson & Sons, Glebe Farm, Wrawby, Brigg

Telephone: 01652 652202

Contractor: Wetland Archaeology and Environments Research Centre, University of  
Hull, Hull, HU6 7RX

Telephone: 01482 466064 Fax: 01482 465362 E-mail: [WAERC@hull.ac.uk](mailto:WAERC@hull.ac.uk)

---

## Contents

---

1. Introduction	5
2. Background	6
3. The watching brief	7
4. Conclusions	8
Figures	9



---

## 1. Introduction

---

- 1.1 The Wetland Archaeology and Environments Research Centre was commissioned by T.H Rowson & Sons to carry out a watching brief on the development of two new houses with garages (SK929793040) in the fulfilment of the requirements of the planning application (Figure 1).
- 1.2 The work was carried out between 18<sup>th</sup> and 20<sup>th</sup> August 2003. This watching brief was undertaken in order to determine the character and extent of any below ground archaeological deposits uncovered during the proposed development and to record any such deposits.

---

## 2. Background

---

- 2.1 The site is located on a plot of land to the east of Templefield Road, Willoughton (Figure 1).
- 2.2 The development lies at the southern end of the village, to the east of Temple Garth, the location of a Knights Templar Perceptory. This is a Scheduled Ancient Monument (SAM 22612) and it may be considered that the site under development may have had associated remains to this settlement. To the northeast of the development site is the moated site of Monks Garth, also a Scheduled Ancient Monument (SAM 22618).

---

### 3. The watching brief

---

- 3.1 To complete the brief an archaeologist was on site to view the excavation of the footings for the new structures.
- 3.2 The site is situated on an area of pasture, with further houses to the north and south. The field had in recent times been ploughed and no signs of any earthworks were visible on the surface.
- 3.3 Two houses with associated garages were to be constructed set back from the main road, leaving a large area of undeveloped land at the rear to form gardens to the new properties (Figure 2).
- 3.4 During the excavation of the footings it was clear that there were no archaeological features within the area. The depth of the footings varied with the majority being dug to 1 m, but the northeastern corner of the north plot being dug to 2.5 m on the request of the Building Inspector due to the proximity of a poplar tree. The footings were no more than 0.7 m width. The sequence of deposits was the same throughout the footings. A mixed, brown clayey-sand topsoil of roughly 0.3 m depth overlay the natural orangey brown clay.
- 3.5 The only features that were noted during the watching brief were numerous field drains forming a complex network over the site.



---

#### 4. Conclusions

---

- 4.1 No archaeological deposits were recovered or recorded during the watching brief. The topsoil directly overlay the natural deposits. The area had previously been heavily affected by the insertion of numerous field drains. This development had no impact on the archaeological resource.
- 4.2 As no settlement evidence was visible within the development area it would suggest that the plot fell outside the core of the Medieval settlement at Willoughton.

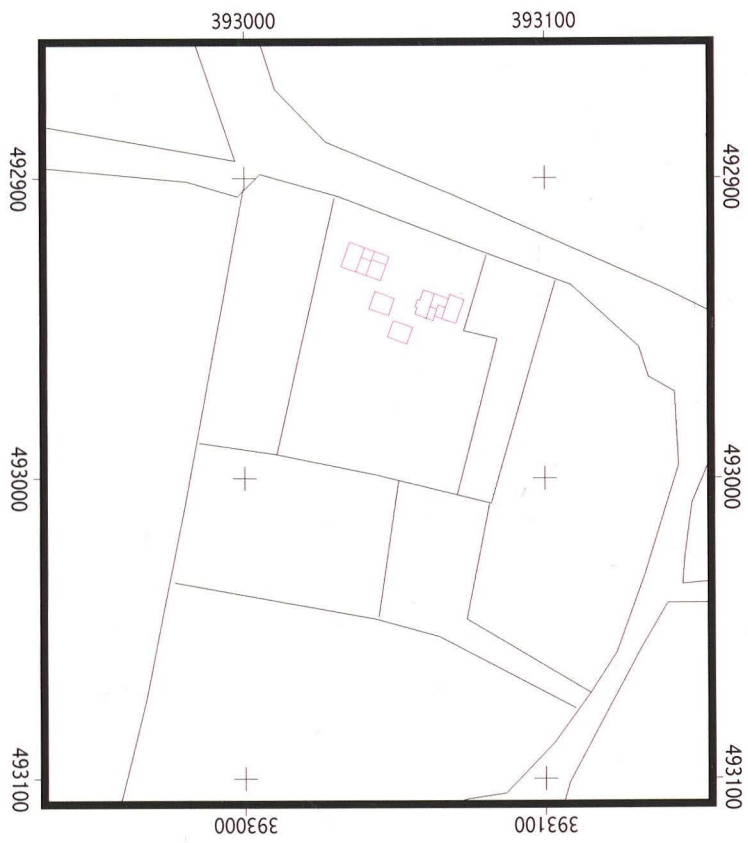

Figure 1. Location plans showing the development area.

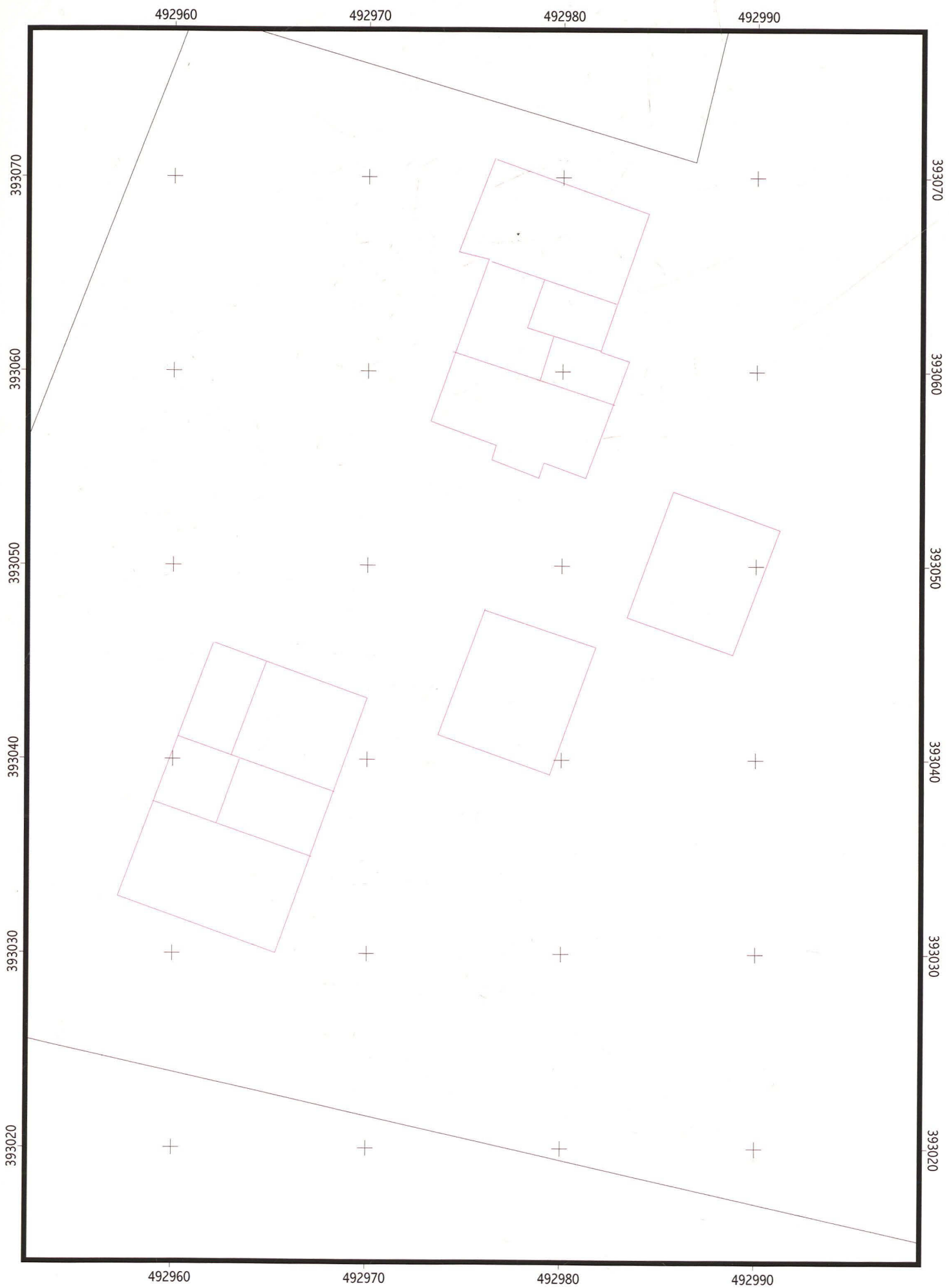

Figure 2. Plan showing the location of the house footings.