

EU 6628

SL1998

94/10

-VE



LINDSEY ARCHAEOLOGICAL SERVICES

FRANCIS HOUSE SILVER BIRCH PARK GREAT NORTHERN TERRACE LINCOLN LN5 8LG

WITHAM ROAD WOODHALL SPA

ARCHAEOLOGICAL EVALUATION

Report for

BROADGATE BUILDERS (SPALDING) LTD

July 1994

WITHAM ROAD WOODHALL SPA Archaeological Evaluation

INTRODUCTION

Archaeological evaluation was carried out on land north of Witham Road designated as Phase 1 of the Woodhall Chase building development by Broadgate Builders (Spalding Ltd). This comprised a geophysical survey which was undertaken by Oxford Archaeotechnics Ltd and is the subject of a separate report (Johnson 1994).

Two small areas were the subject of intensive magnetometer survey and very slight magnetic readings in Area 2 were interpreted as possible remnants of earlier cultivation. In order to verify the reason for these enhanced readings, a single machine trench was excavated from the edge of the field through an area of no known activity and into the area with slight anomalies. The trench was positioned in this way to minimise damage to the crop.

RESULTS

The machine trench was 2.20m wide and 47.40m in length and was excavated to a depth of 0.40m using a 6ft front loading shovel. Apart from a land drain which crossed the trench diagonally, there was no other visible feature. This drain was laid four years ago (farmer, pers.comm).

The topsoil depth was c.0.40 along the length of the trench. It immediately overlay natural silty deposits. There was considerable variation in the soil colouration, possibly the result of leaching and iron panning. All the deposits encountered were alluvial in origin and comprised a fine silt containing a few rounded pebbles.

Slight undulations in the natural may reflect the presence of ploughed out ridge and furrow. The variation in height was too slight to measure. These shallow undulations are thought to account for the slight lineations which were picked up by the magnetometer survey.

The site was viewed by the Assistant County Archaeological Officer prior to backfilling.

CONCLUSION

There were no detectable archaeological features within the machine trench. There were no artefactual finds except for two fragments of modern land drain which were discarded.

Reference

Johnson, A.E. 1994. *Woodhall Chase, Woodhall Spa, Lincolnshire. Topsoil Magnetic Susceptibility and Gradiometer Survey*. Report ref. 0460694/WOL/LAS

Naomi Field July 28th 1994

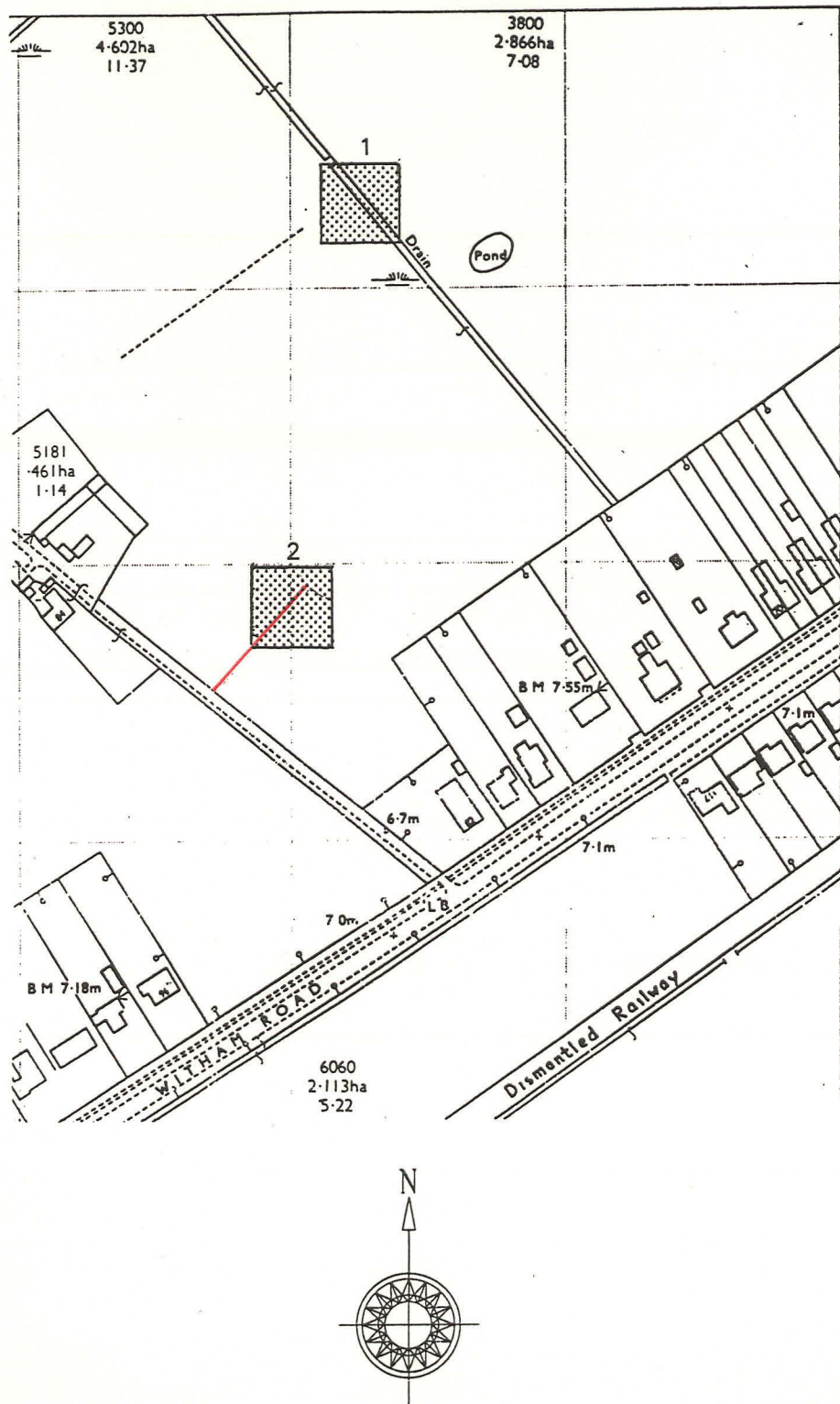

Fig. 1 Witham Road, Woodhall Spa. Trench location and position of magnetometer survey grids. Reproduced from the 1:2500 O.S. map with permission of the Controller of HMSO. Crown copyright. (LAS Licence no. AL50424A)