

MS/19



LINDSEY ARCHAEOLOGICAL SERVICES

**Land to the rear of Rose Cottage, Main Road
Laughterton, Kettlethorpe, Lincs
Archaeological Watching Brief**

NGR: SK 8367 7592

Site Code: LARCS 05

LCNCC Accession No.: 2005.211

Planning Application No.: M02/P/0716 and M05/P/0370

Report for

Hawthorn Construction (Lincoln) Ltd

By

M. Garrett & I. Rowlandson

LAS Report No.: 870

October 2005

25 WEST PARADE · LINCOLN · LN1 1NW

TELEPHONE 01522 544554 · FACSIMILE 01522 522211 · EMAIL las@linarch.co.uk

Lindsey Archaeological Services LLP Registered in England and Wales No. OC304247

Registered address 25 West Parade · Lincoln · LN1 1NW

VAT Registration No. 819 8029 41

Conservation
Services

07 NOV 2005

Highways & Planning
Directorate

List of Figures

Fig 1 Location of Rose Cottage, Laughterton, based on the 1980 Ordnance Survey 1:10,000 scale

Contents

© Crown copyright, reproduced with the permission of the Controller of HMSO
LAS Licence No. AL 10000185

List of Figures	ii
List of Plates	ii
Summary	1
Introduction	1
Site Location and Description	1
Planning Background	1
Archaeological Background	1
Aims and Objectives	1
Method	2
Results	2
Discussion	2
Conclusion	2
Contents of the Site Archive	2
Figures	
Plates	

List of Figures

Fig. 1 Location of Rose Cottage, Laughterton, based on the 1980 Ordnance Survey 1:10,000 scale map sheet SK 87 NW. Crown copyright, reproduced with the permission of the Controller of HMSO. LAS Licence No. AL 100002165.

Fig 2 Plan showing the location of the demolished buildings and the location of the two new bungalow plots.

Fig. 3 Plan of Bungalow 2.

List of Plates

Pl. 1 The site, looking west across the A1133

Pl. 2 Bungalow Plot 2, looking south-west

Pl. 3 The south-west corner of Plot 2, looking east. Scale 2m.

Pl. 4 Excavation of the southern external wall foundation, looking east.

Pl. 5 Internal wall foundations, looking east.

Pl. 6 Modern in-fill/pond 103, looking north-east.

**Land to the rear of Rose Cottage, Main Road
Laughterton, Kettlethorpe, Lincs
Archaeological Watching Brief
NGR: SK 8367 7592
Site Code: LARCS 05
LCNCC Accession No.: 2005.211
Planning Application No.: M02/P/0716 and M05/P/0370**

Summary

The monitoring of groundwork, for the construction of two new bungalows to the west of Rose Cottage, Laughterton, revealed a modern backfilled feature and natural sand heavily disturbed by roots, in Plot 2. No archaeological features were observed during the watching brief.

Introduction

Lindsey Archaeological Services (LAS) was commissioned by Mr. Andy Natrass (Hawthorne Construction, Lincoln) in October 2005 to undertake an archaeological watching brief on land to the west of Rose Cottage, Laughterton. The work was carried out in accordance with a brief dated 03/11/2005, and general requirements set out in the *Lincolnshire Archaeological Handbook* published by the Archaeology Section, Lincolnshire County Council (1998). Work commenced on the 04/11/2005 and was completed, 05/11/2005.

Site Location and Description

Laughterton is situated in the Trent Valley, in the parish of Kettlethorpe. It lies west of Kettlethorpe and Fenton on the A1133, approximately 18km northwest of Lincoln. The site was located in the centre of the village on the west side of Main Road (Fig. 1).

Planning Background

Planning permission was granted for the construction of two bungalows, subject to an archaeological watching brief being carried out during the groundworks for the development. Plot 1 is located immediately west of Rose Cottage, on the site of demolished buildings, and a Plot 2 to the rear (west) of Plot 1 (Fig. 2).

Archaeological Background

Laughterton is first mentioned in medieval records during the 13th century, although this does not mean it was a new settlement at that time. It has been part of the western half of Kettlethorpe parish since the 19th century. There was potential for medieval remains being disturbed by the groundworks stage of development.

Aims and Objectives

The purpose of the Watching Brief was to record any archaeological deposits disturbed during groundworks at the above site.

Method

Groundworks were monitored an experienced archaeologist. A full written and photographic record was made of the site. The trench bases and sides were hand-cleaned, where appropriate, to reveal features in plan and sections, to enable sufficient information about form, development date and stratigraphic relationships to be recorded.

Results (Fig. 3, Pls. 1 – 6)

Plot 2 had been stripped prior to the laying out of the foundations. Approximately 0.2m of turf and topsoil had been removed. The foundations were excavated to a depth of 0.7m beneath the stripped ground level. The remaining topsoil, a dark brown silt sand, **100**, was 0.25m deep covering a backfilled modern pit/pond feature, **103**, observed within the eastern half of the plot. It contained dark brown silt with crushed red brick, large fragments of reinforced concrete, tarmac and polythene inclusions, **104**. **103** cut a 0.45m deep heavily rooted brown orange sand, **101**. Undisturbed natural orange sand, **102**, was exposed at the base of the trench.

Based on the results of Plot 2, and the known truncation of Plot 1 by a number of previous buildings, LAS consulted the Lincolnshire County Council Archaeological Officer, Louise Jennings, who authorised the early conclusion of the watching brief.

Discussion and Conclusion

The only feature observed during the monitoring of Plot 2 was modern. Any earlier features would probably have been destroyed due to the large amount of intrusive root action within the development area. There were no signs of archaeological deposits surviving possibly due to modern disturbance and the plots being set back from the road.

Mike Garrett & Ian Rowlandson
Lindsey Archaeological Services
October 2005

Acknowledgements.

LAS would like to thank Mr. Andy Natrass (Hawthorne Construction, Lincoln) for his help. Archaeological monitoring of site was carried out by Ian Rowlandson. This report was edited by Naomi Field and collated by Doug Young.

Contents of the Site Archive

Record sheets
Plans
Sections
Correspondence
Photographs: LAS film nos. 05/93/1-30

THE FIGURES

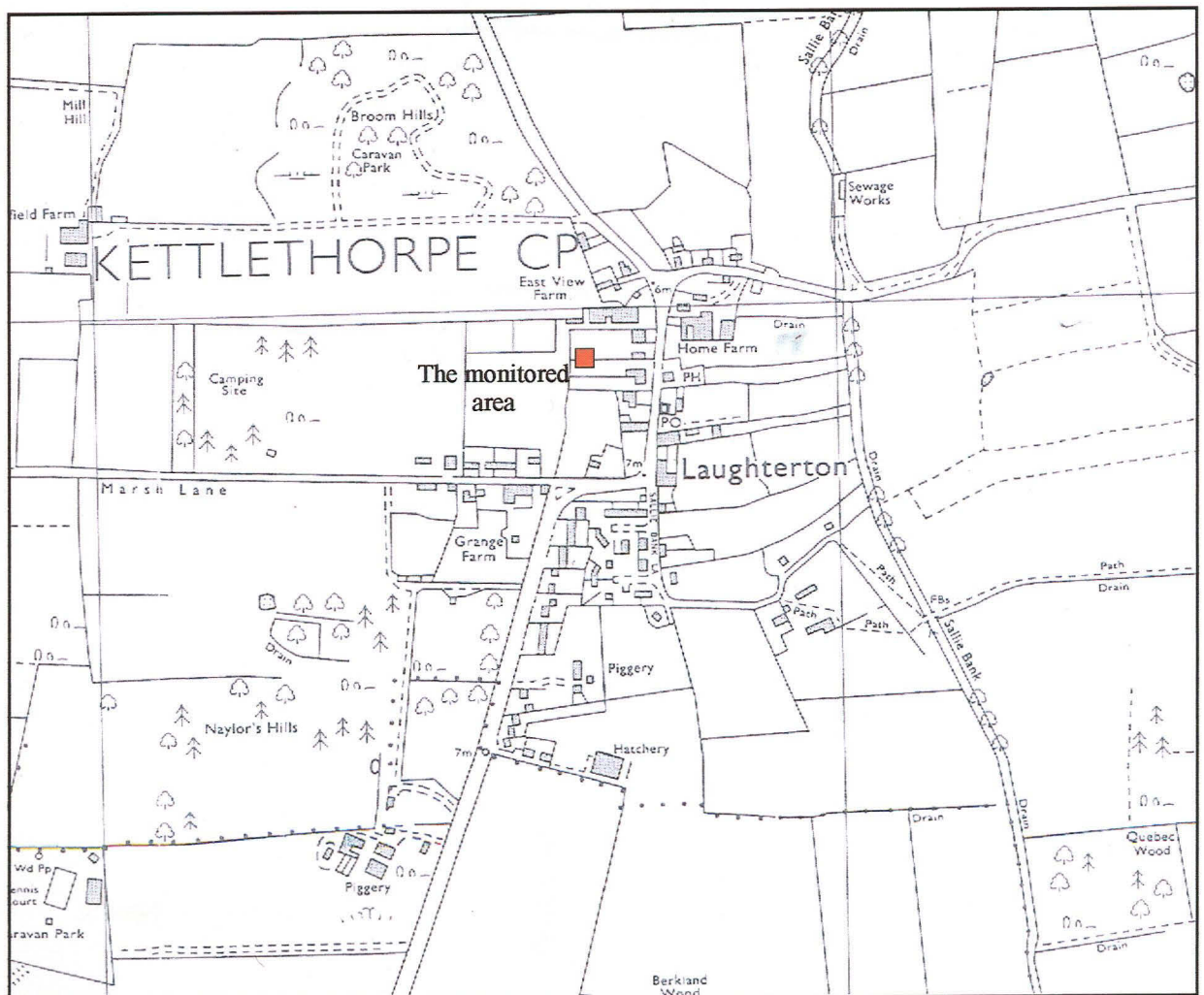
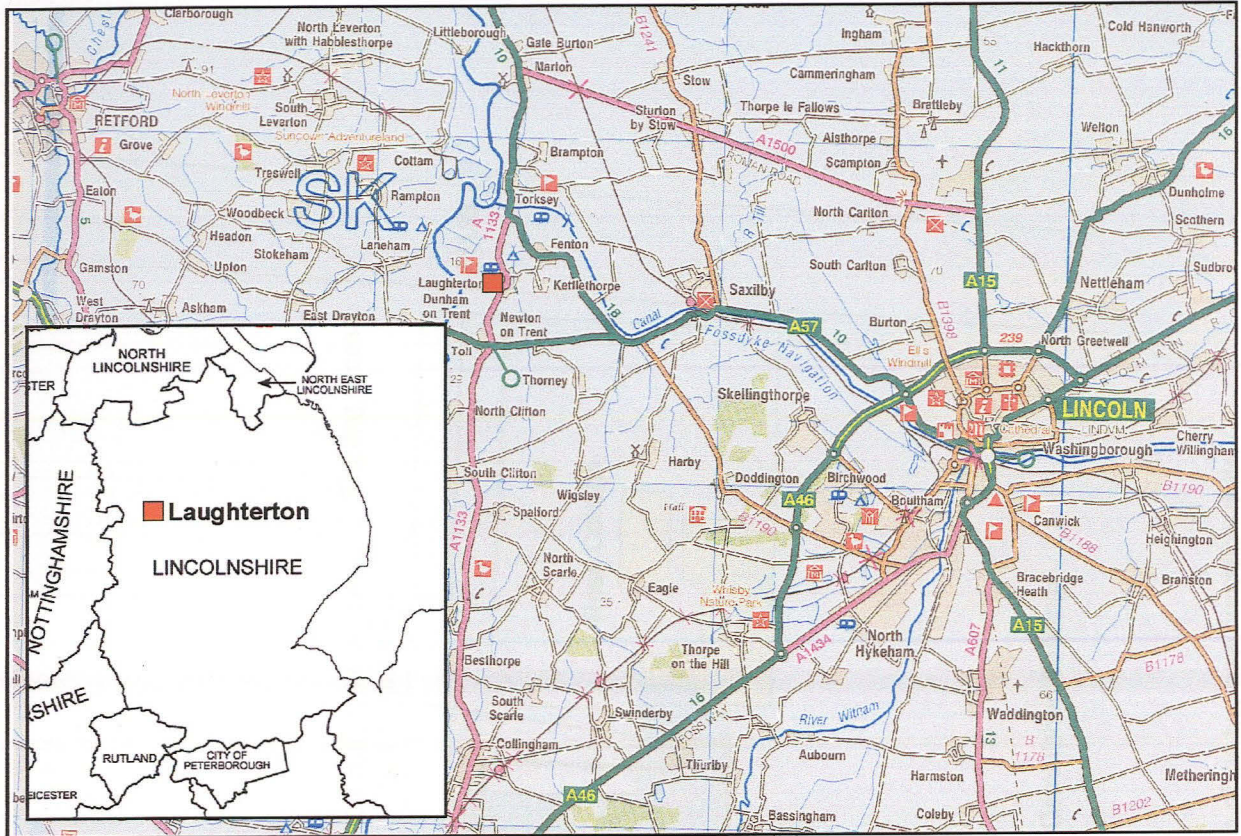

Fig 1 Location of Rose Cottage, Laughterton. Insert C based on the 1980 Ordnance Survey 1:10,000 scale map sheet SK 87 NW. Crown copyright, reproduced with the permission of the Controller of HMSO. LAS Licence No. AL 10002165.

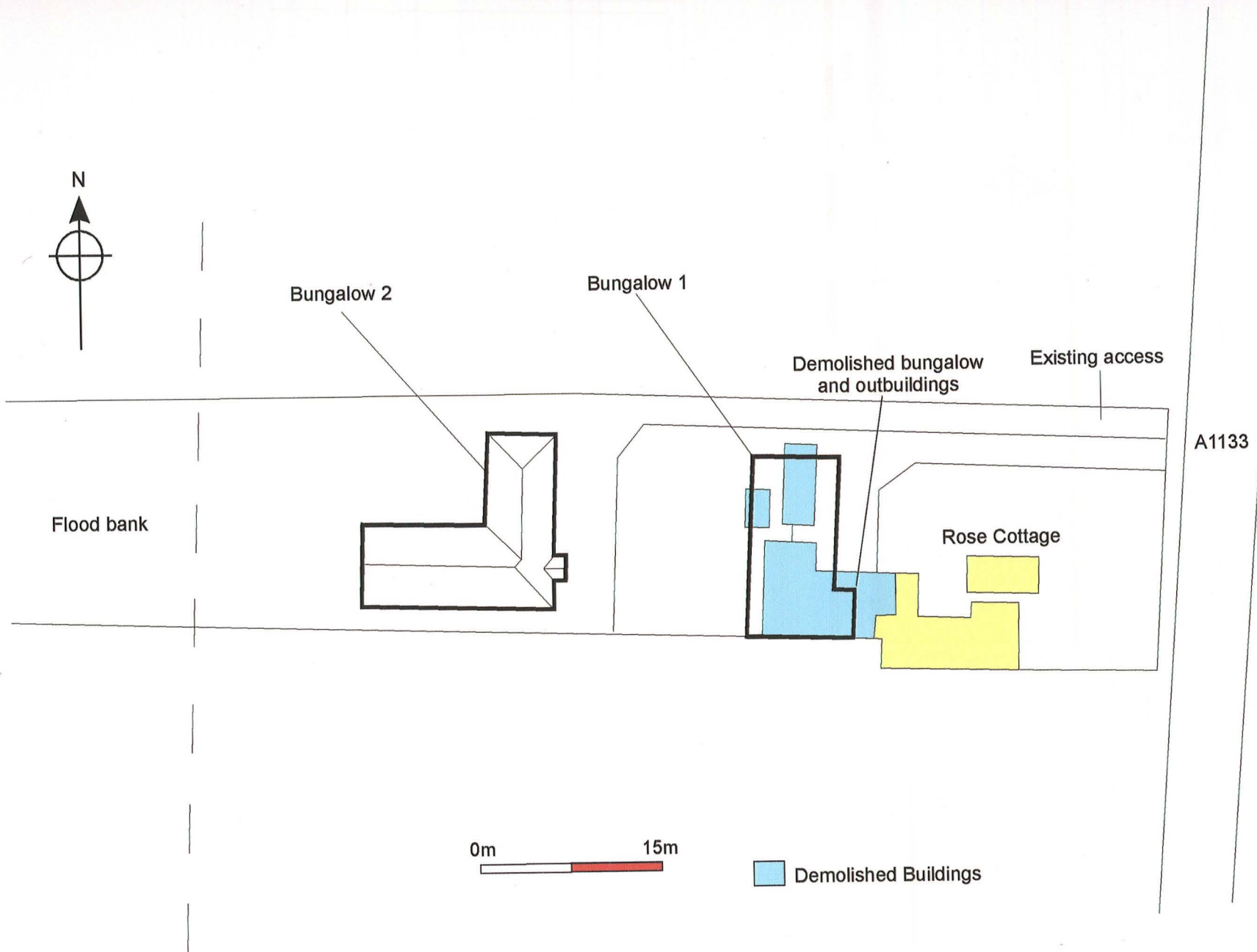

Fig 2 Plan showing the location of the demolished buildings and the location of the two new bungalow plots.

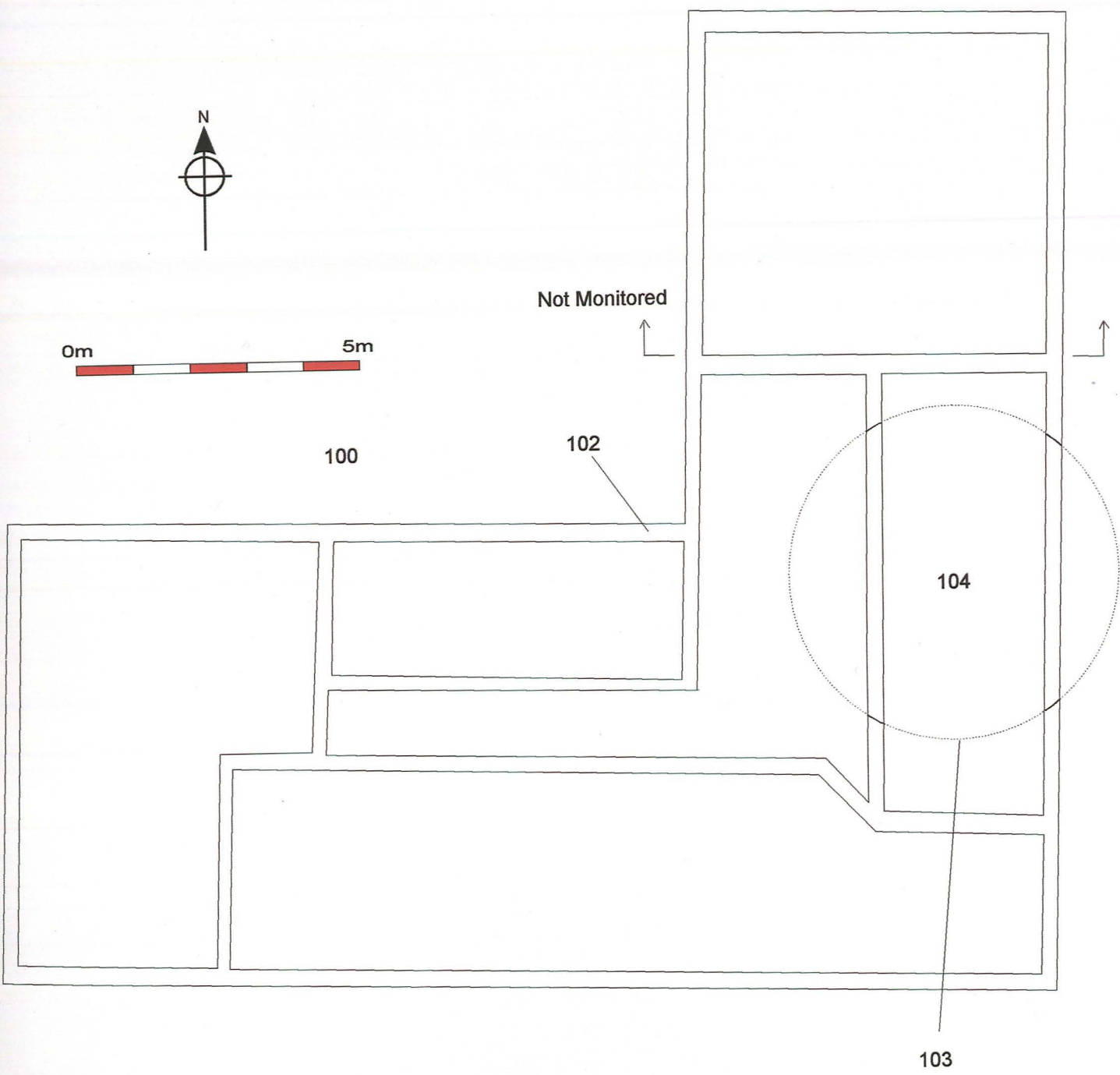

Fig 3: Plan of Bungalow 2

THE PLATES



PI. 1 The site, looking west across the A1133.



PI. 2 Bungalow Plot 2, looking south-west.



Pl. 3 The south-west corner of the Plot 2, looking east. scale 2m.



Pl. 4 Excavation of the southern external wall foundation, looking east.



Pl. 5 Internal wall foundations, looking east.



Pl. 6 Modern in-fill/pond 103, looking north-east.