

MS/13



LINDSEY ARCHAEOLOGICAL SERVICES

**Land to the East of Lincoln County Hospital,
Greetwell Road, Lincoln
Archaeological Watching Brief**

NGR: SK 99250 71800

Site Code: LHGR 05

LCNCC Accession No.: 2005.226

Planning Application: 2005/006/F

Report for

Marcus Worthington

(On behalf of Progress Housing Group Ltd)

By

M. Garrett

LAS Report No.: 877

October 2005

25 WEST PARADE · LINCOLN · LN1 1NW
TELEPHONE 01522 544554 · FACSIMILE 01522 522211 · EMAIL las@linarch.co.uk

Lindsey Archaeological Services LLP Registered in England and Wales No. OC304247
Registered address 25 West Parade · Lincoln · LN1 1NW

VAT Registration No. 819 8029 41

Conservation
Services

07 NOV 2005

Highways & Planning
Directorate

EVENT : ELI 6388

INTERVENTION : SLI 10358

EXCAVATION : SLI 10359

negative

Contents

List of Figures	ii
List of Plates	ii
Summary	1
Introduction	1
Site Location and Description	1
Planning Background	1
Archaeological Background	1
Aims and Objectives	2
Method	2
Results	2
Discussion	2
Conclusion	2
Acknowledgments	2
Contents of the Site Archive	3
Figures	
Plates	

List of Figures

Fig. 1 Location of Lincoln Hospital (insert B based on the 1980 Ordnance Survey 1:50,000 scale map Landranger Sheet 121. Crown copyright, reproduced with the permission of the Controller of HMSO. LAS Licence No. AL 100002165.

Fig. 2 Deposits observed during the topsoil stripping of the development site.

List of Plates

Pl. 1 The western half of the site, looking north-west.

Pl. 2 The eastern half of the site, looking south-west.

Pl. 3 East end of the site after stripping, looking east.

Pl. 4 West end of the site after stripping, looking south-west.

Land to the East of Lincoln County Hospital, Greetwell Road, Lincoln Archaeological Watching Brief

NGR: SK 99250 71800

Site Code: LHGR 05

LCNCC Accession No.: 2005.226

Planning Application: 2005/006/F

Summary

The monitoring of topsoil stripping, in advance of the construction of two new buildings to the east of Lincoln County Hospital, Greetwell Road, revealed evidence of quarrying and modern activity.

Introduction

Lindsey Archaeological Services was commissioned by Marcus Worthington on behalf of Progress Housing Group Ltd, to undertake an archaeological watching brief on Land to the East of Lincoln County Hospital, Greetwell Road, Lincoln. The work was carried out in accordance with a brief prepared by Under Construction Archaeology (dated May 2005), and the general requirements set out in the *Lincolnshire Archaeological Handbook* published by the Archaeology Section, Lincolnshire County Council (1998). Work commenced 12/10/2005 and was completed 17/10/2005.

Site Location

The development site lay to the east of the Lincoln County Hospital complex, to the south of Greetwell Road. Land to the east is part of a housing estate, and adjoins a hospital access road to the west. The site is c.50m east/ west at the street frontage, and approximately 100m wide at the rear (south end of the site); it extends c.50m south of the road (Fig 1, Pls. 1 and 2).

Archaeological Background

Prehistoric activity has been noted in the vicinity of the site. In the Roman period the site lay c.1.5km to the east of the Roman Fortress and later Colonia, and is likely to have been in agricultural use. The site is c.300m north-west of the 3rd-4th century site of Greetwell Roman Villa and archaeological remains associated with the villa could extend into the site. There is also some evidence for Roman burials in the vicinity.

Anglo-Saxon burials are also noted in the vicinity of the site. It has been suggested that the site may lie within, perhaps close to the centre of, the grounds of the monastery of Icahno. During the medieval period, and until the later 19th century, the site lay on agricultural land belonging to the Monks of Saint Mary's, York. The common fields were enclosed in 1803. Subsequent construction of Lincoln County Hospital, and the prison to the north-west, represented suburban growth east of Lincoln. From 1872 ironstone, and possibly limestone, was mined. Both drift and subterranean mining may be present on the site. More limited scale mining could have occurred in earlier periods.

Aims and Objectives

The purpose of the watching brief was to record any archaeological deposits disturbed during groundworks at the above site.

Method

The ground works were monitored by an experienced archaeologist. A full written and photographic record was made of the site. Trench bases and sides were hand-cleaned, where appropriate, to enable sufficient information about stratigraphic relationships to be recorded.

Results (Fig. 2, Pls. 3 – 5)

The site was stripped in zones which were then filled with stone, which meant an overview of the ground below was difficult to gauge. However, four deposits were revealed during monitoring. The topsoil, **1**, consisted of very dark grey brown sand silt, with frequent root inclusions. It had a maximum thickness of 0.14m. The subsoil, **2**, consisted of mid grey sand silt, with very frequent inclusions of modern debris (plastic, rope, pipe fragments and wood). Its maximum thickness was 0.05m at locations where it filled the undulations in the upper surface of the underlying limestone bedrock, **3** and quarry backfill, **4**, which was intermittent but extended c.50m from the southern site boundary. This subsoil is part of more modern landfill activity recorded to the north of the site.

Based on the results of the early phases of stripping, LAS consulted the City Archaeologist, Mick Jones, who authorised the early conclusion of the watching brief.

Discussion and Conclusion

Quarrying activity was recorded at the southern end of the site with modern landfill activity to the north. The present topsoil is the result of reinstatement, after the cessation of quarrying. There were no earlier archaeological features noted that could have been associated with the nearby Roman villa, probably due to the extent of the quarrying which would have destroyed any evidence.

Mike Garrett
Lindsey Archaeological Services
October 2005

Acknowledgements

LAS would like to thank Mr. Giles Worthington for his help. The ground works were monitored by Mike Garrett. This report was edited by Naomi Field and collated by Doug Young.

Contents of the Site Archive

Record sheets

Plans

Sections

Correspondence

Photographs: LAS film nos. 05/96/19-35 and 05/97/9-13,

THE FIGURES

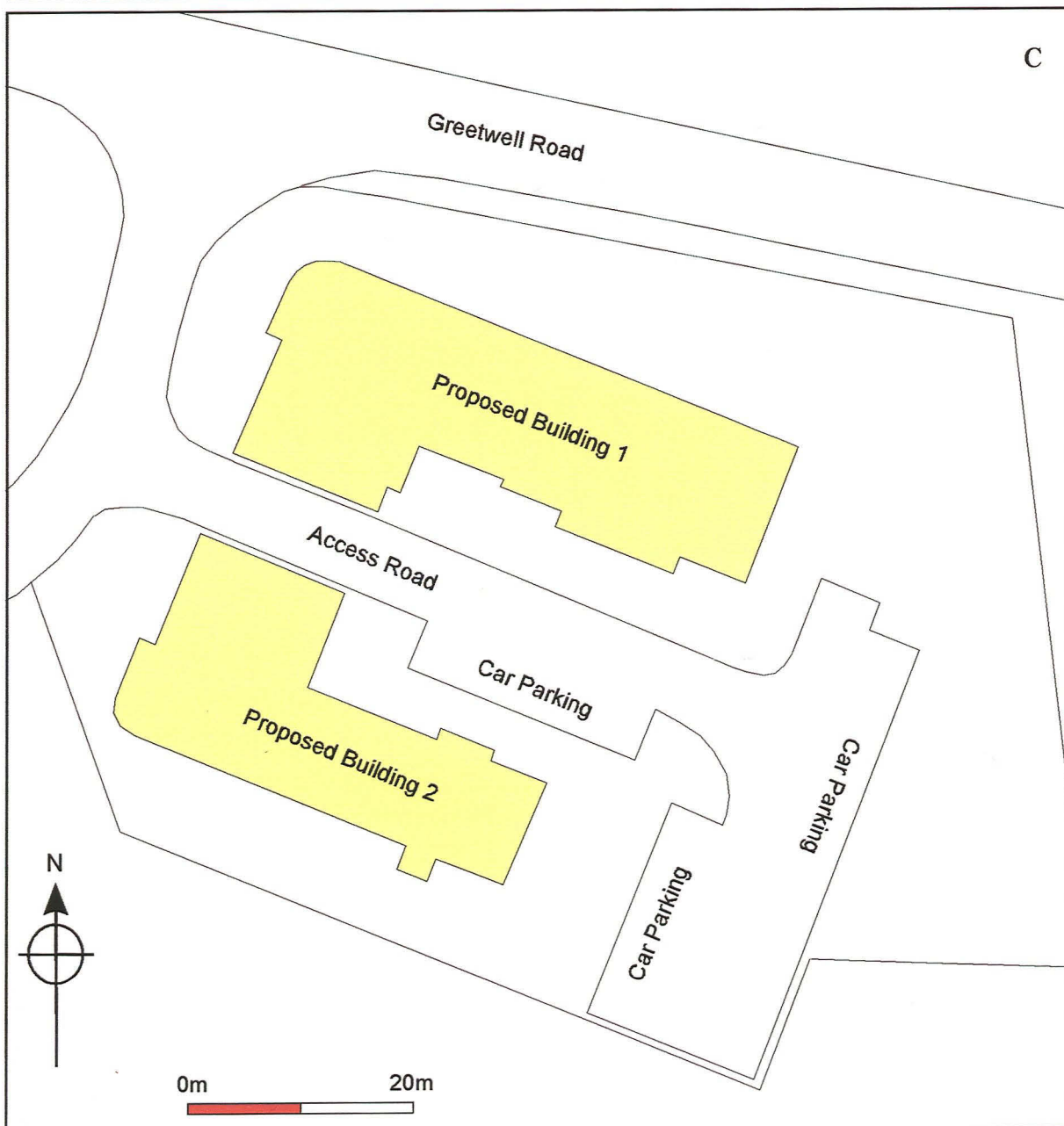
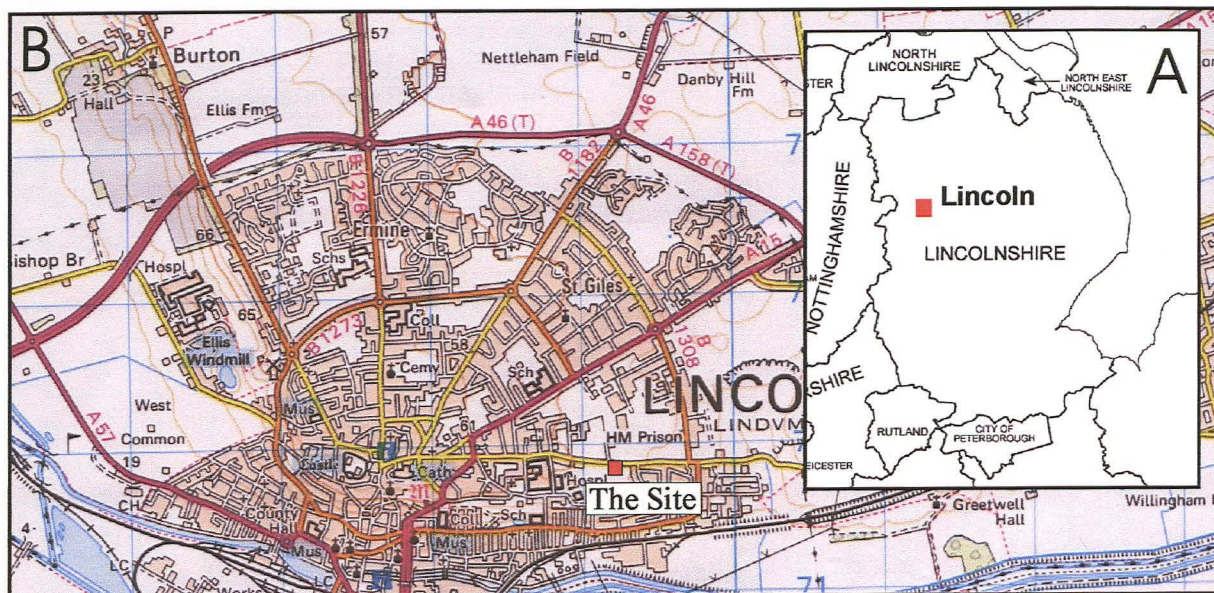

Fig. 1 Location of Lincoln Hospital (insert B based on the 1980 Ordnance Survey 1:50,000 scale map Landranger Sheet 121. Crown copyright, reproduced with the permission of the Controller of HMSO.

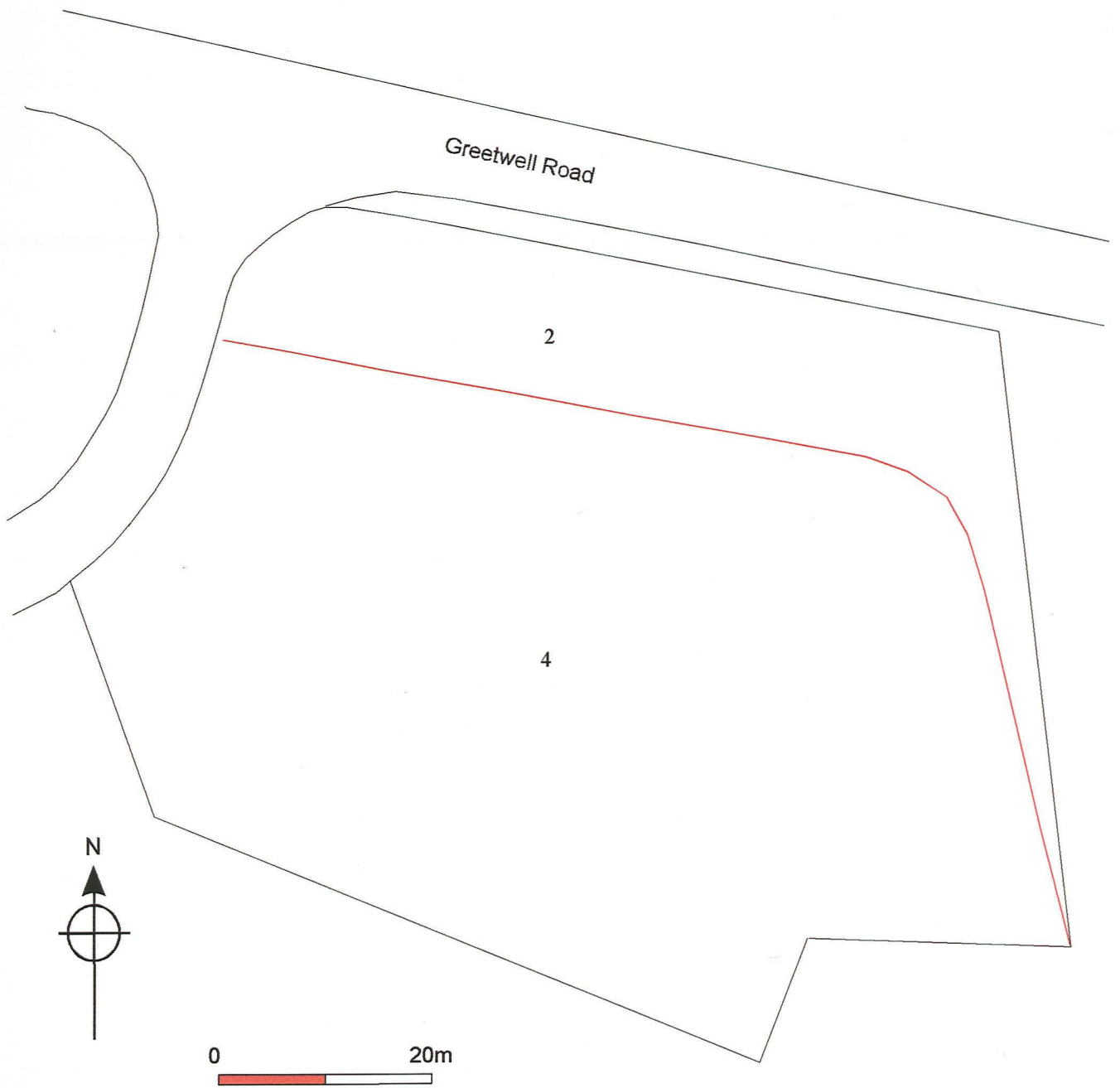

Fig. 2 Deposits observed during the topsoil stripping of the development site.

THE PLATES



Pl. 1 The western half of the site, looking north-west.



Pl. 2 The eastern half of the site, looking south-west.



Pl. 3 East end of the site after stripping, looking east.



Pl. 4 West end of the site after stripping, looking south-west.