



LINDSEY ARCHAEOLOGICAL SERVICES

**17-19 Reynard St, Spilsby, Lincs.
Archaeological Watching Brief**

NGR: TF 4022 6625

Site Code: SRS 05

LCNCC Accession No.: 2005.225

Planning Application No.: No.: S/165/01177/05

Report for

Mr. Dawson

By

M. Garrett

LAS Report No.: 876

October 2005

25 WEST PARADE · LINCOLN · LN1 1NW

TELEPHONE 01522 544554 · FACSIMILE 01522 522211 · EMAIL las@linarch.co.uk

Lindsey Archaeological Services LLP Registered in England and Wales No. OC304247

Registered address 25 West Parade · Lincoln · LN1 1NW

VAT Registration No. 819 8029 41

Conservation
Services

07 NOV 2005

Highways & Planning
Directorate

negative.

Contents

List of Figures

List of Figures ii

List of Plates

List of Plates ii

Summary 1

Introduction 1

Site Location and Description 1

Planning Background 1

Archaeological Background 1

Aims and Objectives 1

Method 1

Results 2

Discussion 2

Conclusion 2

Contents of the Site Archive 2

Appendicies

Appendix 1: Archive Pottery Report by Jane Young

Figures

Plates

List of Figures

Fig. 1 Location of 17 - 19 Reynard Street, Spilsby, based on the 2000 Ordnance Survey 1:25,000 scale Explorer Map Sheet number 274. Crown copyright, reproduced with the permission of the Controller of HMSO. LAS Licence No. AL 10002165.

Fig. 2 Plan of the development site at 17 - 19 Reynard Street, Spilsby.

Fig. 3 Plan of the Plot 1, showing recorded trench sections.

List of Plates

Pl. 1 The site, looking south-east across bungalow plot, with excavation in progress.

Pl. 2 Section 1, looking west. Horizontal scale 2m, vertical scale 1m.

Pl. 3 Eastern half of the bungalow plot, looking south-east, with excavation in progress.

Pl. 4 Section 2, looking west. Horizontal scale 2m, vertical scale 1m.

Pl. 5 Excavated bungalow plot, looking west.

Pl. 6 Section 3, looking south. Horizontal scale 2m, vertical scale 1m.

17-19 Reynard Street, Spilsby, Lincs

Archaeological Watching Brief

NGR: TF 4022 6625

Site Code: SRS 05

LCNCC Accession No.: 2005.225

Planning Application No.: S/165/01177/05

Summary

An archaeological watching brief during groundworks for the construction of a new bungalow at 17 – 19 Reynard Street, Spilsby, revealed no archaeological remains.

Introduction

Lindsey Archaeological Services was commissioned by Mr. Dawson in October 2005 to undertake an archaeological watching brief on land situated at 17 –19 Reynard Street, Spilsby, Lincolnshire. The work was carried out in accordance with the brief dated 29th September 2005, and general requirements set out in the *Lincolnshire Archaeological Handbook* published by the Archaeology Section, Lincolnshire County Council (1998). Work commenced and completed on the 10/10/2005.

Site Location and Description

The parish of Spilsby lies on the dip-slope of the Lincolnshire Wolds. The development site is located on the north side of Reynard Street and bounded by nos 15 and 21 Reynard Street to either side of the property (Figs. 1 and 2).

Planning Background

Planning permission had been granted for the construction of a bungalow, subject to an archaeological watching brief being carried out during the groundworks phase of construction.

Archaeological Background

Spilsby is mentioned in the Domesday Survey of 1086 and is clearly a settlement of Saxon origin. Reynard Street is located north of the market place, within the medieval core of the settlement. There was potential for uncovering medieval, or earlier, settlement remains during the groundwork's phase of construction.

Aims and Objectives

The purpose of the Watching Brief on the bungalow plot was to record any archaeological deposits disturbed during groundworks at the above site.

Method

The groundworks were monitored by an experienced archaeologist. A full written and photographic record was made of the site. The trench bases and sides were hand-cleaned, where appropriate, to enable sufficient information about stratigraphic relationships to be recorded.

Results (Fig.3, Pls 1 -6)

Three layers were revealed during the watching brief on the bungalow plot, comprising 0.35m deep topsoil, **1**, which consisted of very dark grey brown sand silt, with moderate root inclusions. This overlay a 0.30m deep mid grey sand silt subsoil, **2**, with very occasional inclusions of charcoal and an orange and brown sand natural, **3**, which contained very occasional tiny sub-angular pebble inclusions.

Pottery sherds, of 18th century date, were recovered from the topsoil.

Discussion and Conclusion

There were no visible archaeological features present on the site. It is unclear if any features had been present and were destroyed during the creation of the subsoil or if the site had never had any activity on it. No archaeological remains were disturbed by the building development.

Mike Garrett

Lindsey Archaeological Services

October 2005

Acknowledgements

LAS would like to thank Mr. Dawson for his help. Site groundworks were monitored by Mike Garrett. Jane Young produced the pottery archive report. This report was edited by Naomi Field and collated by Doug Young.

Contents of the Site Archive

Record sheets

Plans

Sections

Correspondence

Photographs: LAS film nos. 05/78/21-31

APPENDIX 1

Pottery Archive 17-19 Reynard Street, Spilsby (SRS05)

Jane Young

context	cname	full name	form type	sherds	weight	decoration	part	description	date
01	PEARL	Pearlware	bowl	1	42	early chinese design ext	base	ring base	late 18th to early 19th
01	CREA	Creamware	dish	1	46		base	tiny x mark on base	mid to late 18th
01	CREA	Creamware	bowl	1	105		base	ring base	mid to late 18th
01	SWSG	Staffordshire White Saltglazed stonewar	small bowl	1	3		BS		18th
01	GRE	Glazed Red Earthenware	large jar	1	68		rim	square rim;cracked during firing;similar to previous poss waste from Spilsby	18th

THE FIGURES

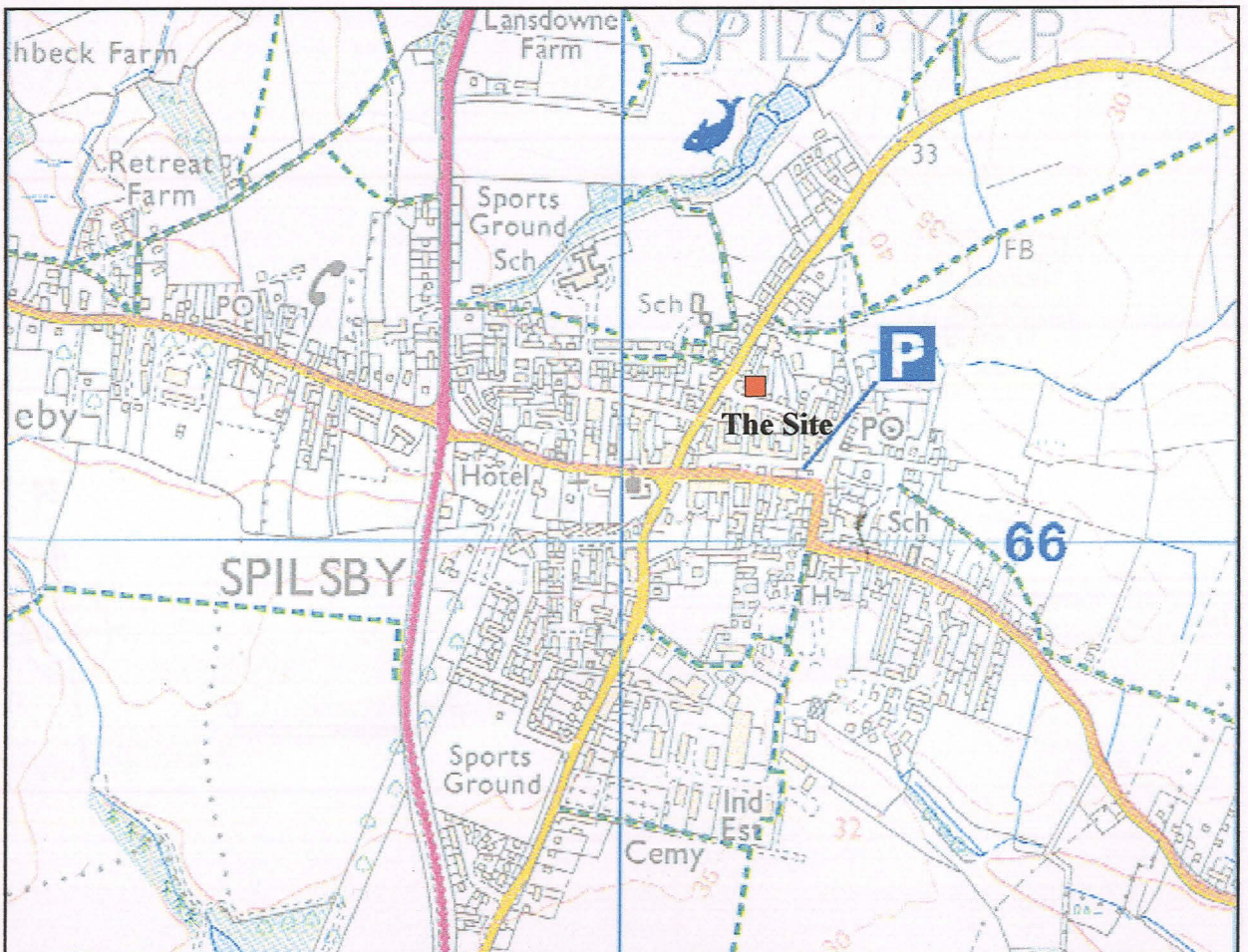
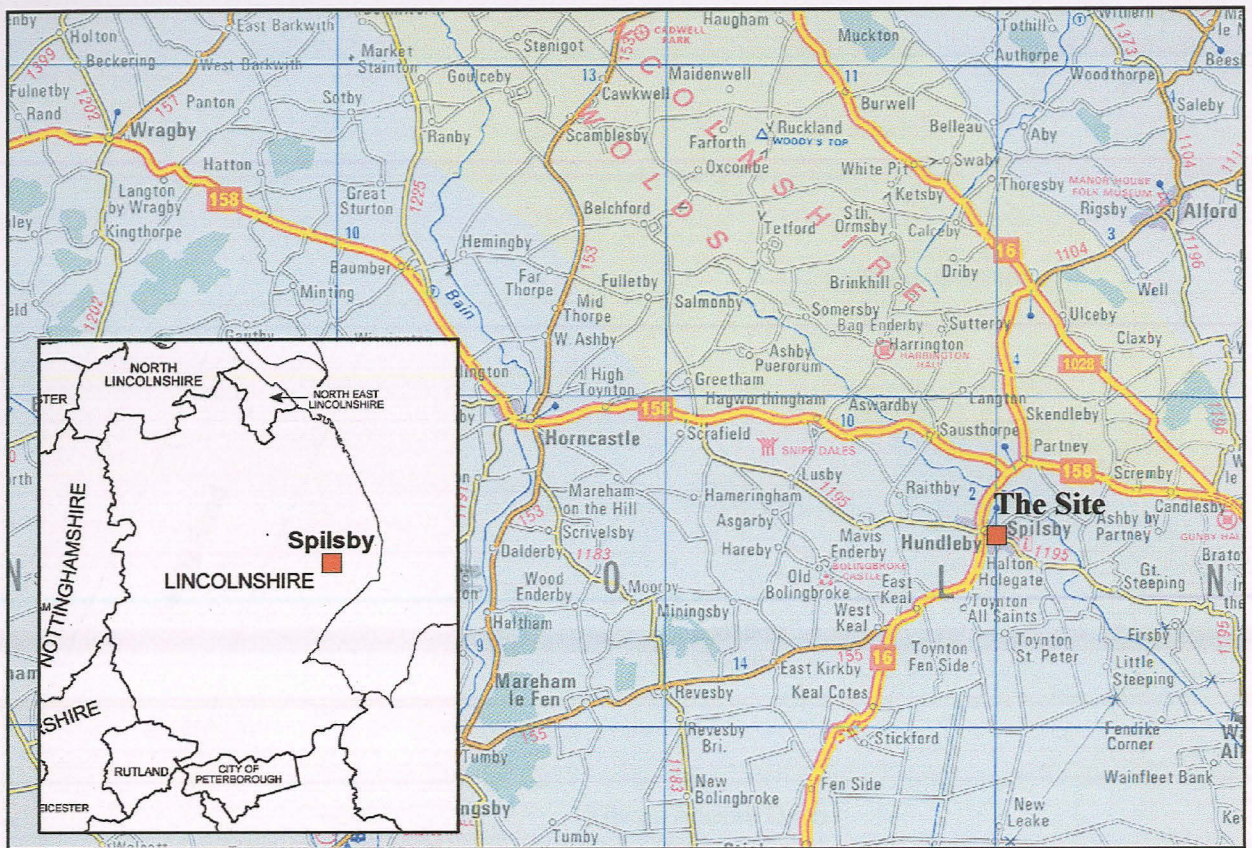

Fig. 1 Location of 17 - 19 Reynard Street, Spilsby, based on the 2000 Ordnance Survey 1:25000 scale Explorer Map sheet no. 274. Crown copyright, reproduced with the permission of the Controller of HMSO. LAS licence no. AL 10002165

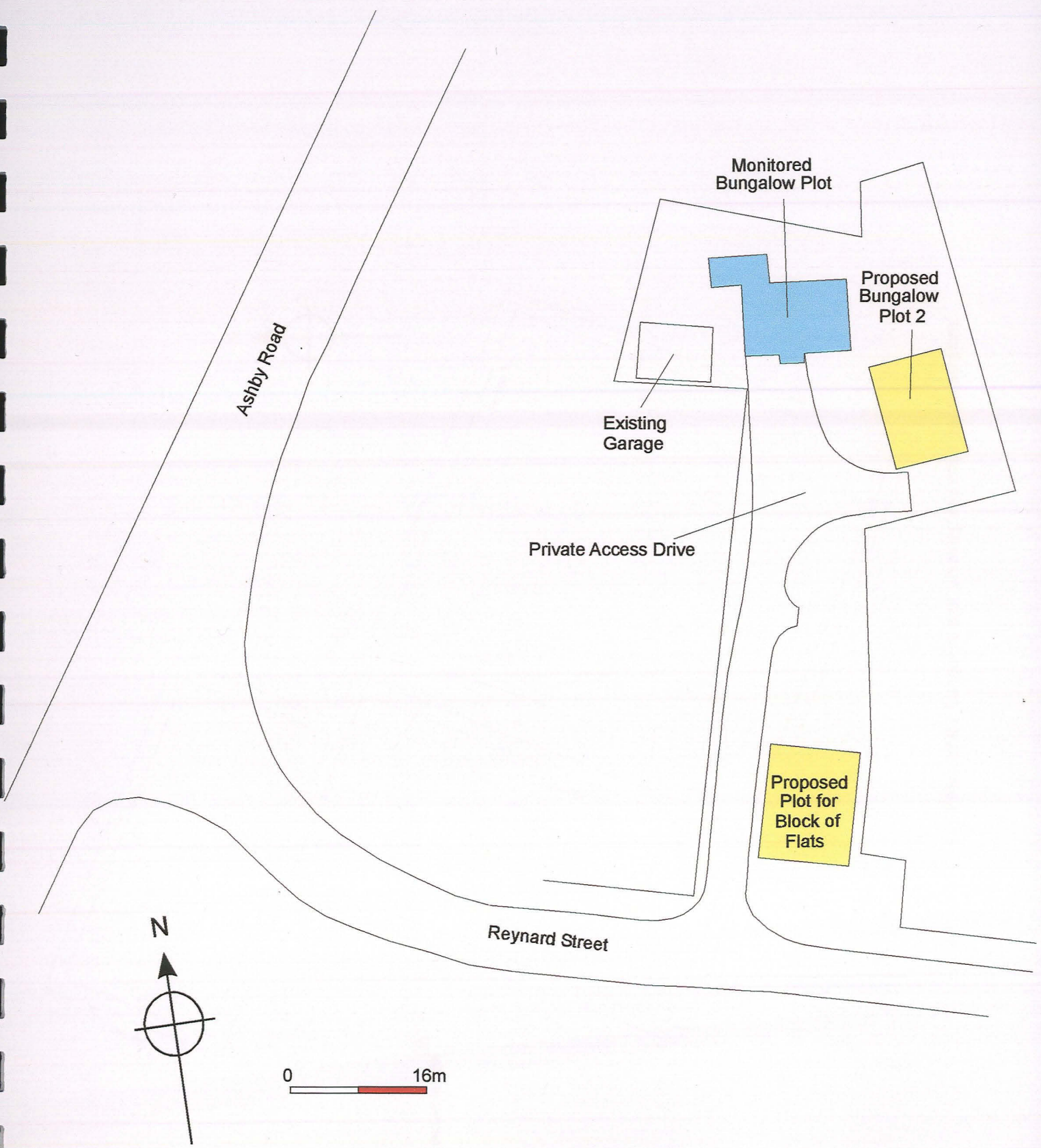

Fig. 2 Plan of the development site at 17 - 19 Reynard Street, Spilsby.

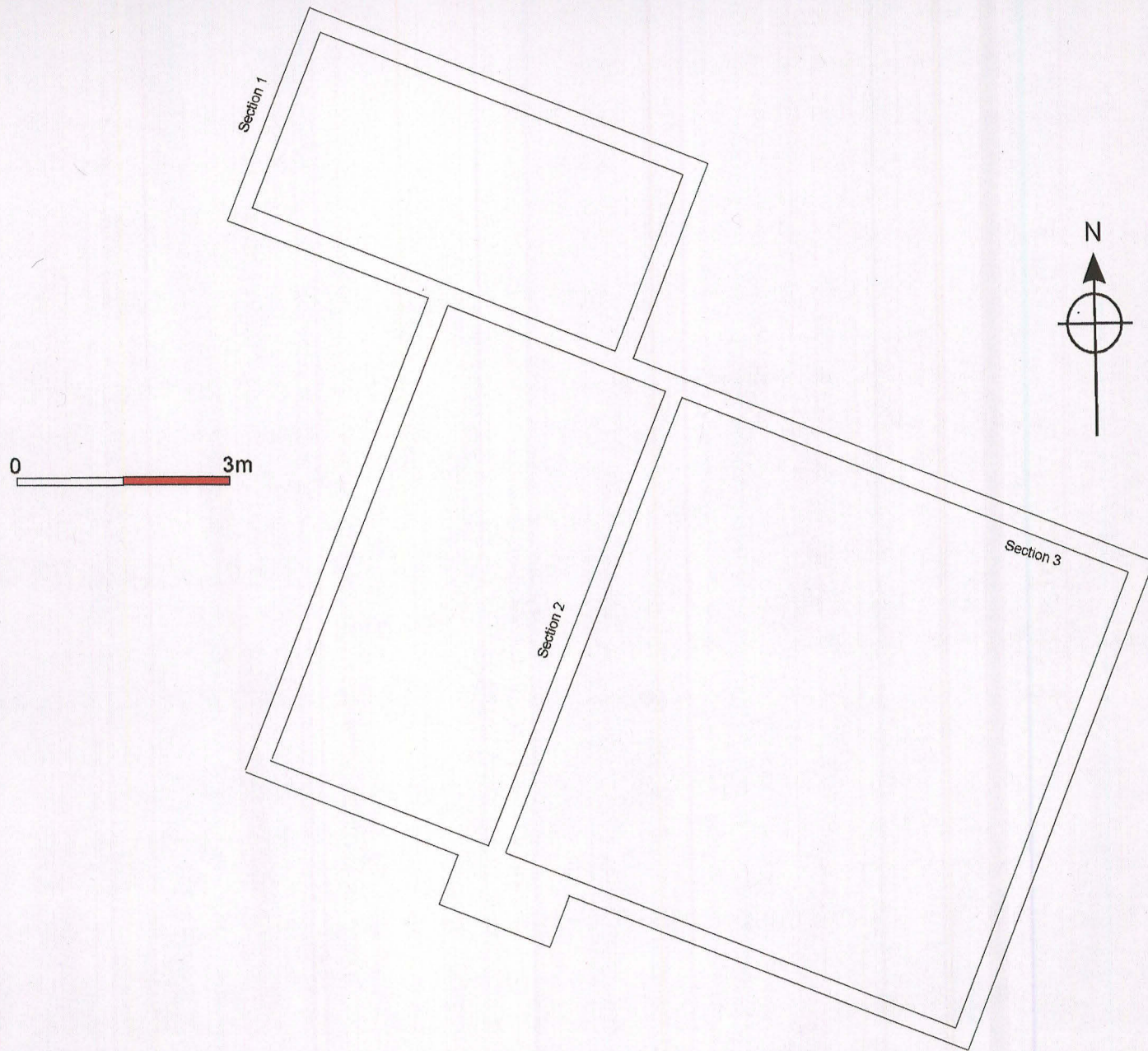

Fig.3 Plan of the bungalow plot, showing recorded trench sections.

THE PLATES



Pl. 1 The site, looking south-east across bungalow plot, with excavation in progress.



Pl. 2 Section 1, looking west. Horizontal scale 2m, vertical scale 1m.



Pl. 3 Eastern half of the bungalow plot, looking south-east, with excavation in progress.



Pl. 4 Section 2, looking west. Horizontal scale 2m, vertical scale 1m.



Pl. 5 Excavated bungalow plot, looking west.



Pl. 6 Section 3, looking south. Horizontal scale 2m, vertical scale 1m.