

MS/19

**M & M ARCHAEOLOGICAL SERVICES**

*The Old Coach House, Church End, Donington, Lincolnshire PE11 4SQ*

*Tel: 01775 822759 Fax: 01775 822025 email: magriff@talk21.com*

**RESULTS OF AN ARCHAEOLOGICAL WATCHING BRIEF:  
74 HOLBEACH ROAD, SPALDING, LINCOLNSHIRE**



**PLANNING APPLICATION REFERENCE: H16/1265/03/FULL.**

**NGR: TF 261 237**

**Site Code: HORS 05**

**Accession No.: LCNCC 2005. 239**

**COMMISSIONED BY:**

**BARRY JOHNSON ARCHITECT**

**16 Main Ridge West**

**Boston**

**LINCOLNSHIRE**

**PE21 6QN**

**UNDERTAKEN BY**

**M & M ARCHAEOLOGICAL SERVICES**

acknowledgement sent 23/3/06  
J. Powell

ELI 2101

SLI 10947

CU9541  
10948

NEGATIVE

**M & M ARCHAEOLOGICAL SERVICES**

The Old Coach House, Church End, Donington, Lincolnshire PE11 4SQ

Tel: 01775 822759 Fax: 01775 822025 email: magriff@talk21.com

RESULTS OF AN ARCHAEOLOGICAL WATCHING BRIEF:  
74 HOLBEACH ROAD, SPALDING, LINCOLNSHIRE

PLANNING APPLICATION REFERENCE: H16/1265/03/FULL.

NGR: TF 261 237



Site Code: **HORS 05**

Accession No.: **LCNCC 2005. 239**

COMMISSIONED BY:

**BARRY JOHNSON ARCHITECT**

16 Main Ridge West

Boston

LINCOLNSHIRE

PE21 6QN

UNDERTAKEN BY

**M & M ARCHAEOLOGICAL SERVICES**

November 2005

CONTENTS

SUMMARY .....	3
2.0 SITE LOCATION AND DESCRIPTION.....	3
3.0 PLANNING BACKGROUND.....	3
4.0 ARCHAEOLOGICAL BACKGROUND .....	4
5.0 AIMS .....	4
6.0 METHODOLOGY & RESULTS.....	4
7.0 DISCUSSION.....	5
8.0 FIGURES.....	6
9.0 PLATES.....	7
APPENDIX A: Context Summary Sheet. ....	8

## SUMMARY

- 1.1 *South Holland District Council granted planning permission for the construction of a single two storey dwelling on land at 74 Holbeach Road, Spalding, Lincolnshire. (Planning Application H16/1265/03/FULL).*
- 1.2 *As a condition of the Planning Permission, an archaeological scheme of works in the form of a watching brief was required. A specification for this fieldwork was approved by the Conservation Services Team at Lincolnshire County Council on behalf of South Holland District Council prior to ground-works commencing. The fieldwork was undertaken according to this document and within nationally recognised archaeological guidelines.*
- 1.3 *The earliest deposit encountered was modern build up layers which continued to a depth of 1.7m where the water table was reached. The natural geology was not reached. The site had been cleared of a previous garage on the site which had been demolished recently. Due to the poor ground conditions the building inspector and a structural engineer were called. On the basis of their recommendations it was decided that the design of the footings be changed to a raft construction, rather than strip foundations.*
- 1.4 *The design for the new build called for the removal of 450mm of soil for the foundation raft and as a result the archaeological levels were not reached or disturbed.*

## 2.0 SITE LOCATION AND DESCRIPTION

- 2.1 The site is approximately 1km to the east of Spalding centre and comprises a rectangular piece of land around 15m x 12m. It is bounded by residential properties to the east and north with open spaces to the south and west. (see Figure 2). The development area is centred on NGR TF 261 237 at an altitude of approximately 3m OD. The underlying drift geology is alluvium (BGS Sheet 144 – Spalding 1:50, 000 Series 1992).

## 3.0 PLANNING BACKGROUND

- 3.1 South Holland District Council granted planning permission for the erection of a two storey dwelling on land to the side of 74 Holbeach Road, Spalding, Lincolnshire (Planning Application H16/1265/03/FULL). A condition of the planning permission required an archaeological watching brief to be maintained during ground works.
- 3.2 This report details the methodology which was maintained during the watching brief and reports on the results. It is prepared in accordance with current best archaeological practices and the appropriate national standards and guidance including:

Management of Archaeological Projects (English Heritage 1991);

Code of Conduct (Institute of Field Archaeologists 1999);  
Standard and Guidance for Archaeological Watching Briefs (IFA 1994);  
Lincolnshire Archaeological Handbook (LCC 1998).

- 3.3 The watching brief was undertaken by Martin Griffiths BA(Hons), PGDip, AIFA in November 2005.

#### 4.0 ARCHAEOLOGICAL BACKGROUND

- 4.1 The earliest archaeological remains recorded close to the development site include a find of a Roman coin to the northwest of the site (SMR 20029) and pottery to the southeast (SMR 23644). Medieval pottery find spots have been recorded to the southeast, east and northeast (SMR 22990, 22992 & 23463/4).

#### 5.0 AIMS

The aims of the watching brief were to:

- a) to monitor ground disturbance during the course of development
- b) to ensure the recording of the extent, condition, character, quality and date of any archaeological deposits and features where they may not be left in-situ;
- c) to report on the results of the watching brief and place them within their Local, Regional or National context

#### 6.0 METHODOLOGY & RESULTS

- 6.1 An archaeological watching brief was undertaken during ground works associated with the construction of the new build on land to the side of 74 Holbeach Road, Spalding, Lincolnshire. The watching brief was undertaken on a comprehensive/intensive basis. Monitoring included site stripping and the excavation of trenches for the footings.
- 6.2 A previous garage was demolished and the ground cleared for the new footings. On initial excavation of the strip footings on the eastern side of the development a problem was encountered at a depth of 1.7m. The area of the development was on made-up ground comprising old refuse material and rubble. The water table was reached at around 1.5m whilst still in made up ground. A halt was called and the Council Building Inspector and Structural Engineer were called.
- 6.3 After a site meeting had been held it was decided that the footprint of the building would be changed. The footings were changed to raft foundations, and as a result only 450mm of surface material was removed over the entire site. The watching brief was terminated as no archaeological material was exposed due to the shallow depth.
- 6.4 The earliest deposits recorded were a black mix of soil and refuse (102) containing modern pottery and metal cans with occasional brick and tarmac material. This layer continued to the maximum depth excavated and re-filled at 1.7m. The water table was reached at 1.5m, only the eastern trench was excavated

to this depth although trial holes were dug over other areas, revealing the same build up material.

6.5 The site had already been disturbed for the erection of the old garage and as a result no top-soil was present after removal of the old footings. There were no signs of any older foundations during the soil strip.

## 7.0 DISCUSSION

7.1 The site clearance and relative shallow depth of soil removal negated any possibility of archaeological activity being found. The build up layer was considerably deeper than the disturbance for the new build and it is unlikely that any detrimental impact would be caused to any archaeology which may be present on the site.

7.2 No archaeological artefacts apart from modern pottery and refuse were seen during the site strip. These were noted but not collected.

8.0 FIGURES

Figure 1. Site location plan.

Figure 2. Development site plan.

Figure 3. Representative section drawing of the trench.

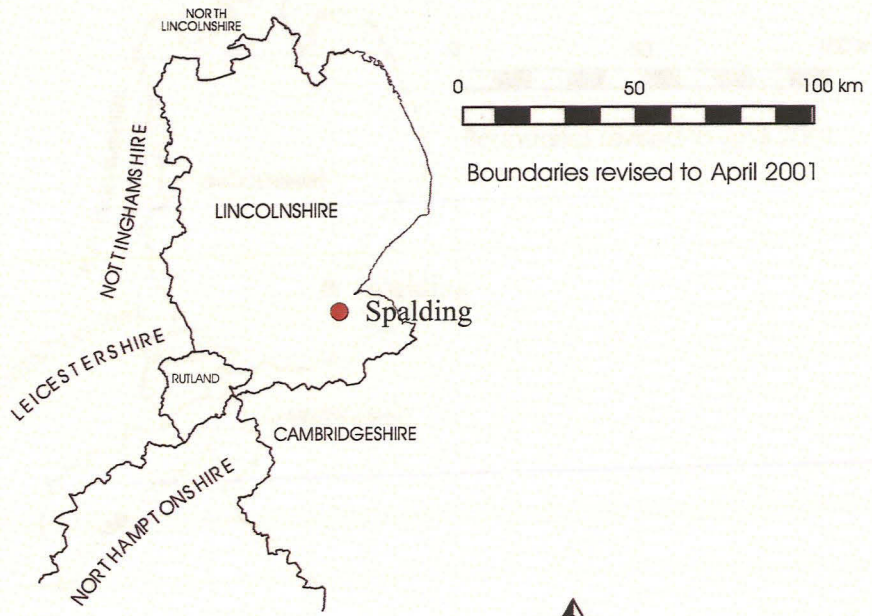

Map based on Ordnance Survey with the sanction of the  
 Controller of H.M. Stationery Office,  
 Crown Copyright Reserved.  
 Licence Number AL 100035919

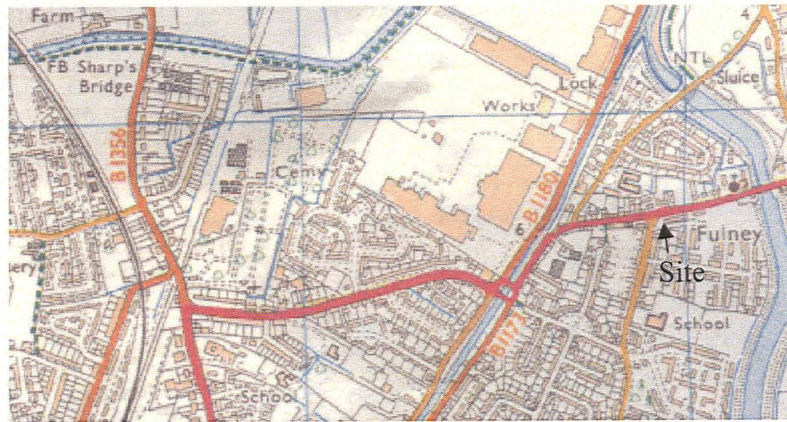

**Figure 1. Site location**



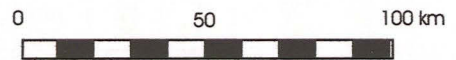

Boundaries revised to April 2001



Map based on Ordnance Survey with the sanction of the  
 Controller of H.M. Stationery Office,  
 Crown Copyright Reserved.  
 Licence Number AL 100035919



**Figure 1. Site location**

New build to side of 74 Holbeach Rd, Spalding

74 Holbeach Rd,  
Spalding

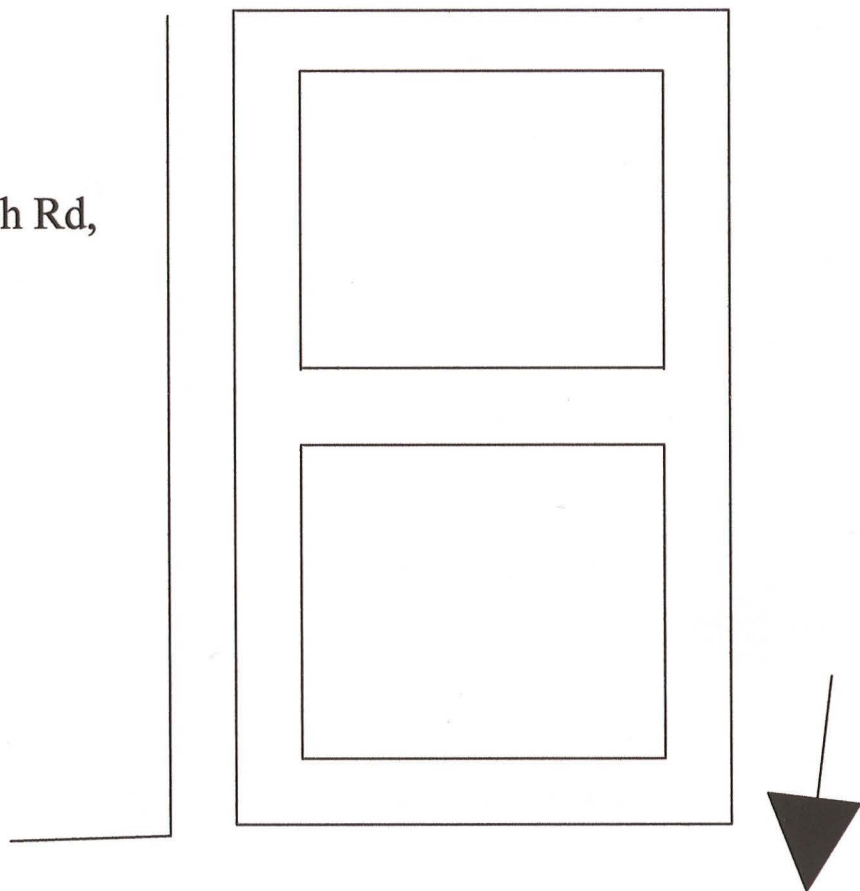

Figure 2. Original Floor Plan of footings

<b>M &amp; M Archaeological Services</b>	
Job	74 Holbeach Rd,
Title	Spalding W Brief
Scale	Not to Scale
NGR	TF 261 237
Drawn	MG
Date	November 2005
Dwg	Figure 2
Site Code	HORS 05

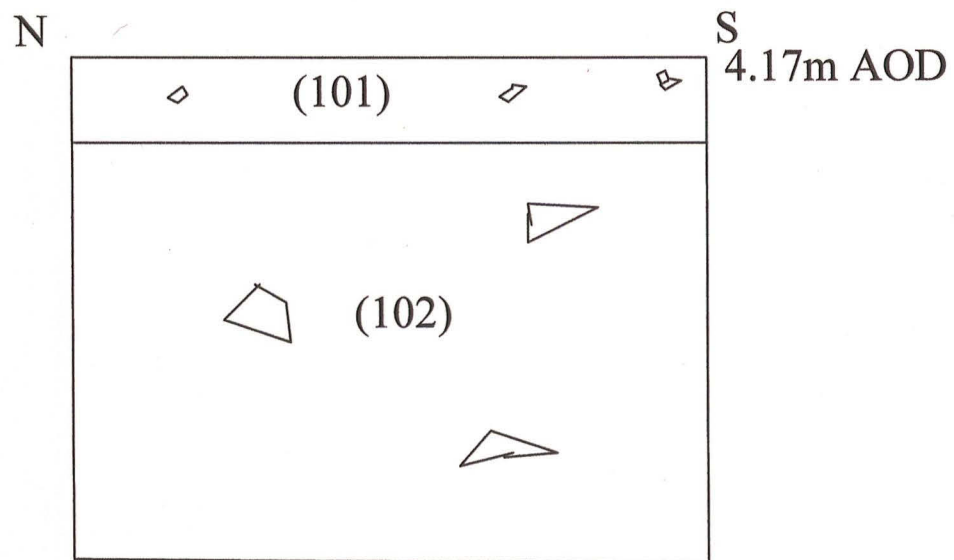

Figure 4. Representative section of footings



<b>M &amp; M Archaeological Services</b>	
Job	74 Holbeach Rd
Title	W Brief
Scale	As drawn
NGR	TF 261 237
Drawn	MG
Date	November 2005
Dwg	Figure 3
Site Code	HORS 05

9.0 PLATES

Plate 1. Site prior to stripping.

Plate 2. Looking north east.

Plate 3. General shot of footings.

Plate 4. Showing maximum depth of footings.



Plate 1. Site looking south east prior to clearance.



Plate 2. Site during stripping of build up layer.



Plate 3. Initial footing in east of site showing made up ground and water table.



Plate 4. Showing final depth of ground surface for rafting of new build.

*Results of an Archaeological Watching Brief:  
74 Holbeach Road, Spalding, Lincolnshire*

**APPENDIX A: Context Summary Sheet.**

<b>Context No.</b>	<b>Description</b>	<b>Interpretation</b>
101	Grey white concrete blocks and chippings	Garage surface
102	Black silty soil and refuse	Made-up ground