



LINDSEY ARCHAEOLOGICAL SERVICES

**Land to the rear of Endwood Cottage,
East Road, Tetford, Lincs
Archaeological Watching Brief**

NGR: TF 333 746

Planning Application No: S/177/00636/05

Site code TEER06

LCCNC accession code 2006.154

Report

for

Mr I Fixter

by

D Young

LAS Report No. 931

July 2006

25 WEST PARADE · LINCOLN · LN1 1NW
TELEPHONE 01522 544554 · FACSIMILE 01522 522211 · EMAIL las@linarch.co.uk

Lindsey Archaeological Services LLP Registered in England and Wales No. OC304247
Registered address 25 West Parade · Lincoln · LN1 1NW

VAT Registration No. 819 8029 41

acknowledged receipt of report 20/7/06
Jan Neill

Conservation
Services

20 JUL 2006

Highways & Planning
Directorate

CL11082

SOURCES SLI 11051
SLI 11052

NEGATIVE

EVENT LI 7259

Rear of Endwood Cottage, Tetford, Archaeological Watching Brief.

Contents

List of Figures	ii
List of Plates	ii
Summary	1
Introduction	1
Site Description	1
Planning Background	1
Archaeological Background	1
Objectives	1
Method	2
Results	2
Acknowledgements	2
Contents of the Site Archive	2

The Figures

Fig. 1 Location of the site behind Endwood Cottage, Tetford, Lincs. C taken from the Ordnance Survey map with the permission of the Controller of HMSO. LAS licence no AL 100002165.

Fig. 2 Plan showing the site at the rear of Endwood Cottage, Tetford. Taken from a plan supplied by the client.

The Plates

Pl. 1 General view of the site before groundworks began.

Pl. 2 General view of the site during excavation of the foundation trenches.

Pl. 3 The south facing section of the northernmost foundation trench.

Pl. 4 The central N/S foundation trench with the sand natural visible in the base.

**Land to the rear of Endwood Cottage, East Road, Tetford, Lincs
Archaeological Watching Brief**

NGR: TF 333 746

Planning Application No: S/177/00636/05

Site code TEER06

LCNCC Accession code 2006.154

Summary

A watching brief was carried out on July 10th 2006 during the excavation of foundation trenches for a new dwelling on a plot of land behind Endwood Cottage, East Road, Tetford, Lincs. No archaeological features or finds were seen during this work.

Introduction

Lindsey Archaeological Services was commissioned by Mr I Fixter to undertake an archaeological watching brief in accordance with the general requirements set out in the Lincolnshire Archaeological Handbook (Lincolnshire County Council Archaeology Section, 1998).

Site Description

Tetford is located towards the south end of the Lincolnshire Wolds between Horncastle and Alford. The development site comprises a plot of land to the rear of Endwood Cottage and to the west of East Road, on the north side of a presently unnamed cul-de-sac close to the White Hart Public House. The ground is currently a grass paddock.

Planning Background

Planning permission was granted for the construction of a single bungalow subject to an archaeological watching brief being carried out during the groundworks phase of construction.

Archaeological Background

The village of Tetford lies below the prehistoric route known as the Bluestone Heath Road and immediately south of a Roman road which runs through the north end of the village and forms the northern boundary of the churchyard. Roman pottery finds were made in the village, north of the development site in the 1950s. Tetford is mentioned in the Domesday Survey of 1086 which confirms its origins in the pre-Conquest period. The parish church lies north east of the development site and is presumed to be close to the centre of the medieval village. There is a ploughed out medieval moated site immediately south-west of the development site. The possibility of Roman and prehistoric remains is more difficult to predict, but their presence could not be ruled out, especially as this area is rich in prehistoric finds such as stone axes, worked flints and Bronze Age axes and spearheads.

Objectives

The purpose of the Watching Brief was to record any archaeological deposits disturbed during groundworks at the above site.

METHOD

There was one experienced archaeologist on site to observe earth moving operations.

Archaeological features if found, would have been excavated and drawn where appropriate, depending upon safe access.

Finds are located in archaeological features, would have been identified accordingly and a context numbering system for archaeological remains was put in operation. LAS operates a standard context recording system, developed by its staff over the past 20 years based on MOLAS and CAS models.

A full photographic record was made during the progress of the excavation to cover each feature together with general site shots.

Results

The topsoil had been removed and the foundation trenches set out prior to the arrival of the attending archaeologist. The foundation trenches were machined on July 10th, 2006, using a JCB excavator with a toothless bucket. Three types of material were noted during the excavation process. Topsoil (100) was a slightly grey, very sandy mid brown clay of up to 0.15m deep. Subsoil (101) was very sandy, slightly clay material of mid brown colour and up to 0.50m deep. (102) was mixed yellow / orange / brown sand natural.

No archaeological features or finds were seen during the excavation of these groundworks.

Acknowledgements

LAS are grateful for the co-operation of Mr I Fixter and I J Builders during the period of the groundworks.

Contents of the Site Archive

3 context sheets

Site drawings

LAS film no 06/67 Negs. 1-12

D Young
July 2006

THE FIGURES

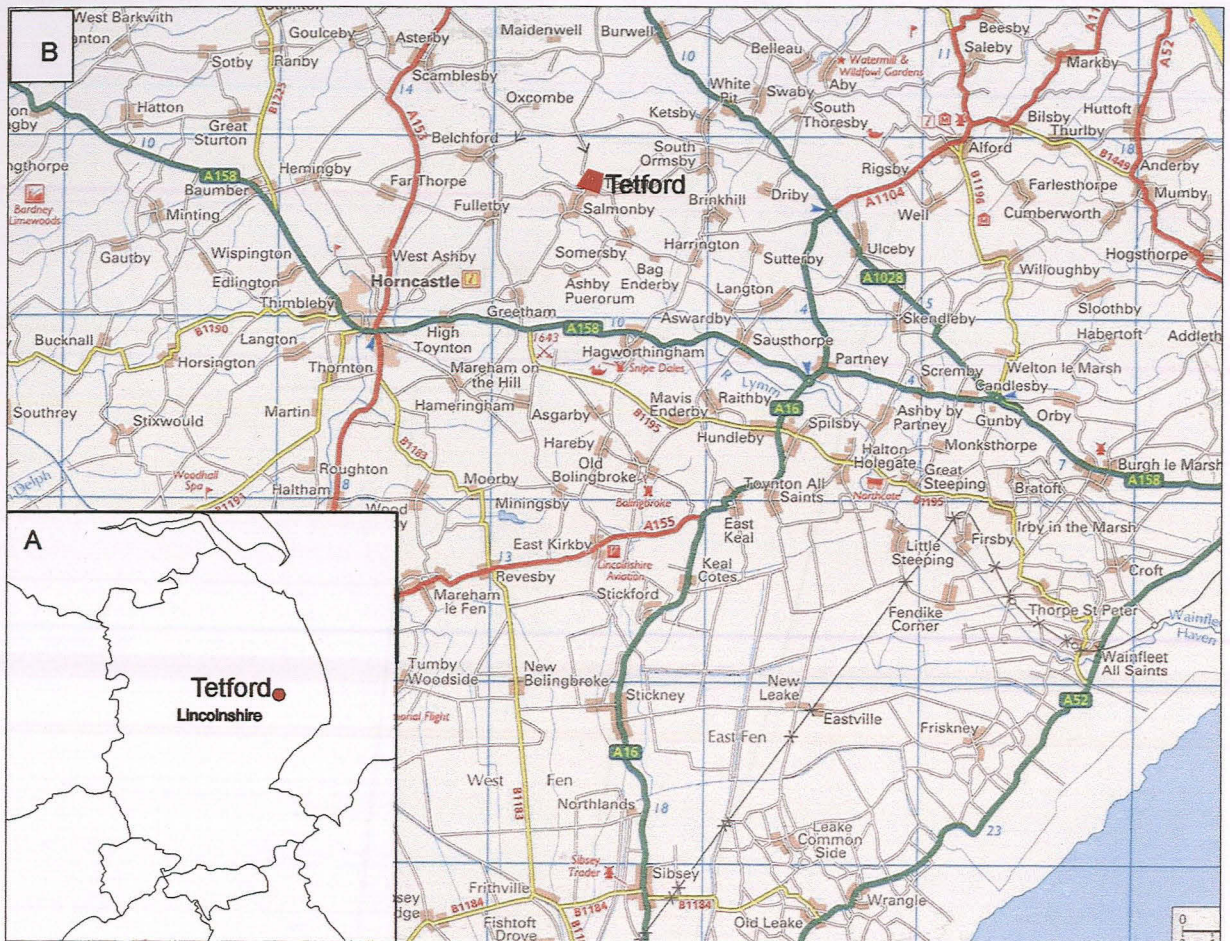

Fig. 1 Location of the site behind Endwood Cottage, Tetford, Lincs. (C) taken from the 1:10,560 Ordnance Survey map with the permission of the Controller of HMSO. LAS licence no. AL 100002165.

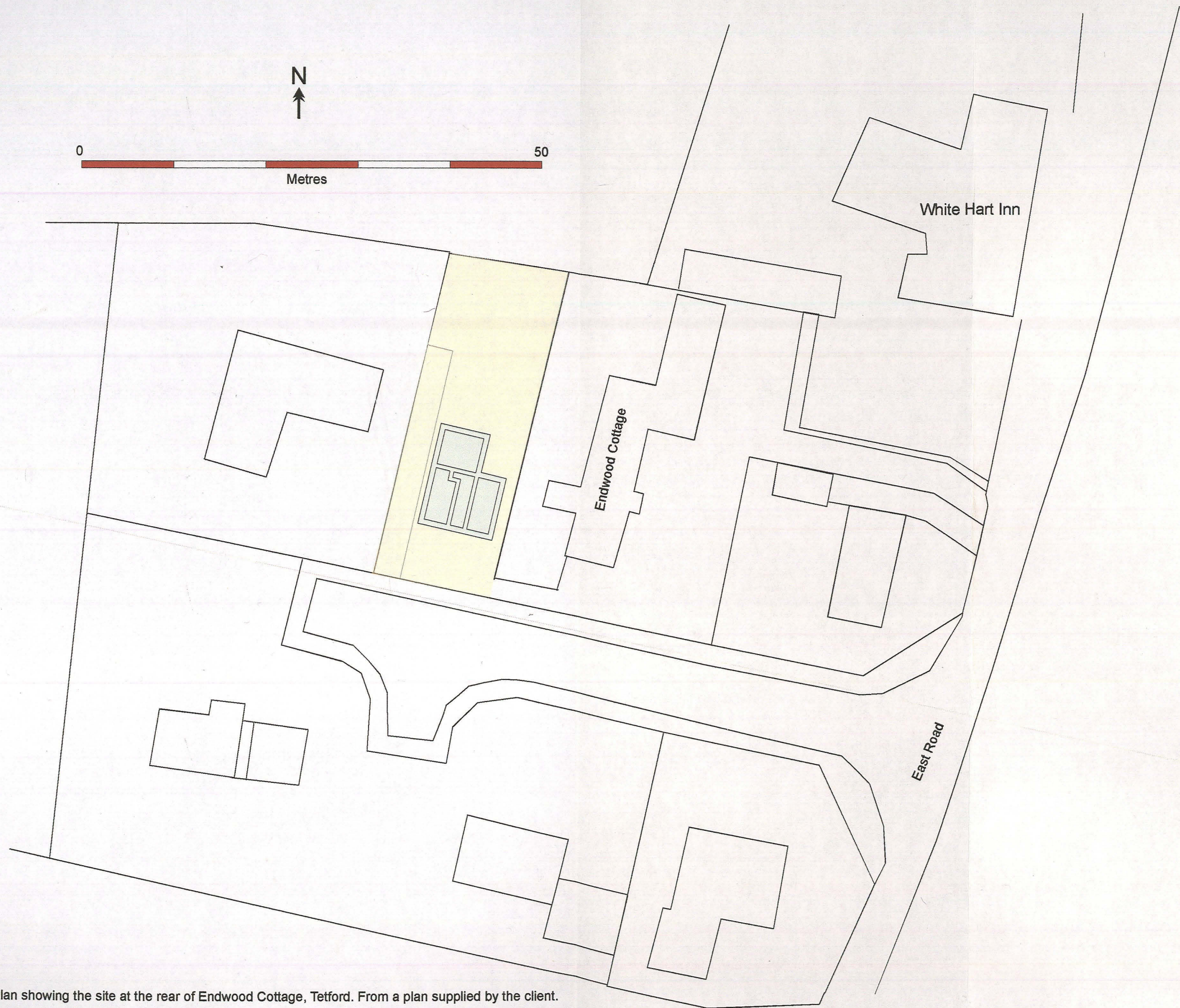

Fig. 2 Plan showing the site at the rear of Endwood Cottage, Tetford. From a plan supplied by the client.

THE PLATES



Pl. 1 General view of the site before the groundworks began



Pl. 2 General view of the site during excavation of the foundation trenches.



Pl. 3 The south facing section of the northern-most foundation trench. Scales 1m.



Pl. 4 The central n/s foundation trench with the sand natural visible in the base.