

M7/1



LINDSEY ARCHAEOLOGICAL SERVICES

**St Mary's Church,
Stow, Lincs.**

Archaeological Watching Brief

NGR: SK 8819 8200

Site Code: SSCD 07

Accession No.: 2007.33

LCNCC Planning Application No.: n/a

**Report for
David Glew Architect and Surveyor
on behalf of
Stow St Mary PCC**

By

M. McDaid

**LAS Report No.: 969
February 2007**

25 WEST PARADE · LINCOLN · LN1 1NW
TELEPHONE 01522 544554 · FACSIMILE 01522 522211 · EMAIL las@linarch.co.uk
VAT Registration No. 813 8029 41

Lindsey Archaeological Services LLP Registered in England and Wales No. OC304247
Registered Address 25 West Parade · Lincoln · LN1 1NW

ELI 7582

SLI 11231 11232

Negative

St Mary's Church , Stow, Lincs. Archaeological Watching Brief

Contents

List of Figures i

List of Plates i

Summary 1

Introduction 1

Site Location and Description 1

Planning Background 1

Archaeological Background 1

Aims and Objectives 1

Method 2

Results 2

Conclusion 2

Acknowledgements 3

Contents of the Site Archive 3

OASIS Summary

The Figures

The Plates

Conservation
Services

20 FEB 2007

Highways & Planning
Directorate

List of Figures

Fig. 1 Location of Stow (insert C based on the 1:25,000 revised 1960 Ordnance Survey map, SK 88,Crown copyright, reproduced with the permission of HMSO, LAS Licence No. AL100002165).

Fig. 2 Location of St Mary's church Stow based on the 1:1250 Ordnance Survey map, Crown copyright, reproduced with the permission of HMSO, LAS Licence No. AL100002165).

Fig. 3 Location of the trench excavated to repair the damaged drain. Scale 1:200

List of Plates

Pl. 1 Location of the trench, looking south.

Pl. 2 The trench showing sequence of disturbed deposits, looking south - west. Scale 1m.

**St Mary's Church, Stow, Lincs.
Archaeological Watching Brief**

NGR: SK8819 8200

Site Code: SSCD 07

LCNCC Accession No.: 2007.33

Planning Application No: n/a

Summary

Monitoring of the trench excavated to repair a blocked drain observed no archaeological features or finds. The ground was too disturbed by existing services that it was not possible to determine if the damage to the pipe coincided with the point where the churchyard had been extended in the 19th century and soil conditions altered.

Introduction

Lindsey Archaeological Services was commissioned by David Glew Architect and Surveyor on behalf of Stow St Mary PCC in July 2006 to undertake an archaeological watching brief at St Mary's church, Stow. The work was carried out in accordance with the general requirements set out in the *Lincolnshire Archaeological Handbook* published by the Archaeology Section, Lincolnshire County Council (1998). Work was started and completed on 17/10/2006.

Site Location and Description

Stow is situated 18km north of Lincoln in the Trent valley. The church is located in the centre of the village (Figs. 1 and 2).

Archaeological Background

This important church still retains its late-Saxon central crossing and north and south transepts. The nave is c.1200 A.D. and the chancel was heavily restored in 1850. Originally the nave and chancel were of similar length to the transepts, in cruciform layout. Excavations in 1983, in advance of the construction of the vestry extension revealed evidence for a contemporary north aisle or *porticus*. These excavations also located the former edge of the churchyard, which was extended in around 1850 to its present position. The former boundary is situated close to or at the location of the blocked drain and may be identifiable in the trench sides. It was thought possible that the pipe may have been damaged at the point where the churchyard was extended in the 19th century and soil conditions altered. It is anticipated that much, if not all of the excavations will be made through already excavated ground. Stow church is a Grade 1 Listed Building.

Objectives

The Phase 1 repair works included the unblocking of drains running from the WCs in the vestry extension built in 1983. English Heritage requested that any groundworks should be monitored by an archaeologist.

The purpose of the Watching Brief was to record any archaeological deposits disturbed during

groundworks at the above site.

Method

A section of the original pipe trench, approximately 2m long, was hand-dug to locate the damaged pipe. An experienced archaeologist was on site to observe the earth moving operations.

Results (Fig 3, Pls. 1 and 2)

An exploratory pit c.1m x 0.50m was excavated c.6m to the west of the toilets in the vestry eextension to expose a blocked pipe. The pit was excavated through a thin layer of topsoil, **001**, 0.10m deep maximum, and compacted clay and topsoil, **002**, to a depth of c.0.50m covering the pipe. To the south side of the damaged pipe were two service pipes. The services trenches for these pipes, **003**, were obviously filled by deposit **002**. The pit revealed that the pipe had been previously repaired using concrete.

Conclusion

The ground was too disturbed by the previous installation of services that it was not possible to determine whether the damage to the pipe coincided with the point where the churchyard had been extended in the 19th century and soil conditions altered. The excavations were contained entirely within previously dug service trenches and did not disturb any *in situ* archaeological remains.

Mick McDaid

February 2007

Acknowledgements

LAS would like to thank David Glew Architect and Surveyor for his help. The field work was carried out by Doug Young. This report was edited by Naomi Field and collated by Doug Young.

Contents of the Site Archive

Site Notes

Plan

Correspondence

Photographs: LAS film nos. 06/138

OASIS DATA COLLECTION FORM: England

[List of Projects](#) | [Search Projects](#) | [New project](#) | [Change your details](#) | [HER coverage](#) | [Change country](#) | [Log out](#)

Printable version

OASIS ID: lindseya1-23871

Project details

Project name St Mary's Church, Stow, Lincs.

Short description of the project Monitoring of the trench excavated to repair a blocked drain observed no archaeological features or finds. The ground was too disturbed by existing services that it was not possible to determine if the damage to the pipe coincided with the point where the churchyard had been extended in the 19th century and soil conditions altered.

Project dates Start: 17-10-2006 End: 17-10-2006

Previous/future work Yes / Yes

Any associated project reference codes SSCD07 - Sitecode

Any associated project reference codes 2007.33 - Museum accession ID

Type of project Recording project

Site status Listed Building

Current Land use Other 4 - Churchyard

Investigation type 'Watching Brief'

Prompt Listed Building Consent

Project location

Country England

Site location LINCOLNSHIRE WEST LINDSEY STOW St Mary's Church, Stow, Lincs.

Postcode LN1 2XX

Study area 100.00 Square metres

Site coordinates SK 8819 8200 53.3272863992 -0.675699701830 53 19 38 N 000 40 32 W Point

Project creators

Name of Organisation LINDSEY ARCHAEOLOGICAL SERVICES

Project brief originator English Heritage/Department of Environment

Project design originator Naomi Field

Project director/manager M. MCDAID
 Project supervisor Doug Young
 Type of sponsor/funding body Diocese
 Name of sponsor/funding body Stow St Mary PCC

Project archives

Physical Archive Exists? No
 Digital Archive Exists? No
 Paper Archive recipient Lindsey Archaeological Services
 Paper Contents 'none'
 Paper Media available 'Drawing','Notebook - Excavation',' Research',' General Notes','Photograph','Report'

Project bibliography 1

Publication type Grey literature (unpublished document/manuscript)
 Title St Mary's Church, Stow, Lincs.
 Author(s)/Editor(s) McDaid. M
 Other bibliographic details LAS Report 969
 Date 2007
 Issuer or publisher Lindsey Archaeological Services
 Place of issue or publication Lincoln
 Description A4 spiral bound developer report
 Entered by dougyoung (doug@linarch.co.uk)
 Entered on 16 February 2007

OASIS:

Please e-mail English Heritage for OASIS help and advice
 © ADS 1996-2006 Created by Jo Gilham and Jen Mitcham, email Last modified Friday 3 February 2006
 Cite only: <http://ads.ahds.ac.uk/oasis/print.cfm> for this page

THE FIGURES

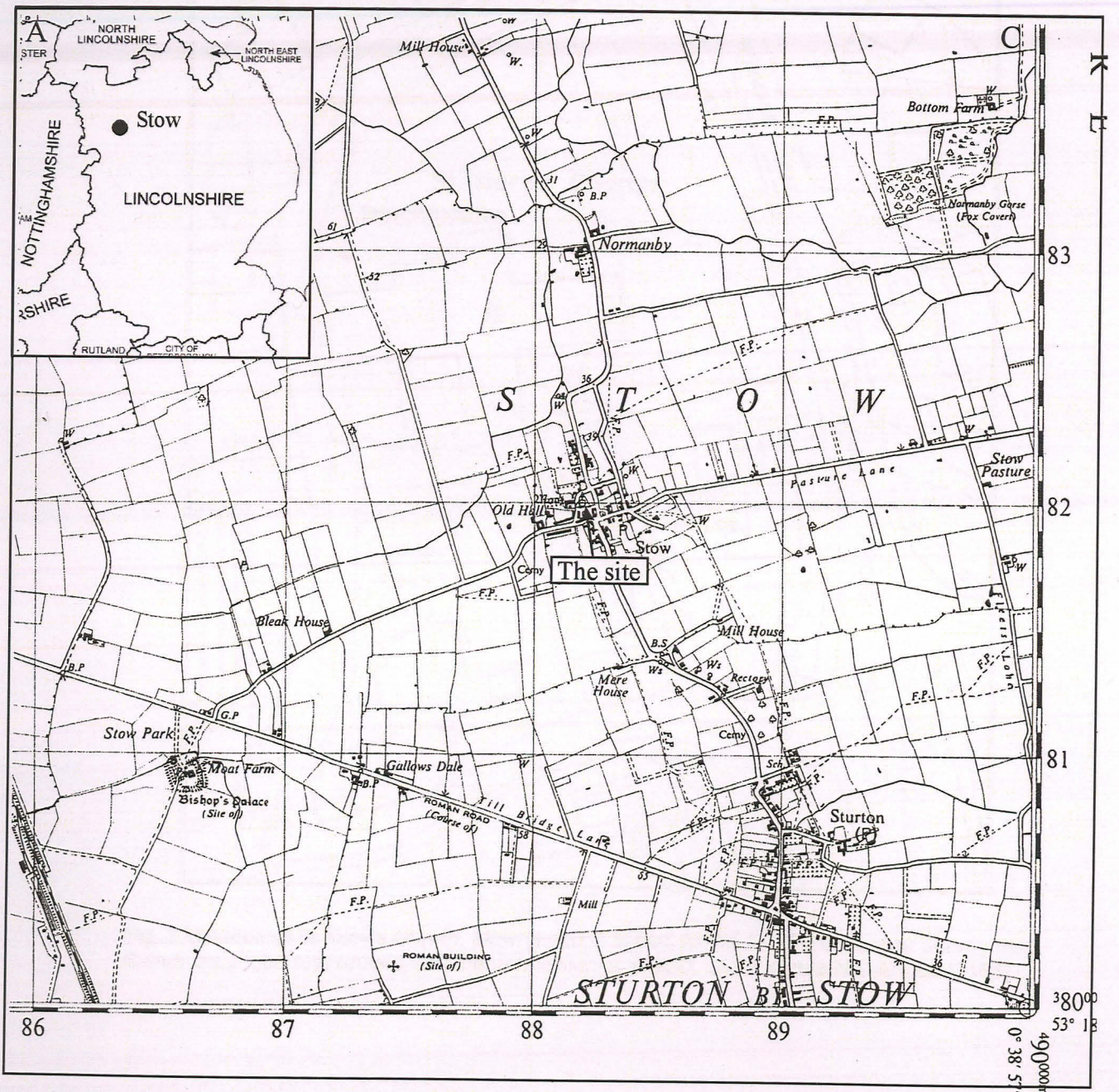
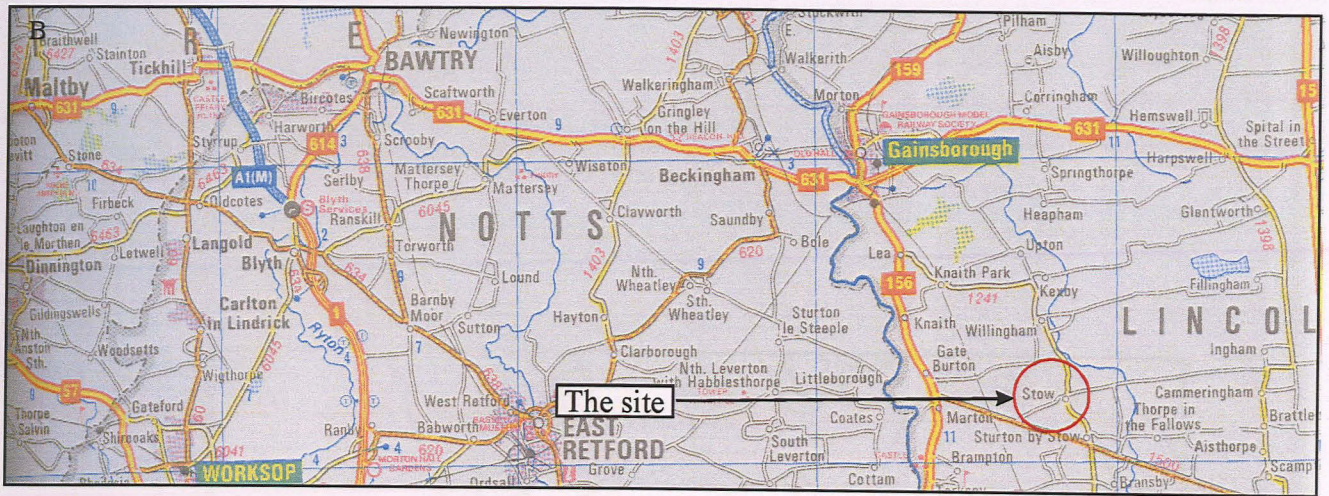

Fig. 1 Location of Stow (insert C based on the 1:25,000 revised 1960 Ordnance Survey map, SK 88, Crown copyright, reproduced with the permission of HMSO, LAS Licence No. AL10002165).

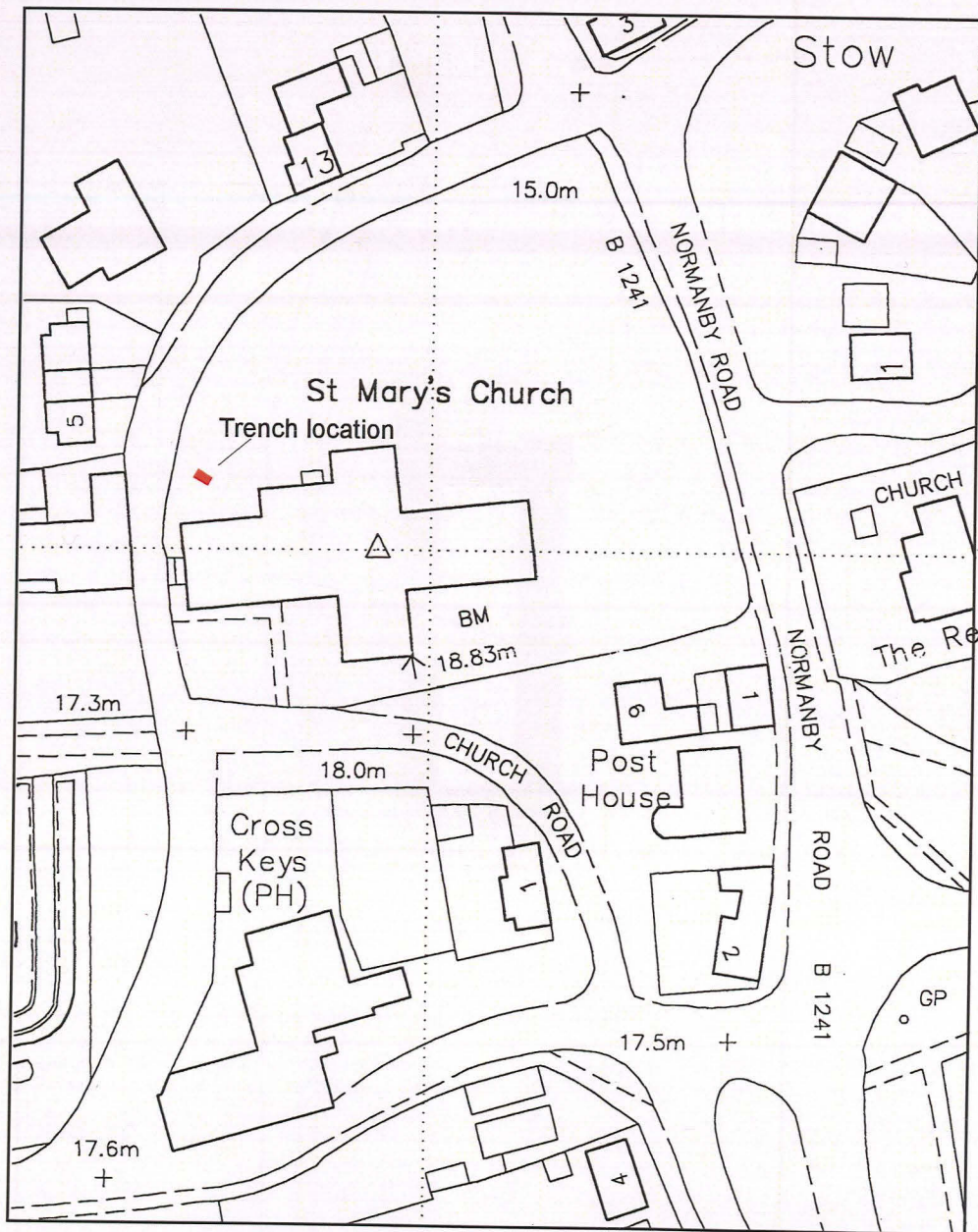

Fig. 2 Location of St Mary's church, Stow (insert C based on the 1:1250 Ordnance Survey map, Crown copyright, reproduced with the permission of HMSO, LAS Licence No. A1100002165).

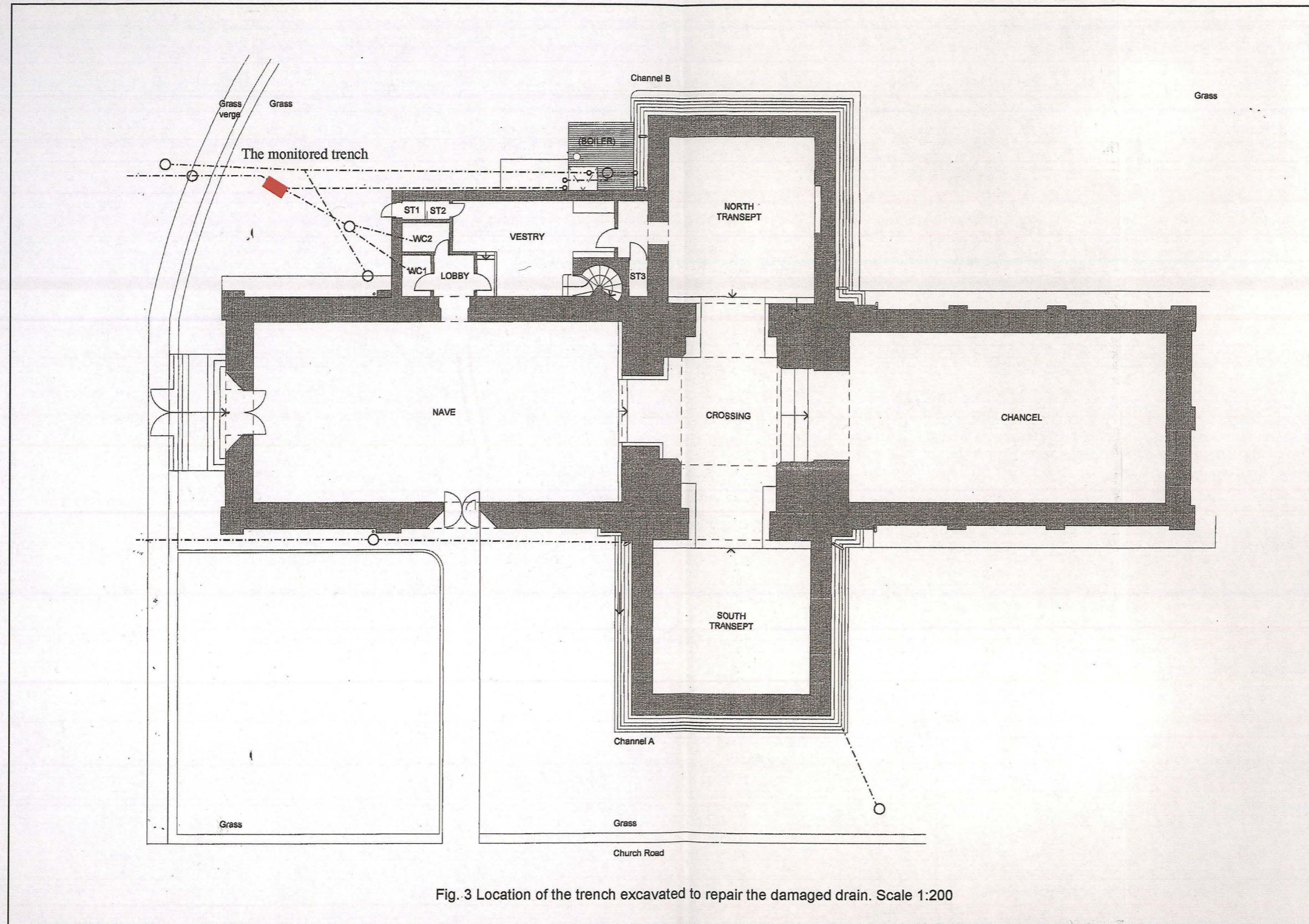

Fig. 3 Location of the trench excavated to repair the damaged drain. Scale 1:200

THE PLATES



Pl.1 Location of the excavated trench, looking south.



Pl. 2 The trench showing sequence of disturbed deposits, looking south - west. Scale 1m.