

EUI 6972

SLI 5249 10869

PRN 43327 96/4



---

# LINDSEY ARCHAEOLOGICAL SERVICES

FRANCIS HOUSE SILVER BIRCH PARK GREAT NORTHERN TERRACE LINCOLN LN5 8LG

---

## **New Bolingbroke Sewerage Scheme:**

### **Archaeological Watching Brief**

at

### **St. Peter's Churchyard**

*NGR: TF 3080 5782*

Site Code: **NBC 96**

LCNCC Museum Accn. No. **50.96**

Faculty No. 578

Report prepared for Anglian Water Services

**April 1996**

Lincolnshire County Council  
Archaeology Section  
12 Lynch Lane  
Y... .. LN42 5AL  
TE . 0522 530724 FAX: 0522 530724  
24.4.96.

## List of Figures and Plates

- Pl. 1** Trenching in St. Peter's graveyard; the path curves behind the mini-excavator towards the car (looking NW).
- Pl. 2** The backfilled trench in the centre of the path, looking west through the churchyard gate.
- Pl. 3** Rubble of the church path overlying the former topsoil above yellow undisturbed sand.

**Fig. 1** Location of New Bolingbroke

**Fig. 2** Position of St. Peter's Church and Teulon House (based on the 1956 Ordnance Survey 1:10,560 map, Sheet TF 35 NW. Crown Copyright, reproduced with the permission of the Controller of HMSO. Licence No. AL 50424A).

**Fig. 3** Route taken by the new sewer connection (based on a plan supplied by Anglian Water, approx. scale 1:500).

# **New Bolingbroke Sewerage Scheme: Archaeological Watching Brief at St. Peter's Churchyard**

*NGR: TF 3080 5782*

Site Code **NBC 96**

LCNCC Museum Accn. No. **50.96**

Faculty No. 578

## **Summary**

*A trench dug along the church path for a new sewer was inspected but no human burials were observed. An uneven depth of topsoil survived beneath the path metalling, covering pale silt deposits. No archaeological remains were present.*

## **Introduction**

A request to be connected to a new sewerage scheme was made to Anglian Water by the owners of Teulon House, New Bolingbroke (Fig. 1). The property, formerly the vicarage, lies to the west of the parish church and the access uses an existing church path on the south and west sides of the graveyard. Connection was agreed subject to the owners (Mr and Mrs Doitch) arranging necessary permission to cross the churchyard.

Faculty no. 578 in the Consistory Court of the Diocese of Lincoln (dated 29.2.1996) was granted for the work, containing a condition that an archaeological watching brief was kept during the progress of the works; the position of any disturbed human remains was to be recorded and they were to be passed to the Incumbent for reverent re-interment elsewhere in the churchyard. Anglian Water offered to satisfy the archaeological condition and commissioned Lindsey Archaeological Services (LAS) in March 1996 to monitor of the trench along the access path (Fig. 2). LAS contacted the Diocesan Advisory Committee Secretary and arranged that an intermittent inspection of the trench would be acceptable unless human remains were encountered; in that eventuality a constant presence would be needed to ensure compliance with the stipulations contained in the Faculty.

Trenching began on April 1st 1996 and the site was visited daily until April 4th when the trench had been backfilled and the path reinstated.

## **Archaeological Background**

St. Peter's in New Bolingbroke, in the parish of New Bolingbroke with Carrington, was built in 1854 and originally served a community around a weaving factory built thirty years earlier (Pevsner and Harris 1964, 321). The church and the adjacent vicarage were designed by S.S. Teulon.

The graveyard has been in use for under 150 years and the existing headstones (some repositioned) and visible graves probably represent most of the actual burials. Most burials are in the area between the broad path and

the church but there appear to be some graves between the path and the churchyard wall; it was unclear whether the path had been positioned over graves or whether it had been contemporary with the church building and carefully avoided by grave digging. Documentary research was not conducted by LAS for this project.

### **The Watching Brief**

The trench was positioned in the centre of the broad path and dug with a mini-excavator; most spoil was removed from the site (Figs. 1 and 2). Outside the churchyard gate the trench was dug to link with the new sewer, and then gradually became shallower within the churchyard. The trench was cut in short lengths and rapidly backfilled.

The present path surface overlay a brick and tile rubble layer about 0.15m thick. Under the path make-up was about 0.25m of dark brown stony soil above pale yellow sand (Fig. 3). Roots from the yew and other trees beside the path had disturbed the topsoil and sand.

At the completion of the trenching an inspection was made of all exposed soil from the trench, both within the graveyard and where spoil had been stored on adjacent land. This confirmed no trace of human skeletal remains or coffin fittings.

### **Conclusion**

The sewer trench disturbed no human remains or evidence of graves. It seems probable that the path has been in use on its present alignment since the church was built and that its course has been respected when graves were dug.

No signs of any archaeological remains pre-dating the church were found.

### **Acknowledgements**

LAS were grateful for the help from Anglian Water, especially David Singerton (Project Engineer), Phil Croft (Resident Engineer) and Rick Newton (Clerk of Works). Full co-operation was also received from the contractors.

Jane Logan (Diocesan Advisory Committee Secretary) liaised with LAS about the requirements of the Faculty.

Geoff Tann  
Lindsey Archaeological Services  
19th April 1996

### **References**

OS 1956 Ordnance Survey 1:10,560 map Sheet TF 35 NW

Pevsner, N. and Harris, J. 1964 *The Buildings of England: Lincolnshire*.



Fig. 1 Location of New Bolingbroke

59

58

06'

57



Fig. 2 Position of St. Peter's Church and Teulon House (based on the 1956 Ordnance Survey 1:10,560 map, Sheet TF 35 NW. Crown Copyright, reproduced with the permission of the Controller of HMSO. LAS Licence No. AL 50424A).

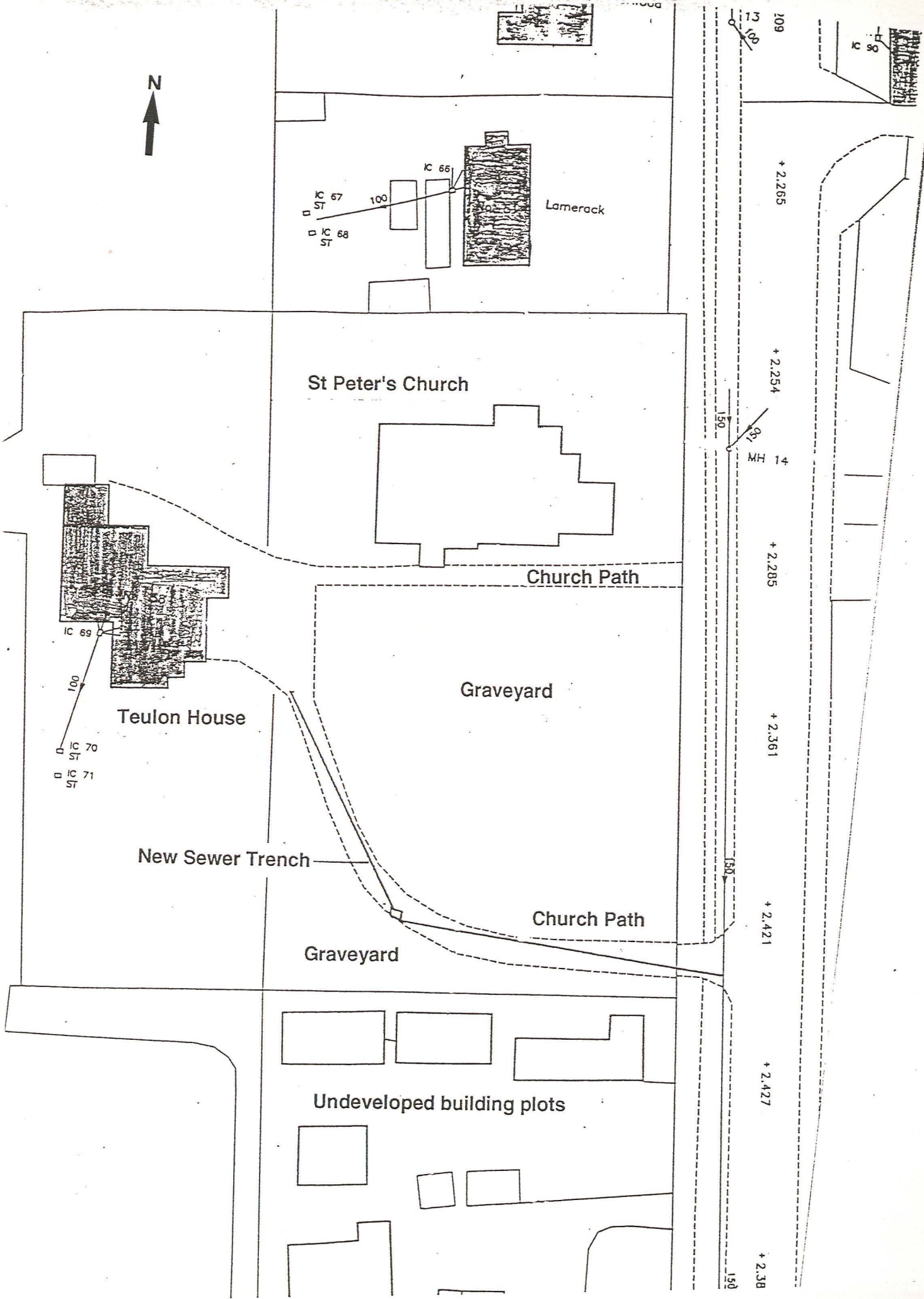

Fig. 3 Route taken by the new sewer connection (based on a plan supplied by Anglian Water, approx. scale 1:500).





Pl. 1 Trenching in St. Peter's graveyard; the path curves behind the mini-excavator towards the car (looking NW).



PI. 2 The backfilled trench in the centre of the path, looking west through the churchyard gate.

PI. 3 Rubble of the church path overlying the former topsoil above yellow undisturbed sand.

