

**NORTH KELSEY ROAD,
CAISTOR,
LINCOLNSHIRE**

**1997 FIELD REPORT
NUMBER 2**

119.96

YORK ARCHAEOLOGICAL TRUST

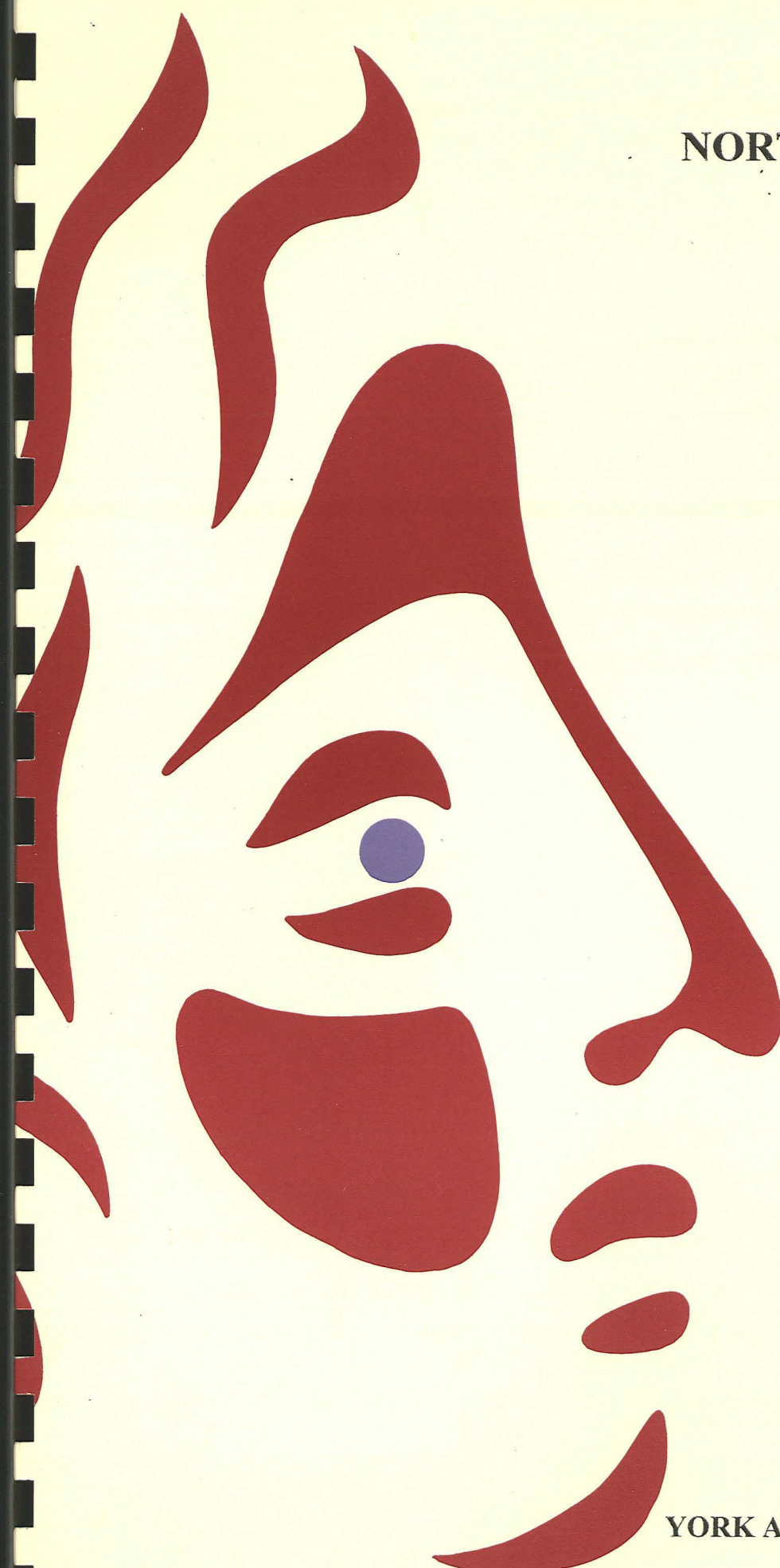

Lincolnshire County Council
Archaeology Section

23 JUN 97

12 Friars Lane
LINCOLN LN2 5AL
Tel: 01522 575292 Fax: 01522 530724

Event: LI 2102
Sources: LI 6818 LI 6819
PRN 54572 LI 81814

NORTH KELSEY ROAD, CAISTOR, LINCOLNSHIRE

A Report on an Archaeological Watching Brief

CONTENTS

1.	Introduction	2
2.	Results of the watching brief	2
3.	Summary	3

FIGURES

Fig. 1 Location of the site

Fig. 2 General location plan

1. INTRODUCTION

In advance of the extension of a sand quarry close to North Kelsey Road, Caistor, Lincolnshire, (NGR TA 0944 0100), an archaeological watching brief was undertaken by Jane Lilley for York Archaeological Trust on behalf of J.W.Hurdiss Ltd. The watching brief took place between 12th and 16th September 1996. A second watching brief was undertaken during a further extension of the site between 26th and 28th February 1997 and was carried out by Nick Pearson of On Site Archaeology working for York Archaeological Trust. The report and finds from the site are currently stored with York Archaeological Trust under the Lincoln City and Council Museum accession code 119.96.

The work took place within OS field 4400 located to the south of West Moor Farm (Figure 1). The field had hedges on the western, northern and eastern sides, a dredged stream on the southern side, and sloped downwards to the south. The field had been agricultural set aside for several years and had light vegetation cover. The thin layer of disturbed sandy topsoil had been extensively burrowed by rabbits.

A desk top study of the area by Wardell Armstrong revealed that the site lay within an area containing remains of both prehistoric and Roman date, as well as crop mark sites and that prehistoric flint artefacts had been found in the vicinity. A geophysical survey of the area suggested that the adjacent field to the east (OS field 5700 within which a scatter of worked flints, scrapers and microliths is recorded on the Lincolnshire Sites and Monuments Record) may contain features of archaeological interest.

2. RESULTS OF THE WATCHING BRIEF

2.1 Observations took place during the removal from the site of the mid brown very finely grained sandy topsoil which was between 0.03m. and 0.40m. thick by means of a 360 degree tracked excavator with a smooth bladed bucket. The total extent of field 4400 within the topsoil dump was observed. The only dating evidence recovered from this deposit was a scatter of 19th and 20th century ceramic and glass fragments with a single fragment of clay pipe stem. This deposit sealed a mottled yellow - grey-brown sand which was clearly the natural sub-soil. Five worked flints and a number of pieces of unworked flint and natural flint nodules were recovered from the upper surface of the natural sub-soil. These flints were not grouped together, but were located randomly across the whole field.

2.2 No cut features were observed at all although the surface of the natural sub soil had been disturbed in places by rabbit burrowing.

2.3 The flints from the site were examined by Gill Woolrich of York Archaeological Trust who contributed the following comments. The flint from the site consists of 16 unworked fragments and five struck pieces all in a medium grey flint. The struck pieces are all unretouched blades, two large (54mm and 45mm) and three small. They are undiagnostic and cannot be dated typologically.

3. SUMMARY

3.1 Observations took place during the removal of topsoil from the site of sand quarrying. The deposits observed implied that the site consisted of a build up of agricultural soil directly above the natural sub-soil. There was no evidence for any form of building or settlement activity and the site would seem to have always had an agricultural function. Nothing of archaeological importance was observed on the site.

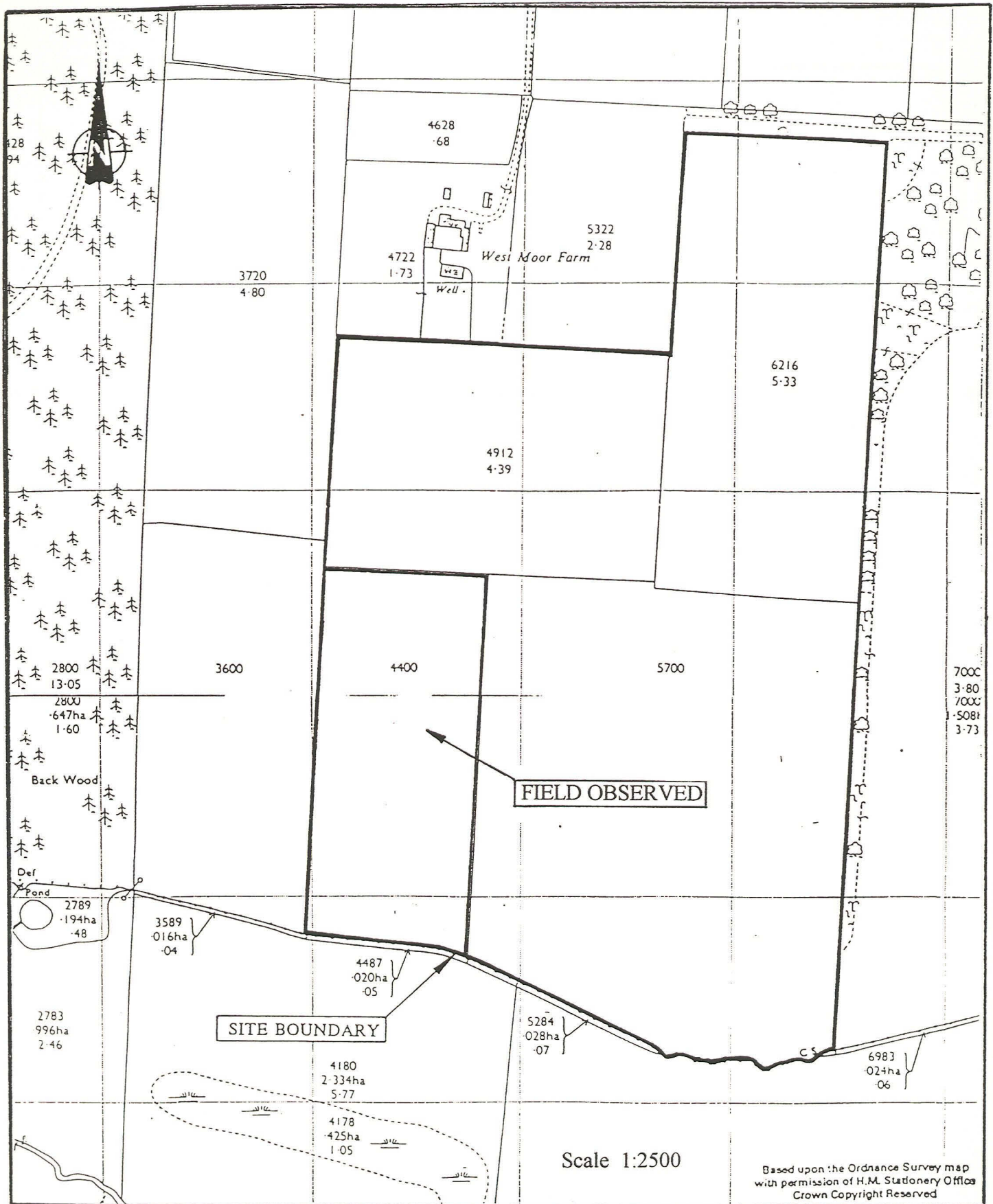
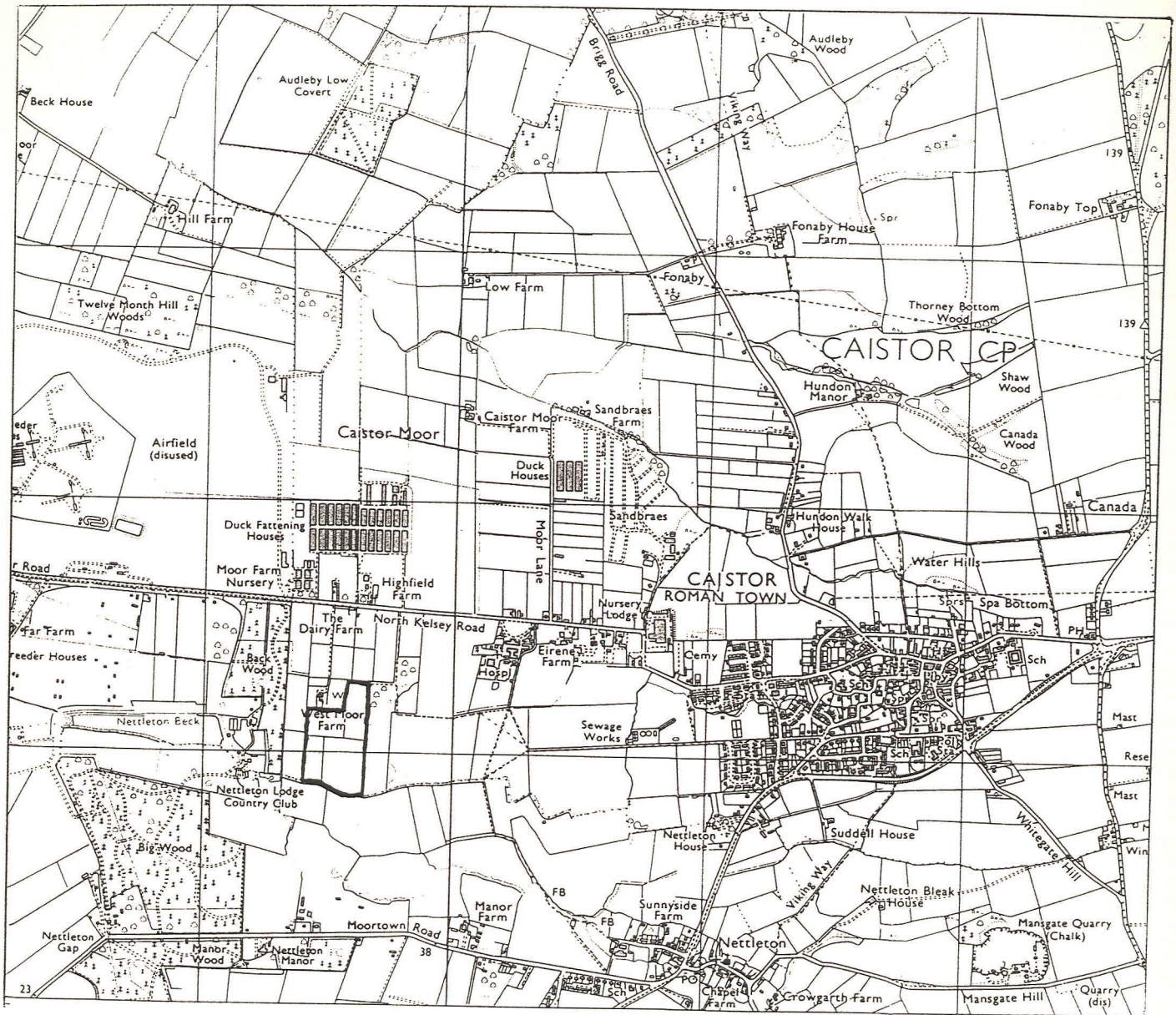

Figure 1. Location of the site



Scale 1:25000

Based upon the 1983 Ordnance Survey 1:25000 scale map with permission of the Controller of Her Majesty's Stationary Office, Crown Copyright, York Archaeological Trust, Cromwell House, 13 Ogleforth, York YO1 2JG Licence Number AL854123

Figure 2. General location plan