

CITY OF  
◇ LINCOLN ARCHAEOLOGY ◇  
UNIT

97/11  
TRAVELODGE,  
THORPE-on-the-HILL,  
LINCOLNSHIRE

ARCHAEOLOGICAL WATCHING BRIEF

*By K Wragg*

CLAU ARCHAEOLOGICAL REPORT NO: 315

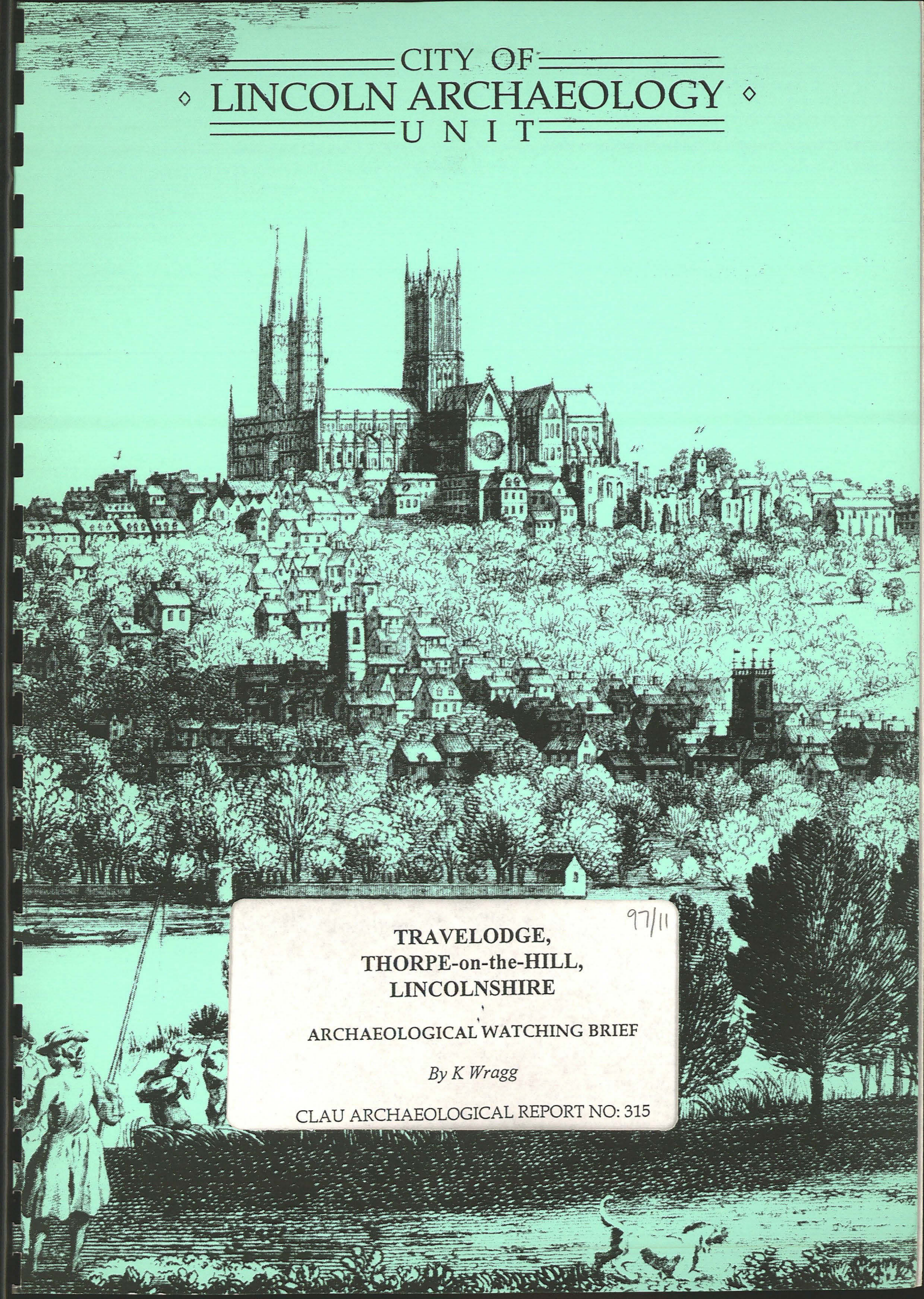



**Lincolnshire County Council**  
**Archaeology Section**

**1 6. NOV 97**

**12 Friars Lane**  
**LINCOLN LN2 5AL**

**Tel: 01522 575292 Fax: 01522 530724**

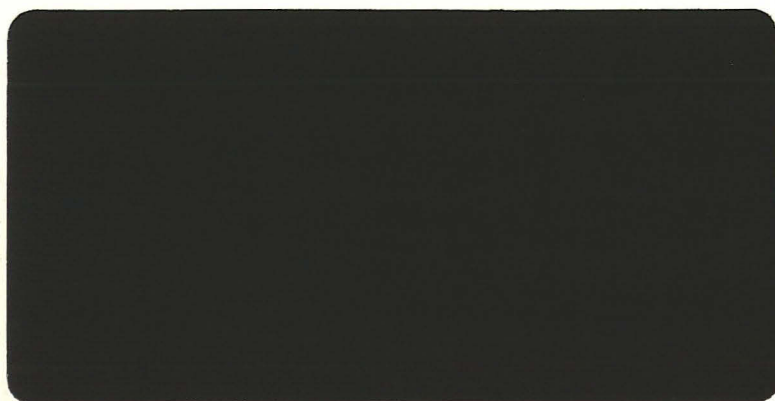

reg.  
Event LI3178  
Source LI7898

A  
Report to  
*Howard Fawcett & Partners*  
on behalf of  
*Granada Roadside Restaurants*

November 1997

---

Prepared by

*The City of Lincoln Archaeology Unit*  
*Charlotte House*  
*The Lawn*  
*Union Road*  
*Lincoln*  
*LN1 3BL*

*Tel: Lincoln (01522) 545326*  
*Fax: Lincoln (01522) 548089*

© CLAU

*Site Code: TOH96*  
*LCCM Accession No.: 161.96*  
*NGR: SK 491900/365350*

TRAVELODGE,  
THORPE-on-the-HILL,  
LINCOLNSHIRE

97/11

ARCHAEOLOGICAL WATCHING BRIEF

*By K Wragg*

CLAU ARCHAEOLOGICAL REPORT NO: 315

# TRAVELODGE, THORPE-on-the-HILL, LINCOLNSHIRE

## *Archaeological Watching Brief*

<i>Contents</i>	<i>Page</i>
NON-TECHNICAL SUMMARY.....	1
1.0 INTRODUCTION.....	2
2.0 ARCHAEOLOGICAL AND HISTORICAL BACKGROUND.....	2
3.0 RESULTS.....	2
4.0 DISCUSSION OF RESULTS & CONCLUSIONS.....	3
5.0 ACKNOWLEDGEMENTS.....	3
6.0 LHA NOTES/ARCHIVE DETAILS.....	4

### *List of Illustrations*

- Fig.1 Site Location Plans - scale 1:50000 & 1:12500
- Fig.2 Plan of proposed development - scale 1:500
- Fig.3 West-facing sections 1/5 & 2 (in area of main building) - scale 1:20
- Fig.4 West-facing sections 3 & 4 (drainage trench) - scale 1:20

# **TRAVELODGE, THORPE-on-the-HILL, LINCOLNSHIRE**

## **ARCHAEOLOGICAL WATCHING BRIEF**

### ***NON-TECHNICAL SUMMARY***

This development involved the construction of a 32-room *Travelodge* motel, on an area of land immediately to the north of the A1434, close to its junction with the A46 Lincoln Relief Road, c.8km south-west of Lincoln city centre.

The area surrounding the development contains evidence for human occupation dating from the prehistoric period through to the present day.

During the Roman period, the site lay immediately to the north of the major Roman road running from Exeter and Leicester to Lincoln (the *Fosse Way*, now the A46). Evidence for Roman roadside settlements has been revealed along the line of this route to both the east and the west, and given the site's proximity to the thoroughfare, it was possible that similar remains might be revealed during the redevelopment.

In the event however, little or no evidence of early occupation was revealed. The majority of the deposits appeared to be of either recent date, most probably representing the 'upcast' from the excavations for the neighbouring *Little Chef* restaurant, or related to the natural geology of the area.



# TRAVELODGE, THORPE-on-the-HILL, LINCOLNSHIRE

## ARCHAEOLOGICAL WATCHING BRIEF

### 1.0 INTRODUCTION

This development involved the construction of a 32-room *Travelodge* motel, on an area of land immediately to the north of the A1434, close to its junction with the A46 Lincoln Relief Road (see Fig.1).

It was proposed to develop an area of disused land, close to the existing *Little Chef* roadside restaurant, with the new structure sharing the present access arrangements (see Fig.2).

The site prior to development was covered with a substantial build-up of spoil, thought to have originated from both the construction of the aforementioned restaurant, and from nearby agricultural activity. In order to facilitate the construction of the new building, it was proposed that initial excavation would be required to clear this overburden, followed by further groundworks for the building foundations and associated services.

In view of the proximity to sites/findspots of known archaeological importance (see 2.0, below), it was decided by North Kesteven District Council, following advice from the North Kesteven Heritage Officer, that the groundworks on the site should be monitored archaeologically.

In accordance with the resulting condition attached to the planning consent, the City of Lincoln Archaeology Unit was commissioned in November 1996 by Howard Fawcett & Partners, on behalf of Granada Roadside Restaurants, to carry out an intermittent watching brief on the site. Following an initial delay in the commencement of building works, observation was carried out on the site between the 6<sup>th</sup> and 23<sup>rd</sup> of May 1997.

The information in this document is presented with the proviso that further data may yet

emerge. The Unit, its members and employees cannot, therefore, be held responsible for any loss, delay or damage, material or otherwise, arising out of this report. The document has been prepared in accordance with the terms of the Unit's Articles of Association, the Code of Conduct of the Institute of Field Archaeologists, and *The Management of Archaeological Projects 2* (English Heritage, 1991).

### 2.0 ARCHAEOLOGICAL AND HISTORICAL BACKGROUND

The area surrounding the development contains evidence for human occupation dating from the prehistoric period through to the present day.

During the Roman period, the site lay immediately to the north of the major Roman road running from Exeter and Leicester to Lincoln (*Fosse Way*, now the A46). Evidence for Roman roadside settlements has been revealed along the line of this route to both the east and the west, and given the site's proximity to the thoroughfare, it was possible that similar remains might be revealed during the redevelopment.

### 3.0 RESULTS

Groundworks comprised a phase of site stripping & levelling work (which removed between 1.2m and 1.8m of overburden), service trenches (mainly concentrated at the north-east corner of the site), and a network of machine-excavated linear foundation trenches, the latter enclosing an area approximately 40m x 10m (see Figs.3 & 4).

The foundation trenches themselves were on average 600mm wide, and excavated to a depth of 900mm, below the stripped site level.

The earliest deposits revealed during the various excavations comprised: [113] - a layer of moderately compacted, mid orange-brown, clayey sand and gravel, present throughout the area of the main building footprint; and a waterlogged mid-dark grey sandy, clayey organic silt/peat deposit ([106]/[111]), revealed during trenching for the main foul water sewer at the north-east corner of the site.



This latter layer contained a high proportion of intact (i.e., not rotted) organic material (including roots, branches and rushes/reeds), and was sealed by [104], a layer of mid grey clay. [104] itself was present c.1.5m below the existing ground level for this part of the site, and both this deposit and the aforementioned [113], lay beneath a moderate-well compacted mid-light yellow-brown clay layer, [103]/[112], which appeared to be present across the whole site, and was up 1.0m thick.

At the south-west corner of the site [103]/[112] was sealed by a 500mm-600mm thick layer of well compacted mid-light grey clay ([109]), containing no obvious inclusions.

In the service trenching at the north-eastern end of the development, [103]/[112] lay beneath a sequence of three deposits. The lowermost deposit of this group comprised [102], a mid brown sandy silt, which was subsequently sealed by [101], a moderate-well compacted, friable, mid-light grey sandy clay, which contained gravel inclusions. This layer gradually became much more silty towards its upper boundary, and ultimately formed part of the topsoil deposit in this area. The final deposit revealed in this part of the site comprised [105]/[110], a moderately compacted, friable, mid red-brown slightly clayey sandy loam, which overlay [101] and represented the remaining topsoil deposit for the majority of the site.

Only two further deposits were revealed during this investigation, both concentrated along the western side of the site, forming the mounds of overburden present in this area.

The first of these (which overlay both [109] and [105]/[110] to the south-west), comprised [108], a well compacted mid yellow-brown clay layer, which included limestone pieces, broken land-drain, roof tile, modern bricks, and fragments of concrete paving slab. This layer was in turn sealed by [107], a grey-brown clay mixed with limestone hardcore and mid brown loam. A patchy covering of grass was then present over the site, rooted into all three surface deposits.

#### **4.0 DISCUSSION OF RESULTS AND CONCLUSIONS**

Notwithstanding the potential of the site, as related above, the results from this watching brief have proved to be largely inconclusive, with little or no evidence of early occupation revealed.

The majority of the deposits appear to be of either recent date, most probably representing the 'upcast' from the excavations for the neighbouring *Little Chef* restaurant, or related to the natural geology of the area.

It is possible that the presence of the organic deposit at the north-eastern corner of the site represents the position of a former pond, but this could not be confirmed. It is also doubtful that this would necessarily represent human activity, rather than a natural feature.

#### **5.0 ACKNOWLEDGEMENTS**

The City of Lincoln Archaeology Unit would like to thank the following for their assistance during this project: Granada Roadside Restaurants, Unit 2, Cartel Business Centre, Stroudley Road, Basingstoke, Hampshire; Mr A.Porter, Granada Building Manager; Mr J.Tinlin of Howard Fawcett & Partners, Chandos House, Wendover, Buckinghamshire, HP22 6EB; Messrs S.Gardner, R.Wilson & Mr N.Gregory of Volumetric Limited, 'Rosdene House', 12 King Street, Potton nr.Sandy, Bedfordshire, SG19 2QT; Ms K.Orr, North Kesteven District Council Heritage Officer, Heritage Lincolnshire, The Old School, Cameron Street, Heckington, Lincolnshire, NG34 9RW.

## **6.0 LHA NOTE/ARCHIVE DETAILS**

### **6.1 LHA NOTE DETAILS**

CLAU CODE: TOH96

PLANNING APPLICATION NO.:  
N/64/600/95

FIELD OFFICER: K. Wragg

NGR: SK 491900/365350

CIVIL PARISH: Thorpe-on-the-hill

SMR No.: n/a

DATE OF INTERVENTION: 19/11/96 -  
12/05/97

TYPE OF INTERVENTION: Watching Brief

UNDERTAKEN FOR: Howard Fawcett &  
Partners, Chandos House, Wendover,  
Buckinghamshire, HP22 6EB, on behalf of  
Granada Roadside Restaurants, Unit 2, Cartel  
Business Centre, Stroudley Road, Basingstoke,  
Hampshire.

### **6.2 ARCHIVE DETAILS**

PRESENT LOCATION: City of Lincoln  
Archaeology Unit, Charlotte House, The  
Lawn, Union Road, Lincoln, LN1 3BL.

FINAL LOCATION: The City and County  
Museum, Friars Lane, Lincoln.

MUSEUM ACCESSION No.: 161.96

ACCESSION DATE: -



<b>CITY OF LINCOLN ARCHAEOLOGY UNIT</b>		
SITE CODE: TOH96	PLANE/ELEV/SECTION NO:	
CLIENT:	Howard Fawcett & Partners on behalf of Granada Roadside Restaurants	
DESCRIPTION:	Site Location Plan	
SCALE:	ARCHIVE NO:	
DRAWN BY:	CHECKED:	DATE:
MUSEUM ACCESSION NO: 161.96		

**KEY**

 Location of Site

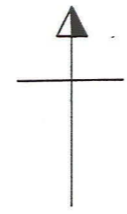

1:50 000

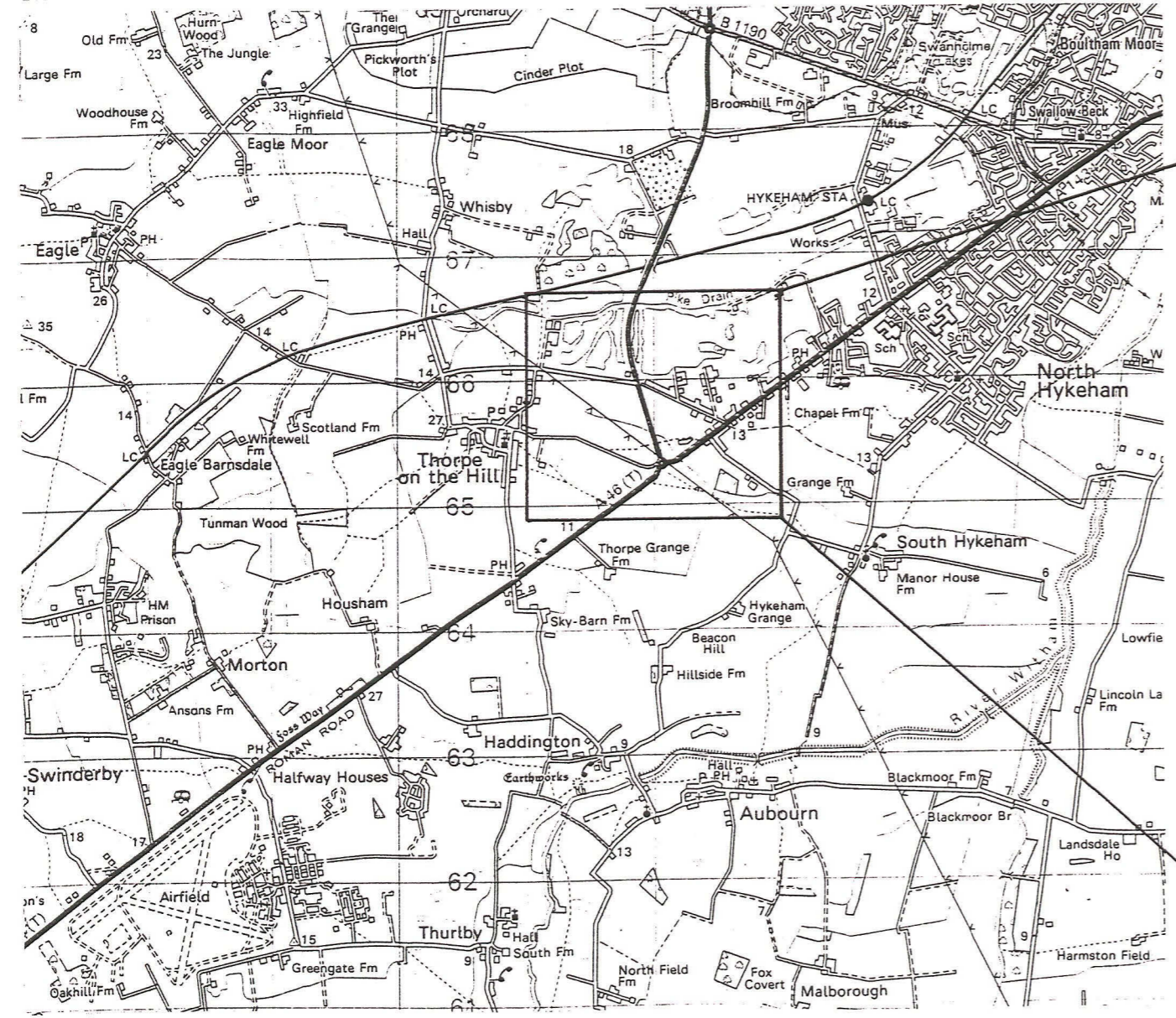

1:12500

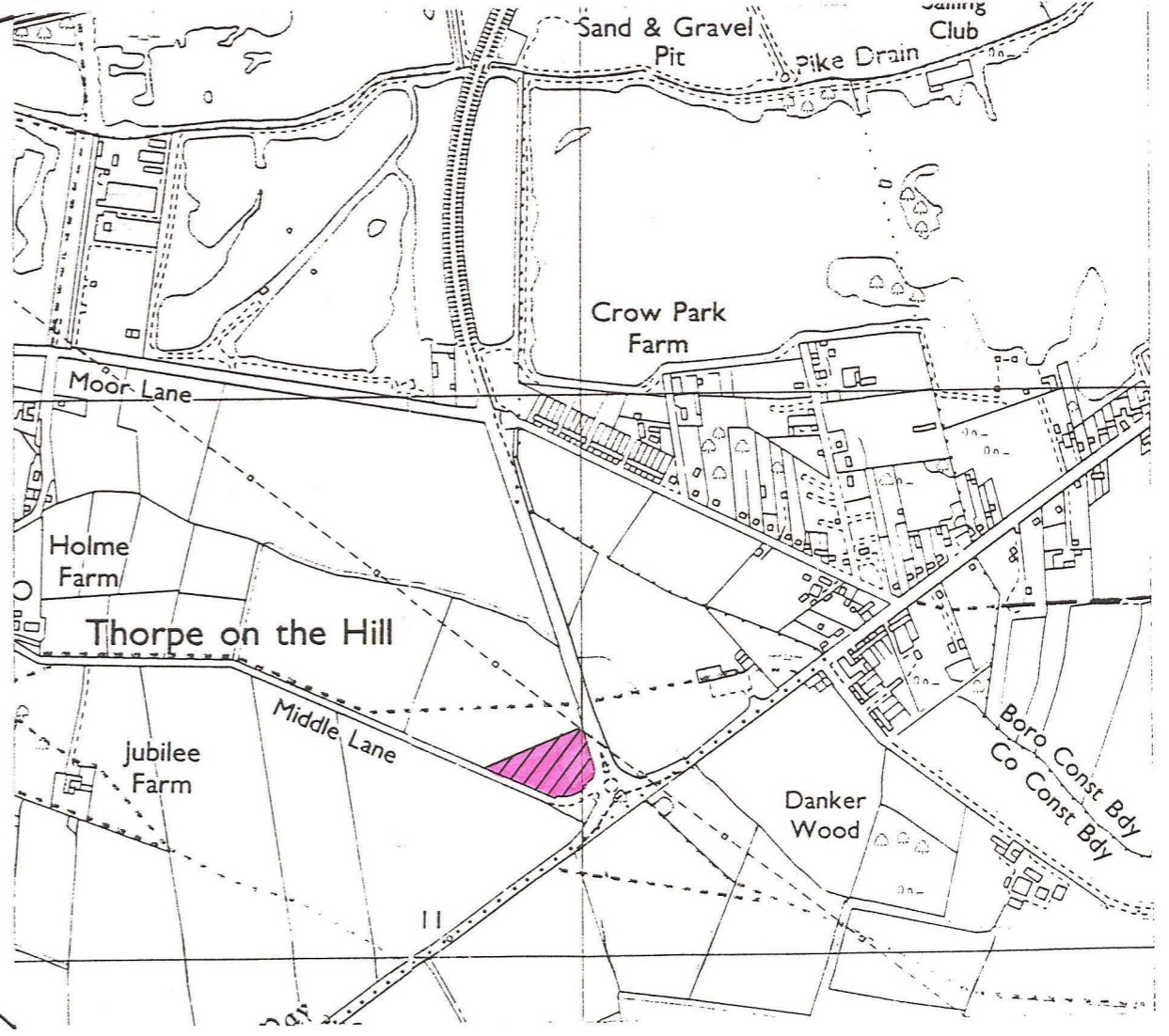

Reproduced from the 1989 Ordnance Survey 1:50 000 Landranger 121 map with the permission of The Controller of Her Majesty's Stationery Office, © Crown copyright.

Reproduced from the Ordnance Survey map with the permission of The Controller of Her Majesty's Stationery Office, © Crown copyright.

Fig.1



<b>CITY OF LINCOLN ARCHAEOLOGY UNIT</b>		
SITE CODE: TOH96	PLAN/ELEV/SECTION NO:	
CLIENT:	Howard Fawcett & Partners on behalf of Granada Roadside Restaurants	
DESCRIPTION: Plan of Proposed Development		
SCALE: 1:500	ARCHIVE NO:	
DRAWN BY:	CHECKED:	DATE:
MUSEUM ACCESSION NO: 161.96		

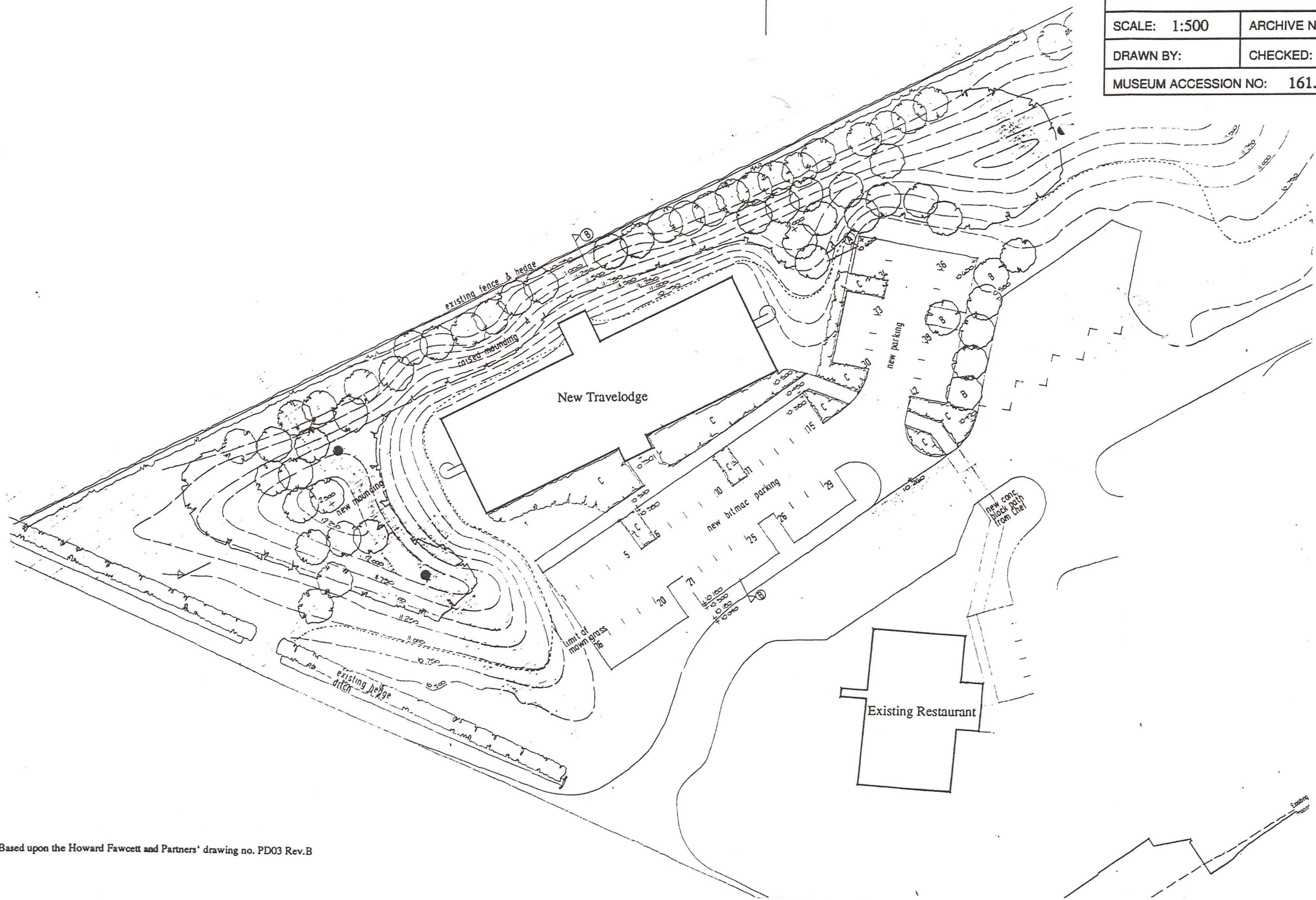



Based upon the Howard Fawcett and Partners' drawing no. PD03 Rev.B

Fig.2



KEY

-  Clay
-  Sand
-  Brick/Tile

CITY OF LINCOLN ARCHAEOLOGY UNIT		
SITE CODE: TOH96	PLANE/LEV/SECTION NO:	
CLIENT:	Howard Fawcett & Partners on behalf of Granada Roadside Restaurants	
DESCRIPTION: West-Facing Sections ① / ⑤ and ② (In Area of Main Building)		
SCALE: 1:20	ARCHIVE NO:	
DRAWN BY: K.W.	CHECKED:	DATE: 8&12/05/97
MUSEUM ACCESSION NO: 161.96		

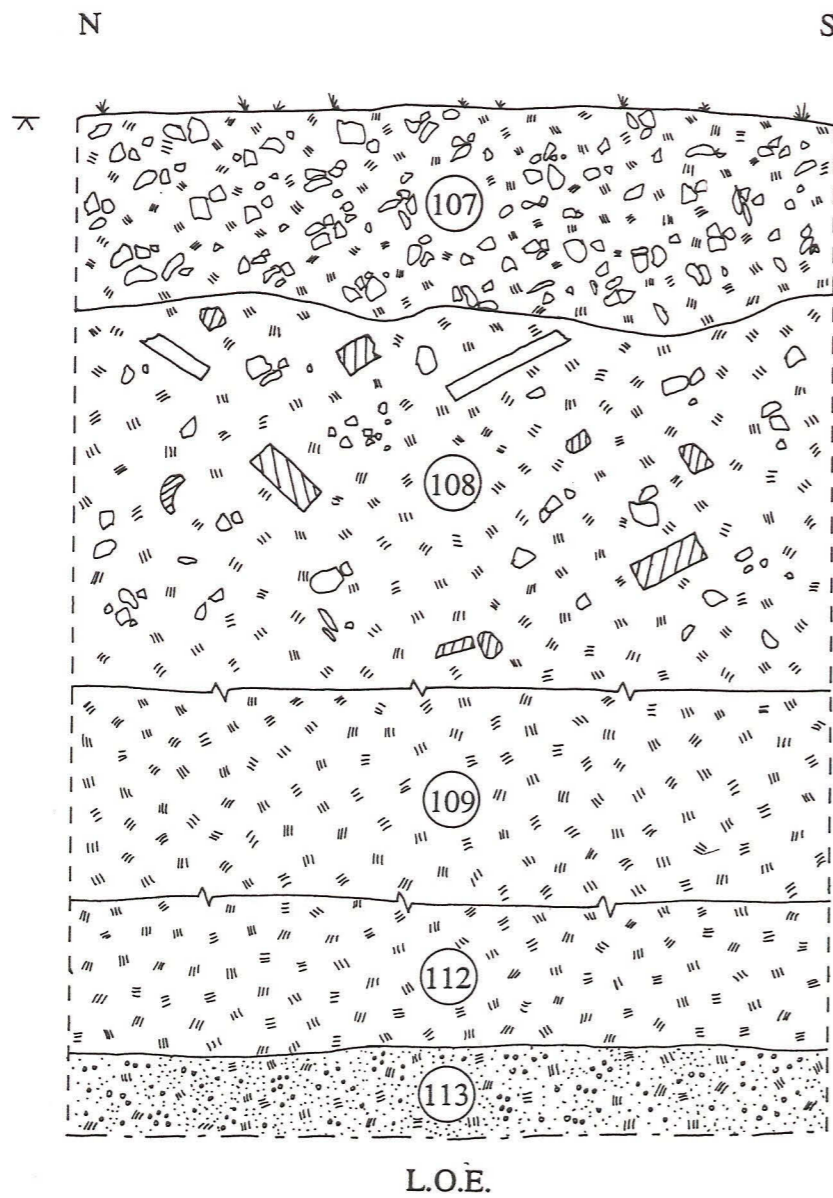

⌘ Nominal Site Level 12.50m O.D. ⌘

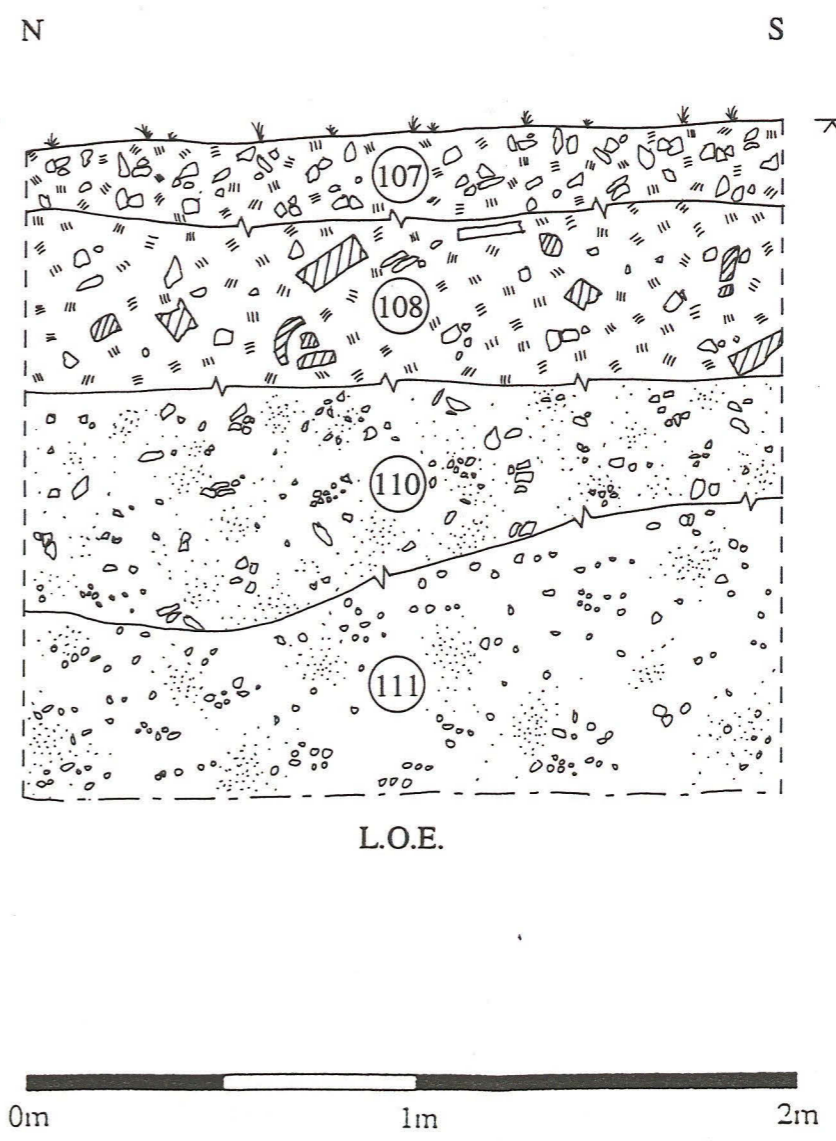





Fig.3



CITY OF LINCOLN ARCHAEOLOGY UNIT		
SITE CODE: TOH96	PLANE/ELEV/SECTION NO:	
CLIENT:	Howard Fawcett & Partners on behalf of Granada Roadside Restaurants	
DESCRIPTION: West-Facing Sections ③ and ④ (Drainage Trench)		
SCALE: 1:20	ARCHIVE NO:	
DRAWN BY: K.W.	CHECKED:	DATE: 08/05/97
MUSEUM ACCESSION NO: 161.96		

- KEY
-  Clay
  -  Sand
  -  Organic Material

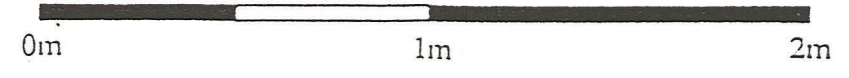
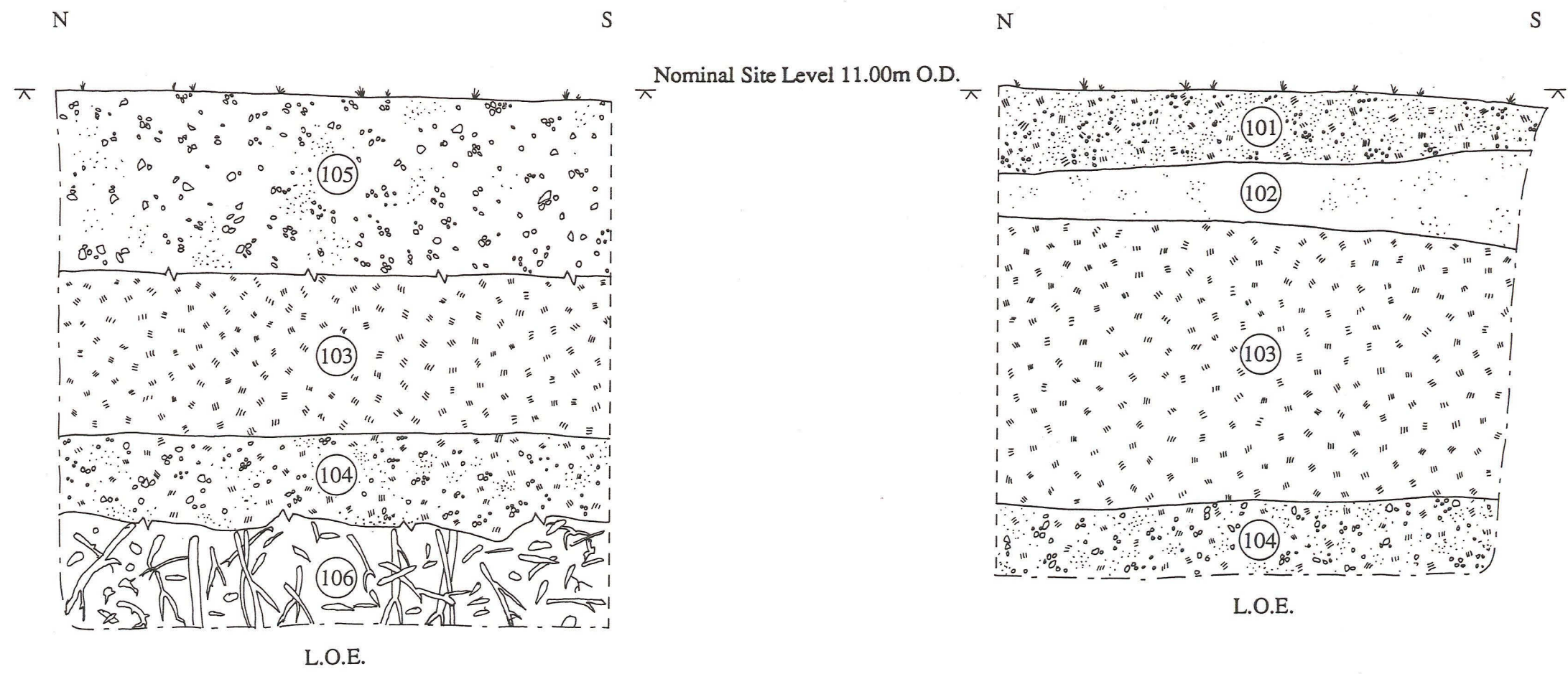

Fig.4