



LINDSEY ARCHAEOLOGICAL SERVICES

97/15

**LAND AT GREETWELL, LINCOLN
PROPOSAL FOR QUARRY EXTENSION**

**NGR : TF 007 724
Site Code : LGW 97
LCNCC Accession No. 226.97**

FIELDWALKING SURVEY

for

Butterley Aggregates Ltd

October 1997

25 WEST PARADE · LINCOLN · LN1 1NW
TELEPHONE 01522 544554 · FACSIMILE 01522 522211 · EMAIL las@lasarchaeology.demon.co.uk

PARTNERS: F.N.FIELD B.A.(Hons), MIFA · M.V.CLARK

QNT L1 3374
SOURCES L13454 L11581
52842 } Roman
54247 }
50348 Prehistoric
Page 54248 Medieval

CONTENTS

List of Figures

List of Tables

Summary	1
Introduction	1
Site Location	1
Planning Background	2
Archaeological Background	2
Method	2
Fieldwalking Survey	2
Results	3
Discussion	5
Acknowledgements	5
References	6

APPENDIX 1 : Pottery Report by Maggi Darling

APPENDIX 2: Finds from Fieldwalking. Archive List

Figures

Fig. 1. Location of proposed quarry extension (reduced from 1:10,000 Ordnance Survey Map). Reproduced with permission of the Controller of HMSO. LAS Licence No. AL 50424A.

Fig. 2. Artefact distribution from fieldwalking over gradiometer survey : grey scale plot, courtesy of Oxford Archaeotechnics Ltd. (© Oxford Archaeotechnics Ltd 1997)

Fig. 3. Artefact distribution from fieldwalking (Survey plot by Midland Surveying and Engineering)

Tables

Table 1 : Artefact retrieval.

Table 2 : Fieldwalking Finds.

**Land at Greetwell, Lincoln
Proposal for Quarry Extension
Fieldwalking Survey**

NGR: TF 007 724
Site Code: LGW 97
LCNCC Accession No. 226.97

Summary

An area of c.15 hectares under threat from the proposed extension of a limestone quarry was fieldwalked in September 1997. A total of 1147 artefacts were collected from the survey area with tile and pottery constituting the largest percentages of material gathered. The greatest concentration of material was in the north-west quadrant of the survey area, associated with the greatest density of archaeological features identified by geophysical survey. Assessment of the pottery assemblage from this area suggests a Roman date, probably 3rd or 4th century, for these features. Quantities of medieval tile and pottery were also recovered, although no significant concentrations were noted.

The results of the fieldwalking survey, in conjunction with the geophysical survey and aerial photographic evidence, suggest the area has the potential to reveal evidence for prehistoric, Roman and medieval activity. This does not, however, preclude the possibility of there being buried archaeological remains in areas which produced few or no artefacts as suggested by cropmark and geophysical evidence.

Introduction

Lindsey Archaeological Services was commissioned by Oxford Archaeological Associates, on behalf of Butterley Aggregates Limited, to undertake a fieldwalking survey at the above site. The scope of the work complies with the guidance from *Archaeology and Planning* (PPG 16), Department of the Environment (1990); *Management of Archaeological Projects*, English Heritage (1991); *Standard and Guidance for Archaeological Desk-Based Studies*, *Standard and Guidance for Archaeological Field Evaluations*, Institute for Field Archaeologists (1993, revised 1994).

The purpose of the non-intrusive phase of evaluation was to :

- establish the presence or absence of archaeological remains and their location within the survey area.

- gather data to assist in the determination of the level of further archaeological investigation required prior to development.

Site Location

The survey area lies close to the eastern outskirts of Lincoln, some 3km east of Lincoln cathedral. It is situated on the south-east slope of the Jurassic Limestone scarp known as the Lincoln Edge (c.35m AOD) on the northern side of the Witham Valley, immediately adjacent to the existing Butterley Aggregates Limited limestone quarry (Fig. 1).

Planning Background

A desk top study was carried out in 1994 (Johnson 1994) to assess the archaeological potential of the site prior to submission of a planning application for the extension of an existing limestone quarry by Butterley Aggregates Limited. The non-intrusive evaluation formed the next part of a staged archaeological assessment of the site prior to determination of the planning application which has now been submitted to Lincolnshire County Council.

Archaeological Background

Previous work in the surrounding area has identified archaeological remains of prehistoric, Roman and medieval date. This includes a triple parallel linear feature recorded from the air as cropmarks within the western half of the survey area which appears to be part of a major linear trackway or boundary observed at several points north of the site, extending north and north-west for a distance of at least 5 km. Staff now working at LAS have excavated two narrow cross-sections of the ditches in 1979 and 1993. Whilst they appear to pre-date Roman features, little clear evidence of their function and date has been obtained so far.

Several additional factors highlight the potential archaeological importance of the Greetwell area; its proximity to the Roman town/legionary fortress and thriving medieval city of Lincoln; its geology, providing accessible sources of both limestone and ironstone and its topographic location overlooking a significant crossing point of the River Witham immediately downstream from Lincoln. It has been suggested that the original crossing point of the Witham in Roman times may have lain east of the fortress and city (Hockley 1992). If this were the case, the higher ground overlooking a river crossing such as at Greetwell would be of great significance within a Roman military context .

Method

A geodimeter 640 total station 1' machine was used to establish a baseline tied into the National Grid and related to existing points used in previous fieldwork carried out to the north.

Fieldwalking Survey

Fieldwalking is normally carried out on land which has been recently ploughed or sown, to retrieve artefacts such as pottery or worked flint whose spatial distribution can indicate zones of occupation or activity beneath the ground surface.

The survey area was walked in transects 10m apart (giving a 10% coverage of the land) and finds individually recorded using a geodimeter 640 total station 1' machine and geodimeter super prisms, providing a two-dimensional co-ordinate for each find.

Contact between the fieldwalkers (referred to as Officers 1 to 4) and the surveyors was maintained using two-way radios. Each fieldwalker carried their own prism and directly reported to the surveyor when recording of a find was required. Pre-numbered bags were used to ensure there was no duplication in the field.

In accordance with the specification, post-medieval material was noted but not collected. In addition, animal bone was not retrieved as bone found on the surface cannot be assigned to a specific archaeological period.

A small area to the south-east of the proposed quarry extension and adjacent to the farm track was also walked. Although this lay outside the survey area, it proved considerably more expedient to lay out fieldwalking lines using the track as a baseline than to survey in the actual proposed extent of the quarry.

Results

Conditions for finds retrieval were not ideal as much of the area walked had been only partially harrowed. Visibility may also have been affected by bright sunshine and an often very strong wind, although the number of artefacts recovered was nevertheless substantial (Table 1).

Officer	Artefacts
1	248
2	374
3	235
4	290
Total	1147

Table 1 : Artefact Retrieval

The survey produced relatively large amounts of cultural material. A total of 1147 artefacts were recovered (Table 2), the majority of which were of tile and pottery with much lower percentages of brick, iron and other materials. 52% of the finds weighed 10g or less.

Type	Finds	%	Weight (g)	Weight/find (g)
Roman Pottery	110	9.6	1375	12.5
Roman pottery ?	53	4.6	235	4.4
Post-Roman pottery	132	11.5	1413	10.7
Post-Roman pottery ?	28	2.4	270	9.6
Indeterminate pottery	8	0.7	14	1.7
Roman tile	5	0.4	328	65.6
Roman tile ?	13	1.13	671	51.6
Post-Roman tile	30	2.62	957	31.9
Undated tile	749	65.3	14434	65.6
Post-Roman brick	10	0.9	994	99.4
Metal	6	0.5	149	24.8
Slag	3	0.25	51	17
Total	1147	100	20891	

Table 2 : Fieldwalking Finds

The ploughsoil consisted of a mid orange-brown clay loam with lighter orange clay and grey limestone often concentrated in strips relating to recent ploughing. It was generally fairly shallow, c.0.2m, as seen in a newly excavated pipe trench some 10-15m north-east of the site. This probably accounted for the high percentages of limestone rubble noted over the survey area as a whole. None of the limestone could be positively identified as having been used as building material although one particularly dense spread was noted in association with a spread of darker topsoil in the north-west quadrant of the survey area possibly associated with potential archaeological remains identified by geophysical survey (Fig. 2). This area also contained a very well defined scatter of Roman pottery (including sherds of imported Samian Ware), quantities of animal bone and occasional oyster shell.

The north-west corner and northern boundary, adjacent to the culvert (Fig. 2) produced very few finds. These areas lie downhill from the higher ground where more dense concentrations of archaeological material were recorded and it is possible that any archaeological features within these areas are sealed by deeper deposits of material which has moved downhill over centuries of agricultural use of the land. A noticeable lack of finds along the western boundary of the fieldwalking area may be indicative of a medieval headland.

In total, 797 fragments of tile were retrieved from the survey. Of these, 749 were too small to date securely. Of the 48 identified pieces, only 5 were positively Roman with a further 13 of possible Roman date. Twelve of the tentatively dated Roman tile fragments were initially identified as imbrices but, given the lack of tegulae present, may actually be post-medieval pantile fragments. Some of the imbrices are represented by the two small groups of Roman tile at the south end of the survey area, outside the main cluster of Roman finds, perhaps adding further weight to their possible re-identification

as post-medieval. The pieces were too small to allow positive identification. There was only one combed flue tile in the collection (find no. 742), which came from the main concentration of Roman finds.

Only 30 pieces of tile were identified as post-Roman but, as far as it was possible to tell, the majority of the unidentified fragments were probably also post-Roman in date. This is perhaps borne out by their general distribution across the site rather than the clustering exhibited by the Roman pottery (Fig. 3). In addition, 10 fragments of brick were recovered, all of which proved to be post-Roman.

A total of 331 sherds of pottery were found, accounting for 28.9% of the total finds. The majority of pieces were small and abraded, probably the result of plough damage. 110 were Roman with a further 53 likely to be of similar date.

132 sherds of positively identified post-Roman pottery were collected with another 28 likely to be of the same period. There were 10 sherds of medieval shelly fabrics in the collection which are probably 10-13th century in date. The majority of the post-Roman pottery sherds were in sandy oxidised fabrics, ranging in date from the 13th-18th centuries. Some reduced fabrics (grey) were clearly medieval because there were remaining traces of glaze but the majority were assigned to the Roman period.

There were 6 pieces of later post-medieval/modern date. Obvious post-medieval material was not collected, which would account for its very low level of representation in the pottery assemblage as a whole. A further 8 sherds were either too small or too abraded to date.

Discussion

Whilst the overall density of finds recovered was relatively low, significant concentrations of 3rd and 4th century pottery suggest a focus of late Roman activity on and around the highest point in the area surveyed. Dense limestone scatters in this area and the results of geophysical survey may be indicative of former buildings although, unfortunately, the stone had been reduced practically to gravel by ploughing making positive identification of building materials an impossibility.

A sparse scatter of 11 Roman pottery sherds was recovered from the triangle of land in the south field. It is not clear whether these are outliers of the concentration to the north, or more probably another concentration immediately to the south and beyond the limits of the survey. The magnetic susceptibility readings in this area are particularly low so it is suggested that these sherds are probably not from immediately underlying features.

The recovery of quantities of medieval material showed no significant spatial patterning and appeared unrelated either to cropmark or geophysical results. This does not necessarily suggest there are no buried archaeological features of this period present on the site, although the possibility remains

that they have been ploughed out or, alternatively, that the artefacts recovered were there as a result of medieval and later manuring.

Assessment of the fieldwalking finds suggests no material of pre-Roman date was recovered, although both cropmark and geophysical evidence show a triple ditch feature of probable Iron Age date crossing the western half of the site (Fig. 2). Excavation of a similar feature by LAS staff in 1994 revealed little artefactual material (Tipper 1994) and it is likely that this situation is reflected at Greetwell. 'Blank' areas evident in the spatial distribution of finds (Fig. 3) appear to follow a similar alignment to the triple ditches, indicating the possible presence of remnant ploughed out banks associated with the ditch system. Geophysical survey results also suggest the presence of a c.50m wide band of ploughed-down bank material following a similar alignment (Johnson 1997). A lack of all finds from these areas may suggest a relatively recent destruction of these earthworks, although the position of modern artefacts was not two dimensionally recorded during the survey, leaving open the possibility that some material of modern date was present.

Acknowledgements

Lindsey Archaeological Services would like to thank Butterley Aggregates Ltd and the farmer, Mr Ward for their help and co-operation during this project. Thanks are also due to Maggi Darling for her work on the pottery and tile assemblages. All fieldwalking and finds processing was undertaken by the author assisted by Sue Farr, Richard Moore and Liz Davis. The MSE surveying team was Doug Hicklin, Alison Hicklin and Ellie Peters. This report was collated and produced by Jane Frost and edited by Naomi Field.

October 1997
R. J. Armour-Chelu

References

- Hockley, J. 1992. *Lincoln Eastern Bypass: Stage 1. Archaeological and Historical Study*. Report by the City of Lincoln Archaeological Unit for Lincolnshire County Council
- Johnson, A. E. 1994. *Land at Greetwell, Lincolnshire. Magnetic Susceptibility and Magnetometer Survey*. OA Report for Butterley Aggregates Ltd
- Johnson, A. E. 1997. *Land at Greetwell, Lincolnshire: Magnetometer (Gradiometer) Survey*. OA Report for Butterley Aggregates Ltd
- McDaid, M. 1997. *Land at Bunker's Hill, Greetwell, Lincoln: Archaeological Fieldwalking Survey*. LAS Report for Smiths Gore Chartered Surveyors
- Tipper, J. 1994. *Archaeological Excavations at Braucewell Limestone Quarry*. LAS Report for Braucewell Quarries Ltd

APPENDIX 1

Pottery Report by Maggi Darling

REPORT ON THE FIELD WALKING FINDS FROM GREETWELL, LGW 97

for LINDSEY ARCHAEOLOGICAL SERVICES

by Margaret J. Darling, M.Phil., F.S.A., M.I.F.A.

18 October 1997

THE POTTERY

Pottery accounts for 28.9% of the finds. Of the pottery, Roman sherds represent about 50% on both sherd count and weight. All sherds are abraded and of relatively small size.

The abraded condition of the pottery made certain identification difficult, particularly with the loss of glaze from sand-tempered fabrics, leaving sherds with fabrics similar to some Roman wares. The datable sherds include four sherds of Central Gaulish samian of 2nd century date, but most of the other datable sherds belong to the 3rd to 4th centuries, and largely to the period c AD250 onwards. The pottery includes sherds of Swanpool mortaria, shell-gritted Dales ware jars, grey wide-mouthed bowls, lid-seated jars, plain and grooved rim dishes, etc.

At this period, although oxidised fabrics were produced at the Swanpool kilns, the occurrence of oxidised fabrics in any assemblage is relatively low. On this basis, most of the abraded oxidized sherds have been regarded as of post-Roman date, while the grey sand-gritted sherds have been largely recorded as of Roman date. Some of these are probably post-Roman.

THE TILE

The tile is notably fragmented. Since the fabric of tiles made using local clays in the Roman and post-Roman period is virtually indistinguishable in the hand specimen, the vast number of fragments were left undated. The important aspect relative to the tiles is that only five fragments could be unequivocally identified as Roman tiles, four fragments of tegulae, and a single combed flue tile. Some were initially regarded as fragments of imbrices, but further work makes it more likely that the early identifications were from pantiles. Tegulae in particular are large tiles which produce a relatively high percentage of identifiable fragments. Equally imbrices, although rarer, are usually quite identifiable as fragments. On this basis, it is very unlikely that many of the undated tile fragments, representing 65% of all finds, are of Roman date.

DISCUSSION

Much of this material seems likely to have come from manuring. The paucity of securely identified Roman tile does not suggest the presence of a ploughed building of Roman date. Although the presence of a few sherds of samian implies a 2nd century start for activity, Central Gaulish samian is common in 3rd century deposits, and the general feeling of the pottery is for a later Roman date, from the early to mid 3rd century onwards, extending well into the 4th century. There were no sherds of positively late Roman date, but since these are sparsely represented in assemblages, their absence is negative evidence of debatable value.

APPENDIX 2

Finds from Fieldwalking. Archive List

LGW 97 (Greetwell) finds from fieldwalking

Finds No.	Category	Description	Date	Discard	Wt/gm
1	tile	frag		y	21
2	tile	frag		y	13
3	tile	frag		y	11
4	pot		Post-Rom?		16
5	metal	fe obj			12
6	tile	roof			50
7	tile	frag	Post-Rom?	y	26
8	pot	OX flake	Rom?		3
9	tile	frag, square			18
10	tile	frag		y	48
11	tile	frag		y	12
12	tile	frag		y	2
13	pot	OX	Post-Rom?		3
14	tile	frag		y	4
15	tile	frag		y	11
16	metal	pb obj			66
17	tile	frag, roof		y	15
18	pot	OX fine	Rom?		1
19	tile	frag		y	18
20	tile	frag		y	13
21	pot	OX bs			2
22	tile	frag, round			38
23	tile	frag		y	4
24	pot	OX bs	Post-Rom?		7
25	tile	frag		y	14
26	tile	frag		y	1
27	pot	OX bs			1
28	tile	frag		y	2
29	tile	frag		y	37
30	pot	OX bs	Post-Rom?		7
31	tile	frag		y	36
32	tile	frag		y	3
33	pot	SHEL	Post-Rom?		5
34	tile	frag		y	13
35	pot	OX			7
36	pot	OX	Post-Rom		10
37	pot	OX flake			1
38	tile	frag		y	48
39	tile	frag		y	28
40	tile	frag		y	2
41	pot	mortarium/amphora	Rom		16
42	tile	frag		y	13
43	pot	OX	Post-Rom?		3
44	pot	OX	Post-Rom?		7
45	tile	frag		y	28
46	pot	OX	Post-Rom?		18
47	tile	frag		y	9
48	tile	frag		y	7
49	tile	frag		y	1
50	tile	frag		y	45
51	tile	frag		y	11
52	tile	imbrex/pipe	Rom?		68
53	tile		Rom?		196
54	pot	handle	Post-med		82
55	tile	frag		y	31
56	tile	frag		y	7
57	tile	imbrex	Rom		42
58	tile	imbrex	Rom		78

LGW 97 (Greetwell) finds from fieldwalking

Finds No.	Category	Description	Date	Discard	Wt/gm
59	pot	OX	Post-Rom		1
60	tile	frag		y	8
61	tile	frag		y	2
62	tile	frag		y	3
63	tile	frag		y	9
64	tile	frag		y	12
65	tile	frag, roof		y	18
66	tile	frag		y	5
67	tile	frag, rounded		y	39
68	tile	frag		y	26
69	pot	OX base	Post-Rom?		12
70	pot	OX	Post-Rom?		2
71	tile	frag		y	6
72	pot		Post-Rom		5
73	tile	frag		y	101
74	pot	bs	Rom?		1
75	tile	frag		y	13
76	tile	frag		y	6
77	tile	frag		y	14
78	tile	frag		y	14
79	tile	frag		y	13
80	tile	frag		y	18
81	tile	frag		y	9
82	tile	frag		y	13
83	tile	frag		y	15
84	tile	frag		y	29
85	pot	OX	Post-Rom?		2
86	tile	imbrex	Rom		21
87	tile	frag		y	13
88	tile	frag		y	5
89	tile	frag		y	7
90	pot	OX	Post-Rom?		16
91	pot	OX	Post-Rom?		8
92	tile	frag		y	6
93	tile	frag		y	1
94	metal	fe nail?			41
95	tile	frag		y	40
96	tile	pipe?			73
97	tile	frag		y	9
98	pot	OX	Post-Rom?		8
99	tile	imbrex?	Rom		14
100	pot	OX	Post-Rom?		3
101	tile	frag		y	4
102	tile	frag		y	7
103	tile	frag		y	10
104	tile	frag		y	2
105	tile	frag		y	31
106	tile	frag		y	4
107	tile	frag		y	6
108	tile	frag		y	1
109	tile	frag		y	1
110	tile	frag		y	2
111	tile	frag		y	10
112	tile	frag		y	1
113	tile	frag		y	2
114	tile	frag		y	40
115	tile	frag		y	19
116	tile	frag		y	19

LGW 97 (Greetwell) finds from fieldwalking

Finds No.	Category	Description	Date	Discard	Wt/gm
117	tile	frag		y	6
118	tile	frag		y	14
119	tile	frag		y	1
120	tile	frag		y	1
121	pot		Post-Rom		8
122	brick			y	12
123	tile	frag		y	7
124	tile	frag		y	2
125	tile	frag		y	1
126	tile	frag		y	1
127	tile	imbrex	Rom		56
128	tile	frag		y	2
129	tile	imbrex?	Rom		84
130	tile	frag		y	30
131	tile	frag	Post-Rom?		4
132	pot		Post-Rom		1
133	tile	frag		y	11
134	tile	frag		y	7
135	tile	frag		y	12
136	tile	frag		y	1
137	tile	frag		y	3
138	tile	frag	Post-Rom?	y	9
139	tile	frag		y	2
140	tile	frag		y	14
141	tile	frag		y	1
142	tile	imbrex?	Rom		20
143	tile	imbrex?	Rom		27
144	tile	frag		y	1
145	tile	imbrex	Rom		37
146	tile	imbrex?	Rom		8
147	brick		Post-Rom	y	30
148	tile	roof	Post-Rom?		159
149	tile	roof	Post-Rom?		92
150	tile	frag		y	3
151	tile	frag		y	6
152	tile	frag		y	5
153	pot ?		Post-Rom?		2
154	tile	frag	Post-Rom?	y	17
155	tile	frag		y	1
156	pot	OX	Post-Rom?		1
157	tile	frag	Post-Rom?	y	
158	tile	frag		y	2
159	pot		Post-Rom		14
160	tile	frag	Post-Rom?	y	31
161	tile	frag	Post-Rom?	y	28
162	tile	frag	Post-Rom?	y	15
163	pot		Post-Rom?		3
164	pot	handle	Post-Rom		37
165	pot		Post-Rom?		6
166	tile	frag		y	4
167	tile	imbrex?	Rom		18
168	tile		Post-Rom?		21
169	tile	frag		y	12
170	pot ?		Post-Rom?		30
171	tile	frag		y	4
172	tile	frag	Post-Rom?	y	19
173	pot ?		Post-Rom?		20
174	tile	frag	Post-Rom	y	9

LGW 97 (Greetwell) finds from fieldwalking

Finds No.	Category	Description	Date	Discard	Wt/gm
175	tile	frag		y	5
176	tile	frag		y	25
177	tile	frag		y	13
178	metal	fe nail			17
179	tile	frag		y	2
180	pot		Post-Rom?		1
181	pot		Post-Rom		13
182	tile	frag		y	2
183	tile	frag		y	13
184	pot		Post-Rom		8
185	brick ?		Post-Rom		400
186	pot		Post-Rom		5
187	tile	frag		y	26
188	tile	frag		y	41
189	tile	frag	Post-Rom?	y	62
190	pot	SHEL	Post-Rom?		5
191	tile	frag	Post-Rom?	y	22
192	tile	frag		y	44
193	tile	frag		y	9
194	tile	frag		y	2
195	tile	frag		y	10
196	tile	frag	Post-Rom	y	36
197	tile	frag		y	10
198	pot	OX	Post-Rom		12
199	pot	SHEL	Post-Rom		1
200	pot		Post-med		6
201	tile	frag	Post-Rom	y	15
202	tile	frag		y	10
203	brick		Post-Rom	y	7
204	tile	frag		y	8
205	tile	frag		y	10
206	tile	frag		y	3
207	pot		Post-Rom		13
208	tile	frag		y	1
209	tile	frag	Post-Rom	y	8
210	tile	frag	Post-Rom	y	31
211	tile	frag	Post-Rom	y	10
212	tile	frag		y	28
213	tile	frag		y	19
214	tile	frag		y	41
215	tile	frag		y	13
216	pot	OX			1
217	tile	frag		y	27
218	tile	frag		y	3
219	tile	frag		y	27
220	tile	frag		y	26
221	pot		Post-Rom		6
222	pot		Post-Rom		2
223	tile	frag		y	6
224	tile	frag		y	9
225	tile	frag	Post-Rom	y	4
226	pot	handle	Post-Rom		60
227	tile	frag	Post-Rom	y	9
228	tile	frag	Post-Rom	y	10
229	tile	frag		y	39
230	tile	frag		y	6
231	tile	frag		y	11
232	tile	frag		y	16

LGW 97 (Greetwell) finds from fieldwalking

Finds No.	Category	Description	Date	Discard	Wt/gm
233	tile	frag		y	12
234	tile	frag		y	6
235	tile	frag		y	10
236	tile	frag		y	34
237	tile	frag		y	11
238	tile	frag		y	16
239	tile	frag		y	14
240	tile	frag		y	25
241	tile	frag		y	62
242	tile	frag		y	7
243	tile	frag		y	13
244	tile	frag		y	62
245	tile	frag		y	10
246	pot		Post-Rom		5
247	tile	frag		y	13
248	pot ?		Post-Rom?		6
249	tile	frag		y	11
250	tile	frag		y	16
251	tile	frag		y	4
252	pot	grey bs	Post-Rom?		5
253	tile	frag		y	20
254	pot ?		Post-Rom		40
255	pot	grey bs	Post-Rom		7
256	tile	frag		y	17
257	tile	frag		y	16
258	tile	frag		y	12
259	tile	frag		y	2
260	tile	frag		y	66
261	tile	frag		y	20
262	tile	frag		y	34
263	tile	frag		y	46
264	tile	frag		y	9
265	tile	frag		y	8
266	tile	frag		y	47
267	tile	frag		y	42
268	tile	frag		y	4
269	tile	frag		y	5
270	tile	frag		y	20
271	tile	frag		y	48
272	tile	frag		y	19
273	tile	frag		y	17
274	tile	frag		y	14
275	pot	bs Samian ?	Rom?		9
276	tile	frag		y	14
277	tile	frag		y	3
278	brick			y	116
279	tile	frag		y	23
280	brick			y	73
281	tile			y	14
282	tile			y	20
283	tile			y	2
284	tile			y	24
285	tile			y	5
286	tile			y	15
287	pot		Post-Rom		5
288	tile			y	21
289	tile			y	10
290	tile			y	2

LGW 97 (Greetwell) finds from fieldwalking

Finds No.	Category	Description	Date	Discard	Wt/gm
291	pot	thin bs	Post-Rom?		1
292	tile			y	6
293	pot		Post-Rom		5
294	tile			y	23
295	pot		Post-Rom		1
296	tile			y	19
297	tile			y	44
298	tile			y	1
299	tile			y	10
300	tile			y	29
301	tile			y	9
302	pot		Post-Rom		2
303	tile			y	2
304	tile			y	14
305	pot		Post-Rom		1
306	tile	frag		y	17
307	tile	frag		y	2
308	tile	frag		y	3
309	tile	frag		y	6
310	tile	frag		y	1
311	tile	frag		y	15
312	pot		Post-Rom		3
313	tile	frag		y	16
314	pot	SHEL	Post-Rom		1
315	pot	SHEL	Post-Rom		7
316	tile	frag		y	3
317	tile	frag		y	5
318	tile	frag		y	15
319	tile	frag		y	4
320	tile	frag		y	8
321	pot ?		Post-Rom		3
322	tile	frag		y	7
323	tile	frag		y	25
324	tile	frag		y	8
325	tile	frag		y	13
326	tile	frag		y	4
327	tile	frag		y	11
328	tile	frag		y	23
329	tile	frag		y	23
330	pot	SHEL	Post-Rom		18
331	tile	frag		y	15
332	tile	burnt		y	76
333	pot		Post-Rom		3
334	tile	frag	Post-Rom	y	58
335	tile	frag		y	42
336	tile	frag		y	11
337	tile	frag	Post-Rom	y	1
338	tile	frag	Post-Rom	y	85
339	tile	frag	Post-Rom	y	6
340	tile	frag		y	18
341	tile	frag		y	10
342	tile	frag		y	14
343	tile	frag		y	4
344	tile	frag		y	25
345	tile	frag		y	18
346	tile	frag		y	5
347	tile	frag		y	3
348	pot	thin wall		y	1

LGW 97 (Greetwell) finds from fieldwalking

Finds No.	Category	Description	Date	Discard	Wt/gm
349	pot		Post-Rom		6
350	tile	frag		y	2
351	tile	frag		y	9
352	tile	frag		y	7
353	tile	frag		y	64
354	tile	frag, curved		y	24
355	tile	frag		y	19
356	tile	frag		y	43
357	tile	frag		y	12
358	pot		Post-med		6
359	tile	frag		y	12
360	tile	frag		y	4
361	tile	frag		y	23
362	tile	frag		y	1
363	tile	frag		y	65
364	tile	frag		y	4
365	tile	frag		y	4
366	tile	frag		y	20
367	tile	frag		y	1
368	tile	frag		y	3
369	tile	frag		y	21
370	tile	frag		y	39
371	tile	frag		y	27
372	tile	frag		y	11
373	tile	frag		y	35
374	tile	frag		y	12
375	tile	frag		y	7
376	tile	frag		y	14
377	tile	frag		y	35
378	pot		Post-Rom		17
379	tile	frag		y	5
380	tile	frag		y	4
381	tile	frag		y	42
382	pot		Post-Rom		2
383	pot ?		Post-Rom		39
384	tile	frag		y	8
385	tile	frag		y	48
386	tile	frag		y	16
387	pot		Post-med		2
388	tile	frag		y	1
389	tile	frag		y	1
390	tile	frag		y	1
391	tile	frag		y	21
392	pot		Post-Rom		7
393	pot		Post-med		1
394	tile	frag		y	29
395	tile	frag		y	1
396	tile	frag		y	16
397	tile	frag		y	29
398	pot		Post-med		4
399	tile	frag		y	9
400	tile	frag		y	20
401	pot	OX bs	Post-Rom		2
402	tile	frag		y	4
403	tile	frag		y	4
404	tile	frag		y	23
405	tile	frag		y	4
406	tile	frag		y	20

LGW 97 (Greetwell) finds from fieldwalking

Finds No.	Category	Description	Date	Discard	Wt/gm
407	tile	frag		y	41
408	tile	frag		y	11
409	pot	bs	Post-Rom?		2
410	tile	frag		y	2
411	tile	frag		y	8
412	tile	frag, curved		y	132
413	tile	frag		y	21
414	tile	frag		y	15
415	tile	frag		y	16
416	tile	frag		y	13
417	tile	frag		y	21
418	tile	frag		y	4
419	tile	frag		y	13
420	pot	base	Post-Rom		11
421	tile	frag		y	54
422	tile	frag		y	25
423	tile	frag		y	12
424	tile	frag		y	15
425	tile	frag		y	6
426	tile	frag		y	3
427	tile	frag		y	39
428	tile	frag		y	23
429	tile	frag		y	16
430	tile	frag		y	7
431	tile	frag		y	2
432	tile	frag		y	34
433	tile	frag		y	27
434	brick			y	45
435	tile	frag		y	14
436	tile	frag		y	1
437	tile	frag		y	23
438	tile	frag		y	1
439	tile	frag		y	65
440	tile	frag		y	18
441	brick			y	147
442	tile	frag		y	58
443	pot	bs grey, glazed	Post-Rom		3
444	tile	frag		y	12
445	tile	frag		y	5
446	pot	OX bs	Post-Rom?		1
447	pot	OX bs	Post-Rom		1
448	tile	frag		y	10
449	pot	grey bs	Rom?		1
450	tile	frag		y	26
451	tile	frag		y	28
452	tile	frag		y	42
453	tile	frag		y	7
454	tile	frag		y	1
455	tile	frag		y	1
456	tile	frag		y	39
457	tile	frag		y	13
458	tile	frag		y	1
459	tile	frag		y	3
460	tile	frag		y	1
461	tile	frag		y	28
462	tile	frag		y	24
463	tile	frag		y	6
464	tile	frag		y	30

LGW 97 (Greetwell) finds from fieldwalking

Finds No.	Category	Description	Date	Discard	Wt/gm
465	tile	frag		y	22
466	tile	frag		y	3
467	pot	OX bs	Post-Rom?		10
468	pot	grey bs	Rom?		2
469	tile	frag		y	19
470	pot	OX bs			1
471	tile	frag		y	28
472	tile	frag		y	12
473	tile	frag		y	7
474	tile	frag		y	17
475	tile	frag		y	18
476	tile	frag		y	14
477	tile	frag		y	40
478	pot	OX bs	Post-Rom		1
479	pot	OX rim	Rom?		16
480	tile	frag		y	5
481	pot	base?	Post-Rom		41
482	tile	frag		y	26
483	tile	frag		y	2
484	pot	grey bs	Rom?		1
485	pot	OX glaze	Post-Rom		2
486	pot	rim	Rom?		10
487	tile	frag		y	7
488	tile	frag		y	2
489	pot	OX bs			5
490	tile	frag		y	10
491	pot	grey bs	Rom		3
492	pot	grey bs	Rom?		6
493	pot	grey bs	Rom?		1
494	pot	OX base	Post-Rom?		17
495	pot	SHEL rim	Post-Rom?		16
496	pot	grey bs	Rom?		1
497	pot	OX bs			1
498	brick			y	159
499	pot	grey bs	Rom?		4
500	tile	frag		y	100
501	tile	frag		y	32
502	tile	frag		y	17
503	tile	frag		y	16
504	pot	base	Post-Rom?		24
505	tile	frag		y	23
506	tile	frag		y	15
507	tile	frag		y	31
508	tile	frag		y	6
509	tile	frag		y	20
510	pot	SHEL bs			2
511	tile	frag		y	12
512	tile	frag		y	3
513	tile	frag		y	21
514	tile	frag		y	39
515	tile	frag		y	24
516	tile	frag		y	1
517	tile	frag		y	1
518	tile	frag		y	33
519	tile	frag		y	6
520	pot	bs	Post-Rom?		8
521	pot	handle	Post-Rom		45
522	tile	frag		y	4

LGW 97 (Greetwell) finds from fieldwalking

Finds No.	Category	Description	Date	Discard	Wt/gm
523	tile	frag		y	103
524	tile	frag		y	20
525	tile	frag		y	34
526	tile	frag		y	7
527	tile	frag		y	1
528	tile	frag		y	7
529	tile	frag		y	8
530	tile	frag		y	17
531	brick			y	5
532	tile	frag		y	19
533	tile	frag		y	28
534	tile	frag		y	2
535	tile	frag		y	45
536	pot	OX base			11
537	pot	OX		y	1
538	slag				20
539	tile	frag		y	2
540	tile	frag		y	79
541	tile	frag		y	1
542	tile	frag		y	1
543	tile	frag		y	18
544	tile	frag		y	2
545	tile	frag		y	4
546	tile	frag		y	3
547	tile	frag		y	17
548	tile	frag		y	2
549	tile	frag		y	1
550	slag				11
551	tile	frag		y	5
552	pot	grey	Rom?		5
553	pot	SHEL	Rom?		1
554	tile	frag		y	77
555	tile	frag		y	18
556	pot	grey bs	Rom?		4
557	tile	frag		y	12
558	tile	frag		y	50
559	tile	frag		y	21
560	tile	frag		y	29
561	pot	OX rim			2
562	tile	frag		y	379
563	tile	frag		y	1
564	pot	grey BWM	Rom		28
565	tile	frag		y	10
566	pot	grey bs	Rom?		4
567	pot	grey bs	Rom?		3
568	pot	grey bs	Rom?		3
569	pot	grey BWM	Rom		48
570	pot	grey bs	Rom?		1
571	tile	frag		y	3
572	tile	frag		y	19
573	pot	OX bs			3
574	pot	grey bs	Rom		2
575	tile	frag		y	5
576	tile	frag		y	1
577	tile	frag		y	13
578	tile	frag		y	8
579	pot	grey bs	Rom?		2
580	tile	frag		y	37

LGW 97 (Greetwell) finds from fieldwalking

Finds No.	Category	Description	Date	Discard	Wt/gm
581	tile	frag		y	1
582	tile	frag		y	29
583	tile	frag		y	7
584	tile	frag		y	13
585	tile	frag		y	12
586	tile	frag		y	5
587	tile	frag		y	42
588	tile	frag		y	1
589	tile	frag		y	8
590	tile	frag		y	4
591	tile	frag		y	13
592	tile	frag		y	4
593	tile	frag		y	19
594	tile	frag		y	6
595	tile	frag		y	34
596	pot	grey bs	Rom?		15
597	tile	frag		y	14
598	pot	grey bs	Rom?		12
599	tile	frag		y	4
600	tile	frag		y	7
601	tile	frag		y	3
602	tile	frag, tegula ?	Rom?		61
603	pot	OX bs		y	1
604	tile	frag		y	12
605	tile	frag		y	14
606	tile	frag		y	5
607	tile	frag		y	24
608	tile	frag		y	1
609	pot	glazed	Post-Rom		1
610	tile	frag		y	4
611	pot	OX bs	Post-Rom?		3
612	tile	frag		y	1
613	tile	frag		y	7
614	tile	frag		y	14
615	tile	frag		y	35
616	tile	frag		y	19
617	tile	frag		y	5
618	tile	frag		y	24
619	tile	frag		y	51
620	pot	grey BRR?	Rom		8
621	pot	OX rim	Post-Rom		10
622	tile	frag		y	7
623	tile	frag		y	33
624	tile	frag		y	12
625	tile	frag		y	6
626	pot	OX rim	Post-Rom		11
627	tile	frag		y	21
628	tile	frag		y	4
629	tile	frag		y	8
630	pot	grey J bs	Rom		16
631	tile	frag		y	3
632	tile	frag		y	31
633	pot	glaze	Post-Rom		1
634	tile	frag		y	1
635	tile	frag		y	7
636	pot	OX bs	Post-Rom?		1
637	tile	frag		y	16
638	pot	OX	Post-Rom?		2

LGW 97 (Greetwell) finds from fieldwalking

Finds No.	Category	Description	Date	Discard	Wt/gm
639	pot		Post-Rom?		2
640	pot	OX	Post-Rom?		1
641	tile	frag		y	9
642	tile	frag		y	15
643	pot	OX	Post-Rom		1
644	tile	frag		y	7
645	tile	frag		y	1
646	pot	grey base	Rom		13
647	tile	frag		y	1
648	pot	grey bs	Rom		11
649	tile	frag		y	80
650	pot	grey JBK base	Rom		16
651	pot	grey bs	Rom?		2
652	pot	SHEL base	Rom?		6
653	pot	OX B rim	Rom		12
654	tile	frag		y	34
655	pot	grey bs	Rom		60
656	tile	frag		y	342
657	pot	grey bs	Rom?		13
658	pot	SHEL			1
659	tile	frag		y	3
660	pot	OX			15
661	tile	frag		y	15
662	tile	frag		y	34
663	pot	grey bs	Rom		1
664	tile	frag		y	25
665	tile	frag		y	15
666	pot	grey JBK base	Rom		22
667	tile	frag		y	5
668	pot	grey bs	Rom		8
669	tile	frag		y	5
670	tile	frag		y	36
671	pot	grey bs	Rom		11
672	pot	grey	Rom?		1
673	tile	frag		y	3
674	pot	grey bs	Rom		1
675	tile	frag, tegula ?	Rom?	y	61
676	tile	frag		y	31
677	pot	grey bs	Rom?		5
678	tile	frag		y	8
679	tile	frag		y	37
680	tile	frag		y	4
681	pot	grey bs	Rom		1
682	tile	frag		y	20
683	pot	grey bs	Rom?		6
684	pot	grey PR	Rom?		12
685	pot	OX			30
686	pot	grey DPR?	Rom		7
687	pot	SAMCG	2 Rom		1
688	pot	grey bs	Rom		8
689	pot	MOSP?	4 Rom		19
690	pot	grey BWM	Rom		29
691	pot	grey bs	Rom		16
692	pot	grey	Rom		3
693	pot	grey JL?	Rom		28
694	pot	grey rim	Rom		10
695	pot	SHEL	Rom?		1
696	tile	frag		y	15

LGW 97 (Greetwell) finds from fieldwalking

Finds No.	Category	Description	Date	Discard	Wt/gm
697	tile	frag		y	3
698	tile	frag		y	8
699	pot	grey bs	Rom		8
700	pot	grey base	Rom		30
701	pot	grey bs	Rom		1
702	tile	frag		y	4
703	tile	frag		y	6
704	tile	frag		y	11
705	tile	frag		y	2
706	pot	bs	Post-Rom		12
707	tile	frag		y	6
708	tile	frag		y	36
709	tile	frag		y	1
710	tile	frag		y	29
711	tile	frag		y	66
712	tile	frag		y	1
713	pot	base	Post-Rom		20
714	tile	frag		y	1
715	tile	frag		y	4
716	pot	chip	Post-Rom?		1
717	tile	frag		y	4
718	tile	frag		y	41
719	pot	OX bs	Post-Rom?		2
720	tile	frag		y	5
721	pot	grey rim	Rom		3
722	pot	glazed	Post-Rom		2
723	pot	DWSH-JDW	M3+ Rom		4
724	tile	frag		y	5
725	pot	grey glaze	Post-Rom		12
726	pot	grey	Rom?		1
727	tile	frag		y	16
728	tile	frag		y	17
729	pot	grey bs	Rom?		5
730	tile	frag		y	16
731	pot	grey bs	Rom?		2
732	tile	frag		y	8
733	pot	glazed	Post-Rom		1
734	tile	frag		y	10
735	tile	frag		y	1
736	pot	glazed	Post-Rom		1
737	pot	grey BFB	L3-4 Rom		11
738	pot	SHEL			2
739	pot	grey bs	Rom		10
740	tile	frag		y	4
741	tile	W nibs			61
742	tile	combed flue	Rom		38
743	pot	grey bs	Rom?		1
744	pot	grey bs	Rom?		1
745	tile	frag		y	1
746	pot	grey bs	Rom?		1
747	tile	frag		y	24
748	tile	frag		y	19
749	pot	grey bs	Rom?		1
750	pot	OX bs			2
751	tile	frag		y	20
752	pot	grey bs	Rom?		1
753	pot	grey bs	Rom		3
754	pot	grey DGR	Rom		7

LGW 97 (Greetwell) finds from fieldwalking

Finds No.	Category	Description	Date	Discard	Wt/gm
755	pot	grey base	Rom		24
756	pot	grey bs	Rom		7
757	pot	grey base	Rom		39
758	pot	OX bs	Post-Rom?		14
759	pot	grey bs	Rom		15
760	pot	grey bs	Rom		3
761	pot	SHEL bs	Rom?		4
762	tile	frag		y	2
763	pot	bs	Post-Rom?		3
764	pot	grey bs	Rom		1
765	pot	SHEL rim	Rom?		4
766	pot	grey bs	Rom		13
767	pot	grey bs	Rom		3
768	tile	frag		y	8
769	pot	grey bs	Rom		13
770	tile	frag		y	11
771	tile	frag		y	6
772	pot ?		Post-Rom?		5
773	tile	frag		y	4
774	tile	frag		y	74
775	pot	grey bs	Rom		1
776	tile	frag		y	1
777	tile	frag		y	28
778	tile	frag		y	38
779	tile	frag		y	6
780	metal	fe nail			6
781	pot	flake			1
782	pot	grey base	Rom		3
783	tile	frag		y	10
784	tile	frag		y	52
785	tile	frag		y	4
786	tile	frag		y	46
787	tile	frag		y	34
788	pot	OX bs			24
789	pot	grey bs	Rom		2
790	pot	grey bs	Rom		37
791	tile	frag		y	28
792	tile	frag		y	42
793	tile	frag		y	36
794	pot	OX bs	Rom?		3
795	pot	OX bs			8
796	tile	tegula	Rom		102
797	tile	frag		y	8
798	tile	frag		y	16
799	tile	frag		y	53
800	tile	frag		y	5
801	tile	frag		y	49
802	tile	frag		y	52
803	pot	grey J	Rom		5
804	pot	grey bs	Rom		6
805	pot	grey bs			2
806	tile	frag		y	14
807	tile	frag		y	37
808	tile	frag		y	37
809	pot	grey bs	Rom		6
810	tile	frag		y	64
811	tile	frag		y	64
812	tile	frag		y	17

LGW 97 (Greetwell) finds from fieldwalking

Finds No.	Category	Description	Date	Discard	Wt/gm
813	tile	frag		y	25
814	pot	grey bs	Rom		7
815	pot	glaze	Post-Rom		1
816	tile	frag		y	73
817	pot	grey bs	Rom		6
818	pot	glaze	Post-Rom		4
819	tile	frag		y	3
820	tile	frag		y	7
821	tile	frag		y	1
822	pot	bs	Post-Rom		7
823	pot	grey bs	Rom		9
824	pot	grey 2B handle	Rom		15
825	pot	grey bs	Rom		13
826	pot	OX rim B	Rom		9
827	tile	frag		y	5
828	pot	grey flake	Rom?		1
829	tile	frag		y	1
830	pot	grey chip	Rom		1
831	tile	frag		y	6
832	tile	frag		y	2
833	pot	grey bs	Rom		15
834	pot	grey rim	Rom		2
835	pot	glazed	Post-Rom		22
836	tile	frag		y	18
837	pot	grey bs	Rom		13
838	pot	grey bs	Rom		8
839	tile	frag		y	20
840	pot	grey bs	Rom		8
841	tile	frag		y	11
842	pot	grey bs	Rom		8
843	pot	grey bs	Rom		4
844	tile	frag		y	3
845	tile	frag		y	20
846	pot	grey bs	Rom		16
847	tile	frag		y	35
848	pot	OS bs BFB?	Rom		6
849	pot	OX bs	Rom?		3
850	tile	frag		y	7
851	pot	grey bs	Rom		30
852	tile	frag		y	13
853	tile	frag		y	6
854	pot	OX bs	Rom?		6
855	tile	frag		y	8
856	pot	grey bs	Rom		3
857	pot	OX bs	Rom?		3
858	tile	frag		y	8
859	tile	frag		y	1
860	pot	OX bs	Rom?		1
861	pot	glazed	Post-Rom		1
862	tile	frag		y	25
863	tile	frag		y	11
864	tile	frag		y	11
865	tile	frag		y	13
866	tile	frag		y	1
867	pot	base	Post-Rom		21
868	pot	grey bs	Rom		5
869	tile	frag		y	110
870	pot	grey bs	Rom		3

LGW 97 (Greetwell) finds from fieldwalking

Finds No.	Category	Description	Date	Discard	Wt/gm
871	pot	grey bs glaze	Post-Rom		5
872	tile	frag		y	72
873	pot	OX bs	Post-Rom?		4
874	pot	CC-BK base	L3-4 Rom		21
875	pot	grey bs	Rom		3
876	tile	frag		y	61
877	tile	frag		y	50
878	pot	grey B rim	Rom		7
879	tile	frag		y	3
881	pot	glaze		y	5
882	tile	frag		y	11
883	pot	grey JB rim	Rom		29
884	pot	grey JB rim	Rom		20
885	pot	DWSH-JDW	M3+ Rom		31
886	tile	frag		y	28
887	tile	frag		y	10
888	tile	frag		y	5
889	tile	frag		y	48
890	tile	frag		y	6
891	pot	grey bs	Rom		9
892	tile	frag		y	1
893	pot	OX bs		y	28
894	tile	frag		y	8
895	tile	frag		y	8
896	pot	grey flake?	Rom?		1
897	pot	grey bs	Rom		5
898	tile	frag		y	10
899	tile	frag		y	8
900	pot	grey DPR	Rom		14
901	tile	frag		y	36
902	tile	frag		y	49
903	pot	grey J	Rom		13
904	tile	frag		y	4
905	tile	frag		y	12
906	tile	frag		y	80
907	tile	frag		y	1
908	pot	grey bs	Rom		6
909	pot	OX bs	Post-Rom?		14
910	pot	OX bs	Post-Rom?		1
911	tile	frag		y	15
912	tile	frag		y	6
913	tile	frag		y	254
914	tile	frag		y	7
915	tile	frag		y	4
916	tile	frag		y	17
917	pot	grey base	Rom		16
918	tile	tegula	Rom		66
919	pot	grey bs	Rom		6
920	tile	frag		y	65
921	tile	frag		y	15
922	tile	frag		y	17
923	tile	frag		y	1
924	tile	frag		y	1
925	tile	frag		y	46
926	tile	frag		y	186
927	tile	frag		y	15
928	tile	frag		y	22
929	tile	frag		y	31

LGW 97 (Greetwell) finds from fieldwalking

Finds No.	Category	Description	Date	Discard	Wt/gm
930	tile	frag		y	53
931	pot	bs	Post-Rom?		21
932	pot	grey bs	Rom		7
933	tile	frag		y	1
934	pot	grey bs	Rom		1
935	pot	grey bs	Rom		18
936	tile	frag		y	4
937	tile	frag		y	23
938	tile	frag		y	1
939	tile	frag		y	3
940	tile	frag		y	9
941	tile	frag		y	2
942	tile	frag		y	1
943	tile	frag		y	2
944	pot	bs	Post-Rom?		6
945	tile	frag		y	54
946	tile	frag		y	37
947	tile	frag		y	106
948	tile	frag		y	1
949	tile	frag		y	20
950	tile	frag		y	37
951	tile	frag		y	113
952	tile	frag		y	47
953	pot	base glaze	Post-Rom		23
954	tile	frag		y	14
955	tile	frag		y	3
956	tile	frag		y	23
957	tile	frag		y	21
958	tile	frag		y	31
959	tile	frag		y	18
960	tile	frag		y	13
961	tile	frag		y	6
962	pot	OX bs	Post-Rom?		1
963	tile	frag		y	6
964	tile	frag		y	1
965	tile	frag		y	21
966	pot	grey bs	Rom		7
967	tile	frag		y	6
968	tile	frag		y	2
969	pot	grey bs	Rom		2
970	pot	grey bs	Rom		13
971	pot	chip	Rom		1
972	tile	frag		y	1
973	pot	SHEL bs	Rom?		6
974	pot	grey base	Rom		15
975	tile	frag		y	86
976	pot	grey bs	Rom		6
977	pot	grey bs	Rom		16
978	pot	grey bs	Rom?		17
979	tile	frag		y	1
980	pot	glaze bs	Post-Rom		2
981	pot	grey chip			1
982	tile	frag		y	1
983	tile	frag		y	7
984	tile	frag		y	40
985	tile	frag		y	24
986	tile	frag, burnt		y	38
987	tile	frag		y	12

LGW 97 (Greetwell) finds from fieldwalking

Finds No.	Category	Description	Date	Discard	Wt/gm
988	tile	frag		y	9
989	tile	frag		y	98
990	tile	frag		y	4
991	tile	frag		y	14
992	pot	glaze	Post-Rom		3
993	pot	handle	Post-Rom		22
994	tile	frag		y	4
995	tile	frag		y	2
996	tile	frag		y	22
997	tile	frag		y	1
998	tile	frag		y	6
999	tile	frag		y	5
1000	tile	frag		y	8
1001	tile	frag		y	3
1002	tile	frag		y	1
1003	tile	frag		y	45
1004	pot	grey bs	Rom		1
1005	pot	bs	Post-Rom		10
1006	tile	frag		y	3
1007	pot	grey bs	Rom?		8
1008	tile	frag		y	4
1009	pot	grey bs	Post-Rom?		2
1010	tile	frag		y	44
1011	pot	SAMCG bs	2-3 Rom		8
1012	tile	frag		y	22
1013	tile	frag		y	17
1014	tile	frag		y	60
1015	pot	SAMCG-FTRG	2 Rom		2
1016	tile	frag		y	56
1017	tile	frag		y	23
1018	tile	frag		y	1
1019	tile	frag		y	23
1020	tile	frag		y	132
1021	tile	frag		y	1
1022	tile	frag		y	53
1023	tile	frag		y	3
1024	tile	frag		y	3
1025	pot	cream bs	Post-Rom		13
1026	tile	frag		y	2
1027	tile	frag		y	1
1028	tile	frag		y	2
1029	tile	frag		y	4
1030	tile	frag		y	4
1031	tile	frag		y	7
1032	tile	frag		y	8
1033	pot	grey bs			4
1034	tile	frag		y	15
1035	tile	frag		y	5
1036	tile	frag		y	27
1037	tile	frag		y	15
1038	tile	frag		y	34
1039	tile	frag		y	17
1040	tile	frag		y	28
1041	tile	frag		y	10
1042	tile	frag		y	70
1043	pot	grey bs	Rom		45
1044	tile	frag		y	26
1045	pot	cream bs	Rom?		9

LGW 97 (Greetwell) finds from fieldwalking

Finds No.	Category	Description	Date	Discard	Wt/gm
1046	tile	frag		y	15
1047	pot	grey JLS	3-4 Rom		57
1048	tile	frag		y	31
1051	pot	grey bs	Rom		1
1052	metal	fe nail			7
1053	pot	OX bs	Rom?		4
1054	pot	glaze	Post-Rom		6
1055	pot	glaze handle	Post-Rom		219
1056	tile	frag		y	11
1057	tile	frag		y	10
1058	tile	frag		y	5
1059	tile	frag		y	22
1060	tile	frag		y	5
1061	tile	frag		y	8
1062	tile	frag		y	19
1063	tile	frag		y	16
1064	tile	frag		y	29
1065	pot	glaze	Post-Rom		7
1066	tile	frag		y	8
1067	tile	frag		y	5
1068	tile	frag		y	4
1069	tile	frag		y	5
1070	tile	frag		y	17
1071	pot ?		Post-Rom?		5
1072	pot	grey base	Rom		85
1073	tile	frag		y	16
1074	tile	frag		y	33
1075	tile	frag		y	9
1076	tile	frag		y	12
1077	tile	frag		y	8
1078	tile	frag		y	40
1079	tile	frag		y	4
1080	tile	frag		y	9
1081	tile	frag		y	10
1082	tile	frag		y	5
1083	tile	frag		y	2
1084	tile	frag		y	13
1085	tile	frag		y	17
1086	tile	frag		y	5
1087	tile	frag		y	23
1088	tile	frag		y	4
1089	tile	frag		y	4
1090	tile	frag		y	2
1101	tile	frag		y	6
1102	pot	SAMCG	2 Rom		1
1103	tile	frag		y	6
1104	pot	OX bs	Post-Rom?		7
1105	tile	frag		y	5
1106	tile	frag		y	8
1107	tile	frag		y	1
1108	tile	frag		y	7
1109	pot	OX-BK base	3 Rom		8
1110	tile	frag		y	7
1111	tile	glazed	Post-Rom		38
1112	tile	frag		y	58
1113	pot	bs	Post-Rom		8
1114	pot	grey BFL rim	M2 Rom		18
1115	pot	rim glaze	Post-Rom		15

LGW 97 (Greetwell) finds from fieldwalking

Finds No.	Category	Description	Date	Discard	Wt/gm
1116	pot	bs glaze	Post-Rom		14
1117	tile	frag		y	37
1118	pot	bs	Post-Rom		3
1119	pot	rim glaze	Post-Rom		21
1120	tile	frag		y	13
1121	tile	frag		y	25
1122	tile	frag		y	23
1123	tile	frag		y	61
1124	tile	frag		y	173
1125	tile	frag		y	18
1126	tile	frag		y	11
1127	pot	bs	Post-Rom		8
1128	pot	grey bs	Rom		2
1129	tile	frag		y	22
1130	tile	frag		y	27
1131	tile	frag		y	61
1132	tile	frag		y	5
1133	pot	OX bs			2
1134	tile	frag		y	31
1135	pot	grey bs	Rom		7
1136	tile	frag		y	6
1137	pot	OX bs			10
1138	tile	frag		y	15
1139	pot	OX base	Post-Rom		43
1140	tile	frag		y	33
1141	tile	frag		y	8
1142	tile	frag		y	17
1143	pot	OX base	Post-Rom		10
1144	tile	frag		y	61
1145	pot	bs	Post-Rom		14
1146	tile	frag		y	27
1147	pot	bs glaze	Post-Rom		4
1148	tile	frag		y	20
1149	pot	grey bs	Rom		24
1150	pot	OX bs			13
1151	tile	frag		y	11
1152	tile	frag		y	9
1153	tile	frag		y	6
1154	tile	frag		y	17
1155	pot	grey J	Rom		4
1156	tile	frag		y	15
1157	tile	frag		y	57
1158	pot	grey bs	Rom		12
1159	tile	frag		y	34
1160	slag				20



Fig. 1. Location of proposed quarry extension (reduced from 1:10,000 Ordnance Survey Map). Reproduced with permission of the Controller of HMSO. LAS Licence No. AL 50424A.

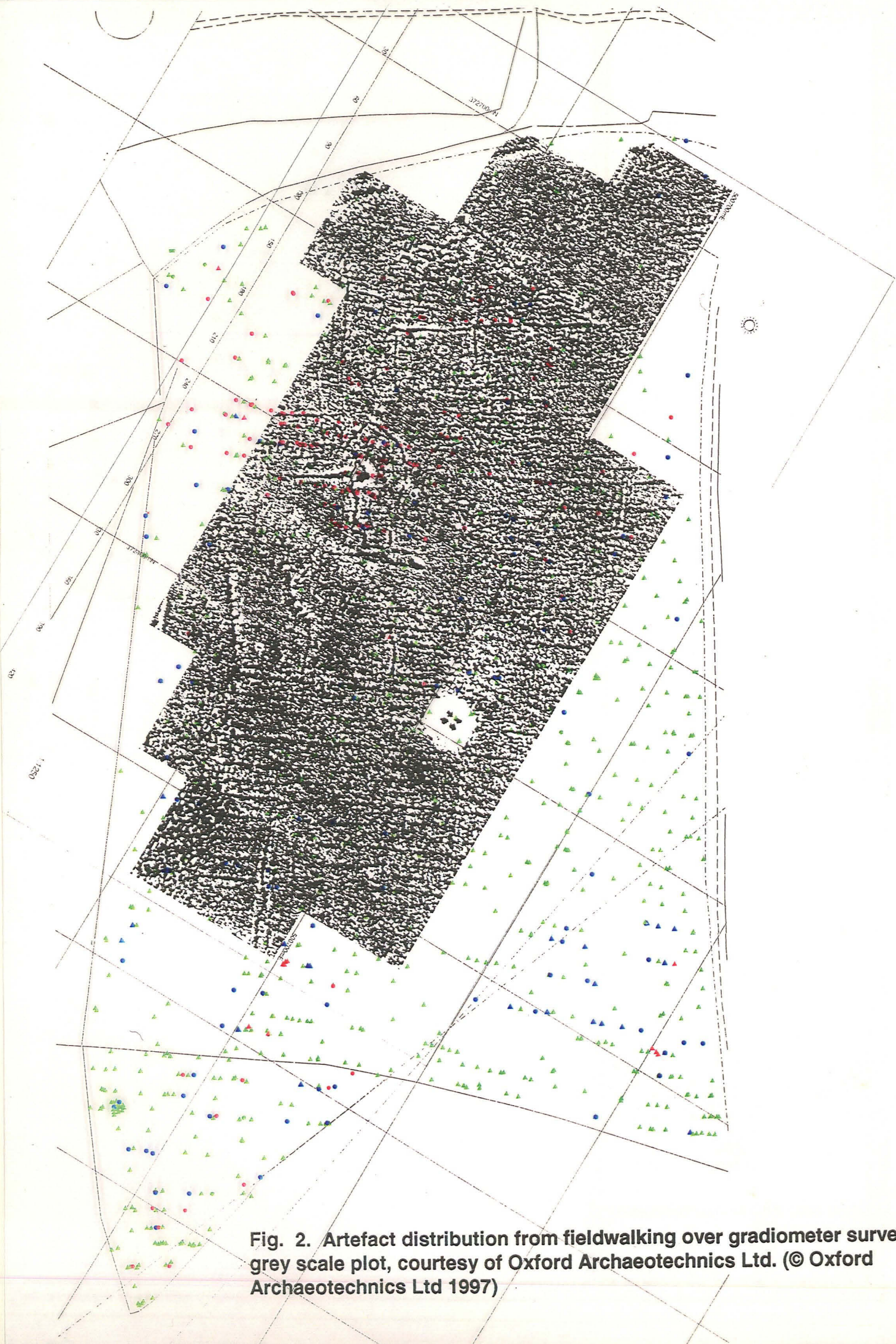

Fig. 2. Artefact distribution from fieldwalking over gradiometer survey : grey scale plot, courtesy of Oxford Archaeotechnics Ltd. (© Oxford Archaeotechnics Ltd 1997)



Notes

Find locations

- Roman Pottery
- Post Roman Pottery
- Undated Pottery
- ▲ Roman Tile
- ▲ Post Roman Tile
- ▲ Undated Tile
- ✱ Metal
- ✕ Slag

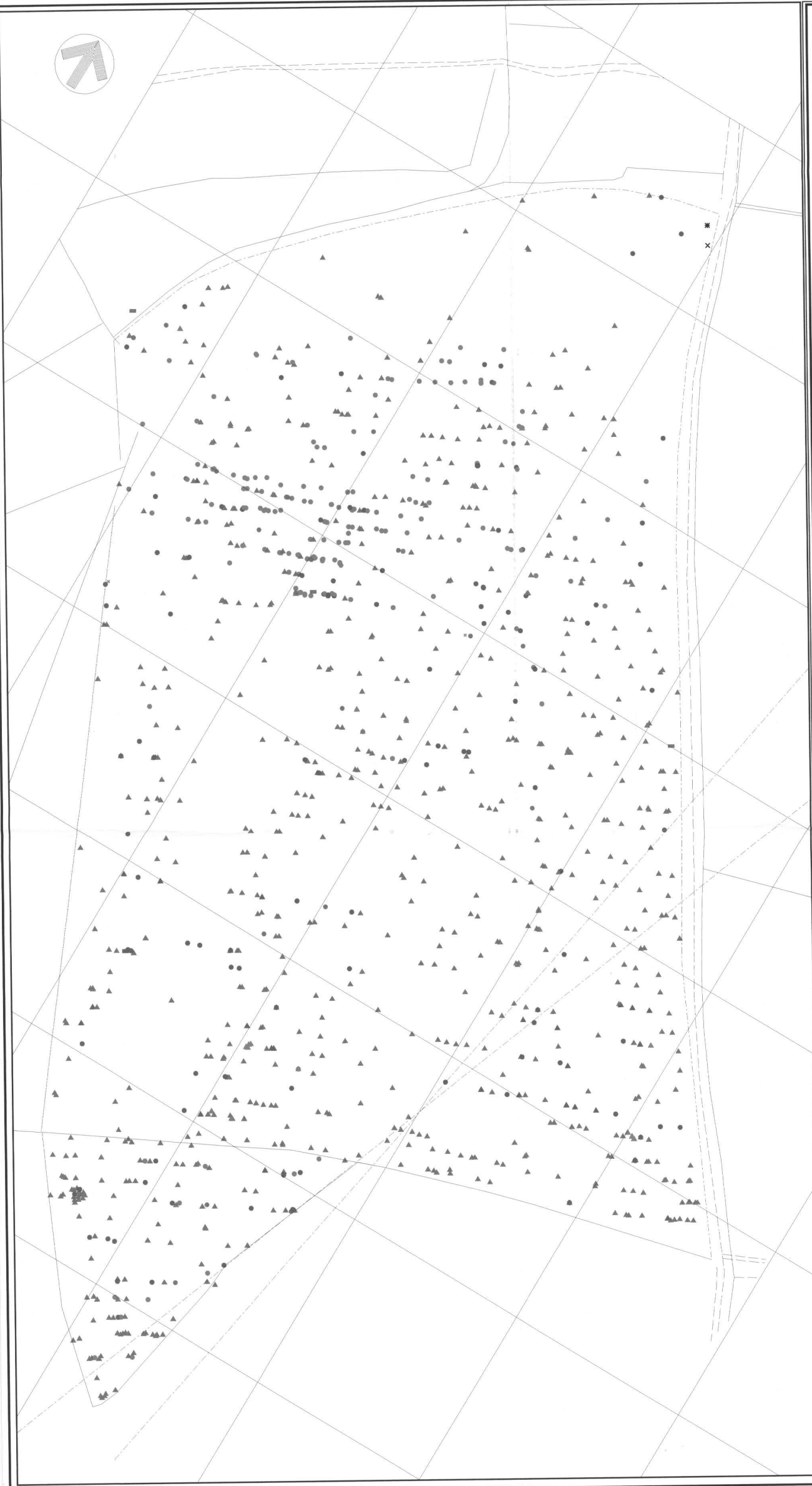

Land at
Greetwell Lincoln

Quarry Extension

Fig 3
Artefact Distribution
From Fieldwalking

Scale: 1:1000 Date: 20/10/97

Plot Ref: LAMSE90
LINDSEY ARCHAEOLOGICAL SERVICES

200 Alton Road
Barnby
Lincolnshire
LN22 6JY
Tel Fax: 01779 811887
email: 10012320@compuserve.com

M.S.E.
A Total Surveying Service