

**Den of Pitfodels, North Garthdee Farm, Garthdee Road, Aberdeen  
AB10 7EN  
Report on an archaeological evaluation  
and standing building survey**



**Cameron Archaeology  
18 January 2013**

## CONTENTS

1	INTRODUCTION.....	3
2	ARCHAEOLOGICAL BACKGROUND.....	4
3	STANDING BUILDING SURVEY.....	5
	Building 1.....	5
	Building 2.....	5
	Building 3.....	6
	Building 4.....	7
	Building 5.....	8
4	FIELD EVALUATION.....	9
5	REFERENCES.....	10
	APPENDIX 1 PHOTOGRAPHS.....	11
	Standing Building Survey.....	11
	Field Evaluation.....	15
	APPENDIX 2 MAPS.....	17

## ILLUSTRATIONS

Cover Top Trenches 1 (left) to 5 (right); Bottom Building 4 (left) and Building 2 (centre) with cobbled courtyard (foreground)

Illus 1	Location plan of site.....	3
Illus 2	Aerial photograph with the current site outlined in red.....	4
Illus 3	Plan of standing buildings.....	5
Illus 4	Building 1 the farmhouse; facing NE.....	6
Illus 5	Building 2; facing SW.....	6
Illus 6	Building 4; facing NNE.....	7
Illus 7	Building 4 facing NE showing original chimney breast and fireplace (centre).....	8
Illus 8	Building 5 NE wall remains; interior face of wall; facing NW.....	8
Illus 9	Plan showing evaluation trenches.....	9
Illus 10	Trench 7 facing SE showing culvert F1 at the lowest point of the trench.....	10
Illus 11	Plan showing camera points used in the standing building survey.....	14
Illus 12	First Edition Ordnance Survey extract with site in red.....	17
Illus 13	Second Edition Ordnance Survey extract with site in red.....	17
Illus 14	Third Edition Ordnance Survey extract with site in red.....	18

### Summary

A 7% archaeological evaluation and a Level 2 Standing Building Survey were carried out at the former North Garthdee Farm. No significant archaeological remains were uncovered during the evaluation and it is recommended that no further archaeological work is required during this current development.

# 1 INTRODUCTION

The site is located on the north side of Garthdee Road Aberdeen and includes Garthdee Farm and the lands to the west of the farm and east of the adjacent allotments; the former Deeside Railway line runs along the north edge of this site. The site is at AB10 7EN, NJ 91051 03344, at 30-36m OD and in the parish of Aberdeen (Illus 1).

BDW East Scotland Ltd has current planning applications P120390 for the proposed demolition of existing buildings and P120394 for demolition of existing buildings and erection of 60 dwellings (Illus 2) and both are both pending with Aberdeen City Council. There is a requirement for a Level 2 standing building survey and a 7-10% archaeological evaluation prior to construction; the standing building survey took place on 7-17th January and the evaluation on 16-17th January 2013.

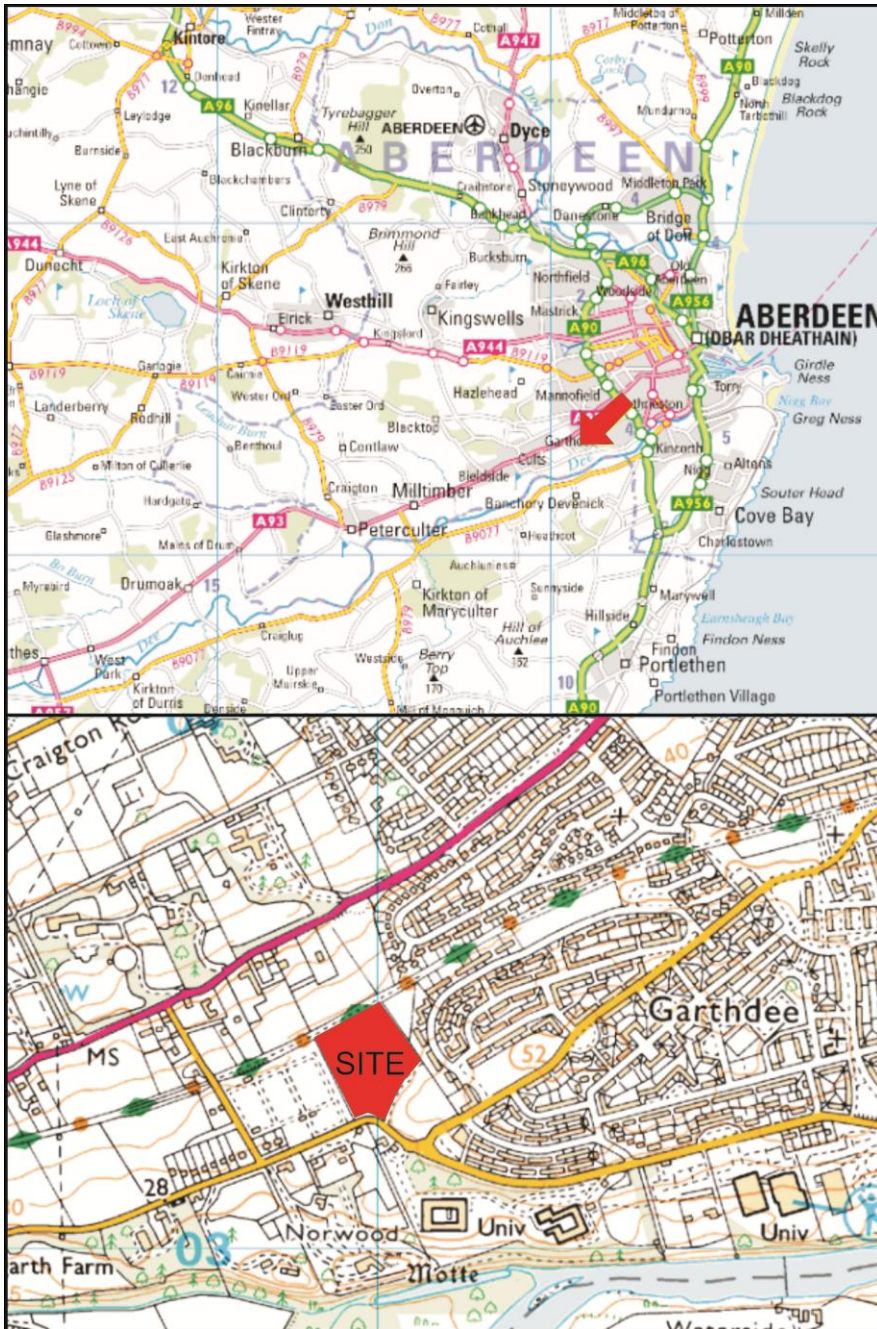

Illus 1 Location plan of site (Contains Ordnance Survey data © Crown copyright and database right 2012)



Illus 2 Aerial photograph with the current site outlined in red (*copyright Google*)

## 2 ARCHAEOLOGICAL BACKGROUND

- 2.1 The current site is occupied by North Garthdee Farm to the extreme east of the site and cultivated fields to the north and west (Illus 2). North Garthdee Farm was built in the late 19th century after the demolition of East Middleton (NJ90SW.183; outwith the current development, to the south) after the First Edition Ordnance Survey (Illus 12).
- 2.2 Several flint tools have been found in the area; a barbed and tanged arrowhead at 4 Gaitside Terrace (NJ90SW 19) and a barbed and tanged arrowhead, flint flake and scraper at 154 Deeside Gardens (NJ90SW 51).
- 2.3 200m south of the current development is a Scheduled Ancient Monument, Pitfodels Castle (NJ90SW.1), a possible motte or medieval castle mound. Small scale archaeological work in the vicinity has not been able to confirm this interpretation (Cameron 2002 unpublished report Site code E61).
- 2.4 A 19th-century house with a 17th-century plaque built into it was recorded prior to the construction of a new International School 400m NNW of the current development (Cameron 2008, 13) but no earlier remains were uncovered during the fieldwork.

### 3 STANDING BUILDING SURVEY

A standing building survey was carried out on 7-17 January 2013. There are the remains of five buildings which were constructed between the 1865 (First Edition OS; Illus 12) and 1901 (Second Edition OS; Illus 13). The current owner, Mr Gordon McWilliam, dates the construction to the 1860s and has title deeds indicating that this was Plot 3 sold by Banchory Devenick Estate in 1863; these documents were not available for viewing at the time of this work. Mr McWilliam knows of a fire which extensively damaged the property, particularly Building 5, in the 1960s after which much was rebuilt, Buildings 2 and 3 separated by a courtyard and concrete floors laid throughout. The cassettes were laid west of Building 4 at that time. The land itself has not been worked since the 1980s (G McWilliam pers com).

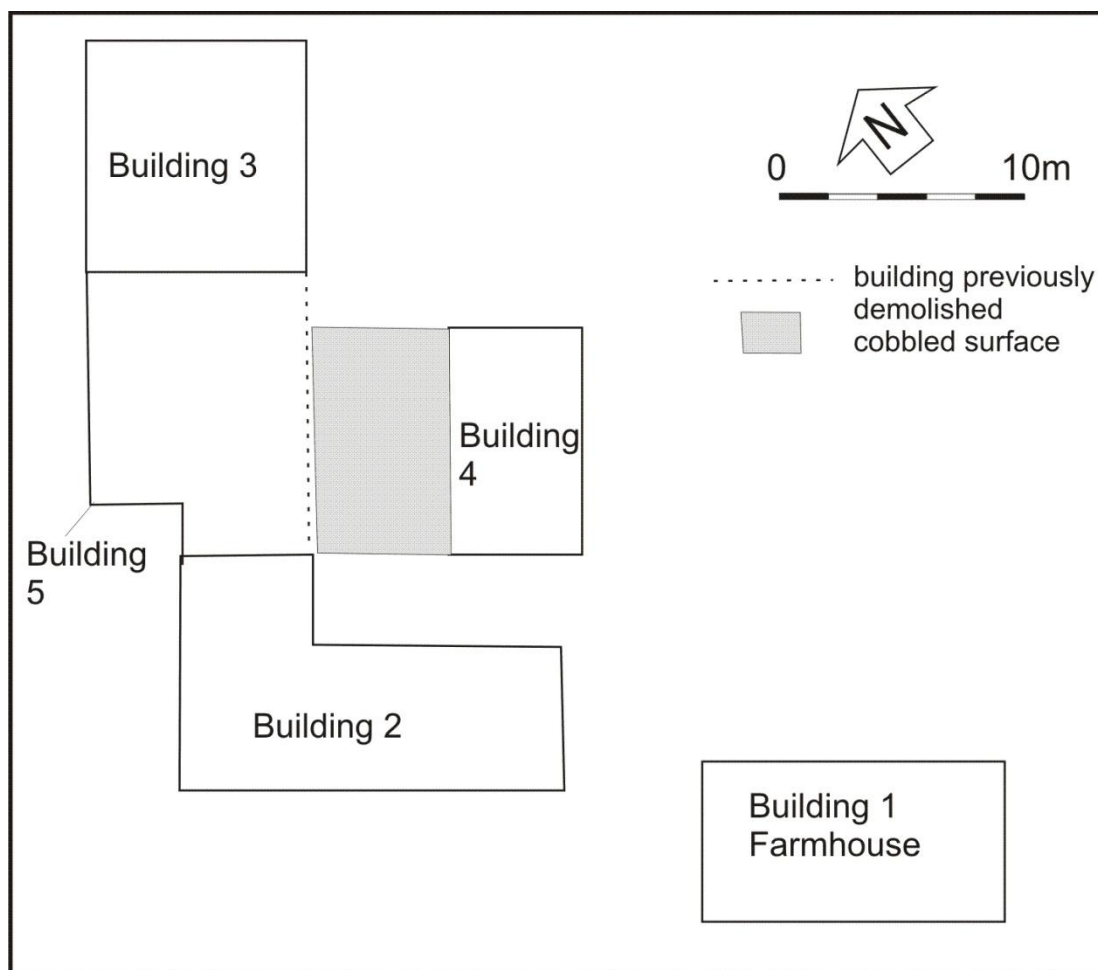

Illus 3 Plan of standing buildings

#### Building 1

Building 1 is the farmhouse (Illus 3, 4). It is double fronted and two and a half storeys and fronts on to the SW facing Garthdee Road and Inchgarth. It is constructed of large, mostly grey, granite blocks and is 11.90m long and 5.80m wide. It has a modern extension on the NE side but this appears to have replaced an older extension which can be seen on the OS maps.

#### Building 2

Building 2 is an L-shaped building at the west side of the farm courtyard. It is 5.6m wide and 14.9m long along the longest axis. It originally linked to Building 3 with the remains of Building 5. It is constructed of pink and grey granite blocks with heavily pointed cherry

cocking; the granite blocks are not random but the pink granite has been used for the wall ends and grey blocks for the mid walls (Illus 5).

### Building 3

Building 3 has been heavily rebuilt but is 5.3m wide and is constructed from random grey and pink granite blocks.



Illus 4 Building 1 the farmhouse; facing NE



Illus 5 Building 2; facing SW

## Building 4

Building 4 is 8.4m long and 5.2m wide, sited at the centre of the farmyard and is not connected to other buildings (Illus 6). It is made from random grey and pink granite blocks with cherry cocking. It is thought to have been the bothy or accommodation for farm staff before being converted into the milk house (G McWilliam pers comm). There is an original fireplace on the NE internal wall (Illus 7).



Illus 6 Building 4; facing NNE



Illus 7 Building 4 facing NE showing original chimney breast and fireplace (centre)



Illus 8 Building 5 NE wall remains; interior face of wall; facing NW

## Building 5

Building 5 has been mostly demolished leaving only the NW wall. It was originally sited between Buildings 2 and 3 (Illus 8). One door survives in the centre of the NW wall. This building was severely damaged by fire in the 1960s (G McWilliam pers comm) and much of the building was then taken down and some was rebuilt.



## 4 FIELD EVALUATION

Eight trenches were excavated on 16-17 January 2013 with a tracked machine and 1.8m ditching bucket. The subsoil was sand, clay and gravel and no significant archaeological features were identified. A culvert or stone drain (F1) ran across the centre of the site; it was set in a stone-filled palaeochannel but this was mainly left unexcavated. A small number of modern ploughmarks (F3) and a small bore ceramic drain (F2) were cut into the natural subsoil; details appear in archive.

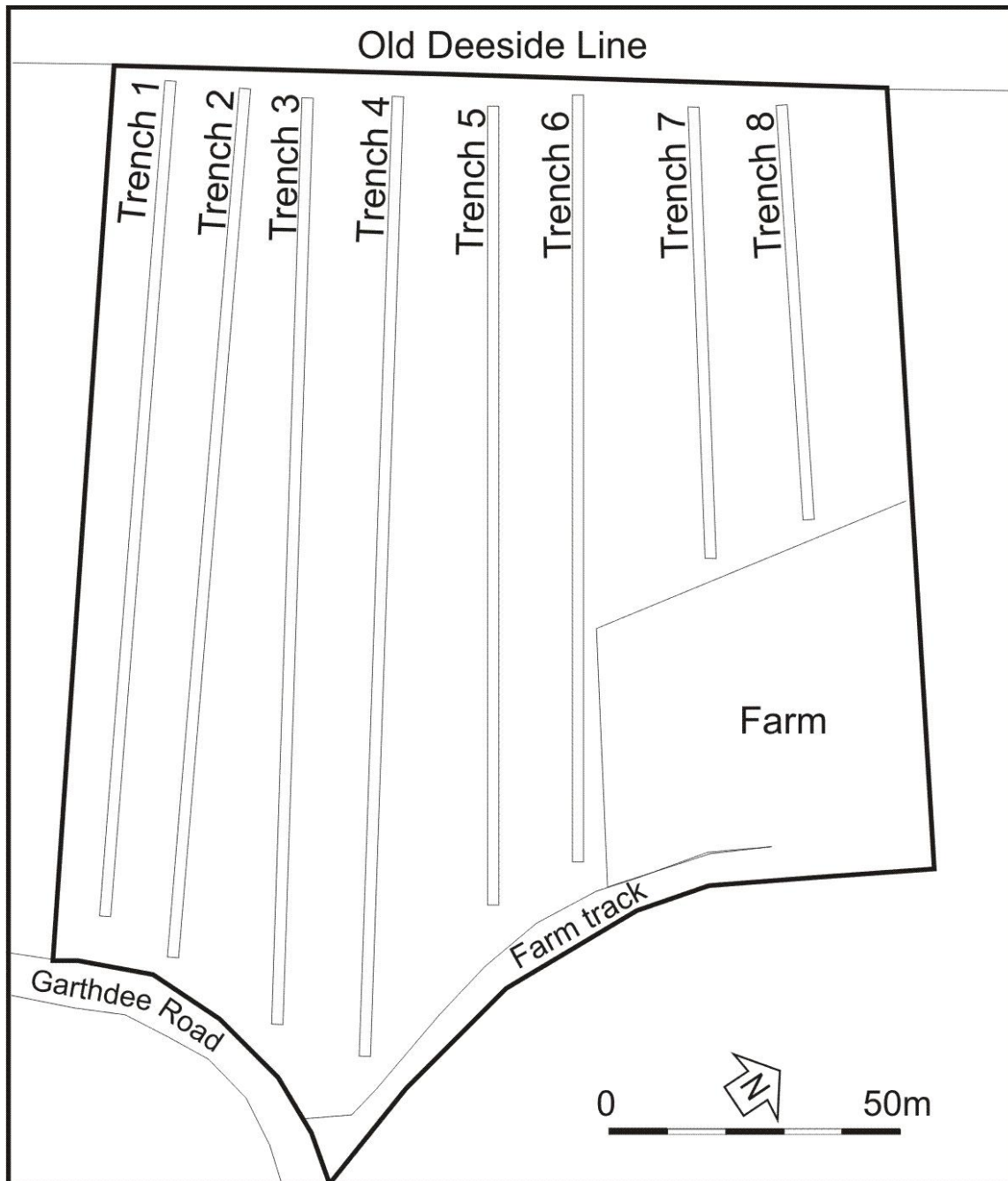

Illus 9 Plan showing evaluation trenches



Illus 10 Trench 7 facing SE showing culvert F1 at the lowest point of the trench

## 5 REFERENCES

- Cameron, AS 2002 Norwood Hall. Unpublished report, Aberdeen City Council (site code E61).  
Cameron, AS 2008 'Pitfodels House (Viewbank)', Discovery and Excavation for Scotland, New Series, Vol 9, 13.

## APPENDIX 1 PHOTOGRAPHS

### STANDING BUILDING SURVEY

Photo no	Description	Facing	Camera point
DSC_0792-798	Building 1 farmhouse SW facade	NE	1
DSC_0799-805	Building 1 farmhouse SW facade	N	2
DSC_0806-812	Building 1 farmhouse SW facade	E	3
DSC_0813-819	Building 1 farmhouse SW facade granite block detail	NE	4
DSC_0820-826	Building 1 farmhouse SW facade front door detail	NE	5
DSC_0827-832	Building 1 farmhouse NW wall	SE	6
DSC_0833-838	Building 1 farmhouse NW wall window detail	SE	7
DSC_0839-845	Building 1 farmhouse SE wall	NW	8
DSC_0846-853	Building 1 farmhouse	W	9
DSC_0854-860	Building 1 farmhouse	W	10
DSC_0861-867	Building 2	W	11
DSC_0868-874	Building 2	NW	12
DSC_0875-885	Building 2	S	13
DSC_0886-890	Building 2	S	14
DSC_0891-896	Building 2	SW	15
DSC_0897-902	Building 2	SW	15
DSC_0903-909	Building 5 SW wall interior face	W	13
DSC_0910-916	Building 5 SW wall interior face	NW	13
DSC_0917-923	Building 5 SW wall interior face door detail	NW	16
DSC_0924-925	Building 5 E wall interior face	E	13
DSC_0926-931	Building 3 SE wall	NW	17
DSC_0932-938	Building 3 SE wall door detail	NW	18
DSC_0939-944	Building 3 NE wall	W	19
DSC_0945-952	Building 3 NE wall	W	20
DSC_0953-958	Building 4 (left) Building 2 (centre) with cobbled surface	SW	17
DSC_0959-969	Building 4 NW facade	SE	21
DSC_0970-975	Building 4 NW facade window detail	SE	22
DSC_0976-981	Building 4 NW facade window detail showing drilled granite	SE	22
DSC_0982-990	Building 4 NW facade door detail	SE	23
DSC_0991-1002	Building 4	S	24
DSC_1003-1008	Building 4 SW wall	NW	15
DSC_1009-1014	Building 4	NW	11
DSC_1015-1021	Building 4 SE wall	NW	25
DSC_1022-1027	Building 4 SE wall door detail	NW	26
DSC_1028-1035	Building 4 N corner	SSE	27
DSC_1036-1042	farm complex	WNW	28
DSC_1043-1048	farm complex	WSW	28
DSC_1049-1054	Building 4	W	29
DSC_1055-1062	Farm from driveway	N	30



DSC_1753	Building 4	NE	31
DSC_1754	Building 4	NNE	31
DSC_1755	Building 4	W	31
DSC_1756	Building 4	NW	31

DSC_1757	Building 4	NW	31
DSC_1758	Building 2	W	32
DSC_1759	Building 2	NW	32
DSC_1760	Building 2	NNW	32
DSC_1761	Building 2	SW	33
DSC_1762	Building 2	NW	33
DSC_1763	Building 2	N	33
DSC_1764	Building 2	NE	33
DSC_1765	Building 3	NW	34
DSC_1766	Building 3	N	34
DSC_1767	Building 3	SE	34
DSC_1768	Building 3 roof beams reused from Craigellachie distillery mash room	ESE	34
DSC_1769	Building 3	NW	35
DSC_1770	Building 3	NNW	35
DSC_1771	Building 3	NE	35
DSC_1772	Building 3	SE	35
DSC_1773	Building 3	SE	35



DSC\_1753



DSC\_1754



DSC\_1755



DSC\_1756



DSC\_1757



DSC\_1758



DSC\_1759



DSC\_1760



DSC\_1761



DSC\_1762



DSC\_1763



DSC\_1764



DSC\_1765



DSC\_1766



DSC\_1767



DSC\_1768



DSC\_1769



DSC\_1770



DSC\_1771



DSC\_1772



DSC\_1773

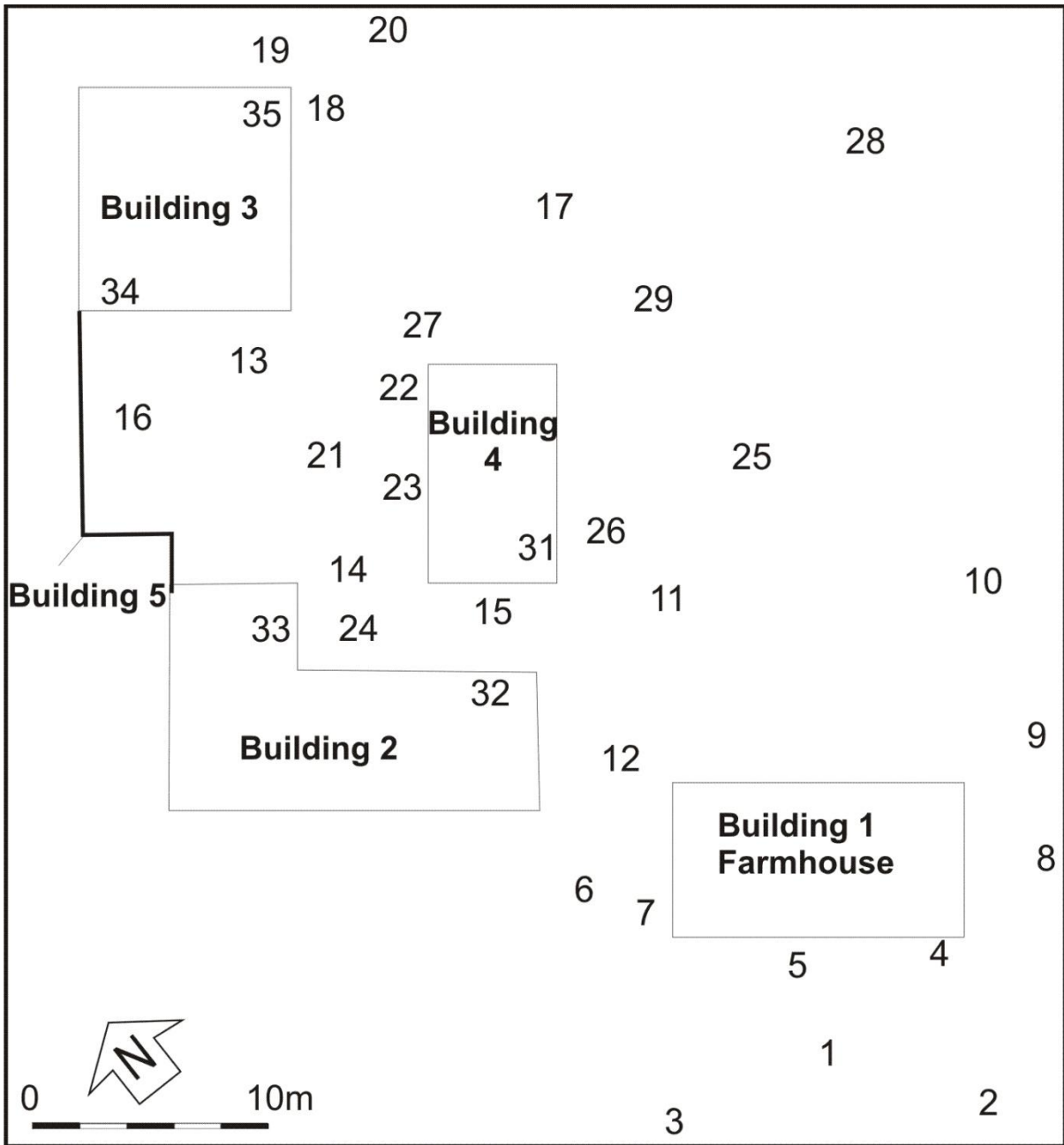

Illus 11 Plan showing camera points used in the standing building survey

# FIELD EVALUATION



DSC\_1487



DSC\_1488



DSC\_1501



DSC\_1502



DSC\_1514



DSC\_1525



DSC\_1526



DSC\_1534



DSC\_1544



DSC\_1545



DSC\_1556



DSC\_1557



DSC\_1568



DSC\_1569



DSC\_1576



DSC\_1588



DSC\_1603



DSC\_1604



DSC\_1624



DSC\_1625



DSC\_1635



DSC\_1641



DSC\_1647



DSC\_1654



DSC\_1658



DSC\_1668



DSC\_1669



DSC\_1677



DSC\_1684



DSC\_1702



DSC\_1709



DSC\_1716



DSC\_1717



DSC\_1724



DSC\_1731



DSC\_1738



DSC\_1744



DSC\_1749

Evaluation		
DSC_1478-1487	Tr 1-3	NW
DSC_1488-1501	Tr 4	NW
DSC_1502-1513	Tr 3	NW
DSC_1514-1525	Tr 2	NW
DSC_1526-1532	Tr 1	NW
DSC_1533-1538	Tr 1 ceramic pipe F2	SW
DSC_1539-1544	Tr 1 NW half	NW
DSC_1545-1550	Tr 1 NW half	NW
DSC_1551-1556	Tr 1	SE
DSC_1557-1562	Tr 1	SE
DSC_1563-1568	Tr 2, 3, 4 from NW end Tr 1	E
DSC_1569-1582	Tr 2	SE
DSC_1583-1590	Tr 3	SE
DSC_1591-1597	Tr 4	SE
DSC_1598-1611	Tr 4, 3, 2, 1	SW, SSW
DSC_1619-1624	Tr 5	NW
DSC_1625-1630	Tr 6	NW
DSC_1631-1637	Tr 7	NW
DSC_1638-1649	Tr 8	NW
DSC_1650-1662	TR 8 F1	NW
DSC_1663-1668	Tr 8	SE
DSC_1669-1674	Tr 8, 7, 6, 5	S
DSC_1675-1688	Tr 7	SE
DSC_1689-1699	Tr 6	SE
DSC_1700-1710	Tr 5	SE
DSC_1711-1716	Tr 5, 6, 7, 8	E
DSC_1717-1722	Tr 5, 6, 7, 8	NE
DSC_1723-1730	Tr 5 F1	SE
DSC_1731-1735	Tr 5 centre from mound east of site	NW
DSC_1736-1740	Tr 1 (left), 2, 3, 4 from mound east of site	WSW
DSC_1741-1746	Tr 6 (centre), 5, 4 (to left) from mound east of site	NW
DSC_1747-1752	Tr 5, 6, and farmhouse from mound east of site	NNW



## APPENDIX 2 MAPS



Illus 12 First Edition Ordnance Survey extract with site in red  
Kincardine Sheet IV.5 (Combined) Survey date: 1865 Publication date: 1868 (copyright National Library of Scotland)

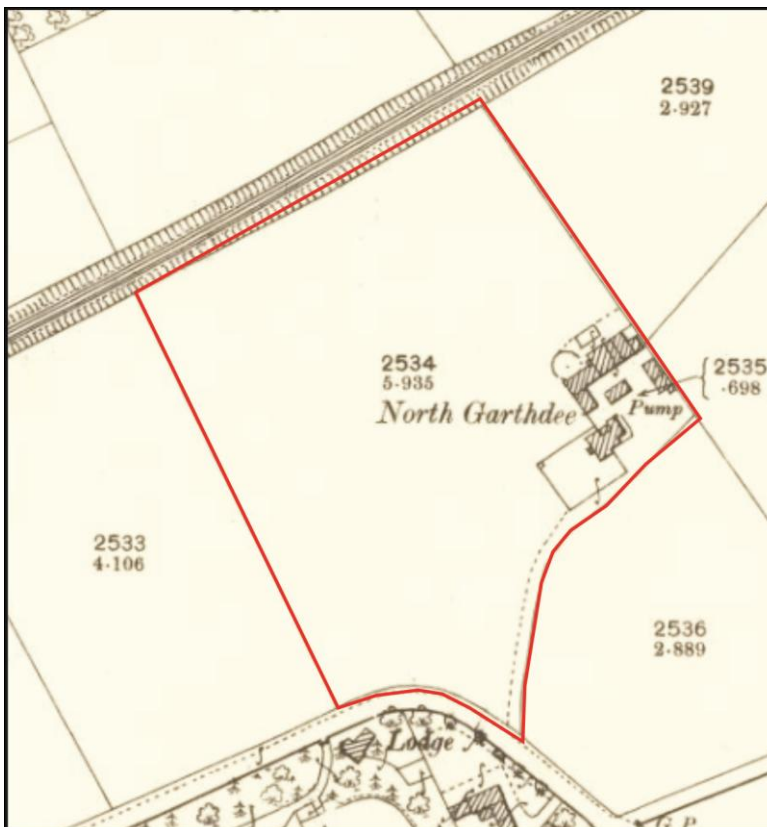

Illus 13 Second Edition Ordnance Survey extract with site in red Title: Kincardineshire, Sheet 007.02  
Publication date: 1901 Revised: ca. 1899 (copyright National Library of Scotland)

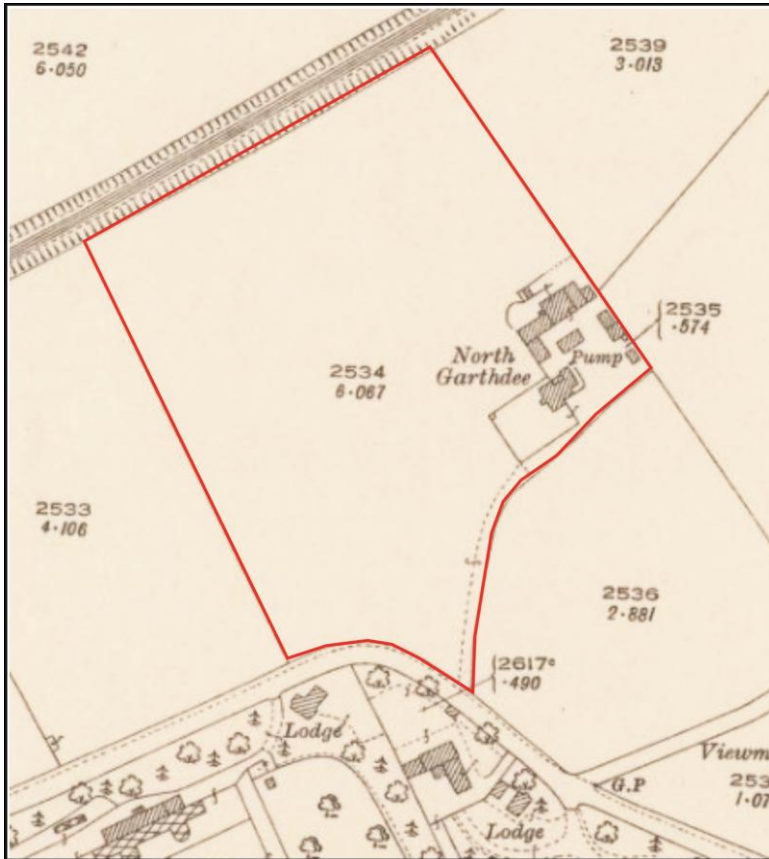

Illus 14 Third Edition Ordnance Survey extract with site in red  
Aberdeenshire, Sheet 086.02 Publication date: 1925 Revised: ca. 1923 Levelled: 1899 (copyright  
National Library of Scotland)