

Former Mill At Glencally, Glen Prosen, DD8 4RQ

Report on Level 1 Standing Building Survey



**Alison Cameron
Cameron Archaeology
4 August 2015**

CONTENTS

1	INTRODUCTION	3
2	BACKGROUND	4
3	THE LEVEL 1 STANDING BUILDING SURVEY	4
4	CONCLUSIONS AND RECOMMENDATIONS.....	9
5	ACKNOWLEDGEMENTS	10
	APPENDIX 1 MAPS.....	11
	APPENDIX 2 PHOTOGRAPHS	14

ILLUSTRATIONS

Cover: top mill from the E; facing W. Bottom mill wheel driveshaft *in situ*; facing SE

Illus 1	Location plan	3
Illus 2	Plan of mill structures recorded.....	4
Illus 3	Building elevations.....	5
Illus 4	Mill from the north; facing S	6
Illus 5	Mill from SE showing wheelhouse Room 3 (right); facing NW.....	6
Illus 6	Wheel pit F1 (not accessible) photographed through roof of Room 3; facing NW.....	7
Illus 7	Wheel driveshaft F2; facing SE.....	7
Illus 8	Interior Room 2; facing NE.....	8
Illus 9	Cartshed Room 1 SW facade with Doors D3 (left) and D4 (right); facing NE	8
Illus 10	Room 4 wall F3; facing NW.....	9
Illus 11	Phase plan.....	9
Illus 12	Pont map showing approximate area of Cally Mill.....	11
Illus 13	Gordon map of 1636-52 with 'Glencaly'	11
Illus 14	1 st Edition Ordnance map showing mill (bottom right) opposite dam.	12
Illus 15	2 nd Edition OS map showing mill (bottom right) opposite dam.	12
Illus 16	3 rd edition Ordnance Survey map showing mill (bottom right).	13
Illus 17	Camera points used in this survey	14

SUMMARY

A Level 1 standing building survey was carried out on 28 July 2015. The original early 19th century L-shaped mill was extended prior to the 2nd Edition OS map (Illus 11) with an extension to the NW which was later demolished leaving a low walled enclosure (Room 4). An extension was also added to the SW and again this was demolished leaving tying in stones on the SW gable. A room added to the centre of the mill in the L between Rooms 1 and 2 was demolished prior to this survey. It is recommended that no further archaeological work is required during the current planning application.

1 INTRODUCTION

- 1.1 The site (Illus 1) is located on the SW side of the Cortachy to Glenprosen Village Road north of Tulloch Hill. It is centred on NGR NO 35720 62970, at 240-250m OD (Illus 1) and in the parish of Cortachy and Clova.
- 1.2 The work was commissioned by John Boath. A planning application 15/00367/FULL was passed by Angus Council on 12 June 2015. Condition 1a is a requirement for a Level 1 standing building survey.
- 1.3 All the archaeological work was carried out in the context of Scottish Planning Policy (SPP) Planning Advice Note (PAN 2/2011) and Scottish Historic Environment Policy (SHEP), which state that archaeological remains should be regarded as part of the environment to be protected and managed.

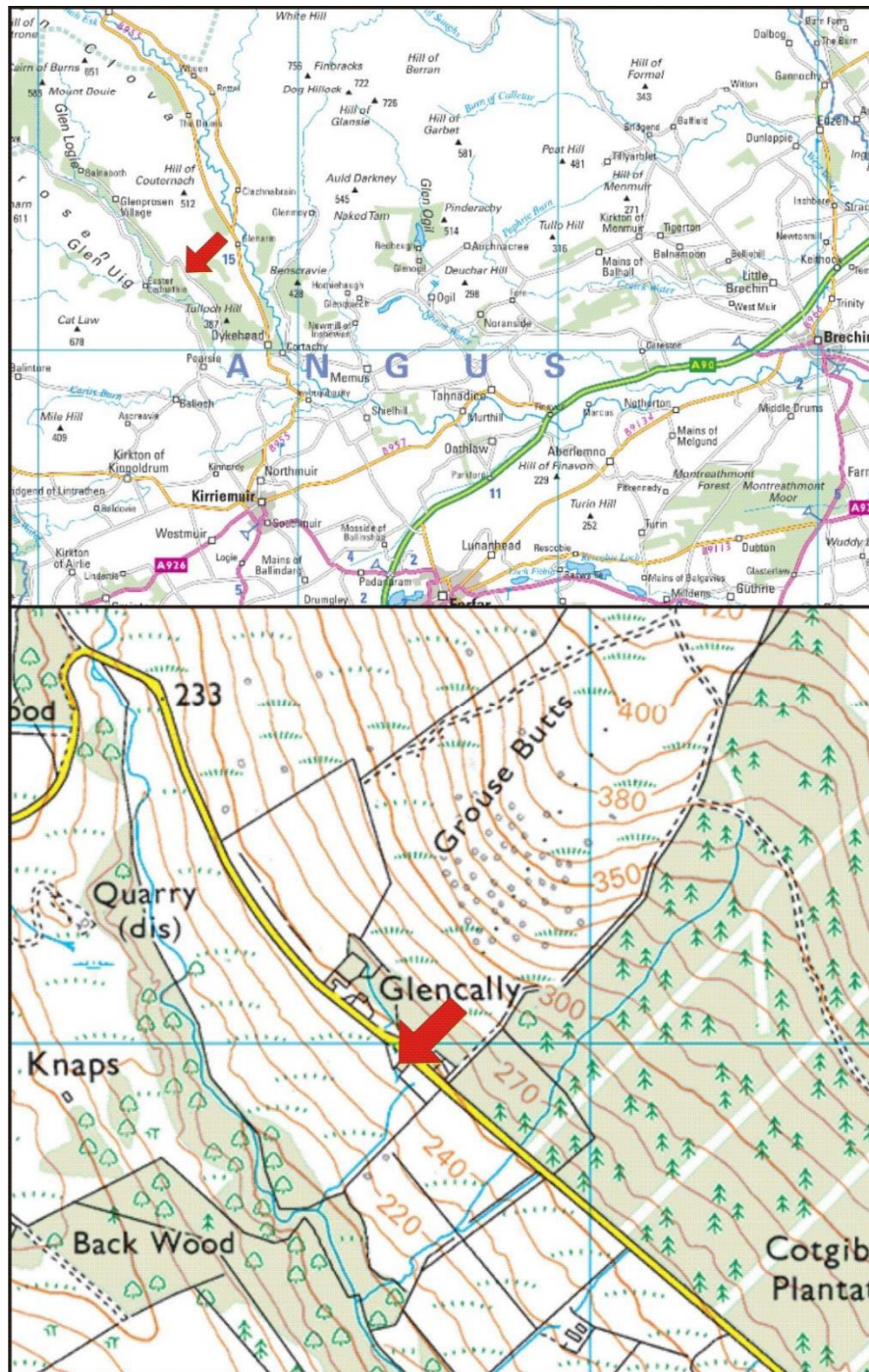

Illus 1 Location plan (Contains Ordnance Survey data © Crown copyright and database right 2015)

2 BACKGROUND

The remains of a mill are depicted on historic OS maps (NO36SE0057; Illus 14-16). The 1st edition shows two L-plan structures, the western one with attached enclosures to the north. To the southeast is a dam and mill pond and an L-plan mill. By the time of the 2nd edition the mill building to the southeast has been altered and extended. The mill is now ruinous and the mill pond has been infilled (Aberdeenshire SMR online).

3 THE LEVEL 1 STANDING BUILDING SURVEY

A level 1 standing building survey was carried out on 28 July 2015; the weather was bright and sunny. Architects plans were checked and drawings of all the major elevations were made.

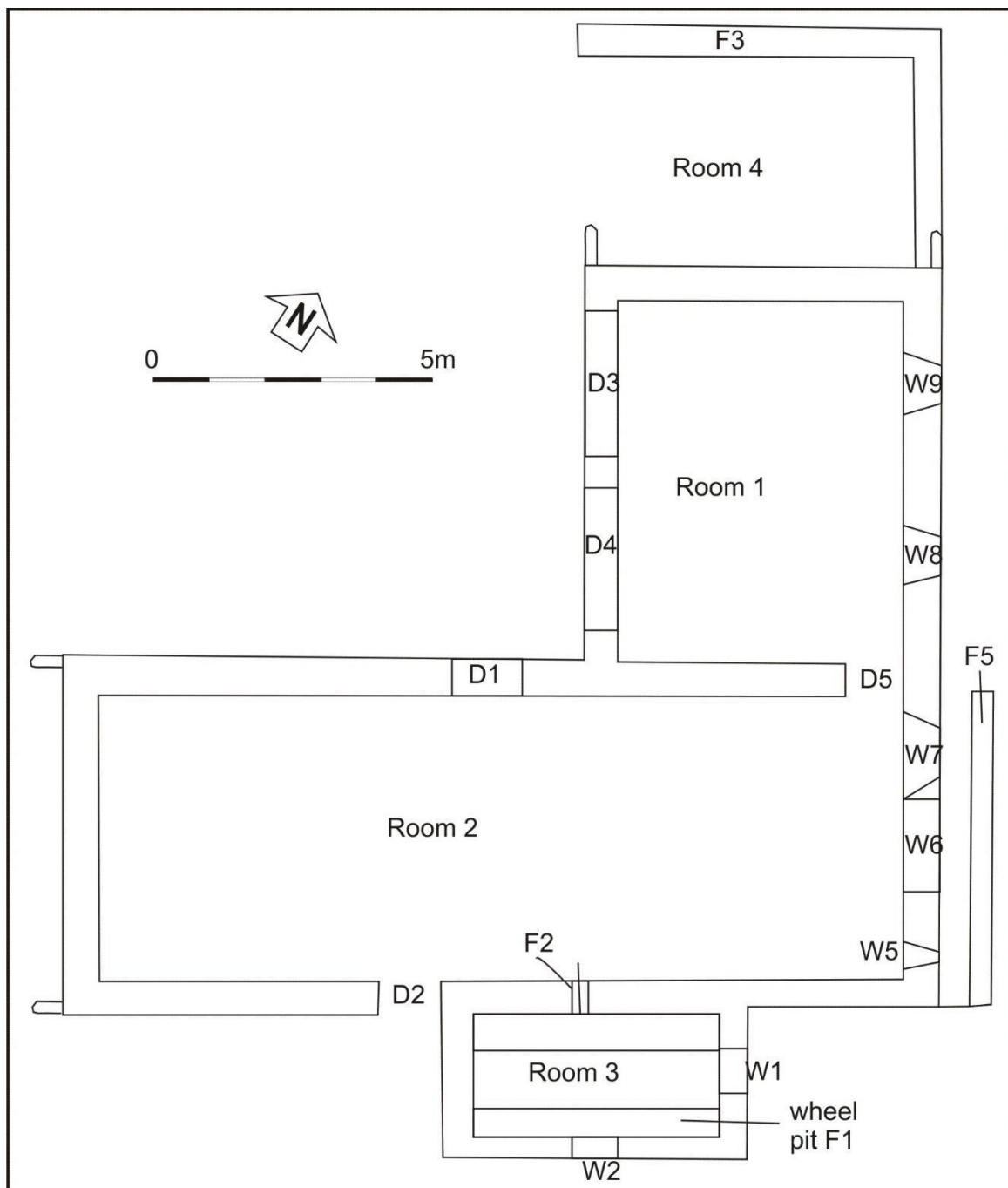

Illus 2 Plan of mill structures recorded (From Copyright Bell Ingram Design)

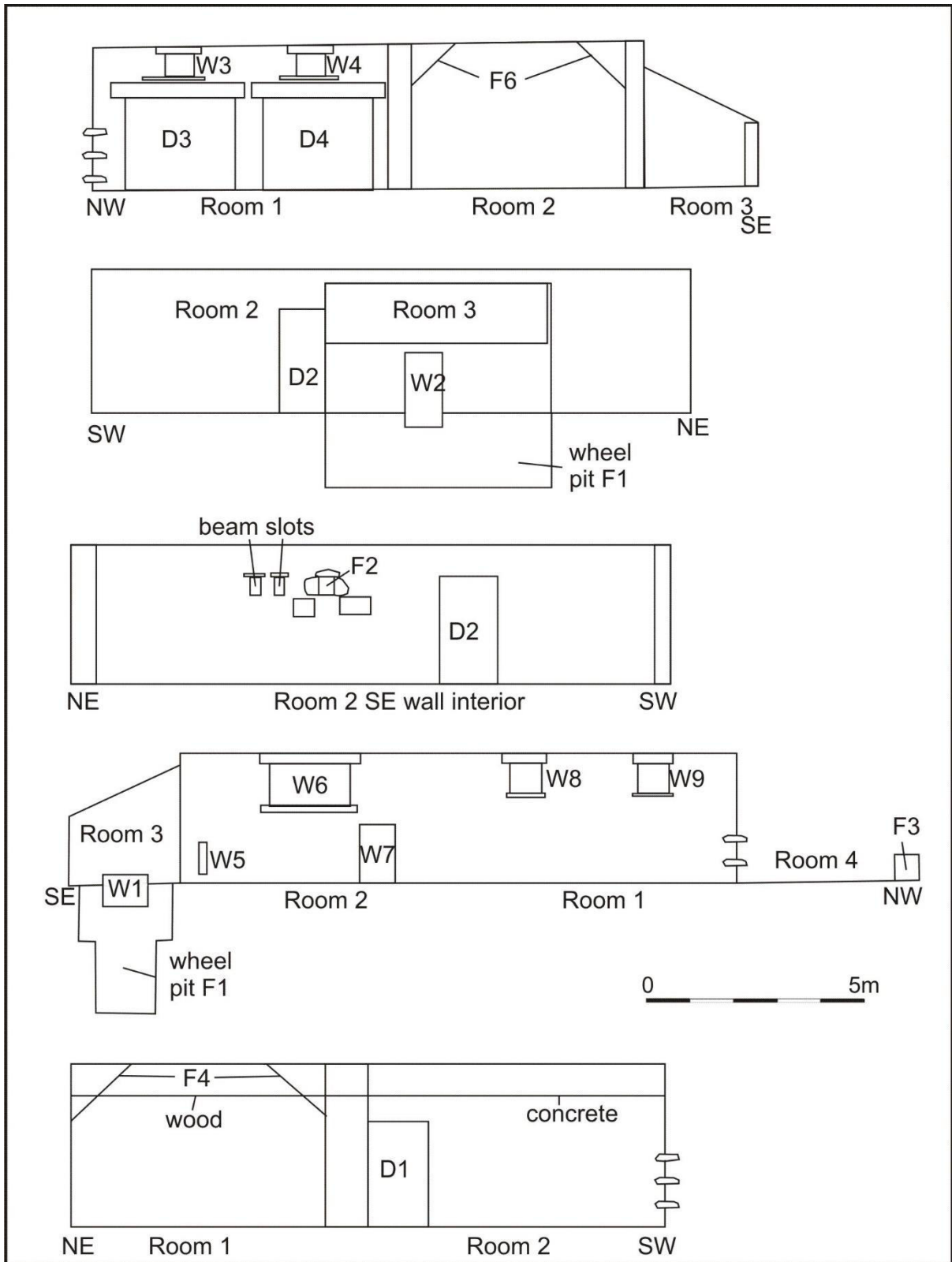

Illus 3 Building elevations

Phase 1

The Phase 1 mill is 13m NW-SE and 13.9m NE-SW and consisted of three rooms. The buildings are constructed of granite and sandstone rubble with granite lintels, quoins and jambs except Room 1 cart doors D3 and D4 which has red sandstone lintels (both cracked; Illus 9) on the SW façade. Room 2 is the main mill and Room 3 the wheelhouse (Illus 4, 5). Room 2 has doors in the NW and SE walls and the driveshaft mechanism for the wheel

survives in the SE wall (F2; Illus 7). The walls of the main building are 0.6m thick and Room 3 the wheelhouse has walls 0.55m thick. Roofs survive only on the wheelhouse which is in a poor condition.



Illus 4 Mill from the north; facing S



Illus 5 Mill from SE showing wheelhouse Room 3 (right); facing NW



Illus 6 Wheel pit F1 (not accessible) photographed through roof of Room 3; facing NW

The wheel pit (F1) is a maximum of 4.9m deep (from the wall-head) and is contained in a slate roofed building added on to the SE wall of Room 2. An aperture through the wall (F2) is 0.5 x 0.5m in size houses the cast iron driveshaft for the mill wheel (Illus 7); the wheel has been removed.



Illus 7 Wheel driveshaft F2; facing SE



Illus 8 Interior Room 2; facing NE

Beam slots on the NW and SE walls of Room 2 and upper windows throughout indicate that the mill had a first floor throughout.



Illus 9 Cartshed Room 1 SW facade with Doors D3 (left) and D4 (right); facing NE



Illus 10 Room 4 wall F3; facing NW

4 CONCLUSIONS AND RECOMMENDATIONS

A Level 1 standing building survey was carried out on 28 July 2015. The original early 19th century L-shaped mill was extended prior to the 2nd Edition OS map (Illus 11) with an extension to the NW which was later demolished leaving a low walled enclosure (Room 4). An extension was also added to the SW and again this was demolished leaving tying in stones on the SW gable. A room added to the centre of the mill in the L between Rooms 1 and 2 was demolished prior to this survey. It is recommended that no further archaeological work is required during the current planning application.

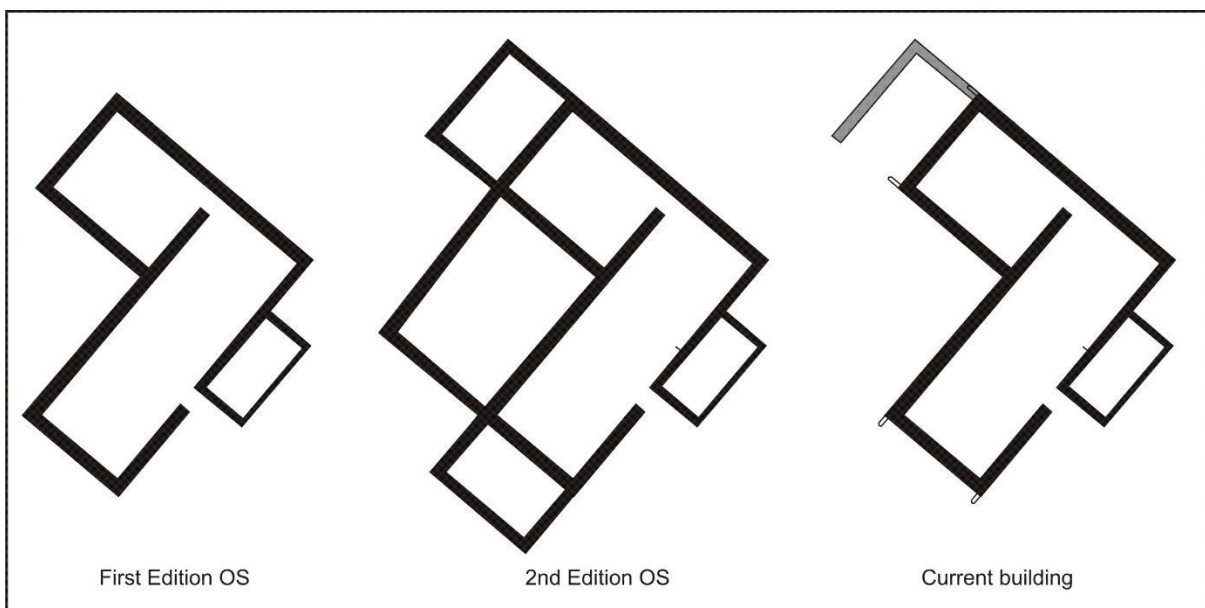

Illus 11 Phase plan

5 ACKNOWLEDGEMENTS

Thanks to John Boath for commissioning this project and to Claire Herbert for her advice during the work.

Cameron Archaeology
45 View Terrace
Aberdeen
AB25 2RS
01224 643020
07581 181057
cameronarch@btinternet.com
www.cameronarchaeology.com
Company registration no 372223 (Scotland)
VAT registration no 990 4373 00

APPENDIX 1 MAPS

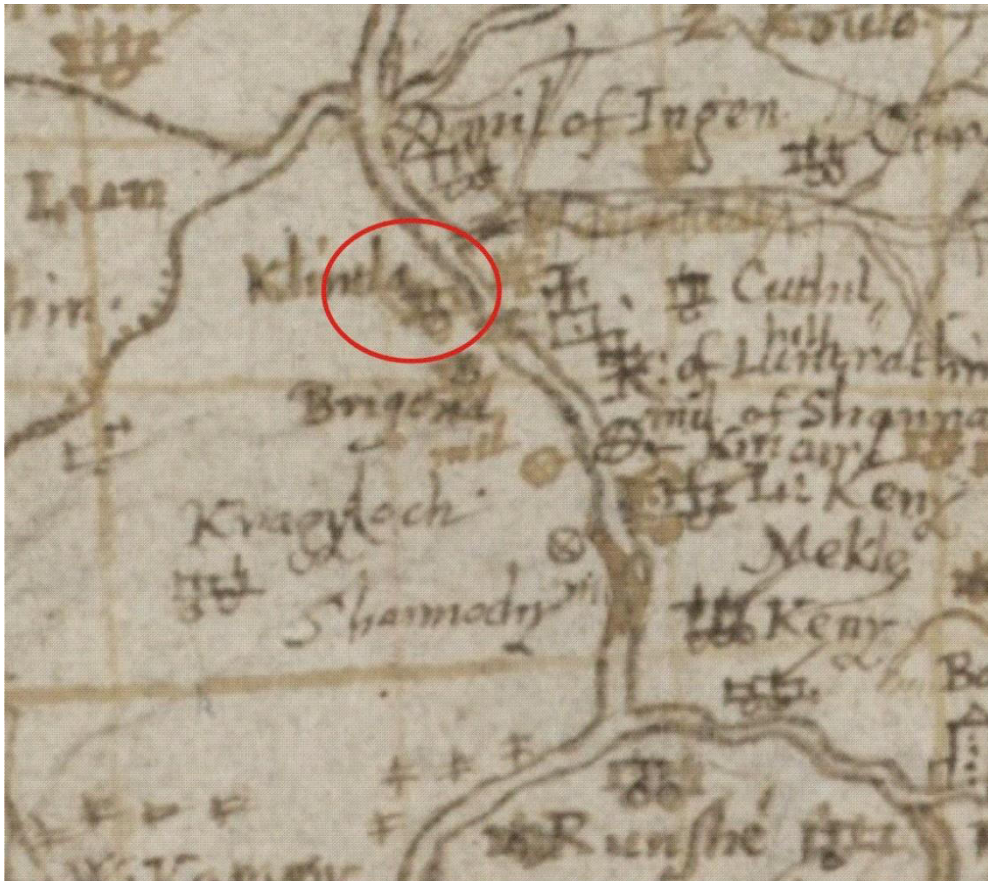

Illus 12 Pont map showing approximate area of Cally Mill (copyright National Library of Scotland)



Illus 13 Gordon map of 1636-52 with 'Glencaly' (copyright National Library of Scotland)

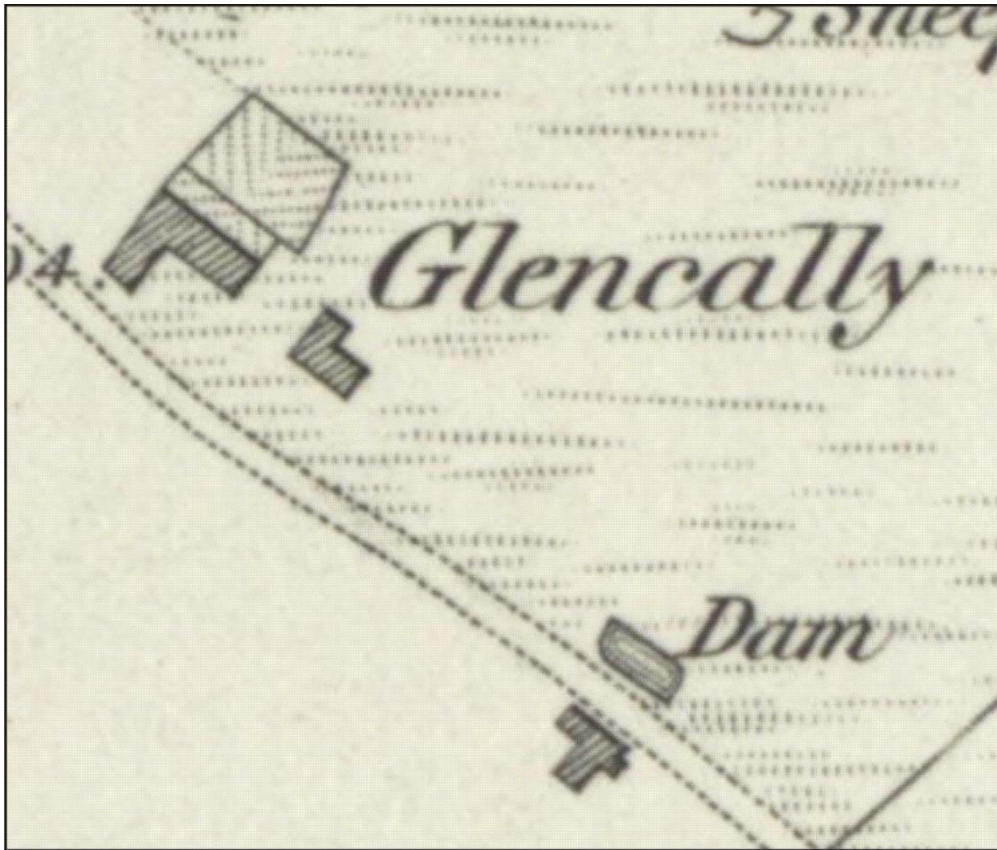

Illus 14 1st Edition Ordnance map showing mill (bottom right) opposite dam. Forfarshire, Sheet XXIV (includes: Cortachy And Clova; Kingoldrum; Lintrathen) Survey date: 1862 Publication date: 1865 (copyright National Library of Scotland)

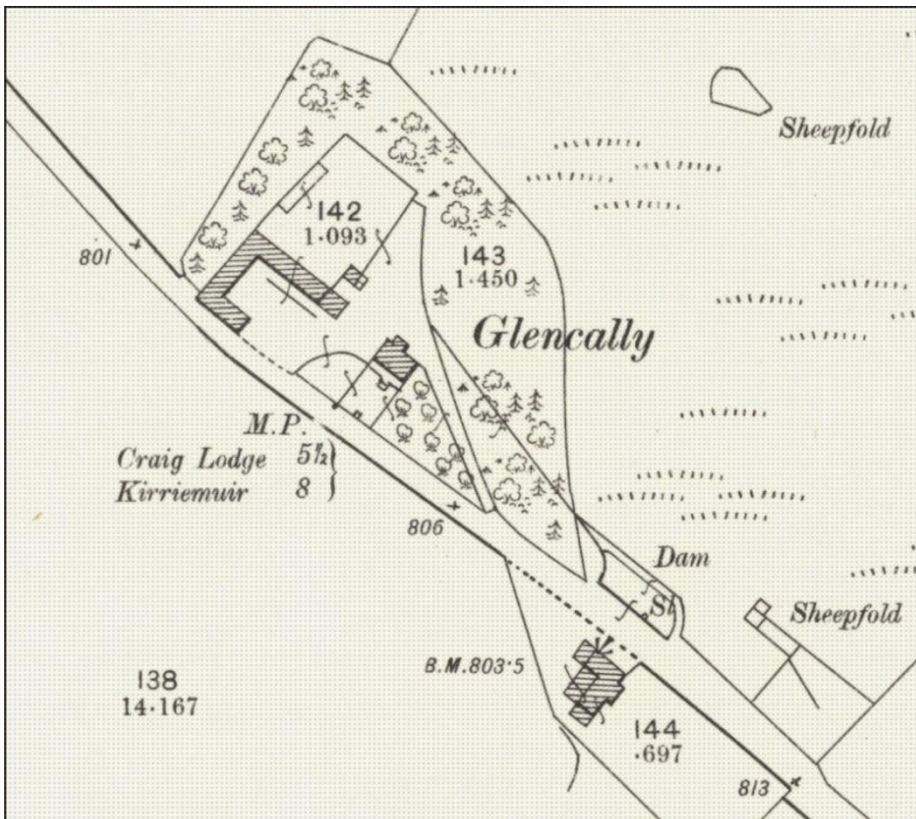

Illus 15 Second Edition OS map showing mill (bottom right) opposite dam. Forfarshire 024.07 (includes: Cortachy and Clova) Publication date: 1901 Revised: ca. 1900 (copyright National Library of Scotland)

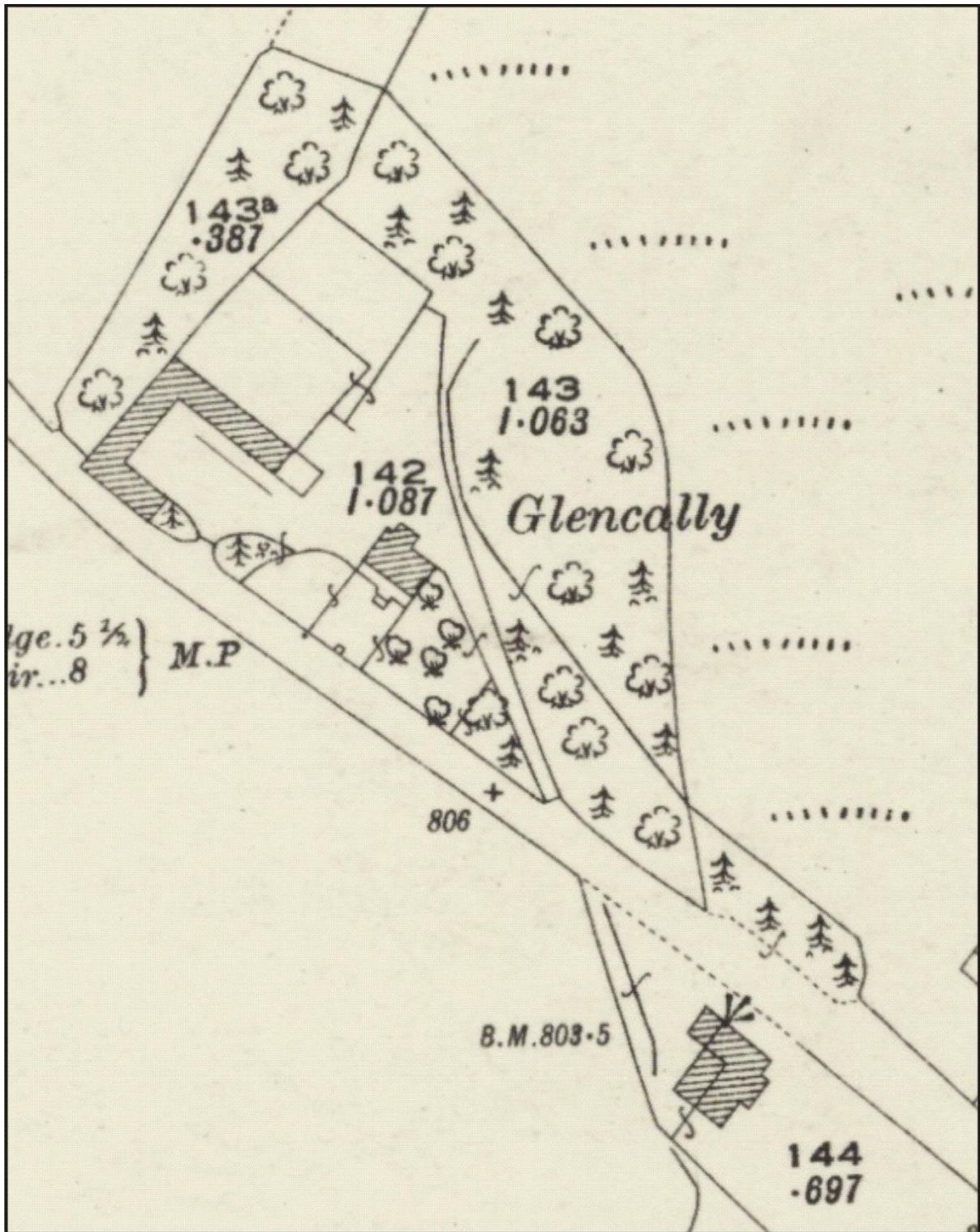

Illus 16 3rd edition Ordnance Survey map showing mill (bottom right). Forfarshire 024.07 (includes: Cortachy and Clova) Publication date: 1924 Revised: ca. 1922 Levelled: 1901 (copyright National Library of Scotland)

APPENDIX 2 PHOTOGRAPHS

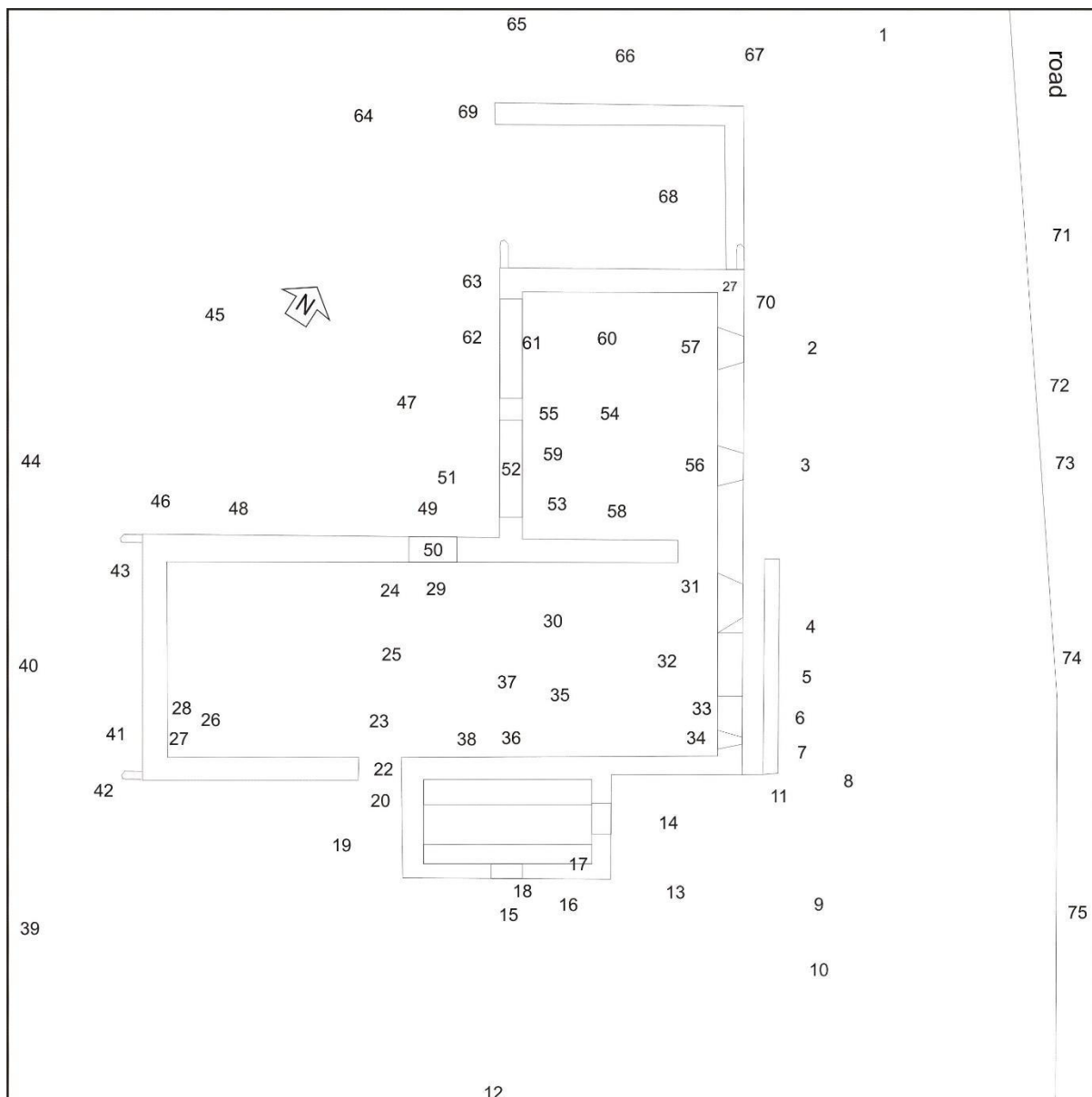

Illus 17 Camera points used in this survey

Photo no	Description	Facing	
DSC_0502-3	N corner of former mill	S	1
DSC_0504	NE wall with window W9 and OS bench mark (bottom right)	SW	2
DSC_0505	NE wall with window W9 (right) and W8 (left)	SW	3
DSC_0506	NE wall with window W6 (left)	SW	3
DSC_0507	NE wall with window W9 (centre) D7 (bottom left) W5 (left of ranging rod)	SW	4
DSC_0508-9	W6	SW	5
DSC_0510	W7	SW	6
DSC_0511	W5	SW	7
DSC_0512	Wall and bank F5 parallel to NE wall of mill	NW	7

DSC_0513	Wall and bank F5 parallel to NE wall of mill	SW	7
DSC_0514	Detail of stonework	SW	6
DSC_0515	NE wall of Mill	W	8
DSC_0516-7	Mill from E	W	9
DSC_0518	E corner quoins	W	10
DSC_0519-20	E corner quoins	NW	11
DSC_0521-6	SE wall	NW	12
DSC_0527	SE wall Room 2 with Room 3 (left)	NW	13
DSC_0528	NE wall Room 3 with W1 (bottom, covered with rubble)	SW	14
DSC_0529	Room 3 SE wall with W2 (centre)	NW	15
DSC_0530	Roof slate detail	NW	16
DSC_0531	Slated roof Room 3	NW	16
DSC_0532-41	Interior Room 3 through gap in roof (no other access)	NW/WNW/W	17
DSC_0542-3	Window W1 interior through gap in the roof	NNE	17
DSC_0544-5	Interior Room 3 through gap in roof (no other access) showing wheel pit	NW	17
DSC_0546-8	W2	NW	18
DSC_0549-51	SW wall Room 3	NE	19
DSC_0552-3	D2	NW	20
DSC_0554	SE wall Room 2 with D2	NW	21
DSC_0555	D2 lintel	NW	20
DSC_0556	D2 details	W	22
DSC_0556-60	D2 details	SW	22
DSC_0561-2	D2 interior	SE	23
DSC_0563	D2 lintel	SE	23
DSC_0564	D2 and interior SE wall Room 2	SE	24
DSC_0565	Room 2 SW wall	SW	25
DSC_0566	Room 2 SW wall	SW	26
DSC_0567	Room 2 SW wall	SW	23
DSC_0568-9	Room 2	NE	26
DSC_0570-1	Stonework detail	SW	27/28
DSC_0572-3	D1	NW	29
DSC_0574	Room 2 NW wall interior with D1 (right)	WNW	23
DSC_0575	Room 2 NW wall interior with D1 (centre)	NW	23
DSC_0576	Room 2 NW wall interior with D1 (left)	NNE	23
DSC_0577-9	D1	W	29
DSC_0580	D1	NNE	29
DSC_0581	Room 2 NW wall interior with D1 (left)	NNE	25
DSC_0582	Room 2 D1 (right) D2 (left)	SW	30
DSC_0583	Room 2 NW wall with D1	W	30
DSC_0584	Room 2 NW wall with D5 (right)	NW	32
DSC_0585-6	Room 2 NW wall showing beam slots	NW	32
DSC_0587-90	D5	NW	31
DSC_0591	Room 2 SE wall with F2 (centre)	SSW	31
DSC_0592	Room 2 SE wall with F2 (centre)	S	31

DSC_0593-4	Room 2 NE wall with W7 (left) and W5 (right); W6 above (hidden partly by joists)	NE	30
DSC_0595	W7	NE	32
DSC_0596	W6	NE	33
DSC_0597	W7 detail	N	32
DSC_0598	W5 interior	NE	34
DSC_0599-601	Room 2 SE wall showing hoist holes	SE	32
DSC_0602-3	Room 2 SE wall showing hoist holes	S	32
DSC_0604	Room 2 SE wall showing hoist holes and voids above	SE	35
DSC_0605-8	F2 waterwheel drive shaft aperture with iron fitting in situ	SE	36
DSC_0609-10	F2 waterwheel drive shaft aperture with iron fitting in situ	E	37
DSC_0611-14	F2 waterwheel drive shaft aperture with iron fitting details	SE/S	35/36
DSC_0615-19	F2 waterwheel drive shaft aperture with iron fitting in situ	SE	36
DSC_0620	Room 2 SE wall F2 waterwheel drive shaft aperture with iron fitting in situ	ESE	25
DSC_0621	Room 2 SE wall D2	SE	25
DSC_0622	Room 2 SE wall D2	SSW	25
DSC_0623	D2	SE	23
DSC_0625-30	Room 2 S corner	N	39
DSC_0631	Room 2 SW wall showing roof scar F6 location of building extension now demolished.	NE	40
DSC_0632-4	Room 2 SW wall crack and details	NE	41
DSC_0635	S corner quoin details	NNE	42
DSC_0636-8	S corner foundation details	NNW	42
DSC_0639	Room 2 NW corner details including tying in stones where extension has been demolished	NE	43a
DSC_0640	Room 2 NW corner details including tying in stones where extension has been demolished	NE	43
DSC_0641-6	Room 2 SW end	E	44
DSC_0647-8	Room 2 SW end (left) Room 1 9left)	NE	44
DSC_0649-51	Room 2 NW corner details including tying in stones where extension has been demolished	SE	46
DSC_0652-7	Room 2 NW wall SW end	SE	47
DSC_0658-60	Room 2 NW wall SW end	SE	48
DSC_0661-2	D1	SE	49
DSC_0663	D1	S	49
DSC_0664-5	D1 lintel	SE	49
DSC_0666-7	D1	E	49
DSC_0668	D2 and F2 through D1	SE	50
DSC_0669	D2 (right) D4 (left)	SE	51
DSC_0670	Room 2 SW wall D3 and D4	NE	47
DSC_0671	D4 showing sandstone cracked lintel	NE	51
DSC_0672	D4	ESE	52

DSC_0673-4	W4 above D4	NE	52
DSC_0675	D4 SE jamb	SE	52
DSC_0676	Room 1 SE wall stone details	SE	53
DSC_0677-8	Room 1 SE wall W7 (left) D5, and beam slot holes	SE	54
DSC_0679-80	Room 1 SE wall W7 (left) D5, and beam slot holes	ESE	54
DSC_0681-3	Room 1 NE wall W9 (left) W8 (right)	NE	54
DSC_0684-5	W8	NE	56
DSC_0686-7	Wooden trough NE wall Room 1	ESE/NNE	56
DSC_0688	W9	NNE	57
DSC_0689	Room 1 NW wall	NW	54
DSC_0690	D4 SE jamb	SSE	55
DSC_0691	D4 (left) D3 (right)	SW	55
DSC_0692-3	D4 (left) D3 (right)	SW	54
DSC_0694-5	W4 above D4	SW	59
DSC_0696-7	W3 above D3	SW	66
DSC_0698	D3 NW jamb	NNW	61
DSC_0699-700	Room 1 NW wall details	NW	61
DSC_0701-3	D3 sandstone lintel cracked	ESE	63
DSC_0704	D3 (left) D4 (right)	SE	63
DSC_0705-8	D3 (right) with tying in stones where extension has been demolished	NE	63
DSC_0709-11	Room 1 (left) Room 2 (right)	SE	64
DSC_0712	Room 1 (left) Room 2 (right)	SSE	64
DSC_0713-14	Room 1 (left) Room 2 (right)	SE/ESE	64
DSC_0715-20	NE elevation Room 1 (left) Room 2 (right)	SE	65
DSC_0721-6	Room 1 NW wall showing F4 roof scars and tying in stones where extension (Room 4) demolished	SE	66
DSC_0727	Room 1 NW wall showing F4 roof scars and tying in stones where extension (Room 4) demolished	SE	68
DSC_0728-9	Room 4 walls F3	SW	68
DSC_0730-1	Chimney frags		
DSC_0732	F3	NE	68
DSC_0733-4	F3	NE	69
DSC_0735	F3 with Room 1 (right)	ENE	69
DSC_0736	Room 1	SE	69
DSC_0737	Mill from N	SW	71
DSC_0738	NW wall W9, W8	SW	72
DSC_0739-40	NW wall of mill	SW	73
DSC_0741	NW wall of mill W6 (left) W7	SW	74
DSC_0742	Mill from E	W	75
DSC_0743-9	Mill from E	W	75
IMG_0642	Detail of OS bench mark on NE wall	SW	70



DSC_0502.JPG



DSC_0503.JPG



DSC_0504.JPG



DSC_0505.JPG



DSC_0506.JPG



DSC_0507.JPG



DSC_0508.JPG



DSC_0509.JPG



DSC_0510.JPG



DSC_0511.JPG



DSC_0512.JPG



DSC_0513.JPG



DSC_0514.JPG



DSC_0515.JPG



DSC_0516.JPG



DSC_0517.JPG



DSC_0518.JPG



DSC_0519.JPG



DSC_0520.JPG



DSC_0521.JPG



DSC_0522.JPG



DSC_0523.JPG



DSC_0524.JPG

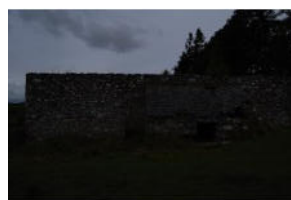

DSC_0525.JPG



DSC_0526.JPG



DSC_0527.JPG



DSC_0528.JPG



DSC_0529.JPG



DSC_0530.JPG



DSC_0531.JPG



DSC_0532.JPG

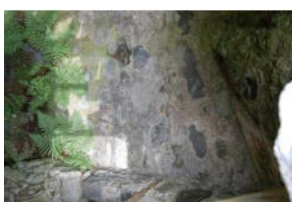

DSC_0533.JPG

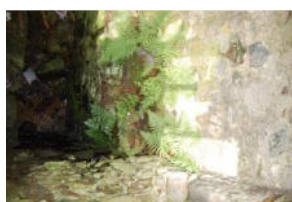

DSC_0534.JPG



DSC_0535.JPG



DSC_0536.JPG



DSC_0572.JPG



DSC_0573.JPG



DSC_0574.JPG



DSC_0575.JPG



DSC_0576.JPG



DSC_0577.JPG



DSC_0578.JPG

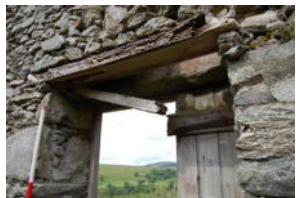

DSC_0579.JPG



DSC_0580.JPG



DSC_0581.JPG



DSC_0582.JPG



DSC_0583.JPG



DSC_0584.JPG



DSC_0585.JPG



DSC_0586.JPG



DSC_0587.JPG



DSC_0588.JPG

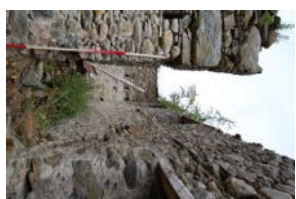

DSC_0589.JPG



DSC_0590.JPG



DSC_0591.JPG



DSC_0592.JPG



DSC_0593.JPG



DSC_0594.JPG



DSC_0595.JPG



DSC_0596.JPG



DSC_0597.JPG



DSC_0598.JPG



DSC_0599.JPG



DSC_0600.JPG



DSC_0601.JPG



DSC_0602.JPG



DSC_0603.JPG

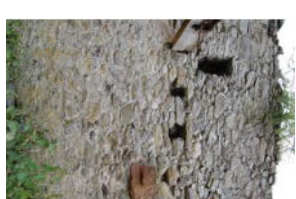

DSC_0604.JPG

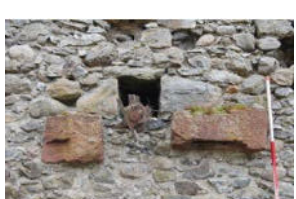

DSC_0605.JPG



DSC_0606.JPG



DSC_0607.JPG



DSC_0608.JPG



DSC_0609.JPG



DSC_0610.JPG



DSC_0611.JPG



DSC_0612.JPG



DSC_0613.JPG



DSC_0614.JPG

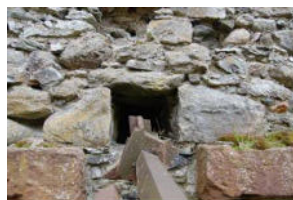

DSC_0615.JPG



DSC_0616.JPG



DSC_0617.JPG



DSC_0618.JPG



DSC_0619.JPG



DSC_0620.JPG



DSC_0621.JPG



DSC_0622.JPG



DSC_0623.JPG



DSC_0625.JPG



DSC_0626.JPG



DSC_0627.JPG



DSC_0628.JPG



DSC_0629.JPG

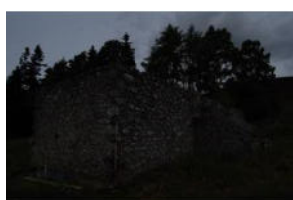

DSC_0630.JPG



DSC_0631.JPG



DSC_0632.JPG



DSC_0633.JPG



DSC_0634.JPG



DSC_0635.JPG



DSC_0636.JPG



DSC_0637.JPG



DSC_0638.JPG



DSC_0639.JPG



DSC_0640.JPG



DSC_0641.JPG



DSC_0642.JPG



DSC_0644.JPG



DSC_0646.JPG



DSC_0647.JPG



DSC_0648.JPG



DSC_0649.JPG



DSC_0650.JPG



DSC_0651.JPG



DSC_0652.JPG



DSC_0653.JPG



DSC_0655.JPG



DSC_0657.JPG



DSC_0658.JPG



DSC_0659.JPG



DSC_0660.JPG



DSC_0661.JPG



DSC_0662.JPG



DSC_0663.JPG



DSC_0664.JPG



DSC_0665.JPG



DSC_0666.JPG



DSC_0667.JPG



DSC_0668.JPG



DSC_0669.JPG



DSC_0670.JPG



DSC_0671.JPG



DSC_0672.JPG



DSC_0673.JPG



DSC_0674.JPG



DSC_0675.JPG



DSC_0676.JPG



DSC_0677.JPG



DSC_0678.JPG



DSC_0679.JPG

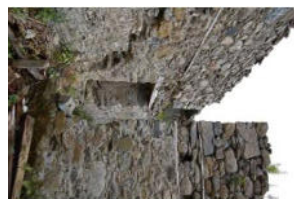

DSC_0680.JPG



DSC_0681.JPG



DSC_0682.JPG



DSC_0683.JPG



DSC_0684.JPG



DSC_0685.JPG



DSC_0686.JPG



DSC_0687.JPG



DSC_0688.JPG



DSC_0689.JPG



DSC_0690.JPG



DSC_0691.JPG



DSC_0692.JPG



DSC_0693.JPG



DSC_0694.JPG



DSC_0695.JPG



DSC_0696.JPG



DSC_0697.JPG



DSC_0698.JPG



DSC_0699.JPG



DSC_0700.JPG



DSC_0701.JPG



DSC_0702.JPG



DSC_0703.JPG



DSC_0704.JPG



DSC_0705.JPG



DSC_0706.JPG



DSC_0707.JPG



DSC_0708.JPG



DSC_0709.JPG



DSC_0710.JPG



DSC_0711.JPG



DSC_0712.JPG



DSC_0713.JPG



DSC_0714.JPG



DSC_0715.JPG



DSC_0716.JPG



DSC_0718.JPG



DSC_0720.JPG



DSC_0721.JPG

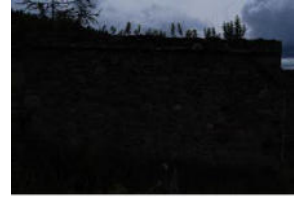

DSC_0722.JPG



DSC_0723.JPG



DSC_0724.JPG



DSC_0725.JPG



DSC_0726.JPG



DSC_0727.JPG



DSC_0728.JPG



DSC_0729.JPG



DSC_0730.JPG



DSC_0731.JPG



DSC_0732.JPG



DSC_0733.JPG



DSC_0734.JPG



DSC_0735.JPG



DSC_0736.JPG



DSC_0737.JPG



DSC_0738.JPG



DSC_0739.JPG



DSC_0740.JPG



DSC_0741.JPG



DSC_0742.JPG



DSC_0743.JPG



DSC_0744.JPG



DSC_0745.JPG



DSC_0747.JPG



DSC_0749.JPG



IMG_0642.JPG