

**Report on an Archaeological Watching Brief
CA-332-2017
Aberdeenshire Council, Aden Caravan Park, Aden Country
Park, Mintlaw, Aberdeenshire, AB42 5FQ**



**Dr Robert Lenfert
Cameron Archaeology
17 March 2017**

CONTENTS

1 BACKGROUND	3
2 ARCHAEOLOGICAL BACKGROUND	4
3 THE WATCHING BRIEF	6
4 CONCLUSIONS	8
5 REFERENCES	8
6 ACKNOWLEDGEMENTS	8
APPENDIX 1 ARCHAEOLOGICAL SITES	9
APPENDIX 2 MAPS	15
APPENDIX 3 PHOTOS	17

ILLUSTRATIONS

Illus 1 Location plan	3
Illus 2 Location of proposed glamping pods (copyright Aberdeenshire Council)	7
Illus 3 GPS location of cable trench (image c. Digital Globe 2017).	7
Illus 4 First Edition OS map showing site outline in red.....	15
Illus 5 Second Edition OS map showing site outline in red.....	16

SUMMARY

On March 15th, 2017, an archaeological watching brief took place at Aden Country Park Camping and Caravan site near Mintlaw, Aberdeenshire. The work took place in response to the installation of several 'glamping pods' or fixed camping shelters, and primarily involved the excavation of a 165m long cable trench for electrical services. No archaeological finds or features were noted during the project, though several suspected Bronze Age platforms are located some 35m NW of the cable route.

1 BACKGROUND

- 1.1 The site (Illus 1) is located at the west side of Aden Country Park Camping and Caravan site on the south side of Station Road, Mintlaw. It is centred on NGR NJ 98462 48290, at 55-57m OD in the parish of Old Deer.
- 1.2 The work was commissioned by Liz Scott, Buchan Development Partnership. An application APP/2016/2681 for erection of 6 glamping pods and creation of car parking spaces was approved on 10.11.2016 with an archaeology watching brief condition (condition 1). Reason: To record items of archaeological interest. This should include, but is not limited to a watching brief during all ground disturbance.
- 1.3 All the archaeological work will be carried out in the context of Scottish Planning Policy (SPP) Planning Advice Note (PAN 2/2011) and Historic Environment Scotland's Policy Statement (HESPS) which state that archaeological remains should be regarded as part of the environment to be protected and managed.



Illus 1 Location plan (Contains Ordnance Survey data © Crown copyright and database right 2017)

2 ARCHAEOLOGICAL BACKGROUND

- 2.1 There is one Scheduled Monument within 1km of the proposed development. Old Deer Old Parish Church is 950m from the proposed development. The ruin comprises the remains of the old parish church which lie immediately E of the present parish church in the centre of Old Deer, incorporated into two contiguous walled roofless burial enclosures, separated by the medieval chancel arch. The only surviving parts of the medieval church appear to be the chancel arch itself, the truncated E end of the nave, and some parts of the N and S walls of the chancel. The nave was 6.2m wide internally and of uncertain length, the W part having been destroyed completely when the parish church was built in 1788-9. Its overall width was probably 8.05m, the same as the present burial enclosure, though it is hard to detect any medieval masonry in the external walls as the facing has been greatly altered by repairs and the insertion into it of various memorials.

The W burial enclosure, of which it now forms part, extends 6.62m E-W, with a W wall 0.6m thick containing the entrance. This enclosure was probably formed in 1892, which is the date at which William Ferguson of Kinmundy erected a memorial against the S wall in memory of his ancestors, the earliest mentioned being James Ferguson of Kinmundy, who died in 1777. Medieval features of the nave that survive in situ include a splayed rounded-arched window in the N wall, and another facing it on the S. Just to the left of the latter is a scalloped piscina, set in a recess enclosed by a trefoil arch; this was probably intended to serve a nave altar placed to the right of the chancel arch. Immediately to the left of the chancel arch is another similar piscina, though less well preserved, indicating the former existence of another nave altar in that position also. To the left of the N window is an aumbry with a segmental-arched head surmounted by a pointed arch containing a cross in circle. The chancel arch is 2.24m wide and roughly semi-circular, with a broad chamfer on both arises. On the E face of the wall between the nave and the chancel, to the left of the arch and at a level just above its springing (perhaps some 2m above the original floor level) is a blocked door, that would possibly have given access to a rood loft above the nave altars. The chancel was 4.3m wide, though the medieval walls survive only as footings at the W end and in the central part of the S wall where the wall of the E burial enclosure appears to retain the original wall-thickness. If one assumes that the form of the chancel is perpetuated more or less in that of the E burial enclosure, it would have been some 10.75m long internally. The burial enclosure itself appears to date from 1731, when James Ferguson of Pitfour erected a fine marble memorial to his wife, Anne Stuart, in the centre of its S wall. A heraldic stone is built into the E wall. A number of heraldic stones and memorials are built into the external S wall of the W burial enclosure and appear to have been brought here from elsewhere. The Old Parish Church is traditionally supposed to have been dedicated to St Drostan, though there appears to be no certain evidence of this. Nor is there any certain evidence that it occupies the site of a monastery established by St Columba and St Drostan in AD 580. The Old Parish Church and Churchyard are listed as Historic Buildings (Category B).

- 2.2 The site is within the Aden Estate (HER NJ94NE0077). It is the remains of a 17th-19th century designed landscape. The estate was purchased in 1758 by Alexander Russell who implemented contemporary ideas of farming 'Improvement' reorganised his tenant farms, planted woods for shelter and built a house overlooking the South Ugie Water (NJ94NE0034). Succeeding generations of the Russell family completed the transformation by enlarging the house and building the unique steading (c. 1800 NJ94NE0035). By the 1920s house and gardens were in decline, and Russell sold the estate in 1937. After a succession of owners it was purchased by Aberdeen County Council in 1974, part of which has since been developed as a country park. It contains several category C-Listed features. These include the former laundry (NJ94NE0092) situated between the mansion and stables, which may be late 18th century in date, and which has now been converted to North East Folklore Archive.

The walled garden (NJ94NE0093) is dated 1766 but was probably rebuilt in the earlier to mid-19th century. It incorporates a bothy, potting shed and gardener's cottage.

- 2.3 Excavation of two stone structures in Aden Country Park was carried out from 6-19th June 2016 by a team of 36 archaeologists, Book of Deer members, students and volunteers as well as staff and nearly 300 pupils from local primary schools and Mintlaw Academy. Structure 1 is a T-shaped building, probably built on the medieval period, possibly as a tower house and possibly later used as an Episcopalian Meeting House. Nearly 20 coins of the late 18th century, copper alloy heart-shaped brooch and copper alloy book fittings are included in the finds from the later use of the building. Burnt timbers and stone were excavated from the demolition of the building which had been burnt prior to demolition. Structure 2 may have an agricultural or mixed domestic and agricultural use. There is a hearth inside the S wall surrounded by a well-laid cobbled floor and a stone-lined pit in the NE corner of the N room which may have been an exterior courtyard (Cameron 2016).
- 2.4 As part of a Book of Deer funded project, an evaluation was carried out by Murray Archaeological Services of a group of 27 circular enclosures or possible huts lie in a plantation 40m N of the former stables of Aden House between NJ 9805 4798 and NJ 9811 4819 (NJ94NE 88) (Murray and Murray 2011).
- 2.5 A trench was also dug in the park by Guard Archaeology with no significant archaeological results (Lelong 2009).
- 2.6 There are circular and linear upstanding earthworks in the wood immediately to the west of the proposed development which may date to the prehistoric period. They are going to be investigated in March and April 2017 as part of a heritage Lottery application within the park. Other possible sites to be investigated are a possible stone circle site, possible World war 1 practice trenches and the ruined Aden Mansion house (Cameron forthcoming).
- 2.7 The proposed development is adjacent to the grounds of the former Pitfour House (RCAHMS no NJ94NE 67), site of manor/ mansion house; possible site of Manor Place of Pitfour. The estate came in to the possession of the Ferguson family in the early 18thC. The original estate was enlarged by the acquisition of land at Inverugie, formerly owned by the Earl Marischal. The 'improving' Fergusons subsequently built one of the most magnificent mansions in the north-east designed by John Smith, with landscaped surrounding policies. The finished product was one of the show-pieces of Buchan. The earlier mansion house may have been an addition to the former manor or built on the site of the manor. The conservatory gallery was carried on Ionic columns with a protruding studio on Corinthian columns, which was added along the entire front of the house. When the house was demolished, the studio and gallery were removed to Kinloch House, near St Fergus. Although the house was demolished in 1927-30 and the grounds have suffered much from timber felling, the lake and its surrounding buildings still have great landscape and architectural value. All buildings associated with the house are listed B because of this. To the north of the house lay gasometers, the laundry (with ice-house to the rear), stables and a riding school. To the west were the kennels and pheasantry. There were also sawmills at NJ9627 4930 with a lade leading from the west to it. To the west of the stable block, itself a U-shaped building with central tower, is the remains of a circular game larder (Aberdeenshire HER).

Several of the buildings within the estate are listed. The Stables (NJ94NE 67.5) are listed B: John Smith, shortly after 1820. 2-storey (low 1st) U-plan, pinned rubble (formerly harled) with granite dressings, centrepiece segmental arch with 3 recessed panels over enclosed in antis and pediment with wooden Doric cupola over. Low-pitched roof (now asbestos) behind blocking course. The Game Larder (NJ94NE 67.15)

Circa 1820. Single-storey octagon, harled with granite margins, apex of broad-eaved roof platformed with louvre. Dilapidated. The Laundry (NJ94NE 67.4) is listed C
Circa 1820. 2-storey 5-window pinned rubble with granite dressings, centre bay projects; broad-eaved piend roof. The Chapel (NJ94NE 67.7) is listed C 1850-1 (as English Episcopal Chapel continuing); Crude gothic, roughly built of rubble, rectangular plan with 60' battlemented W. tower, wood tracery. The NE (NJ94NE 67.1) and SE (NJ94NE 67.2) and NW (NJ94NE 67.3) bridges date to before 1820. 3 low segmental arches with cutwaters granite ashlar built with square recessed panels at the spandrels. Fluted cast-iron post and chain parapets. The Temple of Theseus Circa 1835 (?). Small Greek Doric Hexastyle temple with 34 granite- column peristyle; wood entabature; very finely detailed. The Boathouse (NJ94NE 67.8) is now listed C Probably before 1820. Single-storey artificial rubble-built ruin with gothic arches; granite dressings; landing area for boats. The Kennels (NJ94NE 67.14) are listed B Before 1820(?). Single-storey 2-window and centre distyle Doric Portico in antis. Rubble built with granite dressings (Historic Scotland online).

2.8 On the N side of the estate is Pitfour 'homestead moat' (NJ94NE 41). Air photography (CUCAP BVI 25, flown 29 July 1975 and AAS/77/10/SL/28, flown 8 August 1977) has recorded the cropmark of a rectilinear or rectangular enclosure among indeterminate cropmarks on a gentle slope at an altitude of 75m OD (Bogdan and Bryce 1991, 26). On the E of the estate at Mains of Pitfour is a rectilinear enclosure (NJ94NE 82). Air photography (AAS/82/12/S14/13-17, flown 20 July 1982) has recorded the cropmark of a rectilinear enclosure on a gentle slope at an altitude of 65m OD.

- 2.9 The proposed development is in farmland on the First and Second OS maps (Illus 3, 4) and is now in a grassed area used for pitching tents.

3 THE WATCHING BRIEF

On March 15th, 2017 installation of a 165m long machine-dug cable trench was completed, measuring 50cm in depth and was approximately 10-12cm in width at the base, widening to approximately 20cm at the top. Topsoil deposits averaged 20-25cm in depth, and formed a clear horizon from the underlying subsoils. Evidence of previous disturbance was visible in areas where drain tiles had been installed during the initial construction phase of the campground. The existing gravel track towards the rear of the site was slightly expanded in width for parking. This work did not penetrate topsoil. No archaeological finds or features were noted during this watching brief, though it should be pointed out that this type of narrow cable trench does not readily favour the identification of archaeological finds or features due to the narrow profile. In addition, a number of suspected Bronze Age platforms or enclosures are readily visible some 20-35m to the NW of the campground, located immediately on the opposite side of the track/nature path. Given this close proximity, it would stand to reason that unknown archaeological deposits may yet be located within the campground.

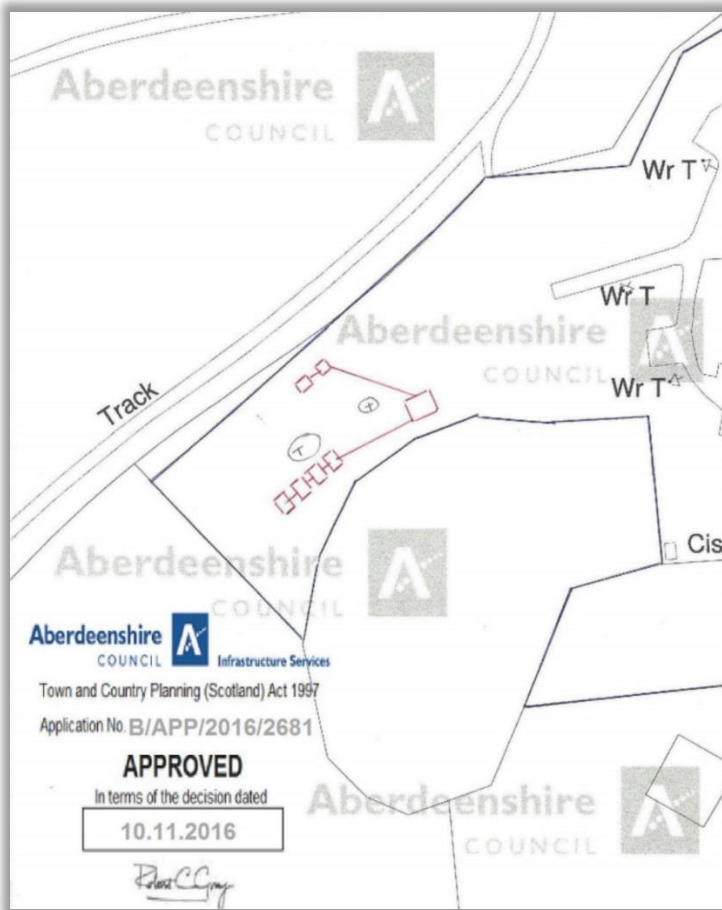

Illus 2 Location of proposed glamping pods (copyright Aberdeenshire Council)



Illus 3 GPS location of cable trench (image c. Digital Globe 2017).

4 CONCLUSIONS

Although no archaeological finds or features were noted within the narrow confines of the cable trench, the presence of apparent upstanding prehistoric Bronze Age features immediately to the NW of the camping area suggests that a reasonable potential exists for buried prehistoric archaeology within the camping area, in particular the area of the glamping pods. If future excavation works take place for additional glamping pods, these factors should be taken into account.

5 REFERENCES

Cameron, A 2016 Excavations at Aden Country Park.

Cameron A forthcoming Excavations in Aden Country Park 2017.

Lelong, O 2009 The Monastery Of Deer Archaeological Project Desk-Based Assessment and Field Evaluation.

Murray, HK and Murray JC 2011 Book of Deer Project Excavations 2011 Old Deer, Aberdeenshire. MAS 2013-27

6 ACKNOWLEDGEMENTS

Thanks to Liz Scott, Buchan Development Partnership for initiating this project and to Claire Herbert, Aberdeenshire Council Archaeology Service for her advice during this work.

Cameron Archaeology
45 View Terrace
Aberdeen
AB25 2RS
01224 643020
07581 181057
cameronarch@btinternet.com
www.cameronarchaeology.com
Company registration no 372223 (Scotland)
VAT registration no 990 4373 00

APPENDIX 1

Archaeological and historical sites within 1km of the proposed site (HES and Aberdeenshire HER online)

Dataset	Dataset UID	Name
HERABER	NJ94NE0002	OLD CHURCH, OLD DEER
HERABER	NJ94NE0004	DEER ABBEY
HERABER	NJ94NE0021	SAPLINBRAE
HERABER	NJ94NE0024	WATERMEADOW
HERABER	NJ94NE0025	WATERMEADOW
HERABER	NJ94NE0026	WATERMEADOW
HERABER	NJ94NE0027	WATERMEADOW
HERABER	NJ94NE0028	MEADOW BANK
HERABER	NJ94NE0029	MEADOW BANK
HERABER	NJ94NE0030	CARTLEHAUGH
HERABER	NJ94NE0031	PITFOUR ROAD
HERABER	NJ94NE0034	ADEN HOUSE
HERABER	NJ94NE0035	ADEN HOUSE STABLES
HERABER	NJ94NE0036	GLENADEN DISTILLERY
HERABER	NJ94NE0039	PITFOUR
HERABER	NJ94NE0042	ADEN HOUSE DOVECOT
HERABER	NJ94NE0046	TOW STONE
HERABER	NJ94NE0047	OLD DEER
HERABER	NJ94NE0049	PITFOUR
HERABER	NJ94NE0053	PITFOUR CHURCH
HERABER	NJ94NE0052	CHAPEL PARK
HERABER	NJ94NE0074	MAVISBANK
HERABER	NJ94NE0075	MAVISBANK
HERABER	NJ94NE0076	WAULKMILL
HERABER	NJ94NE0077	ADEN HOUSE
HERABER	NJ94NE0078	OLD DEER
HERABER	NJ94NE0083	ABBAY STREET, OLD DEER
HERABER	NJ94NE0097	ADEN ARBORETUM
HERABER	NJ94NE0098	ADEN ARBORETUM
HERABER	NJ94NE0092	ADEN HOUSE LAUNDRY AND ICEH...
HERABER	NJ94NE0093	ADEN HOUSE WALLED GARDEN
HERABER	NJ94NE0094	ADEN CRESCENT, OLD DEER
HERABER	NJ94NE0041	OLD DEER
HERABER	NJ94NE0048	PITFOUR
HERABER	NJ94NE0116	UGIE BRAE, NEW DEER
HERABER	NJ94NE0119	OLD DEER
HERABER	NJ94NE0111	ADEN COUNTRY PARK
HERABER	NJ94NE0112	ADEN COUNTRY PARK
HERABER	NJ94NE0113	OLD DEER

HERABER	NJ94NE0114	SAPLINBRAE	
HERABER	NJ94NE0115	ST DROSTAN'S, OLD DEER	
HERABER	NJ94NE0100	OLD DEER	
HERABER	NJ94NE0101	ABBEY LANE, OLD DEER	
HERABER	NJ94NE0102	ABBEY STREET, OLD DEER	
HERABER	NJ94NE0103	KIRKGATE, OLD DEER	
HERABER	NJ94NE0104	UGIEBRAE HOUSE, OLD DEER	
HERABER	NJ94NE0105	ADEN CRESCENT, OLD DEER	
HERABER	NJ94NE0106	ABBEY STREET, OLD DEER	
HERABER	NJ94NE0107	10 ABBEY STREET, OLD DEER	
HERABER	NJ94NE0108	ABBEY STREET, OLD DEER	
HERABER	NJ94NE0109	OLD DEER	
HERABER	NJ94NE0099	THE GLEBE, OLD DEER	
HERABER	NJ94NE0117	OLD DEER	
RCAHMS	NJ 98020 4885	PITFOUR HOUSE ESTATE NORTH EAST BRIDGE	BRIDGE (PERIOD UNASSIGNED). ALTNAME = PITFOUR HOUSE ESTATE, PITFOUR HOUSE POLICIES, PITFOUR LAKE, PITFOUR LOCH
RCAHMS	NJ 97891 4862	PITFOUR HOUSE ESTATE SOUTH EAST BRIDGE	BRIDGE (19TH CENTURY). ALTNAME = PITFOUR HOUSE ESTATE, PITFOUR HOUSE POLICIES
RCAHMS	NJ 97284 4893	PITFOUR HOUSE ESTATE NORTH WEST BRIDGE	BRIDGE (19TH CENTURY). ALTNAME = PITFOUR HOUSE ESTATE, PITFOUR HOUSE POLICIES
RCAHMS	NJ 97743 4925	PITFOUR HOUSE ESTATE LAUNDRY	LAUNDRY (19TH CENTURY). ALTNAME = PITFOUR HOUSE ESTATE, PITFOUR HOUSE POLICIES
RCAHMS	NJ 97981 4921	PITFOUR HOUSE ESTATE THE STABLES	STABLE(S) (19TH CENTURY). ALTNAME = PITFOUR HOUSE POLICIES
RCAHMS	NJ 98195 4912	PITFOUR HOUSE ESTATE CHAPEL	CHAPEL (PERIOD UNASSIGNED). ALTNAME = EPISCOPAL CHAPEL, PITFOUR HOUSE ESTATE, PITFOUR HOUSE POLICIES, PITFOUR CHURCH

RCAHMS	NJ 97486 4886	PITFOUR HOUSE ESTATE BOATHOUSE	BOATHOUSE (PERIOD UNASSIGNED). ALTNAME = PITFOUR HOUSE ESTATE, PITFOUR HOUSE POLICIES PIFOUR LOCH, PITFOUR LAKE
RCAHMS	NJ 97802 4831	PITFOUR HOUSE ESTATE SOUTH LODGE	GATE LODGE (PERIOD UNASSIGNED). ALTNAME = PITFOUR HOUSE ESTATE, PITFOUR HOUSE POLICIES
RCAHMS	NJ 98476 4872	PITFOUR HOUSE ESTATE STATION LODGE AND GATEPIERS	GATE PIER(S) (PERIOD UNASSIGNED), LODGE (PERIOD UNASSIGNED). ALTNAME = PITFOUR HOUSE ESTATE, PITFOUR HOUSE POLICIES
RCAHMS	NJ 97405 4903	PITFOUR HOUSE ESTATE THE KENNELS COTTAGE	COTTAGE (PERIOD UNASSIGNED). ALTNAME = PITFOUR HOUSE ESTATE, PITFOUR HOUSE POLICIES
RCAHMS	NJ 97840 4767	OLD DEER	VILLAGE (PERIOD UNASSIGNED)
RCAHMS	NJ 98260 4786	ADEN HOUSE, NURSERY AND GARDENER'S COTTAGE	COTTAGE (PERIOD UNASSIGNED). WALLED GARDEN (PERIOD UNASSIGNED). ALTNAME = ADEN COUNTRY PARK
RCAHMS	NJ 98510 4776	ADEN HOUSE, FORESTER'S COTTAGE	COTTAGE (PERIOD UNASSIGNED). ALTNAME = ADEN COUNTRY PARK
RCAHMS	NJ 97910 4729	ADEN HOUSE, SOUTH LODGE	LODGE (19TH CENTURY). ALTNAME = ADEN COUNTRY PARK, WEST LODGE
RCAHMS	NJ 97953 4772	ADEN HOUSE POLICIES, ESTATE BRIDGE	BRIDGE (PERIOD UNASSIGNED). ALTNAME = ADEN COUNTRY PARK, SOUTH UGIE WATER
RCAHMS	NJ 97948 4759	ADEN HOUSE POLICIES, ESTATE BRIDGE	BRIDGE (PERIOD UNASSIGNED).
RCAHMS	NJ 98000 4780	ADEN HOUSE, ICEHOUSE	ICEHOUSE (PERIOD UNASSIGNED). ALTNAME = ADEN COUNTRY PARK
RCAHMS	NJ 98487 4842	ADEN HOUSE, NORTH LODGE	LODGE (19TH CENTURY). ALTNAME = ADEN COUNTRY PARK, GOLDIES LODGE
RCAHMS	NJ 98000 4780	ADEN HOUSE, PARK	PARK (PERIOD UNASSIGNED). ALTNAME = ADEN COUNTRY PARK

RCAHMS	NJ 98110 4919	CHAPEL PARK, PITFOUR HOUSE POLICIES	RIG AND FURROW (MEDIEVAL). ALTNAME = PITFOUR HOUSE ESTATE
RCAHMS	NJ 98080 4804	ADEN	ENCLOSURE(S) (PERIOD UNASSIGNED), HUT(S) (PERIOD UNASSIGNED)(POSSIBLE)
RCAHMS	NJ 98131 4795	ABERDEENSHIRE FARMING MUSEUM	DOVECOT (PERIOD UNASSIGNED) MUSEUM (19-20TH CENTURY), STABLE(S) (18TH CENTURY). ALTNAME = ADEN HOUSE STABLES, ADEN COUNTRY PARK
RCAHMS	NJ 97800 4768	TOW STONE	STONE (PERIOD UNASSIGNED)
RCAHMS	NJ 97880 4767	OLD DEER, DEER PARISH CHURCH	CHURCH (PERIOD UNASSIGNED)
RCAHMS	NJ 97820 4765	OLD DEER, ABBEY STREET, ST DROSTAN'S EPISCOPAL CHURCH	CHURCH (PERIOD UNASSIGNED). ALTNAME = ST DRESTAN
RCAHMS	NJ 97910 4768	OLD DEER, CHURCH OF DEER	CHURCH (PERIOD UNASSIGNED), CHURCHYARD (PERIOD UNASSIGNED). ALTNAME = OLD DEER, OLD PARISH CHURCH
RCAHMS	NJ 97835 4769	OLD DEER, 2 ABBEY STREET	COTTAGE (PERIOD UNASSIGNED)
RCAHMS	NJ 97803 4766	OLD DEER, 3 ABBEY STREET	TERM PENDING
RCAHMS	NJ 97780 4767	OLD DEER, 9 ABBEY STREET	TERM PENDING
RCAHMS	NJ 97771 4767	OLD DEER, 11 ABBEY STREET	TERM PENDING. ALTNAME = ABBEY LANE
RCAHMS	NJ 97757 4768	OLD DEER, 13 ABBEY STREET	TERM PENDING
RCAHMS	NJ 97723 4769	OLD DEER, 19 ABBEY STREET, ADEN ARMS HOTEL	HOTEL (PERIOD UNASSIGNED). ALTNAME = 2 RUSSELL STREET
RCAHMS	NJ 97867 4766	OLD DEER, 1 KIRKGATE	TERM PENDING
RCAHMS	NJ 97857 4763	OLD DEER, 4 KIRKGATE	TERM PENDING
RCAHMS	NJ 97681 4759	OLD DEER, 16 RUSSELL STREET	TERM PENDING. ALTNAME = THE COTTAGE

RCAHMS	NJ 97658 4786	OLD DEER, DEER HOUSE OFFICES	STABLE (PERIOD UNASSIGNED). ALTNAME = MANSE OF OLD DEER, OFFICES
RCAHMS	NJ 97881 4774	OLD DEER, BRIDGE OF DEER	BRIDGE (PERIOD UNASSIGNED). ALTNAME = SOUTH UGIE WATER
RCAHMS	NJ 96855 4810	DEER ABBEY	ABBHEY (MEDIEVAL). ALTNAME = OLD DEER ABBEY, CISTERCIAN ABBEY OF DEER
RCAHMS	NJ 97853 4792	ADEN HOUSE, WEST LODGE	GATE LODGE (19TH CENTURY)
RCAHMS	NJ 97753 4768	OLD DEER, 15 ABBEY STREET	TERM PENDING
RCAHMS	NJ 97747 4768	OLD DEER, 17 ABBEY STREET	TERM PENDING
RCAHMS	NJ 97828 4769	OLD DEER, 4 ABBEY STREET	TERM PENDING
RCAHMS	NJ 97795 4767	OLD DEER, 5 ABBEY STREET	TERM PENDING
RCAHMS	NJ 97842 4766	OLD DEER, 1 ABBEY STREET	TERM PENDING
RCAHMS	NJ 97852 4766	OLD DEER, 2 KIRKGATE	TERM PENDING
RCAHMS	NJ 97816 4770	OLD DEER, 6 ABBEY STREET, CLYDESDALE BANK	BANK (FINANCIAL) (PERIOD UNASSIGNED)
RCAHMS	NJ 97790 4770	OLD DEER, 8, 10 ABBEY STREET, POST OFFICE	POST OFFICE (19-20TH CENTURY)
RCAHMS	NJ 97875 4765	OLD DEER, 3-5 KIRKGATE	TERM PENDING
RCAHMS	NJ 97855 4762	OLD DEER, 6 KIRKGATE	TERM PENDING
RCAHMS	NJ 97281 4838	SAPLINBRAE HOUSE HOTEL	HOTEL (PERIOD UNASSIGNED). ALTNAME = SAPLINGBRAE
RCAHMS	NJ 97007 4813	OLD DEER, DEER ABBEY WALLED GARDEN	WALLED GARDEN (PERIOD UNASSIGNED)
RCAHMS	NJ 96912 4821	OLD DEER, NEWLANDS	HOUSE (PERIOD UNASSIGNED). ALTNAME = PITFOUR ESTATE
RCAHMS	NJ 97942 4833	CARTLEHAUGH	HOUSE (PERIOD UNASSIGNED)
RCAHMS	NJ 97820 4819	OLD DEER, ROAD BRIDGE OVER DISUSED RAILWAY	TERM PENDING

RCAHMS	NJ 97820 4831	PITFOUR HOUSE ESTATE SOUTH LODGE, MEMORIAL STONE TO WILLIAM PITT AND VISCOUNT MELVILLE	COMMEMORATIVE STONE (PERIOD UNASSIGNED). ALTNAME = PITFOUR HOUSE POLICIES
RCAHMS	NJ 97812 4831	PITFOUR HOUSE ESTATE SOUTH LODGE, GATE PIERS	GATE PIER(S) (PERIOD UNASSIGNED)
RCAHMS	NJ 97860 4780	OLD DEER, ABBEY STREET	NO CLASS (EVENT)
RCAHMS	NJ 97563 4812	MAVISBANK	WATER MEADOW (POST MEDIEVAL)
RCAHMS	NJ 96855 4810	OLD DEER, DEER ABBEY	CROSS INCISED STONE (PICTISH) PICTISH SYMBOL STONE (PICTISH). ALTNAME = OLD DEER ABBEY, CISTERCIAN ABBAY OF DEER
RCAHMS	NJ 97650 4765	OLD DEER, RUSSEL STREET, ST DROSTAN'S HOME	NO CLASS (EVENT)
RCAHMS	NJ 97705 4758	OLD DEER, RUSSEL STREET	NO CLASS (EVENT)
RCAHMS	NJ 98033 4783	ADEN HOUSE	COUNTRY HOUSE (PERIOD UNASSIGNED). ALTNAME = FORTALICE OF ALNEDEN, ADEN COUNTRY PARK
RCAHMS	NJ 97816 4913	PITFOUR HOUSE	COUNTRY HOUSE (PERIOD UNASSIGNED). ALTNAME = PITFOUR HOUSE ESTATE, PITFOUR HOUSE POLICIES
RCAHMS	NJ 97780 4796	MAVISBANK	CHAPEL (PERIOD UNASSIGNED)
RCAHMS	NJ 98210 4755	OLD DEER, EPISCOPAL MEETING HOUSE	CHURCH (PERIOD UNASSIGNED)
RCAHMS	NJ 97500 4863	PITFOUR HOUSE ESTATE MINERAL WELL	WELL (PERIOD UNASSIGNED). ALTNAME = PITFOUR HOUSE ESTATE, PITFOUR HOUSE POLICIES
RCAHMS	NJ 97472 4869	PITFOUR HOUSE ESTATE TEMPLE OF THESEUS	FOLLY (19TH CENTURY). ALTNAME = PITFOUR HOUSE ESTATE, PITFOUR HOUSE POLICIES BATH HOUSE
RCAHMS	NJ 97614 4790	OLD DEER, DEER HOUSE	MANSE (PERIOD UNASSIGNED).
RCAHMS	NJ 97100 4850	SAPLINBRAE	CULTIVATION REMAINS (PERIOD UNASSIGNED),

APPENDIX 2 MAPS

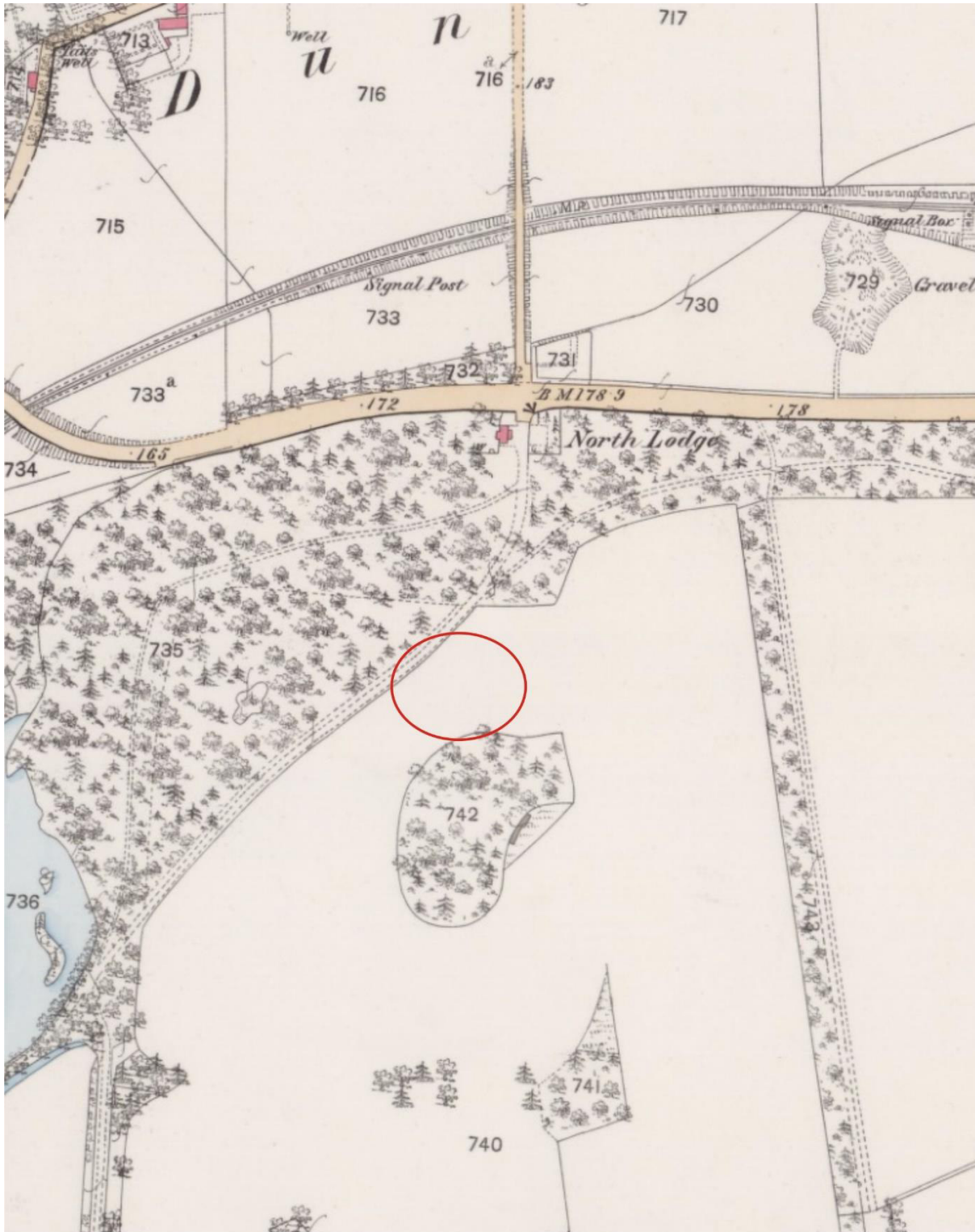

Illus 4 First Edition OS map showing site outline in red (*copyright National Library of Scotland*)
Aberdeen Sheet XXII.1 (Combined) Survey date: 1870 Publication date: 1872

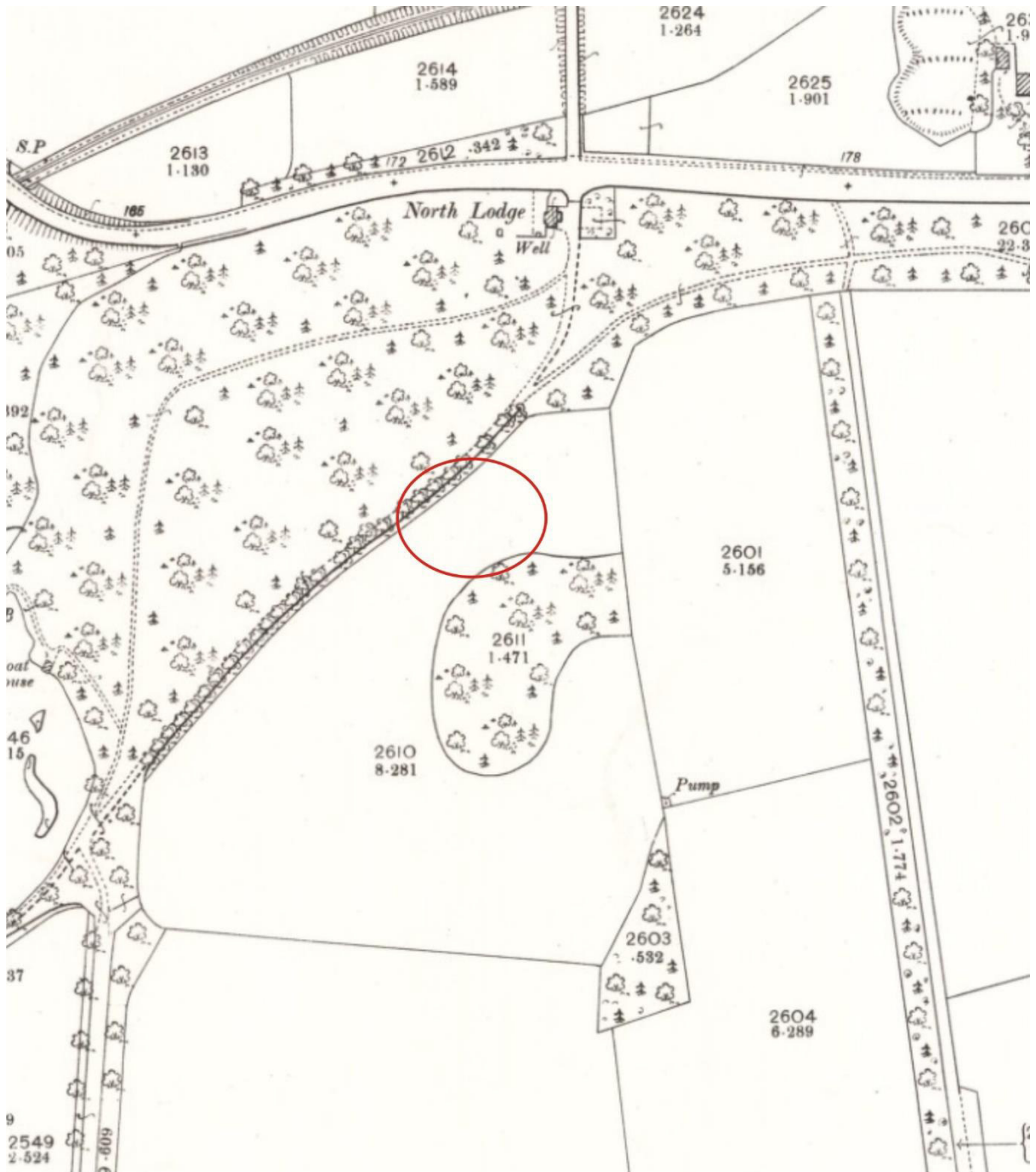

Illus 5 Second Edition OS map showing site outline in red (copyright National Library of Scotland) Aberdeenshire 022.01 (includes: Longside; Old Deer) Publication date: 1902 Revised: 1899

APPENDIX 3 PHOTOS

PHOTO ID	DIRECTION FACING	COMMENTS
DSC0751	W	Two glamping pods resting on raised ground at W end of project area.
DSC0752	NE	Route of cable trench immediately behind pods
DSC0754	NW	East terminus of cable trench
DSC0758	NW	Cable trench, middle section
DSC0759	NE	Profile of cable trench, mid-way along route
DSC0760	NE	Detail shot of cable trench section, mid-route
DSC0761	SE	Spoil heap showing colour and soil composition subsoils. This remained consistent along the route.
DSC0762	NW	Detail shot of section clearly showing topsoil/subs interface
DSC0763	NW	Detail shot of section clearly showing topsoil/subs interface
DSC0765	SW	Cable trench running towards read of glamping pods
DSC0766	NE	View of trench looking away from pods
DSC0767	SW	Cable trench running towards pods
DSC0770	N	Right angle trench section. Pods to right of photo, out frame
DSC0771	N	Right angle trench section with pods (and terminus) frame.
DSC07	SE	Right angle trench section with pods (and terminus) frame.
DSC0751	WSW	Area of fresh gravel overlying topsoil – sod removed Subsoil depth not reached.



_DSC0751.jpg



_DSC0752.jpg



_DSC0753.jpg



_DSC0754.jpg

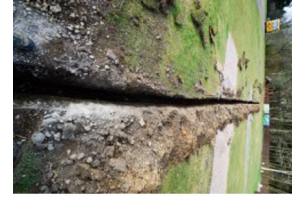

_DSC0755.jpg



_DSC0756.jpg



_DSC0757.jpg



_DSC0758.jpg



_DSC0759.jpg



_DSC0760.jpg



_DSC0761.jpg



_DSC0762.jpg



_DSC0763.jpg



_DSC0764.jpg



_DSC0765.jpg



_DSC0766.jpg



_DSC0767.jpg



_DSC0768.jpg



_DSC0769.jpg



_DSC0770.jpg



_DSC0771.jpg



_DSC0772.jpg



_DSC0773.jpg



_DSC0774.jpg