

**Drummargettie  
Crathie, Aberdeenshire  
Report on an Archaeological Watching Brief  
Cameron Archaeology CA368**



**Dr Robert Lenfert  
Cameron Archaeology  
19-10-2018**

## CONTENTS

|   |                         |   |
|---|-------------------------|---|
| 1 | BACKGROUND .....        | 3 |
| 2 | THE WATCHING BRIEF..... | 4 |
| 3 | CONCLUSIONS.....        | 5 |
| 4 | REFERENCES.....         | 6 |
| 5 | ACKNOWLEDGEMENTS .....  | 6 |
|   | APPENDIX 1 MAPS.....    | 7 |
|   | APPENDIX 2 PHOTOS ..... | 8 |

## ILLUSTRATIONS

**Cover:** Soil strip nearing completion (top) and prior to soil strip (below).

|          |                                                                                                                                                                                                                                                              |   |
|----------|--------------------------------------------------------------------------------------------------------------------------------------------------------------------------------------------------------------------------------------------------------------|---|
| Illus 1  | Location plan (Contains Ordnance Survey data © Crown copyright and database right 2017).....                                                                                                                                                                 | 3 |
| Illus 2  | GPS Location of watching brief area for structure foundations, superimposed upon previous building foundations recorded during the Level One survey in 2017. Northing and Eastings for A-D are given in Table 1, below (image c.Digital Globe/Google 2018).. | 4 |
| Illus 3  | Soil strip nearing completion. Note dark band which comprises shallow (under 0.30m) natural gully in front of dumper, running downslope. ....                                                                                                                | 5 |
| Illus 4: | Roy Military Map of 1747-55 showing 'Drumagad' - red arrow. ( <i>copyright National Library of Scotland</i> ).....                                                                                                                                           | 7 |
| Illus 5: | First Edition OS map, Sheet XC, surveyed 1866 – published 1869, showing site outline in red ( <i>copyright National Library of Scotland</i> ).....                                                                                                           | 7 |
| Illus 6  | Second Edition OS map, Sheet XC, updated 1900 – published 1903, showing site outline in red ( <i>copyright National Library of Scotland</i> ).....                                                                                                           | 8 |
| Table 1: | Locations of corner co-ordinates in Illus 3 for the watching brief. ....                                                                                                                                                                                     | 5 |

## SUMMARY

On October 15th, 2018 a watching brief took place during a 15x30m<sup>2</sup> soil strip for a domestic dwelling at Drummargettie, Crathie, Braemar. This follows on from the Level One Standing Building Survey carried out by Cameron Archaeology in October 2017 (Cameron Archaeology 2017); the walls recorded had been removed prior to this watching brief. This previous work examined and recorded several remaining structures consisting of two longhouses and two enclosures from Drummargettie Township (NO29NW 12) in advance of construction of a domestic dwelling structure. No archaeological features or finds were noted during the soil strip, and no other archaeological mitigation is deemed necessary for the current planning application.

# 1 BACKGROUND

- 1.1 The site (Illus 1) is located Drummargettie, north of Mains of Monaltrie. It is centred on NGR NO 2412 9559, at 351-357m OD in the parish of Crathie and Braemar.
- 1.2 The work was commissioned by Jamie Kinghorn, Moxon Architects for Mr and Mrs Fennema. An application APP/2018/0233 for erection of a house and garage and this includes an archaeology condition (condition 6) for this WSI and a watching brief during the soil strip for this development.
- 1.3 All the archaeological work was carried out in the context of Scottish Planning Policy (SPP) Planning Advice Note (PAN 2/2011) and Historic Environment Scotland's Policy Statement (HESPS) which state that archaeological remains should be regarded as part of the environment to be protected and managed.

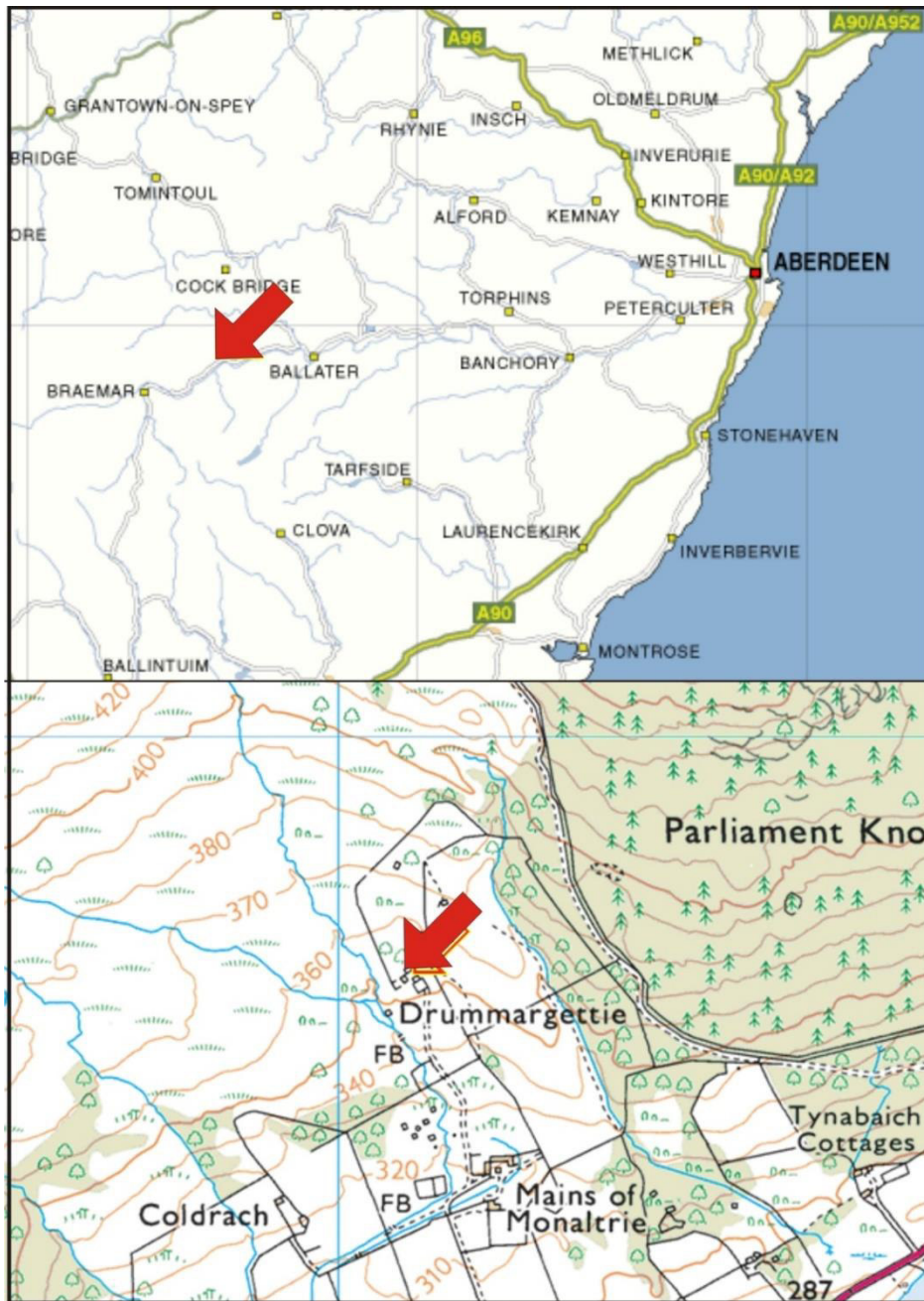

Illus 1 Location plan (Contains Ordnance Survey data © Crown copyright and database right 2018)

## 2 THE WATCHING BRIEF

On October 15th, 2018 a watching brief took place during a 15x30m<sup>2</sup> soil strip for a domestic dwelling on site and follows on from the Level One Standing Building Survey carried out by Cameron Archaeology (Cameron Archaeology 2017) and the Written Scheme of Investigation. The site of the proposed development lies at the southern end of the abandoned Drummargettie Township, at the end of an unpaved single track running past Mains of Monaltrie Farm. In recent years, the land appears to be used as rough grazing, and gradually rises beyond the project area to the north towards the east flank of Creag Mhor (506m).

The soil strip was performed using a six-ton tracked excavator with a bladed bucket. A dumper was allowed to run in areas once they were inspected and cleared. The topsoil depth ranged between 200 and 280mm, consisting of a dark brown peaty clay loam. The subsoil consisted of a light grey to mid-brown sandy clay with moderate stone inclusions. A natural gully or water channel cut approximately diagonally across the site, running downslope in an irregular fashion. A section with the machine bucket was cut to confirm this was a natural feature. The gully was infilled with topsoil and no finds or archaeological features were noted throughout the watching brief area.

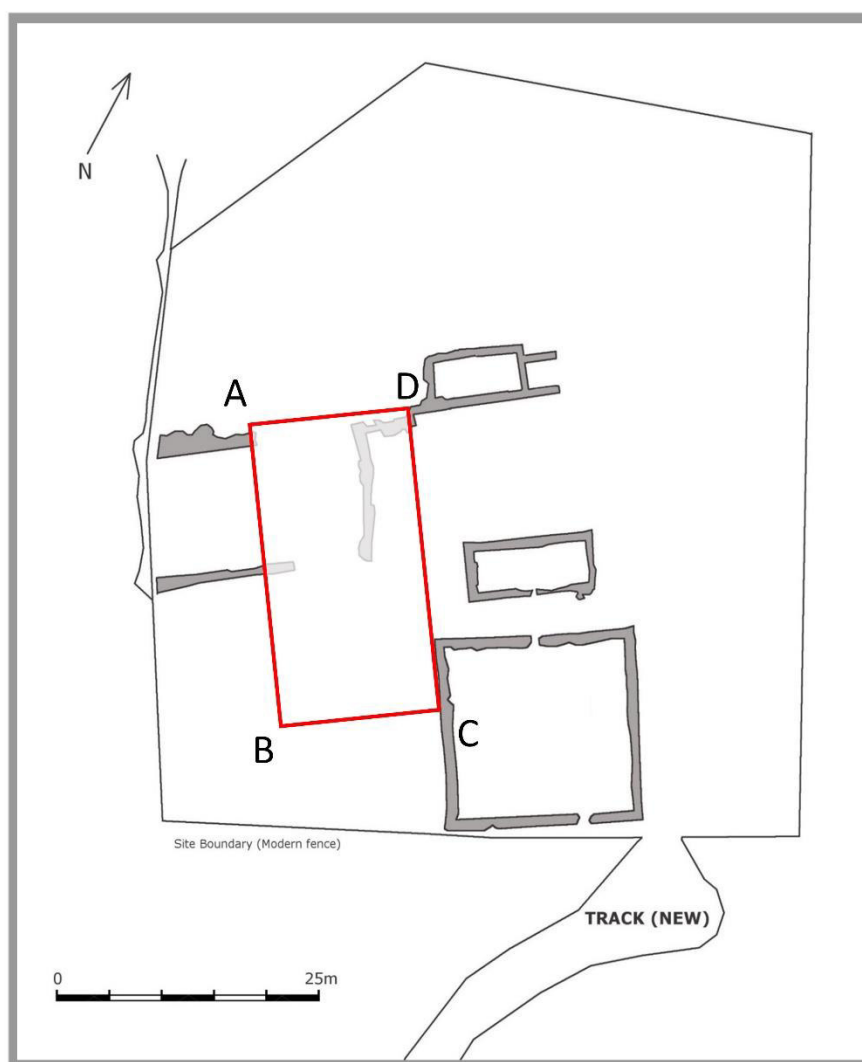

Illus 2 GPS Location of watching brief area, superimposed upon previous building foundations or external walling recorded during the Level One survey in 2017. Northing and Eastings for A-D are given in Table 1, below (image c.Digital Globe/Google 2018).

| <b>Long/Lat in decimal degrees and OSGB 1936 Northings and Eastings</b> |
|-------------------------------------------------------------------------|
| <b>A</b> 57.045155, -3.252635, NO24096 95595, 324096, 795595            |
| <b>B</b> 57.044938, -3.252382, NO24111 95570, 324111, 795570            |
| <b>C</b> 57.045009, -3.252178, NO24124 95578, 324124, 795578            |
| <b>D</b> 57.045219, -3.252441, NO24108 95602, 324108, 795602            |

Table 1: Locations of corner co-ordinates in Illus 3 for the watching brief.



Illus 3 Soil strip nearing completion. Note dark band which comprises shallow (under 0.30m) natural gully in front of dumper, running downslope.

### **3 CONCLUSIONS**

The walls previously recorded (Lenfert 2017) had been removed prior to this watching brief. Other than the shallow natural gully which passes through part of the soil strip area (note dark band in foreground of dumper, Illus 3, above), the site was relatively uniform and archaeologically sterile. No archaeological finds or features were noted during this watching brief, and no further archaeological mitigation is deemed necessary under the current planning application.

## 4 REFERENCES

Aberdeenshire SMR. 2017. 'Drummargettie' accessed at:  
<https://online.aberdeenshire.gov.uk/smrpub/master/detail.aspx?Authority=ASH&refno=N029NW0004> as of 27-10-2017

Lenfert, R. 2017. 'CA368-2017 Drummargettie, Crathie, Aberdeenshire, Level One Standing Building Survey' Unpublished client report, Cameron Archaeology.

Historic Environment Scotland. 2017. 'Drummargettie' accessed at:  
<https://canmore.org.uk/site/155262/drummargettie> as of 27-10-2017.

## 5 ACKNOWLEDGEMENTS

Thanks to Katy Fennema and Jamie Kinghorn, Moxon Architects for initiating this project and to Claire Herbert, Aberdeenshire Council Archaeology Service for her advice during this work.

Cameron Archaeology  
45 View Terrace  
Aberdeen  
AB25 2RS  
01224 643020  
07581 181057  
cameronarch@btinternet.com  
www.cameronarchaeology.com  
Company registration no 372223 (Scotland)  
VAT registration no 990 4373 00

**APPENDIX 1 MAPS**

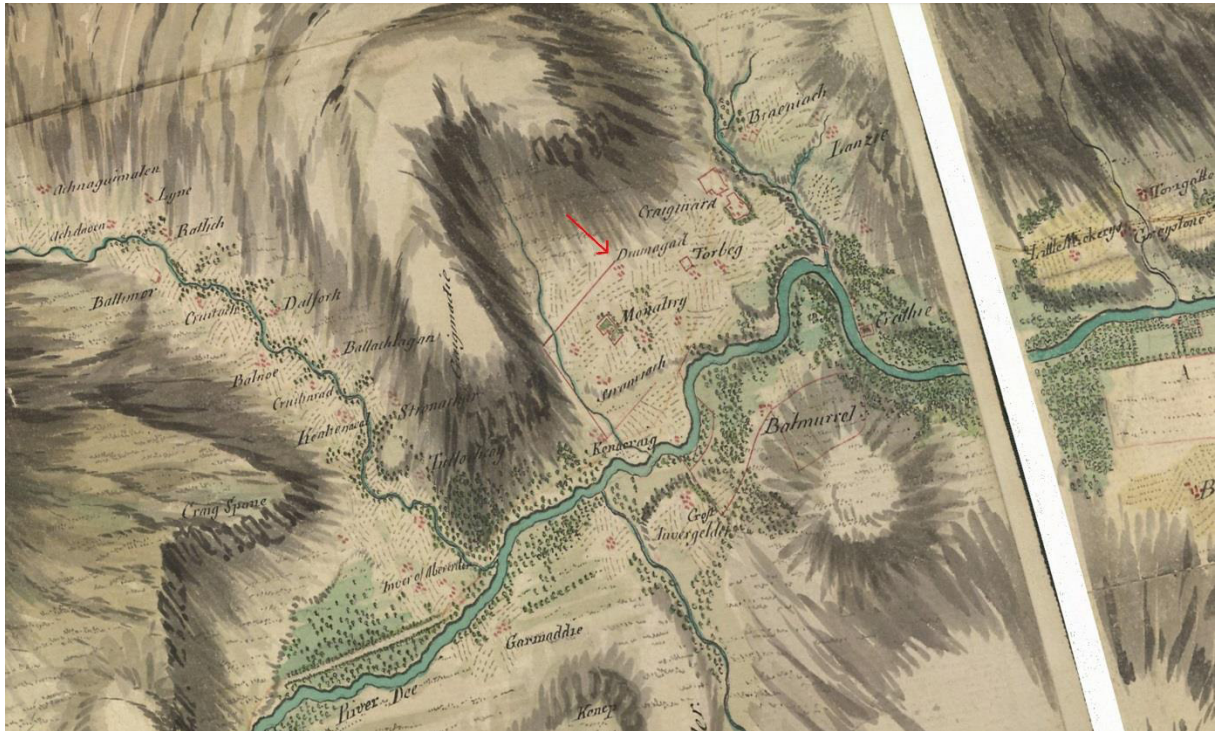

Illus 4: Roy Military Map of 1747-55 showing 'Drumagad' - red arrow. (copyright National Library of Scotland).

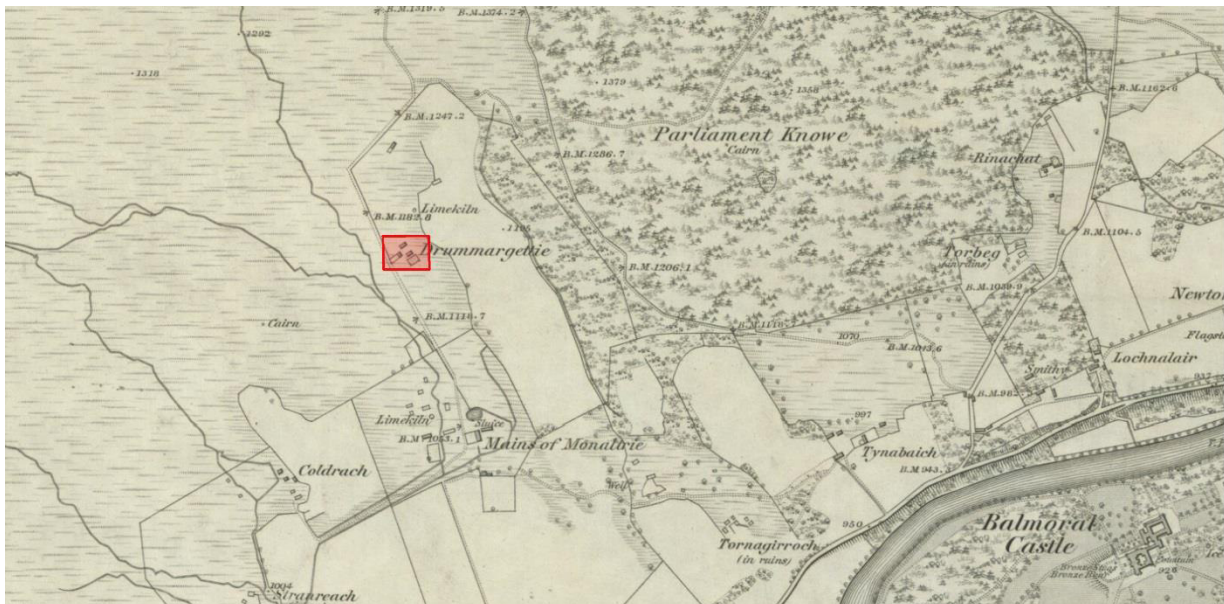

Illus 5: First Edition OS map, Sheet XC, surveyed 1866 – published 1869, showing site outline in red (copyright National Library of Scotland)

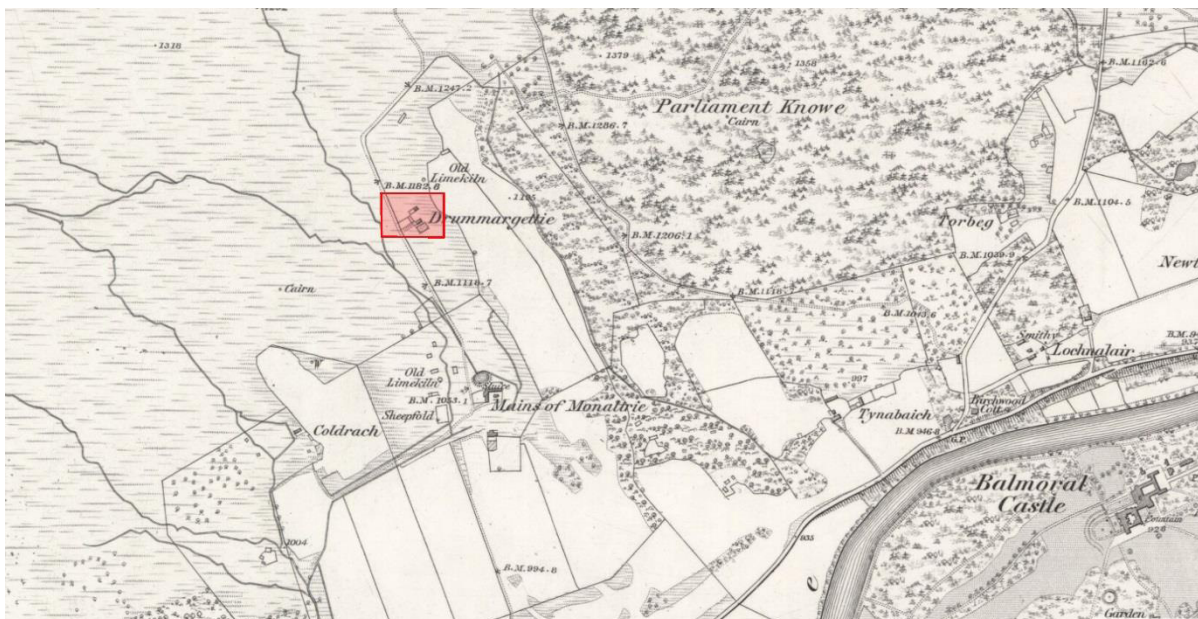

Illus 6 Second Edition OS map, Sheet XC, updated 1900 – published 1903, showing site outline in red (copyright National Library of Scotland).

## APPENDIX 2 PHOTOS

| Photo ID   | Direction Facing | Comments                                                                                     |
|------------|------------------|----------------------------------------------------------------------------------------------|
| CA368WB-1  | NW               | Soil strip prior to commencing. The grass and upper vegetation was removed prior to arrival. |
| CA368WB-2  | NW               | First pass of soil strip complete                                                            |
| CA368WB-3  | NE               | North half of soil strip nearing completion                                                  |
| CA368WB-4  | ENE              | View of central area of soil strip, nearing completion.                                      |
| CA368WB-5  | SE               | Overall soil strip nearing completion.                                                       |
| CA368WB-6  | SE               | Overall soil strip nearing completion.                                                       |
| CA368WB-7  | NW               | Overall soil strip nearing completion.                                                       |
| CA368WB-8  | NNW              | Overall soil strip nearing completion.                                                       |
| CA368WB-9  | SW               | Area of soil strip completed. Dumper tracks are outwith the soil strip area.                 |
| CA368WB-10 | W                | Area of soil strip completed. Dumper tracks are outwith the soil strip area.                 |
| CA368WB-11 | NW               | Area of soil strip completed. Dumper tracks are outwith the soil strip area.                 |





CA368WB-1.jpg



CA368WB-2.jpg



CA368WB-3.jpg



CA368WB-4.jpg



CA368WB-5.jpg



CA368WB-6.jpg



CA368WB-7.jpg



CA368WB-8.jpg



CA368WB-9.jpg



CA368WB-10.jpg



CA368WB-11.jpg