

**Kirkton Farm Steading, Kirkton Road, Inverkeilor,
Arbroath, DD11 5SA
Report on Level 2 Standing Building Survey
Angus Council planning ref 18/00117/PPPL**



**Alison Cameron
Cameron Archaeology
4 January 2019**

CONTENTS

1	INTRODUCTION.....	4
2	BACKGROUND	5
3	THE LEVEL 2 STANDING BUILDING SURVEY	5
3.1	BUILDING 1.....	6
3.1.1	Phase 1	6
3.1.2	Phase 2	8
3.1.3	Phase 3 and later.....	12
3.2	BUILDING 2.....	15
3.3	BUILDING 2A	21
3.4	BUILDING 3.....	22
3.5	BUILDING 4.....	24
4	CONCLUSIONS AND RECOMMENDATIONS.....	28
5	REFERENCES.....	29
6	ACKNOWLEDGEMENTS.....	29
	APPENDIX 1 MAPS.....	30
	APPENDIX 2 PHOTOGRAPHS	34

ILLUSTRATIONS

Cover: (top) SW façade Room 6B; facing NE. (bottom) 1771 date stone on NNW gable Building 2; facing SSE

Illus 1	Location plan	4
Illus 2	Plan showing buildings recorded during this survey (copyright Bell Ingram Design) ...	6
Illus 3	Building 1 Room 3 NW wall D25 with red sandstone facing	7
Illus 4	Room 6A NE wall door to courtyard D16 showing sunken midden wall.....	7
Illus 5	Building 1 Room 7A NW wall W1 (left blocked with red sandstone) and W2	8
Illus 6	Building 1 Room 1 NE wall cart door D3; facing SW	9
Illus 7	SW wall Room 6B with D3 (top left) D20 (right); facing SW.....	9
Illus 8	Building 1 annotated with numbers used in this survey	10
Illus 9	Building 1 main elevations annotated with numbers used in this survey	11
Illus 10	Building 1 Room 10 red brick extension; facing N.....	12
Illus 11	Building 1 Room 11 overgrown Dutch barn; facing SE.....	13
Illus 12	Building 1 elevations 1, 2, 3 and 5 annotated with numbers used in this survey.....	13
Illus 13	Building 1 elevations 6-8 annotated with numbers used in this survey	14
Illus 14	Building 1 NW elevation (elevation 9) annotated with numbers used in this survey.	14
Illus 15	Sections 1 and 2	15
Illus 16	Buildings 2, 2A and 3 ground and first floor plans	16
Illus 17	Elevations 10-12	17
Illus 18	Building 2 elevations 14-16 annotated with numbers used in this survey	17
Illus 19	Building 2 elevation 17 and Building 2A elevation 18	18
Illus 20	Building 2 gable (bottom) Building 2A gable (above); facing SSE	18
Illus 21	Building 2 WSW wall W14 and W16 (top) W15 below infilled with stone	19
Illus 22	Interior of NNW gable with chimney (centre), D41 (top right)	19

Illus 23 NNW gable upper section showing D41 (top left) with dated skewputt F3 (left);	20
Illus 24 NNW gable lower section showing D41 (top left) with dated skewputt F3 (left) and blocked D42 (bottom); facing SSE	20
Illus 25 Detail of grey sandstone tooled skewputt with 1771 inscribed; facing SSE	21
Illus 26 Building 2A ENE wall D43; facing WSW	21
Illus 27 Building 2A WSW wall photographed through door with W13 (right); facing WSW..	22
Illus 28 Building 3 elevations	23
Illus 29 Building 3; facing S	23
Illus 30 Building 4 plan and elevations	24
Illus 31 Building 4 elevations	25
Illus 32 Building 4; facing SW	26
Illus 33 Building 4; facing NW	26
Illus 34 Building 4; facing NE	27
Illus 35 Building 4; facing SE	27
Illus 36 Building 4 interior; facing SW	27
Illus 37 Building 1 phase plan	28
Illus 38 Buildings 2, 2a and 3 phase plan	29
Illus 39 Roy map showing approximate area of site (circled)	30
Illus 40 Moll map showing approximate area of site (circled)	30
Illus 41 Thomson map showing approximate area of site (circled)	31
Illus 42 Gall and Inglis map showing approximate area of site (circled)	31
Illus 43 Edward map showing 'Innerkilur' and showing approximate area of site	32
Illus 44 First Edition Ordnance Survey map (copyright National Library of Scotland)	32
Illus 45 Second Edition Ordnance Survey map (copyright National Library of Scotland)	33
Illus 46 Third Edition Ordnance Survey map (copyright National Library of Scotland)	33
Illus 47 Camera points used in this survey – Building 1 (copyright Bell Ingram Design)	34
Illus 48 Camera points used in this survey – Buildings 2, 2A, 3	35
Illus 49 Camera points used in this survey – Building 4	35

SUMMARY

A Level 2 standing building survey was carried out on 10 December 2018; the weather was freezing and sunny. At least three phases of development were recorded. The farmstead and mill (Building 1) was originally a C-shaped range of buildings around a central courtyard with a horse mill on the SW side and a separate L-shaped building to the NW (Building 2). Later additions to the SW and SE and the horse mill was demolished and a red brick structure attached. The courtyard was then enclosed and additions made in the 20th century to the NE, SE and SW.

Building 2 was originally a rectangular structure; so little of the fabric remains it is not possible to determine definitely but it is likely to have been an agricultural (rather than a domestic) building. In Phase 2, prior to the First Edition OS map, a square stone single-storey building (Building 2A) was added onto the SSE end, one room with 1m thick walls. Building 2 was two storey and when it went out of use it was converted for domestic use with fireplaces added at the NNW end and Building 3 added to the NE side of Building 2.

The Standing Building Survey is complete but a watching brief will be carried out on the soil strip for the residential development.

1 INTRODUCTION

- 1.1 The site (Illus 1) is located on the NE side of Inverkeilor on Kirkton Road. It is centred on NGR NO 66572 49487, at 25-30m OD (Illus 1) and in the parish of Inverkeilor.
- 1.2 The work was commissioned by Lynne Watson. A planning application 18/00117/PPPL for demolition of existing steading and erection of dwellinghouses on brownfield site and adjacent paddock is a requirement for a Level 2 standing building survey and a watching brief during all groundworks.
- 1.3 All the archaeological work was carried out in the context of Scottish Planning Policy (SPP) Planning Advice Note (PAN 2/2011) and Scottish Historic Environment Scotland's Policy Statement (HESPS), which state that archaeological remains should be regarded as part of the environment to be protected and managed.

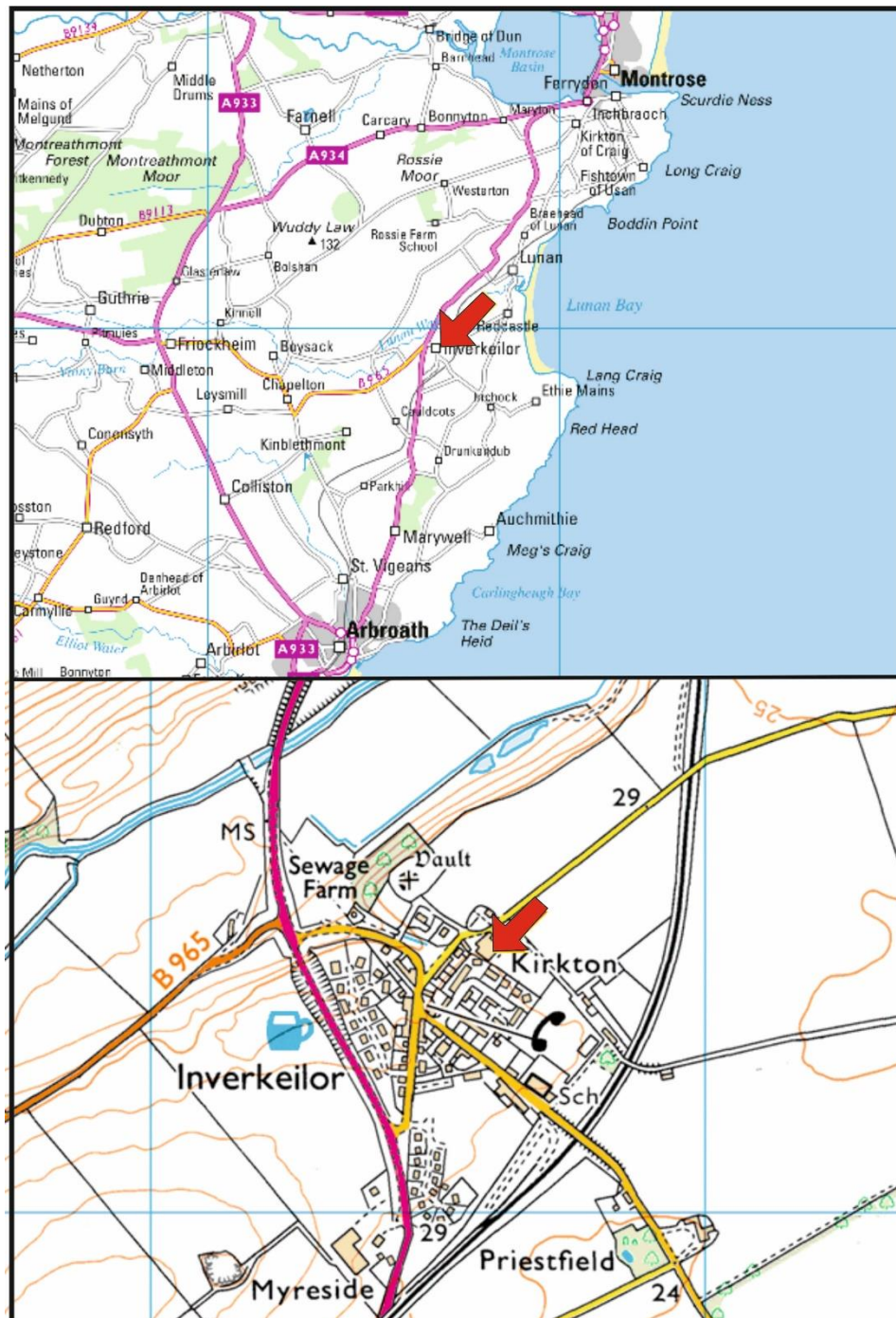

Illus 1 Location plan (Contains Ordnance Survey data © Crown copyright and database right 2019)

2 BACKGROUND

Aberdeenshire SMR (NO64NE38) details the site as a farmstead and C-listed farmhouse, still in use. The farmhouse is not included in this application. The 1st edition OS map shows a shallow L-plan farmhouse to the west of a quadrangular steading, which is open to the north-east and has an attached horsemill to the south-west. There is a rectangular building to the north-east of the steading, and another to the north of the steading within a D-plan enclosure (outwith this proposed development). On the 2nd edition OS map, the farmhouse has been extended to the north-east and south-west. The court of the steading has been infilled and the horsemill removed. The building to the north has been extended to the north-east, and a rectangular building added to the north-west on the outside of the enclosure. Current maps show the building to the north-east of the steading and the building on the outside of the enclosure have both been removed. The farmhouse is a single-storey range constructed from rubble with a slate roof. It has a skewputt dated 1771, and it has been altered from its original form.

According to Pastmap (HES; NO64NE 38) the farm building was probably built in 1771, as indicated by the inscription on the skewputt to the northeast gable. This was a period of significant improvement in farming practices across Scotland, when many farmhouses and associated agricultural buildings were constructed. It lies in Inverkeilor, a small village occupied predominantly by weavers and agricultural workers in the late 18th century (Statistical Account of 1791-99). The Ordnance Survey Name Book for the parish of Forfar indicates that in the mid-19th century Kirkton was a 'good farm steading the property of the Earl of Dalhousie'. All buildings erected before 1840 which are of notable quality and survive predominantly in their original form have a strong case for consideration for listing. While farmhouses and associated steadings are a prolific building type, those associated with the introduction of early and improving farming practice (from roughly mid-18th to the mid-19th centuries), which demonstrate quality of design and construction and which remain to a greater or lesser degree in their original form, including their setting, may have interest in listing terms. Kirkton Farm Building is a relatively early example, but there has been incremental change and a significant loss of fabric. The longer northwest part of the building is roofless and its northeast wall is incomplete. There is a wide, full-height aperture edged mostly in brick at the northwest end of this wall, and another wide gap in the same wall to the southeast with unfinished margins (HES delisting document). The building was listed C in 1980 and has been delisted in 2017.

The Lunan Valley project refers to Kirkton. It states that the 'main house is isolated by a circuit from the improved steadings. Kirkton farmhouse, closer to the kirk and on higher ground than the present steading, is likely to be the earlier site of the farm assuming the concentric wall to mark the line of its earlier enclosure. Although curvilinear walls are associated with planned landscapes at the centre of large estates from the 18th century (as at Kinblethmont, NO 638 470 and Lawton House, NO 637 485) small discrete enclosures concentric to farm buildings may have an early ancestry' (Pollock 1987, 379).

3 THE LEVEL 2 STANDING BUILDING SURVEY

A Level 2 standing building survey was carried out on 10 December 2018; the weather was freezing and sunny. At least three main phases of development were recorded and several other additions (Illus 2). Architects plans were checked and annotated and other plans and elevations drawn as required.

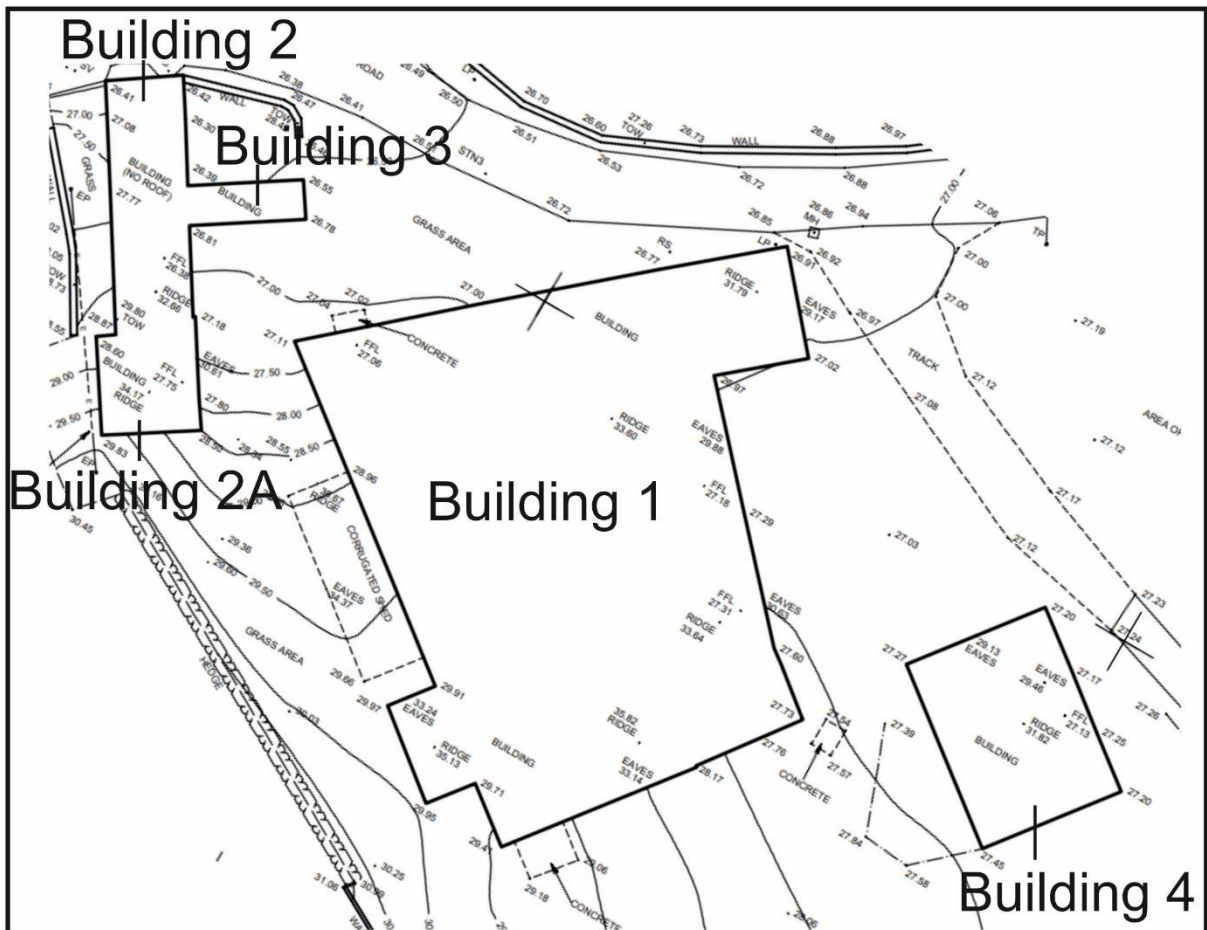

Illus 2 Plan showing buildings recorded during this survey (copyright Bell Ingram Design)

3.1 BUILDING 1

Building 1 (Illus 3-15) is a C-shaped series of ranges around a central courtyard with an opening in the NE elevation. Later additions have enclosed and covered the courtyard with additions on all aspects.

3.1.1 Phase 1

Phase 1 includes Rooms 3, 6, 7A, 8 and 9. Room 3 is on the SE side of the courtyard and is 18.7m long and 5.8m wide; it has a large door to the central courtyard (D25; Illus 3) which has been blocked and replaced by a small window (W11) and three smaller doors to the courtyard (D24, D26 and D27) and one to the SE (D23). After Room 6A was added to the SE side, upper windows were added (W3 and W12). There is a large door in the NE wall (D28) and a window (W6). Room 1 was originally built as an agricultural building and continued in agricultural use with alterations including blocking doors in the NW wall and opening larger doors in the SE wall for machine access presumably around the time that the courtyard (Room 2) was enclosed.



Illus 3 Building 1 Room 3 NW wall D25 with red sandstone facing, blocked with stone and whitewashed and small window W11 added; facing SE

Rooms 6 A and B is 29.8m long and 5.2m wide but has been extended to the SE in Phase 2. The original room had two doors to the courtyard (D16, D17) and access to the exterior (D18). There is no access to most of this room now as it is infested with pigeons with piles of faeces on the floor. There was a circular horsemill attached to the SW wall of this building on the First Edition OS map (Illus 44) and so the original use of the room was as a mill but the SW wall of Room 6A has been rebuilt and plastered for later use for housing animals and so there is now no trace of the apertures for the horsemill. The current owner remembers the threshing mill in use in the loft of Rooms 6A and B with a hammer mill on the ground floor which turned the grain into meal for feeding the cattle. There was an electric mill from the 1940s in Room 10. There was no commercial use of the mill during the memory of the current owner.



Illus 4 Room 6A NE wall door to courtyard D16 showing sunken midden wall and wooden trough (foreground); facing SW

Room 7A was probably constructed in Phase 1 for a bothy (domestic use). It is 5.9m wide and 7.2m long with small window in the NW wall (W1; Illus 5) and windows added to the NW wall (W2; Illus 5) and the NE wall (W5) in Phase 3. There is no access to the interior of this structure as it is overgrown and so it was not possible to check for evidence of fireplaces or other internal structures. Later a concrete block structure was added to the SE side (Room 7b; see below).



Illus 5 Building 1 Room 7A NW wall W1 (left blocked with red sandstone) and W2 inserted in Phase 3; facing SE

Room 8 is the NW wing of the farm and was constructed for agricultural use; it is 5.9m wide and 24-25m long (Room 9 has been added at an angle on the SW end). The NW façade facing Kirkton Road is built in red sandstone with doors D29, D30, D31 and D32 in red sandstone. These doors have then been blocked and larger door D33 added. There are doors in the SE wall through to the former courtyard (Room 2), D9 and D13 are original whereas D10 has been widened with concrete bricks.

Room 9 is located at the W corner of the farm forming the W corner of the courtyard. It is a maximum of 9m long and 5.6m wide internally and was for agricultural use. It has a main door in the NW wall (D14) and doors to Room 8 (D11) and the courtyard (D15).

3.1.2 Phase 2

In Phase 2 stone additions were added including Rooms 1 and 6B.

Room 1 is on the NE side of the courtyard; it has three large cart doors (D1, D2 and D3; Illus 6) on the NE wall constructed with pillars of tooled sandstone. Each door is 2.9m wide and 2.55m high. There was originally a fourth door to the NW which was infilled when Room 7B was constructed and two smaller doors constructed (D6 and D8) but there is no access to this area as it is overgrown. At the SE end of the NW wall of Room 1 there is a small infill door D35. The room would have formed the NE entrance to the courtyard for carts and horses and was then enclosed when the courtyard was roofed.



Illus 6 Building 1 Room 1 NE wall cart door D3; facing SW

Room 6B was built onto the SE side of Room 3 in the S corner of the farm. It has large doors on the SE wall; D21 is 4m wide and 4m high and D22 is 3.4m wide and 1.9m high and ground floor D20 and first floor door D37 and on the SW wall (Illus 7). There are upper windows in this wall (W9 and W10) and windows on the NW wall (W3 and W12). These were all later blocked with modern red brick. The room was originally part of the mill structure but was adapted for agricultural use with large tractor doors on the SE wall.



Illus 7 SW wall Room 6B with D3 (top left) D20 (right); facing SW

Illus 8 Building 1 annotated with numbers used in this survey including room, door, window, feature, elevation and section numbers
(from copyright Bell Ingram Design)

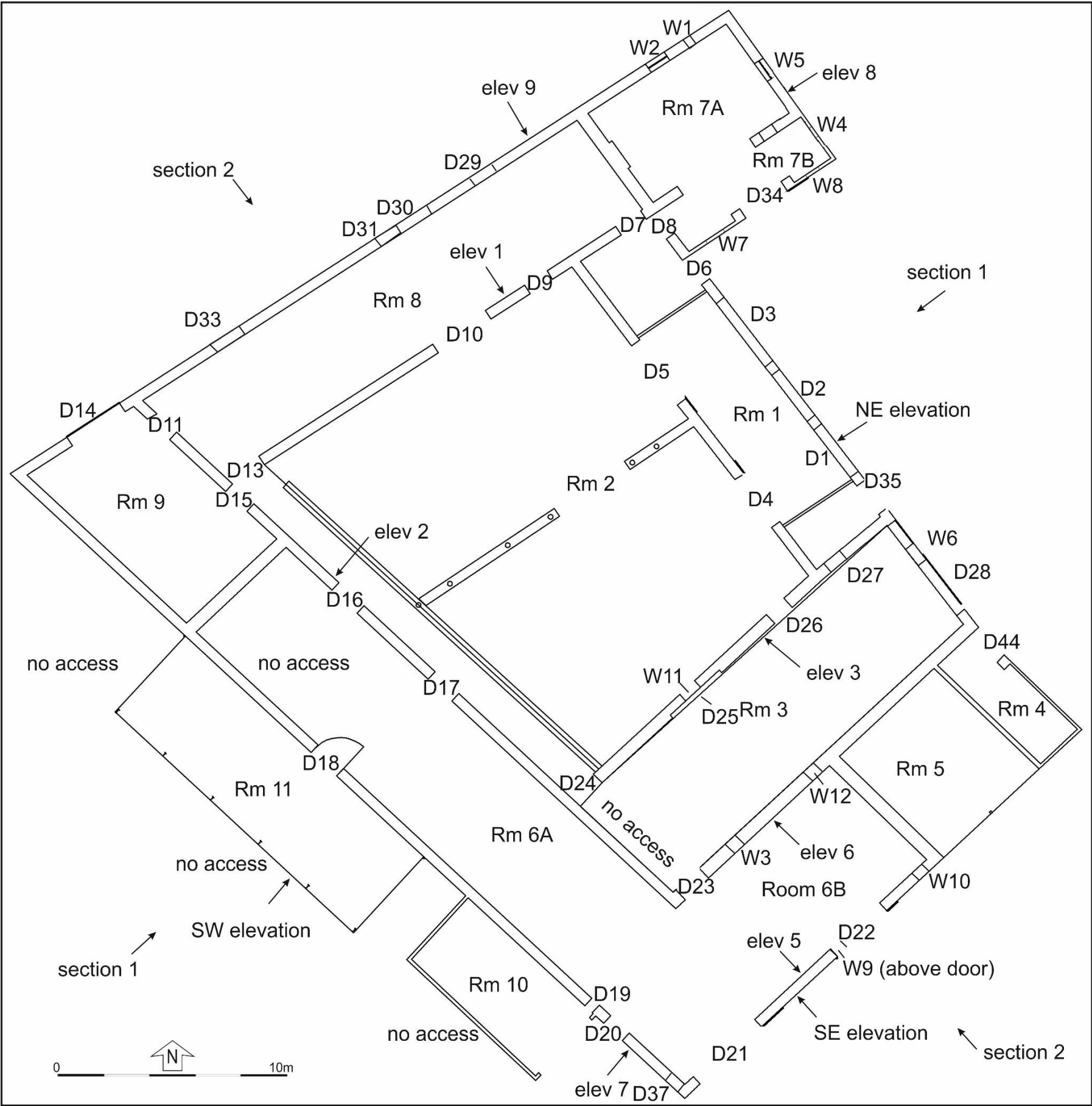



Illus 9 Building 1 main elevations annotated with numbers used in this survey (copyright Bell Ingram Design)

3.1.3 Phase 3 and later

Room 2 is the covered courtyard which was enclosed in Phase 3 and used for general agricultural use. It is 17.6-18.7m long and 17.5-18.5m wide. It has doors to Room 8 in the NW (D9 and D10 which has been altered latterly and widened with concrete bricks), D15, D16 and D17 to Room 6A in the SW, D25 (now blocked), D26 and D27 to Room 3 in the SE. Large doors D4 and D5 on the NE side now divide the courtyard from Room 1. Room 2 has been divided NE-SE with a low stone wall with a wooden and cast iron pillared structure. It is in the style of a sunken midden with a raised cobbled path 1m wide along the SW side with stone wall below and a wooden trough along the full length of the SW wall.

Room 4 has been constructed in the E corner of the farm. It is 5.7m wide and 3.1m long with a door in the NE wall (D44). It is constructed of concrete blocks with a corrugated metal roof and was presumably for storage.

Room 5 is the space created between Room 4 to the NE and Room 6B to the SW; it is 5.7m wide and 5.7m long. It has a high concrete wall on the NE side and the SW wall is formed from the NE wall of Room 6B. It has a wood and corrugated metal roof. It is a covered storage area.

Room 7b is 3m wide and 7.2m long and constructed of concrete blocks. It has cast iron windows in the NE wall (W4) and door D34 and windows (W7 and W8) in the SE wall. There is no access to this room as it is overgrown. It was presumably an extension to the domestic accommodation with door and windows on the SE facade.

Room 10 is a red brick extension on the SW of the farm (Illus 10); it is originally the site of a circular horse mill seen on the First Edition OS map (Illus 44). There is no access to this building as the area is overgrown and the doors blocked.



Illus 10 Building 1 Room 10 red brick extension; facing N

Room 11 is a wooden Dutch barn attached to the SW wall of Room 6A (Illus 11). There is no access to this building as the area is overgrown but there is a blocked door between this room and Room 6A (D19). It is approximately 5 x 16m in size.



Illus 11 Building 1 Room 11 overgrown Dutch barn; facing SE

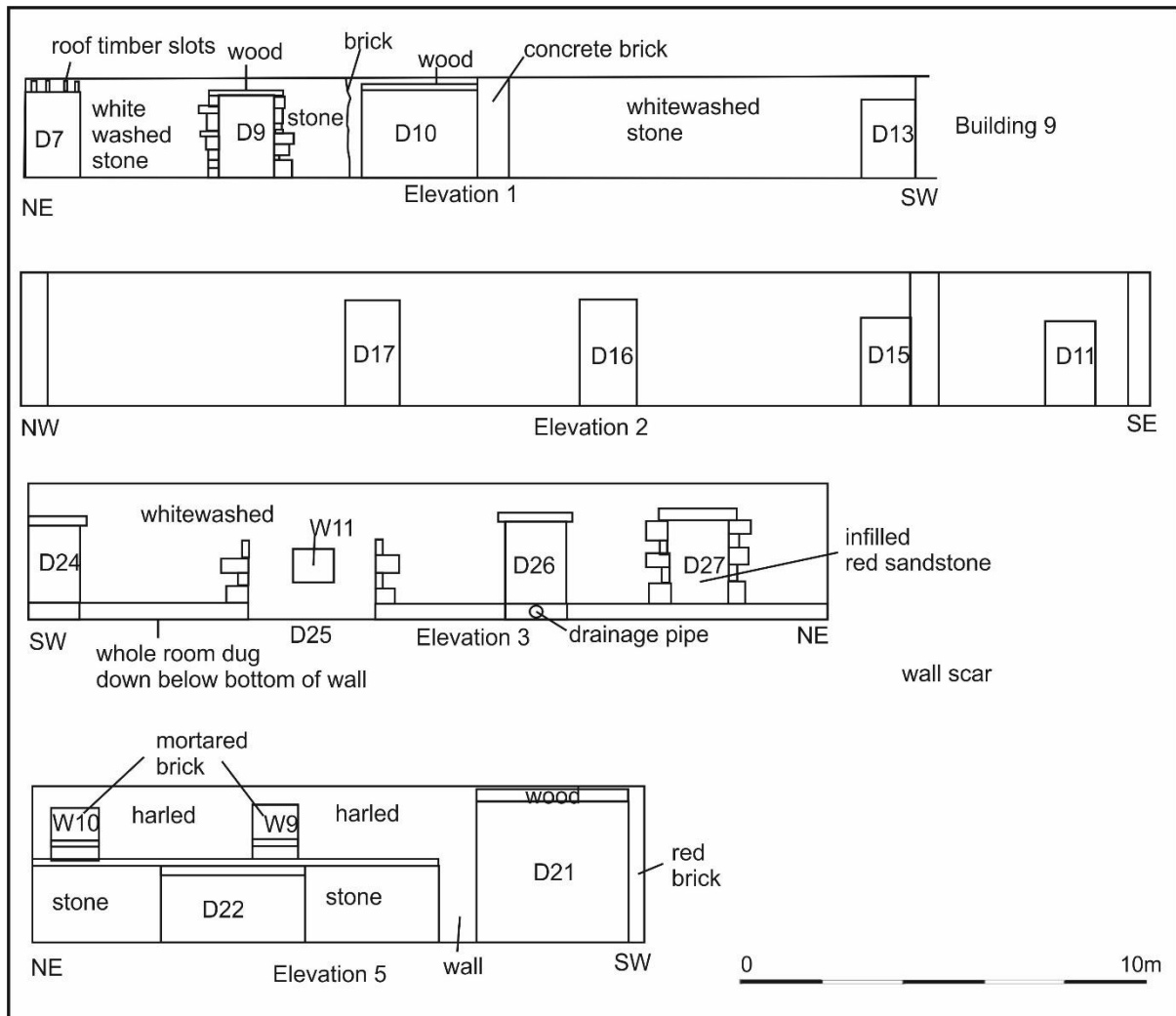

Illus 12 Building 1 elevations 1, 2, 3 and 5 annotated with numbers used in this survey

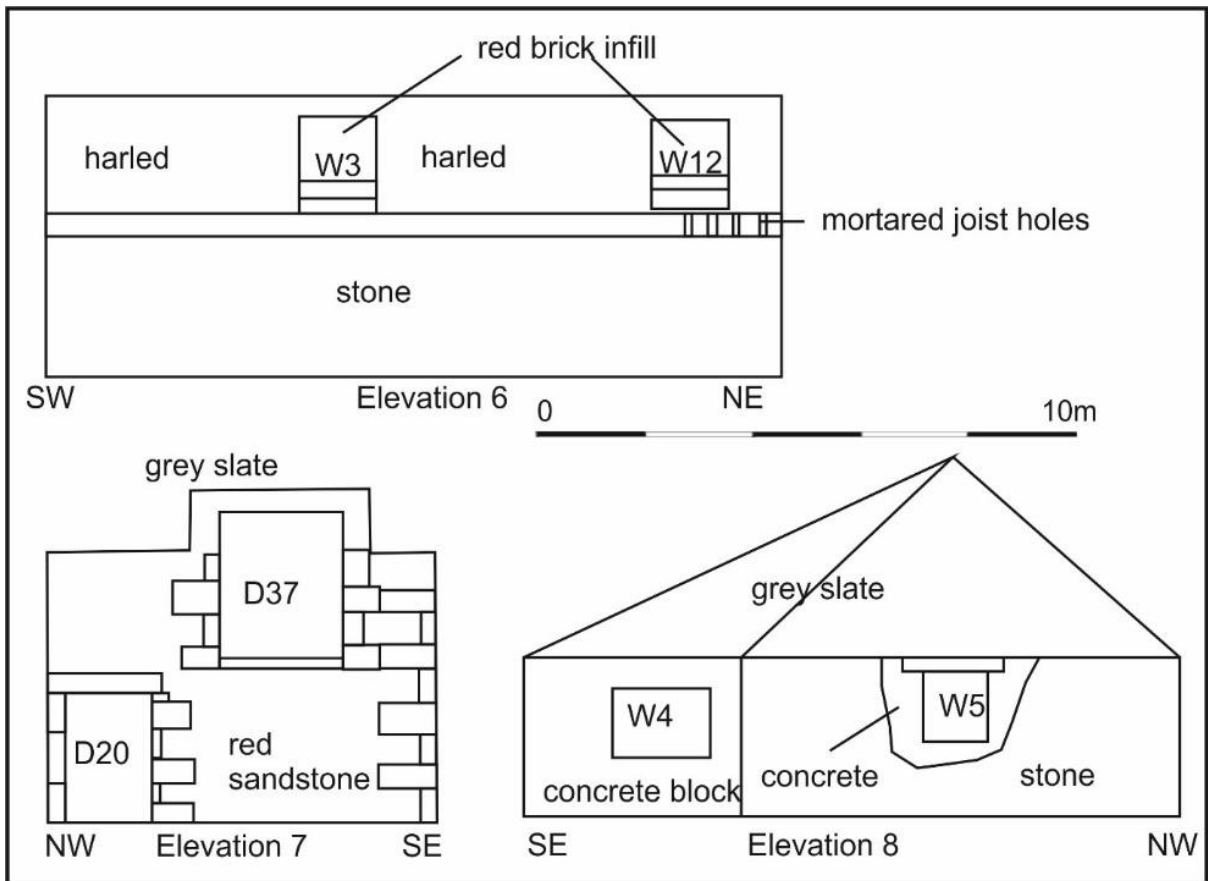

Illus 13 Building 1 elevations 6-8 annotated with numbers used in this survey

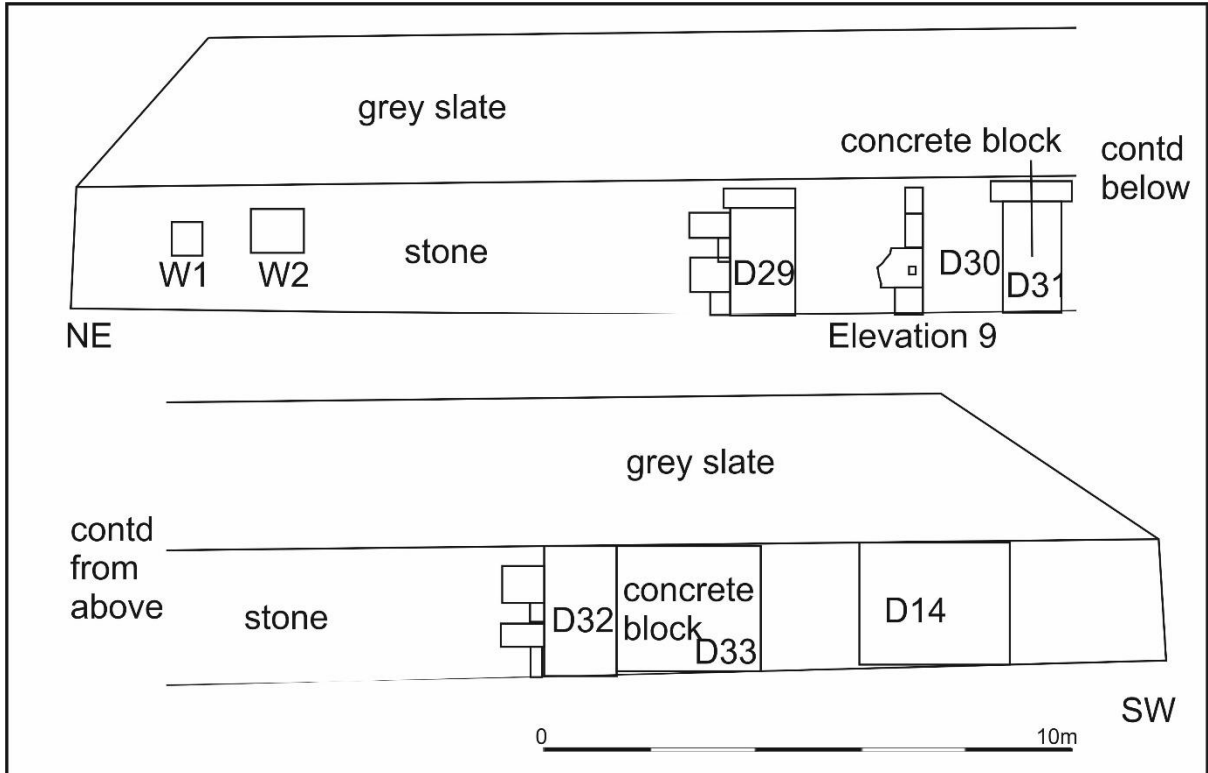

Illus 14 Building 1 NW elevation (elevation 9) annotated with numbers used in this survey

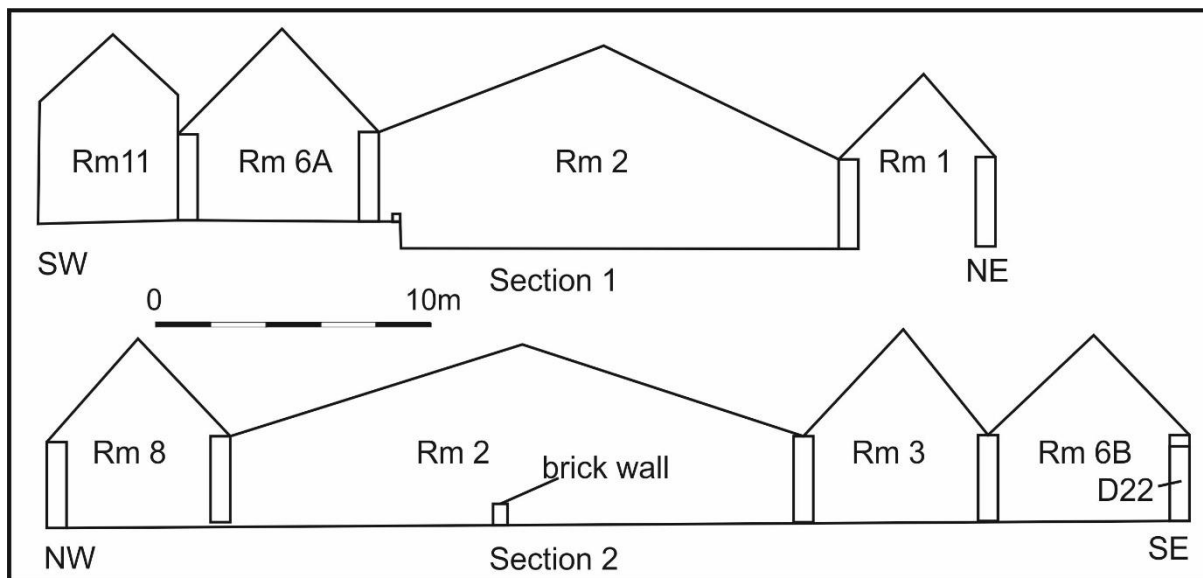

Illus 15 Sections 1 and 2

3.2 BUILDING 2

Building 2 (Illus 16-25) was mainly constructed in Phase 1 with Building 2A added in Phase 2 (Illus 20), prior to the First Edition OS map (Illus 44). It is 19.4m long and 6m wide and is mainly constructed of red sandstone; there is no roof surviving and much of the ENE wall has been demolished prior to this survey. It was originally two storeys but the building had been knocked into one room by the 1940s and was in use for housing cattle (current owner pers comm). There are small (0.6 x 0.78m) ground and first floor windows in the WSW wall (W14-18; Illus 21). W15, 17 and 18 have been blocked with stone and soil has been built up on the exterior (WSW) side of this wall to allow access to the neighbouring property. W14 and W16 remained open and are blocked with plywood. The building was two storeys and the level of the first floor can be seen as a scar on the wall (Illus 21). The ENE wall is mainly demolished but a section remains in the centre with two doors (D39, D40) and a large much later door opened in the NNW end of the wall (D38). The NNW gable is intact and has a dated skewput (F3, 1771; Illus 18, 25).

After D41 and D42 were blocked with red sandstone in the NNW wall, a chimney was added and a fireplace on the ground floor (F1; Illus 22) and probably also a fireplace on the first floor although this has been blocked and plastered over (Illus 17, 18, 22).

There is a concrete scar (F2) and small joist holes on the exterior of the WSW wall where two small, temporary buildings have been attached (Illus 19). They are probably the unroofed structures recorded on the 2nd and 3rd Edition OS maps (Illus 45-46). They had been demolished before the raised path was created which is an access to the neighbouring property.

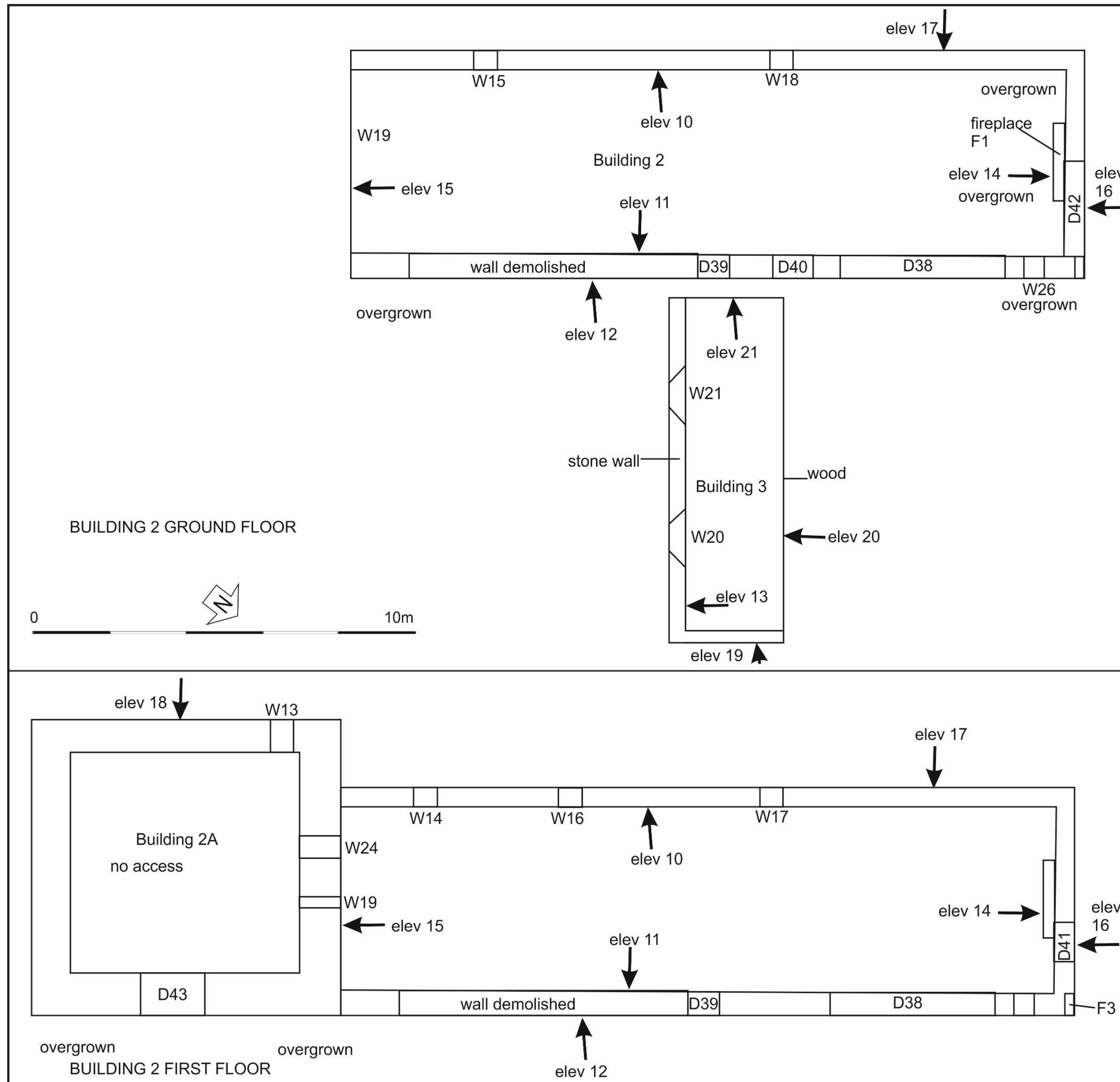

Illus 16 Buildings 2, 2A and 3 ground and first floor plans

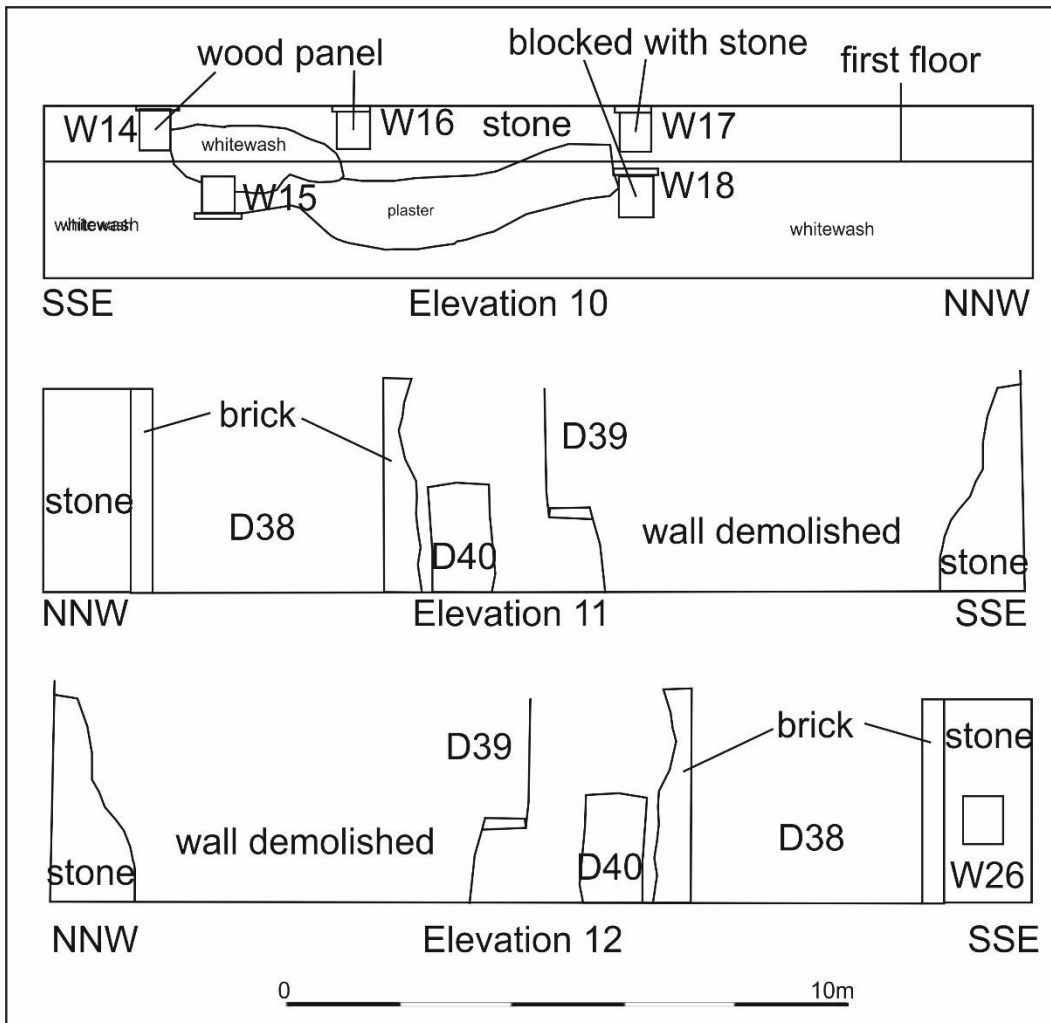

Illus 17 Elevations 10-12

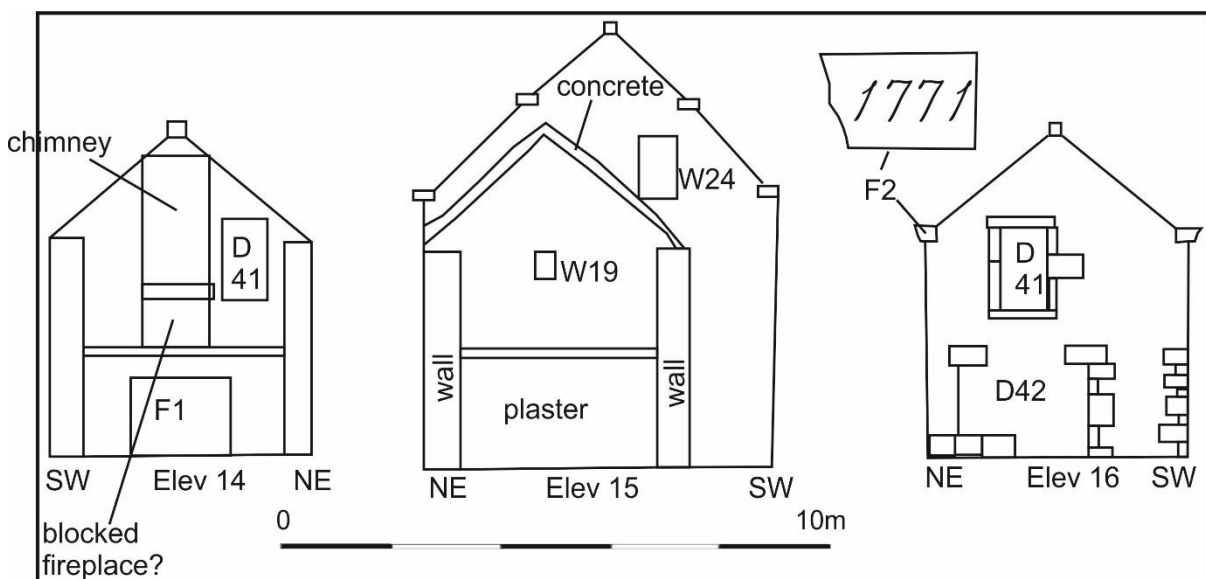

Illus 18 Building 2 elevations 14-16 annotated with numbers used in this survey

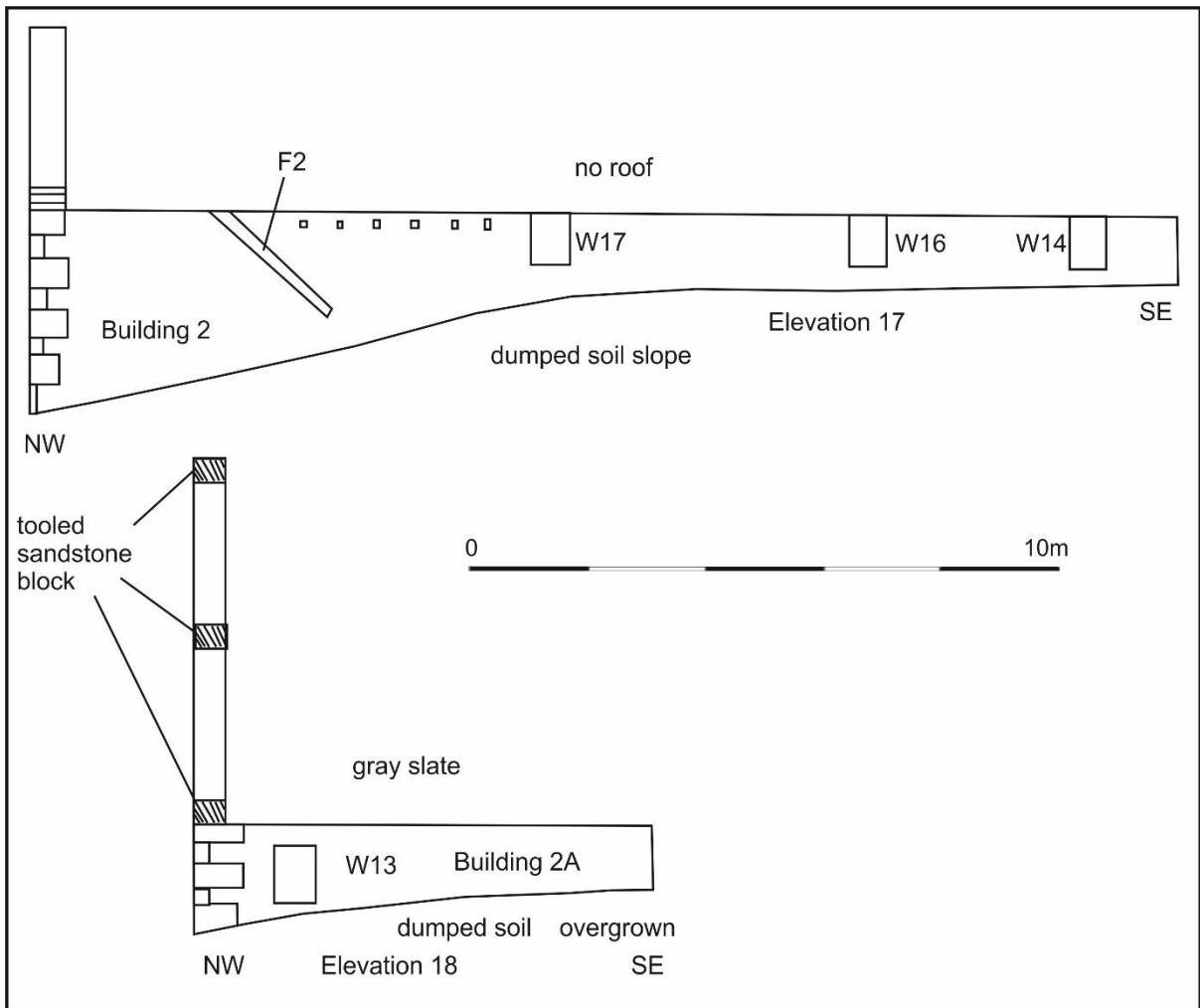

Illus 19 Building 2 elevation 17 and Building 2A elevation 18 annotated with numbers used in this survey



Illus 20 Building 2 gable (bottom) Building 2A gable (above); facing SSE



Illus 21 Building 2 WSW wall W14 and W16 (top) W15 below infilled with stone; facing WSW



Illus 22 Interior of NNW gable with chimney (centre), D41 (top right) showing overgrown interior; facing NNW



Illus 23 NNW gable upper section showing D41 (top left) with dated skewputt F3 (left); facing SSE



Illus 24 NNW gable lower section showing D41 (top left) with dated skewputt F3 (left) and blocked D42 (bottom); facing SSE



Illus 25 Detail of grey sandstone tooled skewputt with 1771 inscribed; facing SSE

3.3 BUILDING 2A

Building 2A (Illus 16, 26, 27) was added on to the SSE end of Building 2 in Phase 2. It is a single storey building consisting of one room 8 x 8m in size with 1m thick walls constructed of pink and grey sandstone rubble with grey slate roof. There is a door (D43) in the ENE wall and a window (W13) on the WSW façade. There is a small aperture in the upper levels of the NNW wall (W19) between Buildings 2A and 2. There is no access to the interior of this building as it is infested with pigeons and the floor is piled with bird faeces.

The roof has a crowstepped gable formed using three blocks of tooled grey sandstone (Illus 18-20).



Illus 26 Building 2A ENE wall D43; facing WSW



Illus 27 Building 2A WSW wall photographed through door with W13 (right); facing WSW

3.4 BUILDING 3

Building 3 (Illus 16, 28, 29) is 7m long and 2.5m wide with grey sandstone stone walls on the SSE and ENE façade and a wood superstructure on the NNW and WSW wall. It is tied into the ENE wall of Building 2 but the stone structures are separate. There are two windows in the SSE wall (W20 and W21) but there is little access as it is overgrown and the roof and wooden structure is in poor condition.

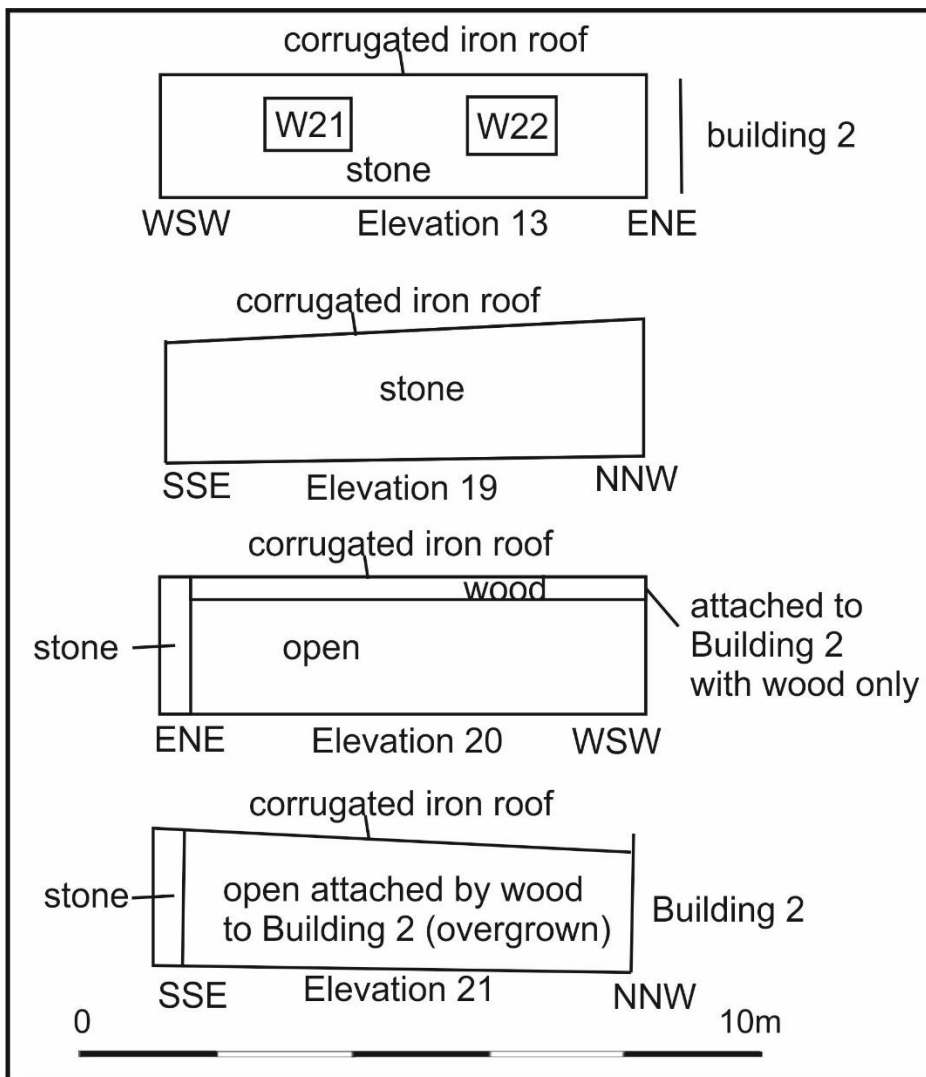

Illus 28 Building 3 elevations



Illus 29 Building 3; facing S

3.5 BUILDING 4

Building 4 (Illus 30-36) is a wood and concrete block shed on the NE side of the farm. The building is 14.9m long and 11m wide constructed of two skins of concrete blocks totaling 41cm thickness. The roof is wood and there are large doors in the NE and SW wall (D45, D46) which have been covered with wooden slats. These are now rotted on the NE side and the roof is in poor condition. The roof is supported internally by two concrete pillars. The building was probably constructed in the mid 20th century as a barn or storage.

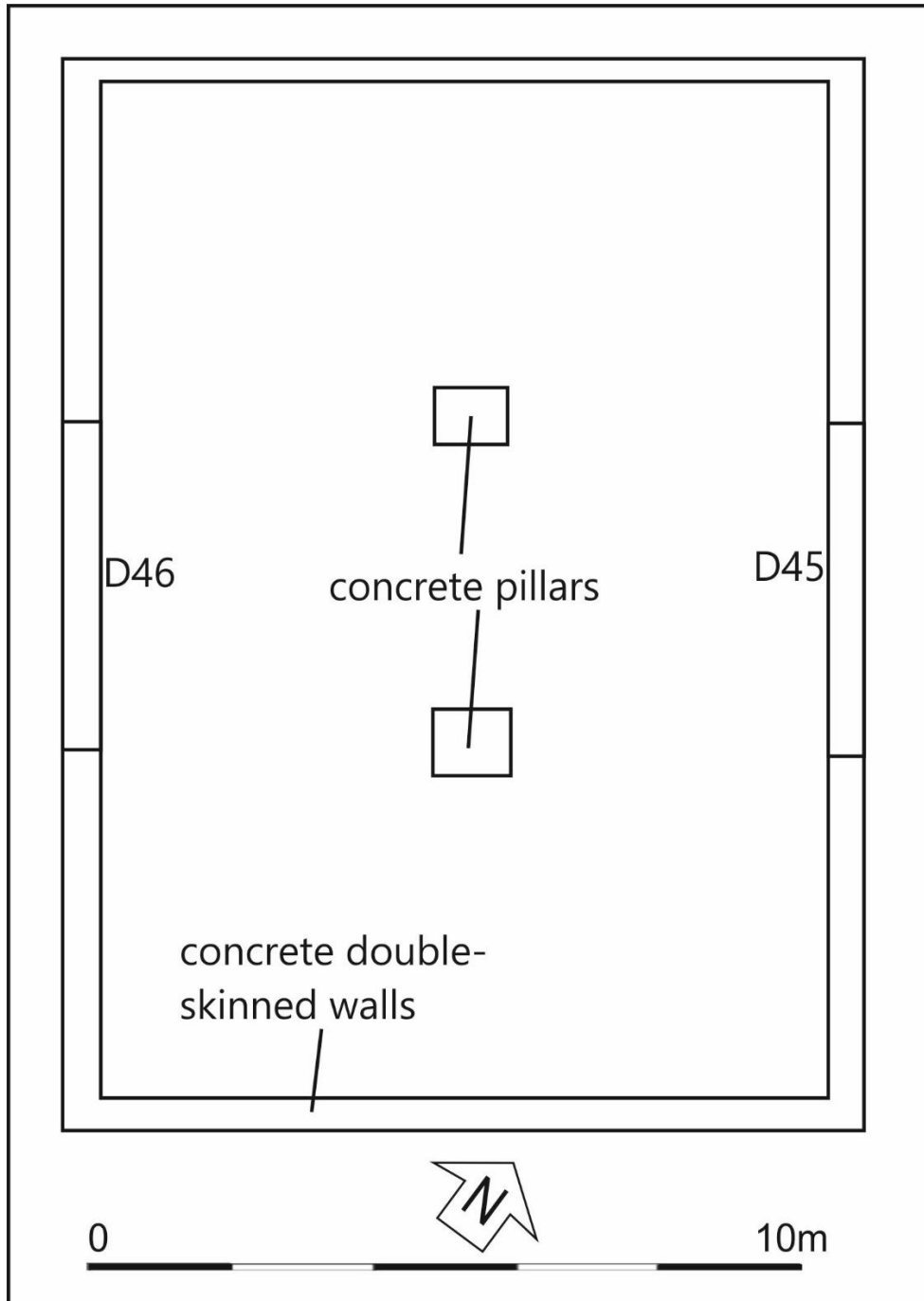

Illus 30 Building 4 plan and elevations

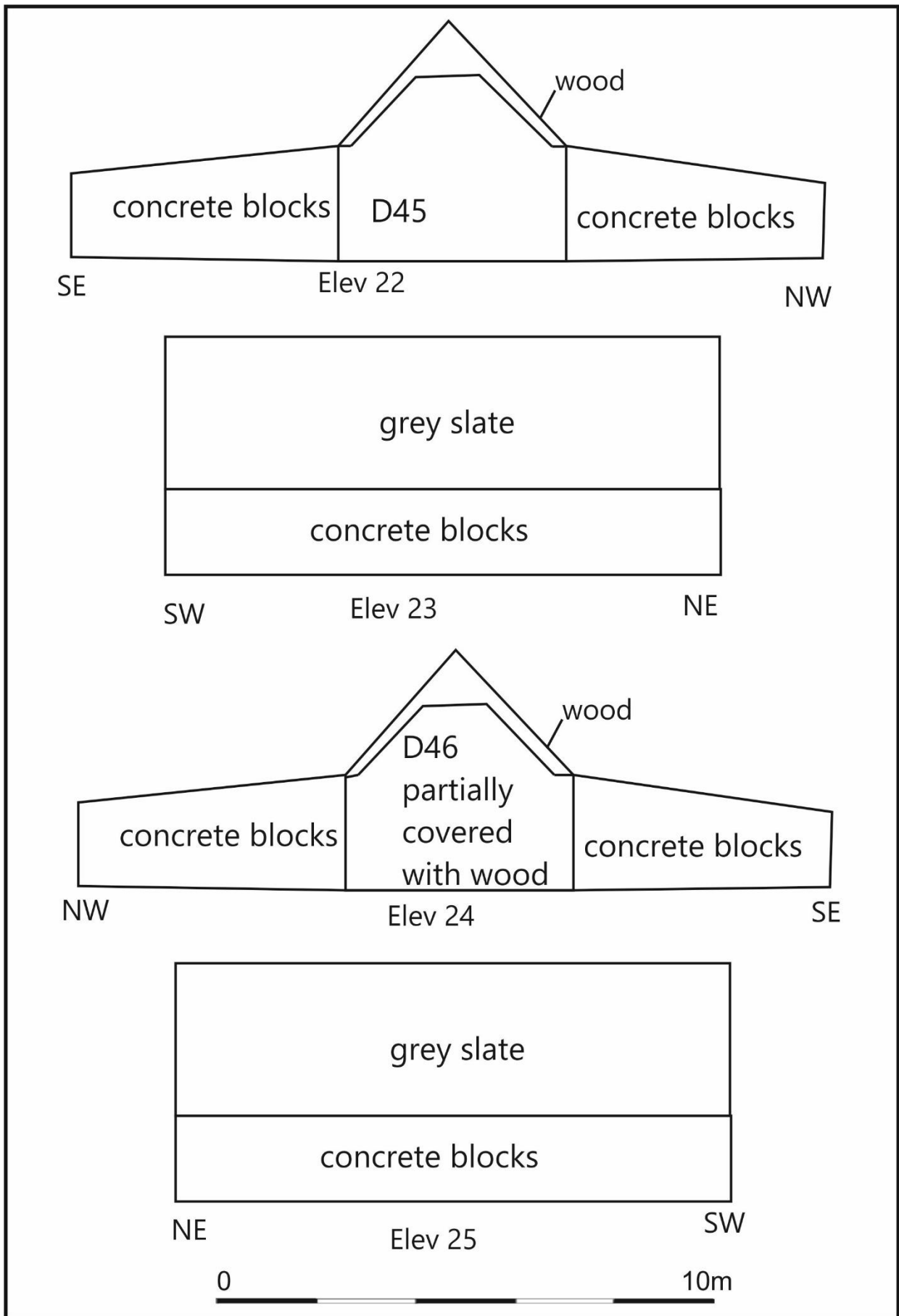

Illus 31 Building 4 elevations



Illus 32 Building 4; facing SW



Illus 33 Building 4; facing NW



Illus 34 Building 4; facing NE



Illus 35 Building 4; facing SE



Illus 36 Building 4 interior; facing SW

4 CONCLUSIONS AND RECOMMENDATIONS

A Level 2 standing building survey was carried out on 10 December 2018; the weather was freezing and sunny. At least three phases of development were recorded (Illus 37). The farmstead and mill (Building 1) was originally a C-shaped range of buildings around a central courtyard with a horse mill on the SW side and a separate L-shaped building to the NW (Building 2). Later additions to the SW and SE and the horsemill was demolished and a red brick structure attached which may also have functioned as a mill. The courtyard was then enclosed, and additions made in the 20th century to the NE, SE and SW.

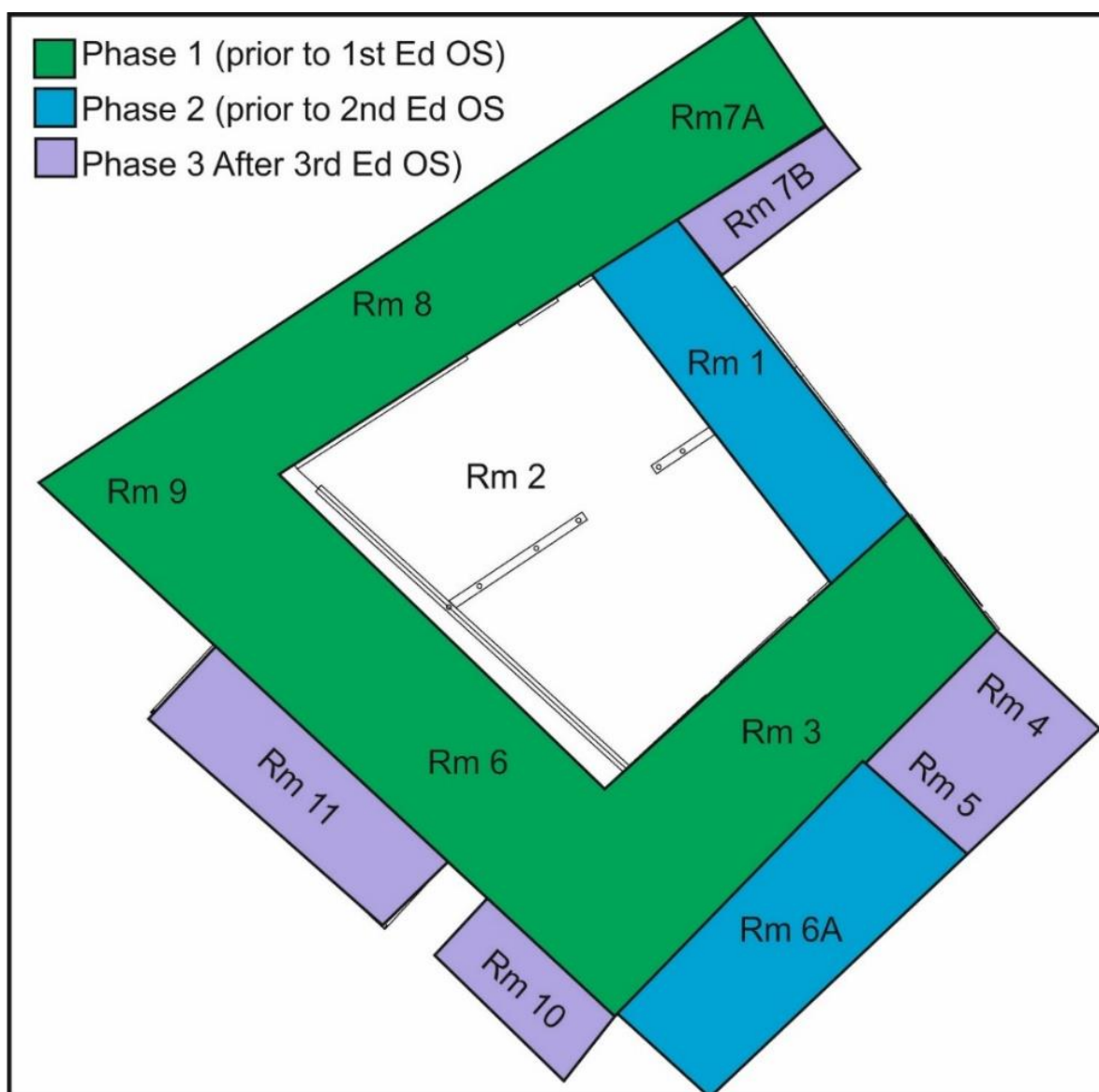

Illus 37 Building 1 phase plan

Building 2 was originally a rectangular structure; so little of the fabric remains it is not possible to determine definitely but it is likely to have been an agricultural (rather than a domestic) building. In Phase 2, prior to the First edition OS map, a square stone building (Building 2A) was added onto the SSE end, one room with 1m thick wall. Building 2 was two storey and when it went out of use it was converted for domestic use with fireplaces added at the NNW end and Building 3 added to the NE side of Building 2.

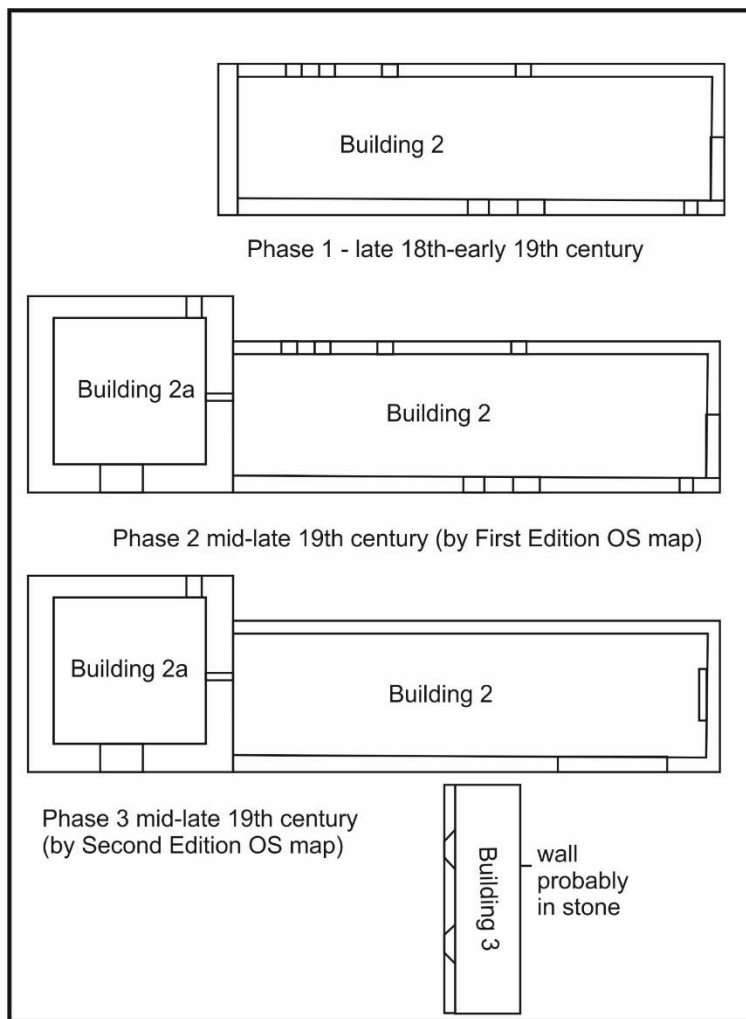

Illus 38 Buildings 2, 2a and 3 phase plan

The Standing Building Survey is complete but a watching brief will be carried out on the soil strip for the residential development.

5 REFERENCES

Statistical Account of 1791-99 vol.3 p280-286: Inverkeilor, County of Forfar. Rev John Carnegie.

New Statistical Account of 1834-45 vol.11 pp239-244: Parish of Inverkeilor, County of Forfar. Rev. Alexander Carnegie.

Ordnance Survey Name Book, Forfarshire (Angus), 1857-1861, Volume 51.

OS1/14/51/11

Pollock, D. (1987) *'The Lunan Valley project: medieval rural settlement in Angus'*, *Proc Soc Antiq Scot*, vol. 115, 1985. Page(s): 379

6 ACKNOWLEDGEMENTS

Thanks to Lynne Watson for commissioning this project and to Claire Herbert, Aberdeenshire Council Archaeology Service for her advice during the work.

Cameron Archaeology
45 View Terrace
Aberdeen AB25 2RS

APPENDIX 1 MAPS



Illus 39 Roy map showing approximate area of site (circled) (copyright National Library of Scotland)



Illus 40 Moll map showing approximate area of site (circled) (copyright National Library of Scotland)



Illus 41 Thomson map showing approximate area of site (circled) (copyright National Library of Scotland)



Illus 42 Gall and Inglis map showing approximate area of site (circled) (copyright National Library of Scotland)



Illus 43 Edward map showing 'Innerkilur' and showing approximate area of site (circled) (copyright National Library of Scotland)

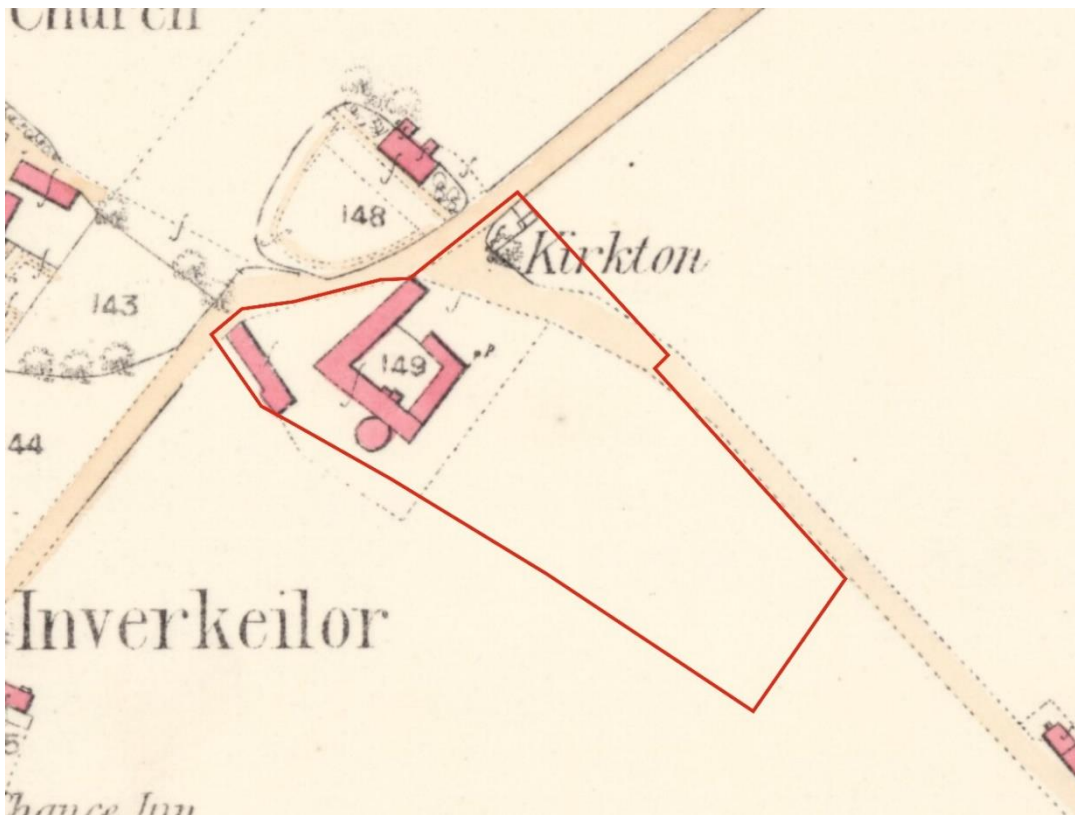

Illus 44 First Edition Ordnance Survey map (copyright National Library of Scotland)



Illus 45 Second Edition Ordnance Survey map (copyright National Library of Scotland)



Illus 46 Third Edition Ordnance Survey map (copyright National Library of Scotland)

APPENDIX 2 PHOTOGRAPHS

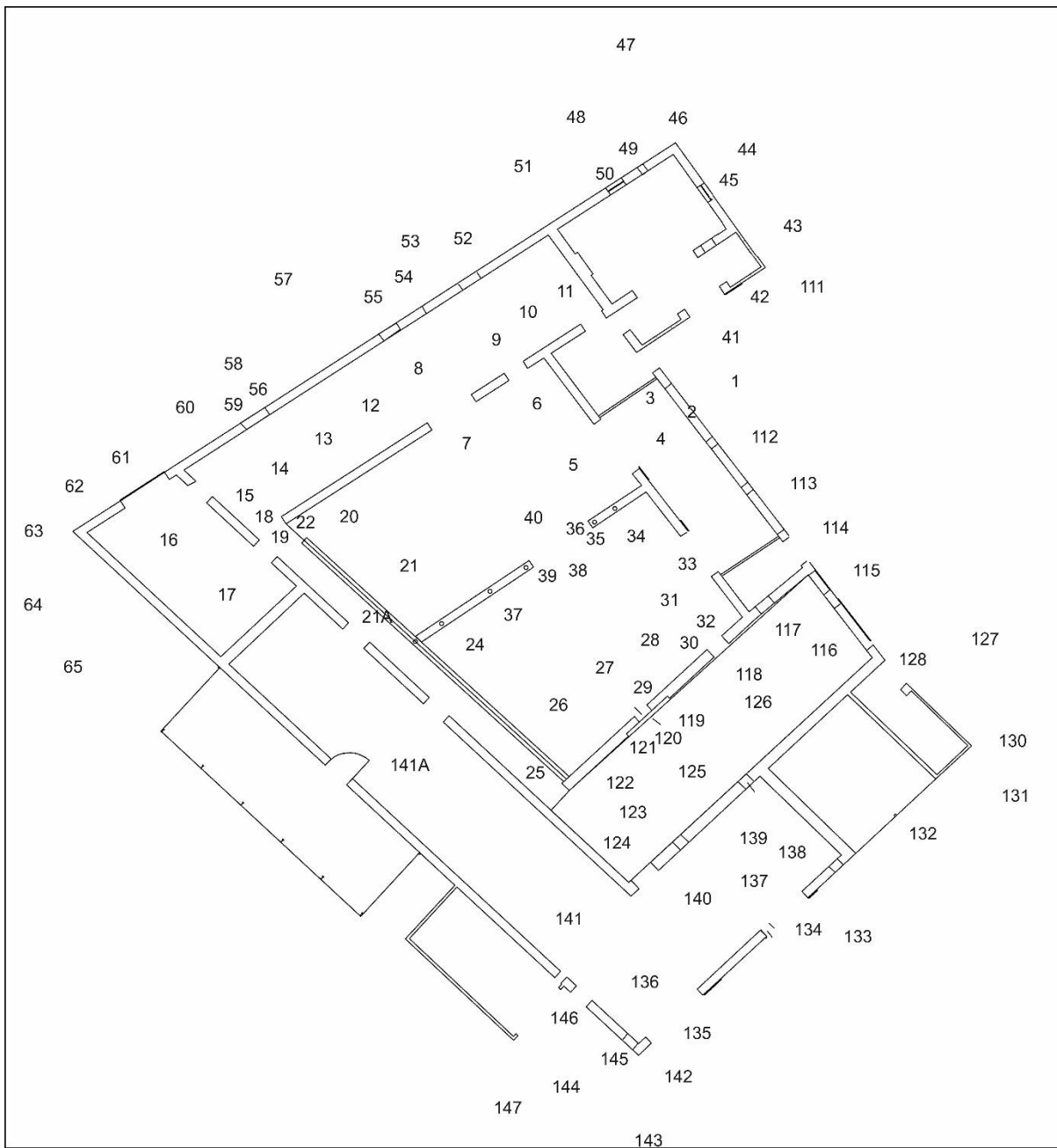

Illus 47 Camera points used in this survey – Building 1 (copyright Bell Ingram Design)

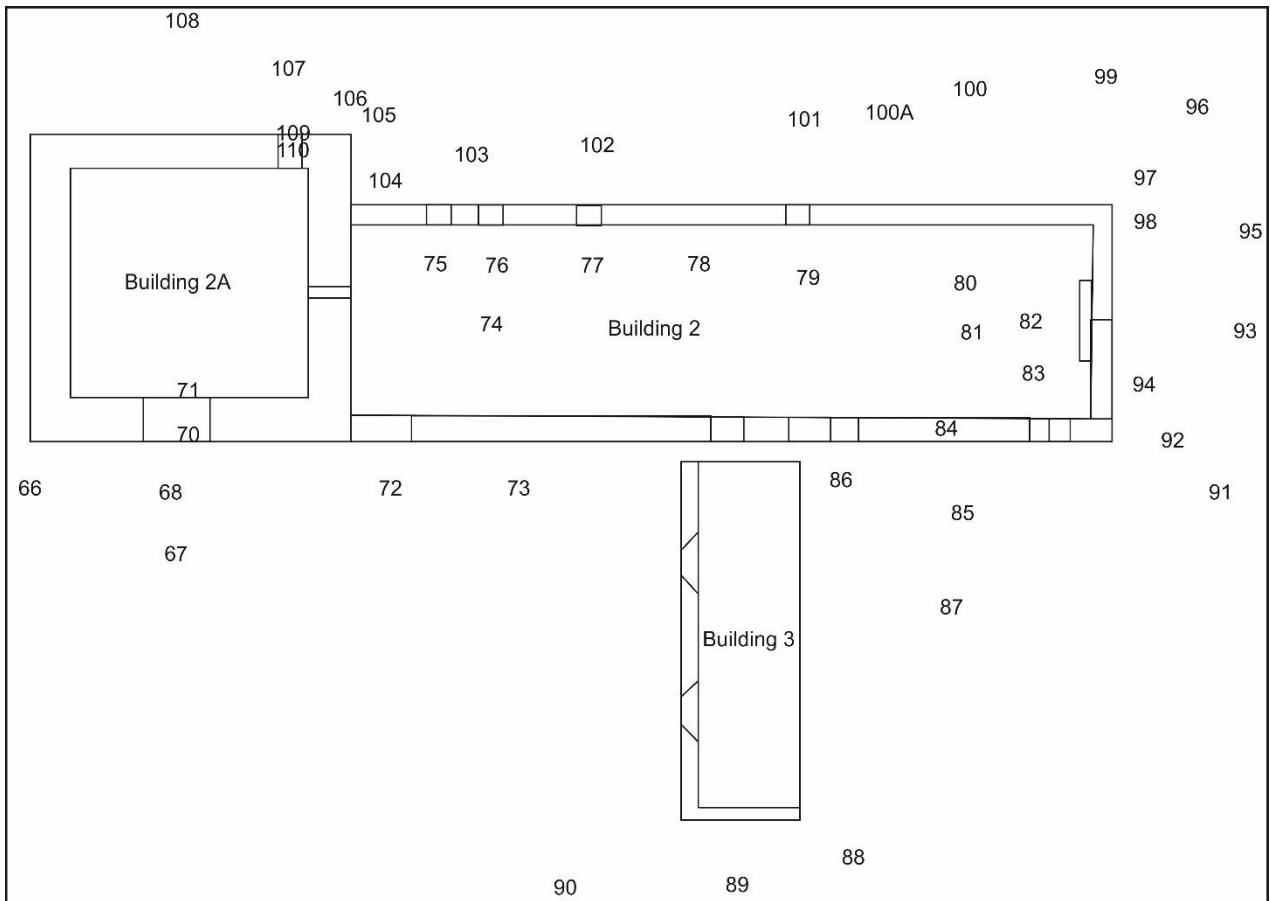

Illus 48 Camera points used in this survey – Buildings 2, 2A, 3 (copyright Bell Ingram Design)



Illus 49 Camera points used in this survey – Building 4 (copyright Bell Ingram Design)

Photo no	Description	Facing	Camera point
3015	Cart door D3 with D5 (behind)	SW	1
3016	D3 details	SW	1a
3017	D3 details	SE	2
3018	D4 (left) D5 (right)	S	4

3019	D5	SW	4
3020	Wooden wall NW end Room 1	NW	4
3021	D5	NE	5
3022	D5 (right)	NE	6
3023	D9	NW	6
3024	D10	NW	7
3025	wall SW of D10	WNW	7
3026	Room 2 SW wall D15 (right) D16 (left)	SW	7
3027	Room 2	SE	7
3028	Room 2 NE wall D5	E	7
3029	D10	SE	8
3030	D9	SE	9
3031-2	wall between D9 (right) D7 (left)	SE	11
3033	Room 8 NE wall	NE	10
3034	Room 8 NW wall	NW	11
3035	D29	NW	10
3036	D29	NW	9
3037	Room 8 NE wall	NE	8
3038	D30	NW	8
3039	wall between D32 and D31	NW	12
3040	Room 8 NW wall	NE	12
3041	D33 (left) D32 (right)	NW	13
3042	Room 8 SW wall	SW	13
3043-44	Room 8 SW wall	SW	14
3045	Room 8 SE wall D13 (right)	SE	14
3046	Room 8 SE wall	E	14
3048	Room 8 SE wall	SE	12
3049	Room 8 SE wall	SW	12
3050	Room 8 SW wall D11	NW	15
3051	D11	NE	16
3052	Room 9 NE wall	N	17
3053	Room 9 NE wall	N	17
3054	D15	NE	17
3055	Room 9 SE wall	SE	17
3056	Room 9 SW wall	S	16
3057	Room 9 SW wall	SW	16
3058-9	Room 9 NW wall D14	NW	16
3060	D12 from Room 8 to Room 2	SE	18
3061	Room 2	E	19
3062	Room 2 raised walkway along SW wall	SE	19
3063	D15	SW	22
3064	D15	SW	20
3065	D16 (left) D15 (right)	WSW	21
3066	D16	SW	21
3067	Room 2 SW wall SE end	SSE	21
3068-69	Room 2 raised walkway along SW wall	SE	21A

3070	Stone dividing wall Room 2	NW	38
3071	Stone dividing wall Room 2	NNW	38
3072	Stone dividing wall Room 2	W	38
3073	Room 2 SW wall D17	SW	38
3074	D24	SE	25
3075	Room 2 SE wall D24 (right)	SE	26
3076	Room 2 SE wall D24 (right)	ESE	27
3077	Room 2 SE wall W11 inside larger D25	S	28
3078	Room 2 SE wall W11 inside larger D25	SSE	28
3079	Room 2 SE wall W11 inside larger D25	SE	28
3080	W11	SE	29
3081-83	D25 NE jamb	SE	27
3084	Room 2 SE wall D24 (right)	SSW	28
3085	wall between D26 (left) D26 (right)	SE	28
3086	D26	E	28
3087-88	D26	SE	32
3089	D4	NE	31
3090	D4 (right) D5 (left)	NNE	31
3091	D4	NE	33
3092	D4 (right) D5 (left)	NE	34
3093	Stone dividing wall Room 2	NW	34
3094-6	Cast iron pillar	NE	35
3097-8	Cast iron pillar	NE	36
3099-3100	Stone dividing wall Room 2	NW	38
3101	Stone dividing wall Room 2	NNW	38
3102	Cast iron pillar	WNW	39
3103	Room 2 NW wall	NW	40
3104	Room 2 NW wall	WNW	40
3105-6	Room 7B SE wall W7 (left) W8 (right)	NW	41
3107	W8	NW	42
3108	Room 7B (left) W4, Room 7A W5 (right)	SW	43
3109	Room 7A W5	SW	44
3110	W5	SW	45
3111-12	N corner Room 7A	S	46
3113	Room 7A N corner	SSE	47
3114	Room 7A N corner	SSW	47
3115	NW façade of farm	WNW	47
3116	W1 (left) W2 (right)	SE	48
3117	W1	SE	49
3118	W2	SE	50
3119-20	W1 (left) W2 (right)	ESE	51
3121	D29, D30	SE	53
3122	D29	SE	52
3123	D30, D31	SE	53
3124	NW façade of farm	NE	53
3125	D29	SE	52

3126	D30	SE	54
3127	D31 (right)	SE	55
3128	D31	SE	55A
3129	NW façade of farm	NE	55A
3130	NW façade of farm	SW	55A
3131	D31	SE	55
3132	D31 (left)	ESE	57
3133	Wall between D31 (left) D32 (right)	SE	57
3134	D32	SE	56
3135	D33	SE	60
3136	D33	SE	59
3137	D14	SE	61
3138	NW façade of farm	NE	61
3139	NW façade of farm	ENE	61
3140-1	D14 (left)	SE	62
3142-4	NW corner Room 9	E	63
3145	SW wall Room 9 showing overgrown areas	NE	64
3146	SW wall Room 9 showing overgrown areas	ENE	64
3147	Dutch barn Room 11 - no access	SE	64
3148-9	SW wall Room 9 showing overgrown areas	NE	65
3150-1	Dutch barn Room 11 - no access	SE	65
3152	Tank next to Building 2A	S	66
3153-4	Building 2A ENE wall D43	WSW	67
3155-6	D43 SSE jamb	WSW	69
3157-8	D43 NNW jamb	NW	70
3159	Stone threshold	WSW	70
3160	Building 2A interior (no access)	S	71
3161	Building 2A interior (no access)	WSW	71
3162	Building 2A interior (no access)	NW	71
3163	Building 2A interior roof	WSW	71
3164	Building 2A interior no access due to piles of pigeon droppings	WSW	71
3165	Building 2	NW	72
3166	Building 3 overgrown	NNW	72
3168	Building 2a overgrown	S	72
3169	Building 2 ENE wall with large area of wall demolished	WSW	73
3170	Building 1	E	73
3171	Building 2 SSE gable with W19	SSE	74
3172	Building 2 SSE gable with W19 and NNW wall Building 2A above	SSE	74
3173-4	Building 2 WSW wall junction with Building 2A and W14 (top right)	SW	75
3175	W14 (top left) W15	WSW	75
3176	W14 (top left) W15 (centre) W16 (top right)	SW	75
3177	W15	SW	76
3178	W16	WSW	77
3179-81	W14 (top left) W15 (centre) W16 (top right)	WSW	74

3182-3	W18 below W17	WSW	78
3184	W18	WSW	79
3185	Building 2	SSE	80
3186	WSW wall NNW end	WSW	80
3187	WSW wall NNW end	SW	80
3188	NNW gable	NNW	81
3189	fireplace F1 overgrown	NNW	82
3190	NNW gable	NNW	81
3191-2	NE corner (overgrown)	NNE	83
3192-3	D38 NNW jamb - brick	NNW	84
3195-6	ENE wall D40 (plastered over bottom left) D39 (top right, partially removed)	ENE	85
3197	D39	ENE	86
3198-99	D38 SSE jamb - brick	SSE	84
3200	D38 NNW jamb with stone boundary wall (right)	N	84
3201	stone boundary wall	NNE	84
3202-3	D38 (right) Building 3 (left) overgrown	SSW	86
3204	Building 1 NW façade	E	88
3205	Building 1 NW façade	SE	88
3206	D38	WSW	87
3207	Building 3 overgrown	SSW	88
3208-9	Building 3 ENE wall	WSW	89
3210	Building 3 SSE and ENE walls	NW	90
3211	Building 1 NW façade	SE	91
3212	stone boundary wall	SSE	91
3213	stone boundary wall	SE	91
3214	Stone boundary wall junction with Building 2	SSE	92
3215-6	Building 2 NNW gable	SSE	93
3217	D42	SSE	94
3218	D41	SSE	94
3219-20	F3 1771 skewputt	SSE	92
3221-2	Building 2 NNW gable	SE	95
3223	Building 2 NNW gable	SE	96
3224-6	Building 2 NW quoins	SE	97
3227	NW skewputt	SSE	98
3228	NW skewputt	ESE	97
3229	Building 2 NNW wall	ENE	99
3230	Building 2 WSW wall	E	99
3231-2	Building 2 WSW wall F2 concrete scar	NE	100
3233	F2	ENE	100
3234	F2 (left) holes for wood structure to be attached	ENE	100A
3235	W17	ENE	101
3236-7	Building 2 WSW wall	NE	101
3238	W16	ENE	102
3239	Building 2 WSW wall	NE	102
3240	W15, W14	SSE	102
3241	W14	SSE	103

3243	Building 3	NE	103
3244	Building 2A (right) Building 1 (left)	ENE	103
3245-6	Building 2 SSE gable with Building 2A gable above	ESE	103
3247	Building 2 WSW wall	NNW	103
3248-51	Building 2 WSW wall (left) Building 2A (right)	SSE	103
3252-3	Building 2A NNW crowstep gable with sandstone tooled skewputts	SSE	104
3254-5	Building 2A NNW crowstep gable with sandstone tooled skewputts	ENE	105
3256	Building 2A WSW wall with W13	ENE	108
3257	Building 2A WSW wall with W13	ENE	107
3258	Building 2A WSW wall	SE	107
3259-60	Building 2A NNW crowstep gable with sandstone tooled skewputts	N	108
3261	Building 2A WSW wall	SE	107
3262-3	W13 SSE jamb	SE	109
3264-5	Building 2A interior through W13	ESE	110
3266	Building 2 WSW wall	N	107
3267	Cart doors D1, D2, D3	S	111
3268-9	D2	SW	113
3270	D35	SW	114
3271	D28 (left) W6 (right)	SW	115
3272	D28	SW	112
3273	D28	NE	116
3274	D27	NW	117
3275	D26	NW	118
3276-7	D25 NE jamb	NW	119
3278-9	W11 in centre of blocked D25	NW	120
3280-1	D24 (left) D25 SW jamb (right)	NW	122
3282-3	Room 3 SW wall showing collapsing roof above	SW	123
3284	D23	SE	124
3285	roof above D23	SE	124
3286	Room 3 SE wall	SE	125
3287	Room 3 SE wall	E	125
3288	Room 3 SE wall	ENE	124
3289	Room 3 SW end	SW	126
3290	Room 3 SE wall	SSW	126
3291	Room 3 SE wall	S	126
3292	Room 3 SE wall	NE	126
3293	Building 4	NE	127
3294-5	Room 3 NE corner showing Room 4 attached	W	128
3296	Room 3 NE wall	NW	128
3297	Room 3 NE wall	NNW	128
3298-99	Building 4	NE	129
3300	Room 4 concrete blocks	NW	130
3301	Room 4 (right) Room 5 (left)	NW	131
3302	Room 5	NW	132

3303	Room 5	W	132
3304	SE façade Rooms 4 (right), 5, 6	NW	133
3305	D21 (left) D22 (right)	WNW	133
3306-7	D22 with W9 and W10 above	NW	134
3308	W9 blocked with brick	NW	133
3309	Building 4	NE	133
3310	D21	NW	135
3311	D21	SE	136
3312	D22	SE	137
3313	D22 with W9 and W10 above	SE	137
3314-5	D22 with W9 and W10 above	SE	138
3316-7	Room 6B NE gable	NE	139
3318-9	Room 6B W3 and W12	NW	139
3320-21	Room 6B W3	NW	123
3322-3	Room 6A SW wall D17	NE	141A
3324	Room 6A SW wall D17	NE	141A
3325	Room 6A SW wall D17	N	141A
3326	Room 6A NW wing showing piles of pigeon faeces	NW	141A
3327	Room 6A NW wing SW wall	WNW	141A
3328	Room 6A SW wall D20 and D3 above	SW	136
3329	Room 6A S corner (D21 (right))	NW	142
3330	Room 6A S corner	N	143
3331	Room 6A S corner	NNW	143
3332	D20 (left) D3 (right)	NE	144
3333	D3	NE	145
3334	D20	NE	146
3335	Room 10 red brick room D36 - no access	NW	144
3336	D20 (left) D3 (right)	NE	147
3337-8	Room 10 red brick room - no access	N	147
3339	Dutch barn Room 11 (no access)	NW	147
3340	Farm from road	SW	148
3341	Farm from road	SW	149
3342-3	Farm from road	WSW	149
3838	Building 4 NE elevation D 45 (centre)	SW	150
3839	Building 4 NE elevation	SW	151
3840	Building 4 NE elevation D45	SW	152
3841-4	Building 4 interior	WNW/SW/SSW	153
3845	Building 4 NE elevation	SW	154
3846-7	Building 4 SE elevation	NW	155
3848-9	Building 4 SW elevation	NE	156
3850	Building 4 SW elevation	NE	157
3851	Building 4 SW elevation	NE	158
3852	Building 4 SW elevation	NE	159
3853-4	Building 4 NW elevation	SE	160
3855	Building 4 NW elevation	SE	161
3856	Building 4 NW elevation	SE	162