

**Land Adjacent to Claymore Homes Ltd, Aden Business  
Park, Newlands Road, Mintlaw, Aberdeenshire, AB42 5BP  
Data Structure Report (DSR)**



**Alison Cameron  
Cameron Archaeology Ltd  
Date: 28 March 2019**

## CONTENTS

1	BACKGROUND .....	3
2	ARCHAEOLOGICAL BACKGROUND .....	4
3	EVALUATION AND RECOMMENDATIONS .....	5
4	REFERENCES.....	6
5	ACKNOWLEDGEMENTS .....	6
	APPENDIX 1 PHOTOGRAPHS .....	6

## ILLUSTRATIONS

**Cover:** the scraped site with Claymore Homes offices in background; facing N

Illus 1	Location plan ( <i>Contains Ordnance Survey data © Crown copyright and database right 2019</i> ).....	3
Illus 2	Site plan showing proposed development ( <i>copyright Claymore Homes</i> ).....	4
Illus 3	Area scraped to check subsoil; facing W.....	5

## SUMMARY

An evaluation was carried out on 27.3.19; the site had been previously stripped of topsoil and so the surface was scraped in three areas to check for features.

No finds or features were recorded and it is recommended that no further archaeological work is required during the current planning application.



# 1 BACKGROUND

- 1.1 The site (Illus 1) is located in the Aden Business Park, Mintlaw. It is centred on NGR NJ 9896 4830, at 50-55m OD in the parish of Old Deer.
- 1.2 The work was commissioned by Claymore Homes. An Aberdeenshire Council planning application APP/2018/2324 requires a 5-7% archaeological evaluation.
- 1.3 All the archaeological work will be carried out in the context of Scottish Planning Policy (SPP) Planning Advice Note (PAN 2/2011) and Historic Environment Scotland's Policy Statement (HESPS) which state that archaeological remains should be regarded as part of the environment to be protected and managed.

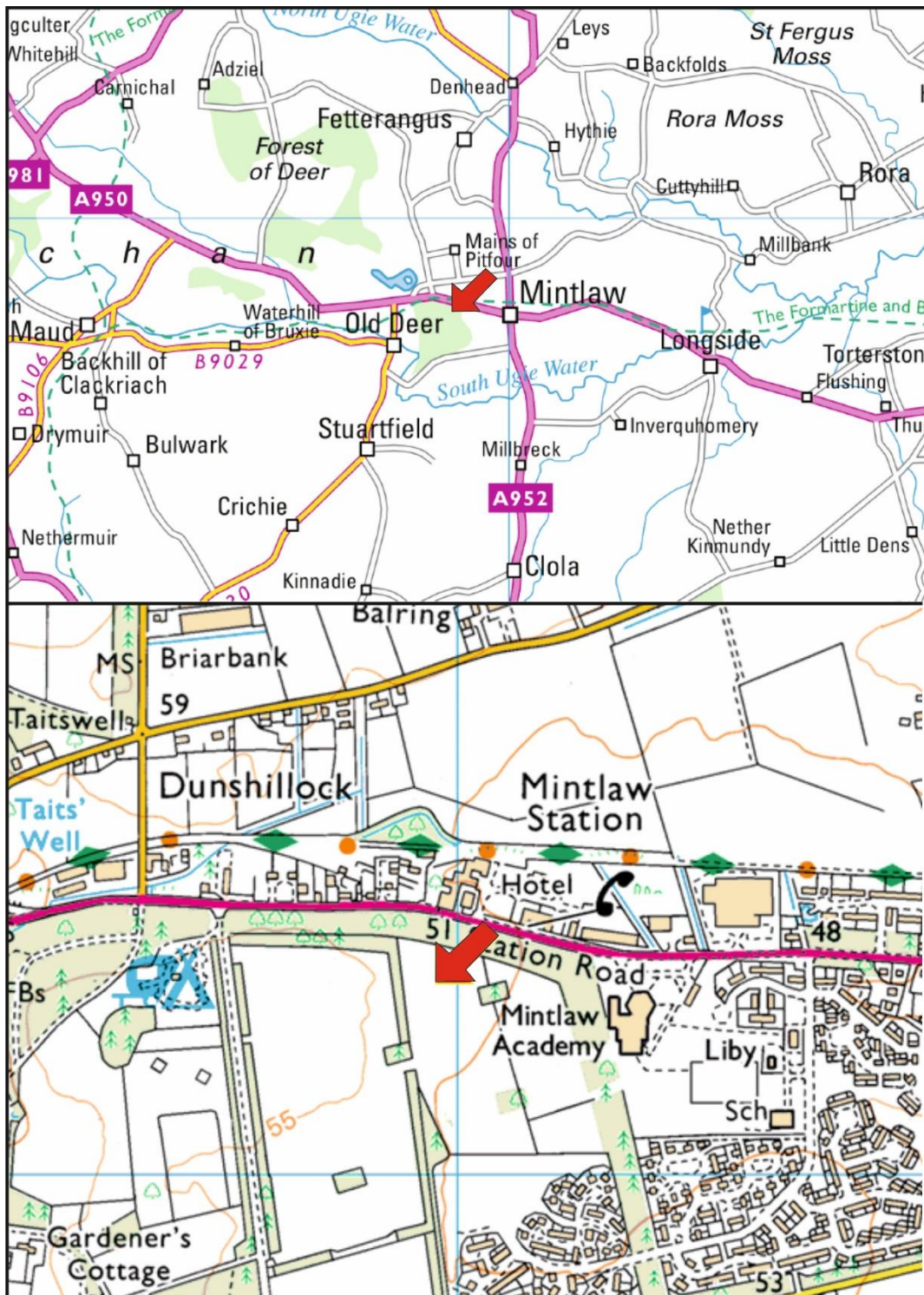

Illus 1 Location plan (Contains Ordnance Survey data © Crown copyright and database right 2019)

## MODENZA SHOWROOM, ADEN BUSINESS PARK

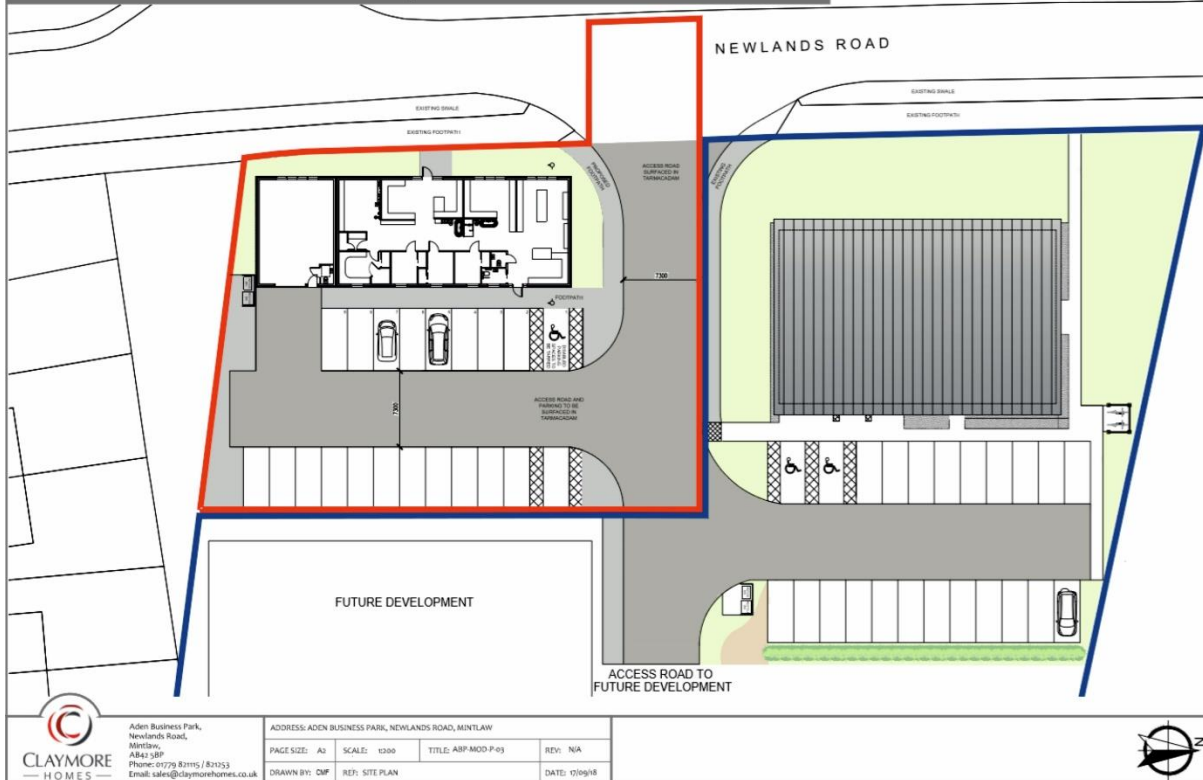

Illus 2 Site plan showing proposed development (*copyright Claymore Homes*)

## 2 ARCHAEOLOGICAL BACKGROUND

The proposed development site lies within the archaeology site NJ94NE0077, the 17th-19th Century designed landscape of Aden House. It is also an area where there is the potential for previously unrecorded archaeological remains, possibly medieval or prehistoric in date, to survive (as is evidenced elsewhere within this designed landscape).

- 2.1 Two stone foundations have been identified in woodland within Aden Country Park (NJ94NE 63.11). The most southerly of these has been identified on Canmore as the remains of an Episcopal Meeting House (NJ94NE 70) but this identification is uncertain.
- 2.2 An evaluation in September 2015 revealed the foundations of a rectangular and T-shaped foundations; small test pits failed to reveal any dating evidence and the finds from the soil in the trenches ranged from prehistoric flint to modern bottle and plastic.
- 2.2 Further excavation of two stone structures in Aden Country Park was carried out from 6-19<sup>th</sup> June 2016 by a team of 36 archaeologists, Book of Deer members, students and volunteers as well as staff and nearly 300 pupils from local primary schools and Mintlaw Academy. Structure 1 is a T-shaped building, probably built on the medieval period, possibly as a tower house and possibly later used as an Episcopalian Meeting House. Nearly 20 coins of the late 18<sup>th</sup> century, copper alloy heart-shaped brooch and copper alloy book fittings are included in the finds from the later use of the building. Burnt timbers and stone were excavated from the demolition of the building which had been burnt prior to demolition. Structure 2 may have an agricultural or mixed domestic and agricultural use. There is a hearth inside the S wall surrounded by a well-laid cobbled floor and a



stone-lined pit in the NE corner of the N room which may have been an exterior courtyard.

- 2.3 As part of a Book of Deer funded project, an evaluation was carried out by Murray Archaeological Services of a group of 27 circular enclosures or possible huts lie in a plantation 40m N of the former stables of Aden House between NJ 9805 4798 and NJ 9811 4819 (NJ94NE 88). An excavation of a series of features in March and April 2017 as part of the HLF project revealed an extensive military training ground and it is suggested that the Murray site may also be of a similar nature and not a Bronze Age site. A trench was also dug in the park by Guard Archaeology with no significant archaeological results.
- 2.4 Excavations in March-April 2017 in the north of the park on the west side of the camping and caravan site identified 19<sup>th</sup> and early 20<sup>th</sup>-century military trenches which were part of a military training area for local militia (Cameron 2017).
- 2.5 Excavation in 2017 and November 2018 revealed a possible Neolithic enclosure in the field next to Hareshowe. Further excavation and post-excavation analysis are required (Cameron 2018).

### 3 EVALUATION AND RECOMMENDATIONS

An evaluation was carried out on 27.3.19; the site had been previously stripped of topsoil and so this was scraped in three areas to check for features.

No finds or features were recorded and it is recommended that no further archaeological work is required during the current planning application.



Illus 3 Area scraped to check subsoil; facing W

## 4 REFERENCES

**Cameron AS 2017** Site 1 19<sup>th</sup> and early 20<sup>th</sup>-century military training ground. Report prepared for Ironside Farrar and Aden Country Park HLF.

**Cameron AS 2018** Excavation at Hareshowe 2017-18. Report prepared for Ironside Farrar and Aden Country Park HLF.

## 5 ACKNOWLEDGEMENTS

Thanks to Chris Forman, Claymore Homes for initiating this project and to Claire Herbert, Aberdeenshire Council Archaeology Service for her advice during this work.

Cameron Archaeology  
45 View Terrace  
Aberdeen  
AB25 2RS  
01224 643020  
07581 181057  
cameronarch@btinternet.com  
www.cameronarchaeology.com  
Company registration no 372223 (Scotland)  
VAT registration no 990 4373 00

## APPENDIX 1 PHOTOGRAPHS

Photo no	Details	Facing
6343	The proposed development site with neighbouring housing development	S
6344	The proposed development site	E
6345	The proposed development site showing scraped area	E
6346	The proposed development site	S
6347	The proposed development site showing scraped area	E
6348-9	The proposed development site showing Claymore Homes offices to N	N
6350	The proposed development site	E



DSC\_6343



DSC\_6344



DSC\_6345



DSC\_6346



DSC\_6347



DSC\_6348



DSC\_6349



DSC\_6350