

**Land At Smiddyhill, Udney, Ellon,
Aberdeenshire, AB41 6SY**

Report on Level 1 Standing Building Survey

Aberdeenshire Planning application APP/2019/1064



**Alison Cameron
Cameron Archaeology
14 July 2019**

CONTENTS

1	INTRODUCTION	4
2	BACKGROUND	5
3	THE LEVEL 1 STANDING BUILDING SURVEY	5
3.1	Building 1	6
3.2	Building 2	7
3.3	Building 3	8
3.4	Building 4	8
3.5	Building 5	15
3.6	Building 6	17
3.7	Building 7	18
4	CONCLUSIONS AND RECOMMENDATIONS.....	19
5	ACKNOWLEDGEMENTS	19
	APPENDIX 1 MAPS.....	21
	APPENDIX 2 PHOTOGRAPHS	24

ILLUSTRATIONS

Cover: the farm from the WNW showing (l-r) Buildings 6, 5, 4, farmhouse not included in this application (centre), Building 1 (right); facing ESE

Illus 1	Location plan (Contains Ordnance Survey data © Crown copyright and database right 2019)	4
Illus 2	Plan of all buildings surveyed (from copyright Caledonia Homes)	5
Illus 3	Building 1 WNW end showing concrete base and metal upper floor; facing ESE	6
Illus 4	Cross section drawing showing Building 2 (cattle court; left) added to Building 1 the existing silo barn (right) (courtesy of Isobel Milne).....	6
Illus 5	Elevations 1-2, 4-7 annotated with numbers used in this survey	7
Illus 6	Building 1 constructed by A&J Main & Co Ltd, Glasgow and London; facing SSW	7
Illus 7	Building 2 WNW wall D24; facing ESE.....	8
Illus 8	Building 3; facing NE	8
Illus 9	Plan of Building 4 annotated with numbers used in this survey	9
Illus 10	Elevations 8-14 annotated with numbers used in this survey	10
Illus 11	Building 4 W wing SSW wall D18; facing NNE	11
Illus 12	Building 4 W wing ESE wall D17, D16, D15, D14; facing WNW	11
Illus 13	Building 4 N wing SSW wall D12, W5, D11; facing NNE	12
Illus 14	Building 4 N wing N wall showing overgrown and inaccessible; facing ESE.....	12
Illus 15	Building 4 E wing WNW wall W4, D9, W17, D7, D6; facing ESE.....	13
Illus 16	Building 4 N wing interior; facing NNE towards gable with D19	13
Illus 17	Building 4 E wing interior towards gable with D10; facing NNE	14
Illus 18	Building 4 E wing W3 (left) with new concrete sill, D2 (right blocked with concrete ..	14
Illus 19	Building 4 E wing interior ESE wall detail of wooden board with show certificates ..	15
Illus 20	Cross section drawing showing Building 5 (feeding area; centre) added to 'existing building (Building 4, left) and Building 6 bedded court (right) (courtesy of Isobel Milne)	15
Illus 21	Building 5 SSW wall; facing NNE	16

Illus 22 Building 5 interior; facing NNE showing collapsing roof and asbestos roofing broken on floor.....	16
Illus 23 Building 6 SSW wall; facing NNE	17
Illus 24 Building 6 WNW wall; facing NE	17
Illus 25 Building 6 interior showing collapsing roof and asbestos roofing broken on floor; facing NNE.....	18
Illus 26 Building 7; facing NE.....	18
Illus 27 Phase plan.....	19
Illus 28 First Edition Ordnance Survey map Aberdeenshire XLVI.8 (with inset XLVI.11) (Tarves) Survey date: 1867 Publication date: 1869 (copyright National Library of Scotland)	21
Illus 29 Second Edition Ordnance Survey map Aberdeenshire XLVI.8 (Tarves; Udney) Publication date: 1900 Revised: 1899 (copyright National Library of Scotland)	22
Illus 30 Third Edition Ordnance Survey map Aberdeenshire XLVI.8 (Tarves; Udney) Publication date: 1926 Revised: 1924 Levelled: 1899 (copyright National Library of Scotland).....	23
Illus 31 Camera points used in this survey – Buildings 1-3, 5-7.....	24

SUMMARY

A Level 1 standing building survey was carried out on 11 July 2019. At least 5 phases of building were recorded including a C-shaped early 19th-century steading around a central courtyard, mid-20th-century silo barn and post-1966 additions. It is recommended that no further archaeological work is required during the current planning application.

1 INTRODUCTION

- 1.1 The site (Illus 1) is located on the N side of the A920 between Oldmeldrum and Pitmedden. It is centred on NGR NJ 8588 2712, at 105-108m OD and in the parish of Tarves.
- 1.2 The work was commissioned by Daniel Cumming, Caledonia Homes. A planning application APP/2019/1064 for proposed 3 dwellinghouses requires a Level 1 standing building survey.
- 1.3 All the archaeological work was carried out in the context of Scottish Planning Policy (SPP) Planning Advice Note (PAN 2/2011) and Scottish Historic Environment Scotland's Policy Statement (HESPS), which state that archaeological remains should be regarded as part of the environment to be protected and managed.

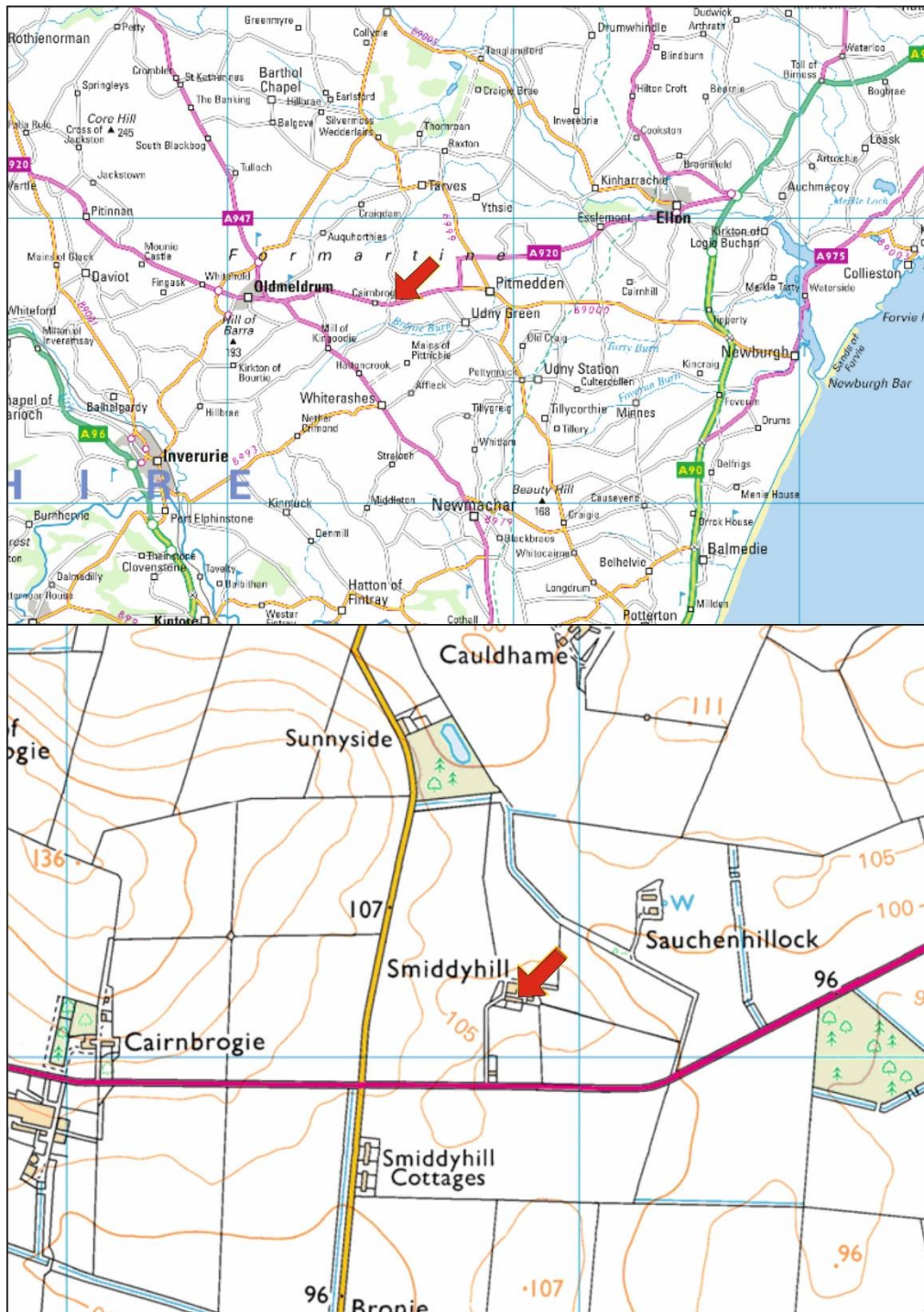

Illus 1 Location plan (Contains Ordnance Survey data © Crown copyright and database right 2019)

2 BACKGROUND

Smiddyhill is on the HES Canmore database (NJ82NE 107) farmhouse and farmstead. Aberdeenshire HER (NJ82NE0113) records a farmstead, still in use, depicted on the 1st and 2nd edition OS maps (Illus 28, 29). The 1st edition OS map depicts a U-plan steading open to the south with farmhouse to the south east. By the 2nd edition OS map, a horse mill has been added to the north wing of the steading and a rectangular building on the south side of the open courtyard, the farmhouse has been enlarged, and a pump is shown to the south. Today, the original steading survives and has been extended to the west and the horse mill and rectangular building on the south side have been removed; a new large building has been added to the south; the pump is no longer depicted.

The farm was purchased by Messrs A & NW Taylor in 28 November 1966 from William G Blackstock deceased. Copies of plans from post-1966 are included in this report and the archive by kind permission of Isobel Milne.

3 THE LEVEL 1 STANDING BUILDING SURVEY

A level 1 standing building survey was carried out on 11 July (Illus 2). The weather was warm and sunny. All plans and elevations were measured and drawn by the current author and a photographic survey was carried out. There was no access to the interiors of Buildings 5 and 6 as the roofs are collapsing and there is asbestos roofing material broken all over the floor. Rubble has been dumped along the N edge of the site allowing little access to the N wall of Building 4. There was no access to the interior of Building 2.

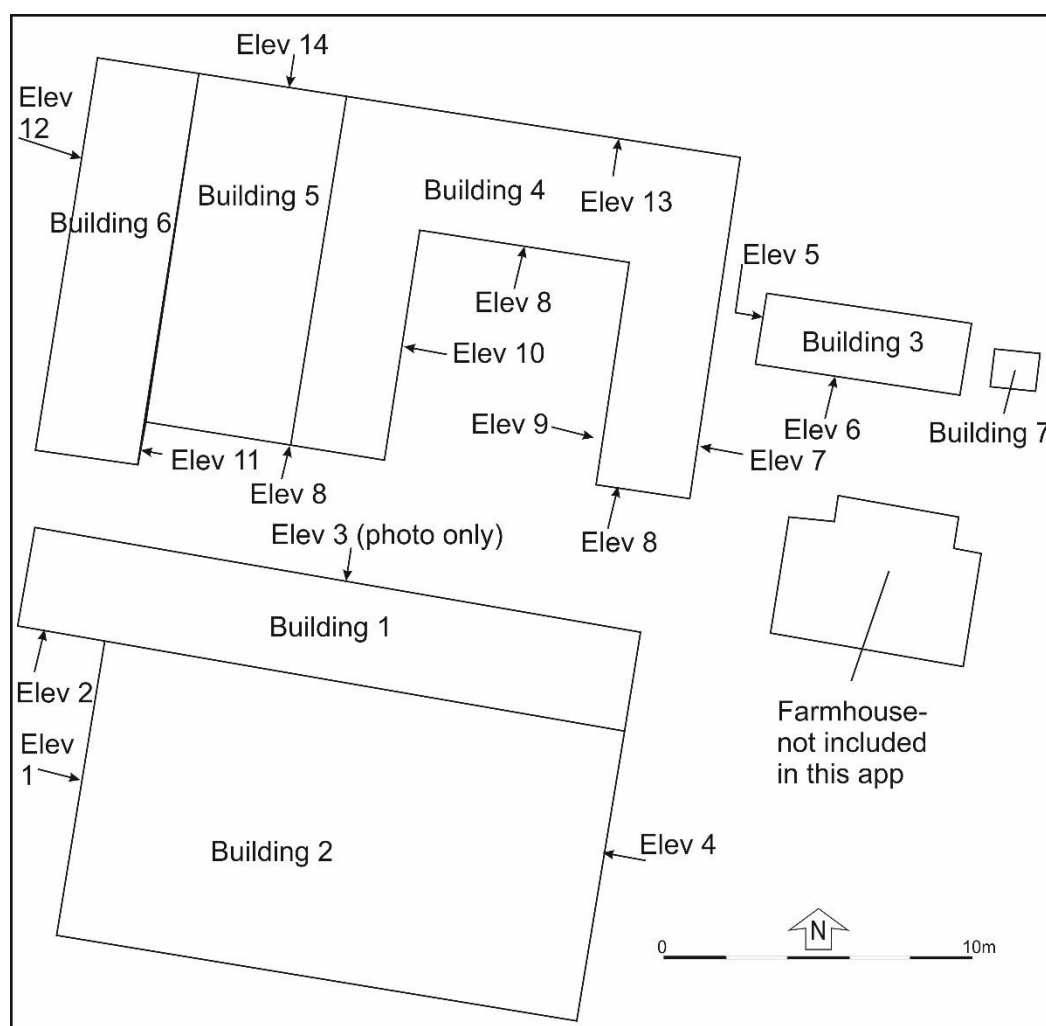

Illus 2 Plan of all buildings surveyed (from copyright Caledonia Homes)

3.1 Building 1

Building 1 is 33m long and 5.7m wide constructed of concrete blocks (Illus 3, 5) with a curved metal roof and corrugated metal walled first floor. It was a silo barn (Illus 4) and was constructed by A&J Main & Co Ltd, Glasgow and London (Illus 6).



Illus 3 Building 1 WNW end showing concrete base and metal upper floor; facing ESE

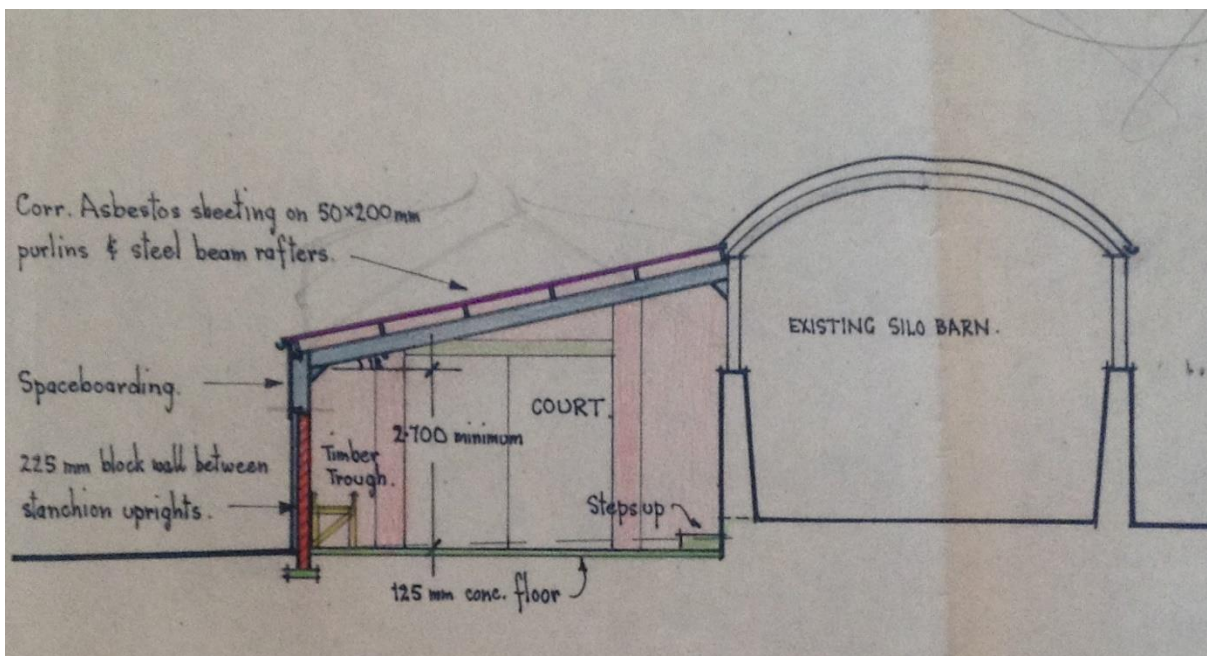

Illus 4 Cross section drawing showing N half of Building 2 (cattle court; left) added to Building 1 the existing silo barn (right) (courtesy of Isobel Milne)

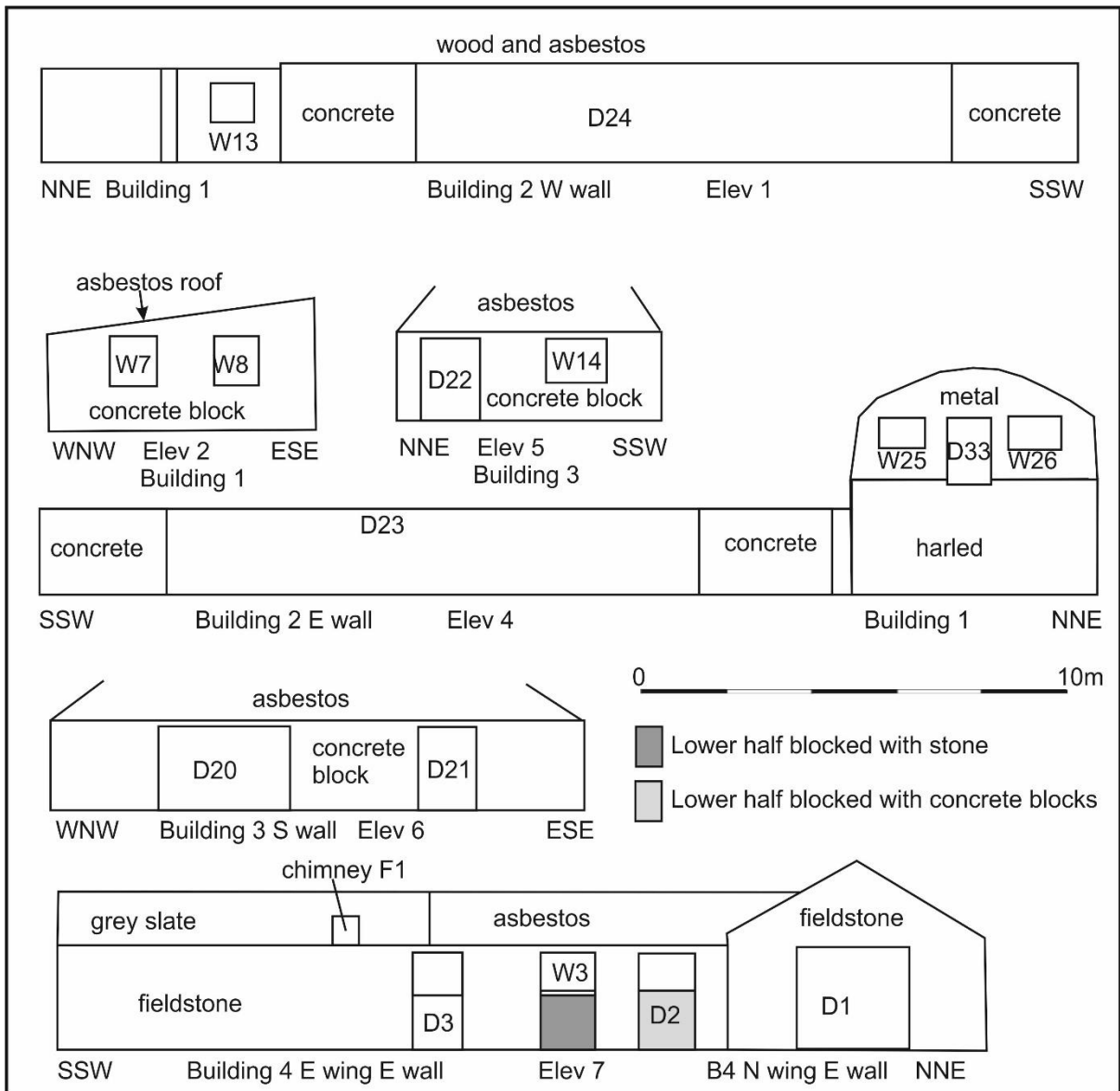

Illus 5 Elevations 1-2, 4-7 annotated with numbers used in this survey



Illus 6 Building 1 constructed by A&J Main & Co Ltd, Glasgow and London; facing SSW

3.2 Building 2

Building 2 was built by the Taylor family as a cattle court (Illus 4). It is 26.8m long and 18.2m wide and constructed of concrete blocks with asbestos roof and large metal doors in the WNW wall (D24; Illus 5) and ESE wall (D23).



Illus 7 Building 2 WNW wall D24; facing ESE

3.3 Building 3

Building 3 is a shed 6 x 12.3m in size constructed of concrete blocks, harled on the exterior and with asbestos roof (Illus 2, 5). There is a door (D22) and window (W14) in the WNW wall and doors D20 and D21 in the SSW wall (Illus 8). It is shown on the 1926 3rd Edition OS map (Illus 30).



Illus 8 Building 3; facing NE

3.4 Building 4

Building 4 is the earlier fieldstone steading constructed in a C shape with W wing 15 x 5.5m, N wing 24 x 6.2m and E wing 15.5 x 6.2m in size around a central courtyard (Illus 9) with access from the S. The original apertures are in granite but many of the doors have been blocked with stone and concrete blocks and some lintels and sills replaced in concrete (see Illus 18). The interiors have all been lined with concrete for housing cattle and there are concrete floors throughout. The original roofs have been grey slate but many have been replaced with asbestos roofs, including the NNE end of the E wing (Illus 18).

The majority of the building appears to have been built in one phase but the SSW end of the E wing has been extended between the 1st and 2nd Edition maps making it approximately the same length as the W wing and adding the cart doors D4 and D5 to the SSW gable.

The W wing has a large door in the SSW wall (D18; Illus 11) and the wing had 4 doors on the ESE wall to access the courtyard (D14-17; Illus 12); three were later converted to windows (Illus 10, 12). A door (D13) has been broken through into the N wing but this is not an original door and has not been faced. It is roofed in grey slate.

The N wing has two small windows in the NNE wall (W1 and W2); this was originally the location of the horsemill seen on the 1st and 2nd OS maps (Illus 28, 29) but the interior has been covered with concrete (Illus 16) and the exterior is inaccessible (Illus 14). This wing has two doors (D11 and D12 to the courtyard and one window (W5; Illus 13) and a door to the E wing (D10) and a large door in the ESE gable (D1). The WNW end of the wing is roofed with grey slate and the ESE section has been replaced with asbestos.

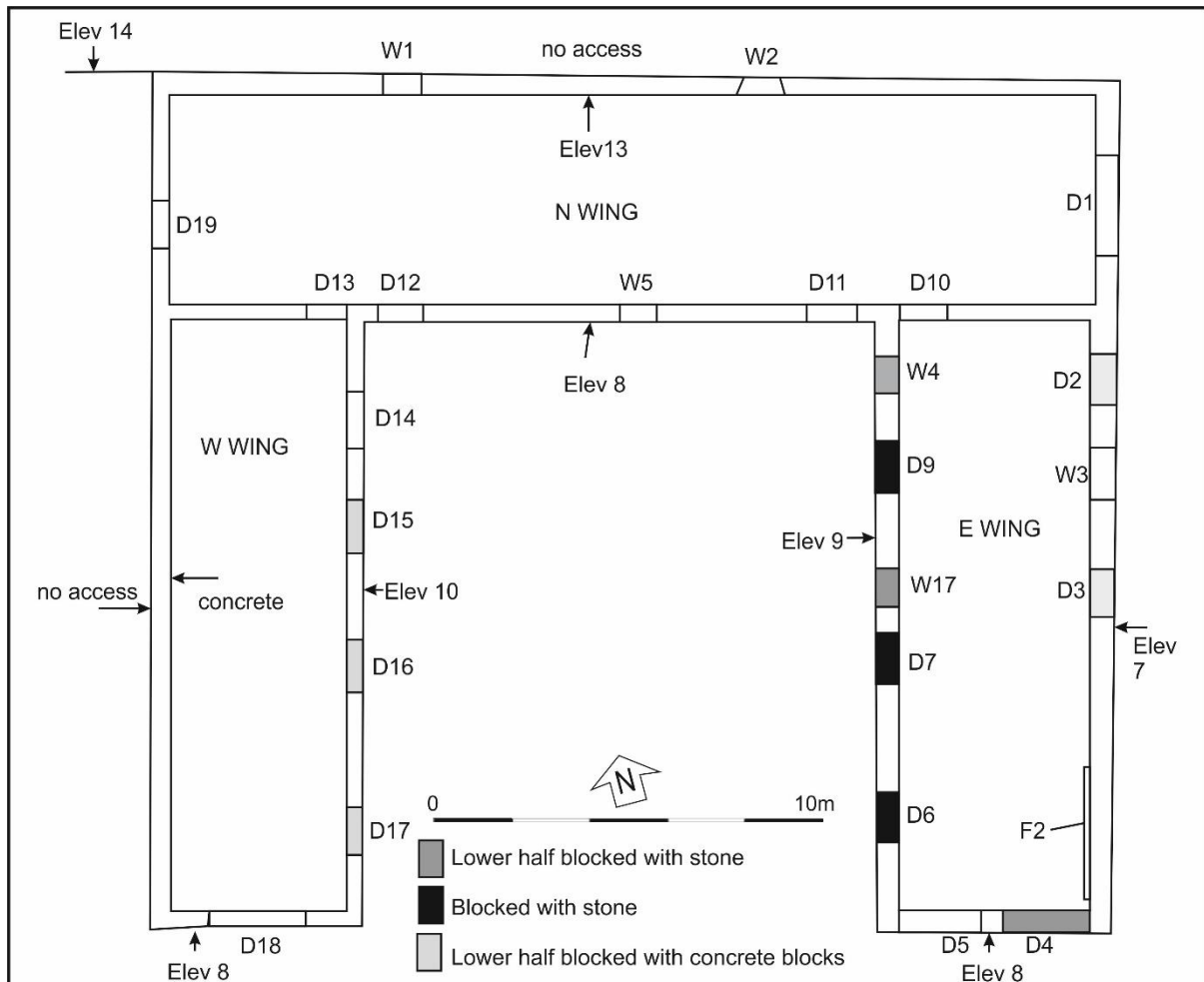

Illus 9 Plan of Building 4 annotated with numbers used in this survey

The E wing has had 5 doors to the courtyard (D9, D7 and D6; Illus 15) but two have been converted to windows by blocking the lower section with stone (W4, W17). There were 3 doors to the exterior ESE D2 has been partially blocked with concrete blocks, W3 is open at the top and blocked with stone below and the lower section of D3 has been blocked with stone and later the upper half blocked with concrete blocks. The interior walls and floor are covered with concrete (Illus 17).

There is a chimney on the exterior of the SE wall (F1; Illus 5 Elev 7) and a concrete scar on the interior where a fireplace and flue have been blocked. These may have been added when this end of the wing was converted into a cartshed, possibly to house a cartman.

The SSW end of this building has been extended between the 1st and 2nd OS dates with a small stone extension SSW of D6, adding cart doors D4 and D5 at this date. The SSW end of this building is roofed with grey slate and the NNE end replaced with asbestos.

On the SSW end of the ESE wall is a wooden board covered with Show certificates (F2 Illus 19) which pre-date the purchase by the Taylors in 1966.

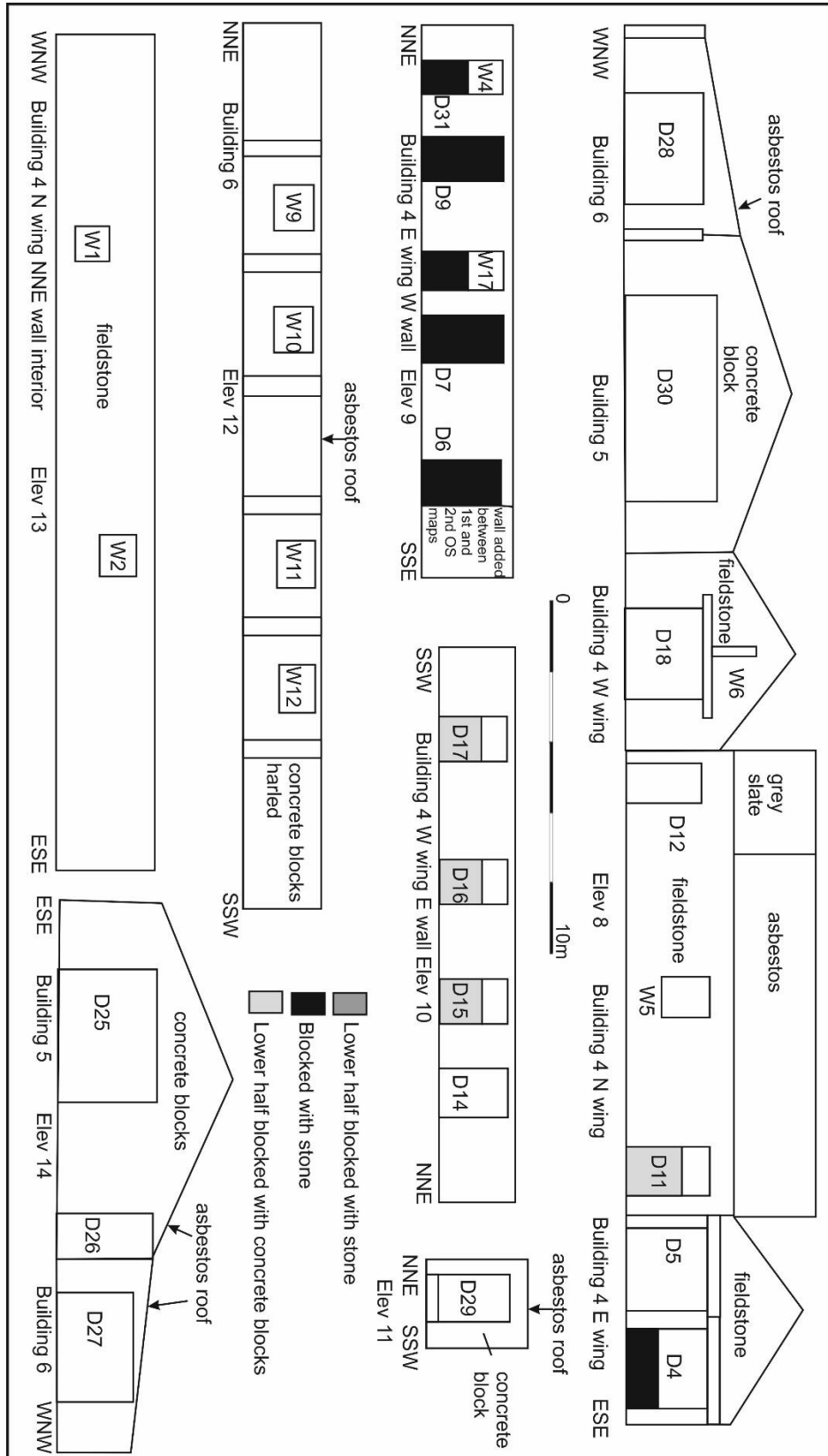

Illus 10 Elevations 8-14 annotated with numbers used in this survey



Illus 11 Building 4 W wing SSW wall D18; facing NNE



Illus 12 Building 4 W wing ESE wall D17, D16, D15, D14; facing WNW



Illus 13 Building 4 N wing SSW wall D12, W5, D11; facing NNE



Illus 14 Building 4 N wing N wall showing overgrown and inaccessible; facing ESE



Illus 15 Building 4 E wing WNW wall W4, D9, W17, D7, D6; facing ESE



Illus 16 Building 4 N wing interior; facing NNE towards gable with D19



Illus 17 Building 4 E wing interior towards gable with D10; facing NNE



Illus 18 Building 4 E wing W3 (left) with new concrete sill, D2 (right) blocked with concrete



Illus 19 Building 4 E wing interior ESE wall detail of wooden board with show certificates F2

3.5 Building 5

Building 5 was built by the Taylor family as a feeding court (Illus 20). It is 10m wide and 22.5m long and constructed of concrete blocks with asbestos roof, now collapsing (Illus 21-2). There was no access to the interior.

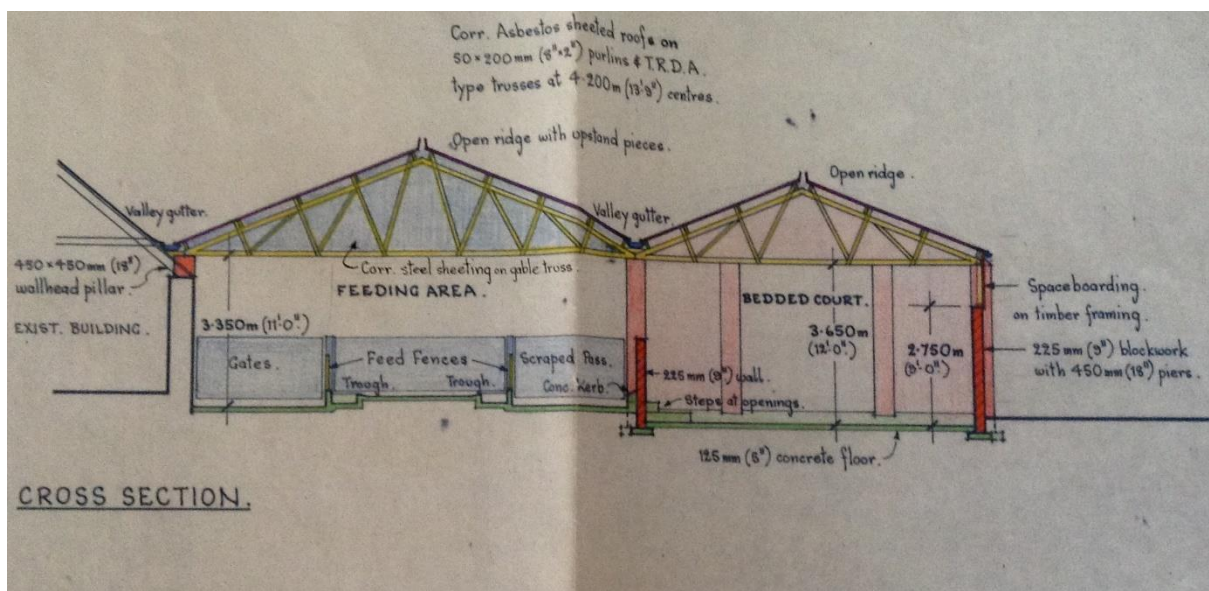

Illus 20 Cross section drawing showing Building 5 (feeding area; centre) added to 'existing building (Building 4, left) and Building 6 bedded court (right) (courtesy of Isobel Milne)



Illus 21 Building 5 SSW wall; facing NNE



Illus 22 Building 5 interior; facing NNE showing collapsing roof and asbestos roofing broken on floor

3.6 Building 6

Building 6 was built by the Taylor family as a feeding court (Illus 20). It is 5.5m wide and 25m long and constructed of concrete blocks with asbestos roof, now collapsing (Illus 23-5). There was no access to the interior.



Illus 23 Building 6 SSW wall; facing NNE



Illus 24 Building 6 WNW wall; facing NE



Illus 25 Building 6 interior showing collapsing roof and asbestos roofing broken on floor; facing NNE

3.7 Building 7

Building 7 (Illus 26) is a small, rectangular silo with a stone base and concrete harled upper level; it is not accessible.



Illus 26 Building 7; facing NE

4 CONCLUSIONS AND RECOMMENDATIONS

A Level 1 standing building survey was carried out on 11 July 2019. At least 5 phases of building were record including a C-shaped early 19th-century steading around a central courtyard (Building 4) which was extended to create a cartshed prior to the 2nd Edition OS map. Building 3 was constructed pre-1926 and Building 1 probably constructed in the mid 20th-century as a silo barn. Post-1966 additions include Buildings 2, 5 and 6.

It is recommended that no further archaeological work is required during the current planning application.

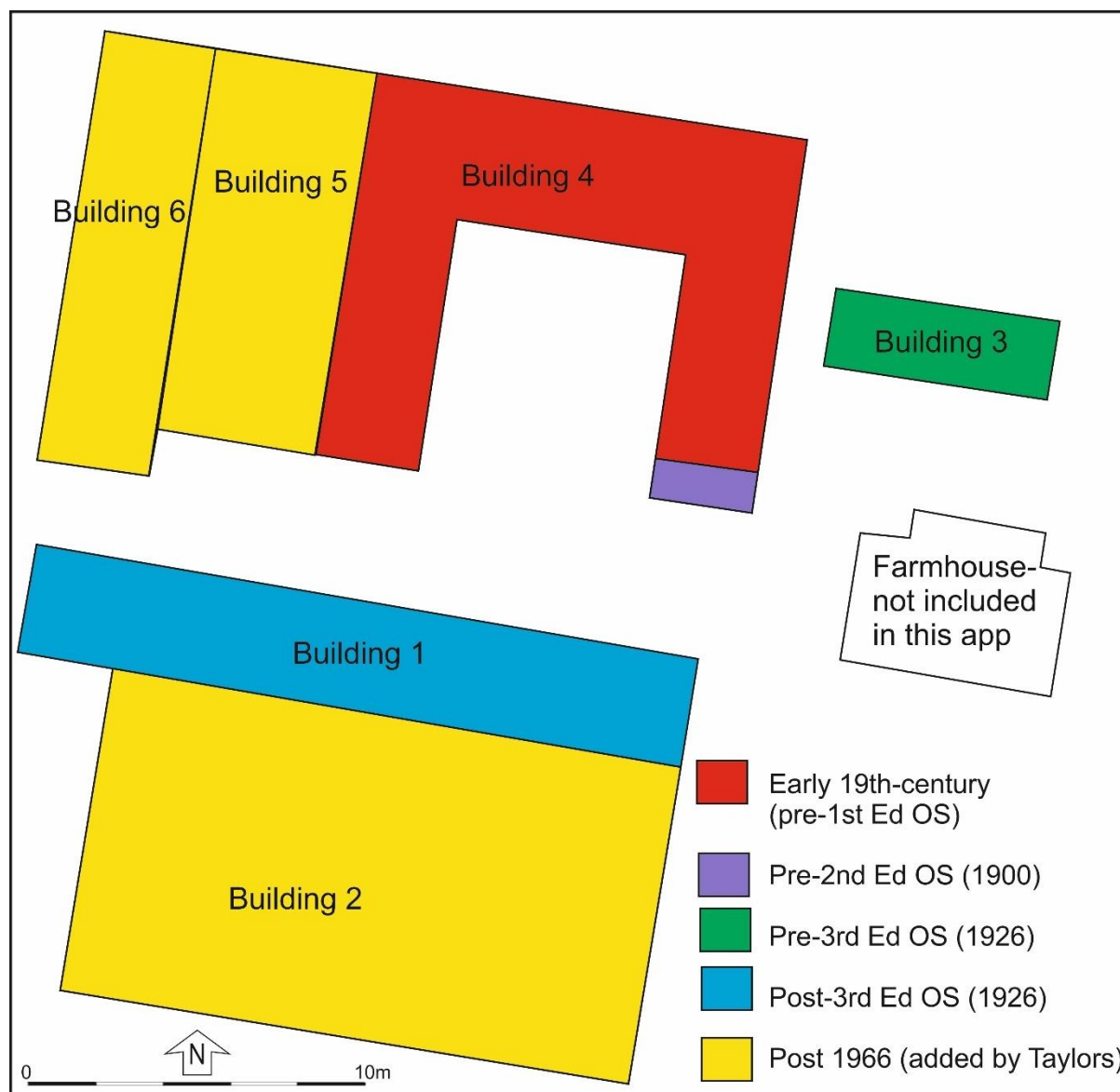

Illus 27 Phase plan

5 ACKNOWLEDGEMENTS

Thanks to Daniel Cumming, Caledonia Homes for commissioning this project and to Claire Herbert, Aberdeenshire Council Archaeology Service for her advice during the work.

Cameron Archaeology
45 View Terrace
Aberdeen
AB25 2RS
01224 643020
07581 181057
cameronarch@btinternet.com
www.cameronarchaeology.com
Company registration no 372223 (Scotland)
VAT registration no 990 4373 00

APPENDIX 1 MAPS

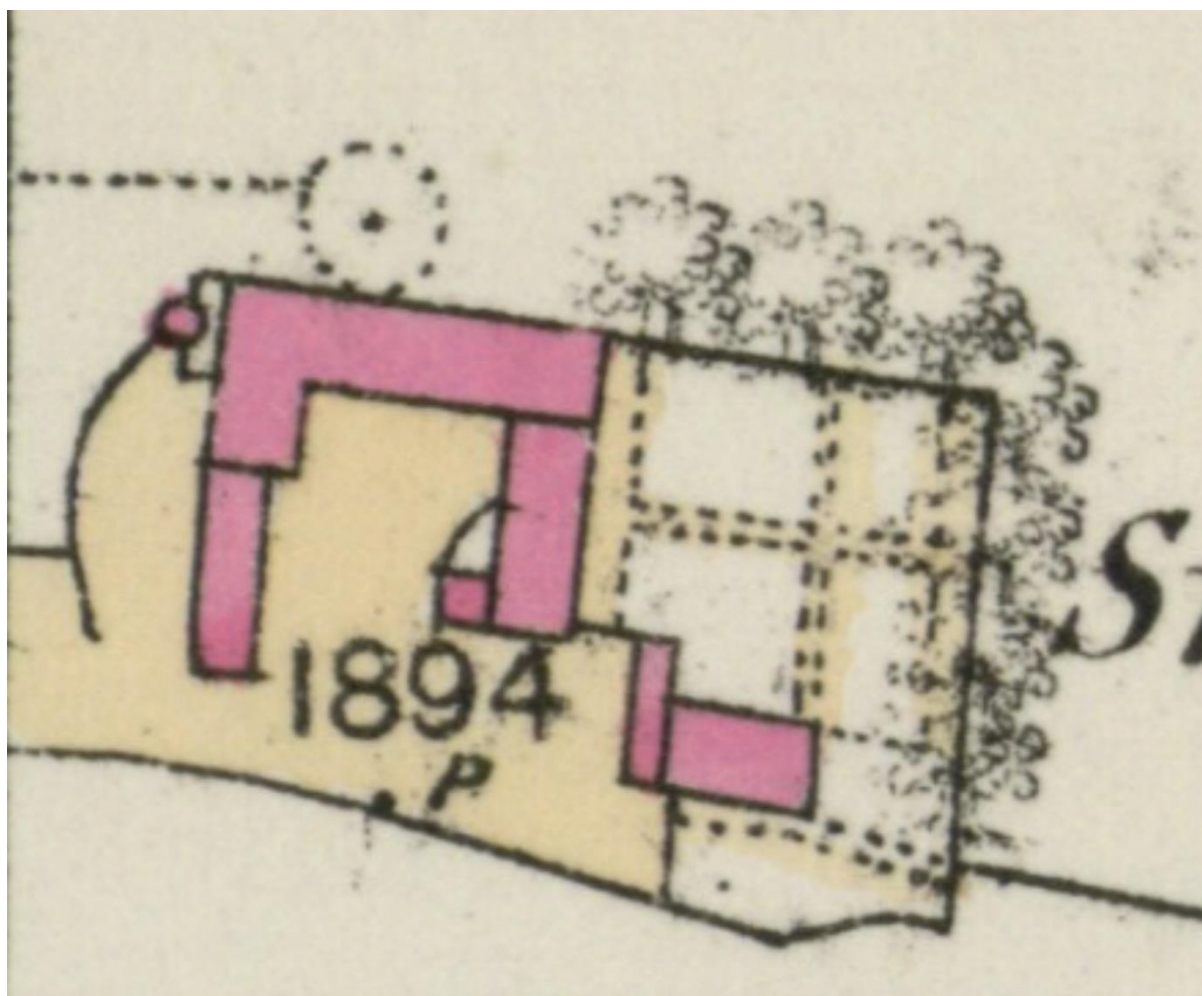

Illus 28 First Edition Ordnance Survey map Aberdeenshire XLVI.8 (with inset XLVI.11) (Tarves)
Survey date: 1867 Publication date: 1869 (copyright National Library of Scotland)

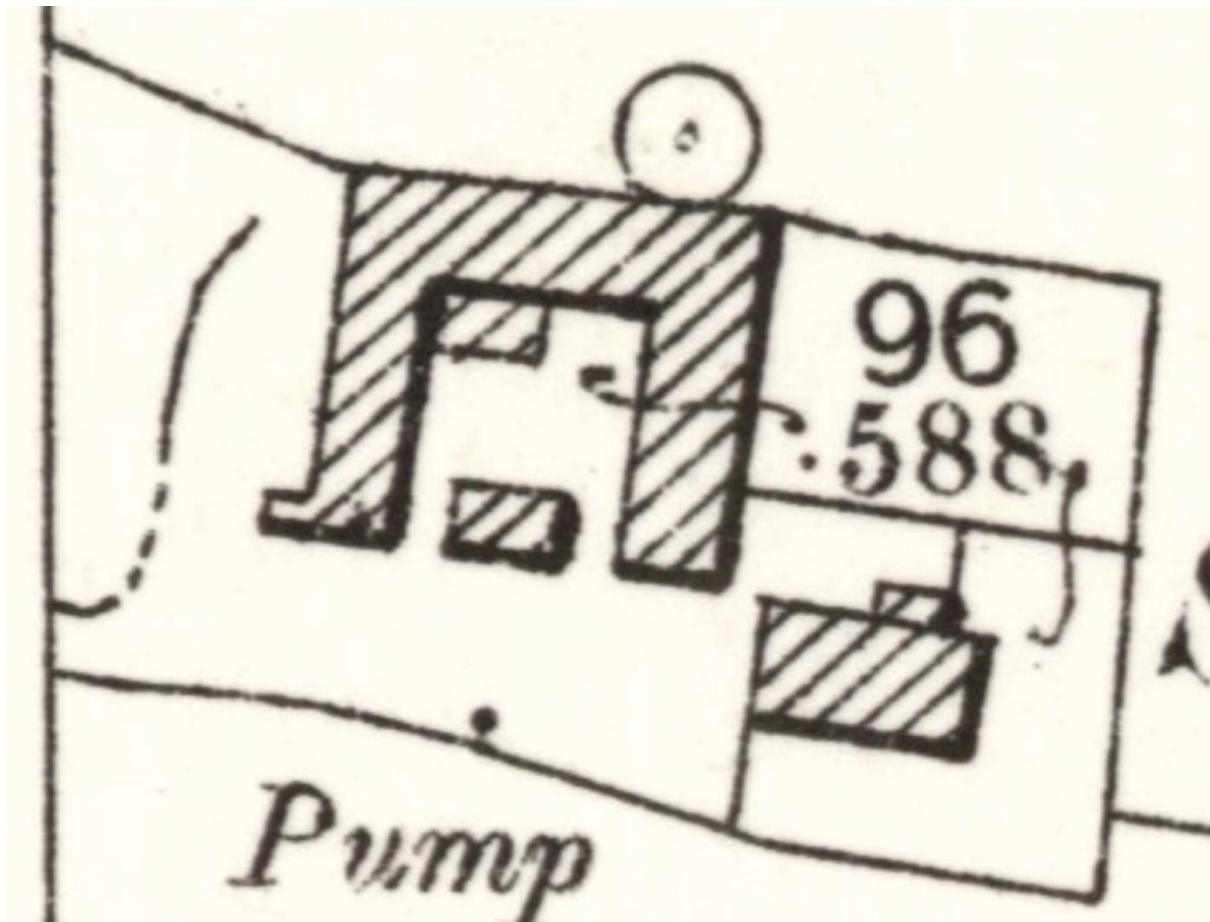

Illus 29 Second Edition Ordnance Survey map Aberdeenshire XLVI.8 (Tarves; Udney)
Publication date: 1900 Revised: 1899 (copyright National Library of Scotland)

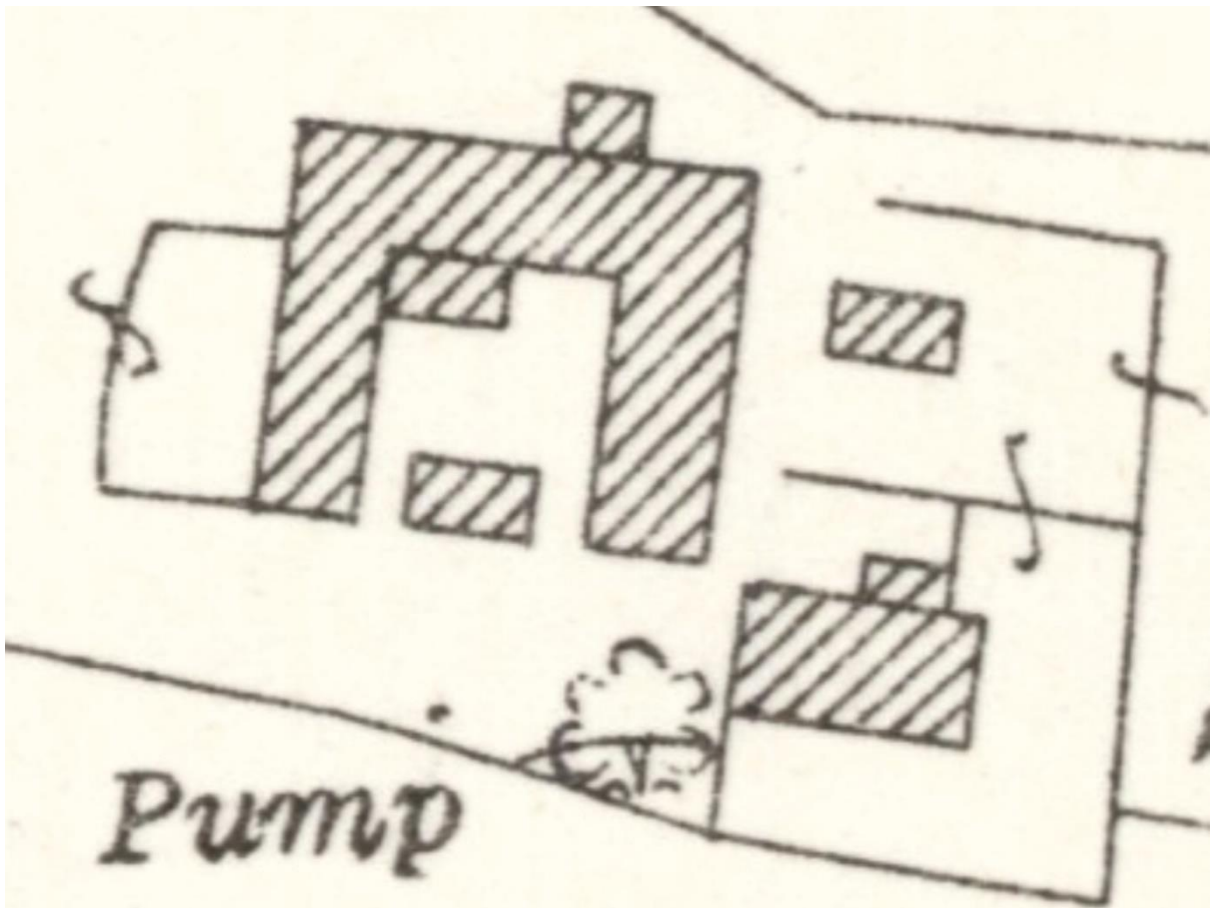

Illus 30 Third Edition Ordnance Survey map Aberdeenshire XLVI.8 (Tarves; Udney)
Publication date: 1926 Revised: 1924 Levelled: 1899 (copyright National Library of Scotland)

APPENDIX 2 PHOTOGRAPHS

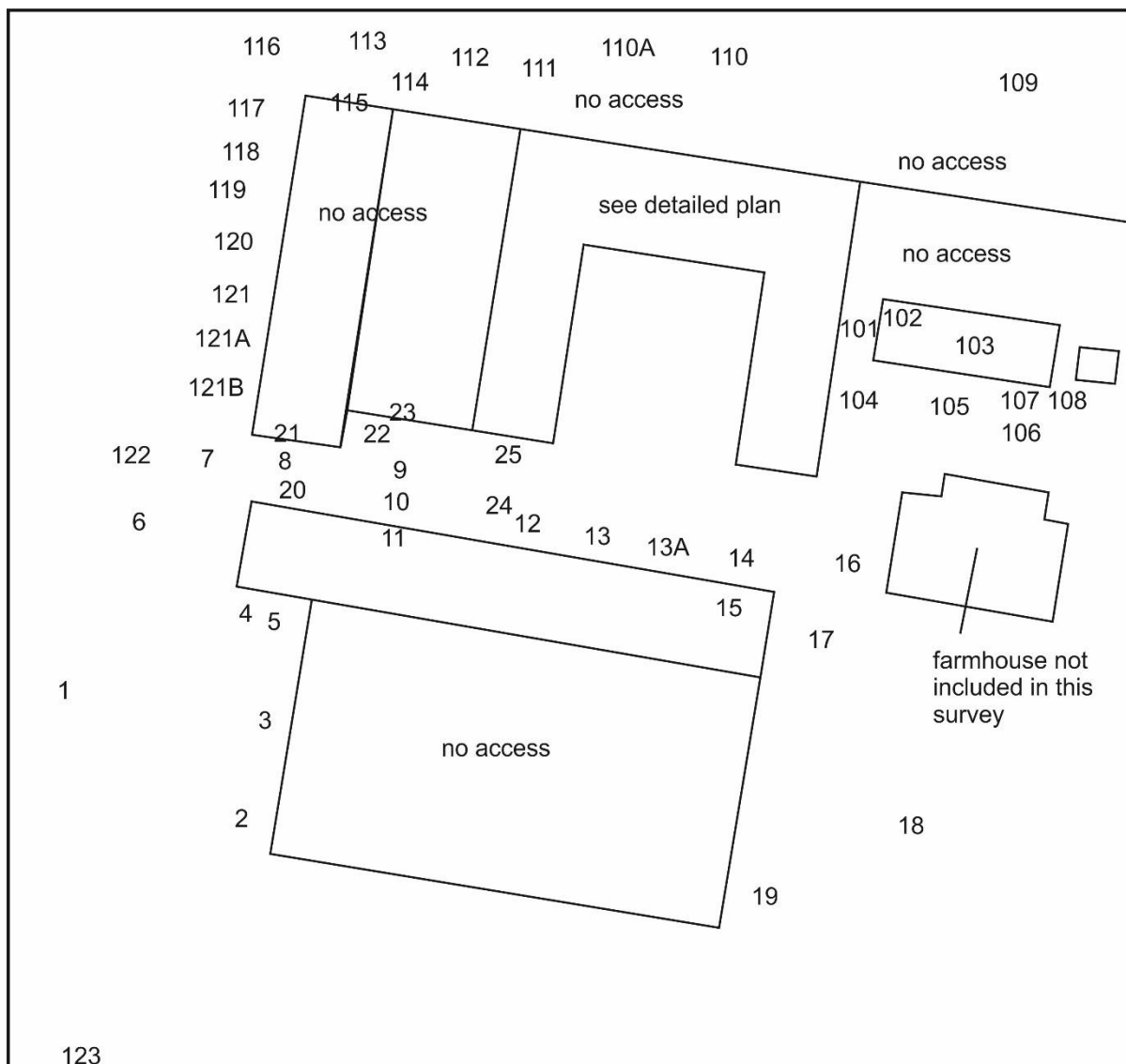

Illus 31 Camera points used in this survey – Buildings 1-3, 5-7

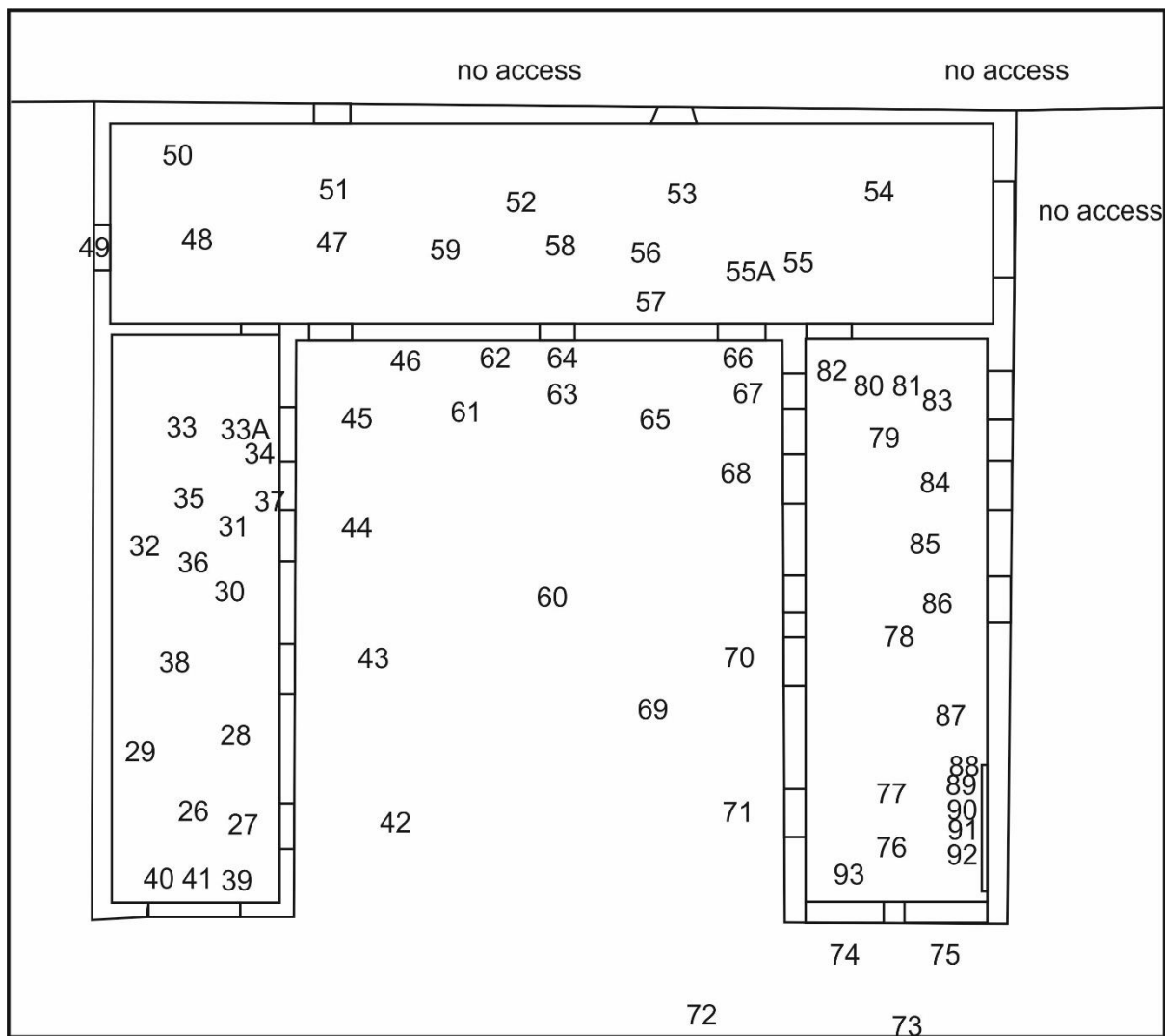

Building 4 camera points

Photo no	Description	Facing	Camera point
8810	Building 2 WNW wall D24	ESE	1
8811	Building 1 (right) Building 6 (left)	NE	1
8812	Building 2 WNW wall	ESE	2
8813	Building 2 WNW wall	ESE	3
8814	Building 2 WNW wall	ESE	3
8815	Building 2 WNW wall	ESE	4
8816	Building 1 SSW wall W7 (left) W8 (right)	NNE	5
8817	Building 1 WNW wall W13	ESE	6
8818	Building 1 metal upper level Building 1 (not accessible)	ESE	6
8819	Building 1	S	7
8820	Building 1	ESE	7
8821	Building 1 NNE wall	SSW	8
8822	Building 1 NNE wall	SSW	9
8823	Building 1 NNE wall Manufactured by A&J Main & Co Ltd Glasgow and Edinburgh	SSW	10

8824	Building 1 interior showing concrete block and metal construction	SSW	11
8825	Building 1 interior showing concrete block and metal construction	S	11
8826	Building 1 NNE wall	SSW	12
8827	Building 1 NNE wall	SSW	13
8828	Building 1 NNE wall	SSW	13A
8829	Building 1 NNE wall	S	13A
8830	Building 1 NNE wall	SW	13
8831	Building 1 NNE wall	SSW	14
8832	Building 1 ESE end interior concrete blocks	SW	15
8833	Building 1 ESE gable with harled lower and metal upper	SW	16
8834	Buildings 1 and 2 ESE façade	SSW	16
8835-6	Building 1 ESE gable with harled lower and metal upper		
8837	Building 2 ESE wall D23	WNW	18
8838	Building 2 ESE wall D23	NW	18
8839	Building 2 ESE wall	WNW	19
8840	Farmhouse (not included in this survey)	NNE	18
8841	Farmhouse (not included in this survey)	NE	17
8842	Building 6 SSW gable D28	NNE	20
8843	Building 5 SSW gable D30	NE	20
8844	Building 5 SSW gable D30	N	20
8845	Interior Building 6 - no access, roof collapsing, asbestos roofing all over floor	N	21
8846	Interior Building 6 - no access, roof collapsing, asbestos roofing all over floor	NNE	21
8847	Interior Building 6	NE	21
8848	Building 6 ESE wall Elev 11 D29	WNW	22
8849-50	Building 5 SSW elevation D30	WNW	10
8851-2	Building 5 interior - no access, roof collapsing, asbestos roofing all over floor	N	23
8853-4	Building 5 interior - no access, roof collapsing, asbestos roofing all over floor	NNE	23
8855-7	Building 5 interior - no access, roof collapsing, asbestos roofing all over floor	NE	23
8858-9	Building 5 interior - no access, roof collapsing, asbestos roofing all over floor	NNE	23
8860	Building 4 W wing SSW elevation D18	NNE	24
8861	D18	NNE	25
8862	W6	NNE	25
8863	Interior D18	SSW	26
8864	Building 4 W wing WNW wall plastered	WNW	27
8865	Building 4 W wing WNW wall plastered	WNW	28
8866	Building 4 W wing WNW wall plastered	WNW	29

8867	Building 4 W wing WNW wall plastered	WNW	30
8868	Building 4 W wing WNW wall plastered	WNW	31
8869	Building 4 W wing WNW wall plastered	WNW	32
8870-1	Building 4 W wing WNW wall plastered	WNW	33
8872	Building 4 W wing	SSW	33
8873-4	Building 4 W wing NNE wall door browkn through D13	NNE	33
8875-6	Building 4 W wing ESE wall D14	ESE	33
8877	D14	ESE	33A
8878-80	D14 SSW jamb stonework uncovered	SE	34
8881	D15	ESE	35
8882	Switch adjacent to D15	ESE	37
8883	D16	ESE	38
8884	D17	ESE	26
8885-6	ESE jamb D18	SE	41
8887-8	WNW jamb D18	SW	41
8889-90	W6	SSW	41
8891-2	Building 4 W wing	NW	13
8893	Building 4 N wing	NNE	13
8894	Building 4 E wing	NE	13
8895	Building 4 W wing ESE wall D14	WNW	70
8896	D17	WNW	42
8897	D16	WNW	43
8898	D15, D14	WNW	44
8899	D14	WNW	45
8900	D12	NNE	46
8901	D12 internal	SSW	47
8902	roof above D12	SSW	47
8903-4	D13 NNE wall W wing	SSW	48
8905	D19 steps down into Building 5 - no access - collapsing roof and asbestos roofing over floor	WNW	49
8906	Building 5 - no access - collapsing roof and asbestos roofing over floor	WSW	49
8907	Building 5 - no access - collapsing roof and asbestos roofing over floor	SW	49
8908-0	Building 4 N wing WNW wall D19	WNW	48
8910-11	Building 4 N wing NNE wall	NNE	48
8912	Building 4 N wing NNE wall water trough	WNW	50
8913	Building 4 N wing NNE wall water trough	WNW	50
8914	Building 4 N wing NNE wall W1	WNW	51
8915	Building 4 N wing NNE wall W1	NW	52
8916	Building 4 N wing NNE wall W2	NE	52
8917	Building 4 N wing NNE wall	WNW	52
8918	Building 4 N wing NNE wall W2	WNW	53
8919-20	Building 4 N wing NNE wall	WNW	54
8921-2	Building 4 N wing ESE wall D1	ESE	54

8923	Building 4 N wing	WNW	54
8924	Building 4 N wing SSW wall D10	SSW	54
8925	Building 4 N wing SSW wall D10 (left) D11 (right) converted to window	SSW	55
8926-7	D11	SSW	55A
8928	W11 (left) W5 (right)	SSW	53
8930	Iron ring for tying cattle	SSW	57
8931	W5	SSW	58
8932-33	W5 (left) D12 (right)	SSW	59
8934	Building 4 courtyard	NW	42
8935	Building 4 courtyard	NNE	42
8936	Building 4 courtyard	NE	42
8937	Building 4 N wing SSW wall D12 (left) W5 (right)	NNE	45
8938	Iron ring for tying cattle	NNE	61
8939-40	W5	NNE	63/64
8941	W5 (left) D11 (right)	NNE	65
8942	D11	NNE	66
8943-5	Building 4 E wing WNW wall	ESE	44
8946	W4(left) D9 (right)	ESE	65
8947	W4	ESE	67
8948	D9 blocked with stone	ESE	68
8949	W17 (left) D7, D6 (right)	ESE	69
8950	W17	ESE	70
8951	D7 blocked with stone	ESE	71
8952-3	D6 blocked with stone	SE	71
8954	Building 4 E wing	NNE	72
8955	Building 4 E wing	NE	72
8956	Building 4 E wing SSW wall D5 (left) D4 (right; converted to window)	NNE	73
8957	D5	NNE	74
8958	D4 converted to window with stone	NNE	75
8959	D5 (right) D4 (left)	SSW	76
8960	D5	SSW	76A
8961	D4	SSW	76B
8962	Building 4 E wing WNW wall blocked door D6	WNW	77
8963-4	Building 4 E wing WNW wall blocked door D7 (left) W17 (right)	WNW	78
8965	Blocked D9	WNW	79
8966-7	W4	WNW	81
8968-9	Building 4 E wing	SSW	81
8970-1	Building 4 E wing NNE wall D10	NNE	79
8972	D10	NNE	82
8973-4	Building 4 E wing ESE wall D2 (left) W3 (right)	ESE	79
8975	D2	ESE	83

8976	W3	ESE	84
8977	W3 (left) D3 (right)	ESE	85
8978	D3	ESE	86
8979	Scar below chimney F1	ESE	87
8980	Wooden trophy board F2	ESE	76
8981	Building 4 E wing	NNE	76
8982-96	F2	ESE	88-92
8997-8	D5 ESE jamb	SE	93
8999-9000	D5 WNW jamb	SW	93
9001	Building 1 (right) B2 (left) ESE wall	SSW	16
9002	Building 1 (right) B2 (left) ESE wall	SW	16
9003	B4 (right)	WNW	16
9004	B4 (right)	NW	16
9005-6	Building 4 E wing ESE wall	WNW	94
9007	Building 4 E wing ESE wall	SW	95
9008	Building 4 E wing ESE wall	WNW	95A
9009-10	Chimney F1	WNW	95
9011	Chimney F1	NW	95B
9012	Building 4 E wing ESE wall	NNE	95B
9013	Building 4 E wing ESE wall D3	SW	97
9014-15	Building 4 E wing ESE wall D3 (left) W3 (right)	WNW	98
9016-17	Building 4 N wing ESE wall D1	NW	100
9018	Concrete block wall NNE of Building 3 (not accessible)	WNW	100
9019	Concrete block wall NNE of Building 3 (not accessible)	NE	100
9020-21	Building 3 WNW wall D22 W14	ESE	101
9022	Building 3 interior	SSW	102
9023	Building 3 interior	ESE	102
9024	Building 3 interior	NE	102
9025	Building 3 interior	ESE	103
9026	Building 3 interior	SE	103
9027	Building 3 interior D20 interior	SSW	103
9028	Building 3 interior W14 (left) D22 (right)	WNW	103
9029	Building 3 interior	NW	103
9033-4	Building 3 exterior	NE	104
9035	Building 3 SSW wall D20	NNE	105
9036	Building 3 SSW wall D21	NNE	106
9037	D21	NNE	107
9038-40	Building 7 stone base, concrete/harled above	NE	108
9041	Building 7 stone base, concrete/harled above	NE	106
9043	Concrete block wall SE Building 4 from NNE	SE	109

9044	Concrete block wall SE Building 4 from NNE	SSW	109
9045	Building 4 NNE wall (overgrown)	SW	109
9046	Concrete block wall SE Building 4 from NNE	SE	110
9047	Building 4 NNE wall (overgrown)	SSW	110
9048-9	Building 4 NNE wall (overgrown)	SSW	110A
9050	Building 4 NNE wall (overgrown)	SW	110A
9051	Building 4 NNE wall (overgrown)	SE	111
9052	Building 5 NNE gable D25	SSW	112
9053	Building 5 (left) D26 Building 6 D27 (right)	SSW	113
9054	Buildings 5, 4 NNE wall showing overgrown and dumping allowing no access	ESE	112
9055	Buildings 5, 4 NNE wall showing overgrown and dumping allowing no access	ESE	113
9056	Building 6 interior	SSW	115
9057	Building 6	SE	116
9058	Building 6	S	116
9059	Building 6 WNW wall	ESE	117
9060	Building 6 WNW wall W9	ESE	118
9061	Building 6 WNW wall W10	ESE	119
9063	Building 6 WNW wall	ESE	120
9064	Building 6 WNW wall W11	ESE	121
9065-6	Building 6 WNW wall W12	ESE	121A
9067	Building 6 WNW wall	ESE	121B
9068	B6 (left) B1 (right)	SE	7
9069-70	B6 (left) B1 (right)	ESE	7
9071	B6	NE	122
9072	B6 (left) B1 (right)	ESE	122
9073-6	Farm from road		