

Greenbank, Fraserburgh
AB43 7AB



Cameron Archaeology
10 November 2010

Greenbank, Fraserburgh, AB43 7AB

SUMMARY

Cameron Archaeology attended the site at Greenbank, Fraserburgh, AB43 7AB on 9 November 2010. An archaeological evaluation was carried out on a small area (40 x 10m) where topsoil remained undisturbed; the rest of the site had been stripped of topsoil earlier in the year and building had commenced. The remainder of the site was walked over to determine if any archaeological deposits were visible. No archaeological remains were identified and no finds recovered.

CONTENTS

1	Introduction	3
2	Archaeological background	4
3	The archaeological evaluation	5
4	Archive	9
5	References	9
	Appendix 1 Photographs	10

ILLUSTRATIONS

Cover Trench 1 facing NW

III 1	Location plan	3
III 2	Site outline showing area available for evaluation	4
III 3	Location of Trenches 1 and 2	5
III 4	Trench 1 facing SE	5
III 5	Trench 2 facing NW	6
III 6	Building plots 7-10 where building has already commenced	7
III 7	House platforms created (Plots 20-22); facing NE	7
III 8	E side of site with topsoil stripped	8
III 9	E section of site showing scarping of natural subsoil	8

1 INTRODUCTION

Claymore Homes Ltd (contact Steven Rollo) received planning permission from Aberdeenshire Council Planning (APP/2009/1462) for the construction of 57 homes on 26/1/2010 with an archaeology condition. The field evaluation was carried out in the context of Scottish Planning Policy (SPP) Planning Advice Note 42 (PAN 42) and Scottish Historic Environment Policy (SHEP), which state that archaeological remains should be regarded as part of the environment to be protected and managed.

The site is 340m N-S and 200m E-W and is located on former arable land at 35-40m OD.

Cameron Archaeology attended the site at Greenbank, Fraserburgh, AB43 7AB (NJ 97997 65421) on 9 November 2010. Most of the site had already been stripped of topsoil and prepared for building, some foundations had been sunk and building started. An archaeological evaluation was carried out on a small area (40 x 10m) where topsoil remained undisturbed and the rest of the site was walked.

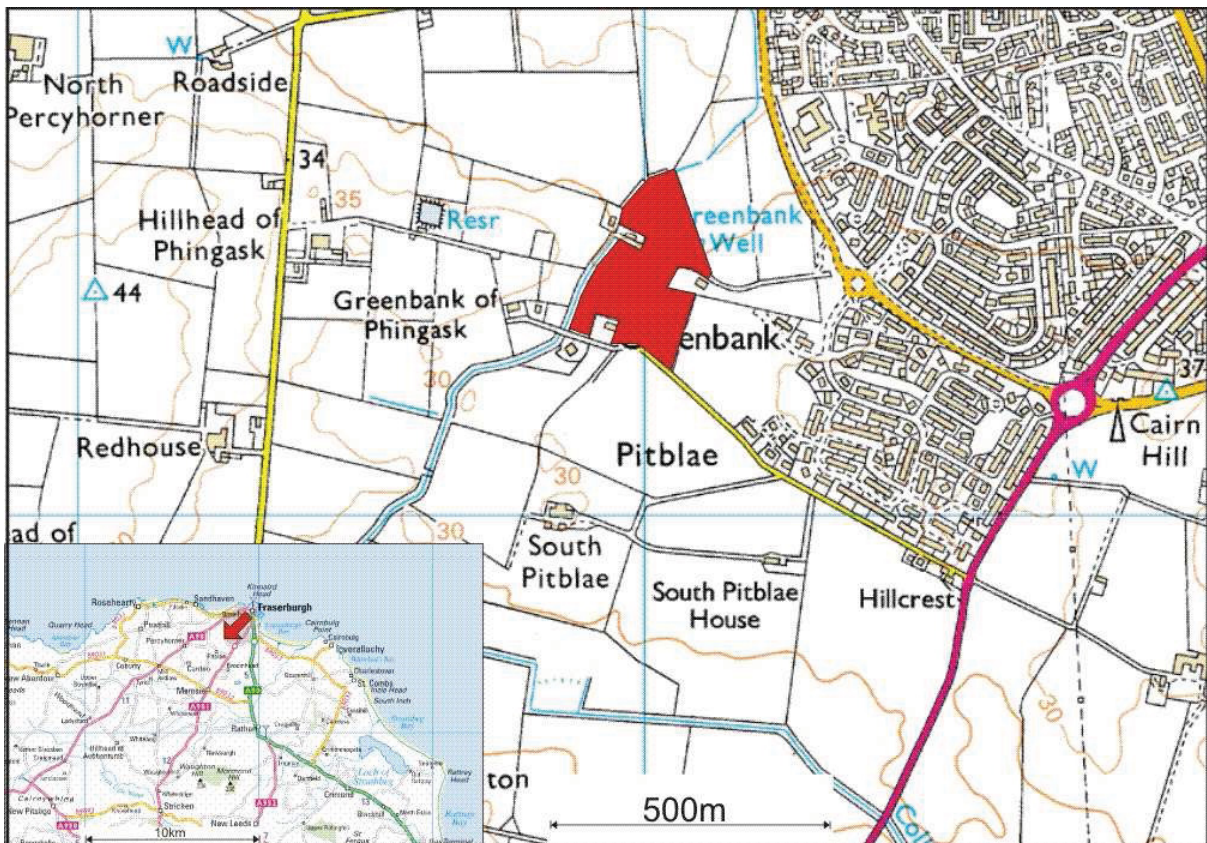

III 1 Location plan (Contains Ordnance Survey data © Crown copyright and database right 2010)

2 ARCHAEOLOGICAL BACKGROUND

There have been no archaeological interventions in the area of the current development site. There is a documentary reference to Greenbank Well (NMRS NJ96NE0055; Ill 4) on the NE boundary of the site and Pitblae Croft (Aberdeenshire SMR NJ96NE70; Ill 4) just outwith the site to the south. Several finds have been recorded in the vicinity including two flint spearheads (NJ96SE 5, NJ96NE 4), two flint arrowheads (NJ96NE 3, 4) and a cinerary urn (NJ96NE 5). A possible cairn and cist was located at Wester Cardno (NJ96SE 2), one at Roadside (NJ96NE 5) and one at Cairn Hill (NJ96NE 23). At Wester Cardno (NJ 9663 6427) a stone cist was found in 1848 containing a 'skull and other bones of a man' (OSNB 33, 20). At Roadside a cairn was removed in 1808 which contained slight traces of human remains and an urn which crumbled to pieces on removal (ONB 33, 11). Cairn Hill (NJ 989 652) is a small hill feature and possible site of a cairn (ONB 33, 54). Two documentary springs or wells were located at Broomhead ('The Mourning Well' and 'The College Well') (NJ96SE 3, 4). The Mourning Well (NJ 9859 6415) was a well 'visited by people from all parts of the north, where the superstitious practice of leaving some trifle after drinking the waters' (NSA 1845, 12, 251; ONB 33, 63). It was filled in before 1870. Several farmsteads survive in the area including Watermill Cottages, Broomhead, Chapeltown, Mains of Cardno, Greenbank and Broomhead.

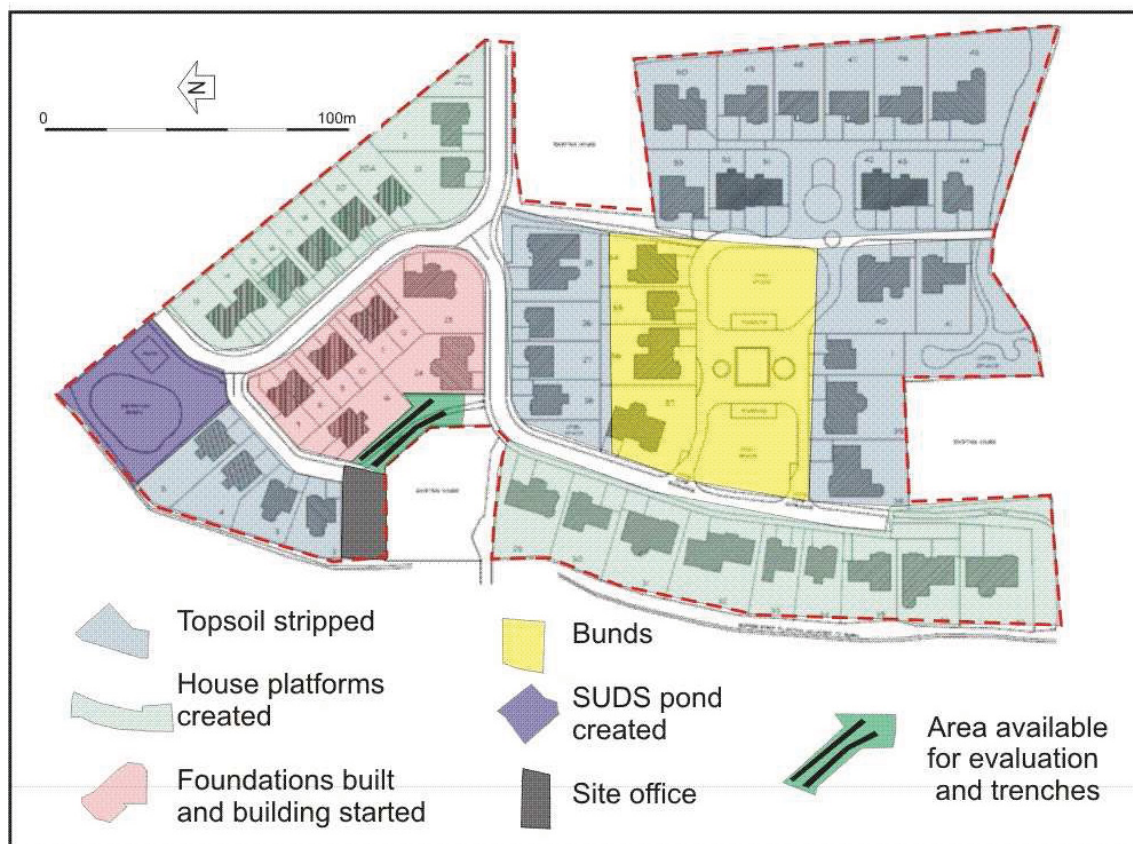

Ill 2 Site outline showing area available for evaluation (Claymore Homes)

3 THE ARCHAEOLOGICAL EVALUATION

Topsoil remained *in situ* in an area 40 x 10m. Two trenches (Trenches 1, 2; Ill 3) 35m long and 1.2m wide were excavated with a tracked machine and ditching bucket on 9 November 2010. The subsoil was rusty brown sandy gravel with occasional large boulders. The topsoil was 15-20cm deep and was well-drained loam. The area has been extensively ploughed in the recent past and no archaeological features or finds were identified.

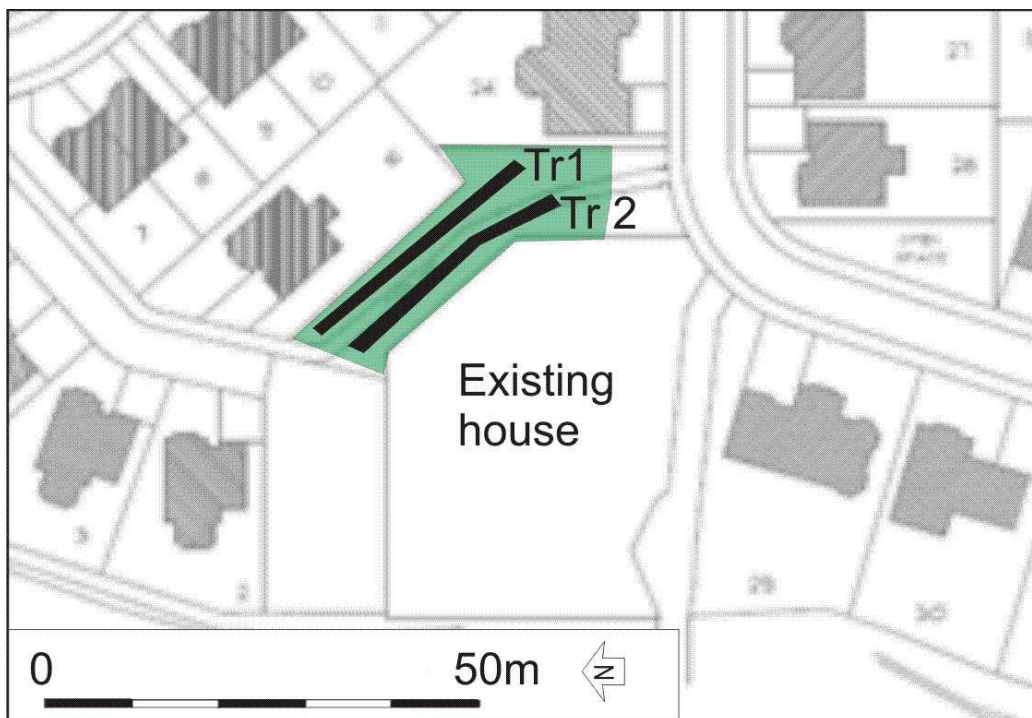

Ill 3 Location of Trenches 1 and 2 (Claymore Homes)



Ill 4 Trench 1 facing SE



III 5 Trench 2 facing NW

The remainder of the development site was walked and photographed. Much of the area had already been made up with house platforms and service trenches being dug. No remains of Greenbank well were identified. No archaeological features were identified and no finds recovered.



III 6 Building plots 7-10 where building has already commenced; facing N



III 7 House platforms created (Plots 20-22); facing NE



III 8 E side of site with topsoil stripped showing well-established bund



III 9 E section of site showing scarping of natural subsoil

4 ARCHIVE

The site archive will be lodged with RCAHMS.

5 REFERENCES

Ordnance Survey (Name Book) Object Name Books of the Ordnance Survey.

Cameron Archaeology
45 View Terrace
Aberdeen
AB25 2RS
01224 643020
07581 181057
cameronarch@btinternet.com
www.cameronarchaeology.com
Company registration no 372223 (Scotland)
VAT registration no 990 4373 00

APPENDIX 1

PHOTOGRAPHS



DSC_0862



DSC_0863



DSC_0864



DSC_0865



DSC_0866



DSC_0867



DSC_0868



DSC_0869



DSC_0870



DSC_0871



DSC_0872



DSC_0873



DSC_0874



DSC_0875



DSC_0876



DSC_0877



DSC_0878



DSC_0879



DSC_0880



DSC_0881



DSC_0882



DSC_0883



DSC_0884



DSC_0885



DSC_0886



DSC_0887



DSC_0888



DSC_0889



DSC_0890



DSC_0891



DSC_0892



DSC_0893



DSC_0894



DSC_0895



DSC_0896





DSCF8973



DSCF8974



DSCF8975



DSCF8976



DSCF8977



DSCF8978



DSCF8979



DSCF8980



DSCF8981



DSCF8982



DSCF8983



DSCF8985



DSCF8986



DSCF8987



DSCF8988



DSCF8991



DSCF8992



DSCF8993



DSCF8994



DSCF8996



DSCF8997



DSCF8998



DSCF8999

Photo no	Description	Facing
DCS_0863	Trench 1	NW
DCS_0864	Building plots 7-10	NE
DCS_0865	Building plots 11-12	E
DCS_0866	Plot 23	ESE
DCS_0867	Plot 25	SE
DCS_0868	Existing Greenbank House	W
DCS_0869	Plot 28 area	E
DCS_0870	Plot 29	W
DCS_0871	Road between plots 30 and 57	SE
DCS_0872	Services Plot 57	E
DCS_0873	House plots 30-32 prepared for building	W
DCS_0874	House plots 30-32 prepared for building	SW
DCS_0875	SW corner of site	S
DCS_0876	Services Plots 38-39	S
DCS_0877	Services N of Plot 38/39	E
DCS_0878	Services Plots 38-39 showing existing house at S of site	S
DCS_0879	Plots 40/41	SE
DCS_0880	S edge of site showing small section cut through topsoil	S
DCS_0881	Plots 40/41	ESE
DCS_0882	Bund of topsoil(left)	E
DCS_0883	Plots 40/41	S
DCS_0884	Looking towards plots 51-53	NE
DCS_0885	Plot 54	NE
DCS_0886	Plot 54	NNE
DCS_0887	Topsoil bund (right)	E
DCS_0888	Subsoil bund	E
DCS_0889	Subsoil bund	E
DCS_0890	Area of plots 25-28	N
DCS_0891	Area of plots 25-28/29 showing Greenbank House	NW
DCS_0892	Area of plots 25-28	W
DCS_0893	Section through natural Plots 25-28	SW
DCS_0895	Plot 28 with Greenbank House	NW
DCS_0896	Plot 28 with Greenbank House (left) and area of evaluation (centre)	NW
DCS_0897	Plot 28 area	E
DCS_0898	Plot 29 with Greenbank House	NW
DCS_0899	Plots 50/53	E
DCS_0900	Plots 46-49 at E edge of site showing section cut through natural subsoil	E
DCS_0901	Plots 45/47	SE
DCS_0902	From Plot 50 showing topsoil bund indicating area stripped earlier this year	SW
DCS_0903	From Plot 53	S
DCS_0904	From Plot 53	SSE
DCS_0905	From Plot 53	SE
DCS_0906	Section through subsoil E edge of site, plot 47	E

DCS_0907	Plot 42 area	SW
DCS_0908	Trench 1	SE
DCS_0911	Trench 1	SW
DCS_0914	Trench 1	NW
DCS_0915	Trench 2 SE end	WNW
DCS_0918	Trench 2	NW
DCS_0921	Trench 2	NW
DCS_0925	Trench 2	SE
DCS_0926	Trench 2	SE
DSCF8968	Subsoil adjacent to SUDS pond	W
DSCF8969	SUDS pond	NW
DSCF8970	Subsoil adjacent to SUDS pond	W
DSCF8971	SUDS pond	N
DSCF8972	SUDS pond	N
DSCF8974	SUDS pond	NW
DSCF8975	Plot 7/8 under construction	NE
DSCF8979	Drainage plot 9/10	SW
DSCF8980	Foundations plot 9/10	NE
DSCF8981	House platforms Plots 16-20	NE
DSCF8982	Plots 12/23	SW
DSCF8983	Foundations plots 9/10	NW
DSCF8985	House platforms Plots 16-20	NE
DSCF8986	House platforms Plots 16-20	NE
DSCF8987	Plots 7/8 under construction (background), 9/10 foundations (centre)	NE