

Witham Archaeology

A report to Cairns Heritage Homes Ltd

November 2014



RECTORY PLACE, OLD PARSONAGE LANE, HOTON, LEICESTERSHIRE

Archaeological Monitoring and Recording

R Trimble

RECTORY PLACE, OLD PARSONAGE LANE, HOTON, LEICESTERSHIRE

Site Code: HORP14
Museum Accession No.: X.A113.2014
Planning Application No.: P/10/1371/2
NGR: SK 575 223

Archaeological Monitoring and Recording

<i>Contents</i>	<i>Page</i>
SUMMARY	1
1.0 INTRODUCTION	1
2.0 SITE LOCATION, TOPOGRAPHY & GEOLOGY (see Figs. 1 and 2).....	1
3.0 PLANNING BACKGROUND	1
4.0 ARCHAEOLOGICAL & HISTORICAL BACKGROUND	2
5.0 AIMS & OBJECTIVES	2
6.0 METHODOLOGY	2
7.0 RESULTS (Figs. 3 and 4)	3
8.0 DISCUSSION & CONCLUSION	3
9.0 ACKNOWLEDGEMENTS	3
10.0 BIBLIOGRAPHY	4
11.0 PROJECT/ ARCHIVE DETAILS	4
11.1 Project Details	4
11.2 Archive Details.....	4

Colour plates

<i>Plate 1: Foundation trench including Section 2, looking northeast; 1m scale</i>	<i>5</i>
<i>Plate 2: Section 1, looking southeast; 1m scale.....</i>	<i>5</i>
<i>Plate 3: Southeast side of the main block, looking northeast; 1m scale</i>	<i>6</i>
<i>Plate 4: Northeast side of the new building, looking east; 1m scale.....</i>	<i>6</i>

Illustrations

Fig. 1 Site Location Maps

Fig. 2 Site Location Plan - Scale 1:1000

Fig. 3 Plan Showing Recorded Sections - Scale 1:250

Fig. 4 Section Drawings – Scale 1:20

APPENDIX A – CERAMIC ARCHIVE *By Alex Beeby*

APPENDIX B – OASIS DETAILS FORM

RECTORY PLACE, OLD PARSONAGE LANE, HOTON, LEICESTERSHIRE

ARCHAEOLOGICAL MONITORING AND RECORDING

SUMMARY

A programme of archaeological monitoring and recording was undertaken by Witham Archaeology, during groundworks relating to the construction of a new office building at Rectory Place, Old Parsonage Lane, Hoton, Leicestershire. The work was commissioned by Cairns Heritage Homes Ltd to meet the requirements of a condition of planning permission imposed by Charwood Borough Council.

Earthworks visible on aerial photographs indicate medieval settlement remains on land immediately north of the site, centred on a hollow way projecting north from Old Parsonage Lane.

The current programme of monitoring and recording identified geological deposits at shallow depth over the north-western part of the site adjacent to Old Parsonage Lane. Elsewhere, comparatively late deposits associated with the farmstead were present to the full depth of excavation. A metalled surface located in the southern part of the site may have formed part of yard or possibly a track.

1.0 INTRODUCTION

A programme of archaeological monitoring and recording was undertaken by Witham Archaeology, during groundworks relating to the construction of an office and storage building, together with a cycle store, carparks and parking areas at Rectory Place, Old Parsonage Lane, Hoton, Leicestershire. The work was commissioned by Cairns Heritage Homes Ltd, to meet the requirements of a condition of planning permission imposed by Charnwood Borough Council.

Fieldwork was carried out during the period 18th – 22nd August 2014.

The information in this document is presented with the proviso that further data may yet emerge. Witham Archaeology cannot, therefore, be held responsible for any loss, delay or damage, material or otherwise, arising out of this report. The document has been prepared in accordance with the Code of Conduct of the Institute of Archaeologists.

2.0 SITE LOCATION, TOPOGRAPHY & GEOLOGY (see Figs. 1 and 2)

The village of Hoton, in the parish of Hoton and administrative district of Charnwood Borough Council, is located approximately 6km northeast of Loughborough in Leicestershire.

The site, at NGR SK 575 223, is located on the south side of the village, south of Old Parsonage Lane and close to the junction with Vinetree Terrace. The plot of c. 0.2ha is currently part a builder's yard associated with existing offices located in portable buildings further to the southeast.

The site is generally level and is located on solid geology of the Arden Sandstone Formation overlain by superficial deposits of Quaternary period glaciofluvial sand and gravel (British Geological Survey, Solid & Drift, 1:50 000).

3.0 PLANNING BACKGROUND

Full planning permission (Ref. P/10/1371/2) for an office development was granted by Charnwood Borough Council, subject to conditions including the implementation of a programme of archaeological works, to be carried out in accordance with an approved written scheme of investigation.

Following the recommendations of a desk-based assessment (Field 2010) submitted in May 2010, the local authority requested that further archaeological works should take the form of a programme of monitoring and recording.

4.0 ARCHAEOLOGICAL & HISTORICAL BACKGROUND

An archaeological desk-based assessment by Naomi Field Archaeological Consultancy (Field 2010) found no record of prehistoric or Roman remains in the vicinity of the village of Hoton.

The settlement is believed to have originated in the Saxon period. It is mentioned in the Leicestershire Survey of 1124-9, when it formed part of the Manor of Barrow on Soar held by Earl Hugh. Rectory Place lies to the south of the medieval core of the village as represented by the parish church of St Leonard's. Earthworks indicating former medieval settlement (MLE10155) have been identified on land to the north, flanking a hollow way (MLE10154) which extends northeast from Old Parsonage Lane to meet Wymeswold Road. The recorded earthworks, interpreted as tofts and crofts, are set within extensive remains of earthwork ridge and furrow (visible on current Google Maps satellite imagery).

The parish was enclosed in 1760, and in 1822 it was ordered that the road (then known as 'Back Lane' and apparently disused) defined by the hollow way north of Old Parsonage Lane should be 'stopped up' (Field 2010).

Farm buildings associated with Pear Tree Farm occupied the site from at least 1884 until 1994 or later. On the Ordnance Survey 1:2500 County Map of 1884, a courtyard arrangement is depicted, with probable catteries facing to the southeast. The same arrangement persisted until at least 1994 when depicted on the 1:10 000 Ordnance Survey. An extant wall forming the northwest boundary of the site was formerly the rear wall of the central range aligned with Old Parsonage Lane. The other ranges were open-sided and therefore probably included cattle shelter sheds.

5.0 AIMS & OBJECTIVES

The principal objectives of the project, as set out in a Witham Archaeology specification of 12th August 2014, were to:

- *allow the preservation by record of any surviving archaeological deposits and artefacts exposed by the development groundwork within the constraints imposed by the contractor's working methods, programme and development design.*
- *produce a project archive for deposition with the appropriate museum together with a client report.*
- *provide information for accession to the Leicestershire and Rutland Historic Environment Record.*

6.0 METHODOLOGY

All foundation trenches were excavated from existing ground level, using a JCB type excavator fitted with a 600mm wide bucket.

Site visits were timed to coincide with the main phases of development groundwork.

All trenches forming the main block were inspected for evidence of archaeological significant deposits. In view of the degree of late disturbance (principally from the former farm buildings), monitoring within the footprints of the associated ranges was carried out on an intermittent basis and was primarily focused on the areas closest to Old Parsonage Lane.

The stratigraphic sequence on the site was recorded through the production of a series of representative sections. Plan and sections were drawn at scales 1:10 or 1:20 as appropriate, and individual context descriptions were made for each unit of stratigraphy. Archaeological deposits and features were

photographed in monochrome (35mm film) and colour digital. The photographic record includes general views of the groundworks in progress.

7.0 RESULTS (Figs. 3 and 4)

Geological deposits (002) on the side of the site bordering Old Parsonage Lane were relatively undisturbed, comprising compact/firm mid reddish brown clay with occasional light greenish grey angular stone (80%) and patches of light reddish brown silty sand (20%). The only feature (see *Plate 2*) of possible archaeological interest was an indistinct hollow [005] containing a primary deposit (004) of dark reddish-brown clay with frequent angular stone (50%) and large fragments of greenish grey stone (50%). The deposit, measuring around 0.30m thick, was overlain by compact/firm, dark reddish brown clay containing occasional flecks of stone (003). The latter was around 0.25m thick and was separated from (004) by a diffuse boundary. Natural in the area adjacent to Old Parsonage Lane was sealed by topsoil 0.30m deep. The topsoil comprised mid reddish brown silty sand containing occasional small stone (see *Plate 1*).

Over the remainder of the site, comparatively late deposits extended to full depth in the excavated areas. A substantial quantity of pottery (006) dated 19th century was recovered from deposits immediately above a layer of cobbles at the southern end of the main block (see Fig. 3). The 'cobbles' were encountered at the base of the foundation trench. A floor consisting of bricks set on edge was located in the same area, at around 0.2m below existing ground level. Measuring around 4m wide, the floor lay within the footprint of buildings forming the south side of the former farm complex. A concrete floor identified further to the southeast, probably related to structure in the same range.

Excavations on the northeast side of the plot (see Section 3 and *Plate 4*) revealed natural clay (002) at around 1m below existing ground level, sealed by a layer (007) comprising rounded cobbles to 0.15m across (80%), angular stone to 0.2m (5%) and mid brown clayey sand (15%). The deposit was around 0.75m thick, extending from the north-western end of the trench over a distance of 6m, before thinning and lensing out altogether *c.* 7m further to the southeast. The layer was sealed by topsoil (as 001) mixed with cobbles and occasional brick.

8.0 DISCUSSION & CONCLUSION

The programme of monitoring and recording at Rectory Place revealed primarily late deposits associated with the former farm buildings, extending through the majority of the site. An area of probable metalling located on the south side of the development could relate to a yard surface pre-dating the southwest range of farm buildings, or possibly part of a track or hollow way. A stony layer (007) on the northern side of the site could represent the northward continuation of the same feature, which may represent an earlier alignment of the road followed by Old Parsonage Lane.

9.0 ACKNOWLEDGEMENTS

The author of this report would like to thank the Cairns Heritage Homes Ltd for their assistance in ensuring that the project was brought to successful conclusion. Thanks are also due to Alex Beeby for production of the pottery catalogue (Appendix A).

10.0 BIBLIOGRAPHY

Field, N 2010 *Rectory Place, Old Parsonage Lane, Hoton, Loughborough, Leicestershire, LE12 4FR. Archaeological Desk-Based Assessment*. Naomi Field Archaeological Consultancy Report **0914**

11.0 PROJECT/ ARCHIVE DETAILS

11.1 Project Details

SITE CODE: HORM14

PLANNING APPLICATION No.: P/10/1371/2

FIELD OFFICER: R. Trimble

NGR: SK 575 223

CIVIL PARISH: Hoton

DATE OF INTERVENTION: 18th to 22nd August 2014

TYPE OF INTERVENTION: Archaeological Monitoring and Recording

UNDERTAKEN FOR: Cairns Heritage Homes

11.2 Archive Details

PRESENT LOCATION: Witham Archaeology, Unit 6, Sleaford Station Business Centre, Station Road, Sleaford, Lincolnshire NG34 7RG

FINAL LOCATION: Leicestershire Museums Service

MUSEUM ACCESSION No.: X.A113.2014

ACCESSION DATE: - December 2014

The Site Archive Comprises:

Context Records	8
Section Drawings at Scale 1:20	3
Digital Photographs	17 files
Monochrome Negatives	5 shots
Set of Site Notes	1

It is intended that transfer of the archive in accordance with current published requirements will be undertaken following completion of this project.

COLOUR PLATES



Plate 1: Foundation trench including Section 2, looking northeast; 1m scale



Plate 2: Section 1, looking southeast; 1m scale



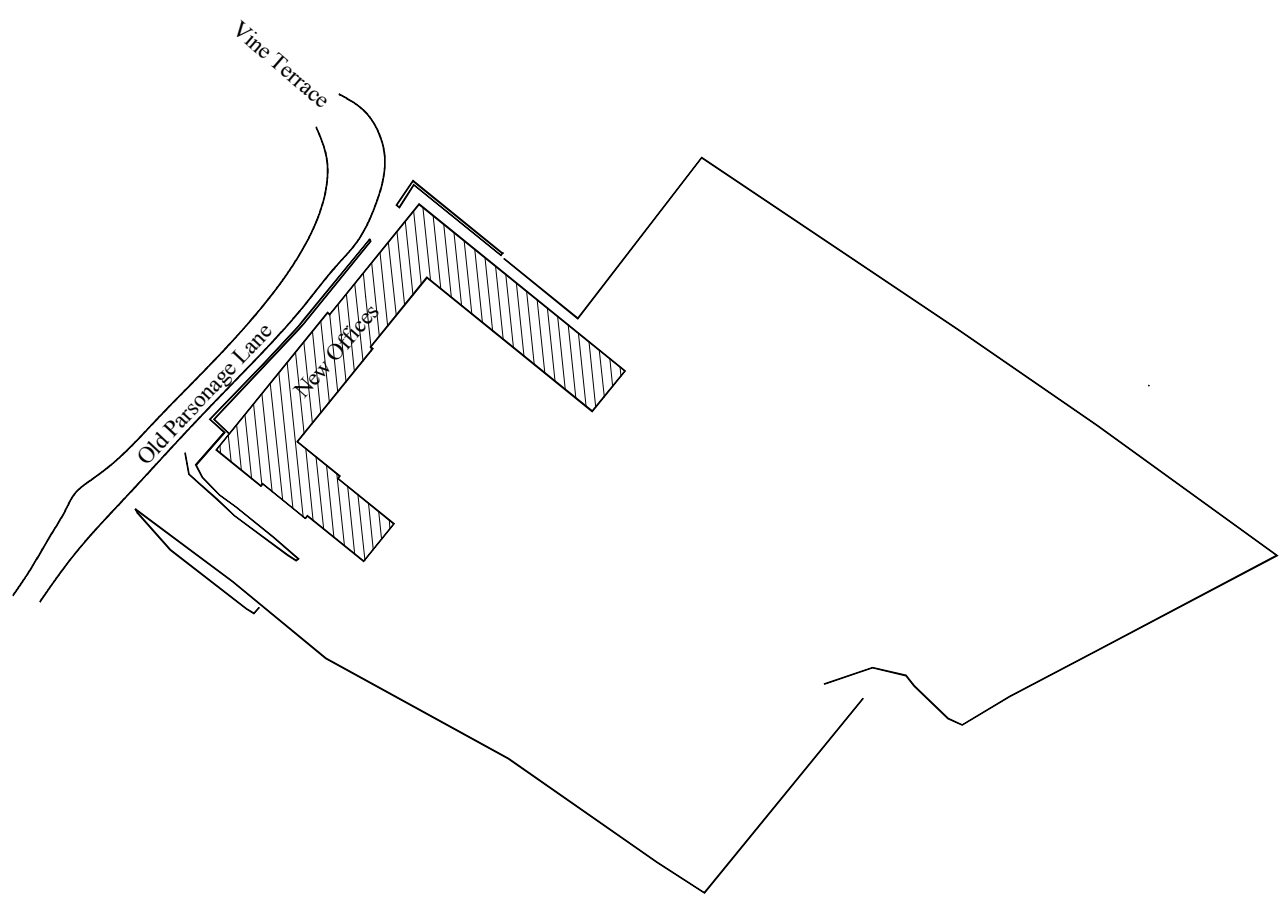
Plate 3: Southeast side of the main block, looking northeast; 1m scale

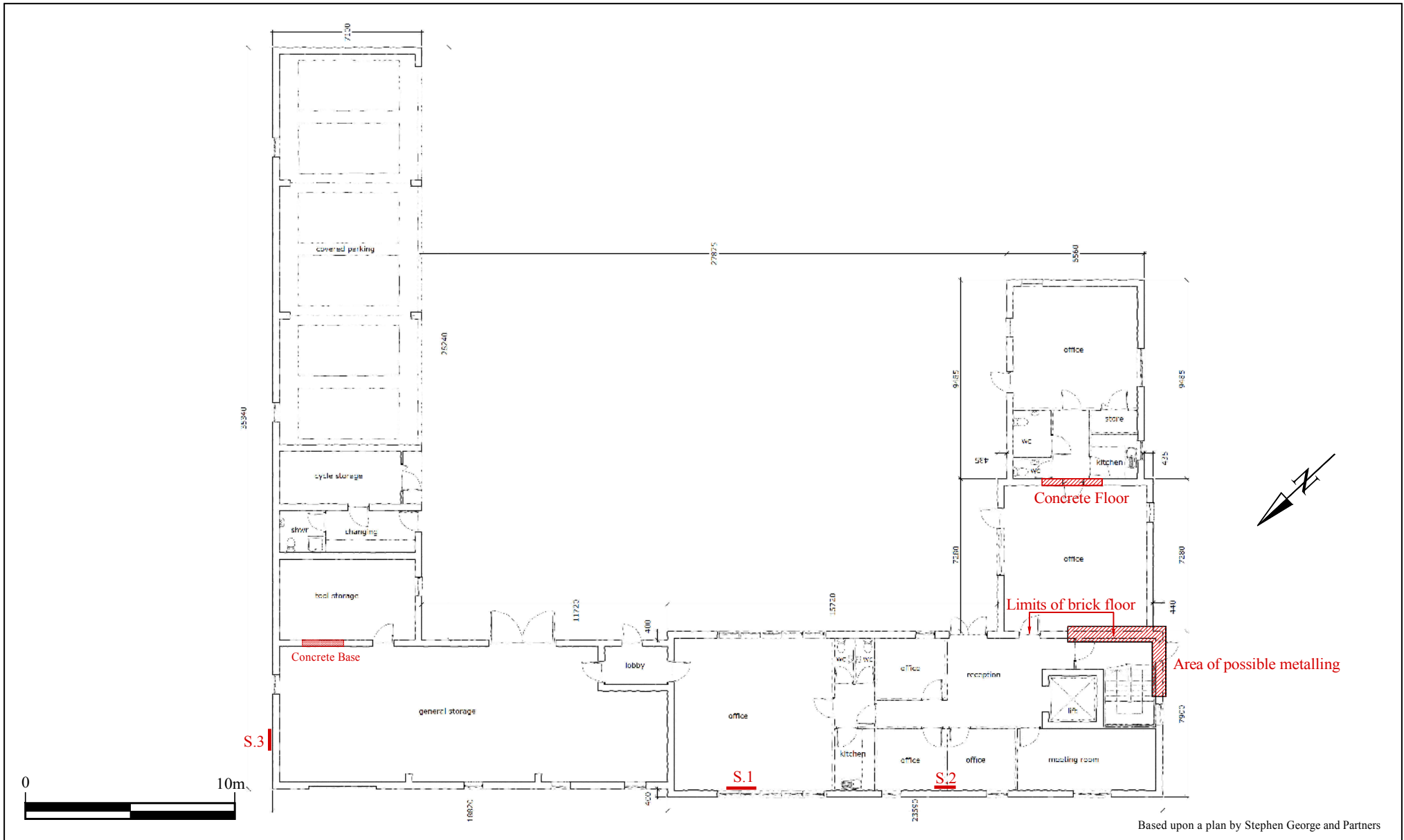


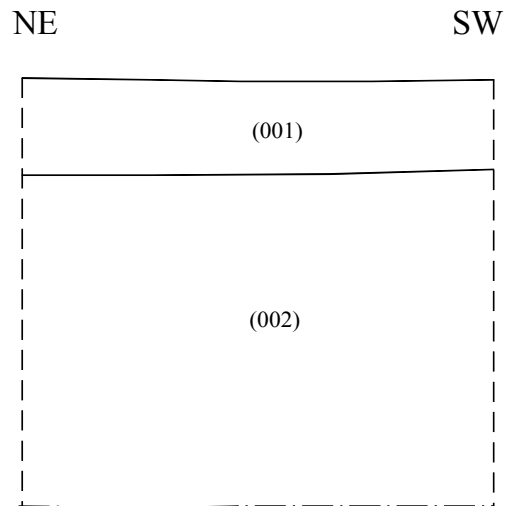
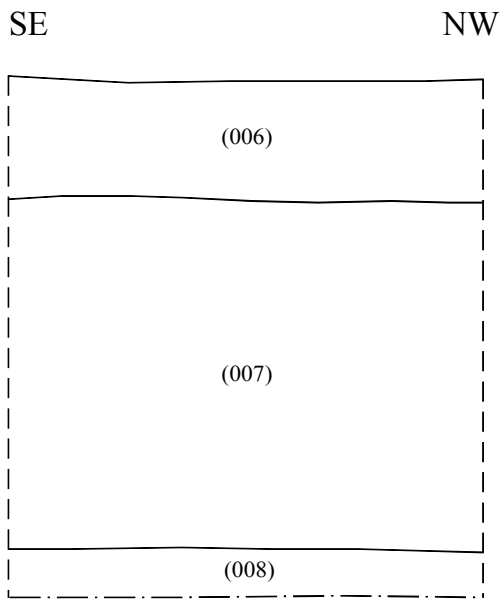
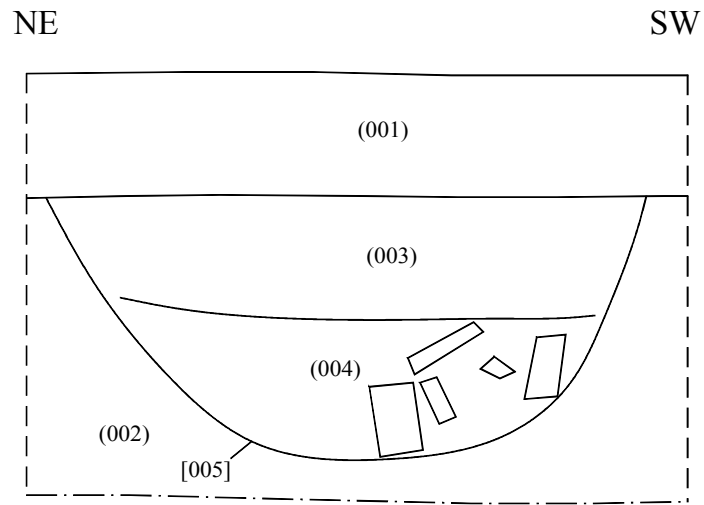
Plate 4: Northeast side of the new building, looking east; 1m scale



Produced from the Ordnance Survey Street View map with the permission of Ordnance Survey on behalf of The Controller of Her Majesty's Stationery Office. © Crown Copyright
Licence No.: 100049610







APPENDIX A – CERAMIC ARCHIVE

CERAMIC FINDS REPORT

POST ROMAN POTTERY

By Alex Beeby

Introduction

The material was recorded at archive level in accordance with the guidelines laid out in Slowikowski *et al.* (2001). The pottery codenames (Cname) are in accordance with the Post Roman pottery type series for Lincolnshire, as published in Young *et al.* (2005), which also includes material from surrounding counties. An equivalent code from the type series for Leicestershire (*c.f.* Sawday, unpublished) is included in Table 1 below. A total of ten sherds from eight vessels, weighing 423 grams was recovered from the site.

Methodology

The material was weighed and then examined visually. This information was then added to an Access database. An archive list of the pottery is included in Table 1 below. The pottery dates from the later Post Medieval to the Early Modern period.

Condition

The material is relatively fresh. Two pieces are stained, probably from contact with other domestic waste.

Results

Table 1, Post Roman Pottery Archive

Cxt	Lincs Cname	Sub Fab	Leics Cname	Full Name	Form	Dec	Part	Comment	Date	NoS	NoV	W(g)
006	BERTH	Bright Orange	EA1	Brown Glazed Earthenware	Bowl		Rim; BS		17th-18th	2	1	267
006	BERTH	Buff	EA1		Jar or Bowl		BS			1	1	52
006	PEARL		EA9		Plate	Green transfer print - rustic scene	Base	Hunting scene with hounds, rider and manor house	19th	1	1	10
006	PEARL		EA9		Meat Dish	Green transfer print -floral	Rims		19th	2	1	36
006	PEARL		EA9		Cup	Blue transfer print - geometric pattern	Base		19th	1	1	10
006	PEARL		EA9		Bowl	Blue transfer print - floral	BS		19th	1	1	23
006	CREA		EA8		Flat		Rim	?ID; stained		1	1	14
006	NCBW		EA		Bowl		Rim	White on yellow	19th	1	1	11
Total										10	8	423

Provenance

The pottery came from above an area of metalling.

Range

There are ten sherds. The fabrics are common domestic types of the Late Post Medieval and Early Modern periods.

Potential

There is no potential for further work. The material is suitable to be discarded.

CERAMIC BUILDING MATERIAL

By Alex Beeby

Introduction

The material was recorded at archive level in accordance with the guidelines laid out by the ACBMG (2001). Two fragments of ceramic building material, weighing 325 grams were recovered from the site.

Methodology

The material was viewed, weighed and then examined visually. This data was then added to an Access database. An archive list of the ceramic building material is included in Table 2 below.

Condition

The material; is relatively fresh, but there is evidence of sooting.

Results

Table 2, Ceramic Building Material Archive

Cxt	Cname	Full Name	Fabric	NoF	W(g)	Description	Date
006	PANT	Pantile	Oxidised; medium sandy	2	325	Sooted	18th-19th

Provenance

The ceramic building material came from above an area of metalling.

Range

There two fragments of Pantile; these pieces are of 18th to 19th century date.

Potential

There is no potential for further work. The fragments can be discarded.

SPOT DATING

The dating in Table 3 is based on the evidence provided by the finds detailed above.

Table 3, Spot dates

Cxt	Date	Comments
006	19th	

ABBREVIATIONS

BS	Body sherd
CXT	Context
NoF	Number of Fragments
NoS	Number of sherds
NoV	Number of vessels
W (g)	Weight (grams)

REFERENCES

~ 2001, *Draft Minimum Standards for the Recovery, Analysis and Publication of Ceramic Building Material*, third version [internet]. Available from <<http://www.geocities.com/acbmg1/CBMGDE3.htm>>
Sawday, D, Unpublished, *Pottery codenames for Leicestershire*

- Slowikowski, A. M., Nenk, B., and Pearce, J., 2001, *Minimum Standards for the Processing, Recording, Analysis and Publication of Post-Roman Ceramics*, Medieval Pottery Research Group Occasional Paper 2
- Young, J., Vince, A.G. and Nailor, V., 2005, *A Corpus of Saxon and Medieval Pottery from Lincoln* (Oxford)

APPENDIX B – OASIS FORM

OASIS DATA COLLECTION FORM: England

[List of Projects](#) | [Manage Projects](#) | [Search Projects](#) | [New project](#) | [Change your details](#) | [HER coverage](#) | [Change country](#) | [Log out](#)

Printable version

OASIS ID: withamar1-190190

Project details

Project name	Archaeological monitoring and recording at Rectory Place, Hoton, Leicestershire
Short description of the project	A programme of monitoring and recording was undertaken at Rectory Place, Old Parsonage Lane, Hoton, Leicestershire, during groundworks relating to the construction of a new office building. The site lies immediately south of probable medieval settlement remains indicated by earthwork tofts and crofts set within extant ridge and furrow. The new office building corresponds to the footprint of a group of farm buildings (demolished at some time after 1994) associated with nearby Peartree Farm and depicted in the Ordnance Survey 1:2500 map of 1884. The northwest boundary of the site adjacent to Old Parsonage Lane is defined by the rear wall of the courtyard arrangement of farm buildings. The programme of monitoring and recording revealed a high level of disturbance associated with the farm buildings extending over the majority of the site. Less disturbed ground encountered on the northwest side of the site revealed a sequence of natural clay overlain by topsoil. There was no evidence of deposits relating to the nearby shrunken medieval settlement.
Project dates	Start: 18-08-2014 End: 22-08-2014
Previous/future work	No / No
Any associated project reference codes	HORP14 - Contracting Unit No.
Any associated project reference codes	X.A113.2014 - Museum accession ID
Type of project	Recording project
Site status	Conservation Area
Current Land use	Industry and Commerce 1 - Industrial
Monument type	AGRICULTURAL BUILDING Post Medieval
Significant Finds	POTTERY Post Medieval
Investigation type	"Watching Brief"
Prompt	Direction from Local Planning Authority - PPS

Project location

Country	England
Site location	LEICESTERSHIRE CHARNWOOD HOTON Rectory Place, Old Parsonage Lane, Hoton, Leicestershire
Postcode	LE12 5SG
Study area	0.20 Hectares
Site coordinates	SK 575 223 52.7948642203 -1.14714814494 52 47 41 N 001 08 49 W Point

Project creators

Name of Organisation	Witham Archaeology
Project brief originator	Local Authority Archaeologist and/or Planning Authority/advisory body
Project design originator	Dale Trimble
Project director/manager	Dale Trimble
Project supervisor	Russell Trimble
Type of sponsor/funding body	Developer
Name of sponsor/funding body	Cairns Heritage Homes Ltd

Project archives

Physical Archive recipient	Leicestershire Museums
Physical Contents	"Ceramics"
Digital Archive recipient	Leicestershire Museums
Digital Contents	"Ceramics","Stratigraphic"
Digital Media available	"Images raster / digital photography","Text"
Paper Archive recipient	Leicestershire Museums
Paper Contents	"Ceramics","Stratigraphic"
Paper Media available	"Context sheet","Notebook - Excavation',' Research',' General Notes","Photograph","Plan","Report","Section"

Project bibliography 1

Publication type	Grey literature (unpublished document/manuscript)
Title	Rectory Place, Old Parsonage Lane, Hoton, Leicestershire. Archaeological Monitoring and Recording
Author(s)/Editor(s)	Trimble, R.
Other bibliographic details	Report No. 65

Date	2014
Issuer or publisher	Witham Archaeology
Place of issue or publication	Sleaford
Description	A4, comb-bound
Entered by	Russell Trimble (russell.trimble@withamarchaeology.co.uk)
Entered on	16 September 2014

OASIS:

Please e-mail [English Heritage](#) for OASIS help and advice

© ADS 1996-2012 Created by [Jo Gilham and Jen Mitcham](#), email Last modified Wednesday 9 May 2012

Cite only: <http://www.oasis.ac.uk/form/print.cfm> for this page

Witham Archaeology

Unit 6, Sleaford Station Business Centre, Station Road,
Sleaford, NG34 7RG

Tel/Fax: (01529) 300890

Email: info@withamarchaeology.co.uk

© Witham Archaeology