

Fig. 1: Site Location within South Derbyshire

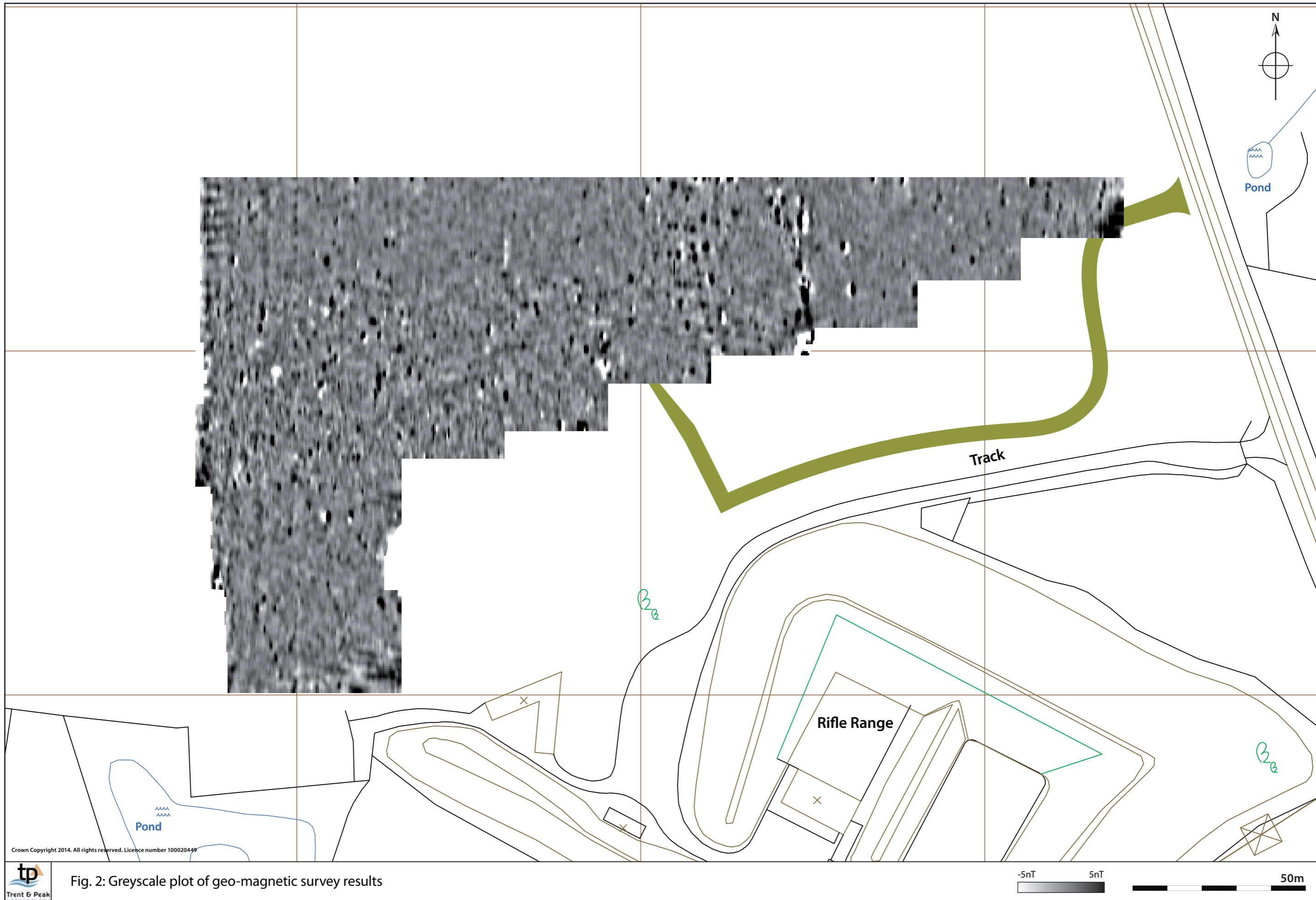
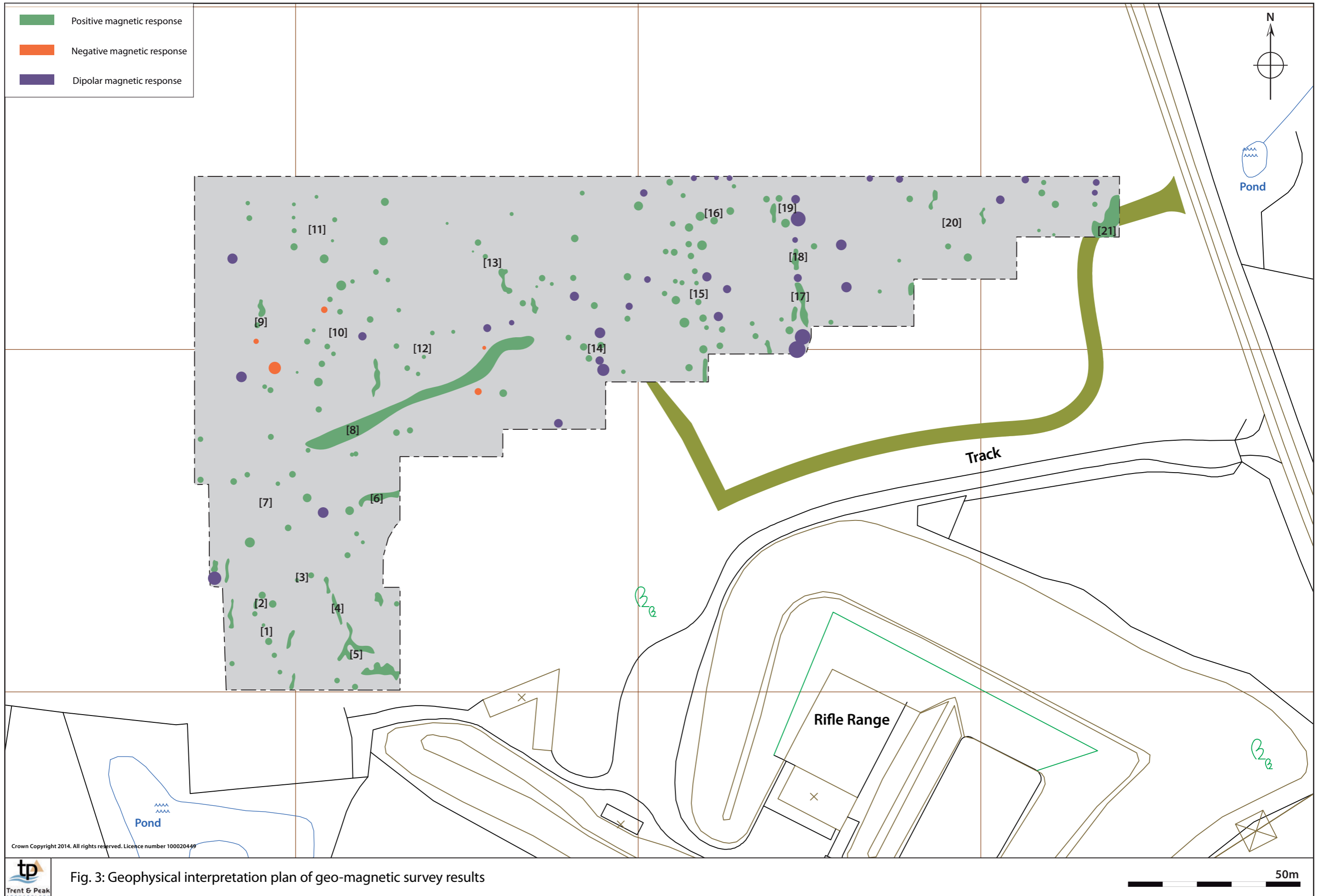

Fig. 2: Greyscale plot of geo-magnetic survey results



Crown Copyright 2014. All rights reserved. Licence number 100020449



Fig. 3: Geophysical interpretation plan of geo-magnetic survey results

50m

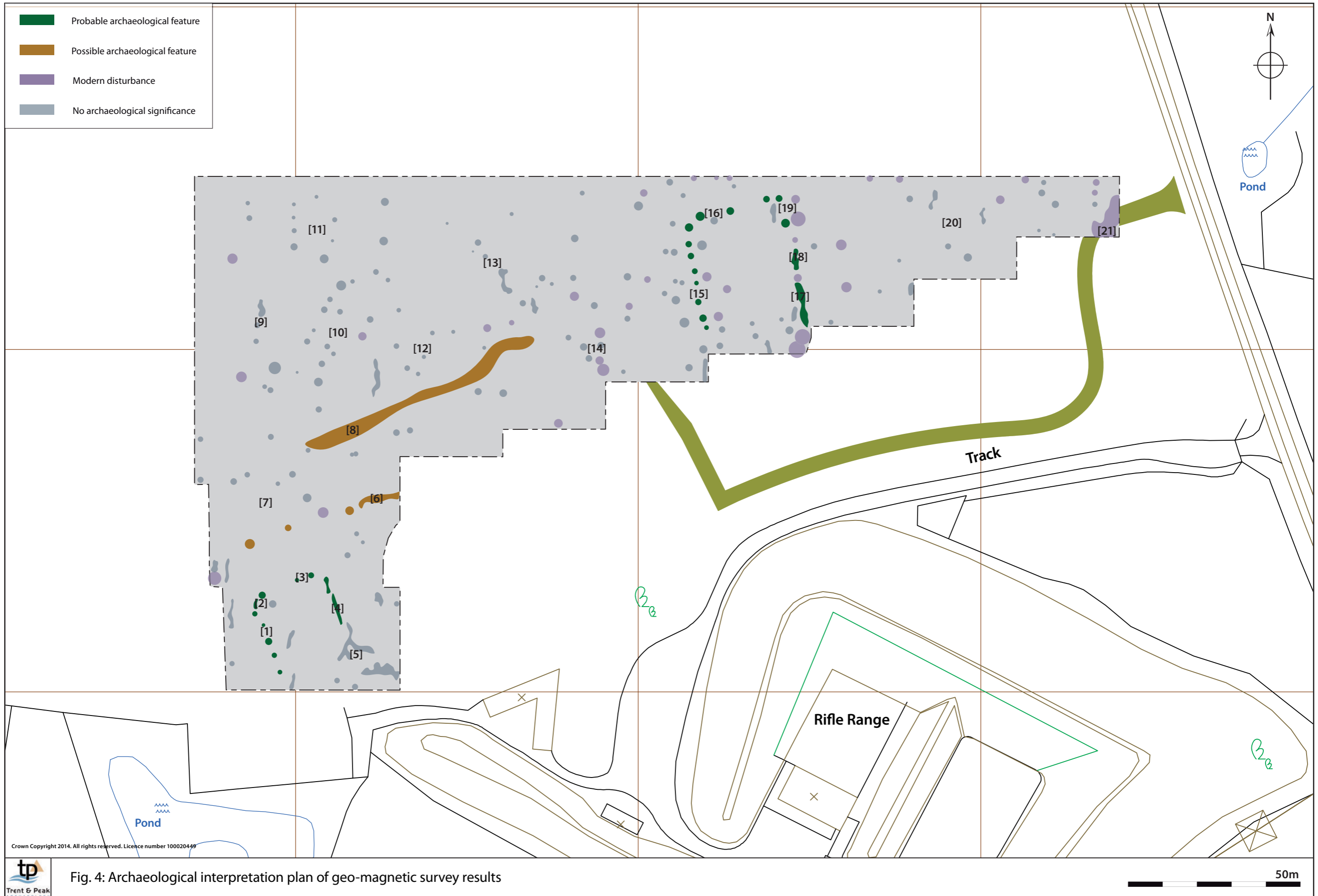
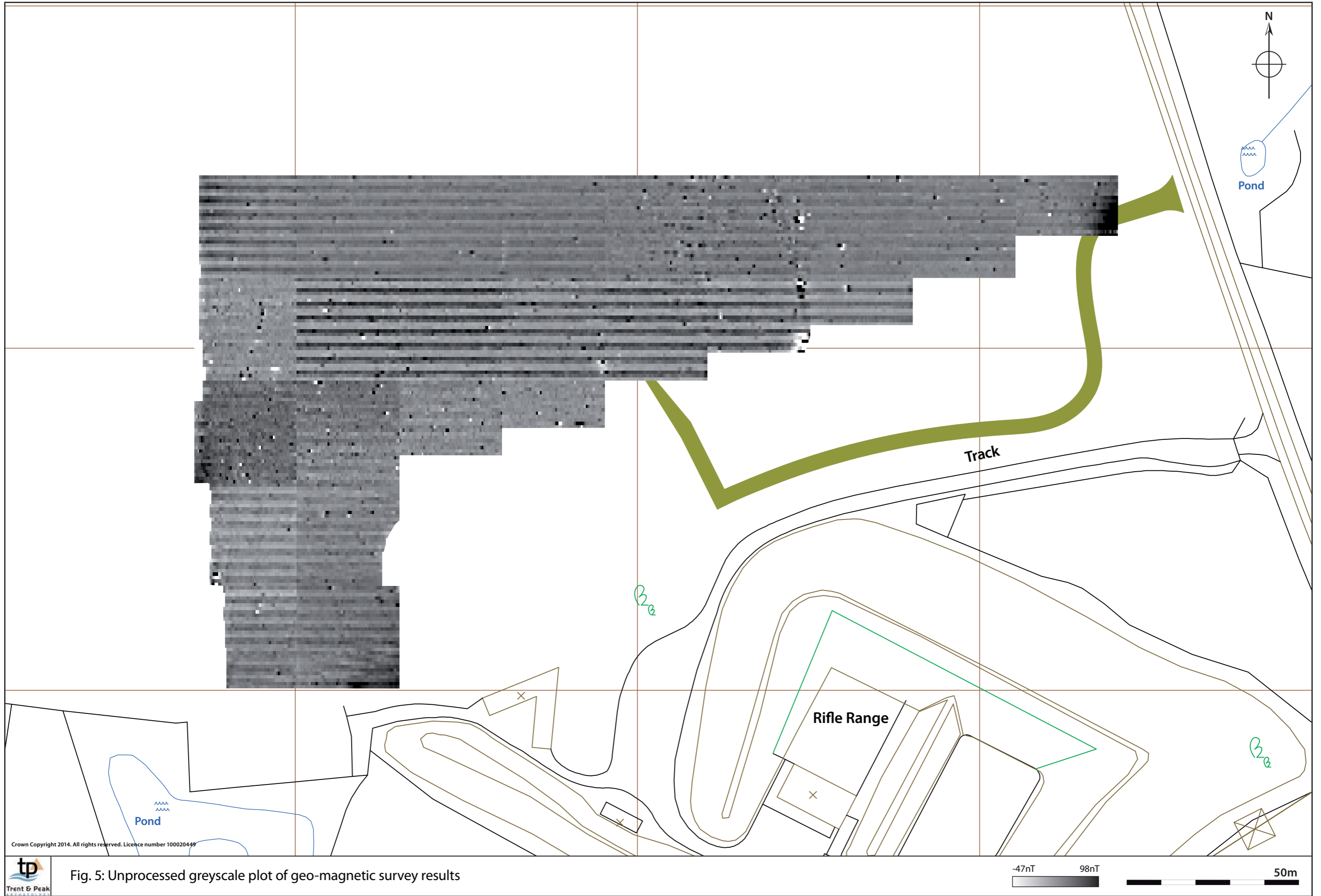

Fig. 4: Archaeological interpretation plan of geo-magnetic survey results



Crown Copyright 2014. All rights reserved. Licence number 100020449



Fig. 5: Unprocessed greyscale plot of geo-magnetic survey results

-47nT 98nT 50m



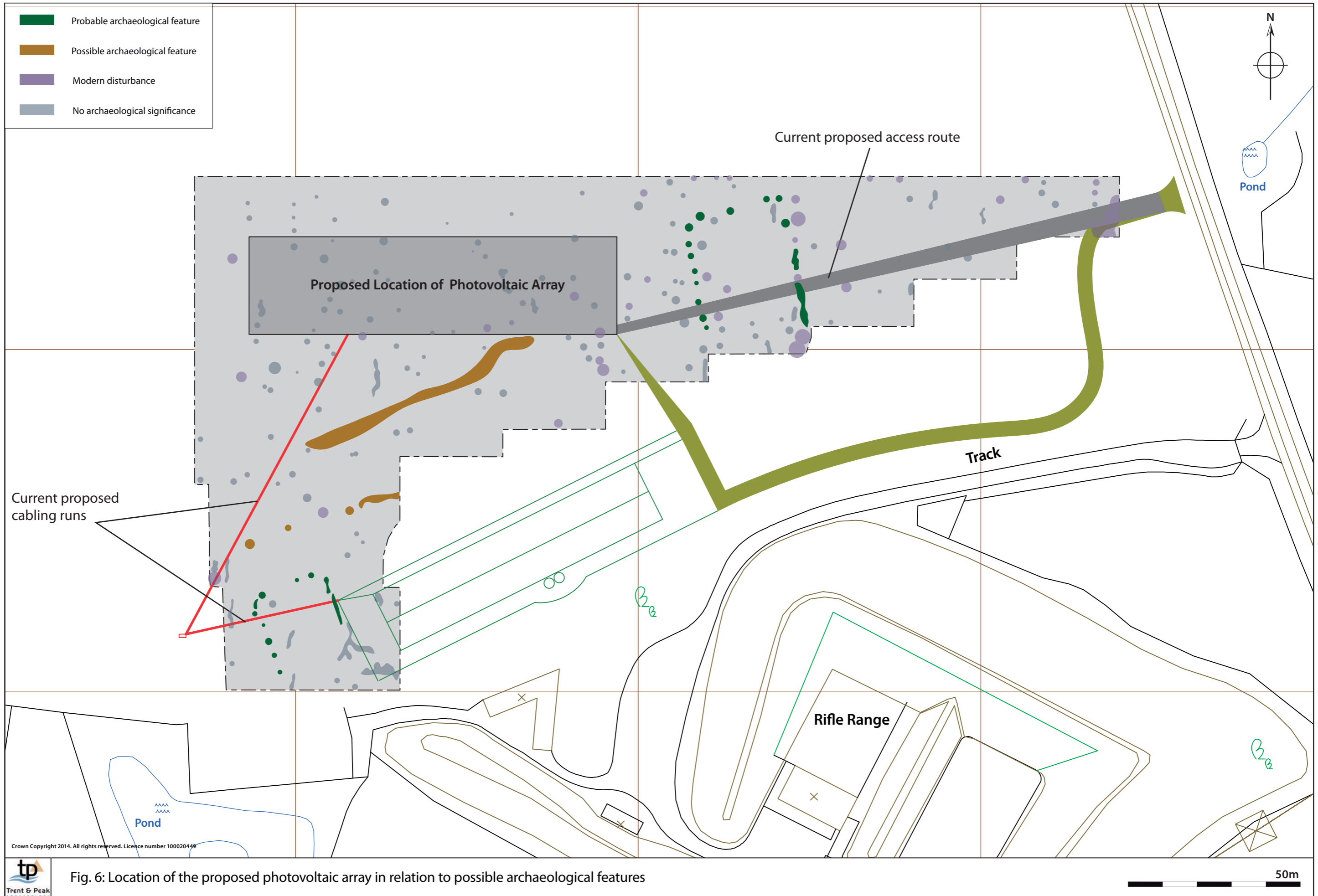

Fig. 6: Location of the proposed photovoltaic array in relation to possible archaeological features