

**ARCHAEOLOGICAL EXCAVATION ON
A DEVELOPMENT AT
CENTURION HOUSE, OLD CHESTER ROAD, DERBY**

**Archaeological excavation on a development at
Centurion House, Old Chester Road, Derby**

Author: Gavin Kinsley, Trent & Peak Archaeological Unit

7th January 2004

T&PAT Project Code: DOR.1

Filename: DorRep.doc

© Trent & Peak Archaeological Unit 2004

Trent & Peak Archaeological Unit

University Park

Nottingham NG7 2RD

Tel (0115) 9514825

Fax (0115) 9514824

email gavin.kinsley@nottingham.ac.uk

Contents

Summary	4
1 Project background, site location and brief description of the proposed scheme	5
2 Excavation: method and results	5
3 Reference	5
4 Archive	5
List of drawings.....	5
List of photographs.....	5

Summary

Background Hand-excavation of two pits was carried out within the footprint of a small extension to Centurion House, Old Chester Road, Derby. The site lies within the Roman civil settlement outside the east gate of the fortified settlement of Little Chester.

Results The pit showed the area contained recent deposits to a depth of 1m, the full formation level of the new structure, and no further archaeological investigation was carried out,

1 Project background, site location and brief description of the proposed scheme

The development site is located within the Roman civil settlement outside the east gate of the fortified settlement of Little Chester, Derby. A substantial Roman building and Anglo-Saxon cemetery had been excavated, 30m to the south-west of the site, by Sparey-Green in 1971-2 (Sparey-Green 2002).

The aim of the excavation was to remove unimportant overburden by manual excavation, and excavate and record significant archaeological remains within the 5x3m area of the extension, to a 1m excavation depth below existing ground level. As the thickness of overburden was unknown, a staged approach was recommended, consisting of

- 1 an initial evaluation by test-pitting
- 2 followed by review leading to
- 3 possible design modifications and further necessary excavation (possibly full excavation of the area to 1m depth).

2 Excavation: method and results

Two test-pits were excavated by hand to a full depth of 1m, as marked in Fig. 2. The deposits encountered contained engineering bricks and other recent material to the full excavation depth, and the ground excavated was extremely compacted. These deposits are presumably related to the Midland Railway embankment which stood on the site until 1971.

No archaeological remains were encountered within the excavation depth, and, by agreement with Andy Myers (Derbyshire County Council Development Control) the construction of the building commenced without further archaeological work.

3 Reference

Sparey-Green, C., 2002. 'Excavations on the South-Eastern Defences and Extramural Settlement of Little Chester, Derby 1971-2' *Derbyshire Archaeological Journal* 122, 1 - 328.

4 Archive

List of drawings

DR01 A4 1:20 East-facing section of 01
DR02 A4 1:20 North-facing section of 02
DR03 A4 1:50 Plan of location of pits.

List of photographs

DI01 Detail of section of 01
DI02 Detail of section of 01
DI03 Detail of section of 01
DI04 Detail of section of 01
DI05 Detail of section of 02
DI06 Detail of section of 02
DI07 Detail of section of 02
DI08 Detail of section of 02

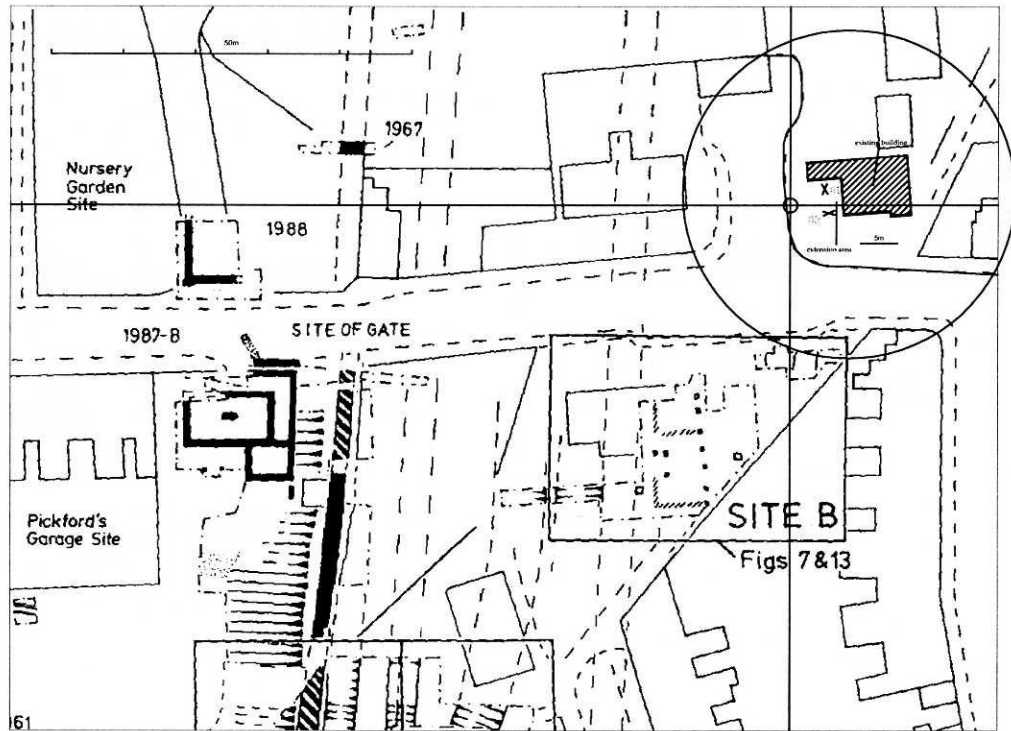

Fig. 1: Site location (ringed) in relation and previous excavations; grid point marked is 435480, 337550; scale 1:1000

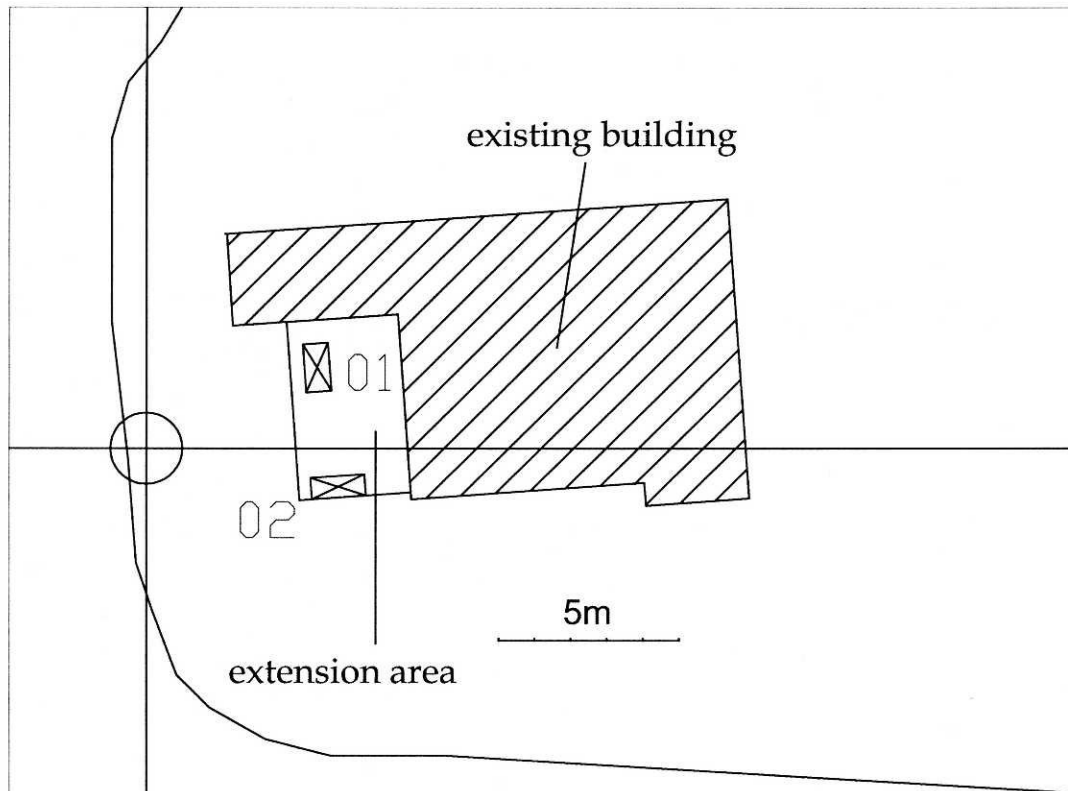

Fig. 2: Location of test-pits (scale 1:200)