

**BLANDFORD HOUSE AND MALTA
BARRACKS,
FARNBOROUGH,
HAMPSHIRE:
ARCHAEOLOGICAL EVALUATION
REPORT**

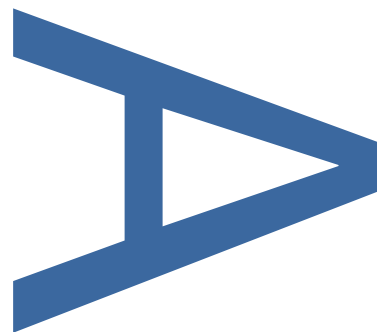
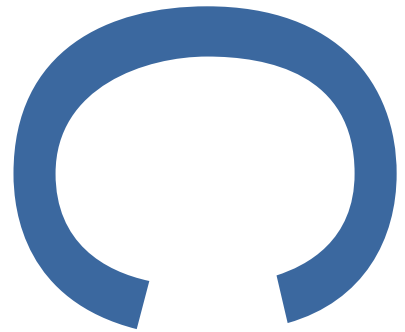

PCA REPORT NO: R14896

MARCH 2022

PRE-CONSTRUCT ARCHAEOLOGY

**BLANDFORD HOUSE AND MALTA BARRACKS, FARNBOROUGH, HAMPSHIRE:
ARCHAEOLOGICAL EVALUATION REPORT**

Local Planning Authority: Rushmoor Borough Council

Central NGR: SU 86242 52910

Site Code: BHAH21

Commissioning Client: RPS Consulting Services UK

Written/Researched by: Dominic McAtominey

Project Manager: Charlotte Matthews

Contractor: Pre-Construct Archaeology Ltd (Winchester)
5 Red Deer Court
Elm Road
Winchester
Hampshire SO22 5LX

Tel: 01962 857 335
E-mail: cmatthews@pre-construct.com
Web: www.pre-construct.com

© Pre-Construct Archaeology Limited

March 2022

© The material contained herein is and remains the sole property of Pre-Construct Archaeology Limited and is not for publication to third parties without prior consent. Whilst every effort has been made to provide detailed and accurate information, Pre-Construct Archaeology Limited cannot be held responsible for errors or inaccuracies herein contained.

PCA REPORT NO. 14896

DOCUMENT VERIFICATION

Site Name: Blandford House and Malta Barracks, Farnborough, Hampshire

Type of project: Evaluation

Report: R14896

Quality Control

Pre-Construct Archaeology Limited Project Code		K7515
Text Prepared by:	D. McAtominey	22/03/2022
Graphics Prepared by:	D. Valk	22/03/2022
Graphics Checked by:	M. Roughley	22/03/2022
Project Manager:	C. Matthews	22/03/2022

Revision No.	Date	Checked	Approved
1 RPS comments	22/03/2022	C. Matthews	C. Matthews

CONTENTS

1	ABSTRACT	4
2	INTRODUCTION	5
3	AIM	7
4	RESULTS	8
5	ARCHIVE PRERARATION AND DEPOSITION	10
6	ACKNOWLEDGEMENTS	11
7	REFERENCES	12
	APPENDIX 1: TRENCH INDEX	13
	APPENDIX 2: PHOTOGRAPHS (PLATES 1 – 5)	14
	APPENDIX 3: OASIS FORM	17

List of Plates:

- Plate 1. Shot of Trench 4, View to south, Scale 1m
- Plate 2. Shot of Trench 7, View to south, Scale 1m
- Plate 3. North Facing Representative Section Trench 5, Scale 1m
- Plate 4. West Facing Representative Section Trench 7, Scale 1m
- Plate 5. Contaminated Ground in Trench 9, View to south east, Scale 1m

List of Figures:

- Figure 1: Site Location
- Figure 2: Detailed Site Location
- Figure 3: Sections

1 ABSTRACT

Pre-Construct Archaeology Ltd (PCA) was appointed by RPS Consulting Services UK to undertake an archaeological evaluation at Blandford House and Malta Barracks, Farnborough, Hampshire.

Rushmoor Borough Council, the Local Planning Authority (LPA), has granted planning consent for the erection of up to 180 dwellings and associated works on the Site (Notice of Decision: Planning Reference 17/00914/OUTPP). The evaluation was carried out to fulfil planning conditions 16, 17 and 18, to provide information towards understanding the archaeological implications of the proposed development and to determine the subsequent treatment of archaeological resources within it. The evaluation forms part of a staged approach to understanding the archaeological implications of the proposed development, following the advice of the LPA's Archaeological Advisor.

The aim of the archaeological evaluation was to determine the presence or absence of archaeological remains within the Site and, where present, determine their nature, extent, date, condition and significance, taking account of their potential to contain biological and palaeo-environmental remains.

The evaluation comprised the excavation of 10 trenches, no archaeological features, finds or deposits were observed in any of the trenches and contaminated deposits (suspected asbestos and chemical dumping) were observed in three trenches.

2 INTRODUCTION

2.1 Project Background

2.1.1 Pre-Construct Archaeology Ltd (PCA) was appointed by RPS Consulting Services UK to undertake an archaeological evaluation at Blandford House and Malta Barracks, Farnborough, Hampshire, hereafter 'the Site' (**Figure 1**).

2.1.2 Rushmoor Borough Council, the Local Planning Authority (LPA), has granted planning consent for the erection of up to 180 dwellings and associated works on the Site (Planning Reference 17/00914/OUTPP). Three conditions concerning archaeology on the outline planning consent state:

16 Development shall not commence on any Reserved Matters Area (other than the demolition of the Category 1 buildings identified on drawing number 6048/PO1 Rev A and not including the proposed SANG establishment works) until there has been submitted to and approved in writing by the Local Planning Authority, a Written Scheme of Investigation (WSI), designed to recognise, characterise and record any archaeological features and deposits that may exist on the site. The assessment shall take the form of trial trenches located within the areas of proposed housing, including those areas where buildings are to be demolished and trees cleared. The archaeological investigations shall be carried out fully in accordance with the WSI as approved.

Reason - To assess the extent, nature and date of any archaeological deposits that might be present and the impact of the development upon these heritage assets.

17 Development shall not commence on any Reserved Matters Area (other than the demolition of the Category 1 buildings identified on drawing number 6048/PO1 Rev A and not including the proposed SANG establishment works) until there has been submitted to and approved in writing by the Local Planning Authority, a Programme of Archaeological Mitigation of Impact, based on the results of trial trenching as required by the Written Scheme of Investigation (WSI). The mitigation measures shall be carried out fully in accordance with the Programme of Archaeological Mitigation of Impact as approved.

Reason - To mitigate the effect of the works associated with the development upon any heritage assets and to ensure that information regarding these heritage assets is preserved by record for future generations.

18 Following completion of the archaeological fieldwork, and prior to first occupation of the Reserved Matters Area to which it relates, a report shall be submitted to and approved in writing by the Local Planning Authority, setting out and securing appropriate post-excavation assessment, specialist analysis and reports, publication and engagement where appropriate. The recommendations within the report shall be carried out fully in accordance with the Fieldwork Report, as approved in accordance with timescales agreed

by the Local Planning Authority.

2.1.3 The evaluation was carried out to fulfil planning conditions 16, 17 and 18, to provide information towards understanding the archaeological implications of the proposed development and to determine the subsequent treatment of archaeological resources within it. The evaluation forms part of a staged approach to understanding the archaeological implications of the proposed development, following the advice of the LPA's Archaeological Advisor.

2.1.4 This document provides the results of the trial trench evaluation, which comprised a total of 10 trenches, out of a proposed 15 trenches. Five proposed trenches were not excavated following discussion with the archaeological advisor to the planning authority owing to on-site constraints and below ground contaminants, shown in grey on **Figure 2**. The trenches were intended to measure between 15m and 20m x 2m, however some trenches containing ground contaminants or restricted by ecological fencing were shortened following discussion with the county archaeological advisor. This document has been prepared in accordance with the Chartered Institute for Archaeologists *Standard and guidance for archaeological field evaluation* (ClfA 2020) and *Management of Research Projects in the Historic Environment* (Historic England, 2015).

2.2 Location, Topography and Geology

2.2.1 The Site is an irregular shaped parcel of land. It was formerly part of the military base. It largely consists of woodland. It is located on the northwest edge of the town of Aldershot and is approximately 2.2km south of Farnborough. It is bounded to the north by the Army Golf Club Course, to the east by woodland, Vine Close and woodland to the south and Shoe Lane to the east. The surrounding area is predominantly wooded and is centred at NGR SU 86242 52910.

2.2.2 The Site is relatively flat and lies at c.85m above Ordnance Datum.

2.2.3 The British Geology Survey shows that the Site lies on Camberley Sand Formation – Sand, with no superficial deposits.

2.3 Archaeological and Historical Background

2.3.1 The Historic Environment Desk-Based Assessment (Wessex Archaeology, 2017) provides an historical background to the larger overall Site which concluded that “there is an archaeological interest within the Site. This is defined as the potential for the presence of buried archaeological remains, principally relating to 19th century and modern military activity. However, due to a lack of previous archaeological investigation within the Site, the potential for and significance of any such remains, particularly relating to prehistoric periods, could not be accurately assessed on the basis of the available evidence.”

3 AIM

3.1 Archaeological Evaluation

3.1.1 The aim of the archaeological evaluation was to determine the presence or absence of archaeological remains within the Site and where present, determine their nature, extent, date, condition and significance, taking account of their potential to contain biological and palaeo-environmental remains.

3.1.2 This report on the results of the evaluation aims to provide a context for archaeological remains that may be identified and provide sufficient information so that the future treatment of the remains, in respect of the proposed development, can be determined in consultation with the LPA and the CAO (County Archaeological Officer).

4 RESULTS

4.1 Introduction

4.1.1 The following presents a summary of the evaluation results based upon the Site archive, which comprises a Site diary, trench recording sheets, drawings, digital photographs and material assemblages. A summary of recorded contexts is provided in a Trench Index in **Appendix 1** and photographs of the trenches in **Appendix 2**. The archive is held at PCA's Winchester office under the site code **BHAH21** and will in due course be deposited with Hampshire Cultural Trust.

4.2 Methodology

4.2.1 The archaeological evaluation was undertaken following the methodology that was detailed in the Written Scheme of Investigation (PCA 2022), which was approved by the Local Planning Authority in advance of the commencement of works and on the advice of their archaeological advisor.

4.2.2 The evaluation comprised the excavation of ten trenches measuring 15m to 20min length and 2m wide (**Figure 2, Plates 1 and 2**). Fifteen trenches were proposed for this evaluation however five trenches (Trenches 1, 10, 12, 13 and 14) were not excavated due to ecological or site access constraints. All evaluated trenches were opened and investigated between 24th and 28th February 2022.

4.3 Summary of Deposition Sequence

4.3.1 Natural geological deposits were reached in 7 of the 10 trenches and were consistent across the Site. The natural geological deposit consisted of light yellow-brown sand, in many cases the sand was discoloured and significantly disturbed by tree roots (**Plates 1 and 2**).

4.3.2 The topsoil observed across the Site was a relatively consistent dark grey-brown sandy silt. The average thickness of the topsoil was between 0.4m BGL (below ground level) and 0.55m BGL; Trench 2 was the shallowest at 0.3m BGL and Trench 5 was the deepest at 0.56m BGL (**Figure 3, Plates 3 and 4**).

4.3.3 Contaminated deposits were observed in trenches 8, 9 and 10. Natural sand in these trenches had been contaminated with suspected asbestos and chemical dumping and discoloured (**Plate 5**).

4.4 Archaeological Features

4.4.1 No archaeological features were observed during the evaluation.

4.5 Conclusion

4.5.1 The evaluation revealed no finds, features or deposits of archaeological interest in any of the excavated trenches.

4.5.2 Contamination (suspected asbestos and chemical dumping) observed in trenches central

to the site are presumably the result of Ministry of Defence activities.

5 ARCHIVE PRERARATION AND DEPOSITION

5.1 The Site Archive

5.1.1 The Site archive, to include all project records produced by the project, will be prepared in accordance with '*Guidelines for the Preparation of Excavation Archives for Long-term Storage*' (UKIC 1990) and the Chartered Institute for Archaeologists '*Standard and Guidance for the creation, compilation, transfer and deposition of archaeological archives*' (CIfA 2020). On completion of the project, PCA will arrange for the archive to be deposited with Hampshire Cultural Trust.

5.2 Copyright

5.2.1 The full copyright of the written/illustrative archive relating to the site will be retained by Pre-Construct Archaeology Ltd under the Copyright, Designs and Patents Act 1988 with all rights reserved. Hampshire County Council, however, will be granted an exclusive licence for the use of the archive for educational purposes, including academic research, providing that such use shall be non-profitmaking, and conforms to the Copyright and Related Rights regulations 2003. Further distribution and uses of the report either in its entirety or part thereof in paper or electronic form is prohibited without the prior consent of Pre-Construct Archaeology Ltd.

5.2.2 The licence extends to the use of all documents arising from this project in all matters relating directly to the project, as well as for bona fide research purposes (which includes the Hampshire County Council Archaeology and Historic Building Record).

5.2.3 Pre-Construct Archaeology Ltd has made every effort to ensure the accuracy of the content of this report. However, Pre-Construct Archaeology Ltd cannot accept any liability in respect of, or resulting from, errors, inaccuracies or omissions this report contains.

6 ACKNOWLEDGEMENTS

Pre-Construct Archaeology is grateful to Edward Hawkins of RPS Consulting Services UK for commissioning the evaluation and to Thom Hayes, Archaeological Advisor to the Local Planning Authority for his advice.

The project was managed for Pre-Construct Archaeology by Charlotte Matthews. The evaluation was supervised by Dominic McAtominey with site assistance from Tom Warburton. This report was written by Dominic McAtominey with graphics prepared by Diana Valk.

7 REFERENCES

- ClfA, 2020, '*Standard and Guidance for Archaeological Field Evaluation*', Reading
- ClfA, 2020, '*Standard and Guidance for the creation, compilation, transfer and deposition of archaeological archives*', Reading
- Historic England, 2015, '*Management of Research Projects in the Historic Environment*'
- PCA, 2021, '*Blandford House and Malta Barracks, Hampshire: WSI for Archaeological Evaluation of the Wider Site*'
- PCA, 2022, '*Written Scheme of Investigation for the First Phase of Archaeological Evaluation at Blandford House, Aldershot, Hampshire*'
- UKIC, 1990, '*Guidelines for the Preparation of Excavation Archives for Long-term Storage*', UKIC Archaeology Section, London
- Wessex Archaeology, 2017, '*Blandford House, Aldershot, Hampshire, Historic Environment Desk-Based Assessment*'

Appendix 1: Trench Index

Context Number	Area/Trench	Type	Date	Interpretation	Depth Below Ground (m)
201	2	Layer	Modern	Turf/ Topsoil	0.00-0.3
202	2	Layer	Natural	Natural sand	0.31+
301	3	Layer	Modern	Turf/ Topsoil	0.00-0.4
302	3	Layer	Natural	Natural sand	0.41+
401	4	Layer	Modern	Turf/ Topsoil	0.00-0.5
402	4	Layer	Natural	Natural sand	0.51+
501	5	Layer	Modern	Turf/ Topsoil	0.00-0.55
502	5	Layer	Natural	Natural sand	0.56+
601	6	Layer	Modern	Turf/ Topsoil	0.00-0.45
602	6	Layer	Natural	Natural sand	0.46+
701	7	Layer	Modern	Turf/ Topsoil	0.00-0.5
702	7	Layer	Natural	Natural sand	0.51+
	8			Contaminated deposits	
	9			Contaminated deposits	
	10			Contaminated deposits	
1501	15	Layer	Natural	Turf/ Topsoil	0.00-0.53
1502	15	Layer	Natural	Natural sand	0.54

Appendix 2: Photographs (Plates 1 – 5)



Plate 1. Shot of Trench 4, View to south, Scale 1m



Plate 2. Shot of Trench 7, View to south, Scale 1m



Plate 3. North Facing Representative Section Trench 5, Scale 1m



Plate 4. West Facing Representative Section Trench 7, Scale 1m

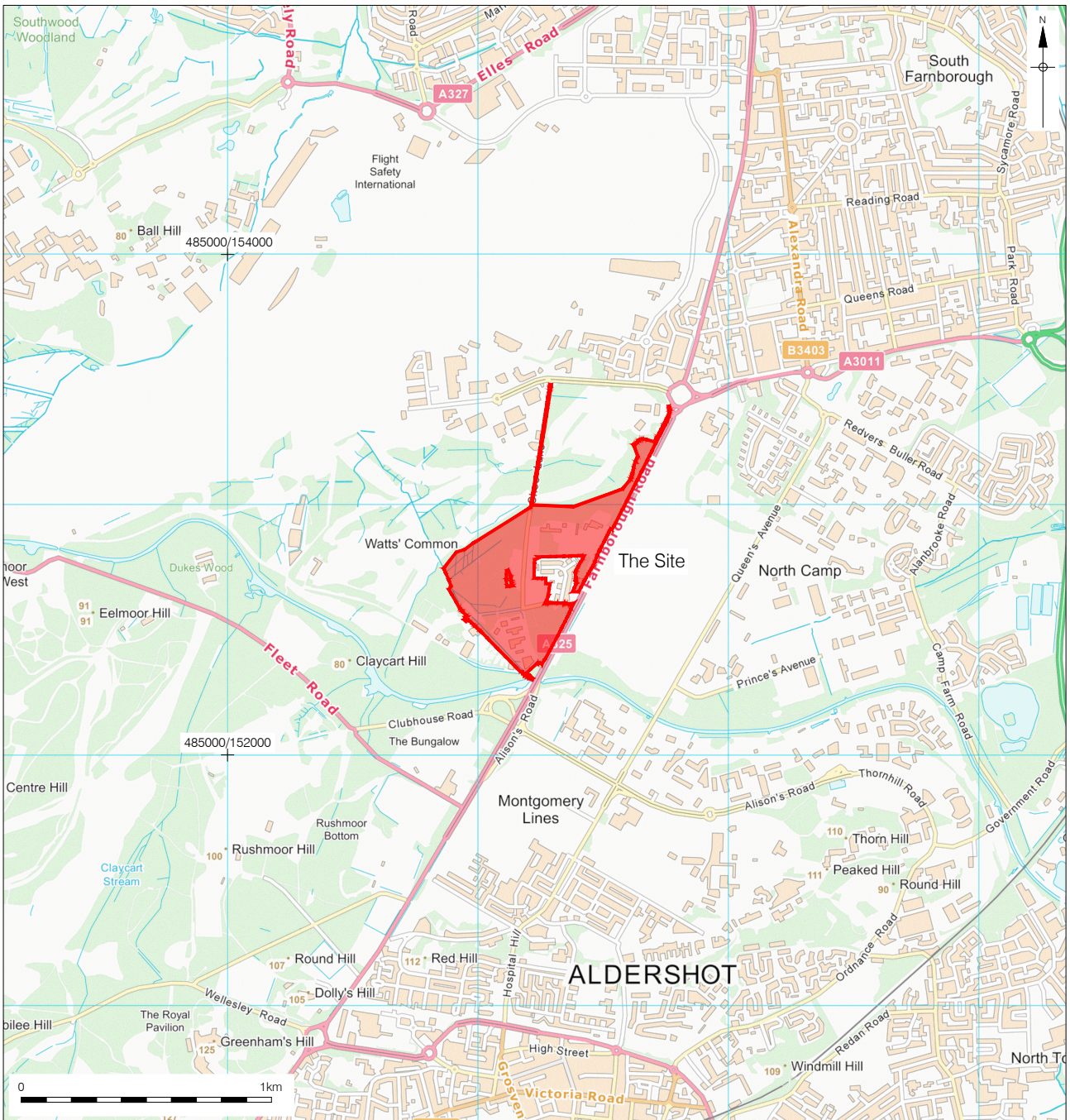
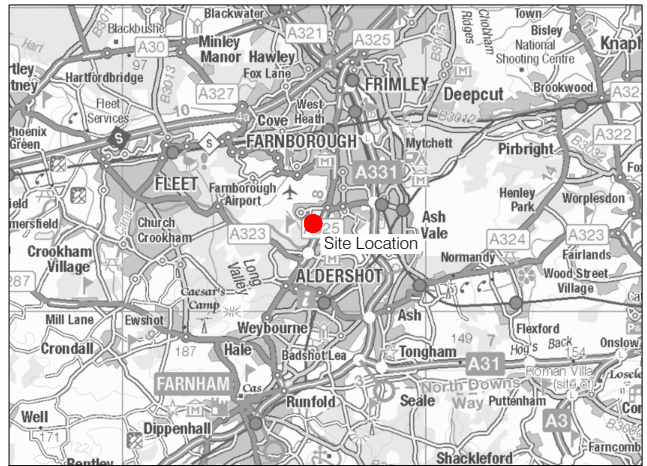

Plate 5. Contaminated Ground in Trench 9, View to south east, Scale 1m

Appendix 3: Oasis Form

Summary for preconst1-505047

OASIS ID (UID)	preconst1-505047
Project Name	Blandford House Sales Area and Locally Listed Area, Aldershot, Hampshire
Activity type	Evaluation
Project Identifier(s)	Blandford House, Aldershot, Hampshire
Planning Id	
Reason For Investigation	Planning requirement
Organisation Responsible for work	Pre-Construct Archaeology Ltd
Project Dates	24-Feb-2022 - 28-Feb-2022
Location	Blandford House, Aldershot NGR : SU 86242 52910 LL : 51.2688278591236, -0.765191251940854 12 Fig : 486242,152910
Administrative Areas	Country : England County : Hampshire District : Rushmoor Parish : Rushmoor, unparished area
Project Methodology	The evaluation comprised the excavation of ten trenches measuring 15m - 20m x 2m. Fifteen trenches were proposed for this stage of evaluation but five (Trenches 1, 10, 12, 13 & 14) were inaccessible due to ecological or site access restraints. All proposed trenches were opened and investigated between the 24th and 28th February 2022.
Project Results	Pre-Construct Archaeology Ltd (PCA) was appointed by RPS Consulting Ltd to undertake an archaeological evaluation on Blandford House Sales Area and Locally Listed Area, Aldershot, Hampshire. The aim of the archaeological evaluation was to determine the presence or absence of archaeological remains within the Site and, where present, determine their nature, extent, date, condition and significance, taking account of their potential to contain biological and palaeo-environmental remains. The evaluation comprised the excavation of 10 trenches, no archaeological features or deposits were observed in any trench and contaminated ground was observed in 3 trenches.
Keywords	
HER	Hampshire Archaeology and Historic Buildings Record (AHBR) - unRev - STANDARD
HER Identifiers	
Archives	Documentary Archive, Digital Archive - to be deposited with Hampshire County Council Arts & Museums Service



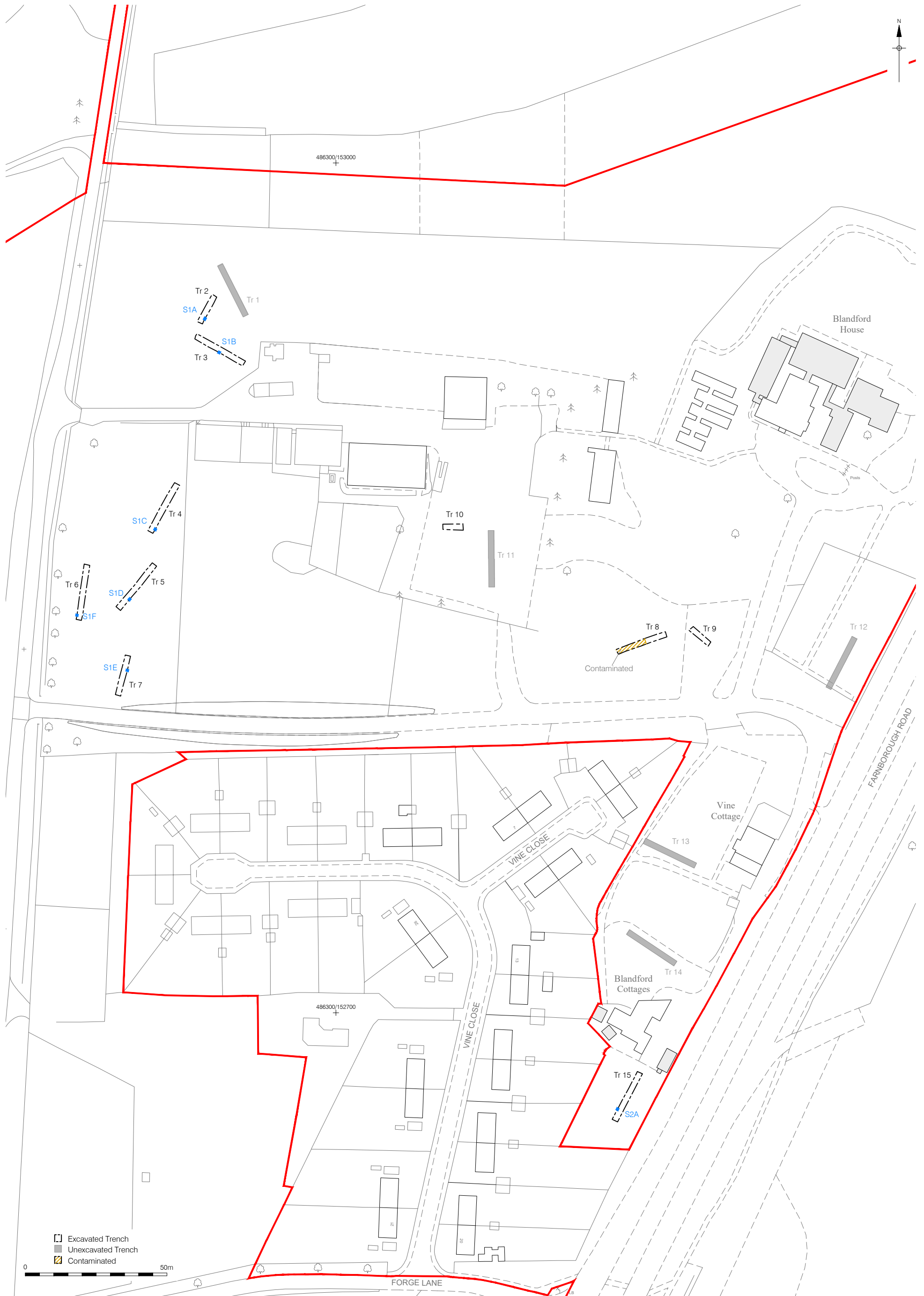

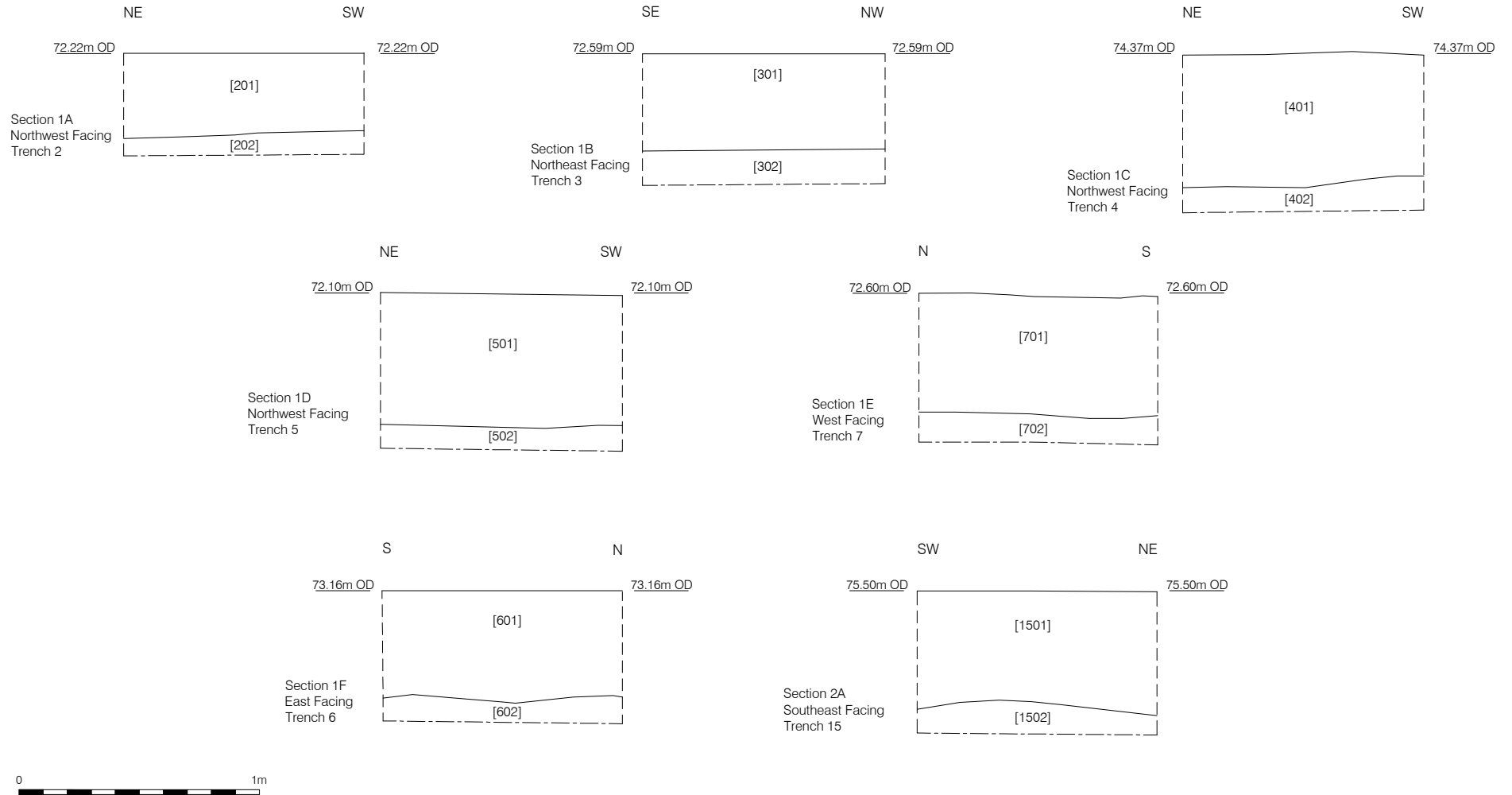

PCA

PCA CAMBRIDGE

THE GRANARY, RECTORY FARM
BREWERY ROAD, PAMPISFORD
CAMBRIDGESHIRE CB22 3EN
t: 01223 845 522

e: cambridge@pre-construct.com

PCA DURHAM

THE ROPE WORKS, BROADWOOD VIEW
CHESTER-LE-STREET
DURHAM DH3 3AF
t: 0191 377 1111

e: durham@pre-construct.com

PCA LONDON

UNIT 54, BROCKLEY CROSS BUSINESS CENTRE
96 ENDWELL ROAD, BROCKLEY
LONDON SE4 2PD
t: 020 7732 3925

e: london@pre-construct.com

PCA NEWARK

OFFICE 8, ROEWOOD COURTYARD
WINKBURN, NEWARK
NOTTINGHAMSHIRE NG22 8PG
t: 01636 370 410

e: newark@pre-construct.com

PCA NORWICH

QUARRY WORKS, DEREHAM ROAD
HONINGHAM
NORWICH NR9 5AP
T: 01603 863 108

e: norwich@pre-construct.com

PCA WARWICK

UNIT 9, THE MILL, MILL LANE
LITTLE SHREWLEY, WARWICK
WARWICKSHIRE CV35 7HN
t: 01926 485 490

e: warwick@pre-construct.com

PCA WINCHESTER

5 RED DEER COURT, ELM ROAD
WINCHESTER
HAMPSHIRE SO22 5LX
t: 01962 849 549

e: winchester@pre-construct.com

