

LAKENHAM SPORTS AND
LEISURE CENTRE, NORWICH

ARCHAEOLOGICAL TRIAL
TRENCH EVALUATION

OCTOBER 2012



PRE-CONSTRUCT ARCHAEOLOGY
R11315

ARCHAEOLOGICAL EVALUATION AT THE FORMER LAKENHAM SPORTS AND LEISURE CENTRE, NORWICH

Site Code: ENF 129932

Central NGR: TG 2356 0718

Local Planning Authority: Norwich City Council

Written and Researched by Daryl Stump

Project Manager: Mark Hinman

Commissioning Client: CgMs Consulting

Contractor:

Pre-Construct Archaeology Limited

7 Granta Terrace

Stapleford

Cambridgeshire

CB22 4PF

Tel: 01223 845522

Email: mhinman@pre-construct.com

Website: www.pre-construct.com

© Pre-Construct Archaeology Limited

October 2012

© The material contained herein is and remains the sole property of Pre-Construct Archaeology Limited and is not for publication to third parties without prior consent. Whilst every effort has been made to provide detailed and accurate information, Pre-Construct Archaeology Limited cannot be held responsible for errors or inaccuracies herein contained.

CONTENTS

ABSTRACT	3
1 INTRODUCTION	4
2 ARCHAEOLOGICAL METHODOLOGY	5
3 ARCHAEOLOGICAL SEQUENCE.....	6
4 CONCLUSION.....	8
5 ACKNOWLEDGEMENTS	9
6 REFERENCES	9
APPENDIX 1: CONTEXT REGISTER	14
APPENDIX 2: PLATES.....	15
APPENDIX 3: OASIS FORM	17
FIGURE 1 SITE LOCATION	10
FIGURE 2 TRENCH LOCATION	11
FIGURE 3 DITCHES.....	11
FIGURE 4 SECTIONS.....	12

ABSTRACT

This document details the results of an archaeological trial trench evaluation at the former Lakenham Sports and Leisure Centre, Norwich. The work was commissioned by CgMs Consulting to assess the archaeological implications of development of the site. The work was undertaken between the 17th and 18th October 2012 and comprised the excavation of four archaeological evaluation trenches, each 1.8m wide and totalling 190m in length. The only archaeological features encountered were two ditches, one of which is undated and the other dates to the post-medieval period.

1 INTRODUCTION

- 1.1 This document details the results of an archaeological trial trench evaluation at the former Lakenham Sports and Leisure Centre, Norwich. The work was commissioned by CgMs Consulting on behalf of SPC Ltd to assess the archaeological implications of development of land at the site. No specific development plans exist for the site at present.
- 1.2 A trenching specification was prepared by Paul Gajos of CgMs Consulting.
- 1.3 The site is located c. 1.3km southeast of Norwich city centre and is bounded by property boundaries of houses fronting onto Geoffrey Road and Carshalton Road to the north; by Lakenham Primary School and property boundaries of houses fronting on to Jubilee Terrace and Smithfield Road to the west; by the rear gardens of houses on Meadowbrook Close and Lakenfields to the south; and by the carparks for Harriet Court to the west. The development site covers approximately 3.2 hectares and is centred at National Grid Reference TG 2356 0718 (Fig 1 & 2). The geology of the site comprises sand and gravel of the Lowestoft Formation, which in turn overlies Crag Group sand and gravel. The site is flat with existing ground level at 37.6 – 37.7 metres above Ordnance Datum (henceforth mOD).
- 1.4 Although there has been very little previous archaeological work undertaken in the immediate vicinity, the specification for work produced by CgMs (2012) notes that well-drained gravel terraces overlooking river valleys are favoured locations for prehistoric and later settlements.
- 1.5 The work reported upon here was carried out between the 17th and 18th October 2012 and comprised the excavation and recording of four archaeological evaluation trenches, each of which was 1.8m wide.

2 ARCHAEOLOGICAL METHODOLOGY

- 2.1 The four evaluation trenches were laid out following the trench location plan contained within the specification of works (CgMs 2012: 13, Figure 2). Trenches 2, 3 and 4 were each 50m long, and Trench 1 measured 40m meters. The locations of these trenches were each scanned for the presence of buried services prior to excavation by a suitably trained member of PCA staff using a radio-detection Cable Avoidance Tool (CAT).
- 2.2 The ground reduction was carried out under archaeological supervision using a 360 mechanical excavator fitted with a 1.8m wide toothless ditching bucket. Topsoil and subsoil deposits were removed in spits down to the level of the undisturbed geological deposits (referred to here as 'natural') where potential archaeological features could be observed and recorded. Topsoil and subsoil were stored separately during excavation, and were scanned with a metal detector prior to reinstatement at the end of the works.
- 2.3 Heights above ordnance datum (m OD) and trench locations were recorded using a Leica 1200 global positioning system (GPS) rover unit with RTK differential correction, giving three dimensional accuracy of 2cm or less. The locations of archaeological features were also recorded via GPS, as well as by scaled drawings on waterproof drafting film.
- 2.4 Deposits or the removal of deposits judged by the excavating archaeologist to constitute individual events were each assigned a unique record number. Archaeological events recognised by the deposition of material are signified in round brackets (thus), whilst events constituting the removal of deposits are referred to here as 'cuts' and signified by square brackets [thus]. Artefacts recovered during excavation were assigned to the record number of the deposit from which they were retrieved.

3 ARCHAEOLOGICAL SEQUENCE

- 3.1 The results of the fieldwork are first presented by trench, and are then discussed by period. The locations of the trenches are presented in Figure 2.
- 3.2 Trench 1 was 40m long, aligned northwest to southeast, and was excavated within a tufted area located to the rear of sports pavilions. No archaeological finds or features were encountered in this trench, where up to 0.45m of topsoil overlies a mixed subsoil up to 0.13m deep and composed of mixed dark brown silt and mid-orange sandy gravel; the latter derived from the underlying natural. The natural in this trench predominantly consists of a mid-reddish brown course to dark orangey-brown, very coarse sandy gravel. Ground level at this location lies at c. 37.5m OD, and the natural was encountered at 37.03m OD at the highest point.
- 3.3 Trench 2: aligned broadly southwest to northeast, this trench contained no archaeological features, but several abrupt changes in the natural were investigated to confirm that these were not of human origin. The topsoil at this location was recorded as extending to an average depth of 0.48m, with subsoil depth varying from c. 0.4m in the southwest to c. 0.1m in the northeast. The natural in this location is primarily the same as that recorded in Trench 1, but changes abruptly to a dark yellowish-brown slightly silty sand approximately 7m from the trench's southwest end. Two spits each of approximately 100mm in depth were excavated into this material, but the depth, consistency and lack of finds demonstrates that it is geological in origin. Ground level at this location lies at 37.7m OD, with the top of the natural sands and gravels lying at approximately 37.1m toward the northeast end of the trench and at c. 36.8m towards the southwest.
- 3.4 Trench 3: A shallow ditch [8] measuring 0.72m wide by up to 0.22m deep was recorded within Trench 3 running north-northeast to south-

southwest, and contained a single fill of mid-brown slightly clayey sandy silt (9). This ditch fill contained postmedieval material including fragments of brick and tile, a sherd of glazed red earthenware pottery, and a short section of stem from a clay tobacco pipe, with the fill deposited within the last 200-300 years. This ditch is probably the remains of a small agricultural boundary ditch. The top of this feature and the surrounding natural sands were encountered at c.37.1m OD, and were sealed beneath up to 0.29m of subsoil and 0.35-0.39m of topsoil.

- 3.5 Trench 4: Natural deposits varying from pale yellowish brown slightly silty sand to mid-orangey brown coarse gravelly were encountered at c. 36.86m OD to 36.77m OD; these deposits being sealed by 0.17-0.46m of subsoil beneath 0.3-0.47m of topsoil. With the exception of three modern postholes penetrating less than 100mm into the natural, this trench contained only one feature: a west-northwest to east-southeast aligned ditch [10], measuring between 0.62m wide, and up to 0.12m deep. The only fill of this feature (11) contained no finds and thus remains undated. In the absence of the evidence to the contrary, it is likely that ditch [10] is also a relatively recent agricultural boundary or drainage feature.

4 CONCLUSION

- 4.1 The topography of the site varies very little, as is to be expected on a former river terrace, with ground level lying between 37.53 and 37.84m OD. The natural consisted predominantly of coarse sands and gravels, and is overlain by subsoil varying in depth from 0.1m to 0.48m deep.
- 4.2 The presence of small fragments of modern pottery, brick and tile within this subsoil probably results from 18th century ploughing but may also be from levelling of ground, drainage feature or other activities associated with the construction of a cricket ground on the site in 1827.
- 4.3 The identification of one post medieval ditch and one undated ditch support the interpretation that the site was in agricultural use during at least the late post medieval and modern periods. The extremely low quantities of finds from any period suggest that the site has always been peripheral to any settlements.
- 4.4 The results of this evaluation indicate that any development at the site will have no or negligible archaeological impact.

5 ACKNOWLEDGEMENTS

PCA would like to thank CgMs for commissioning this work on behalf of SPC Ltd. Thanks are also due to Myk Flitcroft of CgMs for discussions on site; to Bryn Williams for supplying and driving the mechanical excavator; and to Ken Hamilton of Norfolk Landscape Archaeology for monitoring the fieldwork. The fieldwork was undertaken by Tom Woolhouse and Daryl Stump, and the figures were produced by Josephine Brown.

6 REFERENCES

Gajos, P. 2012. A Specification for an Archaeological Trial Trench Evaluation, Former Lakenham Sports and Leisure Centre, Norwich. CgMs Consulting.

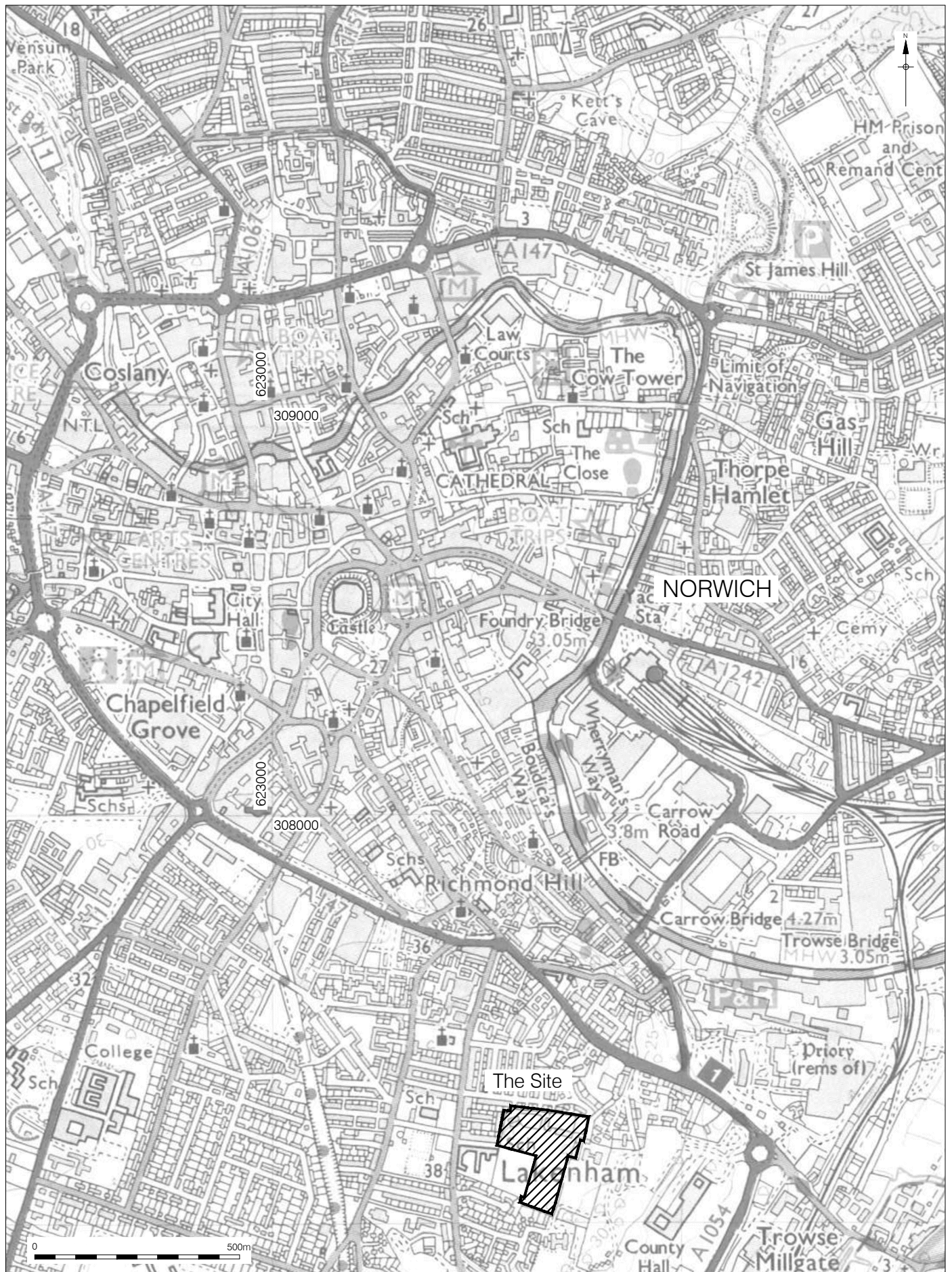

© Crown copyright 2008. All rights reserved. License number 36110309
 © Pre-Construct Archaeology Ltd 2012
 22/10/12 JS

Figure 1
 Site Location
 1:12,500 at A4



© Crown copyright 2012. All rights reserved. License number PMP36110309

© Pre-Construct Archaeology Ltd 2012

22/10/12 JS

Figure 2
Trench Location
1:1,250 at A4

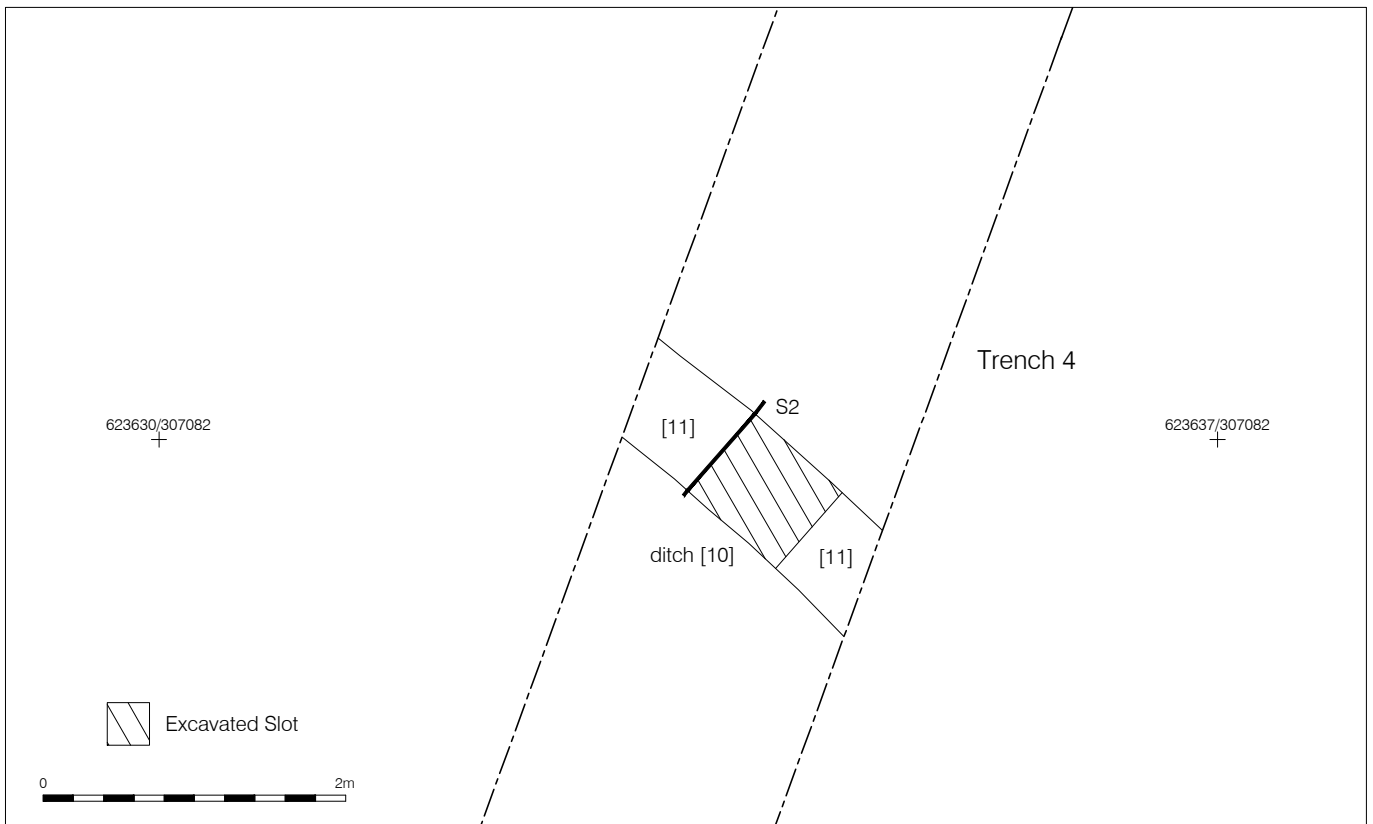
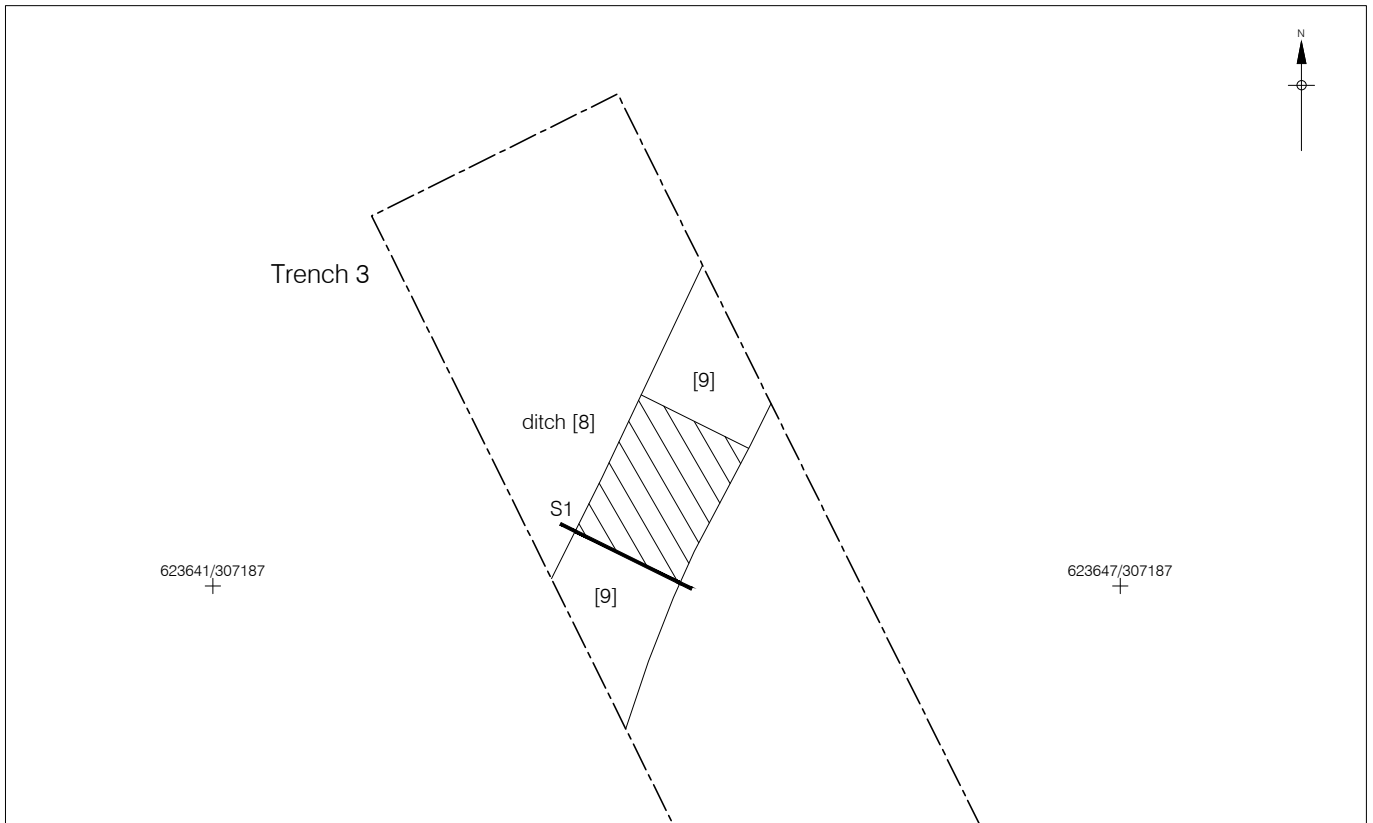
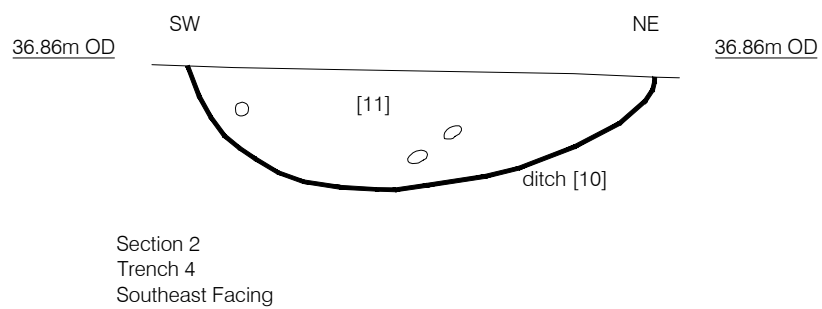
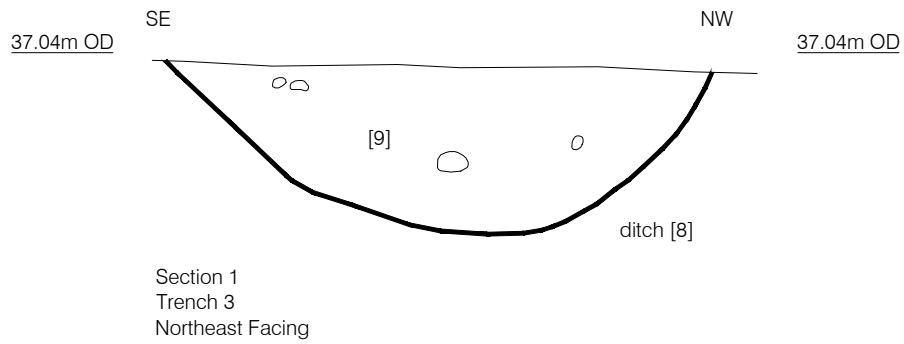

Figure 3
Detail Plan showing Ditches [8] & [10]
1:50 at A4



APPENDIX 1: CONTEXT REGISTER

Context	Cut	Type	Trench	Comments
1	-	Trench	1	Trench 1
2	-	Trench	2	Trench 2
3	-	Trench	3	Trench 3
4		Trench	4	Trench 4
5	-	Layer	All	Topsoil
6	-	Layer	All	Subsoil
7	-	Layer	All	Natural
8	-	Ditch cut	3	Postmedieval field boundary ditch
9		Ditch fill	3	Only fill of postmedieval boundary ditch
10		Ditch cut	4	Undated field boundary ditch
11		Ditch fill	3	Only fill of undated boundary ditch

APPENDIX 2: PLATES

PLATE 1: Lakenham Sports and Leisure Centre pavilion, pre-excavation.



PLATE 2: Trench 3 looking SE with ditch [8] in foreground



PLATE 4: Trench 4 looking north



APPENDIX 3: OASIS FORM

6.1 OASIS ID: preconst1-136193

Project details

Project name	Lakenham, Sports Ground, Norwich
Short description of the project	An archaeological trial trench evaluation at the former Lakenham Sports and Leisure Centre, Norwich. The work was commissioned by CgMs Consulting to assess the archaeological implications of development of the site. The work was undertaken between the 17th and 18th October 2012 and comprised the excavation of four archaeological evaluation trenches, each 1.8m wide and totalling 190m in length. The only archaeological features encountered were two ditches, one of which is undated and the other dates to the post-medieval period.
Project dates	Start: 17-10-2012 End: 18-10-2012
Previous/future work	No / Not known
Any associated project reference codes	ENF 129932 - Sitecode
Type of project	Field evaluation
Site status	None
Current Land use	Community Service 2 - Leisure and recreational buildings
Monument type	AGRICULTURAL, DITCH Post Medieval
Significant Finds	POTTERY Early Medieval
Project location	
Country	England
Site location	NORFOLK NORWICH NORWICH Lakenham Sports Ground

Postcode	NR1 2HN
Study area	3.20 Hectares
Site coordinates	TG 2356 0718 52 1 52 36 56 N 001 18 10 E Point
Lat/Long Datum	WGS 84 Datum
Height OD / Depth	Min: 37.30m Max: 37.50m
Project creators	
Name of Organisation	PCA
Project brief originator	CgMs Consulting
Project design originator	CgMs Consulting
Project director/manager	Mark Hinman
Project supervisor	Tom Woolhouse
Type of sponsor/funding body	Developer
Name of sponsor/funding body	SPC Ltd
Project archives	
Physical Archive recipient	Norfolk Museums and Archaeology Service
Physical Contents	"Ceramics"
Digital Archive recipient	Norfolk Museum and Archaeology Service
Digital Media available	"Database","Survey","Text"
Paper Archive recipient	Norfolk Museums and Archaeology Service
Paper Media available	"Context sheet","Drawing"
Entered by	Mark Hinman (mhinman@pre-construct.com)
Entered on	24 October 2012

LAKENHAM SPORTS AND
LEISURE CENTRE, NORWICH

ARCHAEOLOGICAL TRIAL
TRENCH EVALUATION

OCTOBER 2012

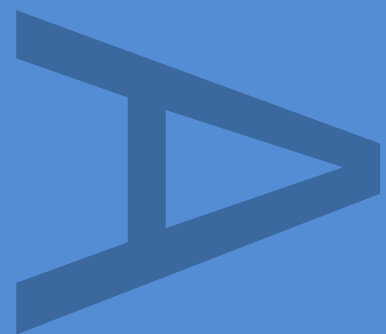

PRE-CONSTRUCT ARCHAEOLOGY
R11315

ARCHAEOLOGICAL EVALUATION AT THE FORMER LAKENHAM SPORTS AND LEISURE CENTRE, NORWICH

Site Code: ENF 129932

Central NGR: TG 2356 0718

Local Planning Authority: Norfolk County Council

Written and Researched by Daryl Stump

Project Manager: Mark Hinman

Commissioning Client: CgMs Consulting

Contractor:

Pre-Construct Archaeology Limited

7 Granta Terrace

Stapleford

Cambridgeshire

CB22 4PF

Tel: 01223 845522

Email: mhinman@pre-construct.com

Website: www.pre-construct.com

© Pre-Construct Archaeology Limited

October 2012

© The material contained herein is and remains the sole property of Pre-Construct Archaeology Limited and is not for publication to third parties without prior consent. Whilst every effort has been made to provide detailed and accurate information, Pre-Construct Archaeology Limited cannot be held responsible for errors or inaccuracies herein contained.

CONTENTS

ABSTRACT	3
1 INTRODUCTION	4
2 ARCHAEOLOGICAL METHODOLOGY	6
3 ARCHAEOLOGICAL SEQUENCE.....	7
4 CONCLUSION.....	9
5 ACKNOWLEDGEMENTS	10
6 REFERENCES	10
APPENDIX 1: CONTEXT REGISTER	15
APPENDIX 2: PLATES.....	16
APPENDIX 3: OASIS FORM	18
FIGURE 1 SITE LOCATION	11
FIGURE 2 TRENCH LOCATION	12
FIGURE 3 DITCHES.....	11
FIGURE 4 SECTIONS.....	12

ABSTRACT

This document details the results of an archaeological trial trench evaluation at the former Lakenham Sports and Leisure Centre, Norwich. The work was commissioned by CgMs Consulting to assess the archaeological implications of development of the site. The work was undertaken between the 17th and 18th October 2012 and comprised the excavation of four archaeological evaluation trenches, each 1.8m wide and totalling 190m in length. The only archaeological features encountered were two ditches, one of which is undated and the other dates to the post-medieval period.

1 INTRODUCTION

- 1.1 This document details the results of an archaeological trial trench evaluation at the former Lakenham Sports and Leisure Centre, Norwich. The work was commissioned by CgMs Consulting on behalf of SPC Ltd to assess the archaeological implications of development of land at the site. No specific development plans exist for the site at present.
- 1.2 A written scheme of investigation (WSI) for archaeological trial trenching within the proposed development area was prepared by Mark Hinman (PCA) in response to a Specification prepared by Paul Gajos of CgMs Consulting.
- 1.3 The site is located c. 1.3km southeast of Norwich city centre and is bounded by property boundaries of houses fronting onto Geoffrey Road and Carshalton Road to the north; by Lakenham Primary School and property boundaries of houses fronting on to Jubilee Terrace and Smithfield Road to the west; by the rear gardens of houses on Meadowbrook Close and Lakenfields to the south; and by the carparks for Harriet Court to the west. The development site covers approximately 3.2 hectares and is centred at National Grid Reference TG 2356 0718 (Fig 1 & 2). The geology of the site comprises sand and gravel of the Lowestoft Formation, which in turn overlies Crag Group sand and gravel. The site is flat with existing ground level at 37.6 – 37.7 metres above Ordnance Datum (henceforth mOD).
- 1.4 Although there has been very little previous archaeological work undertaken in the immediate vicinity, the specification for work produced by CgMs (2012) notes that well-drained gravel terraces overlooking river valleys are favoured locations for prehistoric and later settlements.

- 1.5 The work reported upon here was carried out between the 17th and 18th October 2012 and comprised the excavation and recording of four archaeological evaluation trenches, each of which was 1.8m wide.

2 ARCHAEOLOGICAL METHODOLOGY

- 2.1 The four evaluation trenches were laid out following the trench location plan contained within the specification of works (CgMs 2012: 13, Figure 2). Trenches 2, 3 and 4 were each 50m long, and Trench 1 measured 40m meters. The locations of these trenches were each scanned for the presence of buried services prior to excavation by a suitably trained member of PCA staff using a radio-detection Cable Avoidance Tool (CAT).
- 2.2 The ground reduction was carried out under archaeological supervision using a 360 mechanical excavator fitted with a 1.8m wide toothless ditching bucket. Topsoil and subsoil deposits were removed in spits down to the level of the undisturbed geological deposits (referred to here as 'natural') where potential archaeological features could be observed and recorded. Topsoil and subsoil were stored separately during excavation, and were scanned with a metal detector prior to reinstatement at the end of the works.
- 2.3 Heights above ordnance datum (m OD) and trench locations were recorded using a Leica 1200 global positioning system (GPS) rover unit with RTK differential correction, giving three dimensional accuracy of 2cm or less. The locations of archaeological features were also recorded via GPS, as well as by scaled drawings on waterproof drafting film.
- 2.4 Deposits or the removal of deposits judged by the excavating archaeologist to constitute individual events were each assigned a unique record number. Archaeological events recognised by the deposition of material are signified in round brackets (thus), whilst events constituting the removal of deposits are referred to here as 'cuts' and signified by square brackets [thus]. Artefacts recovered during excavation were assigned to the record number of the deposit from which they were retrieved.

3 ARCHAEOLOGICAL SEQUENCE

- 3.1 The results of the fieldwork are first presented by trench, and are then discussed by period. The locations of the trenches are presented in Figure 2.
- 3.2 Trench 1 was 40m long, aligned northwest to southeast, and was excavated within a tufted area located to the rear of sports pavilions. No archaeological finds or features were encountered in this trench, where up to 0.45m of topsoil overlies a mixed subsoil up to 0.13m deep and composed of mixed dark brown silt and mid-orange sandy gravel; the latter derived from the underlying natural. The natural in this trench predominantly consists of a mid-reddish brown course to dark orangey-brown, very coarse sandy gravel. Ground level at this location lies at c. 37.5m OD, and the natural was encountered at 37.03m OD at the highest point.
- 3.3 Trench 2: aligned broadly southwest to northeast, this trench contained no archaeological features, but several abrupt changes in the natural were investigated to confirm that these do were not of human origin. The topsoil at this location was recorded as extending to an average depth of 0.48m, with subsoil depth varying from c. 0.4m in the southwest to c. 0.1m in the northeast. The natural in this location is primarily the same as that recorded in Trench 1, but changes abruptly to a dark yellowish-brown slightly silty sand approximately 7m from the trench's southwest end. Two spits each of approximately 100mm in depth were excavated into this material, but the depth, consistency and lack of finds demonstrates that it is geological in origin. Ground level at this location lies at 37.7m OD, with the top of the natural sands and gravels lying at approximately 37.1m toward the northeast end of the trench and at c. 36.8m towards the southwest.
- 3.4 Trench 3: A shallow ditch [8] measuring 0.72m wide by up to 0.22m deep was recorded within Trench 3 running north-northeast to south-

southwest, and contained a single fill of mid-brown slightly clayey sandy silt (9). This ditch fill contained postmedieval material including fragments of brick and tile, a sherd of glazed red earthenware pottery, and a short section of stem from a clay tobacco pipe, with the fill deposited within the last 200-300 years. This ditch is probably the remains of a small agricultural boundary ditch. The top of this feature and the surrounding natural sands were encountered at c.37.1m OD, and were sealed beneath up to 0.29m of subsoil and 0.35-0.39m of topsoil.

- 3.5 Trench 4: Natural deposits varying from pale yellowish brown slightly silty sand to mid-orangey brown coarse gravelly were encountered at c. 36.86m OD to 36.77m OD; these deposits being sealed by 0.17-0.46m of subsoil beneath 0.3-0.47m of topsoil. With the exception of three modern postholes penetrating less than 100mm into the natural, this trench contained only one feature: a west-northwest to east-southeast aligned ditch [10], measuring between 0.62m wide, and up to 0.12m deep. The only fill of this feature (11) contained no finds and thus remains undated. In the absence of the evidence to the contrary, it is likely that ditch [10] is also a relatively recent agricultural boundary or drainage feature.

4 CONCLUSION

- 4.1 The topography of the site varies very little, as is to be expected on a former river terrace, with ground level lying between 37.53 and 37.84m OD. The natural consisted predominantly of coarse sands and gravels, and is overlain by subsoil varying in depth from 0.1m to 0.48m deep. The presence of small fragments of modern pottery, brick and tile within this subsoil probably results from ploughing of the area prior to its most recent use as a sports field.
- 4.2 The identification of one post medieval ditch and one undated ditch support the interpretation that the site was in agricultural use during at least the late post medieval and modern periods. The extremely low quantities of finds from any period suggest that the site has always been peripheral to any settlements.
- 4.3 The results of this evaluation indicate that any development at the site will have no or negligible archaeological impact.

5 ACKNOWLEDGEMENTS

PCA would like to thank CgMs for commissioning this work on behalf of SPC Ltd. Thanks are also due to Myk Flitcroft of CgMs for discussions on site; to Bryn Williams for supplying and driving the mechanical excavator; and to Ken Hamilton of Norfolk Landscape Archaeology for monitoring the fieldwork. The fieldwork was undertaken by Tom Woolhouse and Daryl Stump, and the figures were produced by Josephine Brown.

6 REFERENCES

Gajos, P. 2012. A Specification for an Archaeological Trial Trench Evaluation, Former Lakenham Sports and Leisure Centre, Norwich. CgMs Consulting.

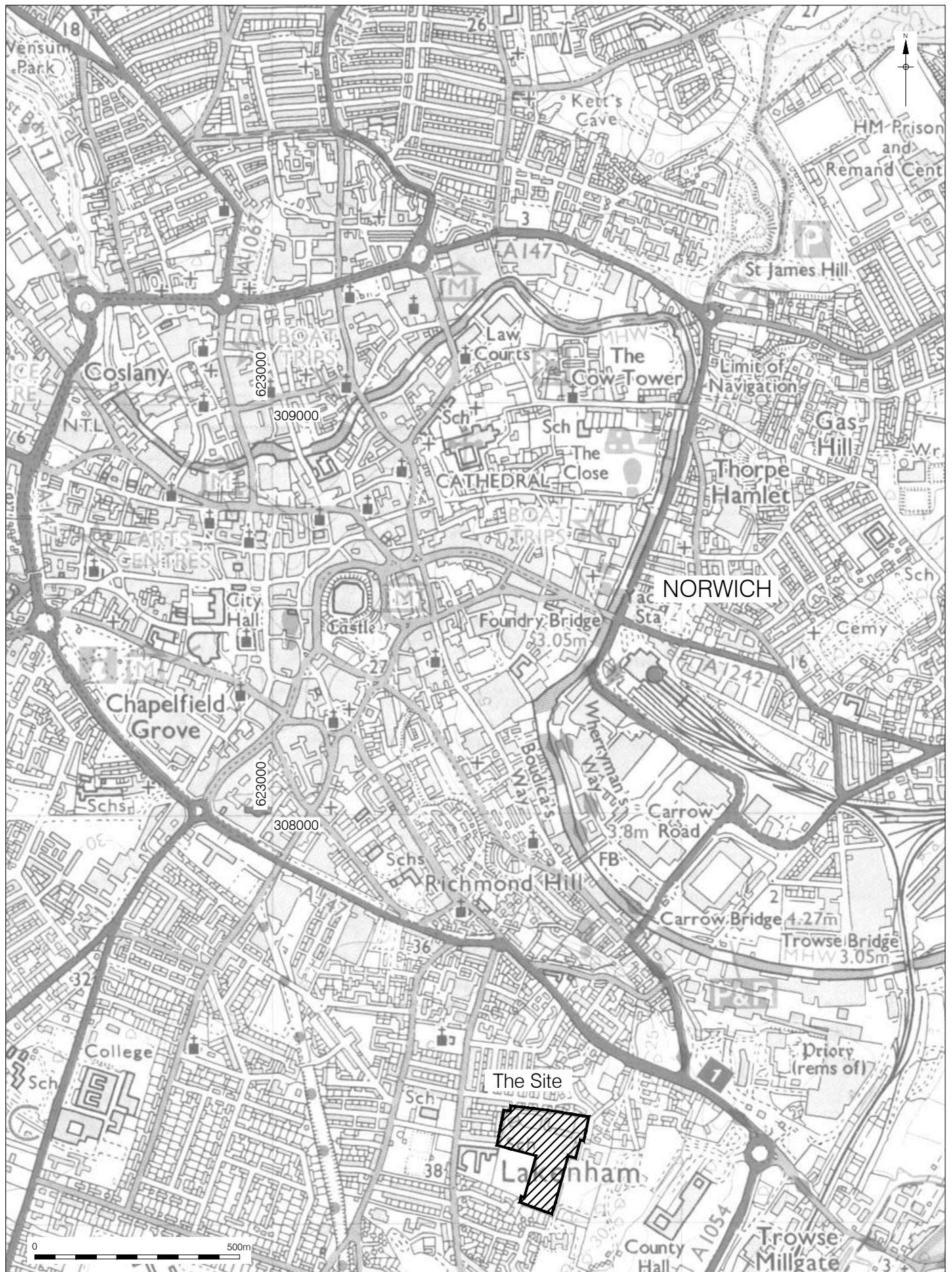

© Crown copyright 2008. All rights reserved. License number 36110309
 © Pre-Construct Archaeology Ltd 2012
 22/10/12 JS

Figure 1
 Site Location
 1:12,500 at A4



© Crown copyright 2012. All rights reserved. License number PMP36110309

© Pre-Construct Archaeology Ltd 2012

22/10/12 JS

Figure 2
Trench Location
1:1,250 at A4

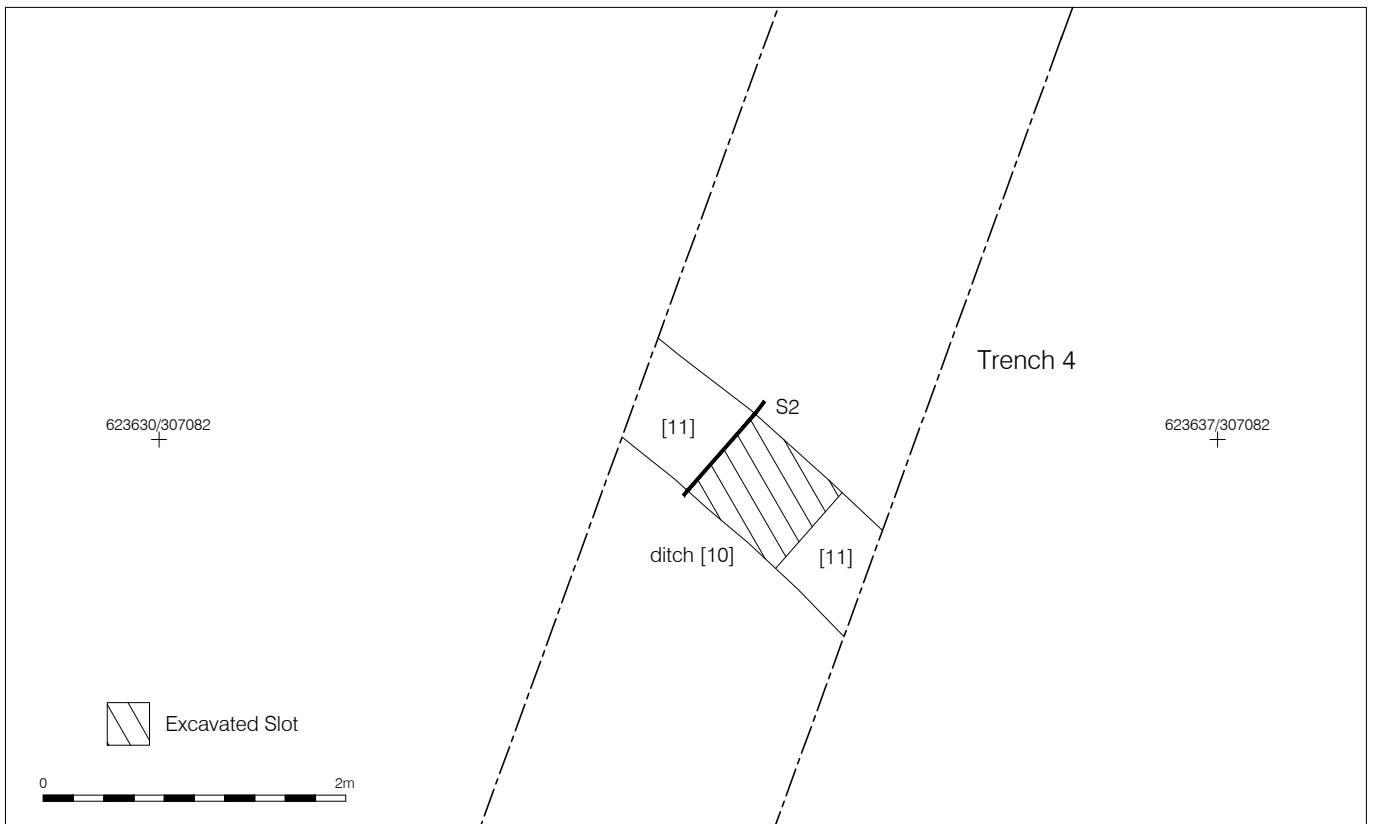
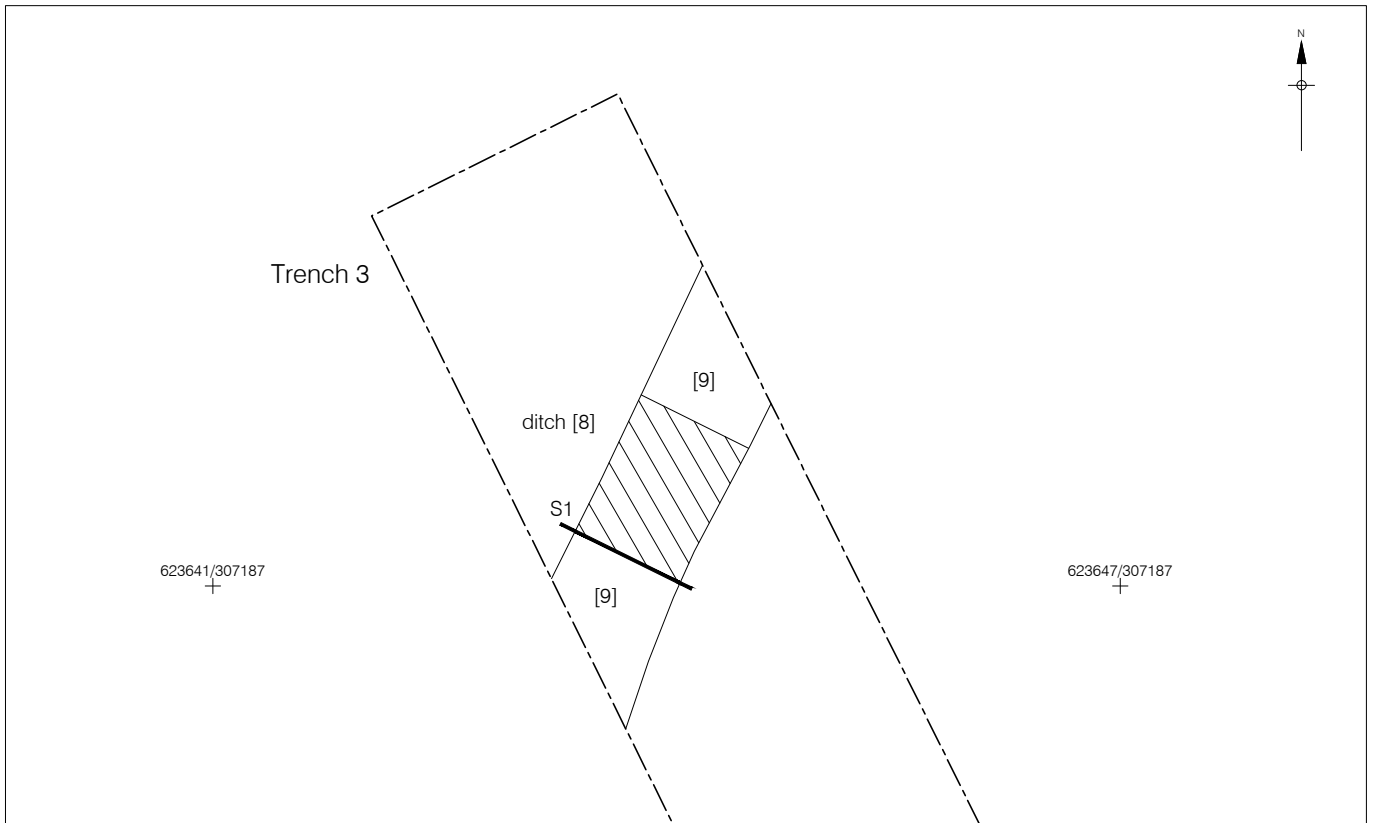
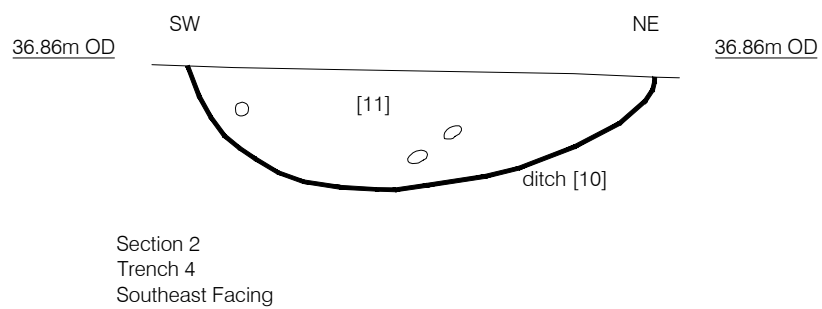
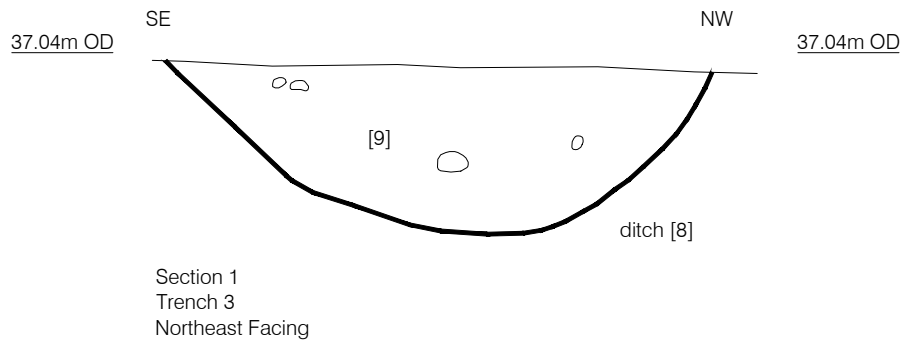

Figure 3
Detail Plan showing Ditches [8] & [10]
1:50 at A4



APPENDIX 1: CONTEXT REGISTER

Context	Cut	Type	Trench	Comments
1	-	Trench	1	Trench 1
2	-	Trench	2	Trench 2
3	-	Trench	3	Trench 3
4		Trench	4	Trench 4
5	-	Layer	All	Topsoil
6	-	Layer	All	Subsoil
7	-	Layer	All	Natural
8	-	Ditch cut	3	Postmedieval field boundary ditch
9		Ditch fill	3	Only fill of postmedieval boundary ditch
10		Ditch cut	4	Undated field boundary ditch
11		Ditch fill	3	Only fill of undated boundary ditch

APPENDIX 2: PLATES

PLATE 1: Lakenham Sports and Leisure Centre pavilion, pre-excavation.



PLATE 2: Trench 3 looking SE with ditch [8] in foreground



PLATE 4: Trench 4 looking north



APPENDIX 3: OASIS FORM

6.1 OASIS ID: preconst1-136193

Project details

Project name	Lakenham, Sports Ground, Norwich
Short description of the project	An archaeological trial trench evaluation at the former Lakenham Sports and Leisure Centre, Norwich. The work was commissioned by CgMs Consulting to assess the archaeological implications of development of the site. The work was undertaken between the 17th and 18th October 2012 and comprised the excavation of four archaeological evaluation trenches, each 1.8m wide and totalling 190m in length. The only archaeological features encountered were two ditches, one of which is undated and the other dates to the post-medieval period.
Project dates	Start: 17-10-2012 End: 18-10-2012
Previous/future work	No / Not known
Any associated project reference codes	ENF 129932 - Sitecode
Type of project	Field evaluation
Site status	None
Current Land use	Community Service 2 - Leisure and recreational buildings
Monument type	AGRICULTURAL, DITCH Post Medieval
Significant Finds	POTTERY Early Medieval
Project location	
Country	England
Site location	NORFOLK NORWICH NORWICH Lakenham Sports Ground

Postcode	NR1 2HN
Study area	3.20 Hectares
Site coordinates	TG 2356 0718 52 1 52 36 56 N 001 18 10 E Point
Lat/Long Datum	WGS 84 Datum
Height OD / Depth	Min: 37.30m Max: 37.50m
Project creators	
Name of Organisation	PCA
Project brief originator	CgMs Consulting
Project design originator	CgMs Consulting
Project director/manager	Mark Hinman
Project supervisor	Tom Woolhouse
Type of sponsor/funding body	Developer
Name of sponsor/funding body	SPC Ltd
Project archives	
Physical Archive recipient	Norfolk Museums and Archaeology Service
Physical Contents	"Ceramics"
Digital Archive recipient	Norfolk Museum and Archaeology Service
Digital Media available	"Database","Survey","Text"
Paper Archive recipient	Norfolk Museums and Archaeology Service
Paper Media available	"Context sheet","Drawing"
Entered by	Mark Hinman (mhinman@pre-construct.com)
Entered on	24 October 2012

PCA

PCA SOUTH

UNIT 54
BROCKLEY CROSS BUSINESS CENTRE
96 ENDWELL ROAD
BROCKLEY
LONDON SE4 2PD
TEL: 020 7732 3925 / 020 7639 9091
FAX: 020 7639 9588
EMAIL: info@pre-construct.com

PCA NORTH

UNIT 19A
TURSDALE BUSINESS PARK
DURHAM DH6 5PG
TEL: 0191 377 1111
FAX: 0191 377 0101
EMAIL: info.north@pre-construct.com

PCA CENTRAL

7 GRANTA TERRACE
STAPLEFORD
CAMBRIDGESHIRE CB22 5DL
TEL: 01223 845 522
FAX: 01223 845 522
EMAIL: info.central@pre-construct.com

PCA WEST

BLOCK 4
CHILCOMB HOUSE
CHILCOMB LANE
WINCHESTER
HAMPSHIRE SO23 8RB
TEL: 01962 849 549
EMAIL: info.west@pre-construct.com

PCA MIDLANDS

17-19 KETTERING RD
LITTLE BOWDEN
MARKET HARBOROUGH
LEICESTERSHIRE LE16 8AN
TEL: 01858 468 333
EMAIL: info.midlands@pre-construct.com

