

**514 UXBRIDGE ROAD
HA5 4SG**

**AN ARCHAEOLOGICAL WATCHING
BRIEF**

**LOCAL PLANNING AUTHORITY:
LONDON BOROUGH OF HARROW**

PCA REPORT NO: 11777

SITE CODE: UXP14

JULY 2014

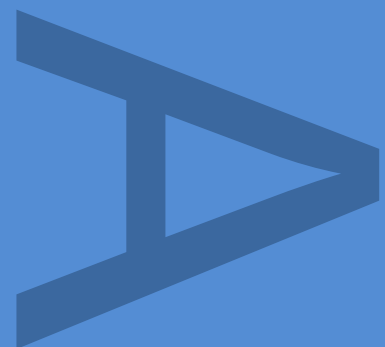

DOCUMENT VERIFICATION

514 UXBRIDGE ROAD, HARROW, HA5 4SG
AN ARCHAEOLOGICAL WATCHING BRIEF

Quality Control

Pre-Construct Archaeology Ltd	
Project Number	K3599
Report Number	R11777

	Name & Title	Signature	Date
Text Prepared by:	David Taylor		June 2014
Graphics Prepared by:	Josephine Brown		June 2014
Graphics Checked by:	Josephine Brown	<i>Josephine Brown</i>	June 2014
Project Manager Sign-off:	Peter Moore	<i>Peter Moore</i>	July 2014

Revision No.	Date	Checked	Approved

Pre-Construct Archaeology Limited
Unit 54
Brockley Cross Business Centre
96 Endwell Road
London
SE4 2PD

514 Uxbridge Road, London Borough Of Harrow, HA5 4SG

An Archaeological Watching Brief

Local Planning Authority: London Borough of Harrow

Planning Application Number: P/3190/13

Site Code: UXP14

Central National Grid Reference: TQ 1211 9077

Written by: David Taylor

Project Manager: Peter Moore

Commissioning Client: Monica Patel

**Contractor: Pre-Construct Archaeology Limited
Unit 54, Brockley Cross Business Centre
96 Endwell Road
Brockley
London SE4 2PD**

Tel: 020 7732 3925

Fax: 020 7732 7896

E-mail: pmoore@pre-construct.com

Web: www.pre-construct.com

© Pre-Construct Archaeology Limited

July 2014

© The material contained herein is and remains the sole property of Pre-Construct Archaeology Limited and is not for publication to third parties without prior consent. Whilst every effort has been made to provide detailed and accurate information, Pre-Construct Archaeology Limited cannot be held responsible for errors or inaccuracies herein contained.

CONTENTS

1	ABSTRACT	2
2	INTRODUCTION.....	3
3	PLANNING BACKGROUND	4
4	ARCHAEOLOGICAL METHODOLOGY	6
5	ARCHAEOLOGICAL SEQUENCE.....	7
6	CONCLUSIONS	8
7	BIBLIOGRAPHY.....	9

APPENDICES

APPENDIX 1: CONTEXT REGISTER.....	10
APPENDIX 2: OASIS FORM	11

FIGURES

FIGURE 1: SITE LOCATION.....	14
FIGURE 2: PILE LOCATIONS.....	15

1 ABSTRACT

- 1.1 An archaeological watching brief was conducted by Pre-Construct Archaeology Ltd at 514 Uxbridge Road, Pinner in the London Borough of Harrow. The work was commissioned by Ms Monica Patel who is the house owner and was monitored on behalf of the London Borough of Harrow by Gillian King, Archaeological Adviser (GLAAS).
- 1.2 The works carried out comprised observing the digging of foundation piles for a house extension. It was agreed that a sample number of foundation piles would be observed archaeologically. The foundation piles that were observed were Pile 1, Pile 2.1, Pile 6, Pile 9 and Pile 10. The location of the piles can be seen in Figure 1. Each pile was observed to a depth of 1m.
- 1.3 The natural alluvium was observed 0.3m below ground level in all the pile locations observed. Above this was either modern top soil or foundations for modern paving stones.
- 1.4 There was no evidence to suggest that Grim's Ditch ran across this part of the site.

2 INTRODUCTION

- 2.1 An archaeological watching brief was conducted by Pre-Construct Archaeology Ltd at 514 Uxbridge Road, Pinner in the London Borough of Harrow. The proposed development consists of a private house extension with piled foundations.
- 2.2 The site is bounded by private houses to the north, east and west and by Uxbridge Road to the south.
- 2.3 It has been suggested that Grim's Dyke may run across the site which means it lies within an Archaeological Priority Area as defined by the London Borough of Harrow. The site does not contain nor is adjacent to a scheduled ancient monument.
- 2.4 The archaeological watching brief was conducted on 16th June 2014, the watching brief was carried out by David Taylor of Pre-Construct Archaeology Ltd and the project manager for this work was Peter Moore also of Pre-Construct Archaeology Ltd. The work was commissioned by Ms Monica Patel and monitored by Gillian King, the Archaeological Adviser to the London Borough of Harrow.
- 2.5 The work was carried out in accordance with the Written Scheme of Investigation¹ which was approved by the Greater London Archaeological Advisory Service (GLAAS). The WSI posed the following research objective:
- It is proposed to auger 13 foundation piles in an area known to lie approximately across the line of Grim's Ditch and an archaeological condition was imposed on the planning permission for the extension. It is proposed that an archaeological watching brief is undertaken on a sample number of the piles so as to ascertain whether Grim's Ditch does cross this site. By measuring the spaces between the auger "teeth", any change in the height of the natural soil can be seen and recorded. If the sample number of piles does not show any change in the height of the natural soil the ditch does not pass through this part of the site and the work will cease. If the ditch is present the other piles will be archaeologically monitored and recorded so as to provide a more accurate profile of this archaeological feature*
- 2.6 The works involved watching a sample number of five pile foundations being dug.
- 2.7 The National Grid reference for the site is TQ 1211 9077
- 2.8 The site was assigned the unique site code UXP 14
- 2.9 The completed site archive comprising all site records will be deposited with LAARC.

¹ Moore P (2014) *Written Scheme of Investigation for an archaeological watching brief at 514 Uxbridge Road Pinner, HA5 4SG London Borough of Harrow*

3 PLANNING BACKGROUND

3.1 National Guidance: Planning Policy Framework NPPF

3.1.1 The National Planning Policy Framework (NPPF) was adopted on March 27th 2012, and now supersedes the Planning Policy Statements (PPSs). The NPPF constitutes guidance for local planning authorities and decision-takers both in drawing up plans and as a material consideration in determining applications.

3.1.2 In considering any planning application for development the local planning authority will be guided by the policy framework set by the NPPF, by current Local Plan policy and by other material considerations.

3.2 Regional Guidance: The London Plan

3.2.1 The proposed development is subject to the considerations of policy 7.8 from The London Plan (2011):

Historic environment and landscapes

Policy 7.8 Heritage assets and Archaeology

Strategic

A London's historic environment, including natural landscapes, conservation areas, heritage assets, World Heritage Sites, Scheduled Ancient Monuments and memorials should be identified, preserved and restored.

B Development should incorporate measures that identify, record, interpret, protect and, where appropriate, present, the site's archaeology.

Planning decisions

C Development should preserve, refurbish and incorporate heritage assets, where appropriate.

D New development in the setting of heritage assets, and conservation areas should be sympathetic to their form, scale, materials and architectural detail.

E New development should make provision for the protection of archaeological resources and significant memorials. Where the artefact or memorial cannot be moved from the site without damaging its cultural value, the assets should where possible be made available to the public on-site.

LDF preparation

F Boroughs should, in LDF policies, seek to maintain and increase the contribution of built heritage to London's environmental quality and economy while allowing for London to accommodate change and regeneration.

G Boroughs, in consultation with English Heritage, Natural England and other relevant statutory organisations, should include appropriate policies in their LDFs for identifying and protecting heritage assets scheduled ancient monuments, archaeological assets, memorials and natural landscape character within their area.

3.3 Local Guidance: Archaeology in Harrow

3.3.1 The geology and topography of Harrow made the area popular with early settlers. Traces of early man have been found in Middlesex and evidence of prehistoric man has been found in Harrow Weald. Roman evidence has been excavated in Stanmore and Saxon material in Sudbury and central Harrow.

3.4 Archaeological Priority Areas

3.4.1 Areas which are suspected to contain below ground archaeology are designated, with the help of English Heritage, as Archaeological Priority Areas (APAs).

There are nine APAs including:

- Possible site of Roman settlement of Sullonicae (along Brockley Hill, Edgware)
- Edgware Village (along Edgware High Street , Edgware)
- Roman tile manufacture in Canons Park (Edgware)
- Medieval Stanmore (along Old Church Lane , Stanmore)
- Possible site of medieval Bentley Priory (east of Clamp Hill, Stanmore)
- Medieval Pinner (including the High Street and surrounding roads in Pinner)
- Old Pinner Deer Park (either side of George V Avenue, Pinner)
- Historic Harrow (core area of Harrow on the Hill)
- Parts of Grim's Dyke (in Hatch End and Pinner)

3.4.2 Where development is proposed within an APA, English Heritage will require applicants to provide sufficient information to assess the archaeological implications of the development.

4 ARCHAEOLOGICAL METHODOLOGY

- 4.1 The watching brief was carried out in accordance with the Written Scheme of Investigation².
- 4.2 A sample of five pile foundation trenches were observed being hand dug down to 1m deep.
- 4.3 The five piles that were observed were Pile 1, Pile 2.1, Pile 6, Pile 9 and Pile 10. The locations of these are shown in Figure 1. These five locations were chosen as they represented an equal spread across the site.

² Moore P (2014) *Written Scheme of Investigation for an archaeological watching brief at 514 Uxbridge Road Pinner, HA5 4SG London Borough of Harrow*

5 ARCHAEOLOGICAL SEQUENCE

- 5.1 The archaeological sequence is fairly simple with only five different deposits recorded in total; however each deposit has been given a separate number in different pile holes. There are eleven contexts in total.
- 5.2 Phase 1: Natural Alluvial Clay
 - 5.2.1 In all piles except Pile 10 a natural yellowish brown silty clay alluvial material [3]/[6]/[8]/[10] was observed.
 - 5.2.2 The only hole this didn't appear in was Pile 10 where it was truncated by modern activity.
 - 5.2.3 The deposit appeared at 0.3m below ground level and continued beyond formation depth in all but one of the four pile holes it was observed in.
 - 5.2.4 The one exception to this was Pile 6 where the alluvial clay first appeared at 0.45m below ground level. The topsoil was thicker here and had truncated the top part of the natural alluvium.
- 5.3 Phase 2: Interface between topsoil and alluvium
 - 5.3.1 This deposit [5] and [2] was observed in Pile 9 and Pile 6 and consisted of yellowish brown sandy clay. This deposit represented the interface where the topsoil had leached into the alluvium creating a unique deposit.
- 5.4 Phase 3 Modern Activity
 - 5.4.1 This was observed in the form of three separate deposits.
 - 5.4.2 In Pile 10 there was a deposit of redeposited alluvium material [11] between two pieces of concrete 0.5m apart.
 - 5.4.3 In Pile 6 and Pile 9 the modern activity was represented by modern topsoil [4] and [1] consisting of mid to dark brown silty soil.
 - 5.4.4 In Pile 2.1 and Pile 1 the modern activity was represented by a light greyish brown clay [7]/[9] that had been used as a foundation for modern paving slabs.

6 CONCLUSIONS

- 6.1 As there was no change in the height of the natural alluvium across the site apart from where it was truncated by natural activity it is possible to conclude that Grim's Dyke does not cross this part of the site.

7 BIBLIOGRAPHY

7.1 Printed Sources

Moore P (2014) *Written Scheme of Investigation for an archaeological watching brief at 514 Uxbridge Road Pinner, HA5 4SG London Borough of Harrow* Pre-Construct Archaeology Ltd unpublished report

7.2 Internet Sources

Harrow Core Strategy

http://www.harrow.gov.uk/info/856/local_development_framework_policy/596/core_strategy

APPENDIX 1: CONTEXT REGISTER

No.	Type	Trench	Comments
1	Layer	9	Garden soil
2	Layer	9	Yellowish brown sandy soil
3	Layer	9	Yellowish brown alluvium
4	Layer	6	Garden soil
5	Layer	6	Yellowish brown sandy soil
6	Layer	6	Yellowish brown alluvium
7	Layer	2.1	Greyish brown alluvium
8	Layer	2.1	Yellowish brown alluvium
9	Layer	1	Greyish brown alluvium
10	Layer	1	Yellowish brown alluvium
11	Layer	10	Redeposited alluvium

APPENDIX 2: OASIS FORM

OASIS ID: preconst1-182728

Project details

Project name	514 Uxbridge Road, London Borough Of Harrow, HA5 4SG
Short description of the project	An archaeological watching brief was conducted by Pre-Construct Archaeology Ltd at 514 Uxbridge Road, Pinner in the London Borough of Harrow. The works carried out comprised observing the digging of foundation piles for a house extension. It was agreed that a sample number of foundation piles would be observed archaeologically. The foundation piles that were observed were Pile 1, Pile 2.1, Pile 6, Pile 9 and Pile 10. Each pile was observed to a depth of 1m. The natural alluvium was observed 0.3m below ground level in all the pile locations observed. Above this was either modern top soil or foundations for modern paving stones. There was no evidence to suggest that Grim's Ditch ran across this part of the site.
Project dates	Start: 16-06-2014 End: 16-06-2014
Previous/future work	No / Not known
Any associated project reference codes	UXP14 - Sitecode
Type of project	Recording project
Site status	Local Authority Designated Archaeological Area
Current Land use	Residential 1 - General Residential
Monument type	NONE None
Monument type	NONE None
Significant Finds	NONE None
Investigation type	"Watching Brief"
Prompt	Planning condition
Project location	
Country	England

Site location	GREATER LONDON HARROW PINNER 514 Uxbridge Road Pinner
Postcode	HA5 4SG
Study area	20.00 Square metres
Site coordinates	TQ 121100 907700 51.6041145072 -0.380982346095 51 36 14 N 000 22 51 W Point
Height OD / Depth	Min: 0m Max: 0m

Project creators

Name of Organisation	Pre-Construct Archaeology Limited
Project brief originator	Greater London Archaeological Advisory Service
Project design originator	Peter Moore
Project director/manager	Peter Moore
Project supervisor	David Taylor
Type of sponsor/funding body	Householder
Name of sponsor/funding body	Ms Monica Patel

Project archives

Physical Archive Exists?	No
Digital Archive recipient	LAARC
Digital Archive ID	UXP14
Digital Contents	"none"
Digital Media	"Database","Images raster / digital

available	photography","Spreadsheets","Text"
Paper Archive recipient	LAARC
Paper Archive ID	UXP14
Paper Contents	"none"
Paper Media available	"Context sheet","Drawing","Map","Matrices","Photograph","Plan","Unpublished Text"

Project bibliography 1

Publication type	Grey literature (unpublished document/manuscript)
Title	514 Uxbridge Road, London Borough Of Harrow, HA5 4SG
Author(s)/Editor(s)	Taylor, D
Date	2014
Issuer or publisher	PCA
Place of issue or publication	London

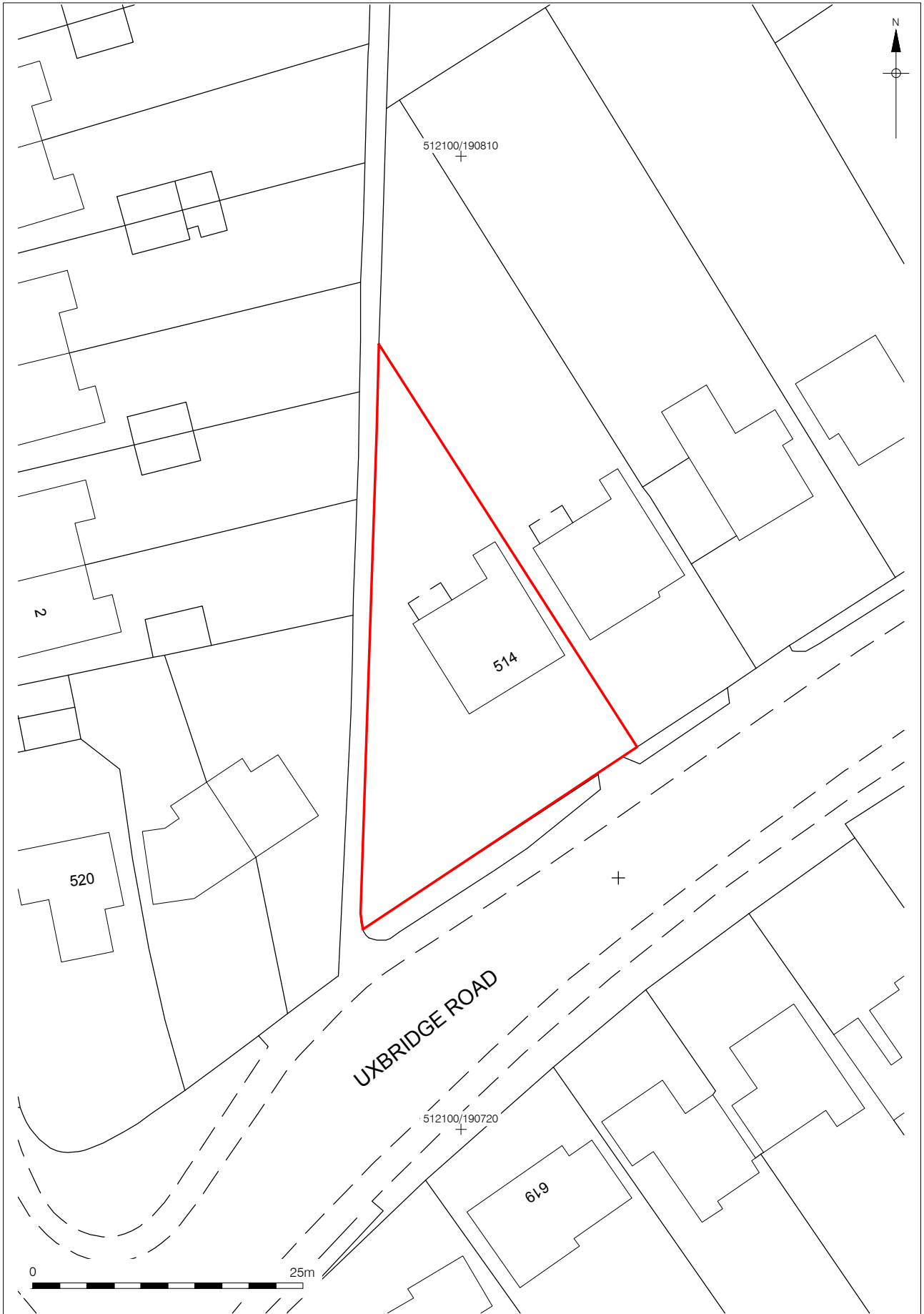

© Crown copyright 2014. All rights reserved. License number PMP36110309

© Pre-Construct Archaeology Ltd 2014

17/06/14 MR

Figure 1
Detailed Site Location
1:500 at A4

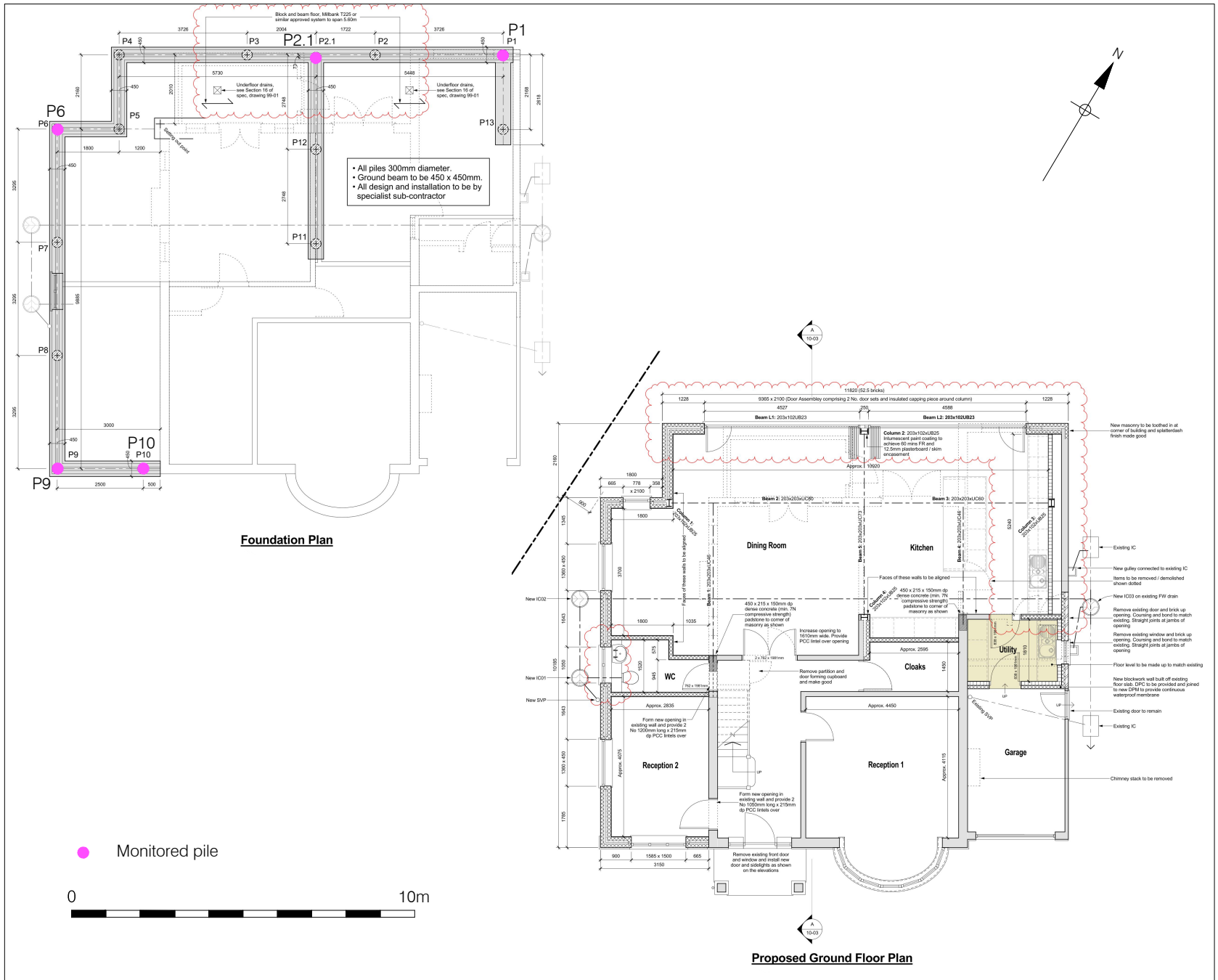

Figure 2
Pile Locations
1:160 at A4

PCA

PCA SOUTH

UNIT 54
BROCKLEY CROSS BUSINESS CENTRE
96 ENDWELL ROAD
BROCKLEY
LONDON SE4 2PD
TEL: 020 7732 3925 / 020 7639 9091
FAX: 020 7639 9588
EMAIL: info@pre-construct.com

PCA NORTH

UNIT 19A
TURSDALE BUSINESS PARK
DURHAM DH6 5PG
TEL: 0191 377 1111
FAX: 0191 377 0101
EMAIL: info.north@pre-construct.com

PCA CENTRAL

THE GRANARY, RECTORY FARM
BREWERY ROAD, PAMPISFORD
CAMBRIDGESHIRE CB22 3EN
TEL: 01223 845 522
FAX: 01223 845 522
EMAIL: info.central@pre-construct.com

PCA WEST

BLOCK 4
CHILCOMB HOUSE
CHILCOMB LANE
WINCHESTER
HAMPSHIRE SO23 8RB
TEL: 01962 849 549
EMAIL: info.west@pre-construct.com

PCA MIDLANDS

17-19 KETTERING RD
LITTLE BOWDEN
MARKET HARBOROUGH
LEICESTERSHIRE LE16 8AN
TEL: 01858 468 333
EMAIL: info.midlands@pre-construct.com

