

**Land at The Hawk, 56 Little  
Whyte, Ramsey,  
Cambridgeshire: Archaeological  
Monitoring**

**January 2016**

**Rev1**

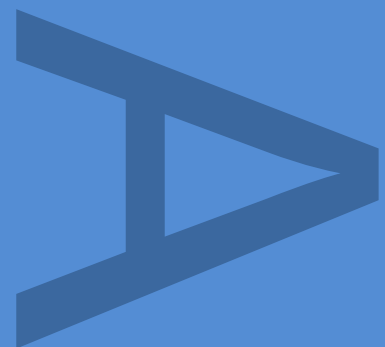

LAND AT THE HAWK, 56 LITTLE WHYTE, RAMSEY,  
CAMBRIDGESHIRE

ARCHAEOLOGICAL MONITORING

Quality Control

Pre-Construct Archaeology Ltd	
Project Number	R12315
Report Number	K4319

	Name & Title	Signature	Date
Text Prepared by:	Clare Jackson		January 2016
Graphics Prepared by:	Jennifer Simonson		January 2016
Graphics Checked by:	Josephine Brown	<i>Josephine Brown</i>	January 2016
Project Manager Sign-off:	Taleyna Fletcher	<i>Taleyna Fletcher</i>	January 2016

Revision No.	Date	Checked	Approved

Pre-Construct Archaeology Limited  
The Granary  
Rectory Farm  
Brewery Road  
Pampisford  
Cambridgeshire  
CB22 3EN

## **Land at The Hawk, 56 Little Whyte, Ramsey, Cambridgeshire: Archaeological Monitoring**

**Local Planning Authority:** Cambridge County Council

**Planning Reference:** 1401833FUL

**Central National Grid Reference:** TL 2898 8517

**Site Code:** ECB4624

**Report No.** R12315

**Written and researched by:** Clare Jackson

**Project Manager:** Taleyna Fletcher

**Commissioning Client:** Partners in Planning and Architecture

**Contractor:** Pre-Construct Archaeology Ltd  
Central Office  
The Granary  
Rectory Farm  
Brewery Road  
Pampisford  
Cambridgeshire  
CB22 3EN

**Tel:** 01223 845522

**Website:** [www.pre-construct.com](http://www.pre-construct.com)

**©Pre-Construct Archaeology Ltd**  
**January 2016**

*The material contained herein is and remains the sole property of Pre-Construct Archaeology Ltd and is not for publication to third parties without prior consent. Whilst every effort has been made to provide detailed and accurate information, Pre-Construct Archaeology Ltd cannot be held responsible for errors or inaccuracies herein contained.*

## CONTENTS

CONTENTS .....	2
1 INTRODUCTION .....	4
2 GEOLOGY AND TOPOGRAPHY .....	5
3 ARCHAEOLOGICAL BACKGROUND .....	6
4 METHODOLOGY .....	7
5 ARCHAEOLOGICAL RESULTS .....	8
6 FINDS.....	9
7 DISCUSSION AND CONCLUSIONS.....	10
8 ACKNOWLEDGEMENTS.....	11
9 BIBLIOGRAPHY .....	12
APPENDIX 1: PLATES .....	15
APPENDIX 2: CONTEXT INDEX .....	17
APPENDIX 3: OASIS FORM.....	18
APPENDIX 4: ATTENDANCE.....	21
FIGURE 1 SITE LOCATION .....	13
FIGURE 2 AREAS MONITORED.....	14

## ABSTRACT

*This report describes the results of a programme of archeological monitoring carried out by Pre-Construct Archaeology on land at The Hawk, 56 Little Whyte, Ramsey, Cambridgeshire (NGR TL 2898 8517) on 15<sup>th</sup> December 2015. The archaeological work was commissioned by Partners in Planning and Architecture on behalf of Will Hopkins in response to an outline planning condition attached to the additions and extensions to the existing public house and flat to provide two additional units. The aim of the work was to monitor the development and to ensure that any archaeological remains exposed during ground works were recorded, investigated and interpreted to an acceptable standard.*

*A silty clay layer containing pottery dating to the 15<sup>th</sup>-16<sup>th</sup> century was recorded. This layer is thought to be a former soil horizon or levelling layer relating to post medieval activity on the site.*

## **1 INTRODUCTION**

- 1.1 A programme of archaeological monitoring was undertaken by Pre-Construct Archaeology Ltd (PCA) on land at The Hawk, 56 Little Whyte, Ramsey, Cambridgeshire (centred on Ordnance Survey National Grid Reference (NGR) TL 2898 8517) on 15<sup>th</sup> December 2015 (Figure 1).
- 1.2 The archaeological work was commissioned by Partners in Planning and Architecture on behalf of Will Hopkins in response to an outline planning condition attached to the additions and extensions to the existing public house and flat to create two additional units.
- 1.3 The programme of monitoring was carried out in accordance with a Written Scheme of Investigation (WSI) prepared by Mary-Anne Slater of PCA (Slater 2015) in response to an archaeological brief produced by Gemma Stewart of Cambridgeshire County Council Historic Environment Team (CCCHET) (Stewart 2015).
- 1.4 The aim of the work was to monitor the development and to ensure that any archaeological remains exposed during ground works were recorded, investigated and interpreted to an acceptable standard.
- 1.5 A silty clay layer was recorded, containing material dating to the post medieval period.
- 1.6 This report describes the results of the archaeological monitoring. The project archive will be deposited with the Cambridgeshire Archaeological Store.

## **2 GEOLOGY AND TOPOGRAPHY**

### **2.1 Geology**

2.2 The underlying bedrock is comprised of the Oxford Clay Formation-Mudstone (British Geological Survey; Website 1). A sedimentary bedrock formed approximately 156 to 165 million years ago in the Jurassic Period when the local environment was dominated by shallow seas.

2.3 The superficial deposits are comprised of Alluvium-clay, silt, sand and gravel (BGS; Website 1). Superficial deposits formed up to 2 million years ago in the Quaternary Period when the local environment was dominated by rivers.

### **2.4 Topography**

2.5 Ramsey lies on the southern edge of the Fen Basin, approximately 11km to the north of Huntingdon and 24km north-west of Ely.

2.6 The centre of the site is located at c.5m AOD, the topography being generally flat.

### **3            ARCHAEOLOGICAL BACKGROUND**

- 3.1        A summary of the archaeological background is contained here and has been taken from the brief.
- 3.2        The proposed development is located in the historic town of Ramsey, c.80m to the north-west of the 12<sup>th</sup> century St Thomas a Becket's Church (MCB3541) and c.300m to the north-west of the scheduled Ancient Monument of 10<sup>th</sup> century Ramsey Abbey (DCB81). The Benedictine Abbey was founded c.969 AD, but a mid-13<sup>th</sup> century building is all that survives of the medieval buildings. Excavations at Ramsey Abbey School unearthed Late Saxon buildings on earth-fast post construction, followed by a 12-14<sup>th</sup> century timber framed building and post-medieval structures (MCB16055) which would have been within the Abbey precinct.
- 3.3        Archaeological investigations on the High Street have revealed evidence for Saxo-Norman and medieval occupation and indicate that this part of Ramsey was not developed until the late 12<sup>th</sup> or early 13<sup>th</sup> century, as it was prone to flooding (MCB16483). An evaluation at 102 High Street, immediately south of the site revealed waterlogged deposits and pottery dating between 1050 and 1900 AD (MCB20434).
- 3.4        The development site is a Grade II Listed building; the list entry describes The Unicorn Public House, 56 Little Whyte, Ramsey as a mid-19<sup>th</sup> century public house occupying corner position. Two storeys. Three first floor recessed hung sash windows with glazing bars; 3 larger hung sash windows with margin lights at ground floor. Main entrance at corner in round-headed arch with plain fanlight and panelled door. Sash windows above door shaped to round-headed arch with glazing bars. Included also for its position facing the corner of Church Green.



## **4 METHODOLOGY**

### **4.1 Machining and Site Planning**

4.2 The initial area monitored (Area A, Figure 2) was a 20m<sup>2</sup> brick paving strip, with a 0.50m wide and 0.20m deep foundation trench round the edge of the stripped area. This was located on the northwest edge of the development area in preparation for a building extension. During the excavation works the demolition of a wall resulted in an additional 1.50m long and 0.90m deep trench (Area B, Figure 2).

4.3 An 8 tonne mechanical excavator fitted with a 0.4m wide toothless bucket was used to strip the brick paving and excavate foundation trenches.

4.4 Exposed deposits were cleaned as necessary (and where practicable) to define them using hand tools.

4.5 Metal-detecting was carried out on all stripped deposits throughout the process and archaeological deposits and spoil heaps were surveyed by metal-detector as they were encountered.

### **4.6 Recording and Sampling**

4.7 Field excavation techniques and recording methods are detailed in the PCA Fieldwork Induction Manual (Operations Manual I) by Joanna Taylor and Gary Brown (2009).

4.8 Individual deposits were recorded as written records on PCA Pro-forma context sheets.

4.9 High-resolution digital photographs were taken at all stages of the monitoring process.

4.10 A metal detector was used during excavation to assist finds recovery.

## **5           ARCHAEOLOGICAL RESULTS**

### **5.1        Overview**

5.2        The initial area monitored (Area A, Figure 2) was a 20m<sup>2</sup> brick paving strip, with a 0.50m wide and 0.20m deep foundation trench around the edge of the stripped area. The stripping and subsequent excavation of foundation trenches in Area A revealed no archaeological finds, features or deposits. Due to the shallow depth of the trenches only a modern made ground layer (100) was revealed, this made ground contained modern pottery and crisp packets.

5.3        During the excavation works the demolition of a wall resulted in an additional 1.50m long and 0.90m deep trench (Area B, Figure 2). The excavation of the foundation trench in Area B also revealed a thick deposit of modern made ground (100), up to 0.85m thick. Sealed by this deposit was a layer of mid grey silty clay (101) containing occasional charcoal flecks and shell with rare very small fragments of demolition material. A single piece of pottery dating to the late 15<sup>th</sup>-16<sup>th</sup> century was recovered from the top of the layer (see Section 6.1). The layer extended under the current building foundations and therefore it is likely that it was a pre-19<sup>th</sup> century soil horizon or levelling layer.

## **6 FINDS**

### **6.1 Post-Roman pottery assessment**

By Chris Jarrett

- 6.2 A single sherd (20g) of pottery was recovered from the archaeological monitoring and this was found in context (101). The pottery type matches that of Bourne D ware (Lincolnshire) and consists of a fairly hard, smooth, brick-red clay body with inclusions of sparse white flecks of shell and chalk. The vessel the sherd was derived from was possibly a jug. The fragment consists of a shoulder with a rilled horizontal band and it is further decorated with an external off-white slip coating. Bourne 'D' Ware is dated 1450-1637, although the sherd from context (101) has the appearance of being 'transitional' in date and a late 15th-16th century date is further suggested for the item.
- 6.3 The sherd of pottery has no significance and the pottery type has been reported elsewhere in Ramsey (96-98 Great Whyte: Spoerry 2005).

## **7 DISCUSSION AND CONCLUSIONS**

- 7.1 No archaeological finds, features or deposits were encountered during the monitoring of groundworks in Area A at The Hawk, 56 Little Whyte Ramsey. A small area (20m<sup>2</sup>) of brick paving was stripped and revealed only modern made ground below. Where the new wall foundation trench around the edge of the stripped area was excavated (0.20m in depth) the full depth of the modern made ground was not reached.
- 7.2 In Area B modern made ground deposits were recorded to a depth of 0.85m below ground level. Beneath the made ground, a layer of mid grey silty clay containing a single piece of pottery dating to the post medieval period was recorded to a depth of 0.90m below ground level. Conclusions regarding this layer can only be tentative due to the limited area uncovered; however similar deposits have been recorded nearby at 102 High Street. It can be concluded that the layer is a levelling layer or former soil horizon relating to post medieval activity in and around the site.

## **8           ACKNOWLEDGEMENTS**

8.1       Pre-Construct Archaeology Ltd would like to thank Will Hopkins and David Mead of Partners in Planning and Architecture for commissioning the work, Stark Contracting for their assistance on site and Gemma Stewart of the Cambridgeshire County Council Historic Environment Team. The author would like to thank PCA's CAD Department for preparing the figures. The project was managed for PCA by Taleyna Fletcher.

## **9 BIBLIOGRAPHY**

### **9.1 Printed Sources**

Brown, N. and Glazebrook, J. (eds.) 2000 Research and Archaeology: a Framework for the Eastern Counties, 2. Research Agenda and Strategy. East Anglian Archaeology Occasional Paper No. 8

Glazebrook, J. (ed.) 1997 Research and Archaeology: a Framework for the Eastern Counties, 1. Resource Assessment. East Anglian Archaeology Occasional Paper No. 3

Medlycott, M. 2011. (ed.) Research and Archaeology Revisited: A revised framework for the East of England. East Anglian Archaeology Occasional Paper 24

Slater, M. 2015. Written Scheme of Investigation for Archaeological Monitoring at The Hawk, 56 Little Whyte, Ramsey, Cambridgeshire. PCA, unpublished

Spoerry, P. 2005, 'Pottery spotdating', in S. Cooper, Medieval Remains at 96-98 Great Whyte, Ramsey, Cambridgeshire: An Archaeological Evaluation. Archaeological Field Unit Cambridgeshire County Council, Report No. 824, unpublished document.

Stewart, G. 2015. Brief for Archaeological Monitoring & Recording, The Hawk, 56 Little Whyte, Ramsey. Cambridgeshire County Council, unpublished

### **9.2 Web Sources**

British Geological Survey online viewer.  
(<http://www.bgs.ac.uk/discoveringGeology/geologyOfBritain/viewer.html>)



Contains Ordnance Survey data © Crown copyright and database right 2014

© Pre-Construct Archaeology Ltd 2015

18/12/15 JS

Figure 1  
 Site Location  
 1:2,000,000; 1:25,000 at A4

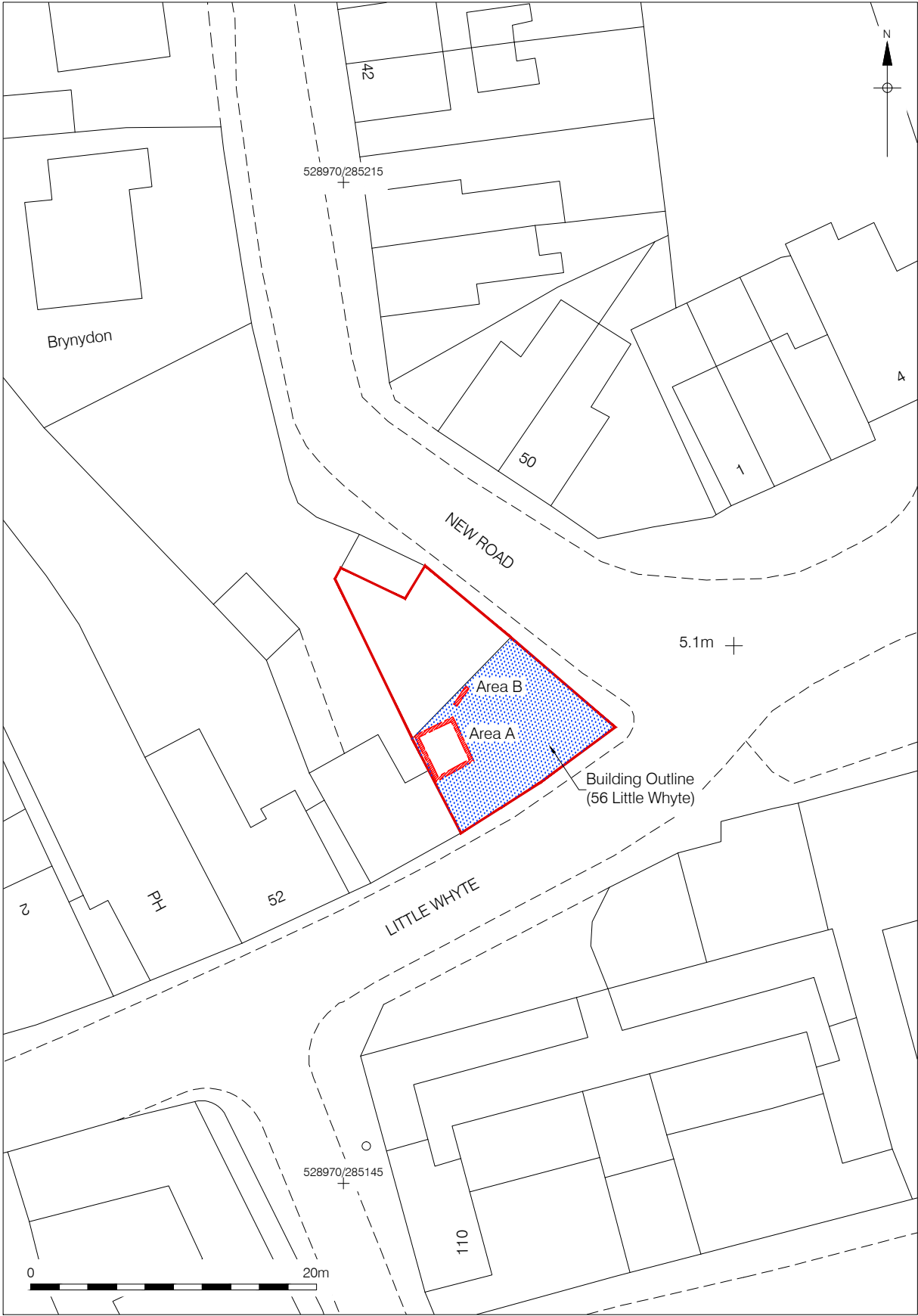

© Crown copyright 2015. All rights reserved. License number PMP36110309  
 © Pre-Construct Archaeology Ltd 2015  
 18/12/15 JS  
 26/01/16 JS\_revision 1

Figure 2  
 Trench Location  
 1:400 at A4



## APPENDIX 1: PLATES



Plate 1: Brick paving strip Area A, looking southwest



Plate 2: Excavation of foundation trench Area A



Plate 3: Made ground deposit (100) within foundation trench, looking northeast: Area A



Plate 4: Area B, Made ground deposit (100) sealing silty clay layer (101) looking southeast



Plate 5: 19<sup>th</sup> century wall foundation, looking northeast.

## APPENDIX 2: CONTEXT INDEX

Context	Type	Comment/Description	Average Thickness (m)
(100)	Made Ground	Modern levelling/foundation deposit. Comprised of crushed brick, concrete and some sand.	0.20m+ (Area A) 0.85 (Area B)
(101)	Levelling layer	Post medieval levelling layer. Comprised of mid grey silty clay with occasional charcoal flecks and rare very small demolition material.	0.05 +

## APPENDIX 3: OASIS FORM

OASIS ID: preconst1-235859

### Project details

Project name	Land at The Hawk, 56 Little Whyte, Ramsey, Cambridgeshire: Archaeological Monitoring
Short description of the project	This report describes the results of a programme of archeological monitoring carried out by Pre-Construct Archaeology on land at The Hawk, 56 Little Whyte, Ramsey, Cambridgeshire (NGR TL 2898 8517) on 15th December 2015. The archaeological work was commissioned by Partners in Planning and Architecture on behalf of Will Hopkins in response to an outline planning condition attached to the additions and extensions to the existing public house and flat to provide two additional units. The aim of the work was to monitor the development and to ensure that any archaeological remains exposed during ground works were recorded, recovered and interpreted to an acceptable standard. A deposit containing material dating to the post medieval period was recorded.
Project dates	Start: 15-12-2015 End: 15-12-2015
Previous/future work	No / No
Any associated project reference codes	ECB4624 - Sitecode
Type of project	Recording project
Site status	Listed Building
Current Land use	Other 3 - Built over
Monument type	NONE None
Monument type	NONE None
Significant Finds	POTTERY Post Medieval
Investigation type	"Recorded Observation"
Prompt	Direction from Local Planning Authority - Direction 4

### Project location

Country	England
Site location	CAMBRIDGESHIRE HUNTINGDONSHIRE RAMSEY Land at The Hawk,

56 Little Whyte, Ramsey, Cambridgeshire: Archaeological Monitoring

Postcode PE26 1BX

Site coordinates TL 2898 8517 52.448854702644 -0.101896819981 52 26 55 N 000 06 06  
W Point

---

### Project creators

Name of Organisation Pre-Construct Archaeology Ltd

Project brief originator Cambridgeshire County Council

Project design originator Mary-Anne Slater

Project director/manager Taleyna Fletcher

Project supervisor Clare Jackson

Type of sponsor/funding body Building contractor

Name of sponsor/funding body Will Hopkins

---

### Project archives

Physical Archive recipient CCC County Archaeology Store

Physical Contents "Ceramics"

Digital Archive recipient CCC County Archaeology Store

Digital Media available "Images raster / digital photography","Text"

Paper Archive recipient Cambridgeshire County Council Archaeology Store

Paper Media available "Plan","Report"

---

### Project

### **bibliography 1**

Publication type	Grey literature (unpublished document/manuscript)
Title	Land at The Hawk, 56 Little Whyte, Ramsey, Cambridgeshire: Archaeological Monitoring
Author(s)/Editor(s)	Jackson, C.
Date	2016
Issuer or publisher	PCA
Place of issue or publication	Cambridge
Description	A4 spiral bound

---

#### **APPENDIX 4: ATTENDANCE**

<b>Date</b>	<b>Staff</b>	<b>Works monitored</b>
15/12/2015	C. Jackson	Excavation of areas A and B

# PCA

---

## PCA SOUTH

UNIT 54  
BROCKLEY CROSS BUSINESS CENTRE  
96 ENDWELL ROAD  
BROCKLEY  
LONDON SE4 2PD  
TEL: 020 7732 3925 / 020 7639 9091  
FAX: 020 7639 9588  
EMAIL: [info@pre-construct.com](mailto:info@pre-construct.com)

---

## PCA NORTH

UNIT 19A  
TURSDALE BUSINESS PARK  
DURHAM DH6 5PG  
TEL: 0191 377 1111  
FAX: 0191 377 0101  
EMAIL: [info.north@pre-construct.com](mailto:info.north@pre-construct.com)

---

## PCA CENTRAL

THE GRANARY, RECTORY FARM  
BREWERY ROAD, PAMPISFORD  
CAMBRIDGESHIRE CB22 3EN  
TEL: 01223 845 522  
FAX: 01223 845 522  
EMAIL: [info.central@pre-construct.com](mailto:info.central@pre-construct.com)

---

## PCA WEST

BLOCK 4  
CHILCOMB HOUSE  
CHILCOMB LANE  
WINCHESTER  
HAMPSHIRE SO23 8RB  
TEL: 01962 849 549  
EMAIL: [info.west@pre-construct.com](mailto:info.west@pre-construct.com)

---

## PCA MIDLANDS

17-19 KETTERING RD  
LITTLE BOWDEN  
MARKET HARBOROUGH  
LEICESTERSHIRE LE16 8AN  
TEL: 01858 468 333  
EMAIL: [info.midlands@pre-construct.com](mailto:info.midlands@pre-construct.com)

---

